

MAULpearly
820 17 LED Table
Lamp



MAULpearly 820 17 LED Table Lamp Owner's Manual

[Home](#) » [MAUL](#) » MAULpearly 820 17 LED Table Lamp Owner's Manual 

Contents

- [1 MAULpearly 820 17 LED Table Lamp](#)
- [2 Product Specifications](#)
- [3 Product Usage Instructions](#)
- [4 FAQ](#)
- [5 OVERVIEW](#)
- [6 spare parts](#)
- [7 Documents / Resources](#)
 - [7.1 References](#)
- [8 Related Posts](#)

MAULpearly

MAULpearly 820 17 LED Table Lamp



Product Specifications

- **Brand:** MAULpearly
- **Model:** 820 17
- **Number of LEDs:** 24
- **Plug Type:** CEE 7/16
- **Input Voltage:** 220 – 240V~ 50/60 Hz
- **Cable Length:** Approximately 1.7m
- **Power Consumption:** 12V 0.36A

Product Usage Instructions

1. **Installation:** Plug the product into a compatible power outlet using the provided CEE 7/16 plug.
2. **Operation:** Switch the product ON/OFF using the designated buttons on the device.
3. **Maintenance:** No specific maintenance is required for normal operation.

FAQ

- **Q:** What is the energy efficiency class of the light source in this product?
- **A:** The energy efficiency class of the light source is indicated by the letter < D > as per regulations.
- **Q:** Are spare parts available for this product?
- **A:** Yes, spare parts are available with the following Art.-No. codes:
 - Art.-No.: 8201709.215 (4 units)
 - Art.-No.: 8201709.200 (1 unit)
 - Art.-No.: 8201709.220 (1 unit)

OVERVIEW

MAULpearly 820 17

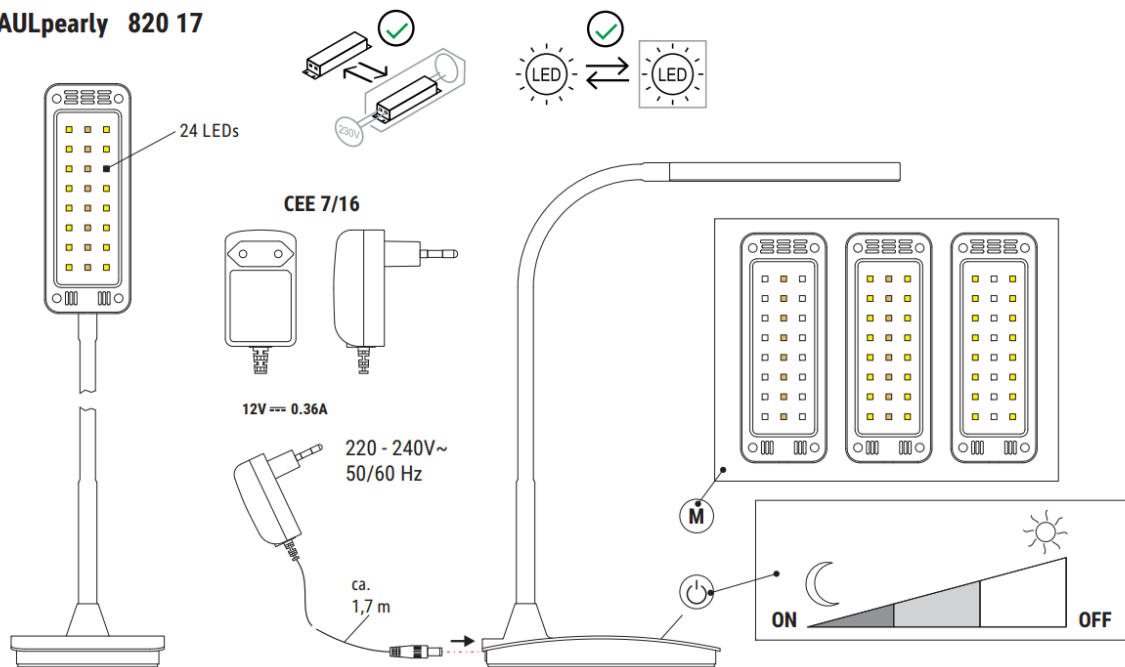

This product contains a light source of energy efficiency class < D >

spare parts



Art.-No.: 8201709.215

4 x



1 x

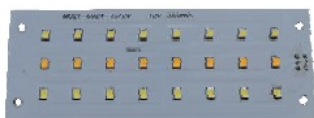

Art.-No.: 8201709.200

4 x



1 x

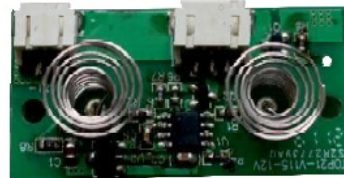

Art.-No.: 8201709.220

Art.-No.:
8201709.215

Art.-No.:
8201709.200

Art.-No.:
8201709.220



Documents / Resources

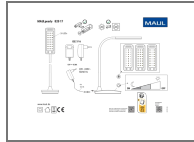

[MAUL MAULpearly 820 17 LED Table Lamp](#) [pdf] Owner's Manual
820 17, 8201709.150I, 8201709.215, 8201709.200, 8201709.220, MAULpearly 820 17 LED Table Lamp, MAULpearly 820 17, LED Table Lamp, Table Lamp, Lamp

References

- [User Manual](#)

Manuals+, Privacy Policy

This website is an independent publication and is neither affiliated with nor endorsed by any of the trademark owners. The "Bluetooth®" word mark and logos are registered trademarks owned by Bluetooth SIG, Inc. The "Wi-Fi®" word mark and logos are registered trademarks owned by the Wi-Fi Alliance. Any use of these marks on this website does not imply any affiliation with or endorsement.