

**MAUL**  
966 10  
Partition  
Wall System



## MAUL 966 10 Partition Wall System Instructions

[Home](#) » [MAUL](#) » MAUL 966 10 Partition Wall System Instructions 

### Contents

- [1 MAUL 966 10 Partition Wall System](#)
- [2 Specifications:](#)
- [3 Assembling the Stellwandsystem:](#)
- [4 Connecting the Power Supply:](#)
- [5 FAQ:](#)
- [6 Documents / Resources](#)
  - [6.1 References](#)
- [7 Related Posts](#)

**MAUL**

**MAUL 966 10 Partition Wall System**



### **Specifications:**

- Model: MAULconnecto Uplight 966 10, 966 20
- Power Supply: 100-240V~ 50/60Hz
- Output: 24V DC 1000mA
- Power Cord Length: 2m

### **Assembling the Stellwandsystem:**

1. Identify all the components included in the package.
2. Follow the provided diagram to assemble the Stellwandsystem MAULconnecto Uplight.
3. Secure the parts using the specified screws and tools.

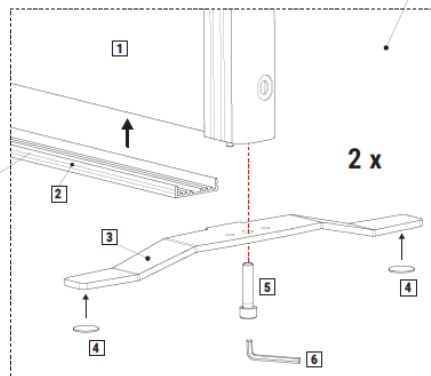
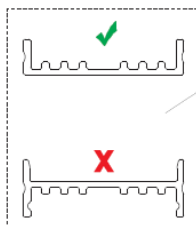
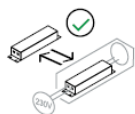
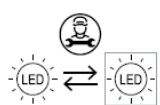
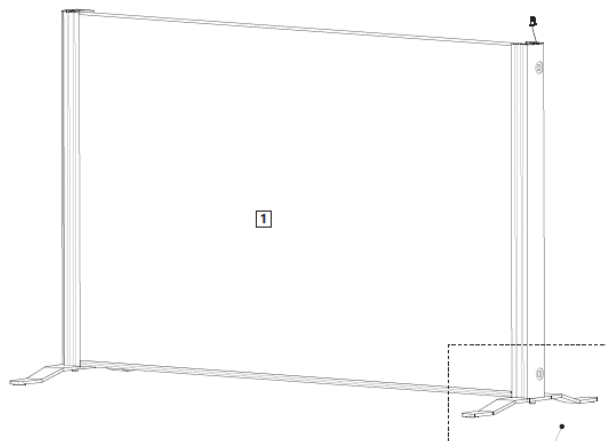
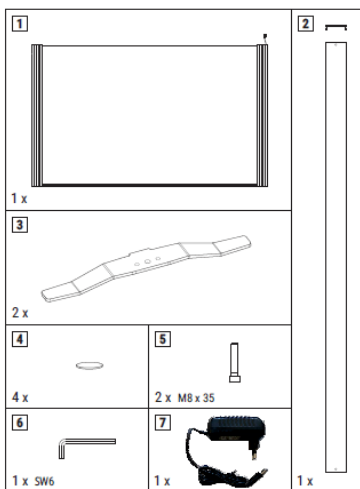

www.maul.de

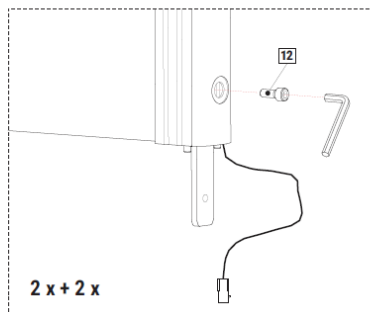
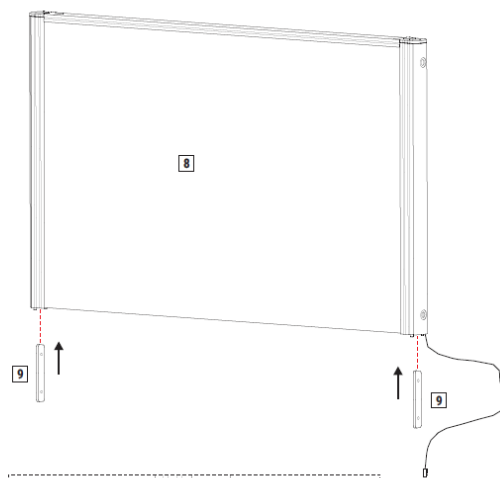
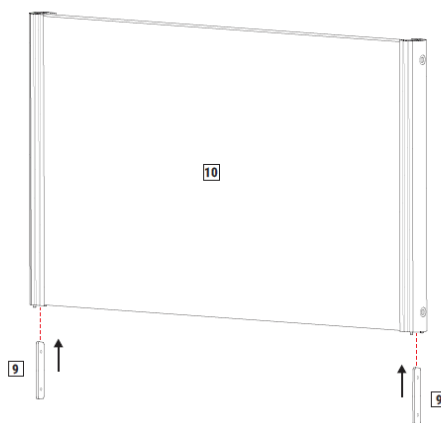
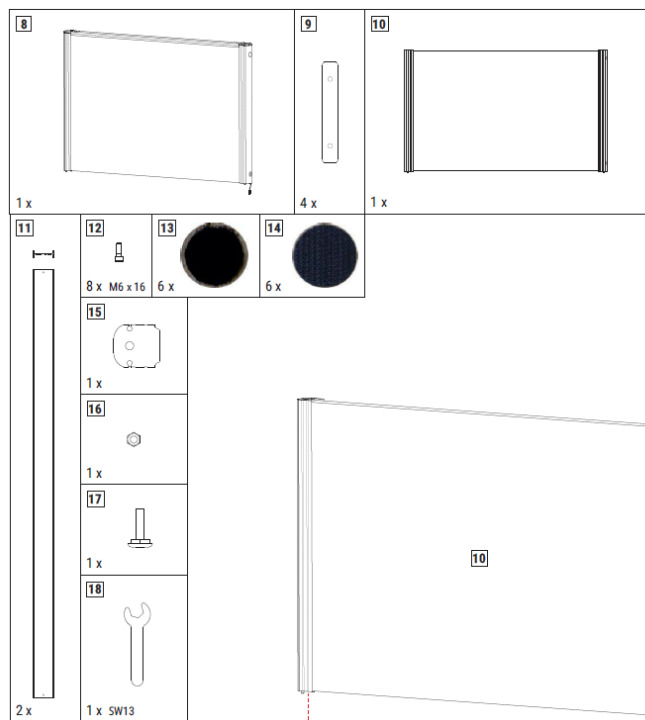

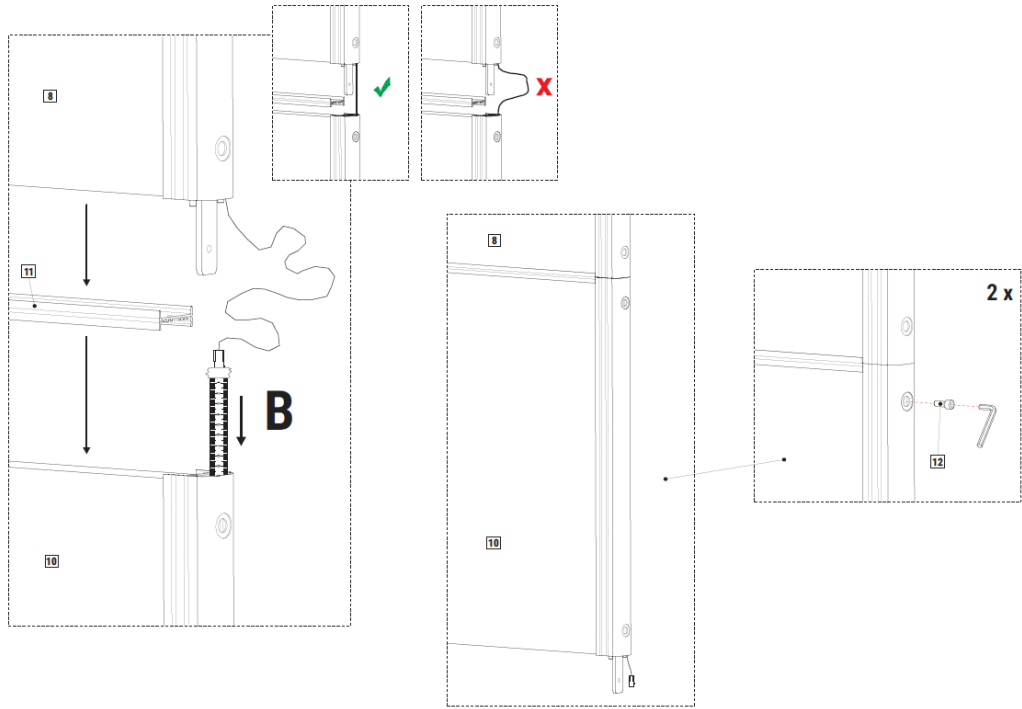
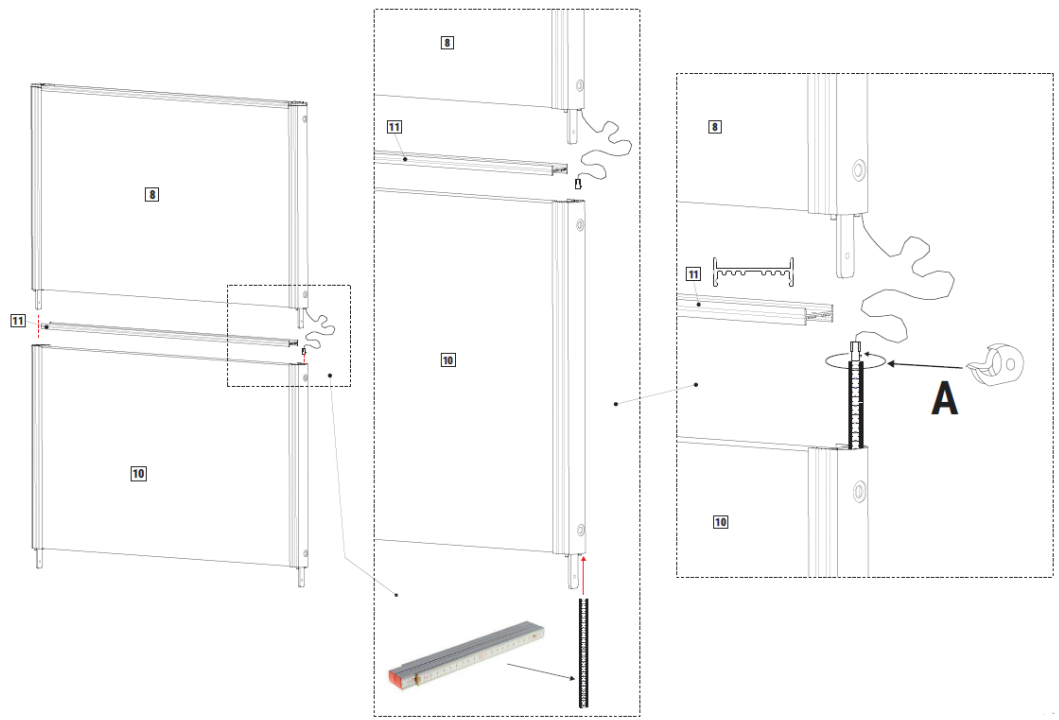

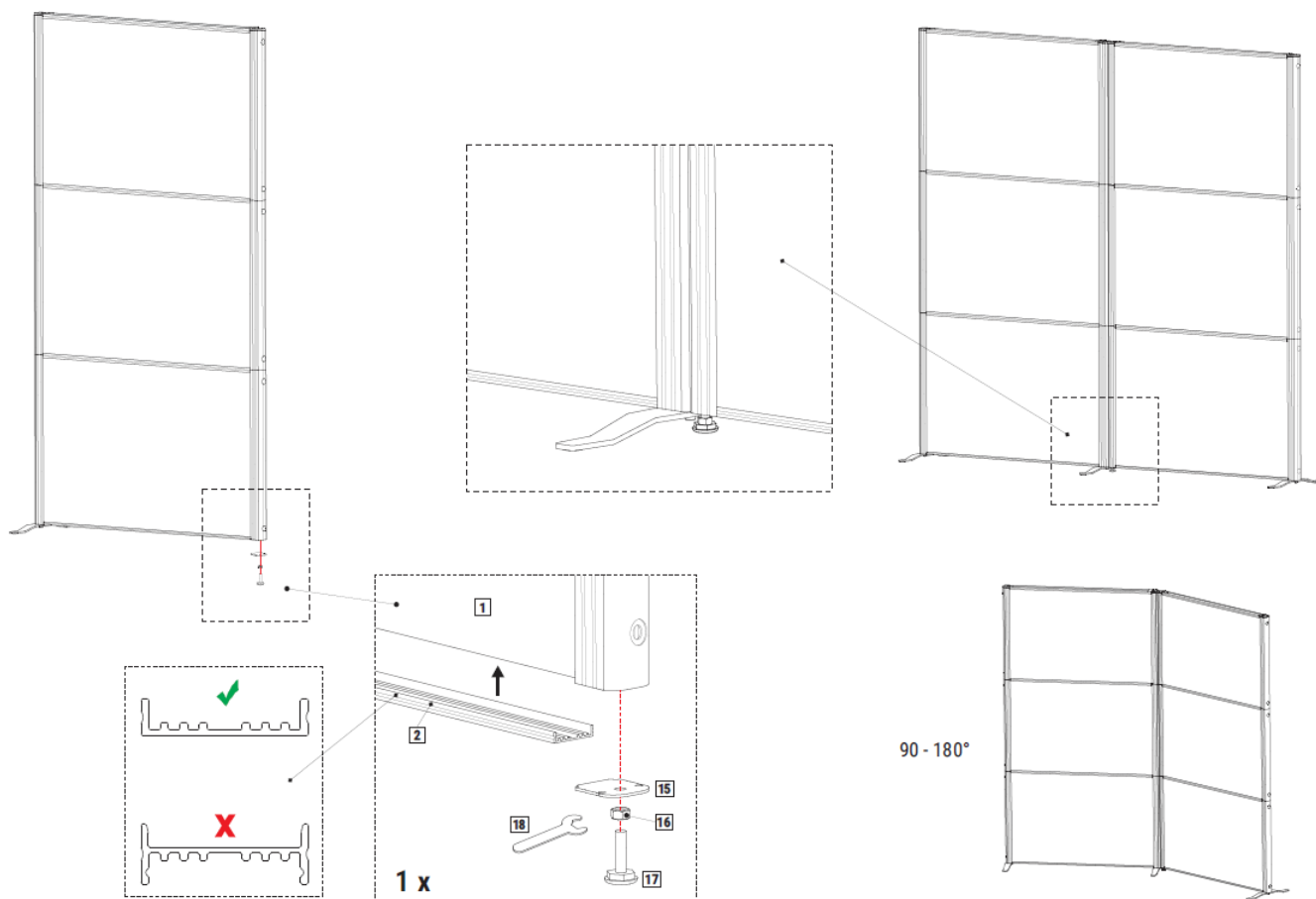
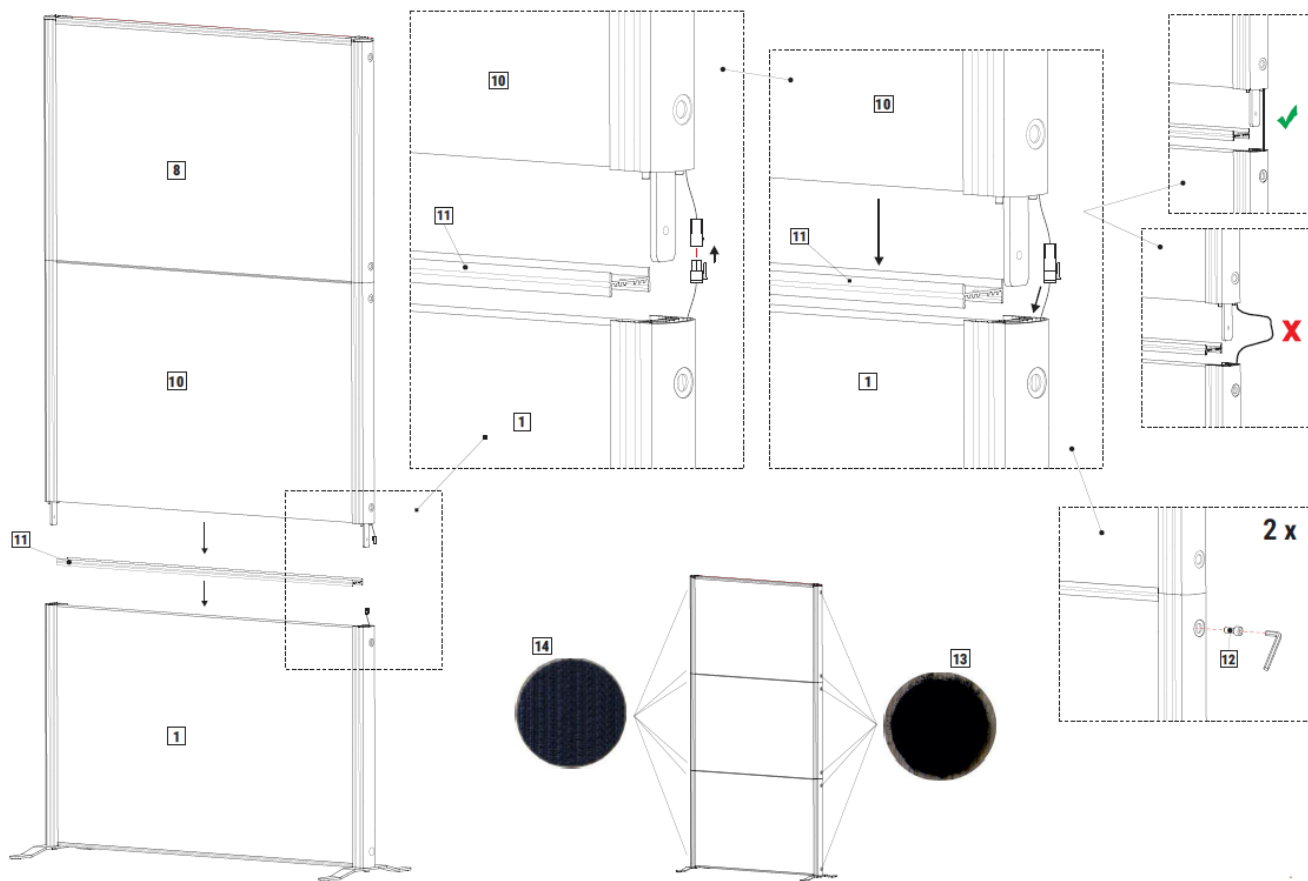

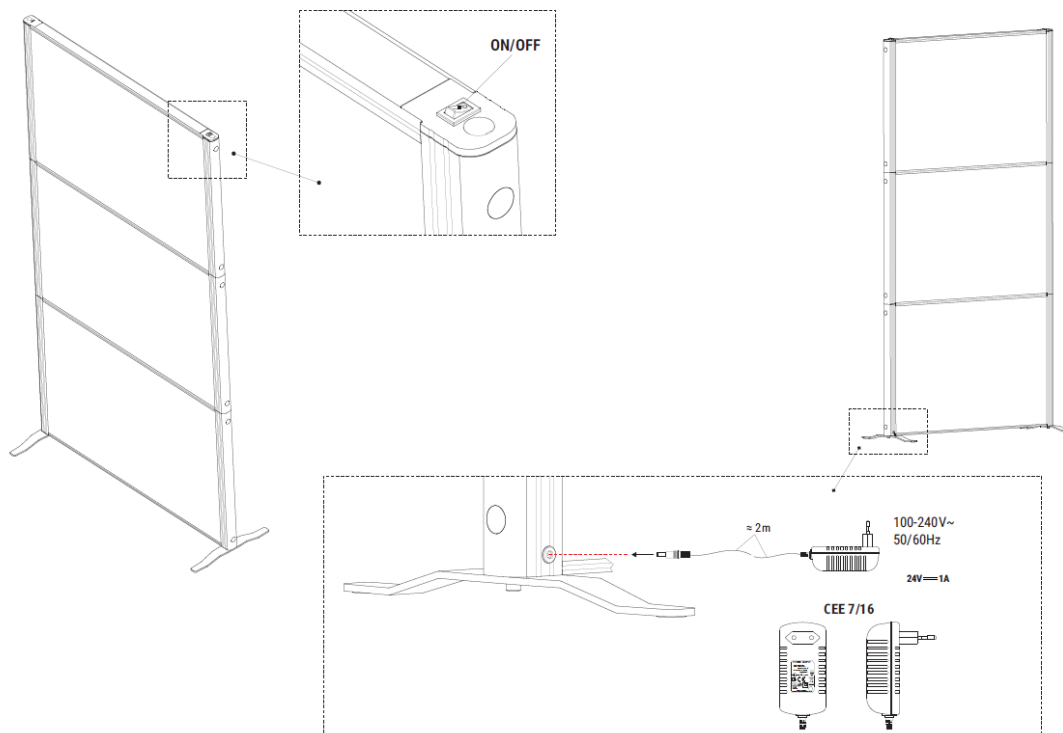
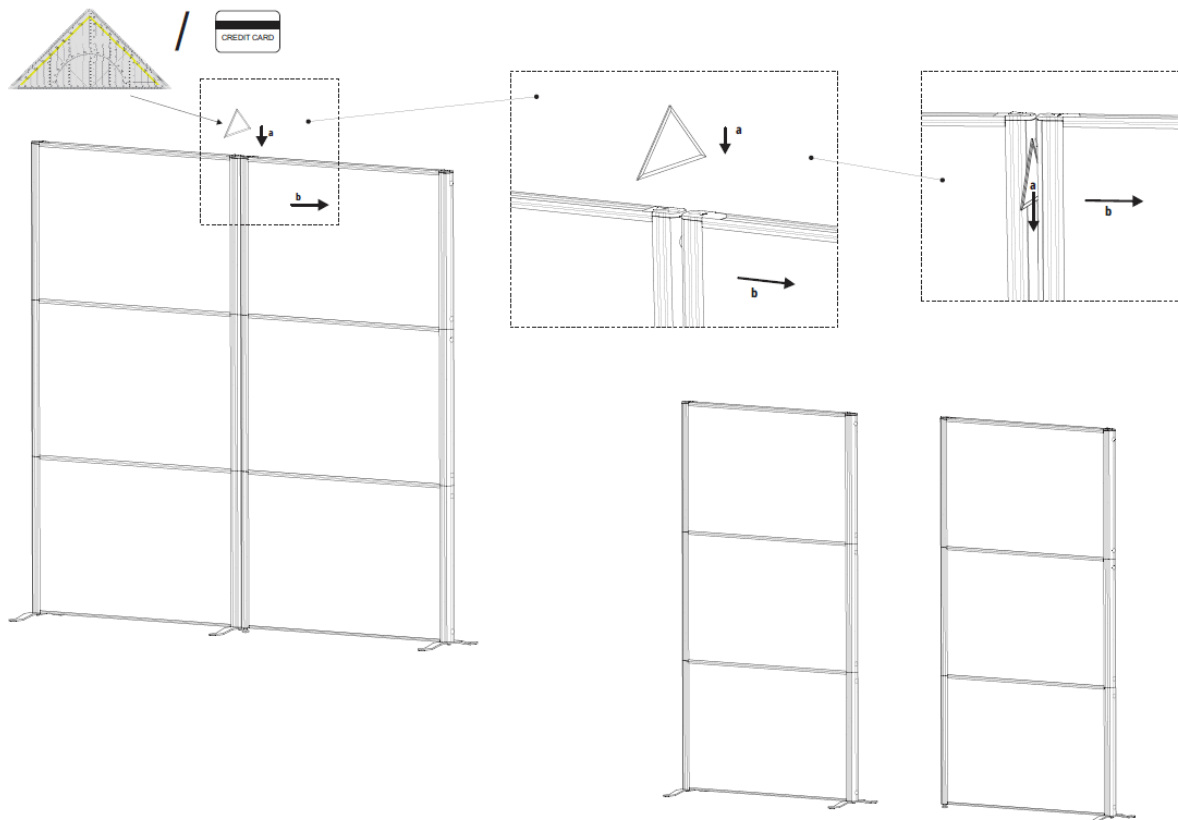

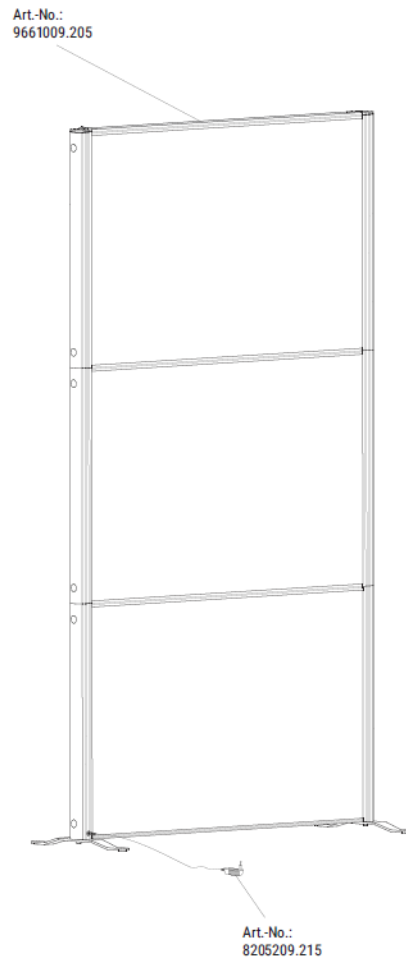

### Connecting the Power Supply:

1. Plug the power cord into a suitable power outlet with the specified voltage requirements (100-240V~ 50/60Hz).
2. Connect the power supply to the Stellwandsystem using the provided cable.
3. Make sure the ON/OFF switch is in the correct position before turning on the power.

### Adjusting the Light:

1. Once assembled and powered on, adjust the direction of the light as needed for your space.
2. You can adjust the height and angle of the light to achieve the desired lighting effect.

This product contains a light source of energy efficiency class < C >

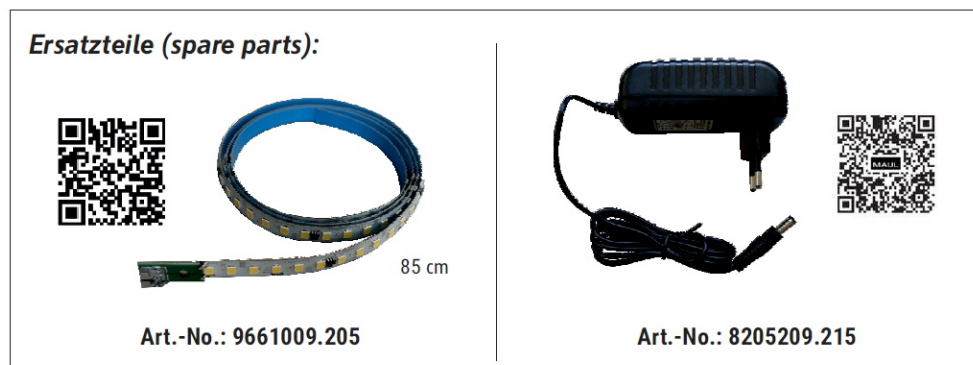

### FAQ:

**Q: What are the spare parts available for this product?**

**A:** The spare parts available include Art.-No.: 9661009.205 and Art.-No.: 8205209.215.

**Q: Where is the product manufactured?**

**A:** The product is made in China by SHENZHEN JIAYUANXING ELECTRONIC CO., LTD.

## Documents / Resources

	<p><b><a href="#">MAUL 966 10 Partition Wall System</a></b> [pdf] Instructions 966 10, 966 20, 966 10 Partition Wall System, 966 10, Partition Wall System, Wall System</p>
---	---

## References

- [TÜV Rheinland - Home | US | TÜV Rheinland](#)
- [User Manual](#)

### Manuals+ Privacy Policy

This website is an independent publication and is neither affiliated with nor endorsed by any of the trademark owners. The "Bluetooth®" word mark and logos are registered trademarks owned by Bluetooth SIG, Inc. The "Wi-Fi®" word mark and logos are registered trademarks owned by the Wi-Fi Alliance. Any use of these marks on this website does not imply any affiliation with or endorsement.