

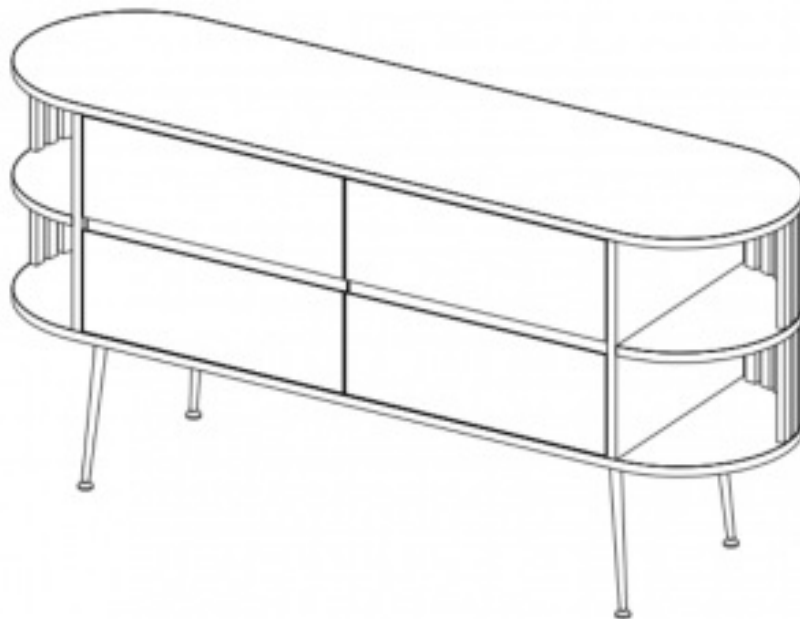

MATT BLATT Recap Sideboard User Guide

[Home](#) » [MATT BLATT](#) » MATT BLATT Recap Sideboard User Guide 

MATT BLATT Recap Sideboard



Contents

- [1 COMPONENTS](#)
- [2 ANTI-TIP KIT](#)
- [3 ASSEMBLY](#)
- [4 CLEANING & CARE](#)
 - [4.1 How to apply oil to the furniture](#)
 - [4.2 General care](#)
- [5 Documents / Resources](#)
- [6 Related Posts](#)

COMPONENTS

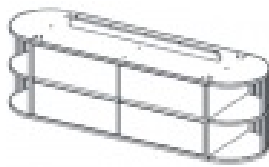

1 Cabinet body



2 Leg (x4)



3 Shelf (x2)



4 Bolt (x12)

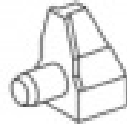

5 Shelf pin (x12)



6 Allen Key (x2)



7 Anti-tip (x2)



8 Felt pad (x4)

ANTI-TIP KIT

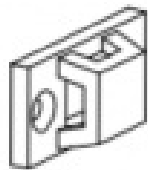

A Wall bracket (x4)



B Screws (x4)



C Cable ties (x2)

ASSEMBLY

Step 1:

- Attach the legs **(2)** to the underside of the body **(1)** using the bolts **(4)**.
- Attach the felt pads **(8)** to the bottom of the legs **(2)**.

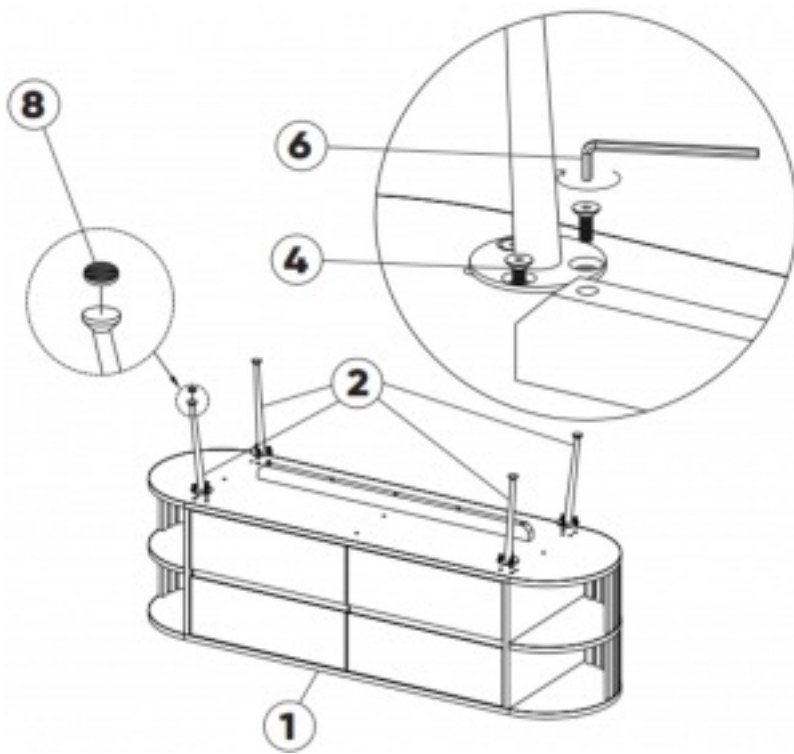

Step 2:

Attach the x8 shelf pins (5) to inside of the cabinet (1).

Note: This pack has been delivered with x4 spare shelf pins.

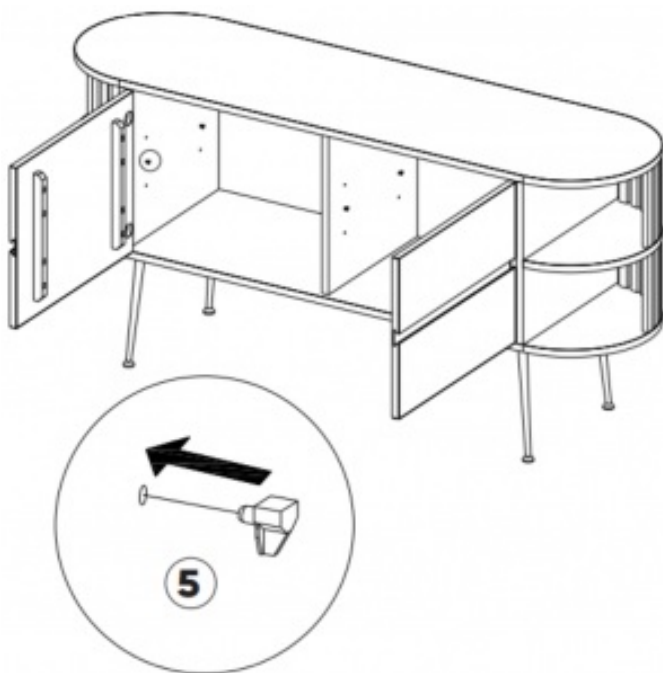

Step 3:

Place the x2 shelves (3) into the cabinet on top of the shelf pins.

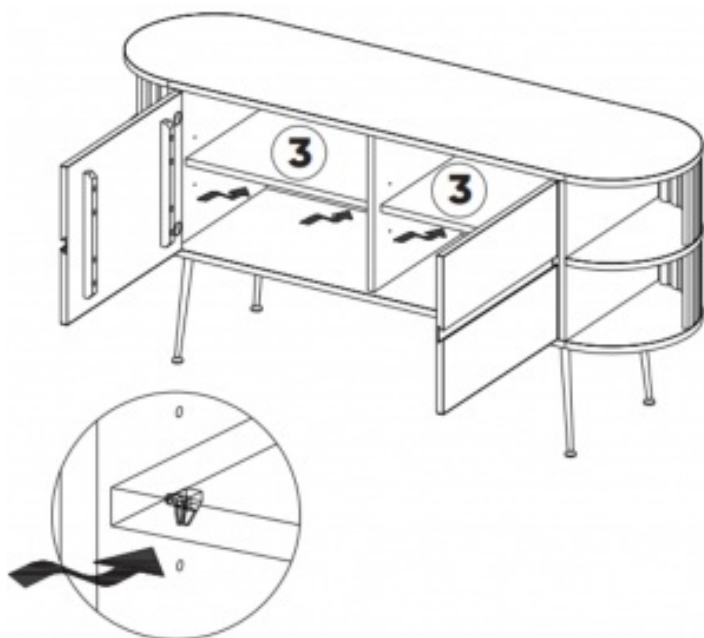

Step 4: Anti-tip kit

- Move furniture into its final position to mark the location of the brackets **(A)**.
- Move the furniture away from the wall so the brackets can be mounted.
- Attach the x2 brackets **(A)** to the marked locations on the wall using the appropriate hardware (not supplied).

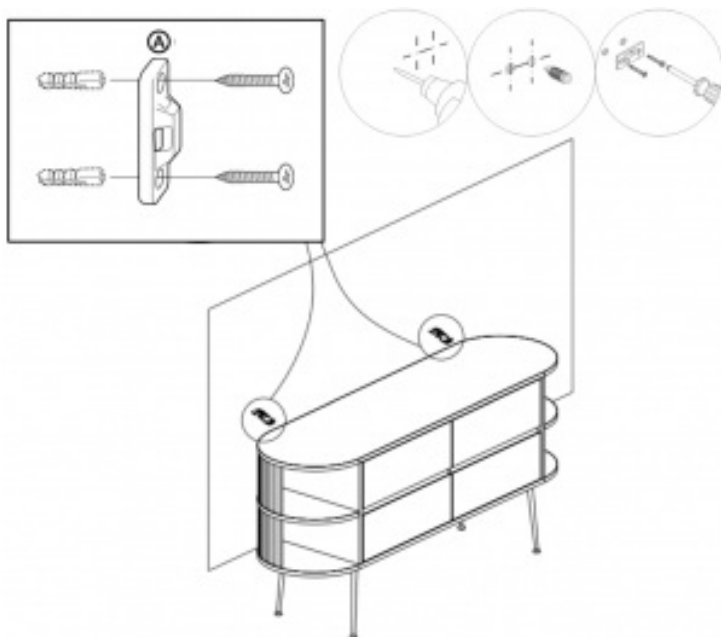

Step 5:

- Attach the x2 brackets **(A)** to rear of the furniture using the x4 screws **(B)**.
- Secure the furniture in place using the supplied cable ties **(C)**.

Note: Do not overtighten the cable ties.

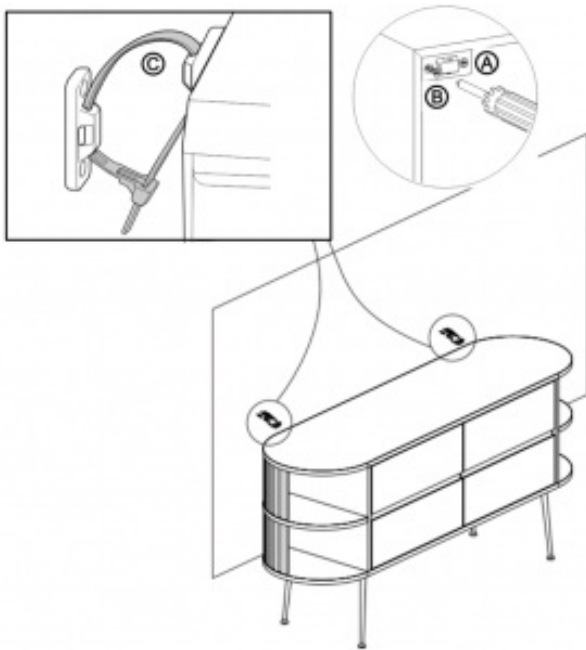

CLEANING & CARE

To ensure that you enjoy many years of life from your furniture, it is imperative the correct care and maintenance be taken. It is recommended to use furniture oil on all wooden surfaces. For best results follow the instructions stated on your chosen product. Your furniture has already been oiled from the factory. The surface should be treated every three months.

How to apply oil to the furniture

- Apply a generous amount of furniture oil using a clean cloth. The underside of the tabletops must be treated along with the top side. Take care not to drop oil on the floor.
- After 15 minutes, following the direction of the wood grain, polish using a fine sandpaper sponge or sandpaper (150 grit).
- Wipe off any remaining oil with a clean, dry cloth.
- The lacquered MDF sides of the cabinet should not be oiled. Instead, clean using a clean, dry cloth.

General care

- Clean the surface using a clean, dry cloth. Do not use detergents.
Ensure coloured stains like red wine are wiped off immediately.
- Small stains and marks can be removed using fine sandpaper (180-220 grit).
- Avoid placing in high humidity environments.
- Do not place the item close to open flames and other sources of heat.
- Legs must be re-fastened occasionally.



NOTE

NEED MORE INFORMATION?

We hope that this user guide has given you the assistance needed for a simple set-up. For the most up-to-date guide for your product, as well as any additional assistance you may require, head online to help.mattblatt.com.au.

MATT BLATT

Documents / Resources

 <p>RECAP SIDEBOARD (OAK) User Guide</p> 	<p>MATT BLATT Recap Sideboard [pdf] User Guide Recap Sideboard, MBRECAPSBOA</p>
-----------------------------------------------------------------------------------------------------------------------------------------------------------------------------------------------------------------	-----------------------------------------------------------------------------------------------------