



Mastervolt CZone MasterBus Bridge Interface Instruction Manual

[Home](#) » [MASTERVOLT](#) » Mastervolt CZone MasterBus Bridge Interface Instruction Manual 





Quick installation CZone – MasterBus Bridge Interface

Contents

- [1 CZone MasterBus Bridge Interface](#)
- [2 SPECIFICATIONS](#)
- [3 Documents / Resources](#)
 - [3.1 References](#)

CZone MasterBus Bridge Interface

1.  This Quick installation guide provides a brief overview of the CZone – MasterBus Bridge Interface installation. Refer to the CZone Configuration Tool Instructions, for information on how to setup the MasterBus Bridge Interface (MBI).
2.  Safety instructions
 - Use the MBI following the instructions and specifications stated in this document.
 - Only use the MBI in a technical correct condition.
 - Do not work on an electrical system if it is still connected to a current source.NAVICO GROUP does not hold itself liable for:
 - Damage resulting from the use of the MBI;
 - Possible errors in the included manual and the consequences of these;
 - Use that is inconsistent with the purpose of the product.
3. Check the contents of the delivery. Contact your supplier if one of the items is missing.

Do not use the MBI if it is damaged!

CZone – MasterBus Bridge Interface

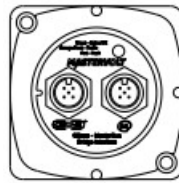

MasterBus adapter

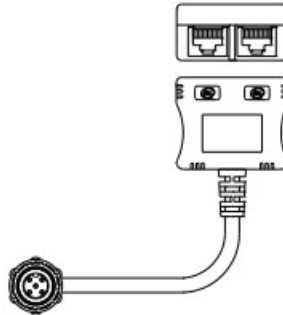

MasterBus Terminator



4. Select a location where the surface material is sturdy, and the LED can be seen.

The minimum installation height including connectors is 10cm [4"].

A. Remove the lower mounting plate from the MBI to use as a template and mark the position of the four holes to be drilled. Drill the holes (3.5mm [9/16"]).

B. Secure the two blind holes of the base with two (short 4mm) screws.

C. Mount the MBI to its bottom plate and fix with two (long 4mm) screws.

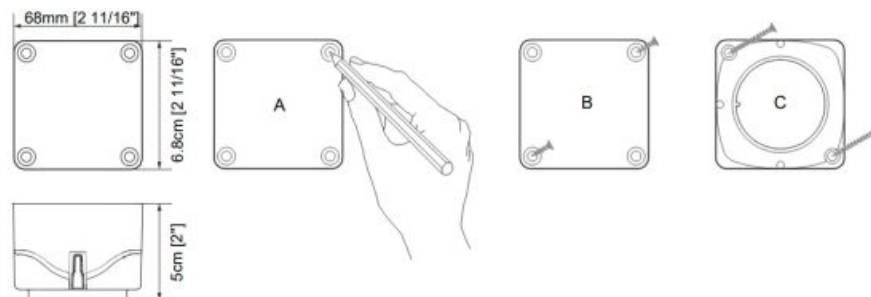

5. Secure the battery in place. Choose the option that best fits the position.

Wire the interface like indicated. The CZone connector must be plugged at the left-hand side (5), the MasterBus connector at the right (6). Notice the polarization nock (10).

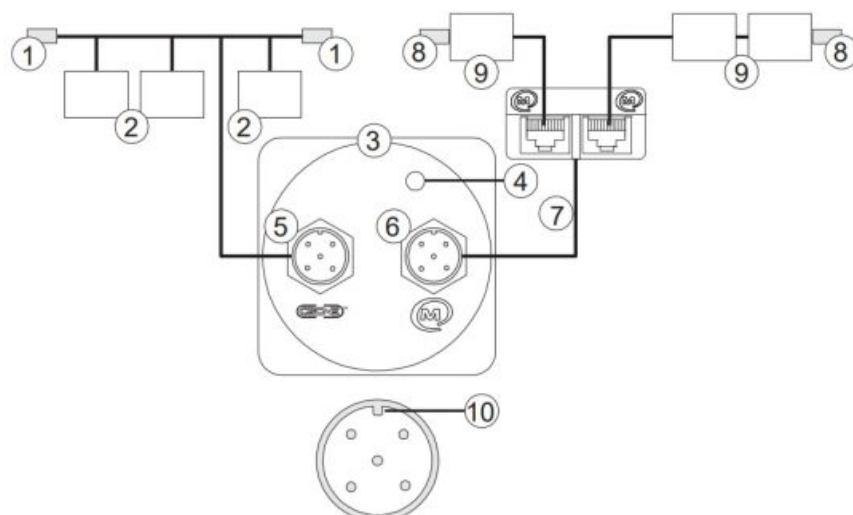

1. CZone terminator
2. CZone devices
3. Bridge Interface
4. LED
5. CZone connector *
6. MasterBus connector
7. Adapter including cable
8. MasterBus terminator
9. MasterBus devices
10. Polarization nock

* can also be used to connect to an NMEA2000 network, enabling basic data exchange.



Ensure that each end of both networks has a terminator.

6. Check if the CZone – MasterBus Bridge Interface works correctly.

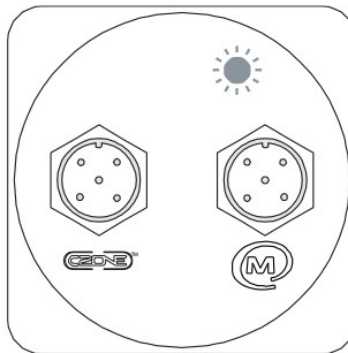

LED (4) functions:

Green: Active/OK, CZone (5) and MasterBus (6) connected.

Orange flashing: Traffic, communication.

Red: Fault, no connection.

If there is no connection, first check the cables, then the configuration of the CZone and MasterBus networks.

SPECIFICATIONS

MODEL:	CZONE MASTERBUS BRIDGE INTERFACE
Product code:	80-911-0072-00
Delivered with:	MasterBus cable adapter, MasterBus Terminator
Current consumption:	60 mA, 720 mW
MasterBus Powering:	No
Din rail mounting:	No
Protection degree:	IP65
Weight:	145g [0.3 lb], excluding cable adapter
Dimensions:	69 x 69 x 50 mm [2.7 x 2.7 x 2.0 inch]



Do not dispose of with normal household waste!
Act according to local rules.



NAVICO GROUP EMEA, P.O.Box 22947,
NL-1100 DK Amsterdam, The Netherlands.
Web: www.mastervolt.com [10000002866_01]

Documents / Resources

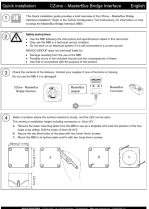
	<p>Mastervolt CZone MasterBus Bridge Interface [pdf] Instruction Manual 80-911-0072-00, CZone MasterBus Bridge Interface, CZone, MasterBus Bridge Interface, Bridge Interface, Interface</p>
---	--

References

- [User Manual](#)

Manuals+, [Privacy Policy](#)

This website is an independent publication and is neither affiliated with nor endorsed by any of the trademark owners. The "Bluetooth®" word mark and logos are registered trademarks owned by Bluetooth SIG, Inc. The "Wi-Fi®" word mark and logos are registered trademarks owned by the Wi-Fi Alliance. Any use of these marks on this website does not imply any affiliation with or endorsement.