



MASTERBUILT G2 Bottom Hopper Replacement Instructions

[Home](#) » [Masterbuilt](#) » MASTERBUILT G2 Bottom Hopper Replacement Instructions 

MASTERBUILT®



Contents

- [1 G2 Bottom Hopper Replacement](#)
- [2 Documents / Resources](#)
 - [2.1 References](#)

G2 Bottom Hopper Replacement

Bottom Hopper Replacement, 2 Piece Hopper, Gravity Series (G2)

CAUTION

- Always remove plug from outlet before servicing your grill.
- Make sure your grill has fully cooled to avoid burns.
- Some components may have sharp edges. Use caution to avoid injury.

Note: Your grill may vary from images shown



Remove the fan from the lower housing, you will reuse.

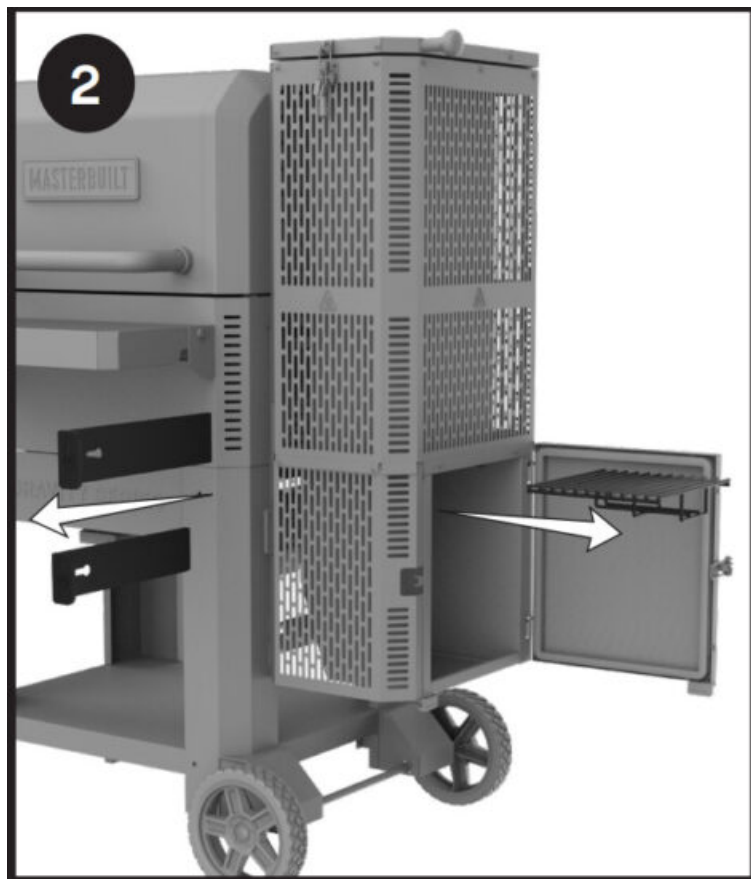

Remove the shutdown slides, charcoal grate and remove all charcoal from the hopper.

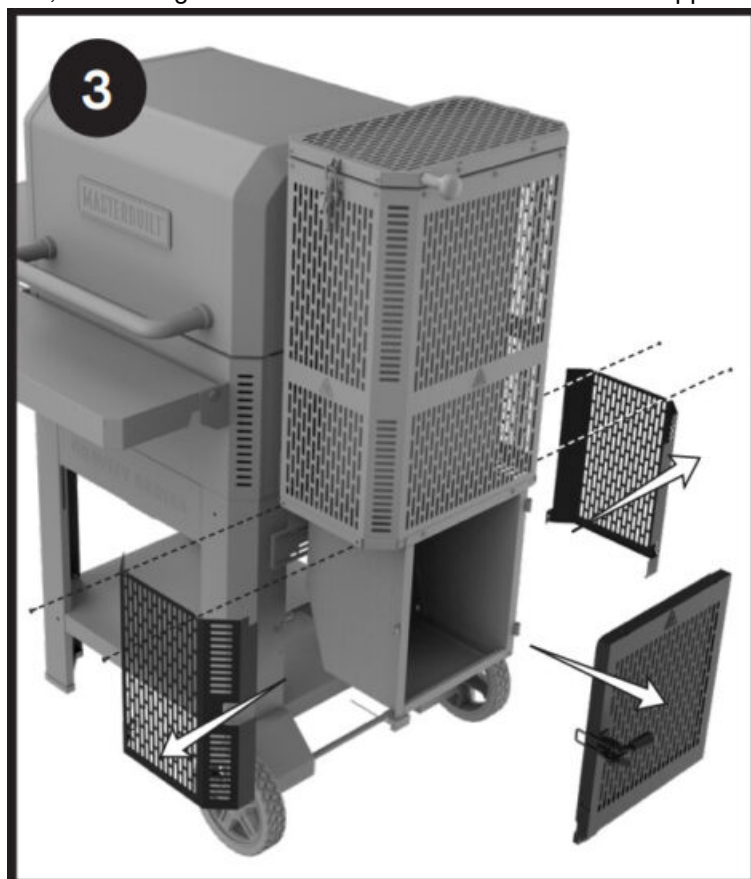

Remove the bottom hopper shroud and hopper door.

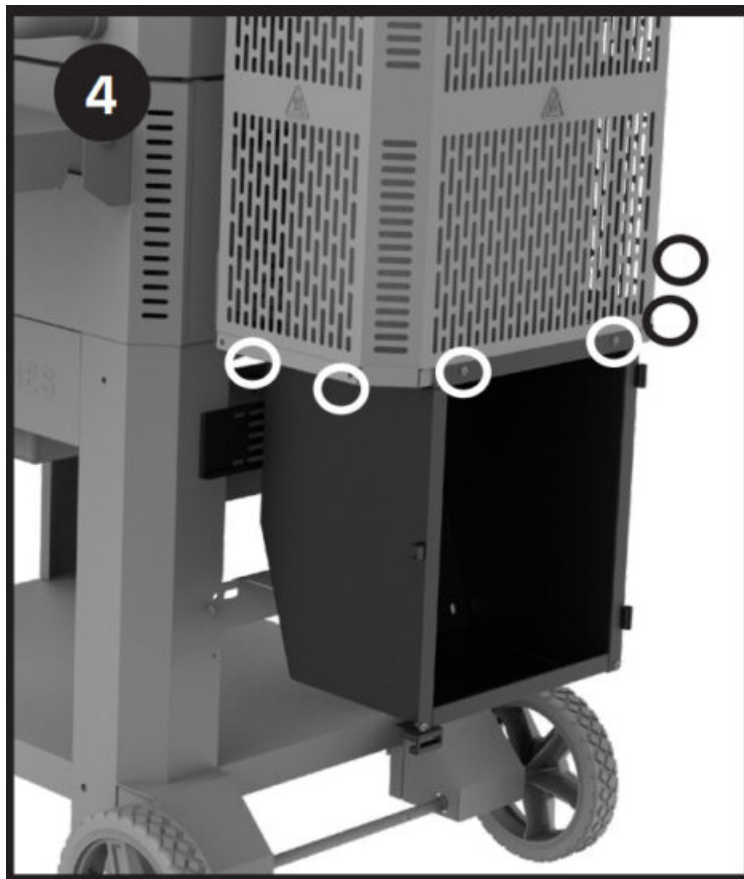

Remove the 6 screws from the bottom of the hopper plate.

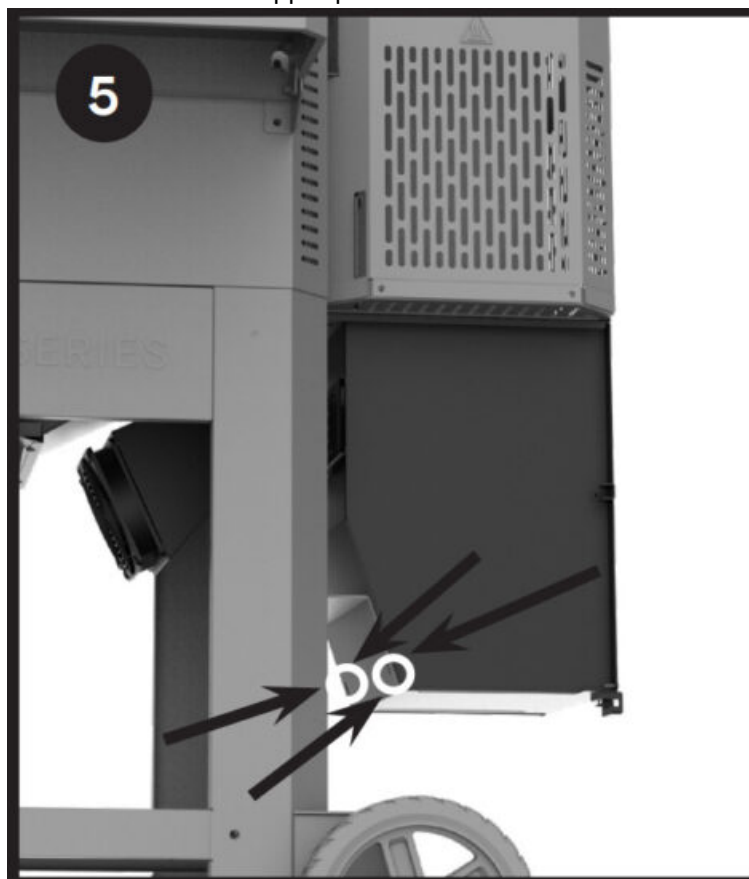

Remove the 2 screws and nuts from lower hopper mounting bracket.

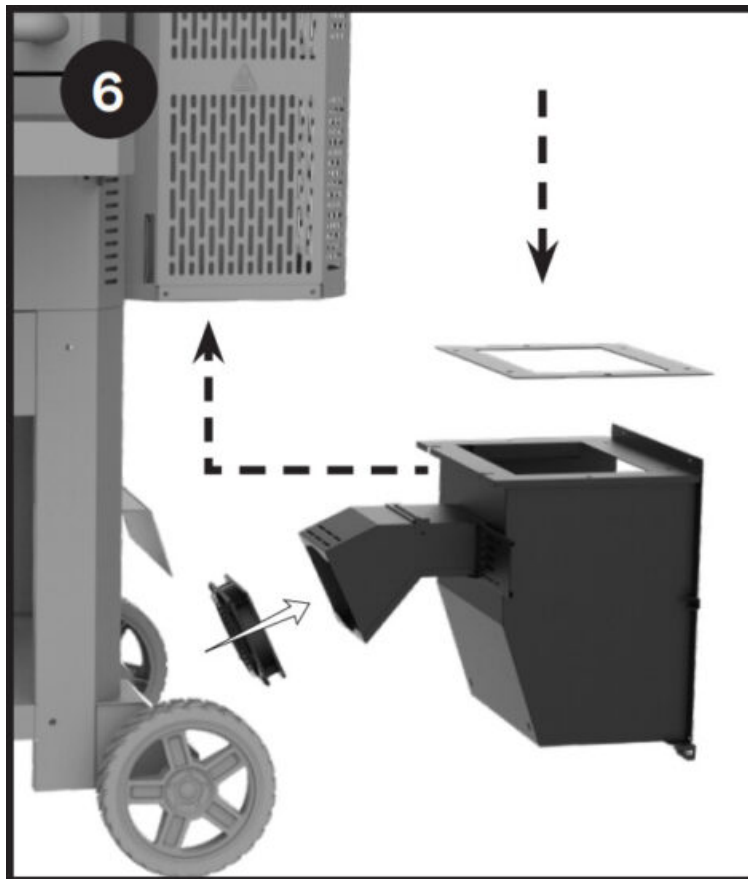

Replace hopper. Replace the gaskets Replace the fan. Reconnect wires.

MASTERBUILT®
For reinstallation, follow all steps in reverse.
601813 240116-GH

Documents / Resources

	<p>MASTERBUILT G2 Bottom Hopper Replacement [pdf] Instructions G2 Bottom Hopper Replacement, G2, Bottom Hopper Replacement, Hopper Replacement, Replacement</p>
--	---

References

- [User Manual](#)

[Manuals+.](#) [Privacy Policy](#)

This website is an independent publication and is neither affiliated with nor endorsed by any of the trademark owners. The "Bluetooth®" word mark and logos are registered trademarks owned by Bluetooth SIG, Inc. The "Wi-Fi®" word mark and logos are registered trademarks owned by the Wi-Fi Alliance. Any use of these marks on this website does not imply any affiliation with or endorsement.