



MARVO Sunspot S1 961 Lightweight Honeycomb Shell Mouse User Manual

[Home](#) » [MARVO](#) » MARVO Sunspot S1 961 Lightweight Honeycomb Shell Mouse User Manual 



MARVO

Sunspot S1 961 Lightweight Honeycomb Shell Mouse

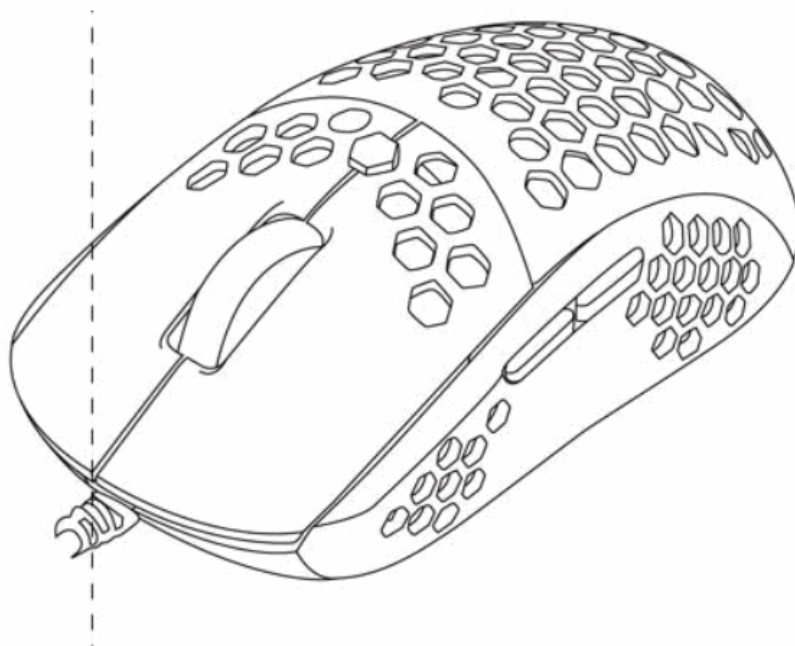

User Manual

Contents

- [1 Product Presentation](#)
- [2 Technical Specifications](#)
- [3 System Requirements](#)
- [4 Installation](#)
- [5 Use](#)
- [6 Mouse Driver Use](#)
- [7 DPI Setting](#)
- [8 Light Setting](#)
- [9 Macro Setting](#)
- [10 Troubleshooting](#)
- [11 Warranty Conditions](#)
- [12 EU Declaration of Conformity](#)
- [13 WEEE](#)
- [14 Documents / Resources](#)
 - [14.1 References](#)
- [15 Related Posts](#)

Product Presentation

Features

- Anti-slip textured side grips
- RGB backlight with multiple selectable lighting schemes
- Advanced customization software

Technical Specifications

Sensor	Optical, PAW3327DB+BY8801
DPI	400-800-1600-2400-32007000-9000-12000 (default)
Buttons	6 (programmable)
Switch rating	20 million clicks
Backlight	RGB
Polling rate	Up to 1000 Hz
Interface	USB 2.0
Cable length	1.6 m
Weight	75 g
Size	125 x 64 x 43 mm
OS support	Windows 7 or newer

System Requirements

PC system or compatible with one USB port available, Windows 7 or newer operating system.



12000 DPI

OPTICAL / LASER SENSOR



DPI STEPS

400-800-1600-2400-
3200-7000-9000-12000



20 MILLION

SWITCH RATING



ERGONOMICS

ADJUSTABLE



DRIVER

PROGRAMMABLE



6 BUTTONS

DESIGN

- 1200 DPI Optical / Laser Sensor
- DPI Steps 400-800-1600-2400-3200-7000-9000-12000
- 20 million Switch-rating
- Ergonomics Adjustable
- Driver Programmable
- 6 Buttons Design

Safety Notes

- Keep the equipment dry. Keep away from precipitation, humidity, all types of liquids and condensation.
- Do not use the product with wet hands.
- Do not use or store the equipment in dusty or dirty areas.
- Do not store the equipment under high-temperature or low-temperature conditions (this may damage it).
- Do not drop, knock, or shake the equipment as it may damage it.

Installation

Connect the mouse to an available USB port on your computer. When connecting for the first time, wait 15 seconds until the generic driver is installed.

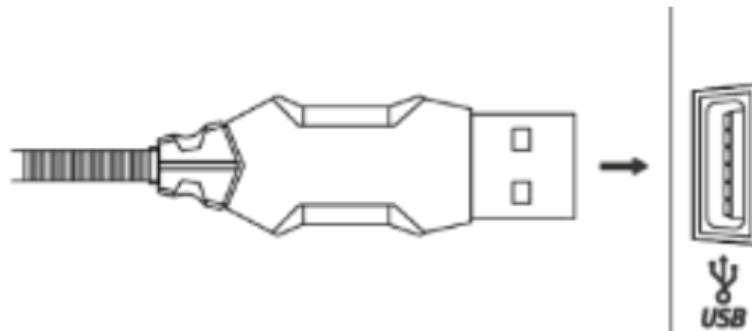

For advanced mouse configuration, please download and install the specialized driver at www.marvopro.com (an Internet connection is required):

- download the driver and double-click the executable file
- follow the on-screen instructions and install the application
- after installing the application successfully, an icon will be displayed in the taskbar
- double-click this icon to launch the application

Use

Press the DPI button below the scroll wheel to change the sensitivity according to predefined DPI steps.

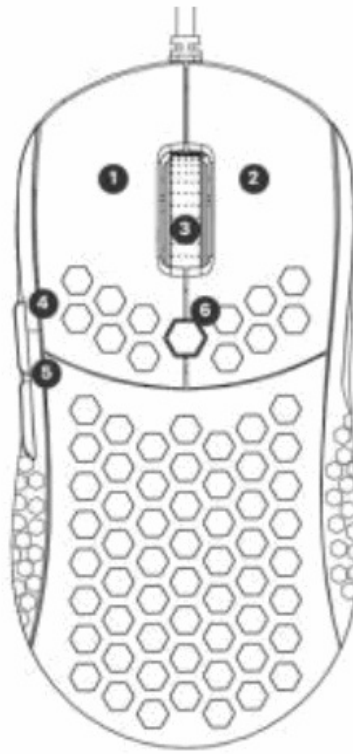

1. Left click
2. Right click
3. Middle click
4. Forward
5. Backward
6. DPI switch

Mouse Driver Use

Key Settings

1 for Left Click, 2 for Right click, 3 for Middle Click, 4 for forward, 5 for back, 6 for DPI loop, is kept as default.

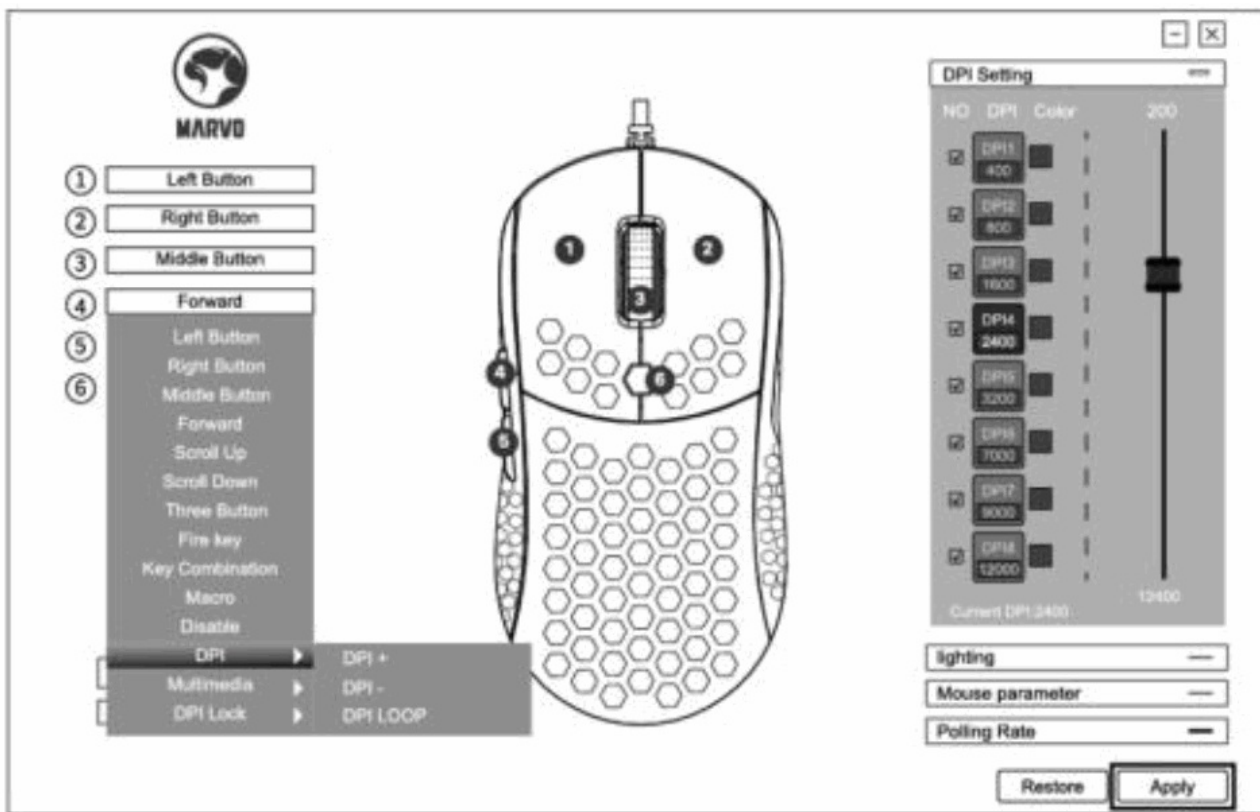

DPI Setting

Select "Mouse Parameter" tab and set Mouse Sensitivity/Scrolling Speed/Double-click speed functions as following graph. Click "Apply" to save the setting.

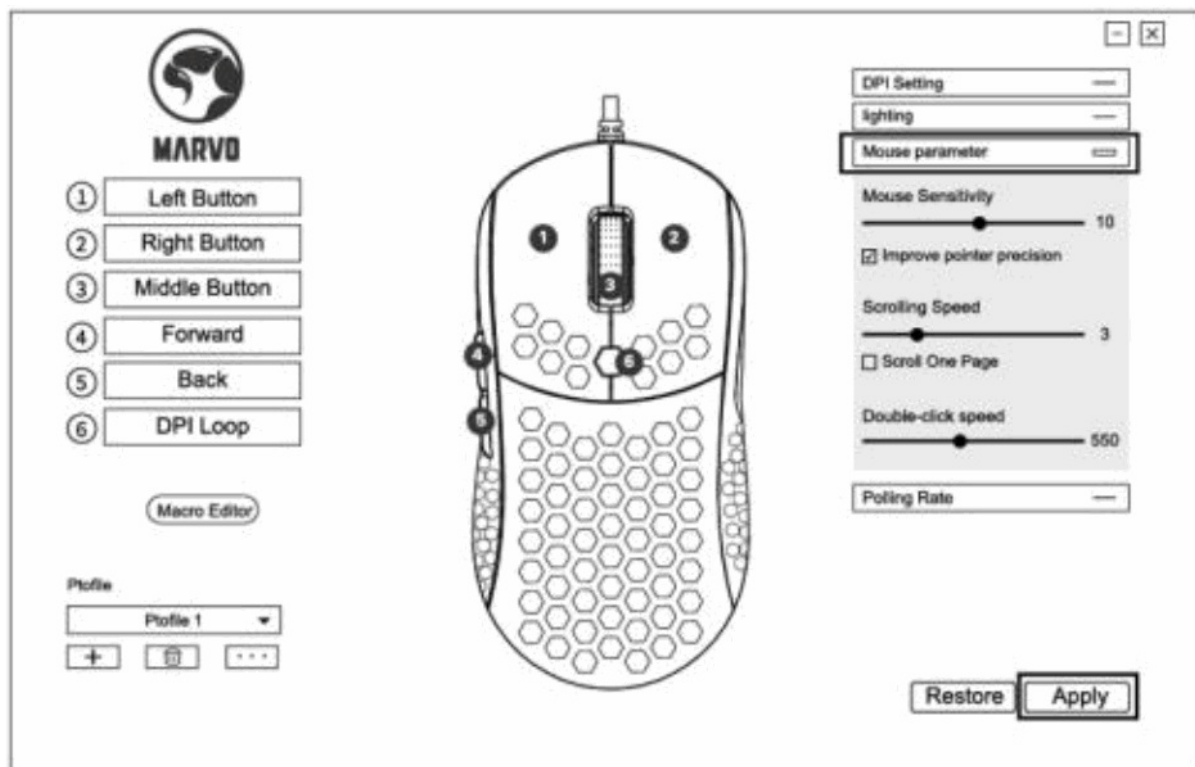

The default DPI: 400-800-1600-2400-3200-7000-9000-12000, you can set the DPI from 400-12000. Click "Apply" to save the setting.

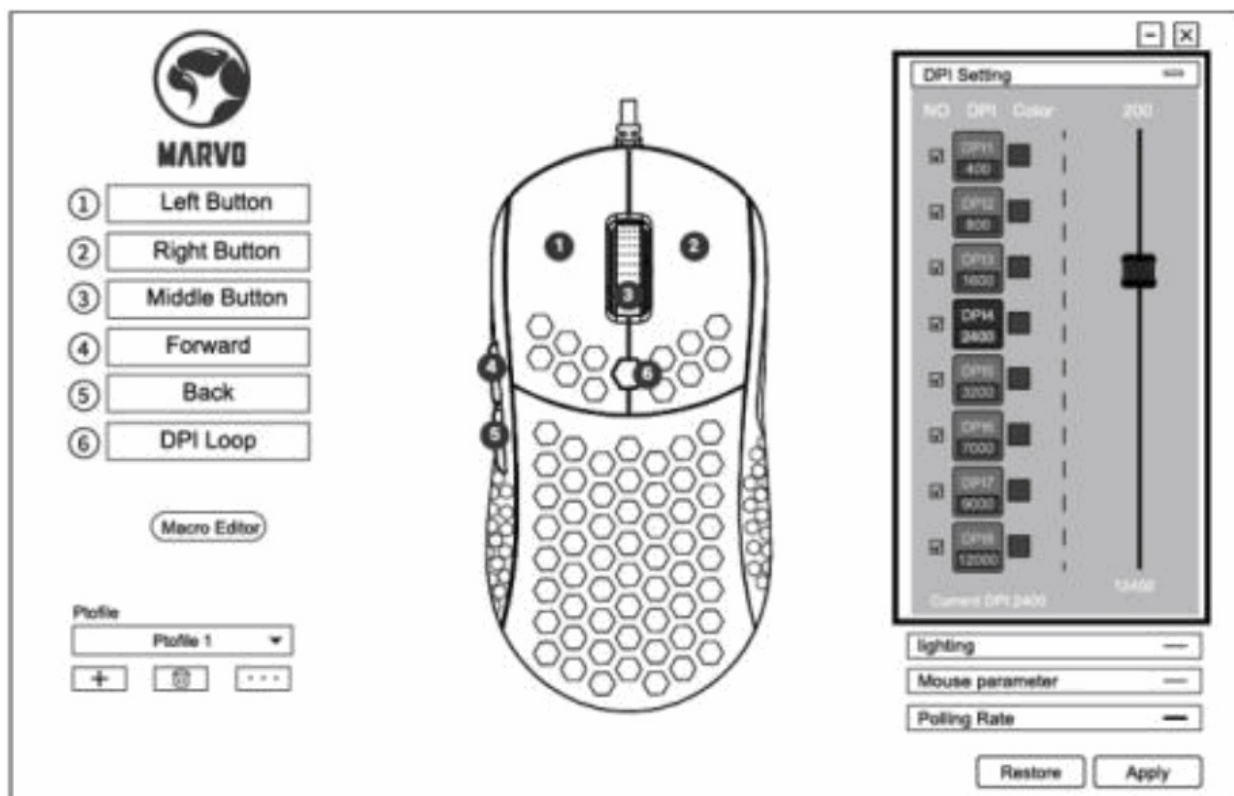

Light Setting

Select "Lighting" tab and set Lighting Effect/Speed/Direction as following graph.
Click "Apply" to save the setting.

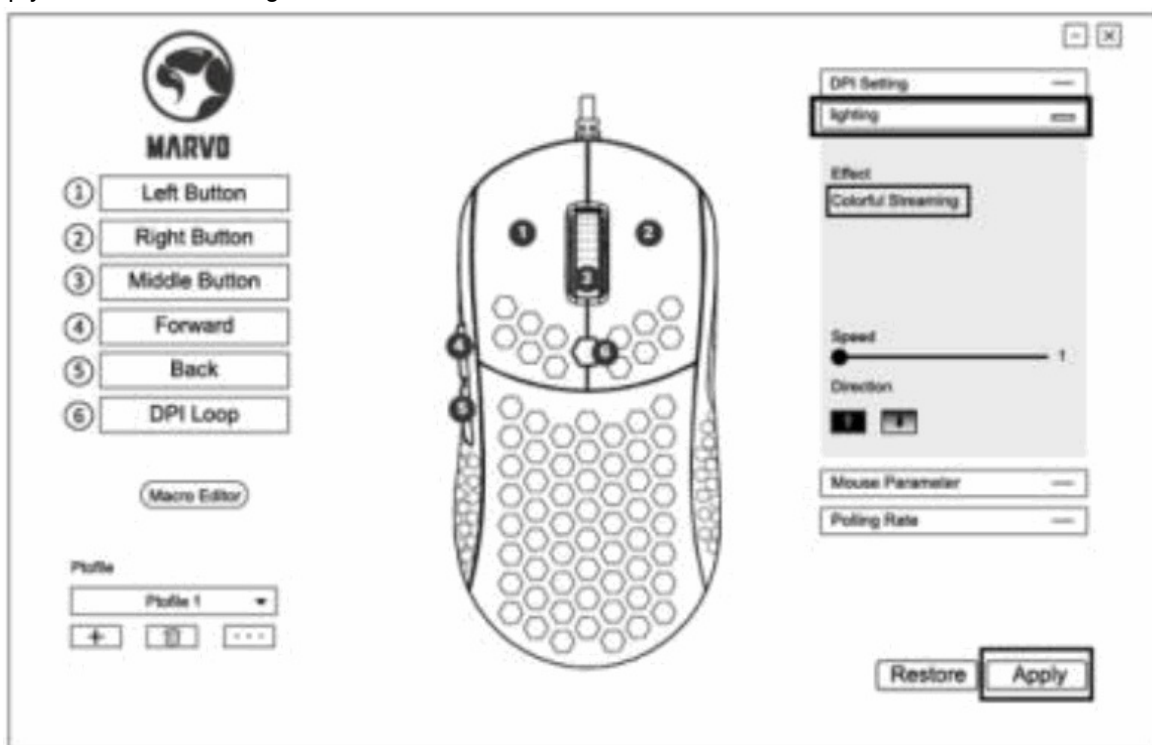

Macro Setting

Macro management can record any keys of keyboard, the time of keys reaction and the number of keys cycles.
Right Click and click "New Macro" to create a new file, such as a, b, c.



Click "Recording" and start recording and keys of keyboard.

The keys you recorded will display in the macro edit box.

After the recording, click "Recording" again to finish.

After recording is completed, just exit the macro recording interface, no need to click the confirmation keys.

Execute a macro, such as the mouse button "4" key set to "macro functions", after recording is complete, press the mouse "4" key to play the recorded content.

Troubleshooting

In case of incorrect operation follow the steps below:

- Check the integrity of the connectors.
- Check the connection to the computer.
- Check your computer settings.
- Disconnect and reconnect the equipment; restart the computer.

If the problem persists, please contact your local seller.

Warranty Conditions

A new product purchased in the Alza.cz sales network is guaranteed for 2 years. If you need repair or other services during the warranty period, contact the product seller directly, you must provide the original proof of purchase with the date of purchase.

The following are considered to be a conflict with the warranty conditions, for which the claimed claim may not be recognized:

- Using the product for any purpose other than that for which the product is intended or failing to follow the instructions for maintenance, operation, and service of the product.
- Damage to the product by a natural disaster, the intervention of an unauthorized person or mechanically through the fault of the buyer (e.g., during transport, cleaning by inappropriate means, etc.).
- Natural wear and aging of consumables or components during use (such as batteries, etc.).

- Exposure to adverse external influences, such as sunlight and other radiation or electromagnetic fields, fluid intrusion, object intrusion, mains overvoltage, electrostatic discharge voltage (including lightning), faulty supply or input voltage and inappropriate polarity of this voltage, chemical processes such as used power supplies, etc.
- If anyone has made modifications, modifications, alterations to the design or adaptation to change or extend the functions of the product compared to the purchased design or use of non-original components.

EU Declaration of Conformity



This product complies with the essential requirements of Directives 2014/30/EU and 2011/65/EU including amendments 2015/863/EU.

WEEE



This product must not be disposed of as normal household waste in accordance with the EU Directive on Waste Electrical and Electronic Equipment (WEEE – 2012/19 / EU). Instead, it shall be returned to the place of purchase or handed over to a public collection point for the recyclable waste. By ensuring this product is disposed of correctly, you will help prevent potential negative consequences for the environment and human health, which could otherwise be caused by inappropriate waste handling of this product. Contact your local authority or the nearest collection point for further details. Improper disposal of this type of waste may result in fines in accordance with national regulations.

Dear customer,

Thank you for purchasing our product. Please read the following instructions carefully before first use and keep this user manual for future reference. Pay particular attention to the safety instructions. If you have any questions or comments about the device, please contact the customer line.

✉ www.alza.co.uk/kontakt







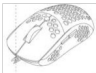

☎ +44 (0)203 514 4411

Importer Alza.cz a.s., Jankovcova 1522/53, Holešovice, 170 00 Prague 7, www.alza.cz

Documents / Resources

  <p>Sunspot S1 961</p> <p>User Manual • Uživatelský manuál • Uživatelský manuál • Handleiding • Benutzerhandbuch • Manuel d'utilisation</p>	<p>MARVO Sunspot S1 961 Lightweight Honeycomb Shell Mouse [pdf] User Manual Sunspot S1 961 Lightweight Honeycomb Shell Mouse, Sunspot S1 961, Lightweight Honeycomb b Shell Mouse, Honeycomb Shell Mouse, Shell Mouse</p>
--	--

References

-  alza.at
-  alza.co.uk
-  alza.de
-  alza.fr
-  alza.hu
-  alza.sk
-  [Best Gaming Mechanical Keyboards Membrane, Mice, Headsets](#)
-  [Best Gaming Mechanical Keyboards Membrane, Mice, Headsets](#)

Manuals+.