



marta MT-1569 Countertop Blender User Manual

[Home](#) » [MARTA](#) » marta MT-1569 Countertop Blender User Manual 

marta

COUNTERTOP BLENDER
MT-1569
User manual
GBR User manual 5

Contents

- [1 MT-1569 Countertop Blender](#)
- [2 BEFORE THE FIRST USE](#)
- [3 INSTRUCTION FOR USE](#)
- [4 CLEANING AND MAINTENANCE](#)
- [5 STORAGE](#)
- [6 SPECIFICATION](#)
- [7 Documents / Resources](#)
- [8 Related Posts](#)

MT-1569 Countertop Blender



Description

1. Lid
2. Jar
3. Sealing ring
4. Blade unit
5. Motor unit
6. Control panel
7. Mill container
8. Mill blade unit

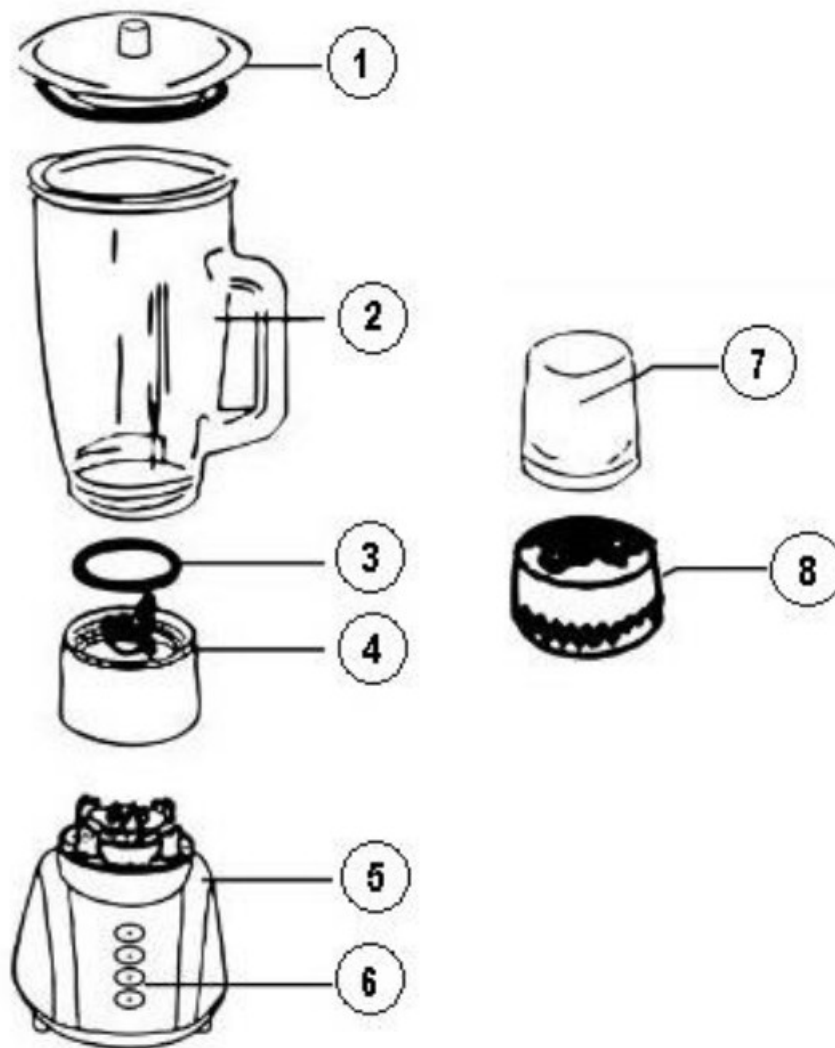

GBR Real set of the appliance could be different from listed in the User manual. Check once buy.

GBR USER MANUAL

CAUTION

- Read this manual carefully before using the appliance and save it for future reference.
- Before the first use, check the device specifications and the power supply in your network.
- It is not intended for industrial use.
- For indoor use only. Use only for domestic purposes according to the instruction manual.
- Keep the power cord away from sharp edges and hot surfaces.
- Do not pull the cord. Always take the socket. Do not reel the cord around the device housing.
- Never attempt to frame and repair the appliance by yourself. If you meet problems, please contact the nearest customer service center.
- Using accessories or replacement parts that are not recommended or sold by the manufacturer may cause damage to the appliance.
- Always unplug the appliance and let it cool down before cleaning and removing parts. Keep unplugged when not in use.
- To avoid electric shock and fire, do not immerse in water or other liquids. If this occurs, immediately unplug it and contact service center for inspection.
- This appliance is not intended for use by persons (including children) with reduced physical, sensory or mental capabilities, or lack of experience and knowledge, unless they have been given supervision or instruction concerning use of the appliance by a person responsible for their safety.

- Be cautious when using blade.
- Every time after use, make sure the appliance is turned off, the blades stopped completely. Only then open the lid.
- Do not overload the appliance. The appliance is designed for processing relatively small quantities of food and maximum quantities given in the table should not be exceeded.
- Never blend hot liquids!
- Maximum time of continuous operation – no more than 1 minute with an interval for at least 5 minutes.
- Do not use the device if the cord is damaged.
- Do not use the device if the cup is empty.
- Do not leave the device unattended.
- Always disconnect the device from power supply if you do not use it and before cleaning.

BEFORE THE FIRST USE

- Please unpack your appliance and remove all packing materials
- Clean the motor unit with damp cloth, wash blades and jar with soapy water, rinse and dry.
- Do not immerse motor unit into water.

INSTRUCTION FOR USE

CHOPPING

- Place the device on a flat steady surface.
 - Place the blade unit (4) on the drive spindle (5), position sealing ring (3) and put the jar (2) on, screwing it clockwise until fixed.
 - Load the ingredients into the jar. Caution: blender cannot be used for crushing ice and very hot ingredients with temperature more than 60C°. This can cause damage of the device.
 - Place the lid (1) on top of the the jar and tighten it turning clockwise.
 - Insert the plug into power supply.
 - Put the ingredients in the jar. Cut big pieces into smaller ones with size of 2-3 cm. Add liquid.
 - For using dry mill, turn it's container (7) upside down and remove mill blade unit (8). Put ingredients into container and attach the blade unit (8). Install the assembled mill onto blender's motor unit (5).
 - Speed modes: 1, 2 or pulse mode * . To stop the blender press 0.
 - Start with lower speed and then increase it.* Use pulse mode for short times if necessary.
 - Do not put more than 0.8l of hot liquids or foamy ingredients. Never exceed max level of the jar!
 - If ingredients are not mixed well or stuck, stop the blender and mix the ingredients with silicone spatula. It is recommended to mix sticky ingredients from time to time with the spatula.
- Caution:** never put any items in the blender jar when blade is working!
- Before opening lid wait until blade fully stops. Before removing jar from the motor unit unplug the device from the power source.

CAUTION: For most kinds of food, it is advisable to switch on the device a few times in succession and then to continue operating until the required degree of fineness has been achieved. Do not overload the appliance by putting in too much food and do not operate continuously for more than one minute. In pulse mode work time should not exceed 20 secs.

CLEANING AND MAINTENANCE

- Unplug the appliance from the power supply.
- Wipe the motor outside with a damp cloth.
- Wash jar, blades and lid right after use with warm soapy water and wipe it with dry cloth.
- Do not use aggressive and abrasive agents for cleaning

CAUTION: The blades are sharp and therefore dangerous. Handle with caution.

STORAGE

- Before storing, dry thoroughly the container, container lid, cutting blade.
- Store the appliance in a cool, dry place.

SPECIFICATION

Model	Power supply	Net weight / Gross weight	Package size (L x W x H)
MT-1569	230 V ~ 50 Hz	2.5 kg / 2.65 kg	200 mm x 170 mm x 390 mm

WARRANTY DOES NOT COVER SUPPLIES (filters, ceramic and non-stick coating, rubber seals, etc.)

Production date is available in the serial number located on the identification sticker on the gift box and/or on sticker on the device. The serial number consists of 13 characters, the 4th and 5th characters indicate the month, the 6th and 7th indicate the year of device production.

Producer may change the complete set, appearance, country of manufacture, warranty and technical characteristics of the model without notice. Please check when purchasing device.

Current information about service centers is available on the website <http://multimarta.com>

Producer:
Cosmos Far View International Limited
Room 701, 16 apt, Lane 165, Rainbow North Street , Ningbo, China
Made in China

Documents / Resources

	marta MT-1569 Countertop Blender [pdf] User Manual MT-1569 Countertop Blender, MT-1569, Countertop Blender, Blender
---	--