

Marset Fragile LED Table Lamp



# Marset Fragile LED Table Lamp Instruction Manual

[Home](#) » [marset](#) » Marset Fragile LED Table Lamp Instruction Manual 

## Contents

- [1 Marset Fragile LED Table Lamp](#)
- [2 Product Information](#)
- [3 Product Usage Instructions](#)
- [4 Assembly Instructions](#)
- [5 Technical Data](#)
- [6 Documents / Resources](#)
  - [6.1 References](#)

# marset

## Marset Fragile LED Table Lamp



## Product Information

## Specifications

- Light fitting for indoor use only
- Power Factor: 1
- Bulb to be used: Fragile LED SMD 2.1W (included)
- Dimmer: 230 V – 50 Hz

## Product Usage Instructions

### Assembly Instructions

1. Unscrew the screws (A). Join the tube (B) and the base (C), tightening the screws of the plate (A) located at the bottom of the lamp. NOTE: Pass the electric cable of the tube (A) through the groove located in the part (A), before screwing the assembly, as shown in figure 1.1.
2. Position the base by placing the plugs at the bottom.
3. Slip the sphere through the tube until it reaches the base of the body.
4. Attach the shade to the lamp body using the magnetized part located at the top.
5. When moving the lamp, hold it with two hands, one by the tube and one by the base, as shown in the figure.

**Note:** It is possible that after mounting the glass, it becomes uneven due to the artisan process of its elaboration. Move the shade to adjust it.

### Dimmer Instructions

To turn the lamp on or off or to adjust it, press the pushbutton.

### FAQs

**Q:** Can I use a different bulb with this lamp?

**A:** The recommended bulb for use with this lamp is Fragile LED SMD 2.1W. Using a different bulb may affect performance and safety.

**Q:** Is this lamp suitable for outdoor use?

**A:** No, this lamp is designed for indoor use only. Using it outdoors may damage the product and pose safety risks.

### WARNING

1. It is recommended that a professional electrician be responsible for installing the light.
2. Disconnect power supply before installation.
3. If the wire or flexible cord is damaged, it must only be changed by the manufacturer, their Service Dept. or qualified personnel in order to avoid risk.
4. The light source contained in this luminaire shall only be replaced by the manufacturer or his service agent or a similar qualified person.
5. To clean the luminaire use a soft damp cloth with soap or neutral detergent. Do not use alcohol or other solvents.
6. The light source and control gear contained in this luminaire shall only be replaced by a qualified person.

## Assembly Instructions

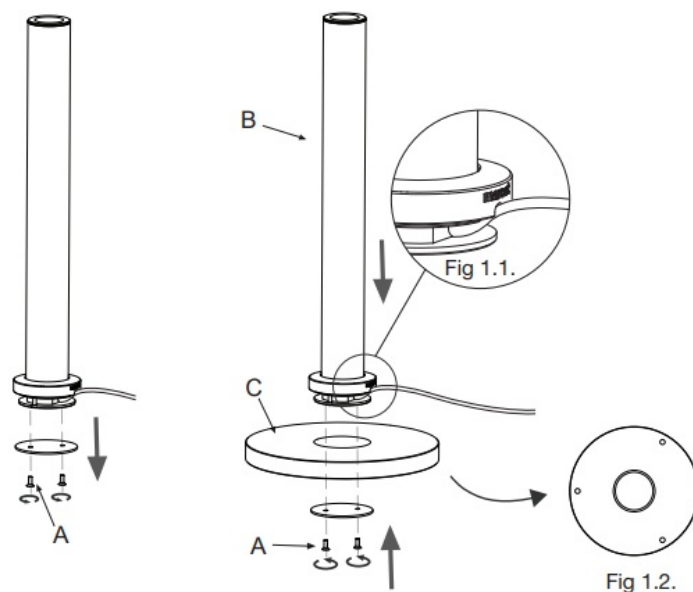

1. Unscrew the screws (A). Join the tube (B) and the base (C), tightening the screws of the plate (A) located at the bottom of the lamp.

**NOTE:** Pass the electric cable of the tube (A) through the groove located in the part (A), before screwing the assembly, as shown in figure 1.1.

1. Position the base by placing the plugs at the bottom.
2. Slip the sphere through the tube until it reaches the base of the body.

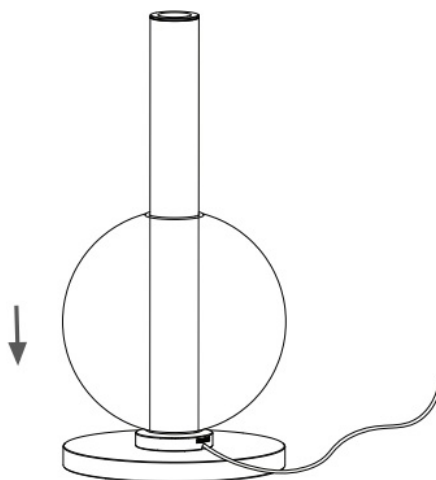

3. Attach the shade to the lamp body using the magnetized part located at the top.

It is possible that after mounting the glass, it becomes uneven due to the artisan process of its elaboration.

1. Move the shade to adjust it.

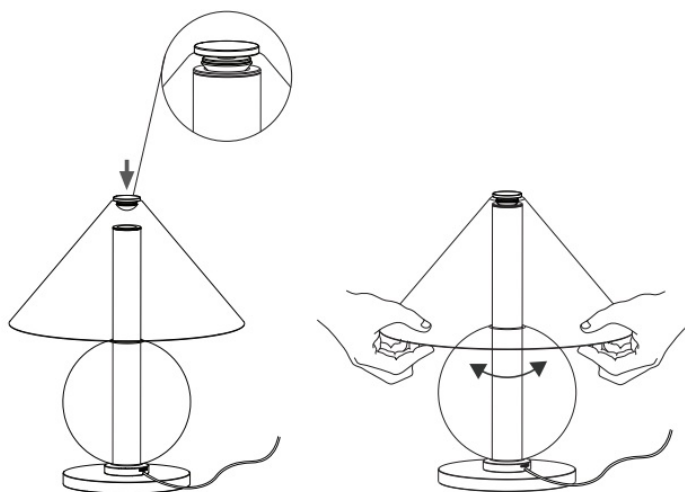

4. When moving the lamp, hold it with two hands, one by the tube and one by the base, as shown in the figure.

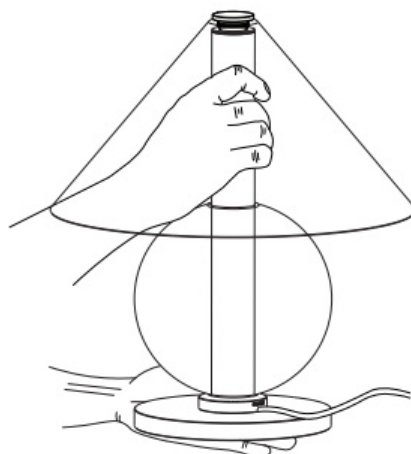

5. To turn the lamp on or off or to adjust it, press the pushbutton.

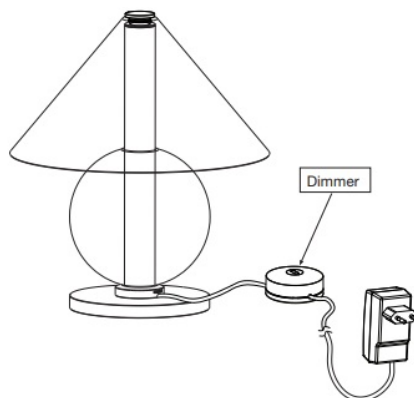

## Technical Data

Light fitting for indoor use only

- Power Factor: 1
- Bulb to be used: Fragile  
LED SMD 2,1W (included)



Basic insulation plus second insulation or both replaced by reinforced insulation. Earthing: excluded.



This symbol on the product or its packaging indicates that it must not be treated as household waste.

It should, in fact, be handed in at a recognised collection point for recycling electrical and electronic equipment. For more detailed information about the recycling of this product, please contact your locality office, your household waste disposal service or the shop where you purchased the product.

Operated progressive in-line dimmer.

This product contains a light source of energy efficiency class F



**marset**

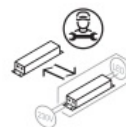

MARSET ILUMINACIÓN SA • CTRA. DE RUBÍ 284 • 08228 TERRASSA (BARCELONA) • SPAIN •  
[WWW.MARSET.CON](http://WWW.MARSET.CON)

## Documents / Resources

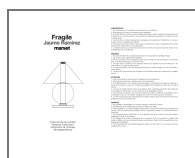

[Marset Fragile LED Table Lamp](#) [pdf] Instruction Manual  
Fragile LED Table Lamp, Fragile, LED Table Lamp, Table Lamp, Lamp

## References

- [marset Marset Lighting - Taking Care of Light](#)
- [User Manual](#)

[Manuals+](#), [Privacy Policy](#)

This website is an independent publication and is neither affiliated with nor endorsed by any of the trademark owners. The "Bluetooth®" word mark and logos are registered trademarks owned by Bluetooth SIG, Inc. The "Wi-Fi®" word mark and logos are registered trademarks owned by the Wi-Fi Alliance. Any use of these marks on this website does not imply any affiliation with or endorsement.