

[Home](#) » [MARS GAMING](#) » **MARS GAMING MC-INFINIO-MANUAL Computer Case Tower White**
User Manual 

MARS GAMING MC-INFINIO-MANUAL Computer Case Tower White

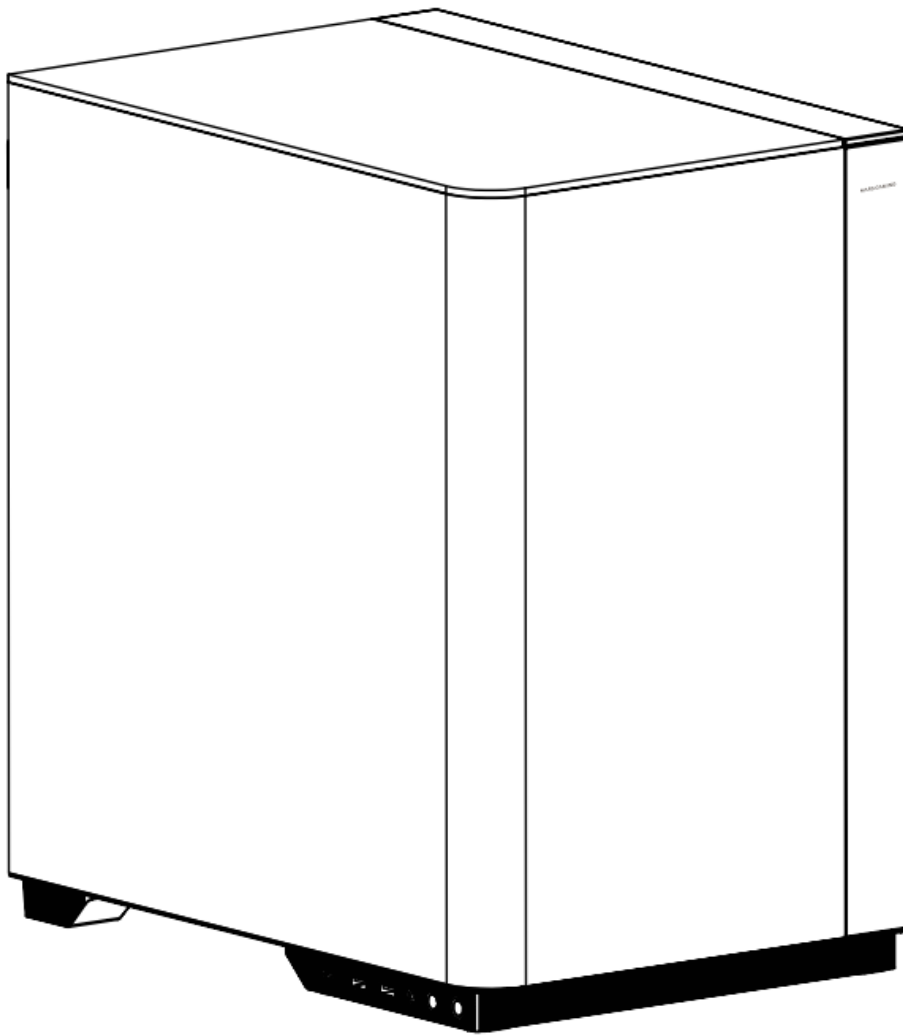

Contents [[hide](#)]

- 1 I/O Panel
- 2 Accessories
- 3 Installation (Please Refer To The Installation Drawings)
- 4 Control HUB
- 5 Remote Control
- 6 Lighting
- 7 Safety Reminders
- 8 Troubleshooting
- 9 Warranty
- 10 Compliance
- 11 Disposal And Recycling
- 12 Contact
- 13 Customer Support
- 14 Documents / Resources
- 14.1 References

I/O Panel

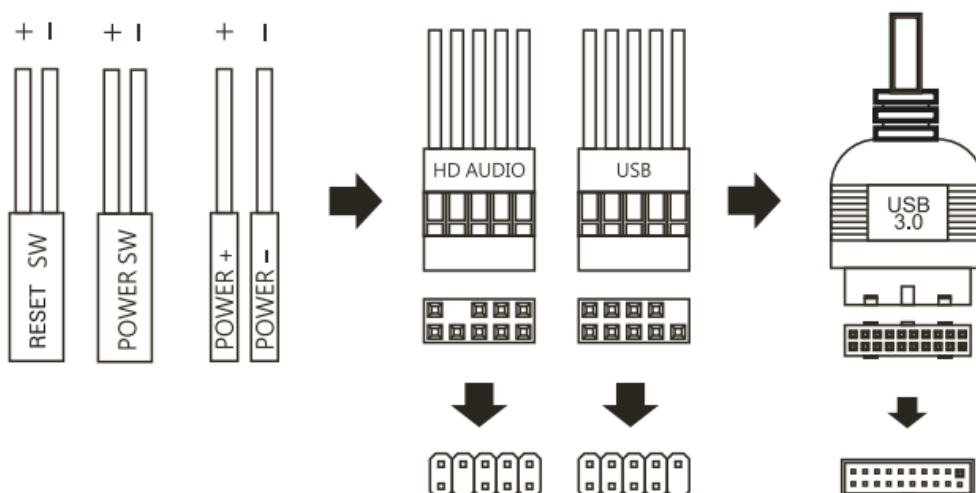
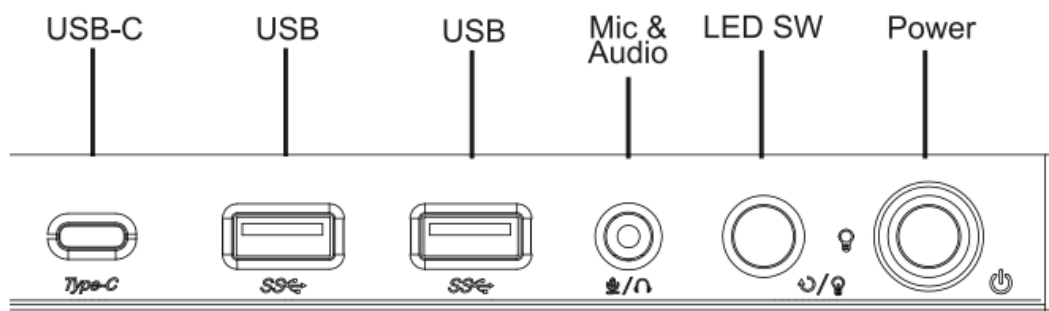

Accessories

- MB Standoff



- HOD Screw



- SSD Screw MB Screw



- PSU Screw PCI Screw



Installation (Please Refer To The Installation Drawings)

1. **Panels:** Unscrew the side panel fixing screws. Unscrew the screws Ma” shown in the drawing to remove the top and front panels.

PANELS INSTALLATION

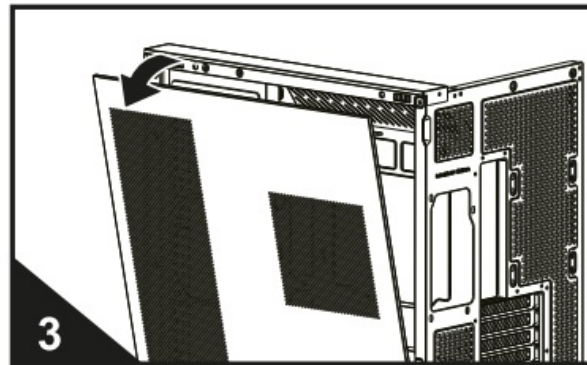
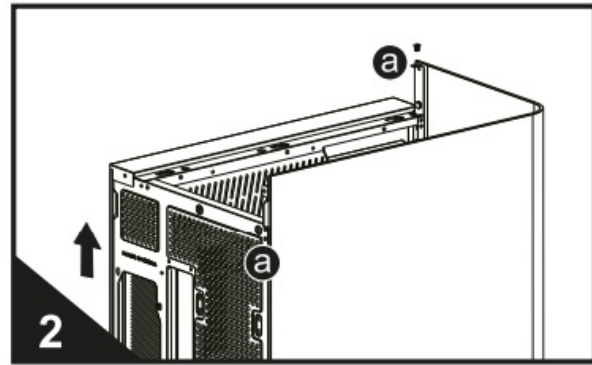
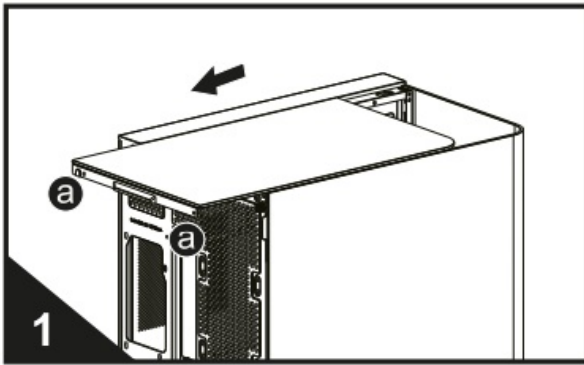

2. **Power supply installation:** Install the power supply and screw the 4 screws in the position indicated “a”.

POWER SUPPLY INSTALLATION

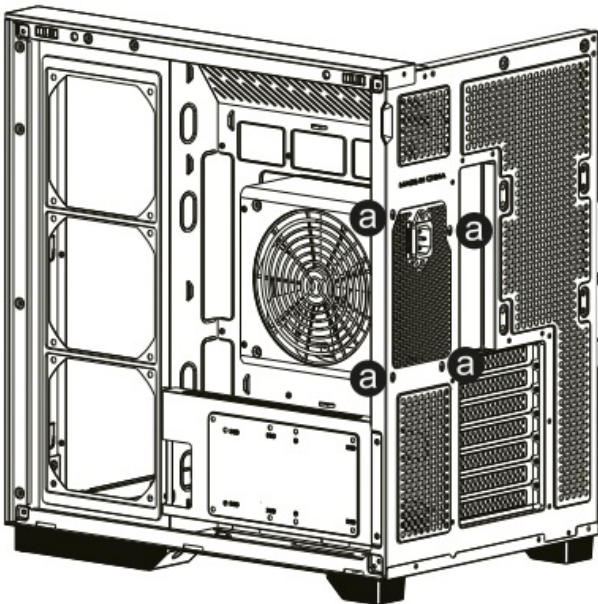

3. **Motherboard installation:** Install an ATX/MicroATX/Mini ITX motherboard and screw the screws in the position corresponding to your motherboard.

MOTHERBOARD INSTALLATION

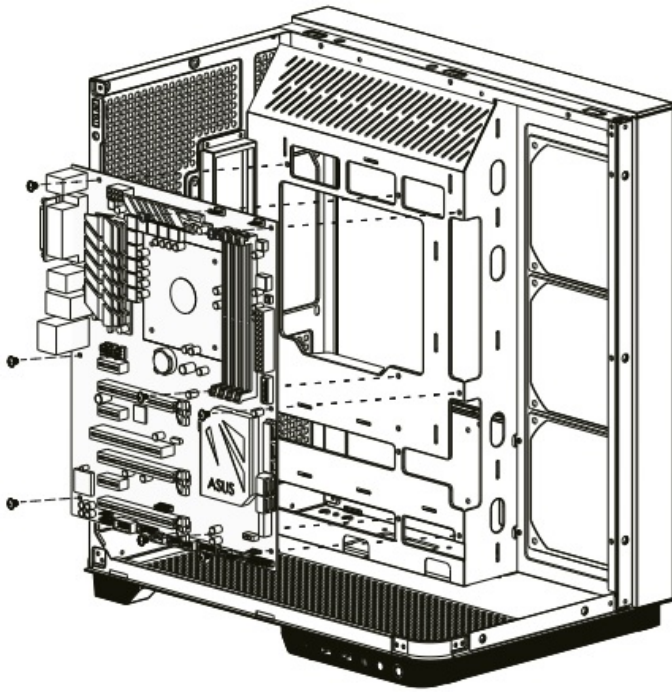

4. Graphic card installation

1. **Horizontal installation:** Remove the corresponding PCI covers and install the graphic card.

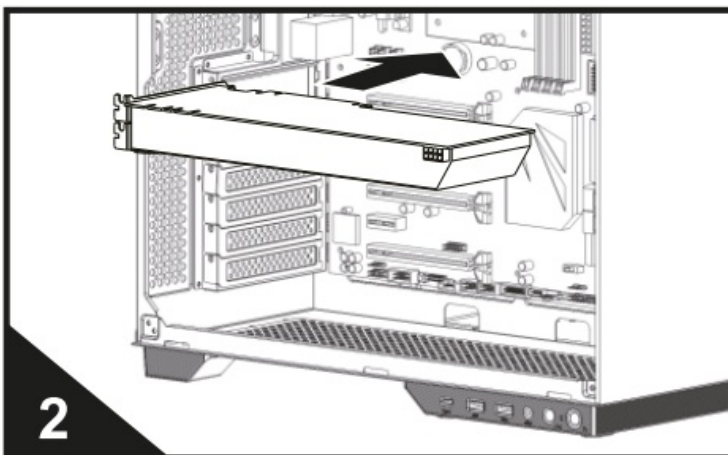
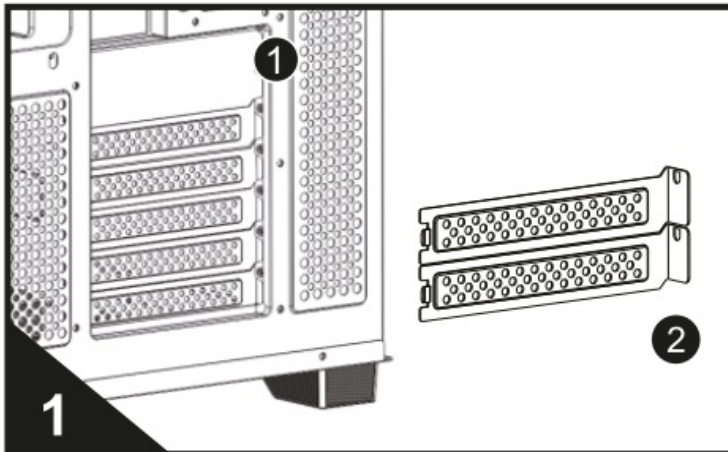

2. **Vertical installation:**

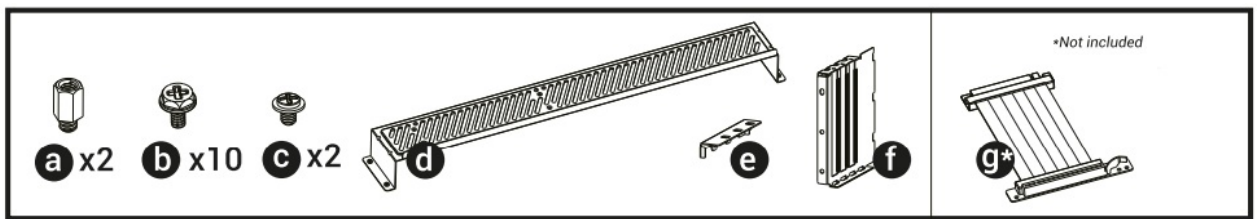

1. Remove all PCI covers from the case/.
2. Install two metal brackets on the graphic card bracket in the position indicated “a”. Secure the graphics card holder to the base of the case using the screws “b” in the indicated position/.

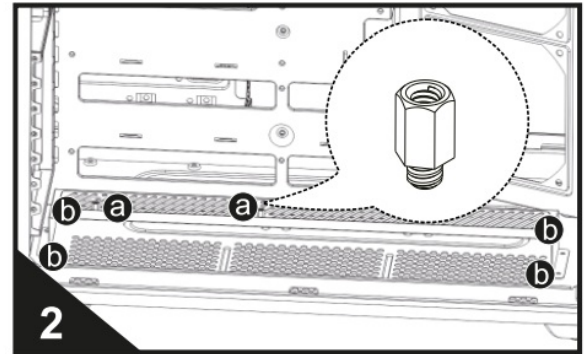
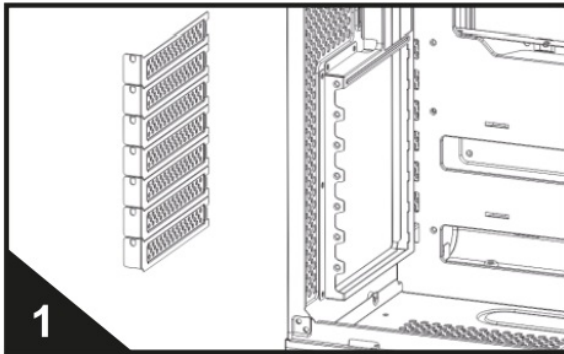

3. Install the vertical PCI adapter in the position occupied by the 6 PCI slots starting from the bottom. Screw the PCI adapter to the case using screws in position “a”/.
4. Connect the GPU riser cable to the motherboard and screw the other end to the graphics card holder using screws “c” /.

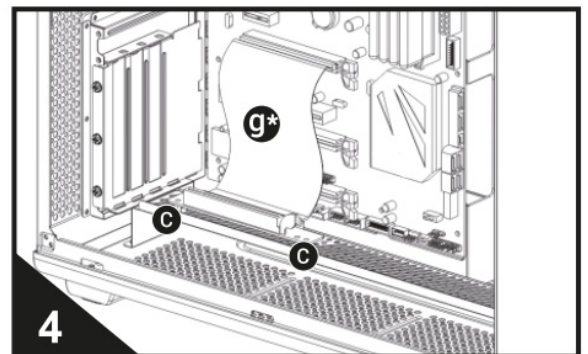
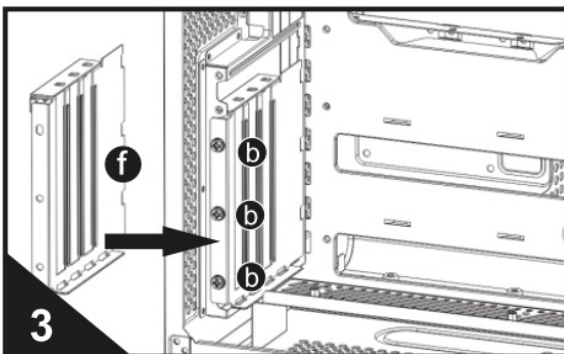

5. Install the graphics card in the GPU riser cable slot/.
6. Place the covers in the indicated places. Place the piece Me” and fit it by aligning the three small slots with the PCI adapter, once placed secure it with three screws.

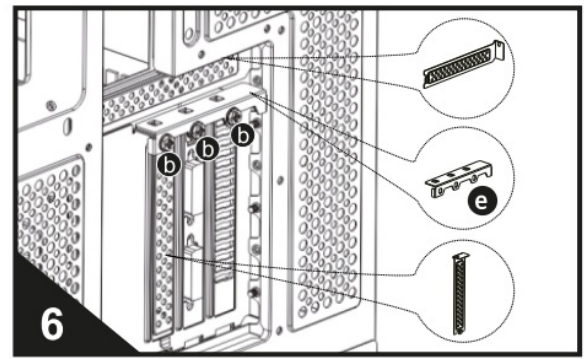
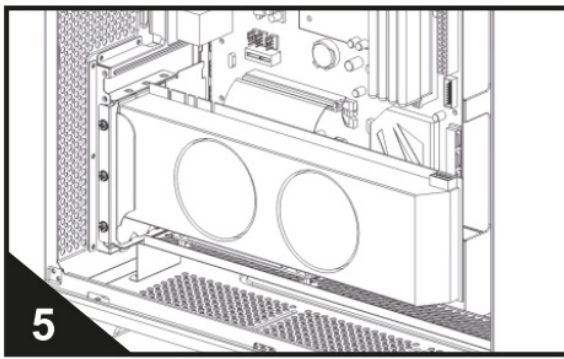

Note: To install the graphics card in a vertical position, a GPU riser cable is required (not included). It is recommended to use a GPU riser cable of at least 300 mm in length, such as the Mars gaming MCAPCIE 40 model.

5. Installing 2.5• SSD/ 3.5• HDD:

1. Install an SSD on the bottom panel and secure it with the screws/
2. Remove the HDD bracket. If you want to install HDD and SSD at the same time, you need to install the SSD first. After installing the HDDs, reinstall the bracket into the case.

5. 2.5" SSD & 3.5" HDD

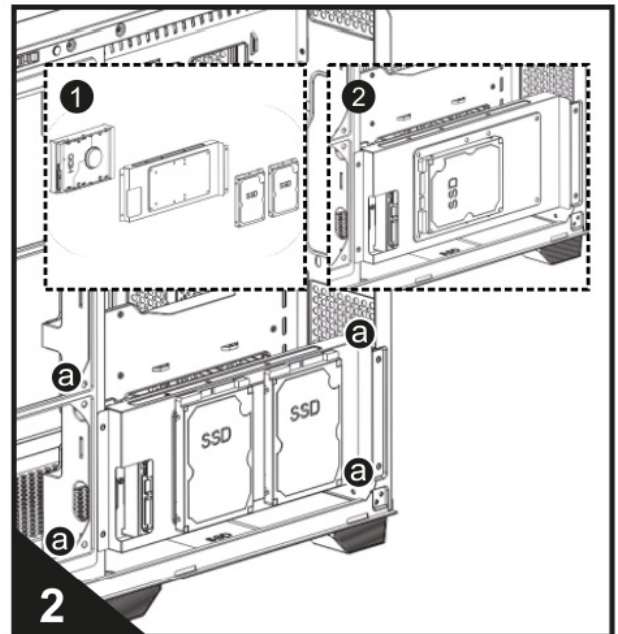
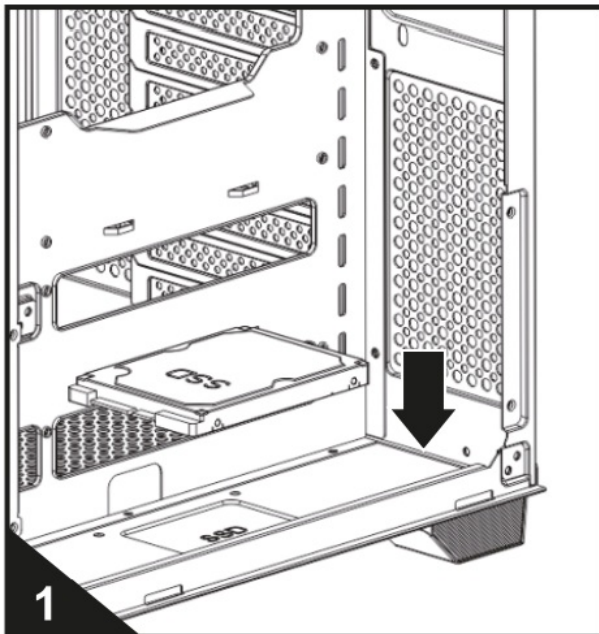

Control HUB

1. **Fan:** Connect the 4-pin cable from the fan to the MFAN" 4-pin port on the HUB.

Note: The HUB is designed exclusively for use with the fans included with the case. It is not recommended to connect other fans to the HUB as this may compromise the function of the fan and damage the HUB.

2. **Power:** Connect the SATA connector from the power supply to the SATA port on the

HUB.

3. **Connect Button (Optional):** Allows you to control the lighting effects via the button on the case in addition to the remote control, connect the “RESET SW” cable to the 2-pin connector on the HUB.
4. **Connect M/B (Optional):** Allows you to change lighting effects via the control software of an ARGB-compatible motherboard or other ARGB controller.

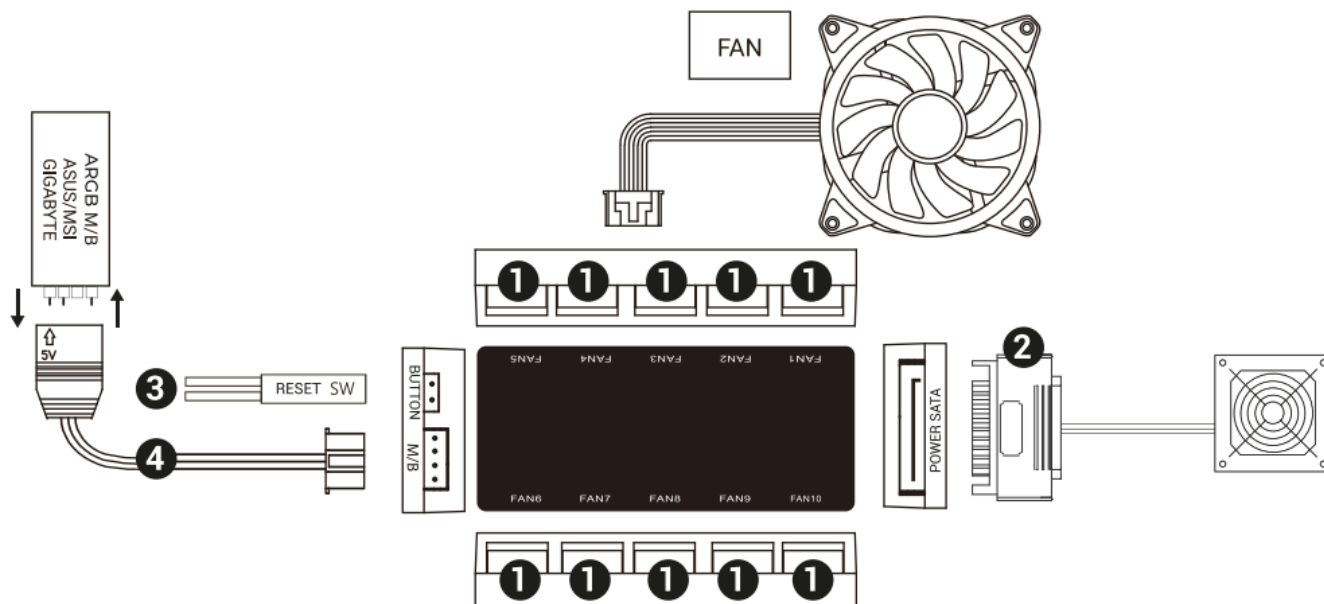

Remote Control

1. Power on/off
2. Minimum/Maximum fan speed
3. Speed adjustment
4. Lighting effect switching
5. Lighting brightness adjustment
6. Fixed colors
7. Automatic lighting switching
8. PRESET/ARGB lighting mode selection

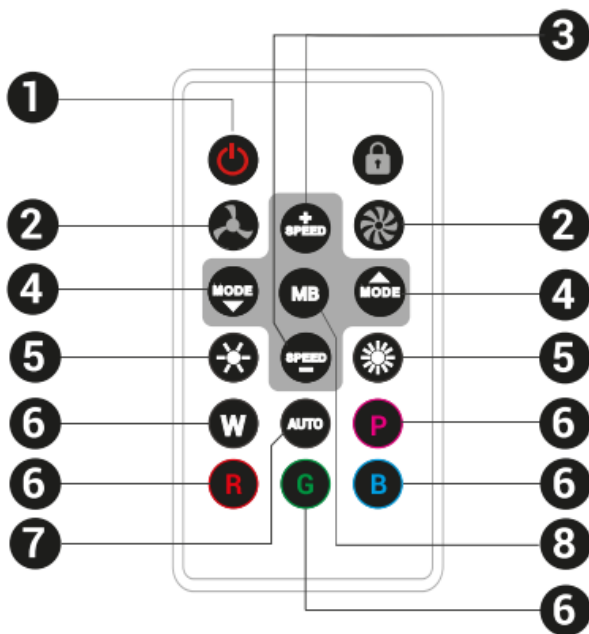

Lighting

PRESET lighting modes: The HUB includes multiple preset lighting effects that can be controlled via the remote control.

ARGB Lighting Mode (Optional): Fan lighting can be controlled by a compatible ARGB motherboard or controller, using the ARGB cable.

1. Connect the ARGB cable to the 3-pin +5V connector on the motherboard or controller.
2. Press the M/B button on the control knob, the HUB will enter ARGB lighting mode.

Press the M/B button again if you want to return to PRESET lighting mode.

Note: Please make sure your motherboard or controller supports 3-pin +5V ARGB lighting. Make sure the ARGB connector on the fans is connected to the correct ARGB control device port, otherwise components may be damaged. If you have any doubts about your motherboard or controllers' compatibility with ARGB lighting, please feel free to contact us for help.

Safety Reminders

- Do not use the product in areas with high humidity or near water.
- Keep children away from the parts while installing the product.
- Protect your hands and fingers when handling and installing the parts.
- Place the product on a flat surface.
- Make sure all components and panels are installed correctly and the screws are

tightened.

- Disconnect the equipment from the power plug before cleaning the chassis.
- Use a soft, dry cloth to clean the table. Do not use abrasive cleaners or solvents.
- Keep the computer in a clean and dry environment, as dust and moisture can limit the life of computer components.
- DO NOT modify the cables or connectors included with this product.
- DO NOT use excessive force when plugging and unplugging.

Important Notice: If you notice any damage or irregularities on the product, please do not proceed with the installation and contact our customer service immediately. Failure to follow these instructions could lead to risks of injury or additional damage.

Troubleshooting

- **The computer does not turn on:** Check the motherboard documentation and make sure the POWER button is connected to the correct port on the motherboard.
- **The front panel connectors do not work:** Check that the front panel connectors (USB, HD AUDIO) are properly connected to the corresponding connectors on the motherboard. Make sure the motherboard drivers are updated and correctly installed. Test the functionality of the USB and Audio connectors with different devices to determine if the problem persists.
- **Component Compatibility** Please refer to the product specification sheet at www.marsgaming.eu for detailed information on the case's compatibility with graphics cards, liquid cooling, air coolers and fans. If you need further assistance, please feel free to contact us for support. Please note that the GPU riser cable for graphics card installation is not included with the product.
- **Fan not spinning:** Make sure the fan's SATA connector is properly connected to the power supply.
- **Lighting not working:** Make sure the fans are connected as shown in the fan connection diagram and the HUB is connected to the SATA port on the power supply.
- **ARGB lighting mode not working:** Make sure the ARGB connector is plugged into the motherboard or ARGB controller. Check the ARGB compatibility of the motherboard or controller.
- **RESET SW button for lighting switching not working:** Make sure the RESET SW

switch cable on the case is connected to the “Connect button” connector on the HUB.

If the problem persists or if it is not listed, please contact us at
customerseivice@biomag.es

Warranty

The original purchase receipt will be required to use the warranty service. Please keep it in a safe place. Tampering with the product, technical modifications of any kind and damage due to external mechanical forces will void your warranty. To read the terms and conditions of the warranty, please visit es.marsgaming.eu/es/terms.

Compliance

You can consult the product's European Union Declaration of Conformity at www.marsgaming.eu/en/conformity. For more information, please visit www.marsgaming.eu.

Disposal And Recycling

At the end of the product's life, it should not be disposed of with regular household waste. To promote environmental sustainability and ensure proper waste management, please take the product to a designated collection and recycling center.

Contact

If you have questions or need spare parts for the product, please do not hesitate to contact us: attcliente@biomag.es / +34945124598

Customer Support

MARSGAMING Biomag S. L.

EU office:

Address: Barratxi 39, Pab. 3 01013, Vitoria, SPAIN

Telephone: +34945124598

Email: attcliente@biomag.es Made In China



Points de collecte sur www.quefairedemesdechets.fr Privileges la reparation ou le don de votre appareil !



MARS GAMING
G A M E R S • U N I V E R S E

Documents / Resources

	<p>MARS GAMING MC-INFINIO-MANUAL Computer Case Tower White [pdf]</p> <p>] User Manual</p> <p>MC-INFINIO-MANUAL, MC-INFINIO-MANUAL Computer Case Tower White, MC-INFINIO-MANUAL, Computer Case Tower White, Case Tower White, Tower White</p>
---	--

References

- [User Manual](#)

■ MARS
GAMING

◆ Case Tower White, Computer Case Tower White, MARS GAMING, MC-INFINIO-MANUAL, MC-INFINIO-MANUAL Computer Case Tower White, Tower White

Leave a comment

Your email address will not be published. Required fields are marked *

Comment *

Name

Email

Website

☐ Save my name, email, and website in this browser for the next time I comment.

Post Comment

Search:

e.g. whirlpool wrf535swhz

Search

[Manuals+](#) | [Upload](#) | [Deep Search](#) | [Privacy Policy](#) | [@manuals.plus](#) | [YouTube](#)

This website is an independent publication and is neither affiliated with nor endorsed by any of the trademark owners. The "Bluetooth®" word mark and logos are registered trademarks owned by Bluetooth SIG, Inc. The "Wi-Fi®" word mark and logos are registered trademarks owned by the Wi-Fi Alliance. Any use of these marks on this website does not imply any affiliation with or endorsement.