



marklin 39810 Giruno High Speed Multiple Unit Instruction Manual

[Home](#) » [marklin](#) » marklin 39810 Giruno High Speed Multiple Unit Instruction Manual 



39810 Giruno High Speed Multiple Unit Instruction Manual

Contents

- [1 39810 Giruno High Speed Multiple Unit](#)
- [2 Safety Notes](#)
- [3 Documents / Resources](#)
 - [3.1 References](#)
- [4 Related Posts](#)

39810 Giruno High Speed Multiple Unit



The 3-part unit with cars F, G, and H is permanently coupled and cannot be separated.

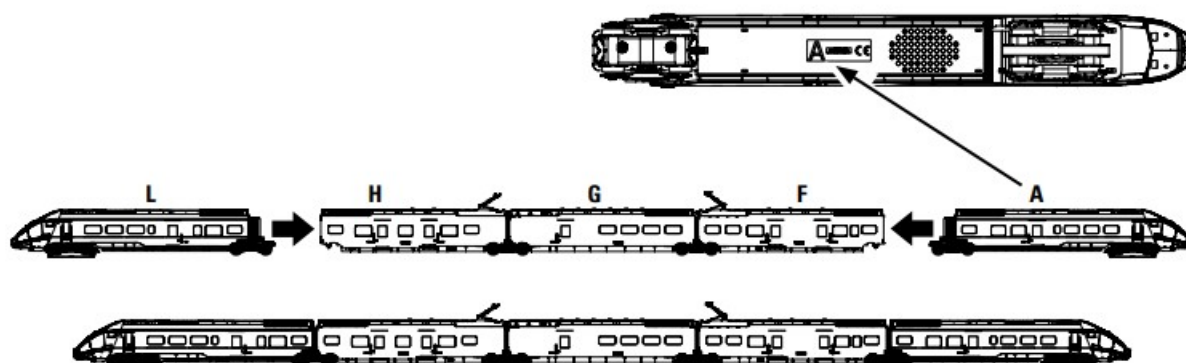
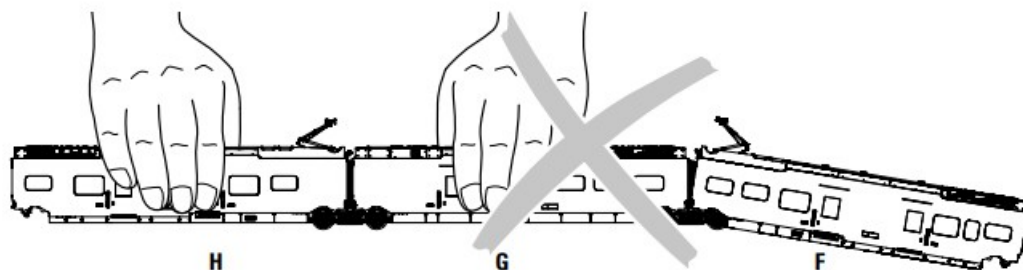

To uncouple, lift gently, and use the uncoupling tool included with this model to unlock at the car floor.

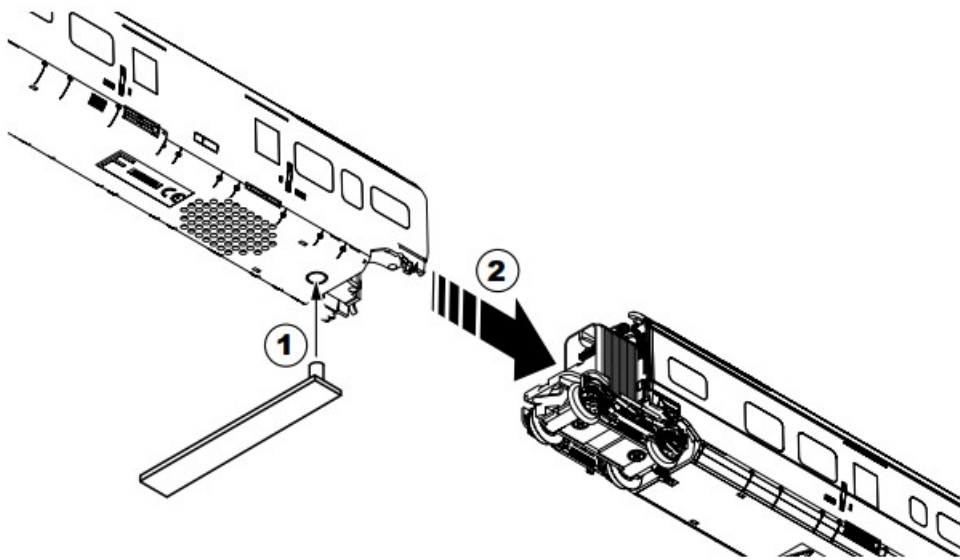

Safety Notes

- This locomotive is to be used only with an operating system designed for it (Märklin AC, Märklin Delta, Märklin Digital or DCC).
- Use only switched mode power supply units and transformers that are designed for your local power system.
- This locomotive must never be supplied with power from more than one transformer.
- Pay close attention to the safety notes in the instructions for your operating system.
- The feeder track must be equipped to prevent interference with radio and television reception, when the locomotive is to be run in conventional operation. The 74046 interference suppression set is to be used for this purpose.
- Do not expose the model to direct sunlight, extreme changes in temperature, or high humidity.
- WARNING! Sharp edges and points required for operation.
- The LEDs in this item correspond to Laser Class 1 according to Standard EN 60825-1.

Important Notes

- The operating instructions and the packaging are a component part of the product and must therefore be kept as well as transferred along with the product to others.
- Please see your authorized Märklin dealer for repairs or spare parts.
- The warranty card included with this product specifies the warranty conditions.
- Disposing: www.maerklin.com/en/imprint.html

Notes about using this model for the first time

- This model needs a great deal of current to start up due to its considerable weight. You should therefore be

careful when starting the locomotive without acceleration and braking delay (ABV) that the locomotive controller is not immediately turned up 100%. The motor control shuts off for safety reasons when the locomotive is started up too quickly.

- Minimum radius for operation is 360 mm / 14-3/16“.
- Sharp curves and turnouts with sharp curves should only be negotiated at moderate speed, however.
- Due to the prototypical execution of this model, very high demands are placed on the precision and execution of the track material used. While the Märklin C or K Track meets these standards, M Track might not always meet them due to greater tolerances caused by years of operation. For that reason you may have operating problems in these situations when running the rail bus at extremely slow speeds or fast speeds through turnouts.
- This model is larger than the customary European loading gauge. It swings out quite a ways, chiefly on curves. Please check before using this model for the first time, to make sure that it can operate on your layout without hitting signals, catenary masts, bridge railings, tunnel portals, etc.
- Power cannot be supplied from the catenary.
- Fitted pickup shoe switching. The motor therefore always receives its voltage from the front power end car.
- The pantograph may not be moved by hand.

Functions

- Recognition of the mode of operation: automatic.
- Mfx technology for the Mobile Station / Central Station. Name set at the factory: RABe 501 003
- Address set at the factory: MM 51 / DCC 03
- Setting the locomotive parameters (address, acceleration/braking delay (ABV), maximum speed): with the Control Unit, Mobile Station, Central Station.
- Headlights, changing over with the direction of travel.
- Various controllable functions.
- The full range of functions is only available under mfx.
- Mode of Operation: Locomotive Engineer
- Additional explanations about the mode of operation can be found in the supplemental instructions (included).
- Only the train control functions and headlight changeover feature are available in analog operation.

Note:

The digital protocol with the most possibilities is the highest order digital protocol. The sequence of digital protocols in descending order is:

- Priority 1: mfx
- Priority 2: DCC
- Priority 3: MM

If two or more digital protocols are recognized in the track, the decoder automatically takes on the highest value digital protocol. For example, if mfx & MM are recognized, the mfx digital protocol is taken on by the decoder. Individual protocols can be deactivated with Parameter CV 50.

Controllable Functions		6021	MS I ¹	MS II ²	CSI	CS II/III
Headlights / Red marker light	F0					
Interior lights	F1		1			
Operating sounds ³	F2		2			
Sound effect: Long horn blast	F3		6			
ABV, off	F4		4			
Sound effect: Squealing brakes off	F5		5			
Pantograph F raise/lower	F6		7			
Switching light special symbol ⁴	F7		8			
Pantograph H raise/lower	F8		3			
Sound effect: Train announcement	F9					
Sound effect: Train announcement	F10					
Long distance headlights ⁴	F11					
Sound effect: Station announcements	F12					
Sound effect: Conductor whistle	F13					
Sound effect: Opening doors	F14					
Sound effect: Squealing brakes on ⁵	F15					
Sound effect: Train announcement, sequence	F16					
Sound effect: Short horn blast	F17					

Controllable Functions		6021	MS I ¹	MS II ²	CSI	CS II/III
Sound effect: Train announcement	F18					
Sound effect: Train announcement	F19					
Pantograph B raise/lower (43461)	F20					
Pantograph D raise/lower (43462)	F21					
Control desk lighting	F22					
Engineer's cab lighting 1	F23					
Engineer's cab lighting 2	F24					
Third headlight off ⁴	F25					
Switching symbol in Italy ⁴	F26					
Warning light(s) in Switzerland ⁴	F27					
Parking position in Switzerland ⁴	F28					
Park position in Italy ⁴	F29					
Train destination sign ⁶	F30					
Sound effect: Doors beeping	F31					

1. The number corresponds to the button number on the device.
2. Functions starting at F16 are not possible until you have Software Version 3.55 in the MS2.
3. with random sounds
4. Only in conjunction with the headlights.
5. Only for „World of Operation“, do not move (do not map).
6. Can only be activated when the train is standing still.

CV (Parameter)	CV-Nº	Value
Address	1	01 – (80)* 255
Acceleration delay	3	01 – (63)* 255
Braking delay	4	01 – (63)* 255
Maximum speed	5	01 – (63)* 255
Reset to series value	8	8
Alternative Protocols	50	0 – 15
Volume	63	01 – (63)* 255

CV 50 Alternative Protocols

Analog AC	Analog DC	DCC or MM	mfx	Values
—	—	—	—	0
✓	—	—	—	1
—	✓	—	—	2
✓	✓	—	—	3
—	—	✓	—	4
✓	—	✓	—	5
—	✓	✓	—	6
✓	✓	✓	—	7
—	—	—	✓	8
✓	—	—	✓	9
—	✓	—	✓	10
✓	✓	—	✓	11
—	—	✓	✓	12
✓	—	—	✓	13
—	✓	✓	✓	14
✓	✓	✓	✓	15

Note: The current protocol in use cannot be deactivated.

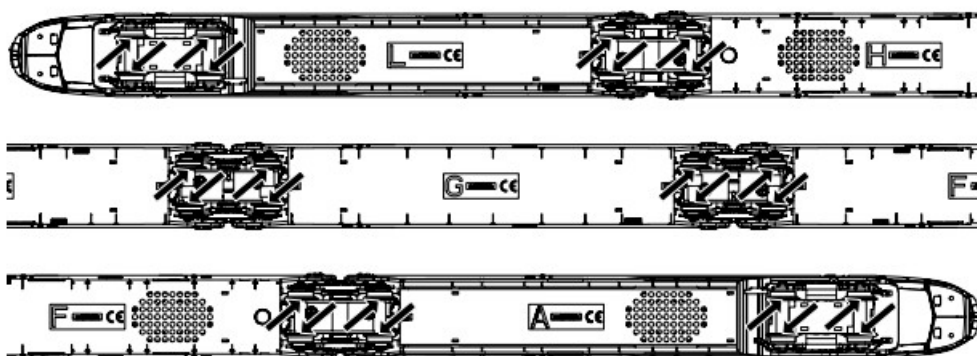
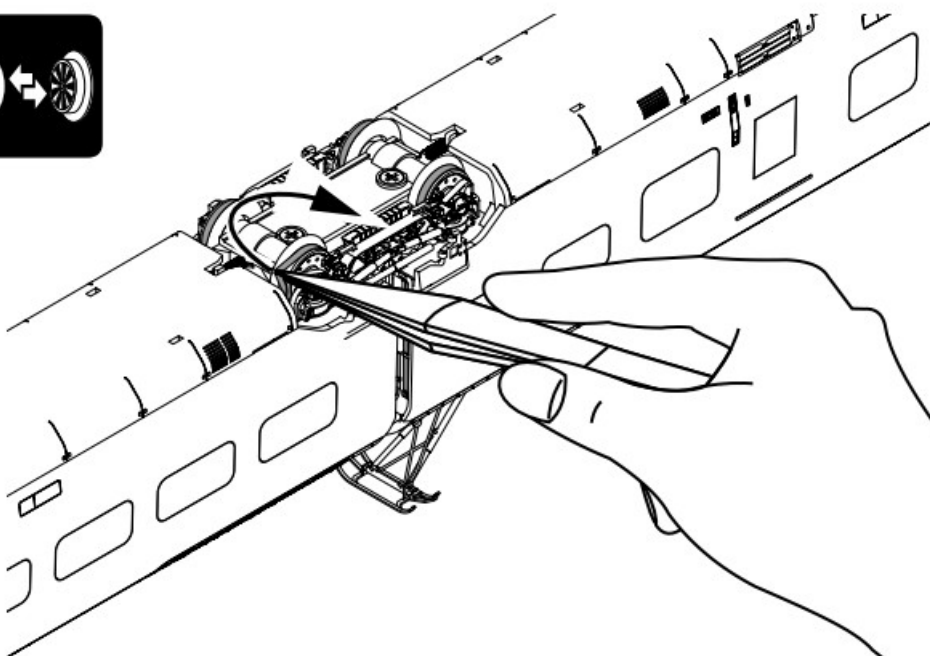
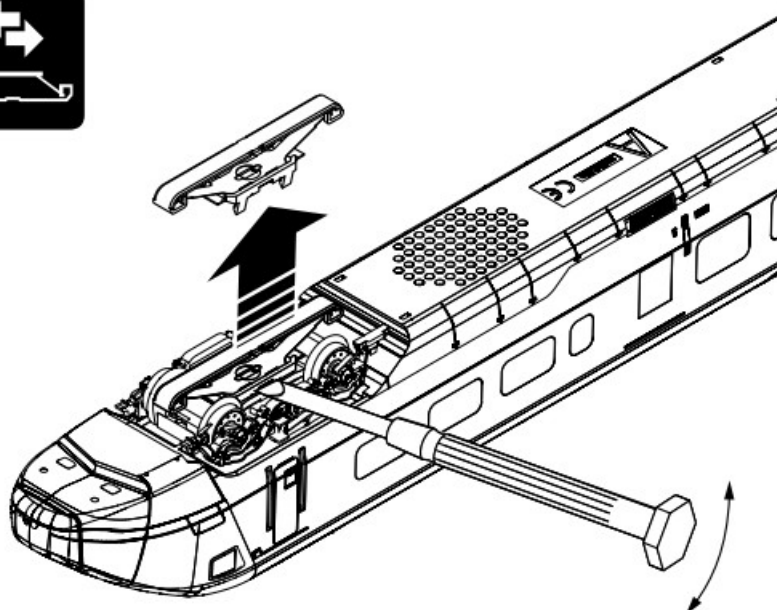



66626
Trix 66626

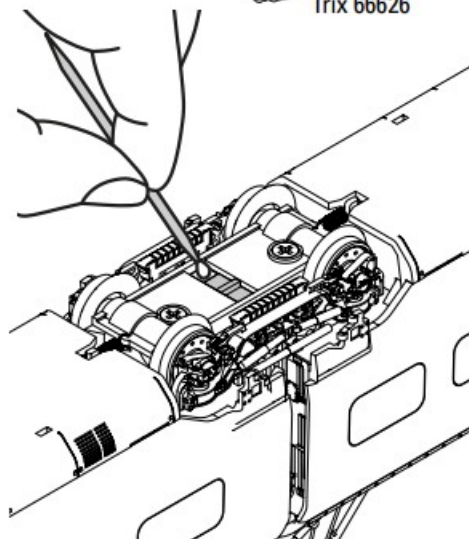
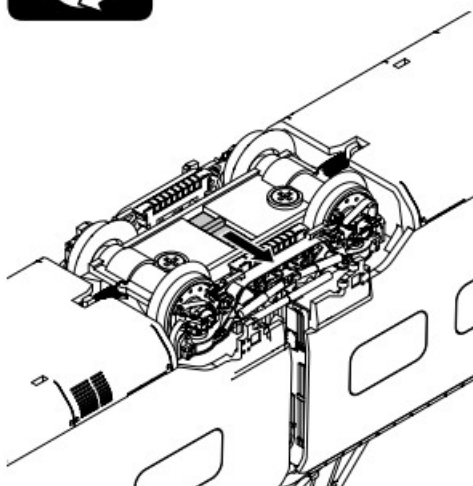

66626
Trix 66626

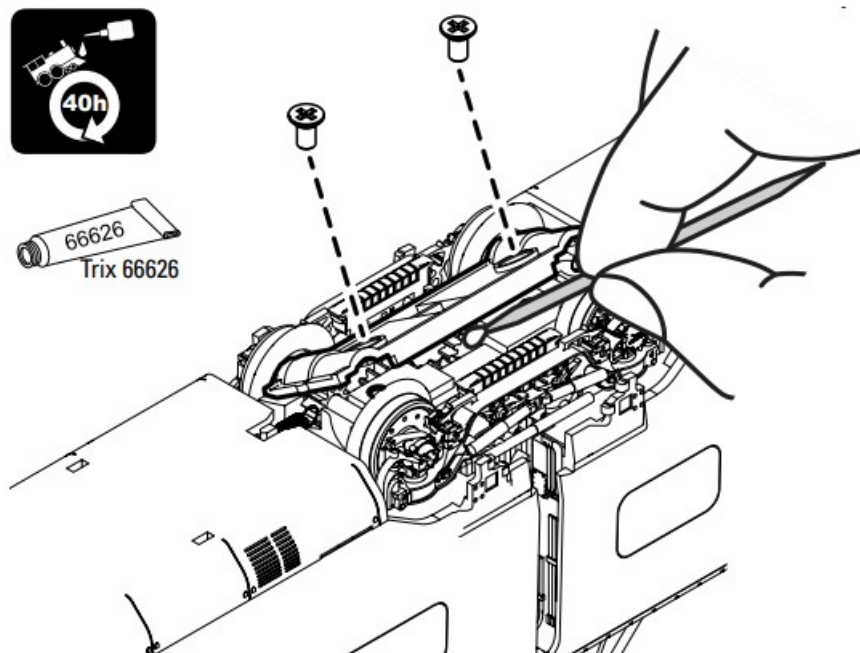

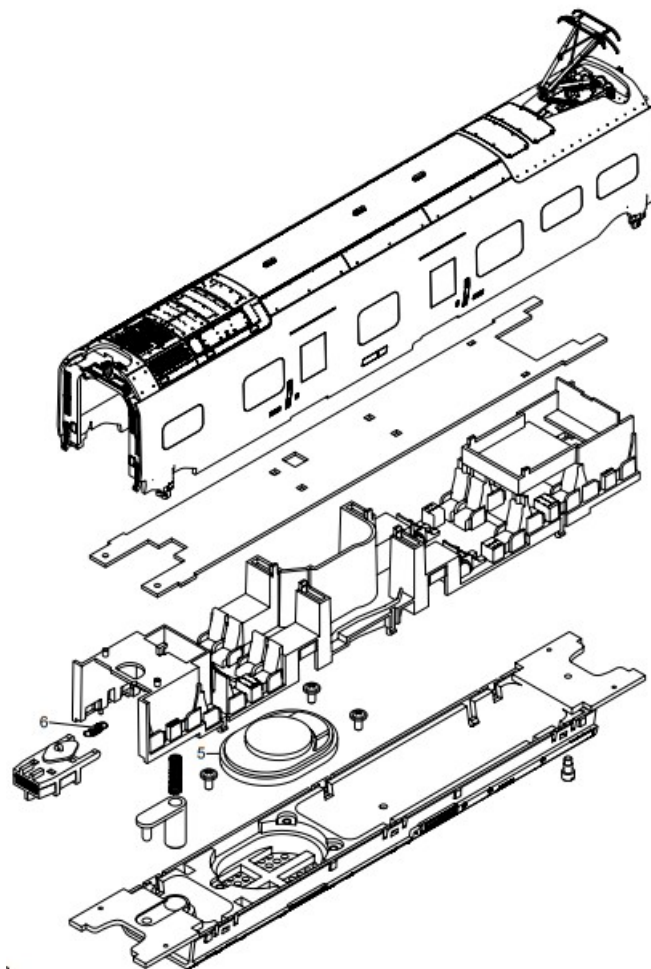
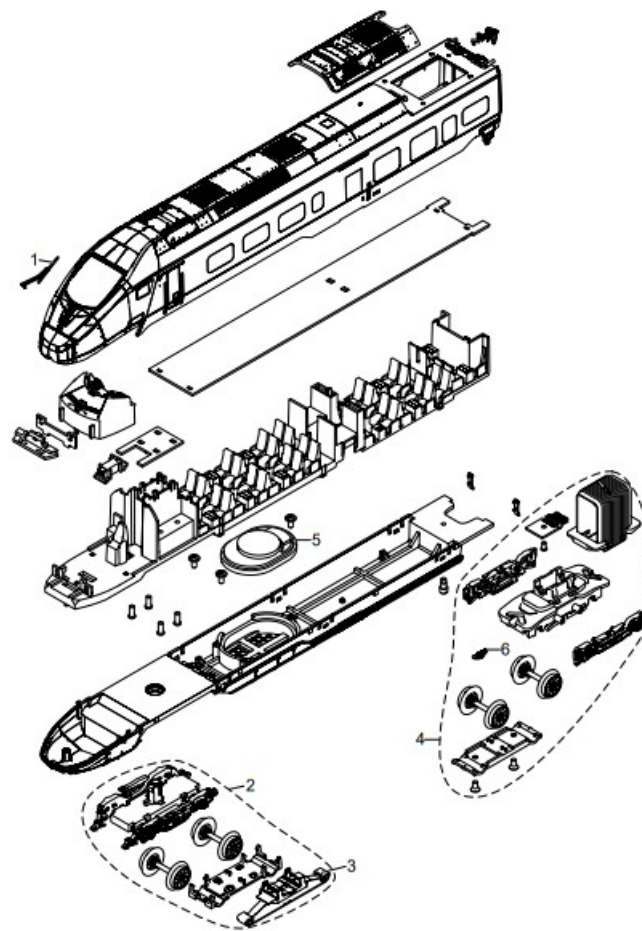

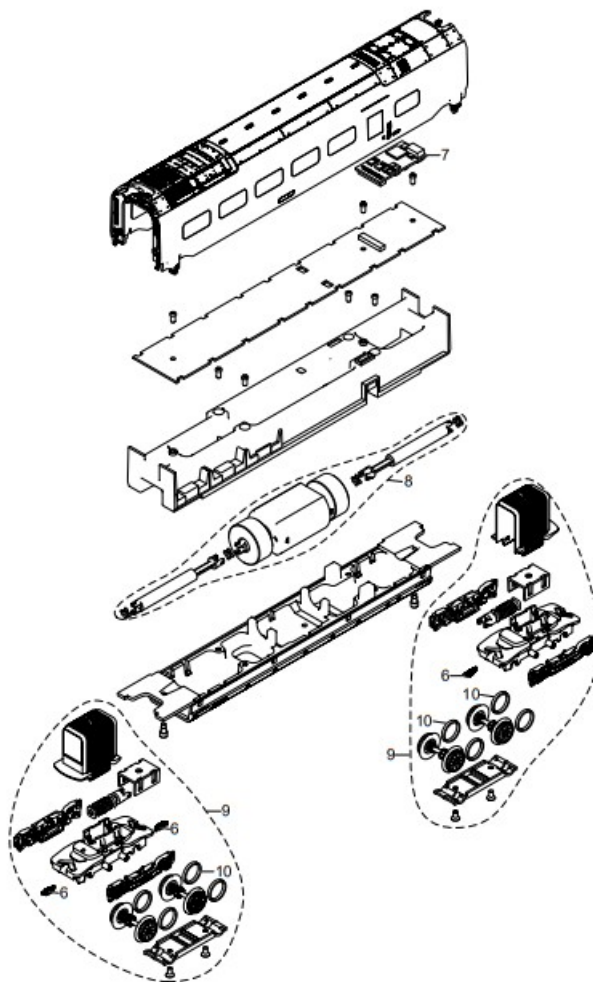

	End- wagen A	Mittel- wagen F	Mittel- wagen G	Mittel- wagen H
1 Scheibenwischer	E376 326	—	—	—
2 Drehgestell	E376 316	—	—	—
3 Schleifer	E262 501	—	—	—
4 Drehgestell	E379 319	—	—	—
5 Lautsprecher	E340 118	E340 118	—	E340 118
6 Feder	E376 698	E376 698	—	E376 698
7 Decoder	—	—	376239	—
8 Motor	—	—	E376	—
9 Drehgestell mit Antrieb	—	—	E376 244	—
10 Haftreifen	—	—	E656	—
11 Verbinder	—	E379 304	—	E376 262

Note: Several parts are offered unpainted or in another color.

Parts that are not listed here can only be repaired by the Märklin repair service department.

General Note to Avoid Electromagnetic Interference:

A permanent, flawless wheel-rail contact is required in order to guarantee operation for which a model is designed. Do not make any changes to current-conducting parts.

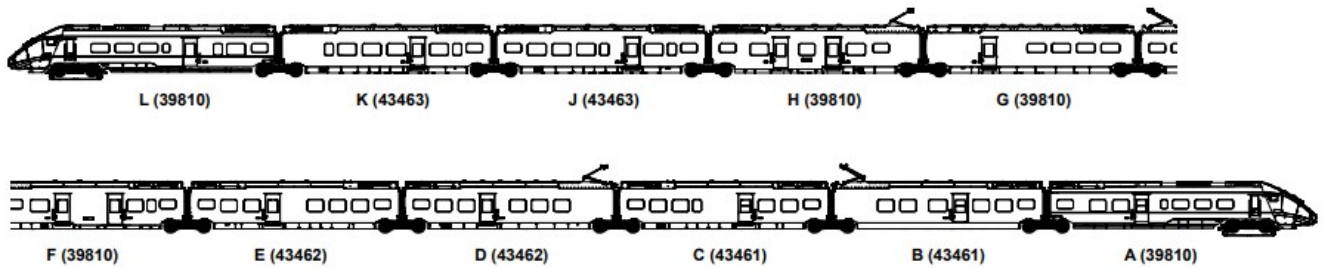

Gebr. Märklin & Cie. GmbH

Stuttgarter Straße 55 – 57

73033 Göppingen



Germany

www.maerklin.com



www.maerklin.com/en/imprint.html

Documents / Resources

  Modell des Hochgeschwindigkeits-Triebzugs Gira-39810 39810	marklin 39810 Giruno High Speed Multiple Unit [pdf] Instruction Manual 39810, 39810 Giruno High Speed Multiple Unit, Giruno High Speed Multiple Unit, High Speed Multiple Unit, Multiple Unit, Unit
---	--

References

- [User Manual](#)