

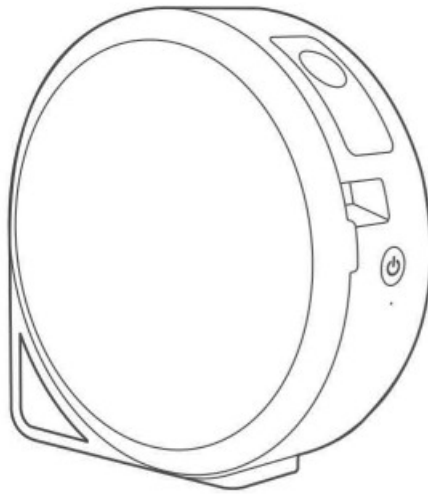

MARK DOMAIN P3100D Label Maker Machine with Tape User Guide

[Home](#) » [MARK DOMAIN](#) » MARK DOMAIN P3100D Label Maker Machine with Tape User Guide

P3100D User's Guide



Thank you for choosing our products!
Please read this instruction carefully before using this product and keep it properly.

Contents [[hide](#)

- 1 Packaging List
- 2 Product Specifications
- 3 Parts Description Appearance
- 4 Parts Description Power Button and Indicator Light
- 5 Guidance on switching on the Power Supply
- 6 App Download Method
- 7 Installation for Label Tape
- 8 Printer Connection
- 9 Print Head Cleaning
- 10 Instruction for Replacing Cutter Holder
- 11 FCC Caution
- 12 Solutions for Common Problems
- 13 After-sale Support Product Warranty
- 14 After-sale Support Warranty
- 15 Documents / Resources
- 16 Related Posts

Packaging List



Label maker*1



User' s guide*1

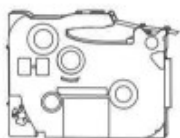

Label tape*1

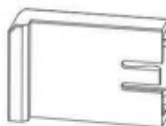

Replacement cutter holder*1

Product Specifications

Product name	Portable label maker
Product model	P3100D
Version	Alkaline battery version
Printing technology	Thermal transfer printing
Width for label tape	6mm, 9mm, 12mm
Type for supported label tape	Continuous label and can be cut in different lengths
Printing density	Light, standard, dark
Printing resolution	180 dpi
Print head service life	50 KM
Communication interface	Bluetooth 4.2
Product size	145*143*57mm (5.72"5.69*2.2inch)
Input power	9V-2A
Power supply mode	Adapter
	Alkaline battery
Supported operating system	Android
	iOS

Parts Description Appearance

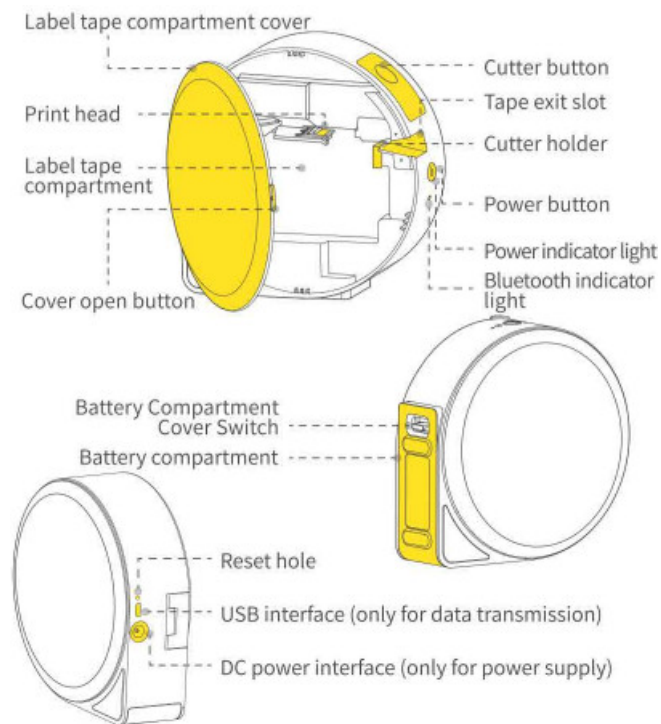



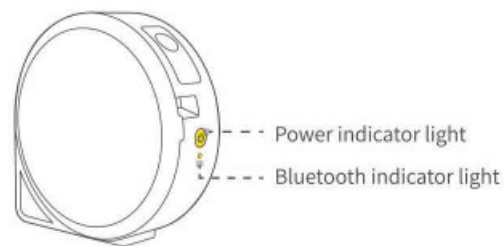

Parts Description Power Button and Indicator Light



Power button description

Button	Operation method	Functions
Power button	Long press for 3 seconds	Turn on/off
	Double click	Print the self-checking label

Indicator light

Indicator light	State	Description
Power indicator light	 Blue light is frequently on	Normal status
	 Orange light flashing slowly	Please check whether the label tape is installed properly
		Press the cutter key during printing
		Battery power is less than 10%
	 Orange light flashing quickly	Battery power is less than 5% and cannot support printing
Bluetooth indicator light	 Blue light is frequently on	Connected to USB or Bluetooth
	 Blue light flashing slowly	No device is connected

Guidance on switching on the Power Supply



NOTE

- A. It does not support charging.
- B. This label maker is NOT equipped with batteries. You need to purchase 6 standard AA alkaline batteries, or it may have a shorter printing time and worse printing effect.
- C. This product is NOT equipped with an adapter. It is recommended to purchase a 9V/2A adapter that complies with CE/FCC certification.
- D. If you install the AA batteries and insert the adapter at the same time, the battery power will not be consumed. After unplugging the adapter, it will automatically switch to the battery power supply.
- E. After printing, please remove the AAA batteries to prevent this label maker from being used normally because of the alkaline battery's corrosion.
- F. If the battery power is low, kindly replace all six batteries at the same time.

Method 1: Power on with AAA alkaline battery

- Press the battery compartment cover switch in the groove upward in the direction of the arrow to open and remove the battery compartment cover.
- When installing the batteries, put the black cloth strip to the opposite side firstly, then install the batteries on the black stripe from the bottom as the positive and negative pole instructions to quickly remove batteries after printing. Please make sure the battery poles point in the correct directions, or the label maker cannot be powered on.

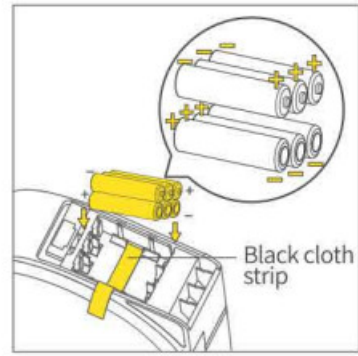
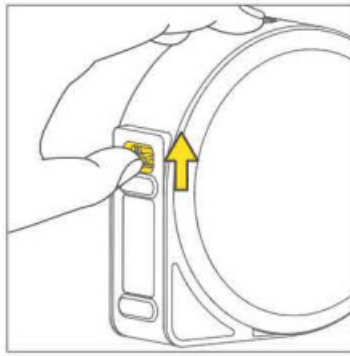

3. Close the battery compartment Cover

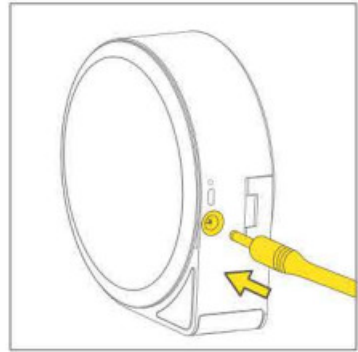

Method II: Power on with the adapter

App Download Method



NOTE

- This product requires the mobile phone or tablet PC to turn on Bluetooth and connect with the label maker in the App.
- Due to the requirements of the Android system, it's necessary to open the location permission when using the App.



<http://downloadapp.qu-in.com/MrIn-Phomemo/>

Method 1: Please use your mobile phone or tablet PC to scan the QR code to download the phoneme App.

Method 2: Search “phoneme” and download the phoneme



Installation for Label Tape



Note

Please ensure that the label printer is power-on before installing the label tape.

1. Long press the power button for 3 seconds to turn it on.
2. Open the label tape compartment cover by pulling the open button outward as indicated.

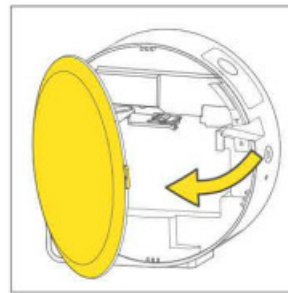
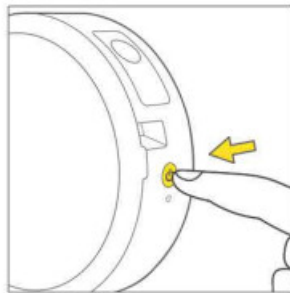

3. Take out the label tape and remove the blue card.
4. Make sure the end of the tape passes through both tape guides 1 and 2.

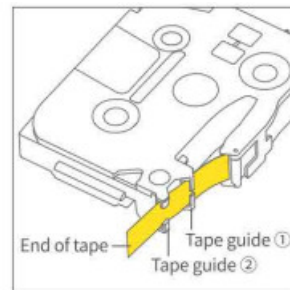
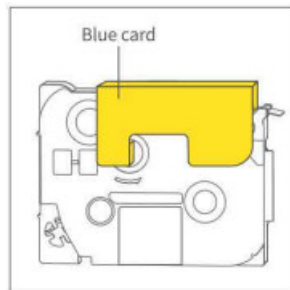

5. Extend 4-5cm label tape.
6. When you notice the carbon ribbon is loose, turn the toothed wheel in the direction of the arrow on the label tape until tight to avoid damage.

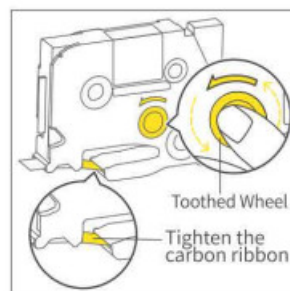
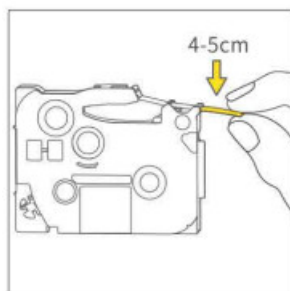

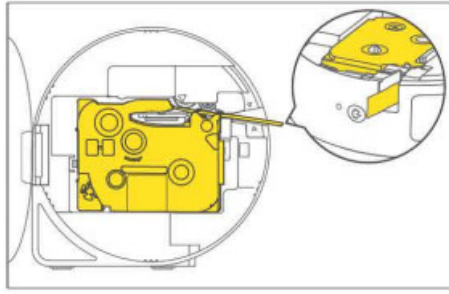

7. Install the label tape correctly as indicated, and make sure that extended tape is through the tape exit slot of the label maker.



Printer Connection

1. Turn on the Bluetooth for your device and open the phoneme App.

2. Click the   button on the top right corner to search the device.

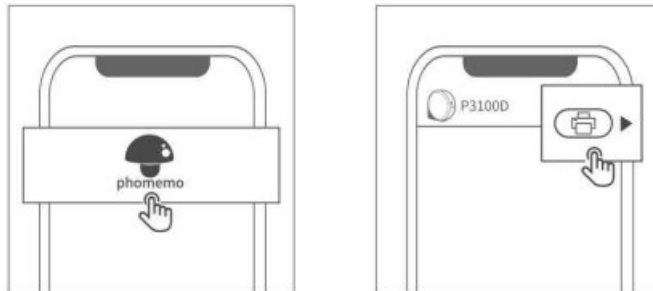

3. Find "P3100D" and click "P3100D" to connect with the label maker.



Note

- For more instructions, please check the "Profile"- "Use Tutorial" in the App.
- App functions will be updated new functions in irregularity. Please refer to the actual functions.

Print Head Cleaning

1. Turn off the label printer
2. Use a cotton swab dipped in a small amount of alcohol.

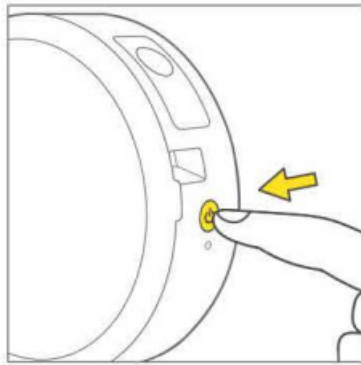

3. Wipe the print head gently
4. Wait 30 seconds for the alcohol to dry and double-click the power button to print the self-checking page.

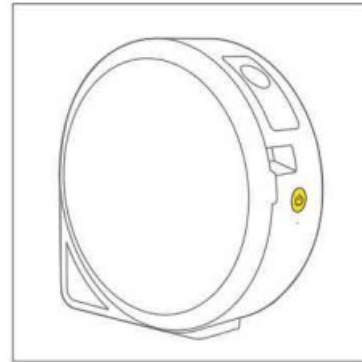
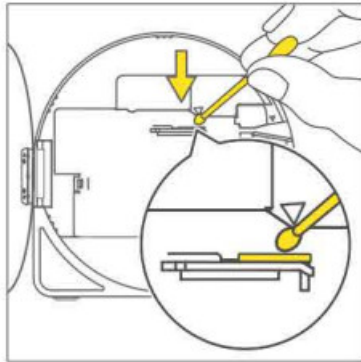

Note

- The print head needs to be cleaned when printing is not clear.
- Do not scratch the print head with a hard object, otherwise, the print head will be damaged and the printing effect will not be, guaranteed.

Instruction for Replacing Cutter Holder

- If the label tape cannot be cut neatly after continuous use, please replace the cutter holder as shown in the following diagram.

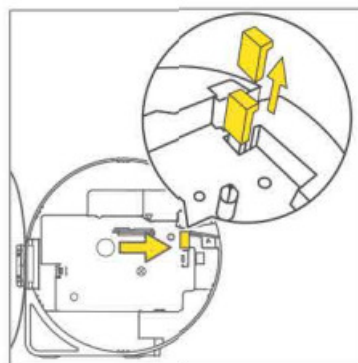

FCC Caution

This device complies with part 15 of the FCC Rules. Operation is subject to the following two conditions:
 (1) This device may not cause harmful interference, and (2) this device must accept any interference received, including interference that may cause undesired operation.
 Any changes or modifications not expressly approved by the party responsible for compliance could void the

user's authority to operate the equipment.

Note: This equipment has been tested and found to comply with the limits for a Class B digital device, pursuant to part 15 of the FCC Rules. These limits are designed to provide reasonable protection against harmful interference in a residential installation. This equipment generates uses and can radiate radio frequency energy and, if not installed and used in accordance with the instructions, may cause harmful interference to radio communications. However, there is no guarantee that interference will not occur in a particular installation. If this equipment does cause harmful interference to radio or television reception, which can be determined by turning the equipment off and on, the user is encouraged to try to correct the interference by one or more of the following measures:

-Reorient or relocate the receiving antenna.

-Increase the separation between the equipment and receiver. -Connect the equipment into an outlet on a circuit different from that to which the receiver is connected.

-Consult the dealer or an experienced radio/TV technician for help. "RF warning for Portable device:

The device has been evaluated to meet general RF exposure requirements.

The device can be used in portable exposure conditions without restriction.

Solutions for Common Problems

Problem	Solution
Unable to be power-on	1. Check whether the positive and negative poles of the battery are installed correctly.
	2. Replace with new MA alkaline batteries.
	3. Make sure the adapter is properly connected and power-on.
Cannot print, or fail to display characters normally	1. Check whether the label tape is installed correctly.
	2. Check whether the printer's back cover is tightly closed.
	3. Check whether the label tape has been used up.
A blank horizontal on the printed label	<p>There may be dust on the print head. Please take out the label tape and gently wipe the print head in a vertical direction with a dry cotton swab.</p> <p>Note: Do not touch the print head with your hand to avoid scalding.</p>
When printing, the power is suddenly off	1. The AAA alkaline batteries may have low power, please replace them with new batteries.

	2. Please check the adapter specification and confirm whether it is 9V/ 2A.
The printer fails to feed the label tape correctly, or the label tape is stuck inside the printer	1. Please check whether the end of the tape has passed through the two tape guides.
	2. It may be caused by pressing the cutter key during printing. DO NOT cut the label tape during printing.
Unable to print via mobile phone	Please check and confirm that Bluetooth has been turned on on your mobile phone and the label printer has been connected in the App.

After-sale Support Product Warranty

Thank you for choosing our portable label maker.

1. We will provide our customers with reliable “replacement/ return” support during the one-year warranty period from the date of purchase;
2. Please keep the product manual and warranty card in a safe place so that you can read it when needed.



+1855 957 5321 (the US only)

Service time: Mon-Fri 9 AM-5 PM



(US EST) support@phomemo.com



www.phomemo.com

For more detailed information, please check the official website:

After-sale Support Warranty

Replace
Return

User Information	Name : Gender: Phone :
	Address :
Product Information	Date of purchase:
	Product order number:
	Product serial number:
Reason for Return (Replace / Repair / Request Maintenance)	Fault description :

Documents / Resources

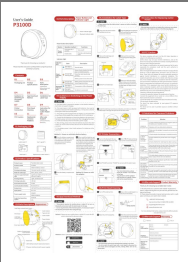
	<p>MARK DOMAIN P3100D Label Maker Machine with Tape [pdf] User Guide P3100D, Label Maker Machine with Tape</p>
--	--