

MARELUX
Apollo S
Underwater
Strobe



MARELUX Apollo S Underwater Strobe User Manual

[Home](#) » [Marelux](#) » MARELUX Apollo S Underwater Strobe User Manual 

Contents

- [1 MARELUX Apollo S Underwater Strobe](#)
- [2 Product Usage Instructions](#)
- [3 Frequently Asked Questions](#)
- [4 Package Contents](#)
- [5 Product Features](#)
- [6 Parts Illustration](#)
- [7 Battery Installation](#)
- [8 Operation](#)
- [9 Protective Cover Installation](#)
- [10 Mounting Ball Installation](#)
- [11 Dome Diffuser Installation](#)
- [12 Maintenance And Storage](#)
- [13 Light scattering angle](#)
- [14 Warranty](#)
- [15 Documents / Resources](#)
 - [15.1 References](#)
- [16 Related Posts](#)

MARELUX

MARELUX Apollo S Underwater Strobe



Specifications

- **Model:** Apollo S Strobe
- **Power Source:** 2 x 18650 lithium batteries (not included)
- **Compatibility:** Works underwater
- **Wireless Trigger Mode:** Requires Lumilink optical transmitter
- **Reception Distance:** 2 to above 10 meters underwater

Product Usage Instructions

Battery Installation

1. Ensure the mode knob is in the OFF position before changing or installing the battery.
2. Slowly rotate counterclockwise to remove the Battery Cap.
3. Insert two 18650 lithium batteries with the correct polarity in the battery compartment.
(**Note:** Requires batteries with a discharge current greater than 20A and a voltage of 3.7V)

Operation Modes

- **OFF:** Turns the power off. Use this mode when not using the strobe.
- **TEST:** Allows you to test the strobe's working status. Press the mode knob to trigger the strobe.
- **M:** Manual mode for setting light amount.
- **Caution:** High-speed continuous shooting in M mode may cause damage.

- **AUTO SYNC:** For TTL flash output, requires compatible flash trigger or camera settings.
- **M-HSS:** High-speed synchronization mode for supported flash triggers.
- **MTL:** Continuous mode with fiber connection support. Different power settings have varying continuous shot limits.

Wireless Trigger Mode

- Requires Lumilink optical transmitter for wireless triggering.
- To activate wireless trigger mode, press and hold the mode knob for 2 seconds in modes other than test mode.
- To deactivate wireless flash mode, press and hold the mode switch for 2 seconds.

Frequently Asked Questions

Q: What type of batteries does the Apollo S Strobe require?

A: The strobe requires two 18650 lithium batteries with a discharge current greater than 20A and a voltage of 3.7V. Regular 18650 batteries are not compatible.

Q: Can I use the MTL mode for continuous shooting at any battery level?

A: It is advised not to use the MTL mode for continuous shooting when the battery level is at half or below to avoid issues.

Please read this user manual carefully before starting to use the product, and use the product properly based on the thorough understanding of this user manual <https://www.marelux.co/>

Package Contents

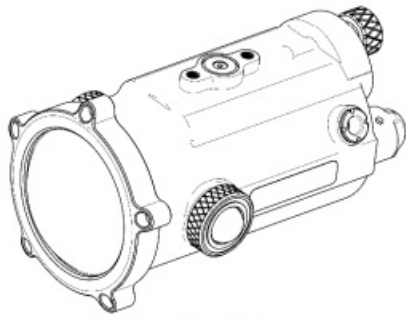

Apollo S Strobe



Battery *2

(Need purchase from Marelux)

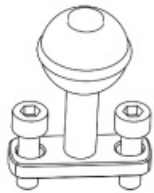

Mounting Ball

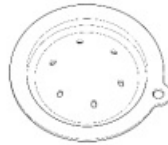

Dome Diffuser

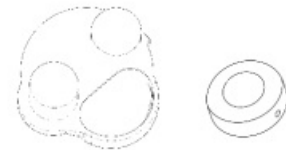

Protective Cover



O-Ring*2



Lanyard sheet

Product Features

1. Support TTL, RC, HSS, wireless triggering (The TTL, HSS, and RC modes require compatible flash triggers to be used)
2. With a specially designed MTL mode, supports continuous flashes
3. With 2 fisheye wireless signal sensor units. Plus one fiber port, sensor coverage 160 °. Wireless trigger supports M, MTL, and HSS. (TTL, RC needs fiber)
4. GN.ISO 100: 33 (tested on land)
5. Scattering angle 110 ° (underwater)
6. Temp 6200k
7. With dome diffuser, scattering angle 140 °, Temp 5500k
8. Full power recycle time 0.9 second
9. Max diameter 70mm, length of main body 140mm, full length including knobs 160mm
10. Weight on land 762 grams (without battery, with ball mount), 856 grams with 2×18650 batteries (with ball mount)
11. Weight in water 210 grams (including 2×18650 batteries, including ball mount)
12. Battery: 2×18650 lithium batteries (discharging current equal or over 20A). 94 grams total
13. Waterproof battery chamber
14. **Full power flash:** around 800 times
15. **Waterproof Depth:** 100m

16. With The Lumilink 2.0 wireless transmitter, synchronize with your camera's shutter speed up to S1/200.

- In shallow water and strong sunlight, it maintains a reliable connection up to 2 meters. In deep water and dim ambient light, the working distance extends to over 10 meters.
- The optical signal for triggering is encrypted and designed to be anti-jam, minimizing interference.

Parts Illustration

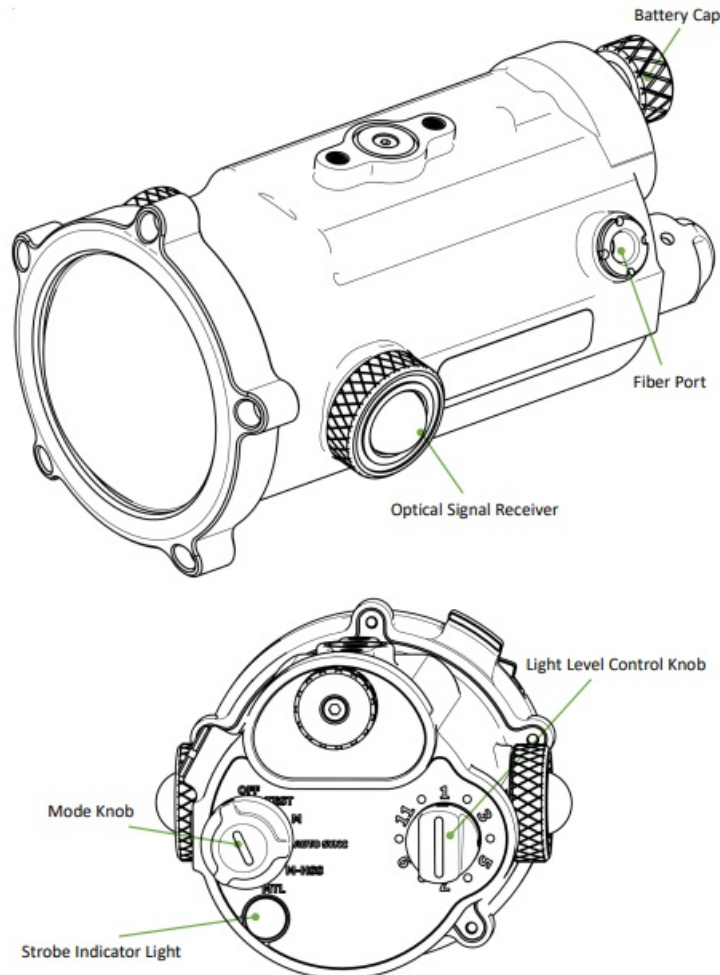

Battery Installation

- When changing or installing the battery, make sure the mode knob is in the OFF position!
- Remove the Battery Cap by slowly rotating counterclockwise.

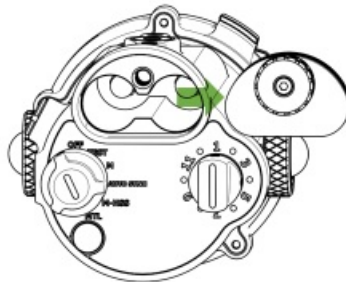

- Insert two 18650 lithium batteries with the polarity shown in the battery compartment.
- Please note that this strobe requires two 18650 lithium batteries with a discharge current greater than 20A and a voltage of 3.7V. It cannot work with regular 18650 batteries.



Operation

Mode Knob

- **OFF** Turns the power off. Switch mode knob to [OFF] when you don't use the strobe.
TEST In this mode, you can test the working status of the strobe. Press the mode knob to trigger the strobe.
- **M** Switch to M mode to set the light amount to Manual.
- **(Warning!)** Use M model power level 12, for high-speed continuous shooting over 100 times, which may cause aging of the coating on the dome and deformation of the internal structure. Please don't use M mode for high-frequency continuous shooting. And only use strobe underwater !)
- **AUTO SYNC** Switch to AUTO SYNC mode when shooting with TTL flash output. (This mode requires a flash trigger that supports TTL mode to use or configure your Olympus camera to RC – TTL AUTO)
- **M-HSS** Switch the M-HSS mode when shooting with high-speed synchronization. (This mode requires a flash trigger that supports HSS mode to use)
- **(Warning!)** In M-HSS mode, please do not take more than 30 continuous shots within one minute !)
- **MTL** Switch to MTL mode when shooting in continuous mode. When using the strobe in MTL mode with a fiber connection, it supports 10 continuous shots per second at all power settings.
- (When using the compact camera in auto flash mode or fill flash mode, please switch to the MTL mode)
- When shooting in continuous mode using wireless trigger mode, the strobe may miss some flashes. The number of continuous shots supported under different power settings for MTL in wireless trigger mode are as follows.

<i>Light Level</i>	<i>The number of continuous shots</i>
1	10/s
2	
3	
4	8/s
5	
6	
7	6/s
8	6/s
9	5/s
10	4/s
11	4/s
12	2/s

- Do not use the MTL mode for continuous shooting when the battery level is at half or below!

Wireless Trigger Mode

- To use the wireless trigger mode, the Lumilink optical transmitter is required as the signal transmitter. When the strobe is turned on, the wireless trigger mode is disabled by default.

- In modes other than the test mode, press and hold the mode knob for 2 seconds, and after hearing four “beep” sounds, the wireless trigger mode will be activated. (Wireless triggering is supported in M, M-HSS, and MTL modes)
- Press and hold the mode switch for 2 seconds, and after hearing two “beep” sounds, the wireless flash mode will be deactivated.
- The reception distance of the optical signal receiver underwater is 2 to above 10 meters up to the visibility and brightness of sunlight.
- (Under strong sunlight, the effective range of reception for the optical signal receiver is 60-70cm, with a reception angle of 50-60 degrees)



Strobe Indicator Light

- The emission color of the strobe indicator light will change depending on the remaining battery level.
- Emission colors are shown in the table below.

<i>Remaining Battery Level</i>	<i>Emission color</i>
80~100%	Blue
60~80%	Green
40~60%	Yellow
20~40%	Purple
0~20%	Red

- When the strobe indicator light is in a low battery state with a red light, please refrain from using the flash function to avoid damaging the battery.
- The strobe will preheat for 10 seconds when first turned on, during which the strobe indicator light will remain red. Please wait for the preheating to finish before using the strobe.
- When the strobe overheats, it will trigger an overheat protection mechanism, preventing further flash triggering. The strobe indicator light will become yellow, indicating the need for cooling for a few minutes.

Light Level Control Knob



The light amount can be adjusted in 12 increments:

M Mode

Level	1	2	3	4	5	6	7	8	9	10	11	12
GN	4.8	5.6	6.8	8	9.5	11	13.5	16	19	22	27	33

MTL Mode

Level	1	2	3	4	5	6	7	8	9	10	11	12
GN	1.0	1.4	2.0	2.8	4.0	5.6	8	9.5	11	13.5	16	19

- The lifespan of the tube is tested through one million full-power cycles.
- To achieve the longest possible lifespan and safety, the electronic components of the Apollo III are designed with redundant power, which may result in instability of brightness during low-power flickering.
- At positions below the third level in M mode and below the sixth level in MTL mode, there will be minor variations in brightness.

Protective Cover Installation

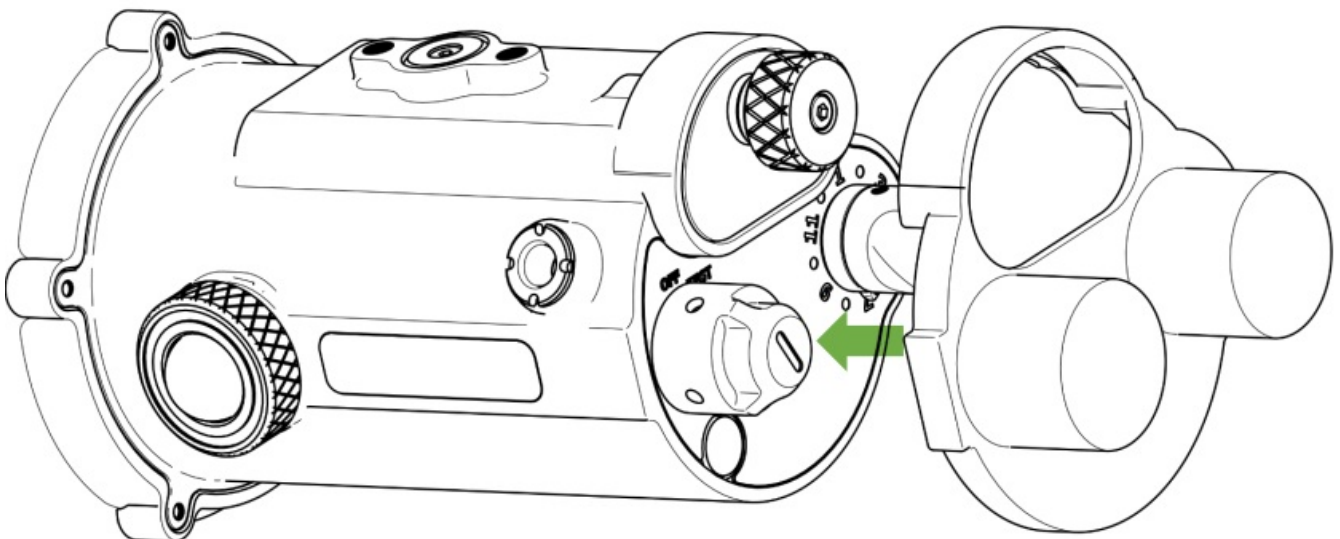

- Align the protective cover with the strobe as shown in the diagram.

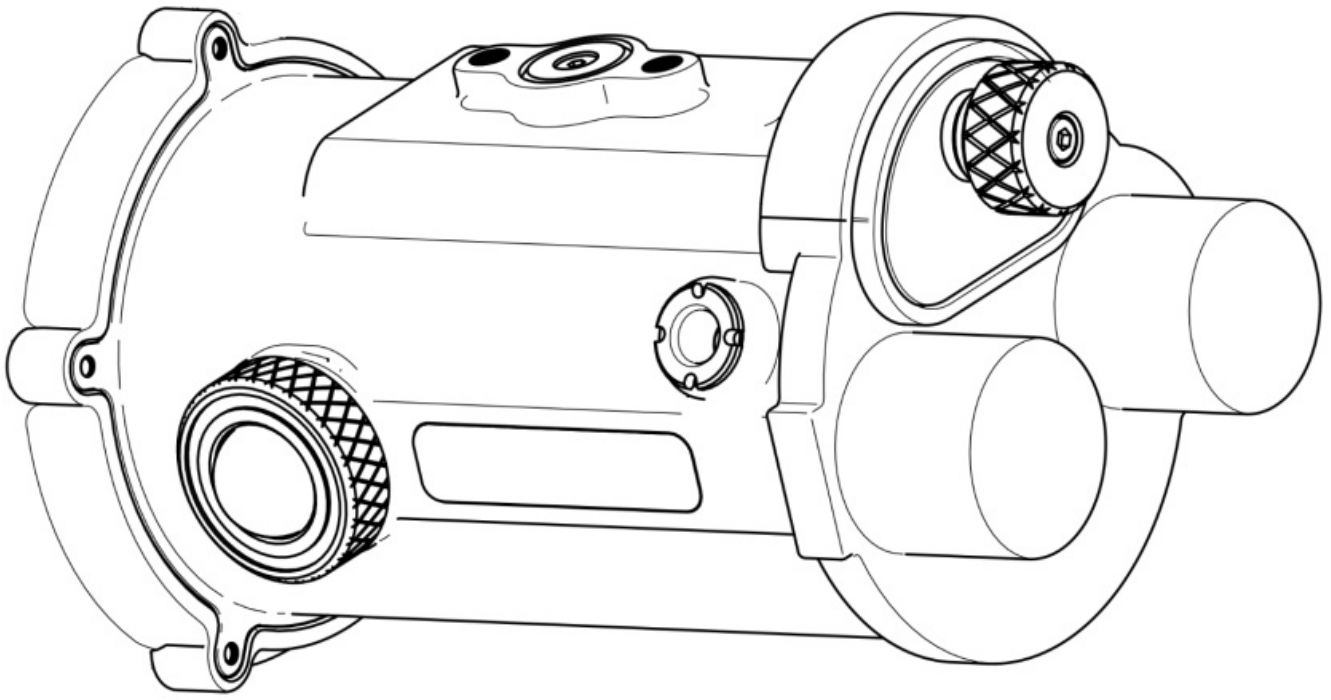

Mounting Ball Installation

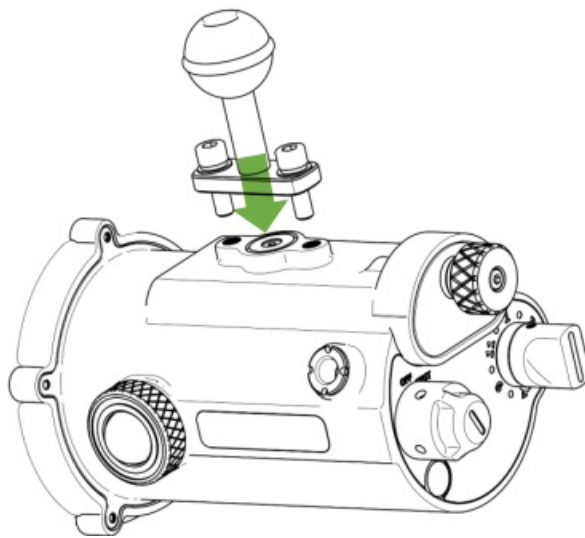

- Install the mounting ball with two screws in the direction shown in the diagram.

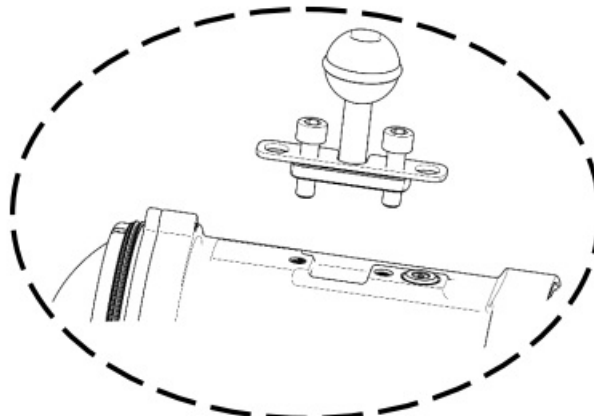

- Install the lanyard sheet with two screws in the direction shown in the diagram.

Dome Diffuser Installation

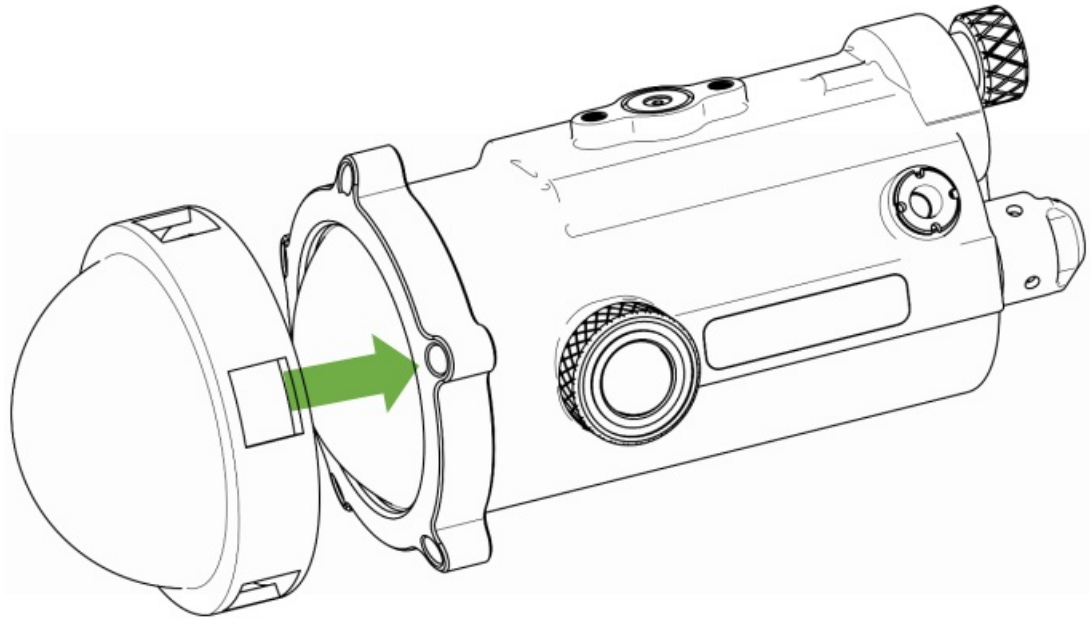

Align the holes of the diffuser as shown with the protrusion of the strobe, then attach it to the strobe.

Maintenance And Storage

1. After diving, make sure the strobe is locked and sealed, and wash the strobe body with fresh water.
2. When immersed in fresh water, push each button a few times, thus can help to let salt and sand go out.
3. Use a soft cloth to wipe and clean the glass on the dome.
4. After each dive, clean the O-rings and check if there are damages on the O-rings.
5. Use a sturdy and shock-proof case to carry the strobe and its accessories.
6. Don't leave the strobe for too long inside the vehicle under exposure to sunlight or heat.
7. Please stop charging the battery when it is full to prevent overcharging and damage to the battery.
8. If don't use the strobe for a long period, remove the batteries.
9. This product is prohibited for use or play by children under 10 years old.

Light scattering angle

Light scattering angle for different accessories installed on Apollo S

Apollo S

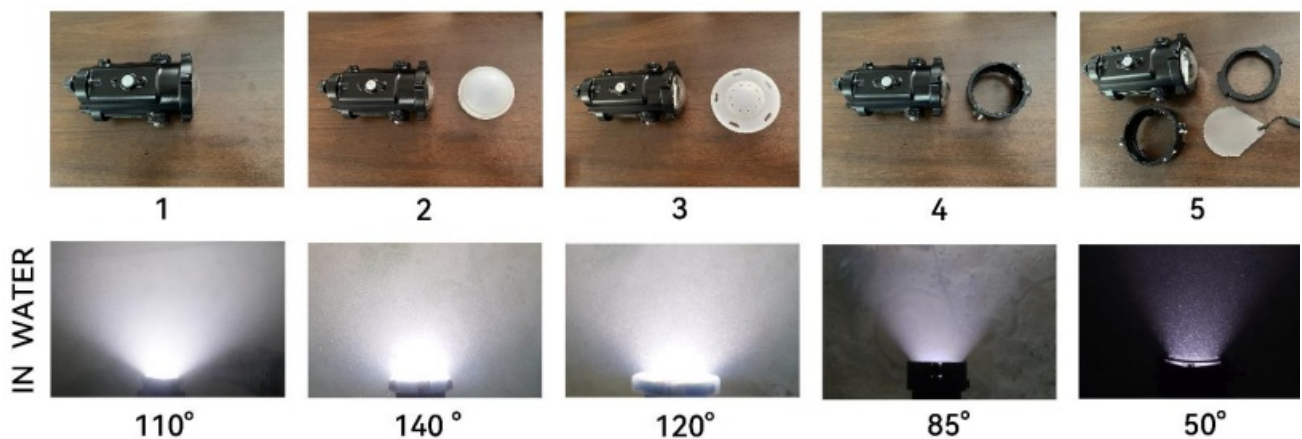

- Apollo S Dome Diffuser
- Apollo S Diffuser
- Apollo S Dock
- Apollo S Dock+ External Slot+ Flat Diffuser

Warranty

1. Marelux provides 2 years warranty for its housing body, cable (such as fiber cable and HDMI cable), and 1 year warranty for electronic parts and components made of silicon, rubber, and plastic.
2. Marelux will keep components and parts for repair and maintenance in storage for 5 years after the EOL of each model. Beyond this period, Marelux may not be able to provide repair services for those products.
3. Repair caused by the following reasons will still be charged by Marelux even during the 2-year warranty.
 - Damage from misuse, incorrect maintenance, or storage not complying with the specifications and notices in this user's manual
 - Damage from falling or inappropriate placement of the product
 - Damage caused by repair, maintenance, dismantlement, modification, or cleaning by any unauthorized vendor or service center by Marelux;
 - Product without authentic Marelux serial number, or with erased, distorted, or falsified serial number;
 - Damage caused by the usage of non-Marelux recommended accessories, parts, and components from other makers or suppliers, such as Flash Trigger, Cable, Dome Port, Extension Ring, Convertor, etc
 - Damage caused by misuse or mistreatment by humans, or by natural disaster or other situations of force majeure;
 - Malfunction or damage caused by erosion due to not cleaning the housing or accessories.
4. Batteries, lubricants, and other consumable supplies are not in warranty.
5. All parts and components replaced from the housing and its accessories in the warranty service should belong to Marelux.
6. Marelux is not responsible for and will not compensate any collateral damages or financial losses caused by using Marelux products, such as income or fees related to the users of Marelux products.
 - Warranty is only provided to products sold inside the service territory of the distributor or reseller.
 - Products purchased and used for rental business are not included in the warranty.
 - Products will lose warranty immediately after unauthorized repair or modification.
 - The warranty terms above are made for Marelux customers to conduct free warranty service and repair and have no restriction to any legal rights that customers shall possess.

Documents / Resources

 <p>MARELUX Apollo S Strobe</p> <p>User Manual</p> <p><small>Please read this user manual carefully before starting to use the product, and use the product properly based on the thorough understanding of this user manual.</small></p> <p><small>©2020 MARELUX</small></p>	<p>MARELUX Apollo S Underwater Strobe [pdf] User Manual</p> <p>Apollo S Underwater Strobe, Apollo S, Underwater Strobe, Apollo S Strobe</p>
---	---

References

-  [Marelux](#)
- [User Manual](#)

[Manuals+](#), [Privacy Policy](#)

This website is an independent publication and is neither affiliated with nor endorsed by any of the trademark owners. The "Bluetooth®" word mark and logos are registered trademarks owned by Bluetooth SIG, Inc. The "Wi-Fi®" word mark and logos are registered trademarks owned by the Wi-Fi Alliance. Any use of these marks on this website does not imply any affiliation with or endorsement.