

Mareda
TMST142
Classic
Extendable
Dining Table



Mareda TMST142 Classic Extendable Dining Table Instruction Manual

[Home](#) » [Mareda](#) » Mareda TMST142 Classic Extendable Dining Table Instruction Manual 

Contents

- 1 Mareda TMST142 Classic Extendable Dining Table
- 2 Product Usage Instructions
- 3 FAQ
- 4 Dimension
- 5 PRECAUTION
- 6 Service
- 7 INSTALLATION INSTRUCTION
- 8 GUIDELINES FOR FURNITURE CARE
- 9 Documents / Resources
 - 9.1 References
- 10 Related Posts

Mareda

Mareda TMST142 Classic Extendable Dining Table



Product Specifications

- **Model:** TMST142
- **Duration:** 90 minutes
- **Power:** 852 watts
- **Input:** 1200V – Output: 852V
- **Weight:** 782 grams
- **Dimensions:** 1750 mm

Product Usage Instructions

Assembly

Ensure that the assembly is carried out according to the manufacturer's instructions to avoid any risks.

Indoor Air Quality

Furniture containing wood-based panels may emit substances into indoor air. After assembling the furniture, it is recommended to ventilate the room for about four weeks or until any odor dissipates.

FAQ

Q: How long should I ventilate the room after assembling the furniture?

A: It is advised to ventilate the room for approximately four weeks or until any lingering smell disappears.

Dimension

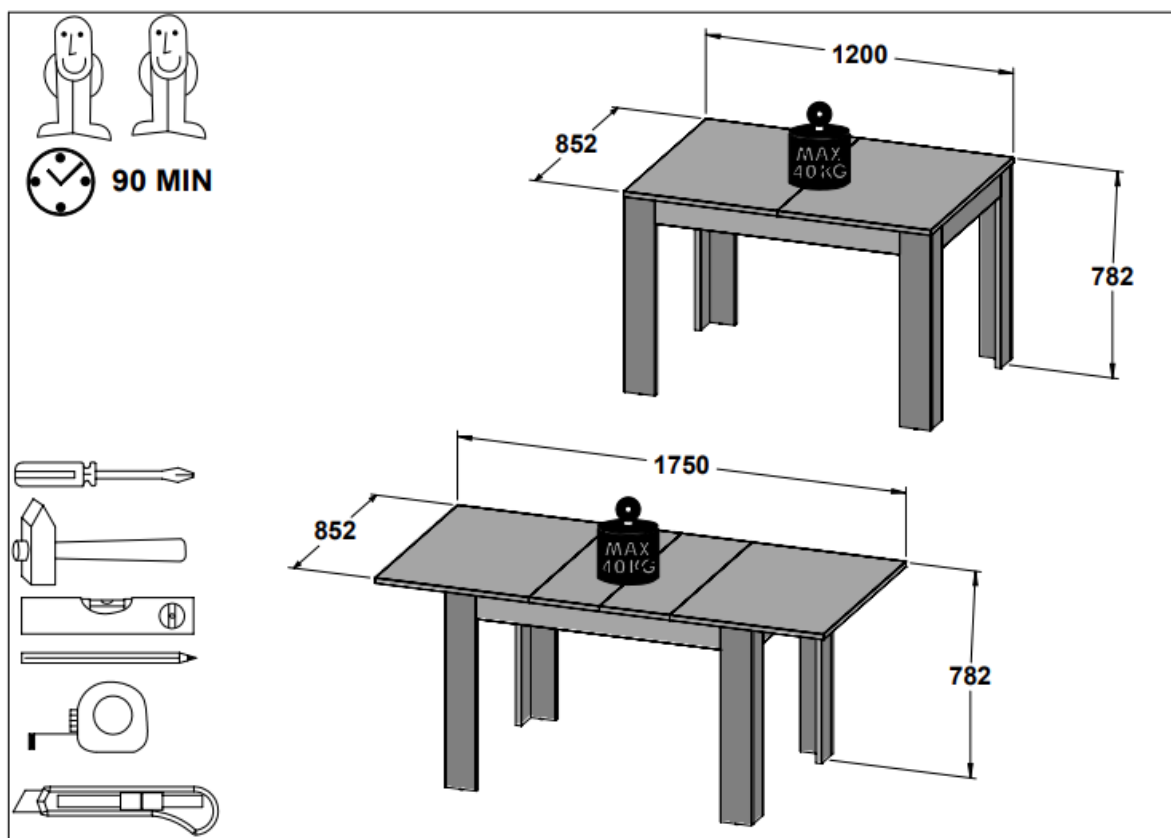

Follow the manufacturer's assembly instructions, otherwise, danger may occur.

PRECAUTION

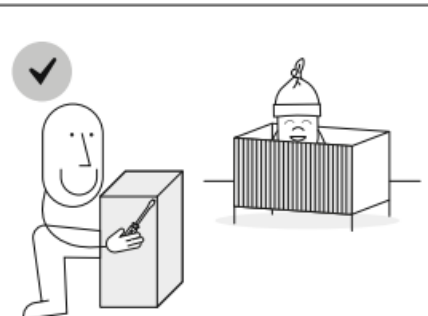
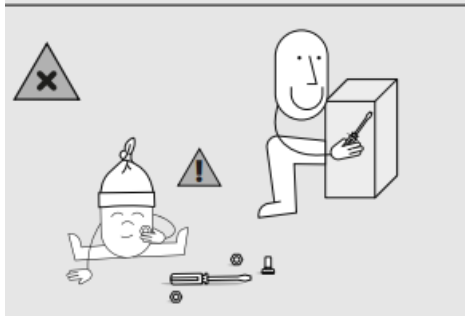
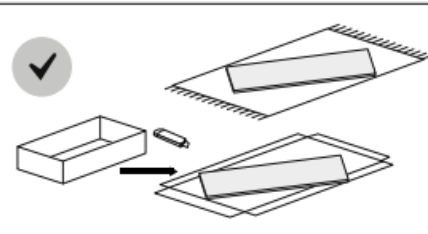
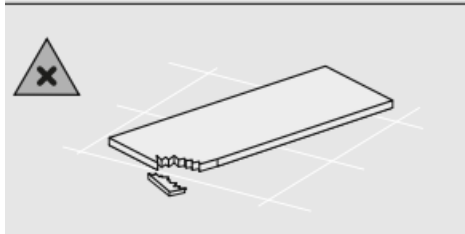
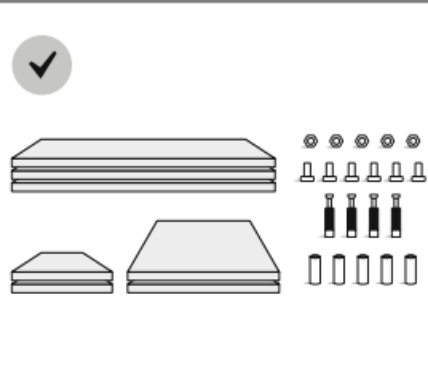
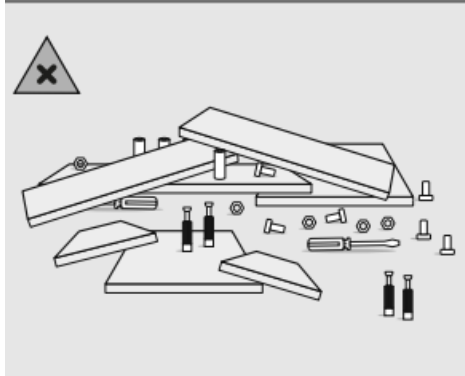
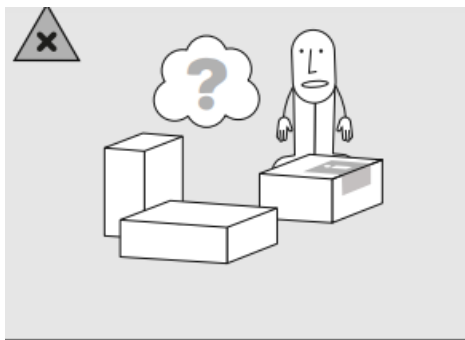

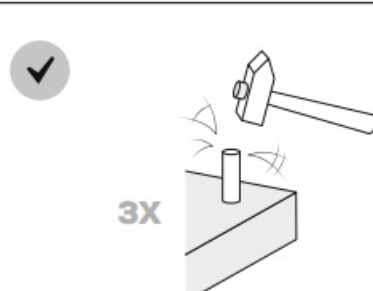
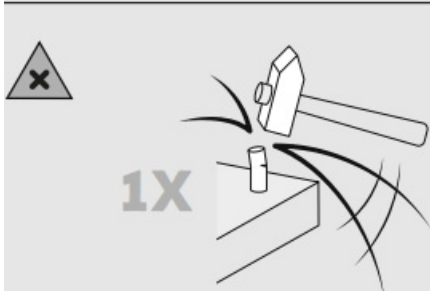
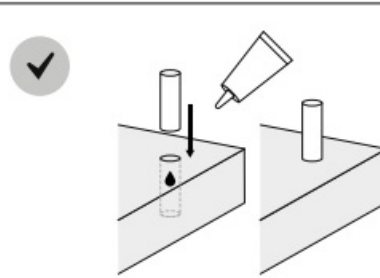
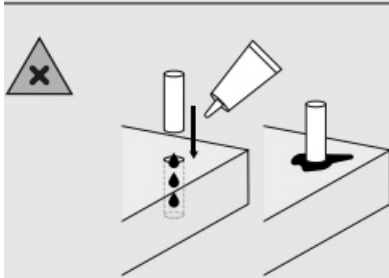
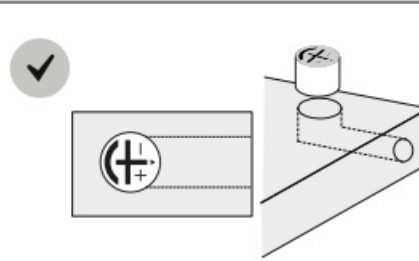
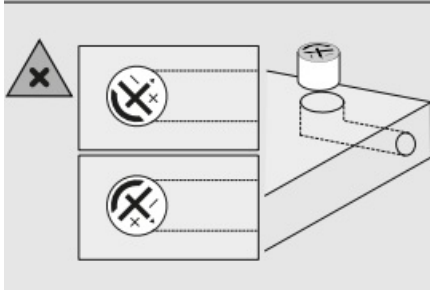
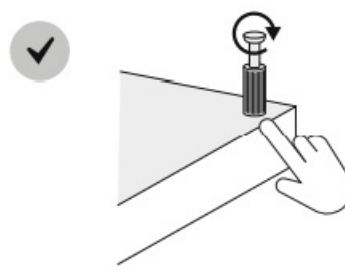
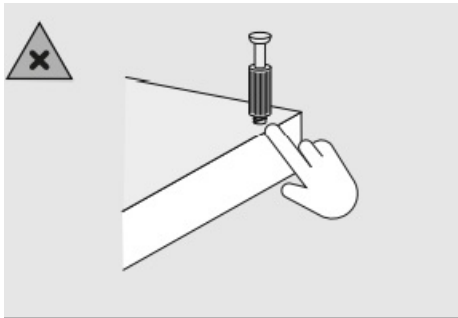

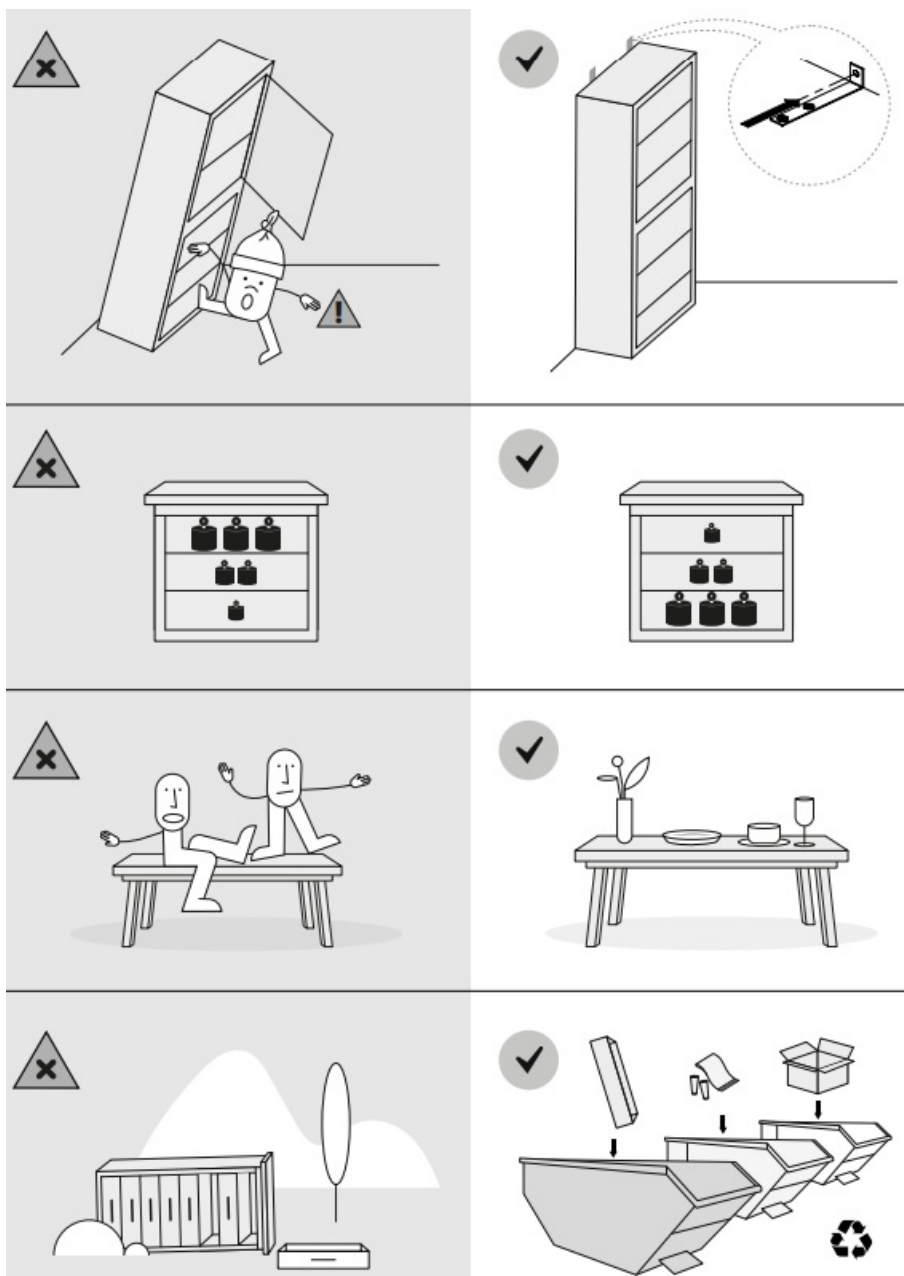

Furniture containing wood-based panels (particle board, fibreboard, plywood, etc.) may emit into indoor air considerable amounts of substances used in the production processes. The level of this emission is examined and it meets the applicable standards. After assembling the furniture, it is advised to regularly ventilate the room where the furniture stands, which should last about four weeks or until the smell is eliminated.

Service

Name INFO

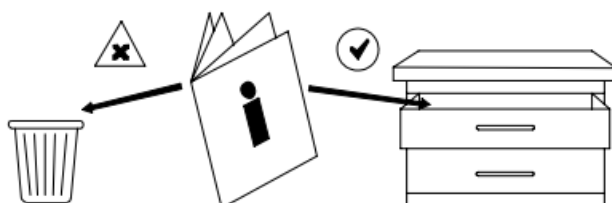

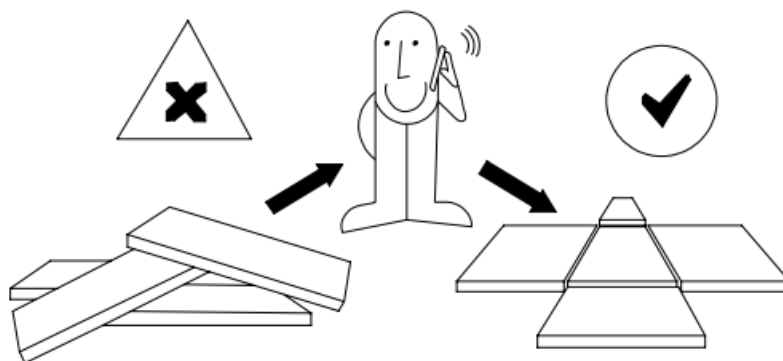

CODE	DIMENSIONS	Coli- 0001	Coli- 0002
230390	852x600x22	2	
230391	852x275x22	2	
535211	755x120x22		2
535212	755x98x22		2
535213	755x98x22		2
535214	755x120x22		2
535257	954x90x22		2
535258	606x90x22		2
535259	802x125x22		2

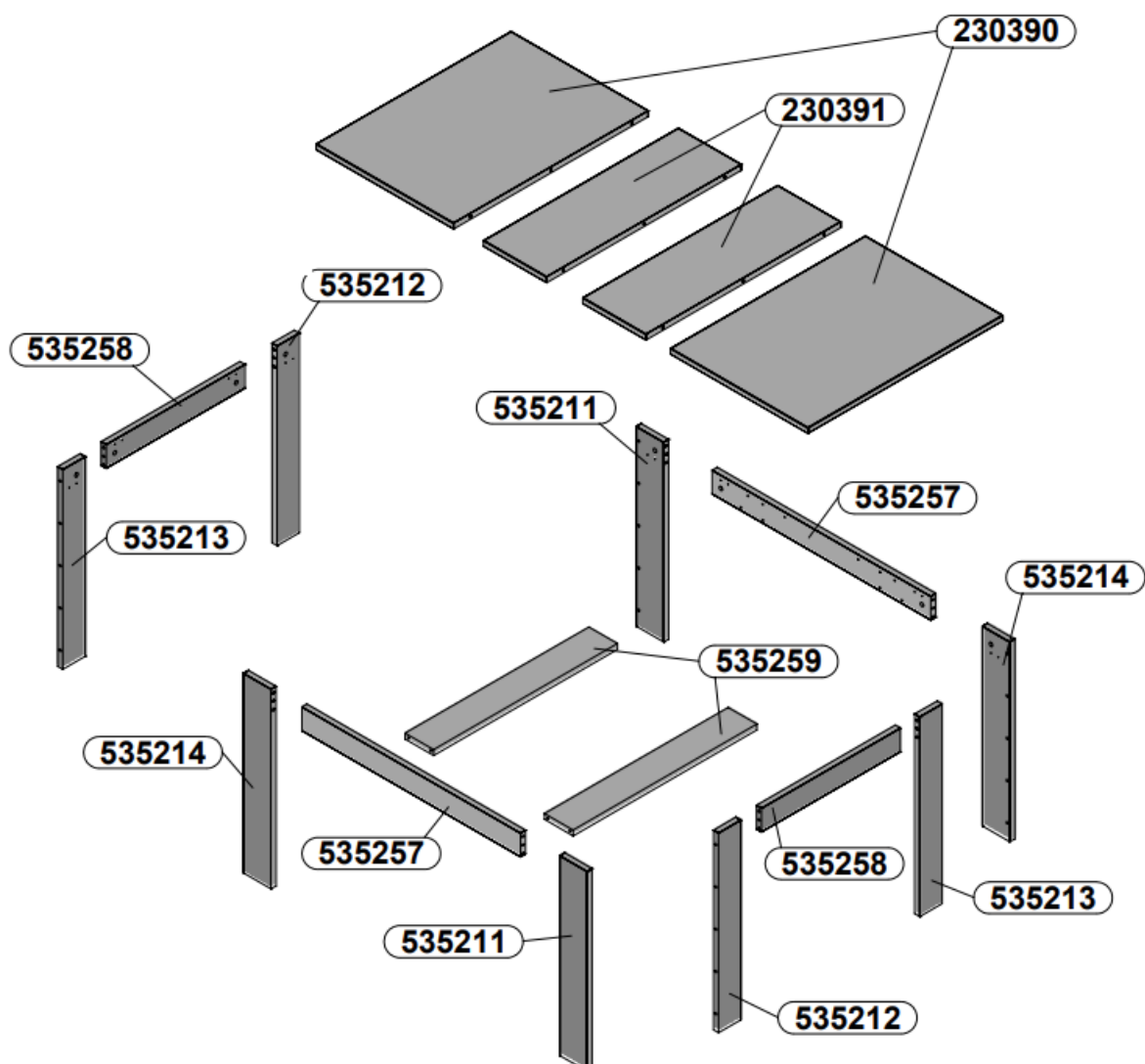

36x S70972 $\varnothing 8 \times 36$ 	8x S30211 	8x S31326 <i>L - 68</i> 	24x S30205 $\varnothing 15 \times 16$ 
76x S32604 $\varnothing 4,5 \times 16$ 	28x S30102 $\varnothing 6,3 \times 13$ 	8x S30558 	9x S37088 
9x S37089 	6x SF30440 	2x S20553-N 	
4x S34759 			
2x S39017 			

DEAR CUSTOMER

- After full assembly and set up of the furniture made of high gloss elements, you must remove the protective foil.
- In the case, where such elements are connected during assembly, then the foil must be removed partially only from the places of connection. Removal of the foil should be completed after full assembly and set up of the furniture.
- **WARNING!!!** After removal of the foil, the elements can be cleaned and used only after 72 hours.
- The cleaning must be conducted with the use of delicate and soft fabrics and if it's necessary, the fabrics may be slightly moistened with water or a cleaning agent intended for cleaning furniture.



INSTALLATION INSTRUCTION

1x2

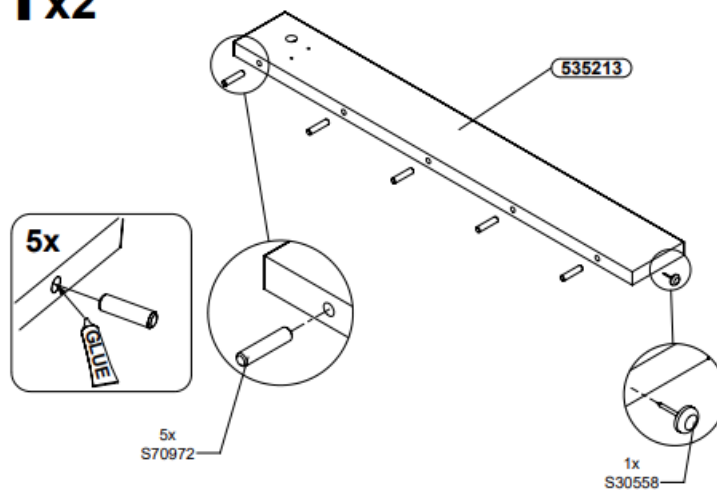

2x2

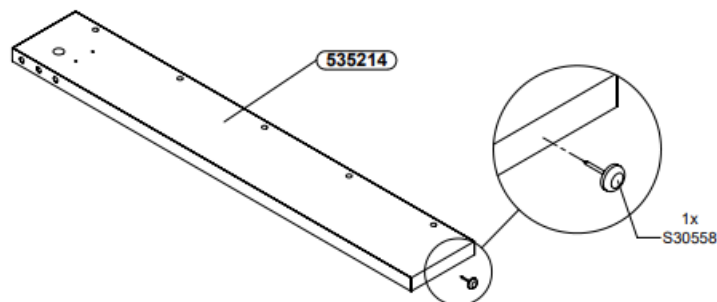

3x2

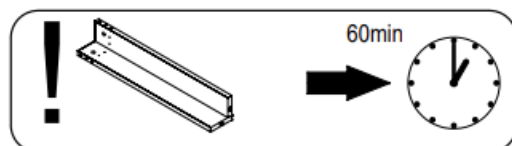
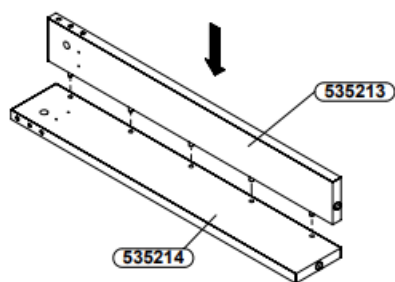
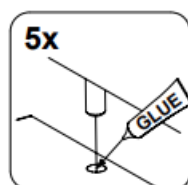

4x2

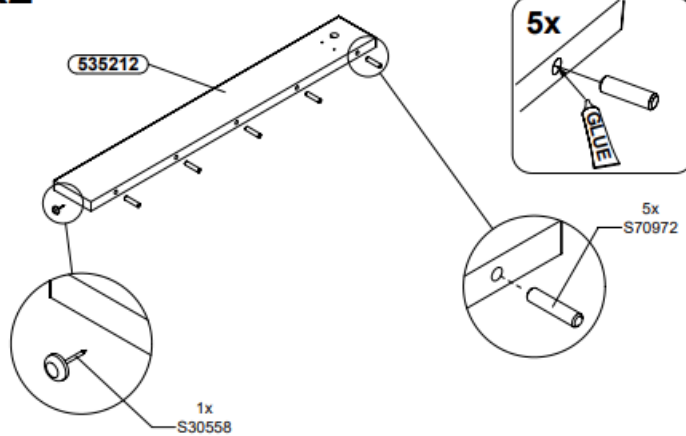

5 x2

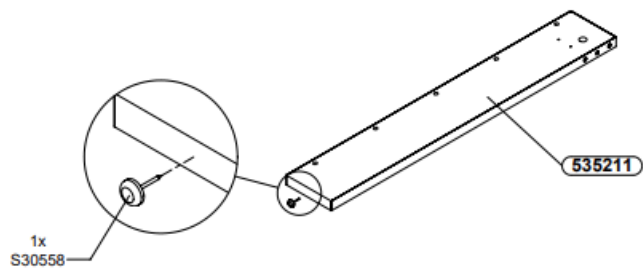

6 x2

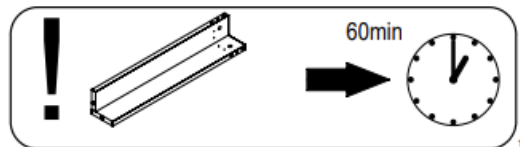
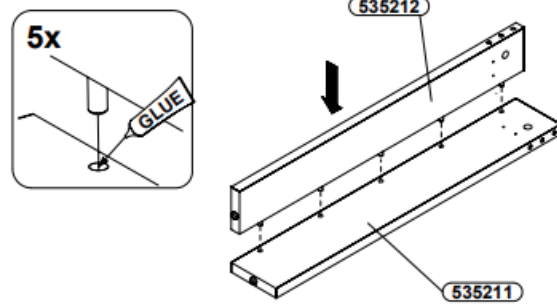

7 x2

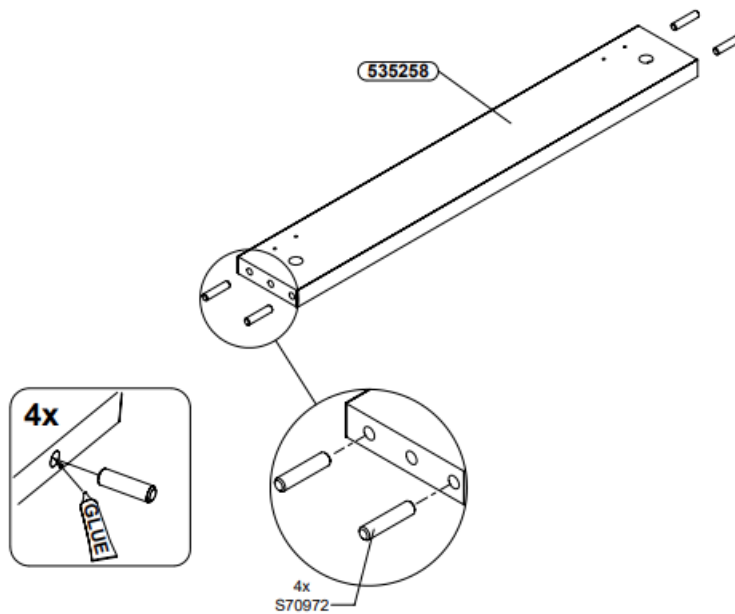

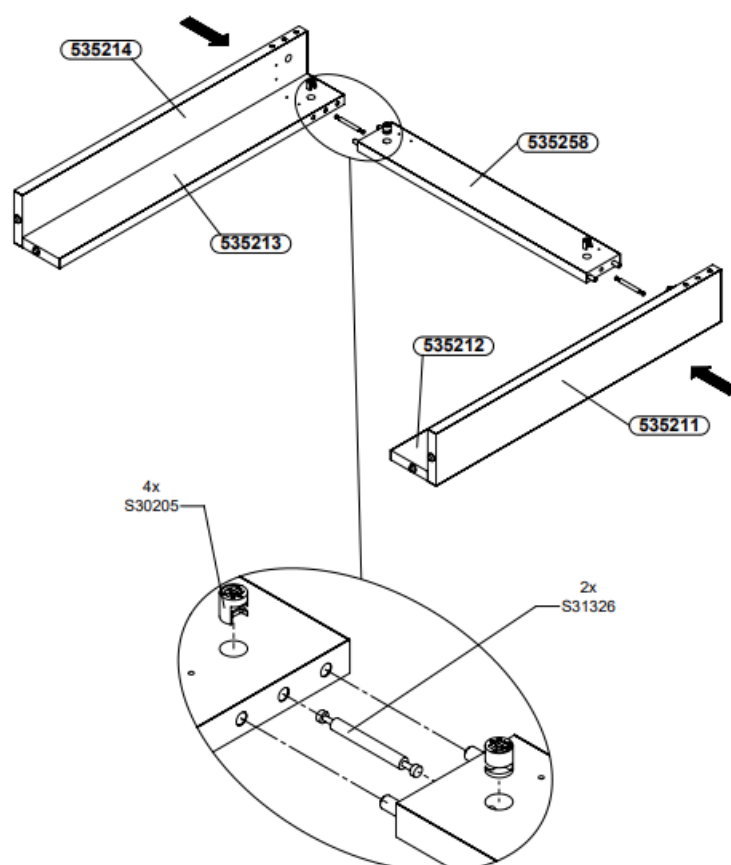
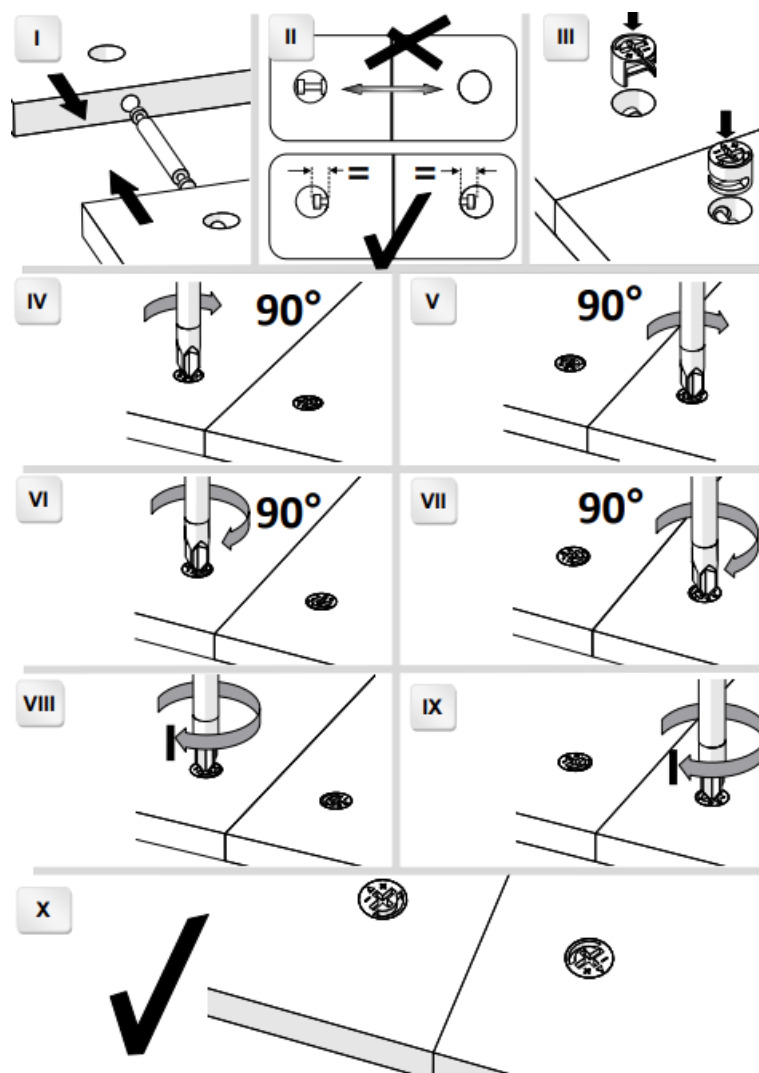

9 x2

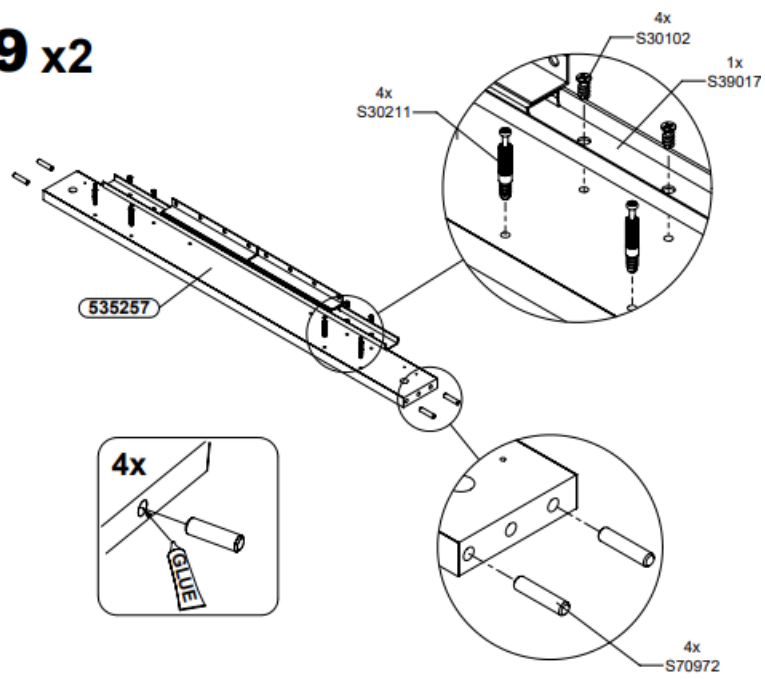

10 x2

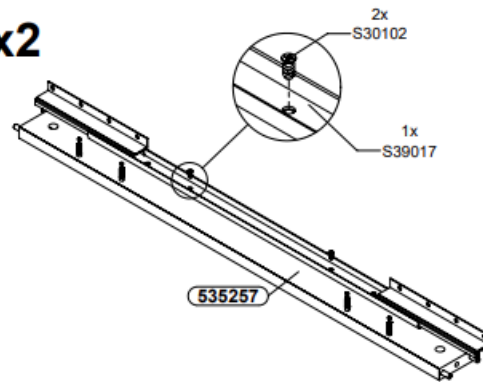

11x2

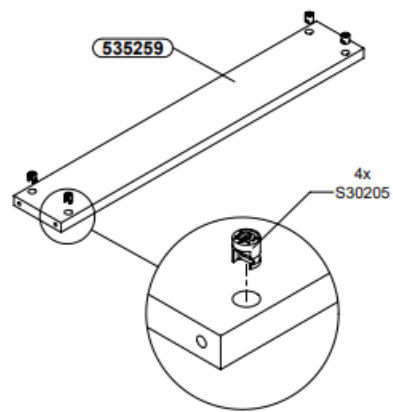

12

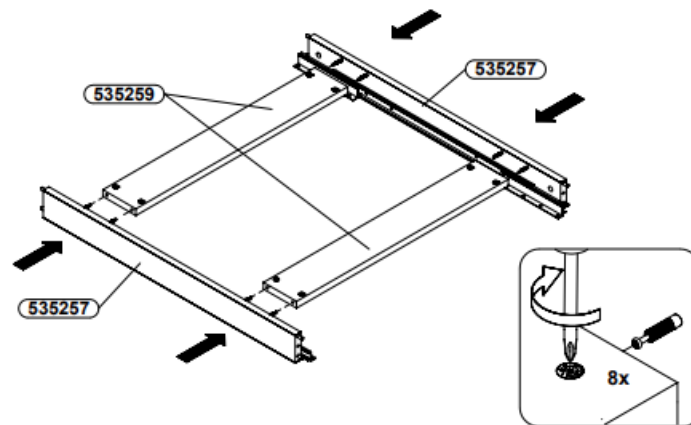

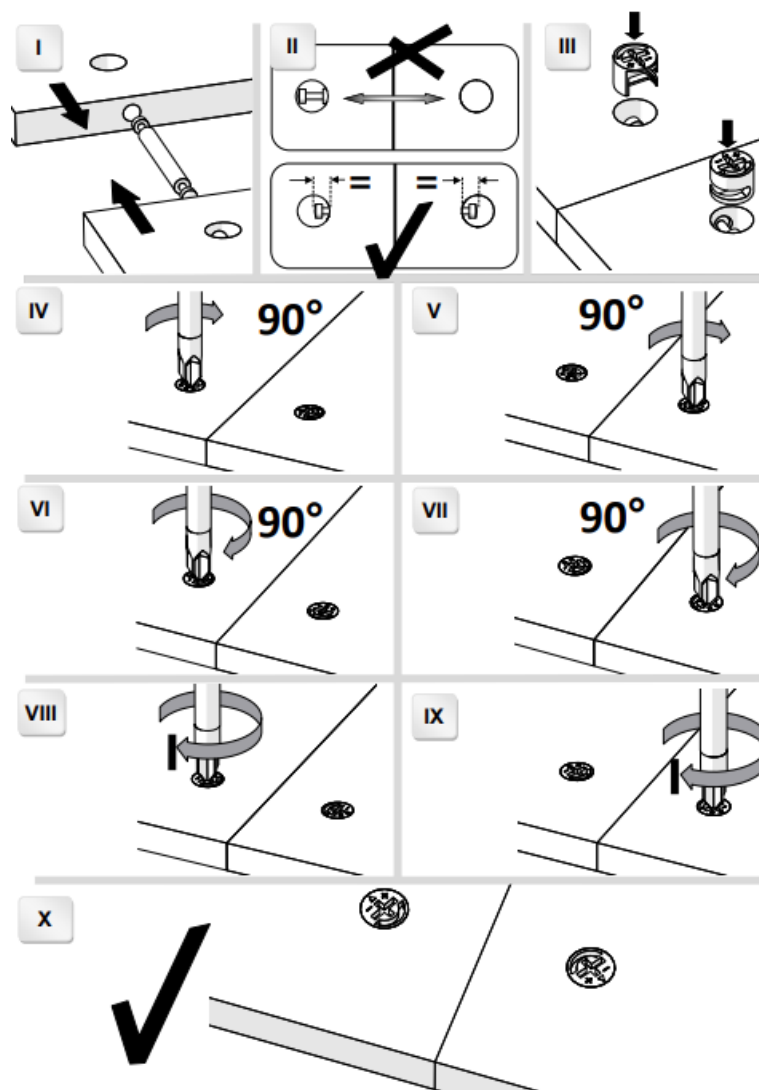

13

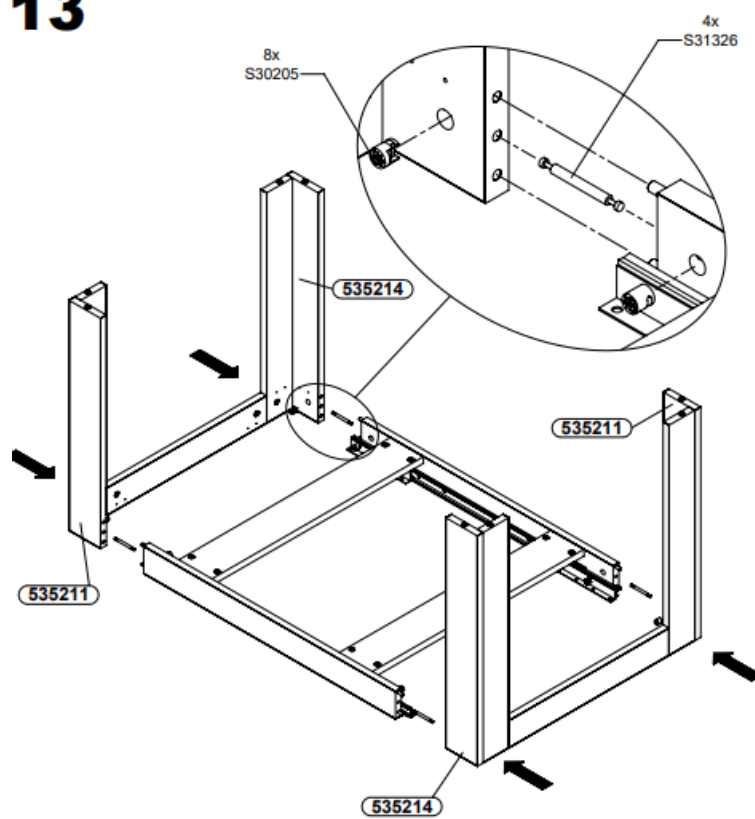

14

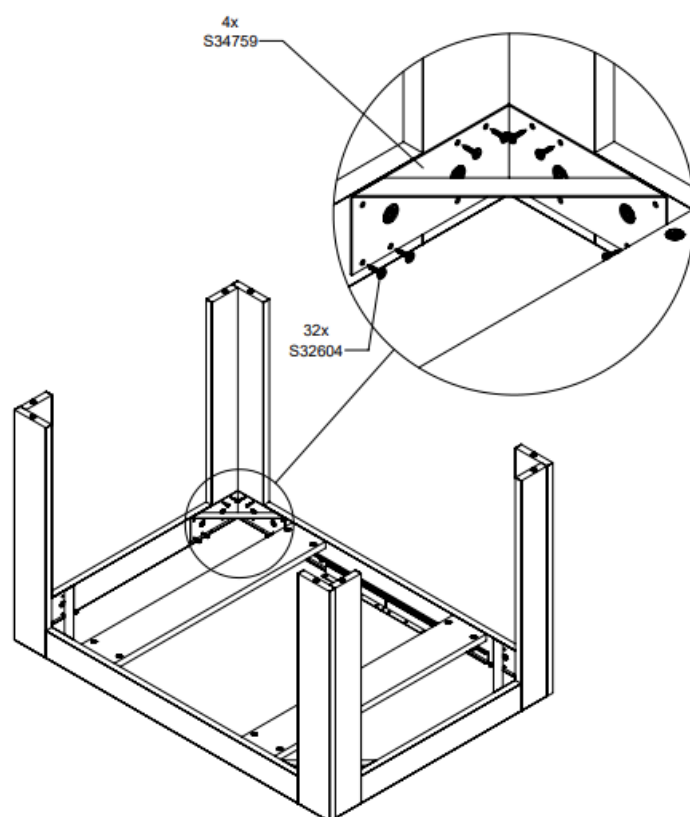

15

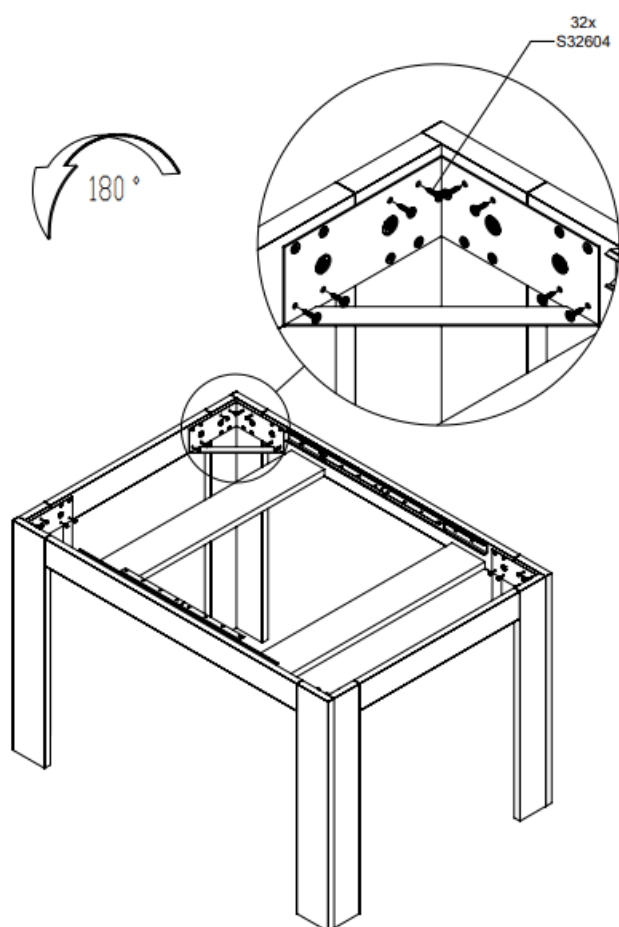

16x1

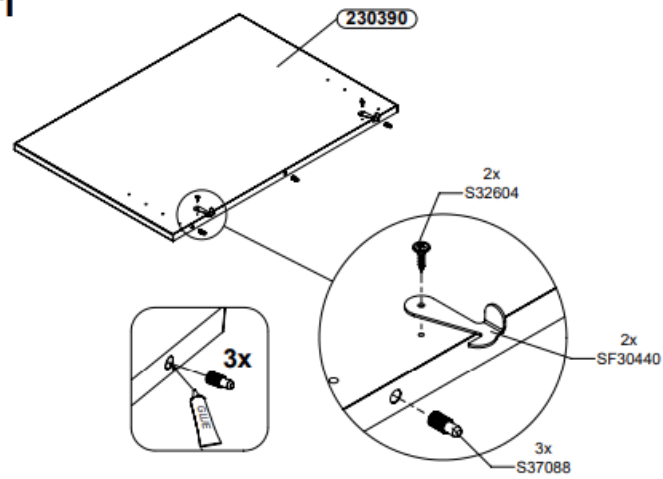

17x1

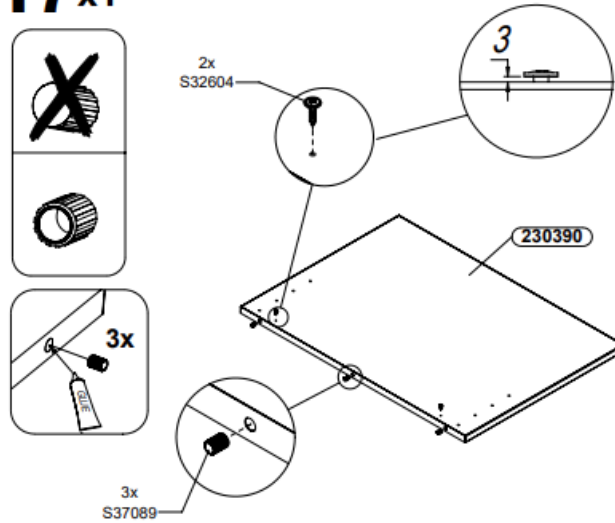

18

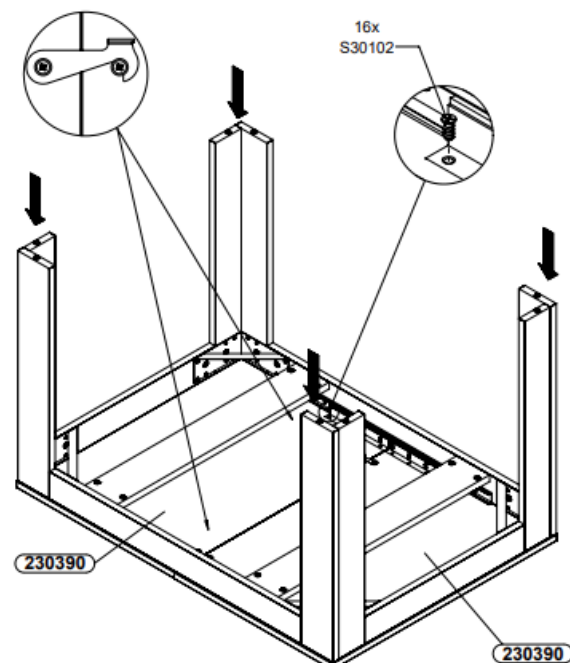

19 x2

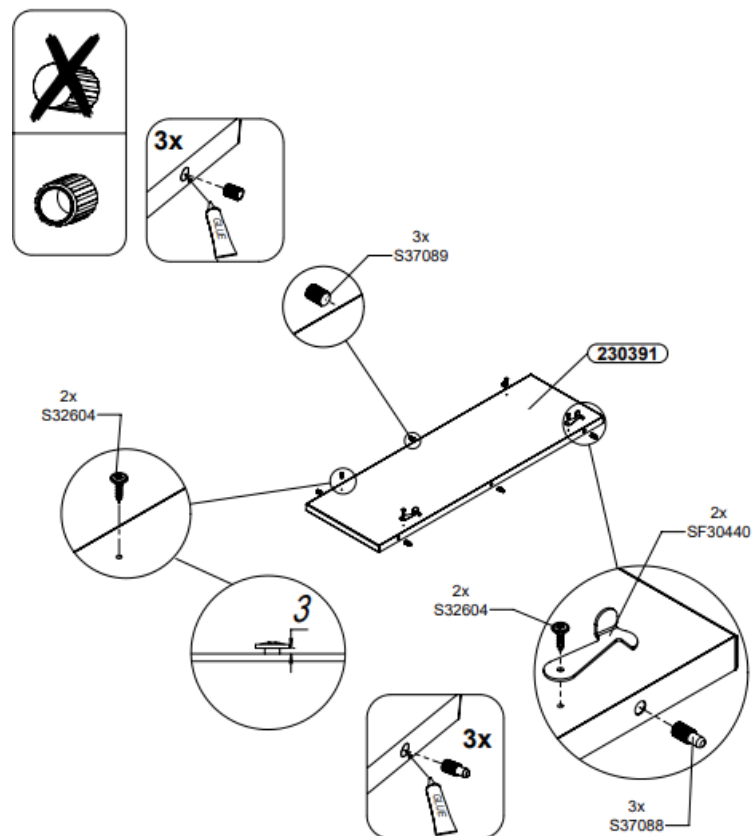

20

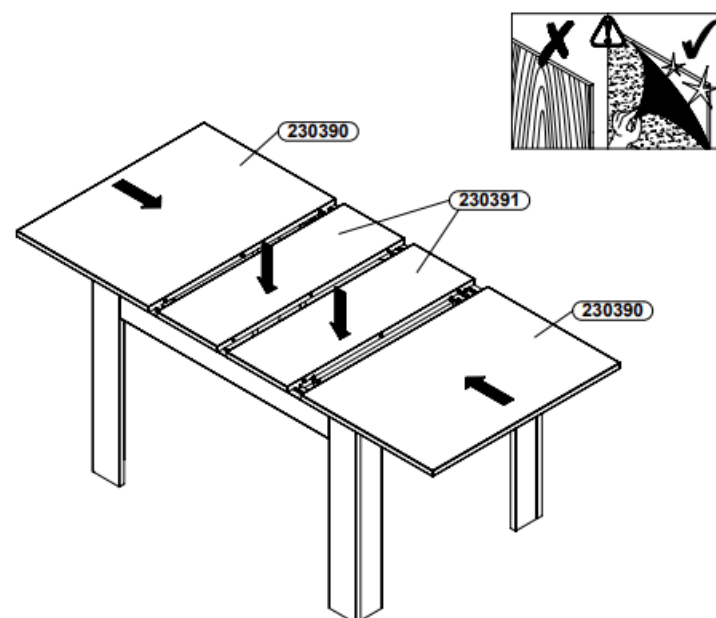

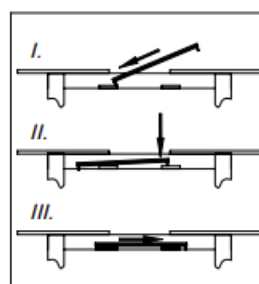
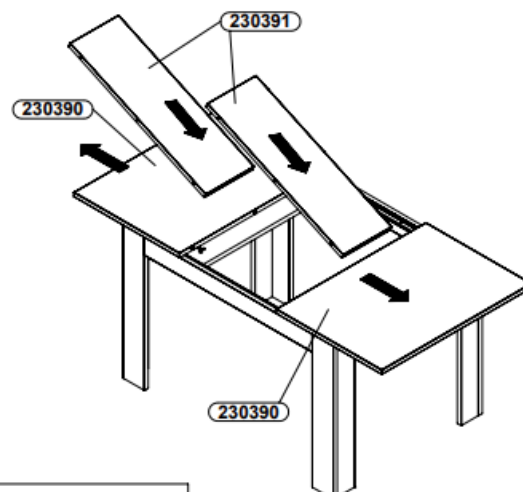
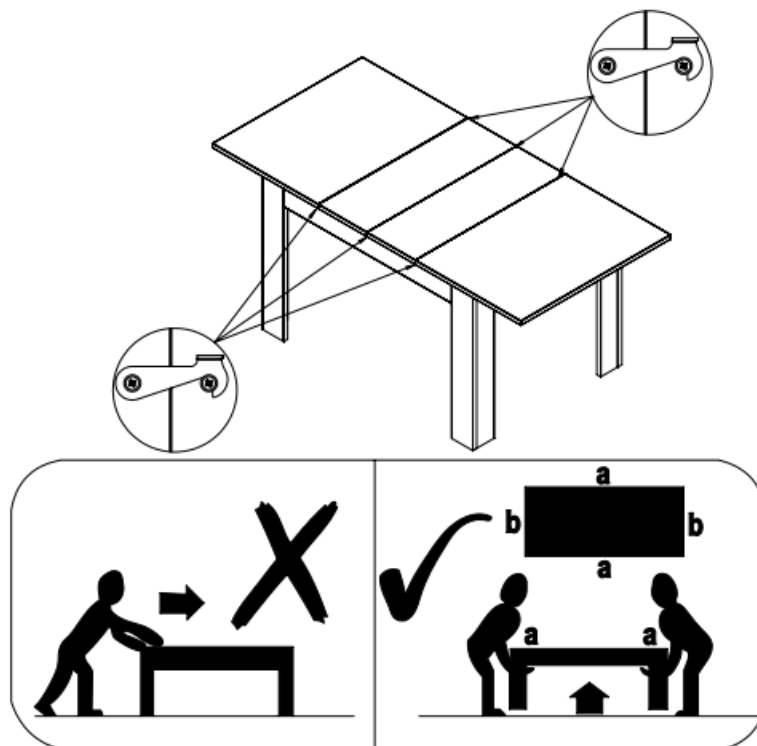

23

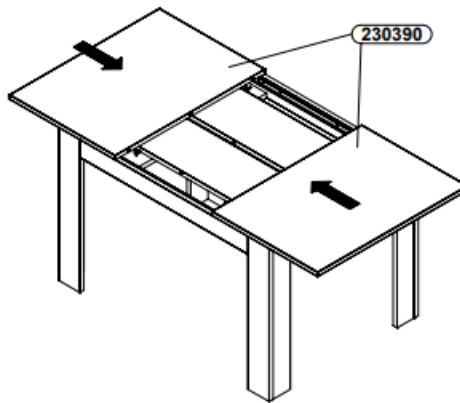

24

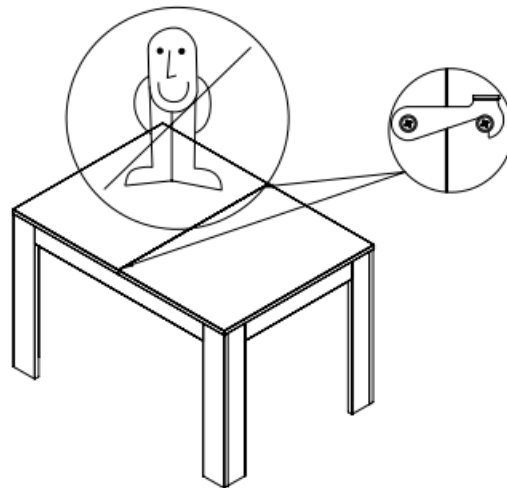

GUIDELINES FOR FURNITURE CARE

- Please follow the below-specified remarks in order to properly take care of your furniture.
- A clean dry soft fabric must be used for cleaning.
- If the furniture requires a thorough cleaning, then you can slightly moisten it with water or a cleaning agent designed for furniture cleaning, and subsequently, the cleaned elements must be wiped until they're dry.
- Metal and glass parts must be cleaned using commercially available cleaning agents designed for cleaning these types of materials, under the included instructions.
- Do not use corrosive agents, scouring agents, and other agents if their intended use is unknown.
- The cleaning agents must have clear markings that are intended for cleaning the furniture.
- **WARNING!!!** High gloss elements, from which the protective foil was removed, may be cleaned and used only after 72 hours.

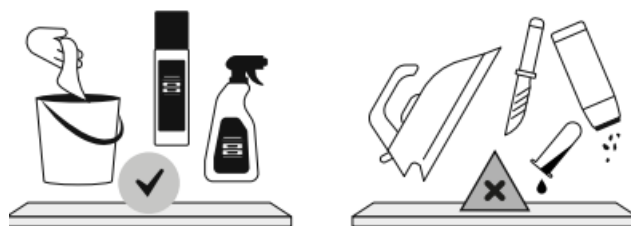

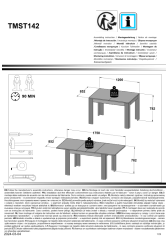
	<p>Mareda TMST142 Classic Extendable Dining Table [pdf] Instruction Manual 142, TMST142, TMST142 Classic Extendable Dining Table, TMST142, Classic Extendable Dining Table, Extendable Dining Table, Dining Table, Table</p>
--	--

References

- [User Manual](#)

Manuals+, Privacy Policy

This website is an independent publication and is neither affiliated with nor endorsed by any of the trademark owners. The "Bluetooth®" word mark and logos are registered trademarks owned by Bluetooth SIG, Inc. The "Wi-Fi®" word mark and logos are registered trademarks owned by the Wi-Fi Alliance. Any use of these marks on this website does not imply any affiliation with or endorsement.