

maono
PS22 Live
Prostudio
2x2 Live
USB Audio
Interface



maono PS22 Live Prostudio 2x2 Live USB Audio Interface User Manual

[Home](#) » [maono](#) » maono PS22 Live Prostudio 2x2 Live USB Audio Interface User Manual 

Contents

- [1 maono PS22 Live Prostudio 2x2 Live USB Audio Interface](#)
- [2 Packing List](#)
- [3 Description](#)
- [4 Features](#)
- [5 Layout](#)
- [6 Connection Guide](#)
- [7 Driver and Maono Routing Center](#)
- [8 FCC Requirement](#)
- [9 Documents / Resources](#)
 - [9.1 References](#)
- [10 Related Posts](#)



maono PS22 Live Prostudio 2x2 Live USB Audio Interface



Thank you for selecting the Maono PS22 Live Audio Interface.

To ensure an optimal user experience, we kindly request that you carefully read the provided user manual.

Packing List

- Maono PS22 Live USB Audio Interface
- USB-A to USB-C Cable
- USB-C to USB-C Cable
- User Manual

Description

The Maono ProStudio PS22 Live audio interface is the latest addition to the ProStudio series. With mic preamps offering up to 56 dB of gain range, a high-quality 24-bit/96 kHz sample rate, and a secondary USB-C with OTG streaming support, the PS22 Live delivers ultimate versatility and studio-level sound for all your audio needs.

Enhance your workflow with the Maono Routing Center Windows software, which provides flexible routing options among two analogue channels, two OTG channels, four virtual channels, and two loopback channels. This versatility allows streamers, podcasters, musicians, and content creators to maximize their creative potential. Elevate your audio production and streaming to new heights with the PS22 Live, the perfect tool for capturing exceptional sound quality in any application.

Features

- 24-bit/96 kHz sample rate
- OTG smartphone streaming
- Mic preamps with up to 56dB of gain range
- 2-in/2-out configuration
- ASIO driver
- Advanced routing software
- Four virtual channels and two loopback channels
- Direct Monitoring Switch
- Dual USB-C and bus powered

Layout

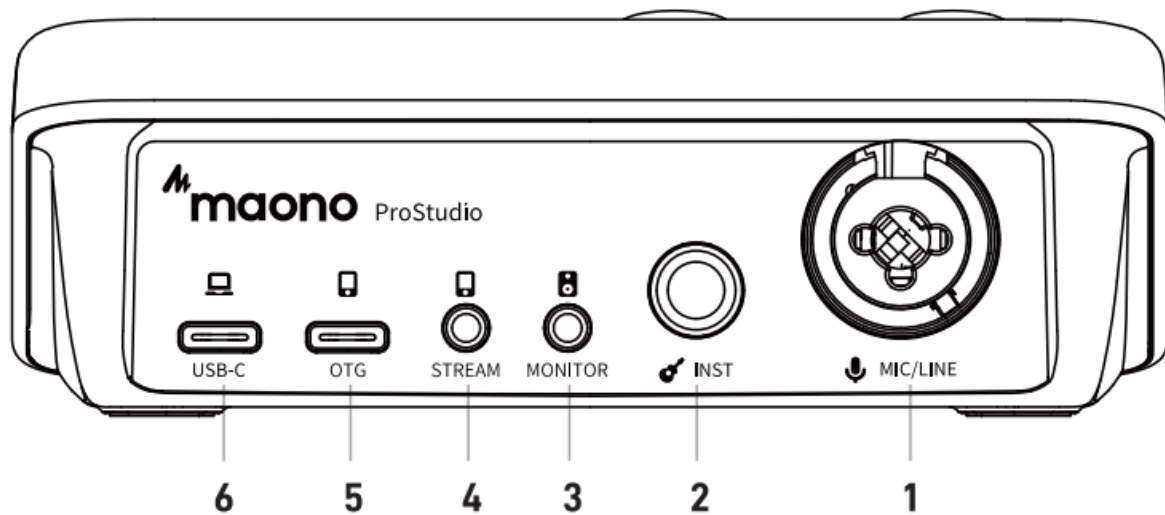

1. Mic/Line Input (MIC1) – Combo XLR socket. Connect a microphone or line-level input. It accepts both XLR and 1/4" (6.35 mm) jacks. Connect a microphone using an XLR plug; connect a line-level input using a TS or TRS 1/4" (6.35 mm) jack. To protect the circuitry, the 1/4" (6.35 mm) microphone input is not supported. Please use an XLR to XLR cable to connect your microphone.
2. Instrument Input (MIC2) – Accept Instrument level 1/4" (6.35mm) TS plug input.
3. 3.5mm Monitor Out – It can be used to connect to a powered speaker or other audio device. It requires a 3.5mm TRS to TRS cable.
4. 3.5mm TRRS Stream Out – This interface connects to a smartphone with a headphone jack for recording or streaming purposes. It requires a 3.5mm TRRS to TRRS cable.
5. OTG: USB data for mobile device – This USB-C interface connects to a smartphone or tablet using a USB-C to USB-C cable for recording or streaming. It requires your mobile device to support the standard UAC (USB Audio Class) protocol.

Note:

1. Android phones need to support the USB host (OTG) feature and have it enabled.
 2. iPhones with a Lightning connector require a Lightning to USB Camera Adapter from Apple
6. USB-C Data and Power for Computer – Supports both power and data transfer.
- If you are using an external power adapter to power the device, please use one rated at 5V  1A.
7. 3.5mm Headphone Jack – Connect your headphones or headsets with a 3.5mm TRS or TRRS plug. Please note that the microphone input of the headset is not supported. The jack is located on the right side of the device.

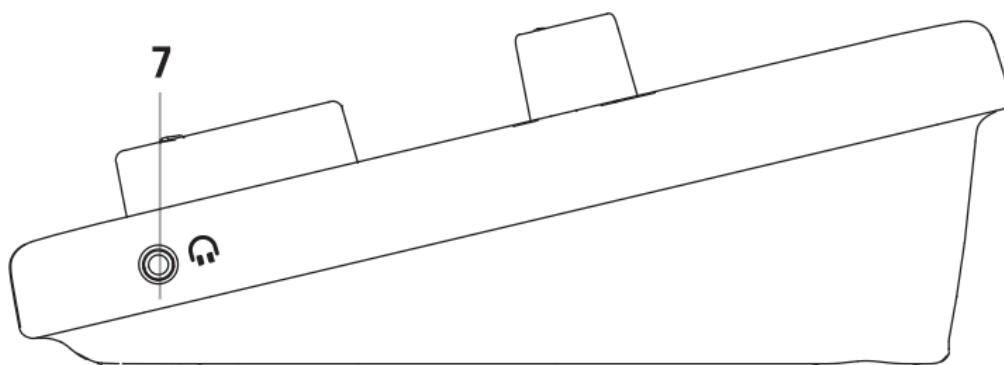

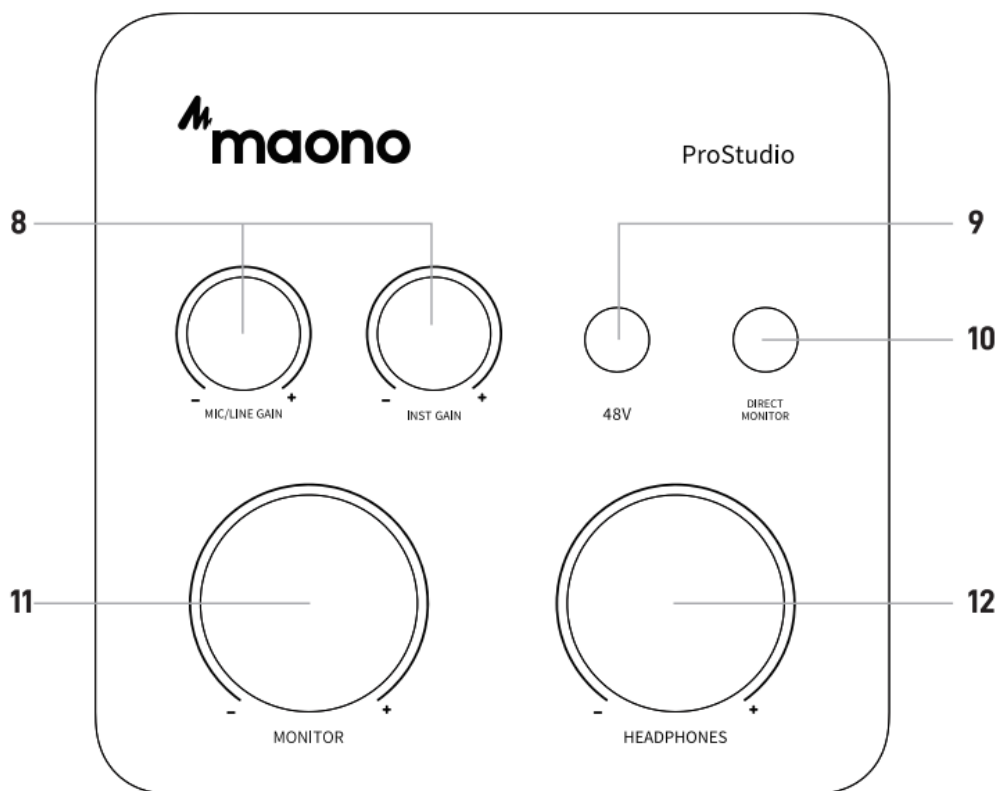

8. Mic/Line (MIC1) and Instrument (MIC2) Gain Knobs and LED Indicators – Adjust the preamp gain for Mic/Line and Instrument using the respective knobs. LED indicates status with three colors: white when input is connected, pink when the signal is close to clipping, and red for clipping. To prevent clipping, lower the gain and keep the input in the white and pink zone.
9. 48V Phantom Power Switch and LED Indicator – Press the switch to enable and disable 48V phantom power for the microphone input. The LED indicator turns white when phantom power is enabled. Please note that phantom power can only be enabled when an XLR microphone is connected. Typically, only condenser microphones require phantom power. It is important to avoid turning on phantom power when it is not needed, as it may damage your microphone. If you are unsure about the type of microphone you have, it is recommended to contact the manufacturer for confirmation.
Select Maono XLR condenser microphone models: PM320, PM350, PM500, A03Pro Select Maono XLR dynamic microphone models: PD80, PD100, PD100X, PD200X, PD300X, PD400X, HD300
10. Direct Monitor Switch and LED Indicator – Enable and disable real-time monitoring of mic and instrument input with a single button press. When enabled, the mix of microphone input and instrument input is routed to both left and right channels of the headphones and monitor output. The LED indicator turns white to indicate that the Director Monitor feature is enabled.
11. Monitor Level and LED Indicator – Adjust the level of the 3.5mm monitor output on the rear of the device using this knob. The LED indicator turns white to indicate that the PS22 Live is powered.
12. Headphone Level and LED Indicator – Use this knob to adjust the level of the headphone jack on the right side of the device.

The LED indicates device status:

- Blue: PS22 Live is powered, but no data connection detected.
- Green: USB-C data connection detected.
- Cyan: OTG data connection detected.
- White: Both USB-C and OTG data connection detected.

- Purple: Device is in Instrument Stream Mode.

Stream Mode, Studio Mode and Instrument Stream Mode The PS22 Live offers two modes for enhanced convenience in streaming and music recording applications.

By default:

- **Stream Mode:** Both the MIC1 and MIC2 inputs on the computer duplicate the hardware MIC/Line input signal. If only the MIC/Line Input (MIC1) is connected, the device automatically enters stream mode. Stream mode enhances compatibility with streaming software and mobile devices that may encounter difficulties with mono channel audio input.
- **Studio Mode:** The MIC1 on the computer maps to the hardware MIC/Line input signal, while the MIC2 on the computer maps to the hardware instrument input signals. If the Instrument Input (MIC2) is connected, the device automatically enters studio mode. Studio mode allows for separate track (stereo) recording in music applications.

Switching from Studio Mode to Instrument Stream Mode:

If you need to enter Instrument Stream Mode when an instrument is connected, simply hold the Direct Monitor button for more than 3 seconds. When enabled, the mix of hardware microphone input and hardware instrument input is routed to both MIC1 and MIC2. The LED indicator of the headphone level knob will turn purple when the device is in this mode.

Connection Guide

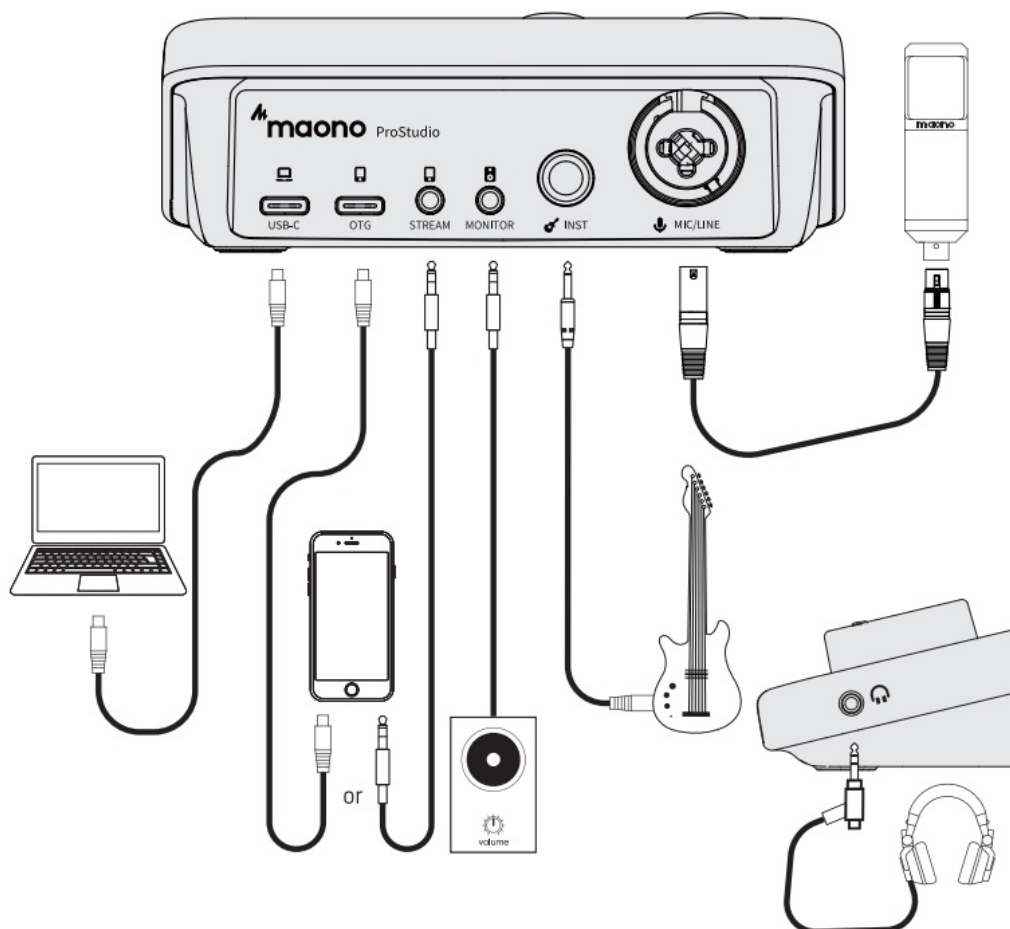

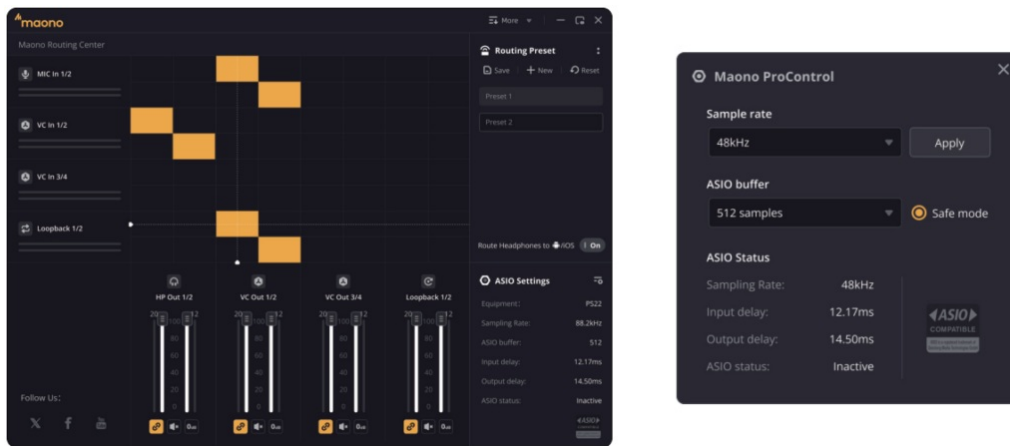

PS22 Live does not require driver installation on macOS.

For Windows OS, you will need to install ASIO low latency drivers and Maono Routing Center.

Maono Routing Center provides you advanced features like ASIO settings, software routing, and virtual channels. You will also be able to mix and route audio among analogue channels, OTG channels, virtual channels, and loopback channels.

Please download the Maono ProStudio software, driver and detailed guide from the Software sections on <https://maono.com> and install per instructions.

Setting up the device on your Operating System

macOS

After successfully connecting the device, your OS should automatically switch the default audio input and output to the PS 22 Live. To verify this, go to System Preferences > Sound and ensure that both the input and output are set to 'Maono ProStudio 2x2 Live'.

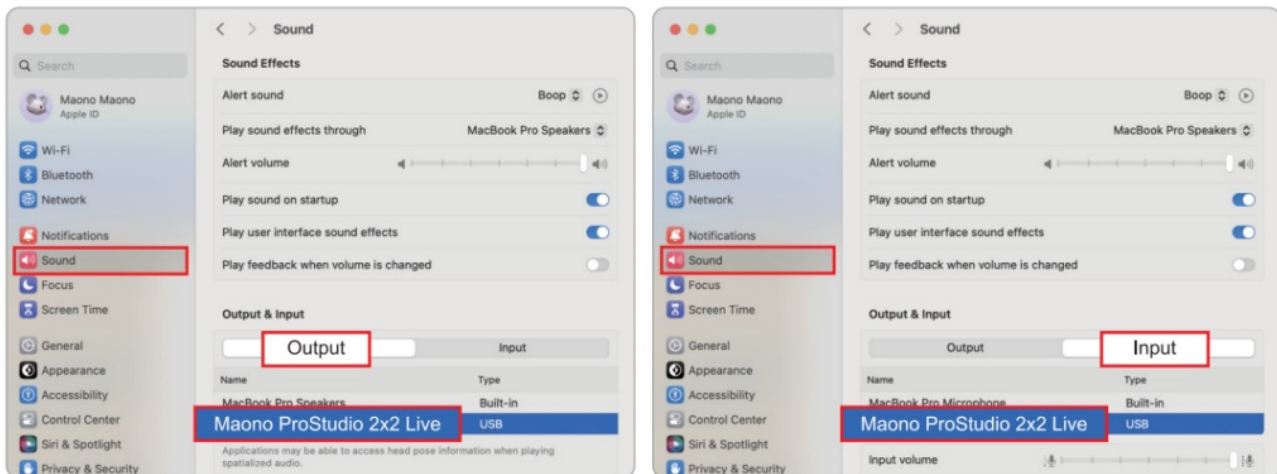

Windows with Maono Routing Center Installation

Once you have successfully installed the software and drivers and connected your device, your operating system should automatically switch default audio input and output to the PS22 Live.

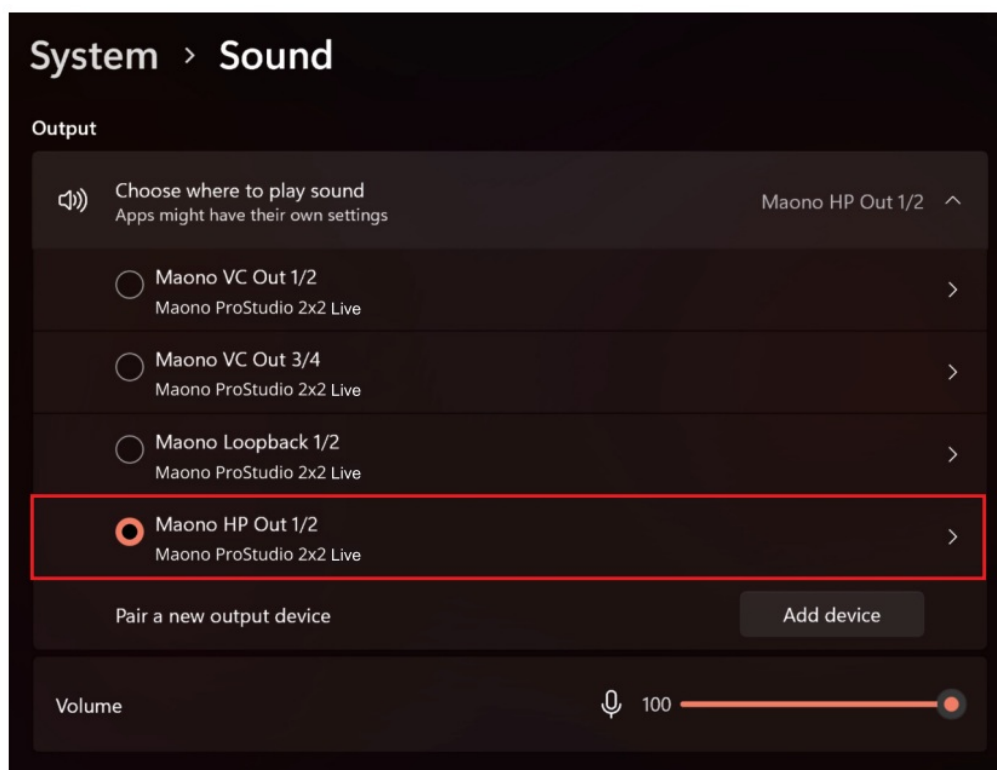
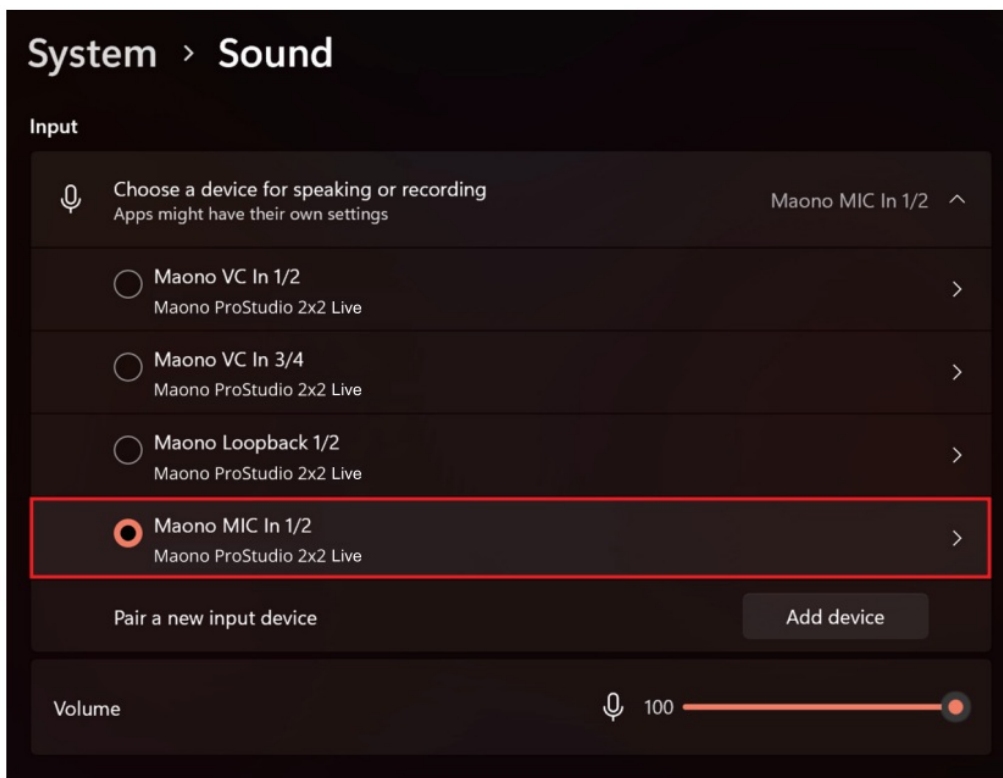

To verify this go to: Start > Settings > System > Sound and ensure the input is set to 'Maono In 1/2' and the output is set to 'Maono Out 1/2'. This menu location may vary based on the version of Windows you are using. The Maono MIC In 1/2 refers to the hardware microphone/line inputs on the device, while Maono HP 1/2 represents the hardware headphone and monitor outputs. Maono VC In 1/2, Maono VC Out 1/2, Maono VC In 3/4, Maono VC Out 3/4, and Loopback 1/2 are virtual channels. These virtual channels are not physical inputs or outputs on the device itself but are instead software-based channels that can be configured using the Maono Routing Center software. For more detailed information on how to use and configure these virtual channels, you can refer to the digital user guide that comes with the Maono Routing Center software.

FCC Requirement

Any changes or modifications not expressly approved by the party responsible for compliance could void the user's authority to operate the equipment. This device complies with Part 15 of the FCC Rules. Operation is subject to the following two conditions:

1. this device may not cause harmful interference, and
2. this device must accept any interference received, including interference that may cause undesired operation.

Note: This equipment has been tested and found to comply with the limits for a Class B digital device, pursuant to Part 15 of the FCC Rules. These limits are designed to provide reasonable protection against harmful interference in a residential installation.

This equipment generates, uses, and can radiate radio frequency energy, and if not installed and used in accordance with the instructions, may cause harmful interference to radio communications. However, there is no guarantee that interference will not occur in a particular installation. If this equipment does cause harmful interference to radio or television reception, which can be determined by turning the equipment off and on, the user is encouraged to try to correct the interference by one or more of the following measures:

- Reorient or relocate the receiving antenna.
- Increase the separation between the equipment and receiver.
- Connect the equipment into an outlet on a circuit different from that to which the receiver is connected.
- Consult the dealer or an experienced radio/TV technician for help.

The device has been evaluated to meet general RF exposure requirement. The device can be used in portable exposure condition without restriction.

IC Caution:

This device complies with Industry Canada licence-exempt RSS standard(s).

Operation is subject to the following two conditions:

1. This device may not cause interference, and
2. This device must accept any interference, including interference that may cause undesired operation of the device.

The device has been evaluated to meet general RF exposure requirement. The device can be used in portable exposure condition without restriction.

Global Best Selling
Internet Microphone

Maonol manov], meaning "vision" in Kiswahili, is the Global Best Selling Internet Microphone Brand that products are sold well in 153 countries worldwide. With the beautiful vision of becoming a global leading brand of Internet audio products that deliver a pleasant sound experience, Maono is always working with audio professionals, influencers, and users, to make the world's best microphones and audio products.



Technical Support:

support@maono.com

www.maono.com



Final clause:

Information and data contained in this manual are subject to change without notice in advance.



Company: Zhou's Jade Star UG
Address: Brunnenallee 11A 14478 Potsdam
Tell: +49 179 7962788
E-mail: jadestar.eu@gmail.com



Company: CET PRODUCT SERVICE LTD.
Address: Chase Business Centre, 39-41
Chase Side, London N14 5BP United Kingdom
Email: info.cetservice@gmail.com
TEL: +447419325266

We frequently update product firmware to improve user experiences and performance.
The status display and operations may be slightly different among different firmware versions.
For latest user manuals, please access on <https://www.maono.com>.

Documents / Resources

	maono PS22 Live Prostudio 2x2 Live USB Audio Interface [pdf] User Manual PS22 Live Prostudio 2x2 Live USB Audio Interface, PS22 Live, Prostudio 2x2 Live USB Audio Interface, Live USB Audio Interface, USB Audio Interface, Audio Interface, Interface
--	--

References

- [User Manual](#)

[Manuals+](#), [Privacy Policy](#)

This website is an independent publication and is neither affiliated with nor endorsed by any of the trademark owners. The "Bluetooth®" word mark and logos are registered trademarks owned by Bluetooth SIG, Inc. The "Wi-Fi®" word mark and logos are registered trademarks owned by the Wi-Fi Alliance. Any use of these marks on this website does not imply any affiliation with or endorsement.