



ManoMano Modern LED Ceiling Lamp With Variable Intensity Installation Guide

[Home](#) » [ManoMano](#) » ManoMano Modern LED Ceiling Lamp With Variable Intensity Installation Guide 

Contents

- [1 ManoMano Modern LED Ceiling Lamp With Variable Intensity](#)
- [2 Product Usage Instructions](#)
- [3 Explanation of symbols](#)
- [4 WARRANTY PROVISIONS](#)
- [5 TOOLS](#)
- [6 ASSEMBLY](#)
- [7 Documents / Resources](#)
 - [7.1 References](#)
- [8 Related Posts](#)



ManoMano Modern LED Ceiling Lamp With Variable Intensity



Product Specifications:

- Brand: EcoLighting
- Model: XYZ123
- Power: 20W
- Color Temperature: 5000K
- Lumens: 1800lm

Product Usage Instructions

Installation:

Follow these steps to install the EcoLighting product:

1. Refer to the installation video available at <https://goecolighting.fr/> for detailed guidance.
2. Ensure the power source is switched off before starting the installation process.
3. Mount the product securely using the provided mounting hardware.
4. Connect the appropriate wires following the color-coding or instructions provided.
5. Once installed, turn on the power and test the product to ensure it functions correctly.

Operation:

To operate the EcoLighting product:

1. Use the designated switch or control mechanism to turn the product on/off.
2. Adjust the direction of the light if applicable to suit your needs.
3. Maintain the product by cleaning it regularly to ensure optimal performance.

FAQ (Frequently Asked Questions):

- **Q: How do I change the light bulb in the EcoLighting product?**

A: To change the light bulb, follow these steps:

1. Turn off the power source and allow the product to cool down.
2. Remove any covers or casings to access the bulb.
3. Unscrew the old bulb and replace it with a new one of the same type and wattage.
4. Securely reassemble the product and test the new bulb.

- **Q: Can I use dimmer switches with this product?**

A: It is recommended to check the product specifications or contact customer support to verify compatibility with dimmer switches, as not all products support dimming functionality.

Plafonnier LED

Important

If you have questions about installation, visit the website <https://goecolighting.fr/> for an installation video.

To fully enjoy your new lamps and to maximize its efficiency, please read and store all installation, care and safety instructions and any other attached information brochures detailing special product features.









IMPORTANT! Always shut off power to the circuit before starting installation work. In some countries electrical installation work may only be carried out by a authorized electrical contractor. Contact your local electricity authority for advice. Different materials require different types of fittings. Always choose screws and plugs that are specially suited to the material.

WARNING! The light source of this luminaire is not replaceable; when the light source reaches its end of life the whole luminaire shall be replaced. Safety directions/Please read this information carefully before installing or using this product. Please keep this user manual for further reference.

1. The lamps may only be installed by authorized and qualified technicians according to the valid regulations for electrical installation.
2. The manufacturer does not accept any responsibility for injuries or damage resulting from improper use of the light.
3. Maintenance of the lights is limited to the surfaces. When doing this, no moisture must come in to contact with any areas of the terminal connections or mains voltage control parts. Use the light only in dry areas. Do not use it for professional purposes.
4. Warning! Before drilling the mounting holes, make sure that no gas, water or electricity pipes and wires can be drilled through or damaged in your chosen mounting location.
5. When mounting the wall or ceiling fixture, ensure that the attachment material is suitable for the subsurface and that this surface is capable of carrying the weight of the fixture. The manufacturer is not liable for improper installation of the item on the relevant subsurface.
6. If you give the light to someone else, also hand over this instruction sheet and all attached documents.
7. Before first use, check that the illuminant is firmly seated in its socket, check that all safety and decorative panels are in perfect condition, and make sure that they are correctly held in place.
8. If silicon sleeves are provided for the light, these must be placed over the mains connection wires to protect against heat.
9. Do not install the light on a damp or conductive subsurface.
10. Protective covers and end covers for mains voltage control parts must always be mounted.
11. Please make sure that no cables get damaged during the installation work.

12. Attention! During operation, lamp parts and illuminants can reach temperatures of more than 60°C. Do not touch during operation!
13. Do not look directly into the light source (illuminant, LED, etc)
14. In order to prevent hazards, a damaged exterior flexible cable belonging to this light should be replaced only by the manufacturer, his service center, or a comparable specialist. Keep the light out of the reach of children.

Explanation of symbols

-  The crossed-out wheeled bin symbol indicates that the item should be disposed of separately from household waste. The item should be handed in for recycling in accordance with local environmental regulations for waste disposal. By separating a marked item from household waste, you will help reduce the volume of waste sent to incinerators or land-fill and minimize any potential negative impact on human health and the environment.
-  The product complies with the currently valid European directives. Voluntary declaration by distributors and manufacturers that the products are in conformity with the laws and directives of the EU. 4
-  Caution: danger of an electric shock
-  This light must be connected to the earthed conductor-terminal with the earthed conductor (green-yellow wire)
-  The Green Dot is a license symbol used on packaging in some European markets which shows that a fee has been paid to fund the recycling of that packaging when it becomes waste. IP20
-  The lights have a protection class rating of "IP20" and are solely intended for use in interior areas of private households.
-  Should install the luminaire indoor.
- The manufacturer/ dealer hereby shows that the product complies with the German packaging guidelines. The manufacturer/ dealer hereby shows that the product complies with the France packaging guidelines.
-  The recycling code shows what material the packaging is made of and thus defines the recycling cycle into which it is returned. In this case "20" – corrugated board.

WARRANTY PROVISIONS

In addition to the statutory warranty, We grants a warranty pursuant to the following provisions to you for specific products as well. Your statutory rights in particular regarding guarantee and consumer protection are not limited by this in any manner.

1. Products for which a warranty is granted are marked with the corresponding print on the packaging.

2. The warranty period is one year. The warranty periods shall commence on the date of purchase of the product by the first end customer. Please keep the purchasing voucher as evidence.
3. The warranty shall apply to any products purchased by the end customer in the territory of the European Union or UK.
4. In case of defects due to material and / or manufacturing errors, free removal of defects shall be provided if they are asserted during the warranty period.
5. In case of warranty, please contact the us through the channel you purchased the product from. Visit website <https://aoecoliahtina.fr/> also could more help..
5. In case of warranty, please contact the us through the channel you purchased the product from. Visit website <https://goecolighting.fr/> also could more help.
6. Warranty claims shall be excluded at minor deviations from the target properties that are not relevant for the product's value and suitability for use, as well as in case of defects caused by abusive or improper treatment, environmental influences (moisture, heat, overvoltage, dust, current or mains fluctuations, oxidised surfaces/flash rust polished away specifically in coastal regions, etc.) and in case of damage to breakable components (e.g. glass) or consumables (e.g. batteries).

TOOLS

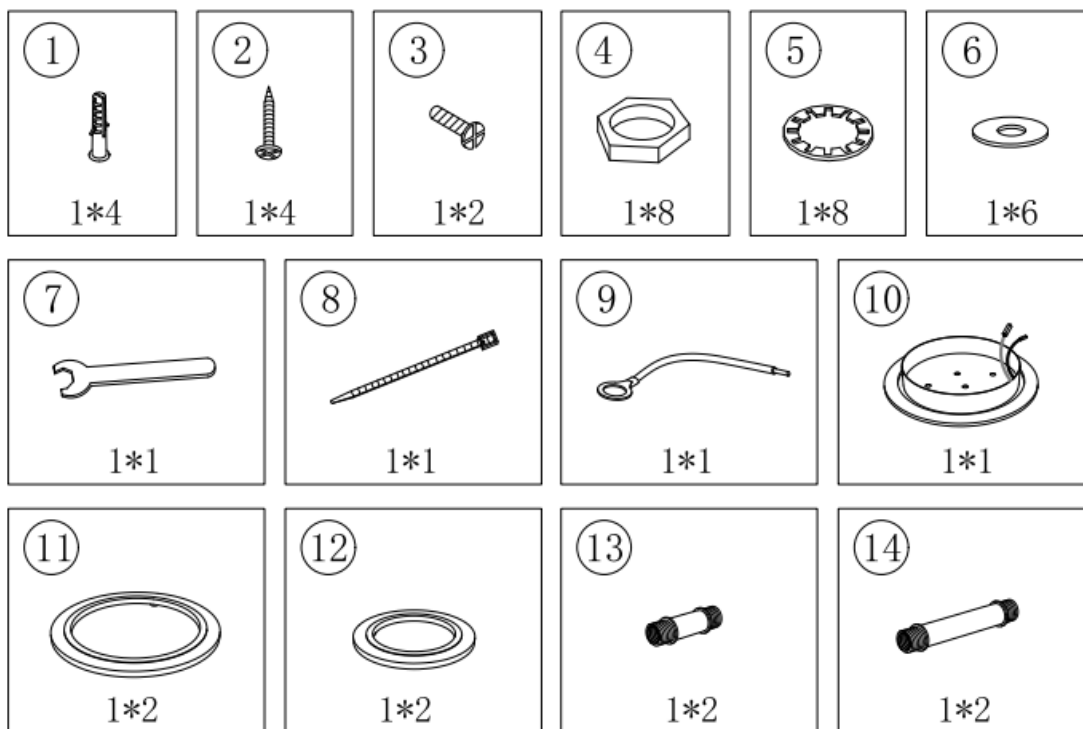

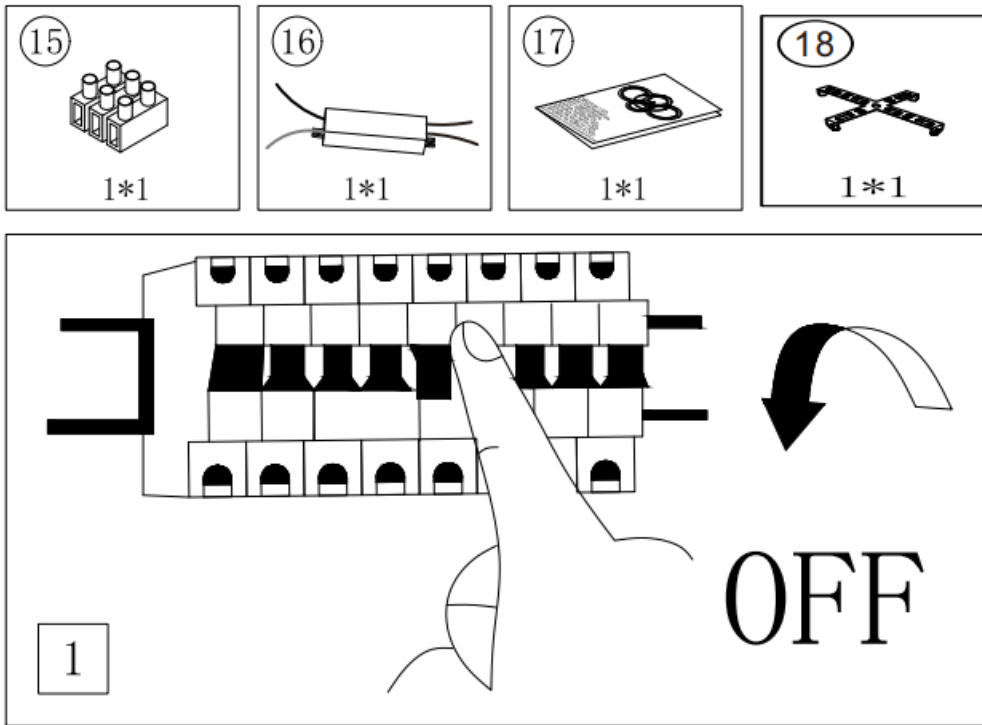

ASSEMBLY

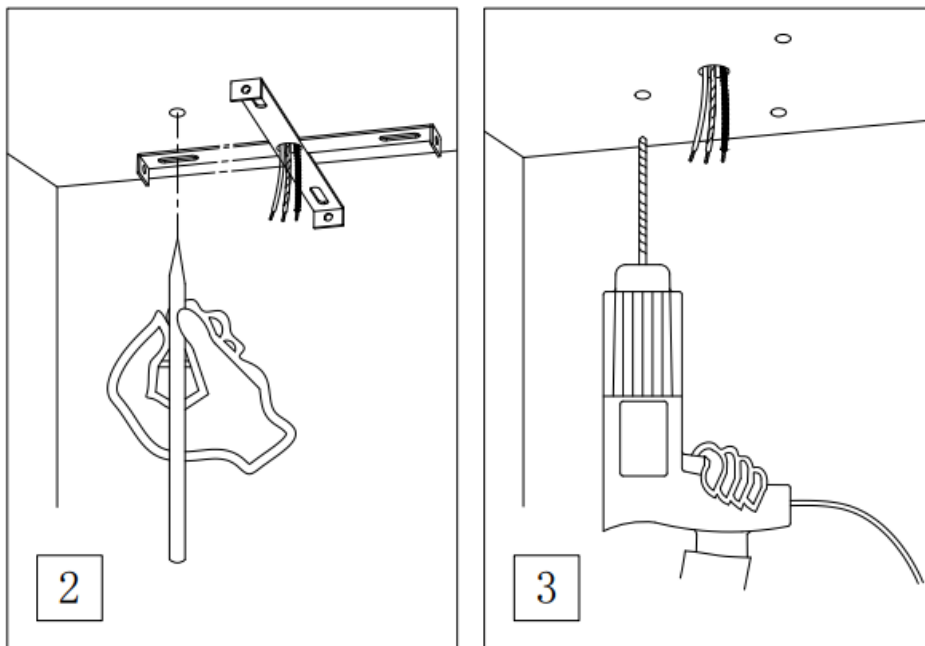

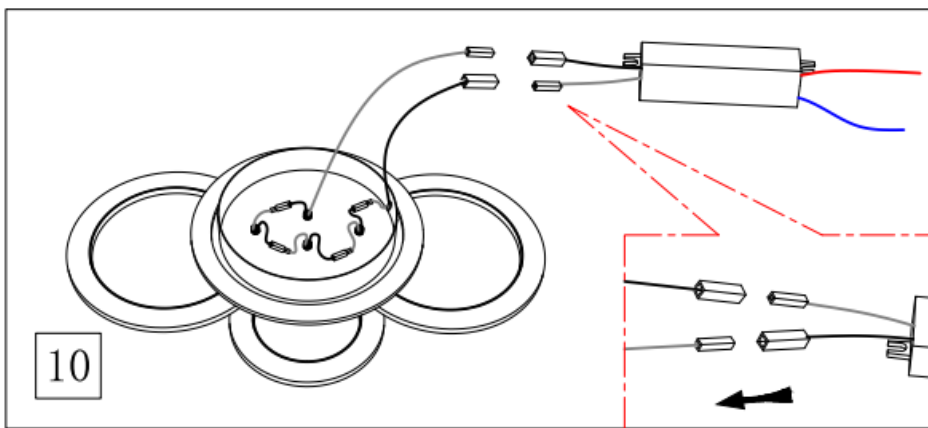
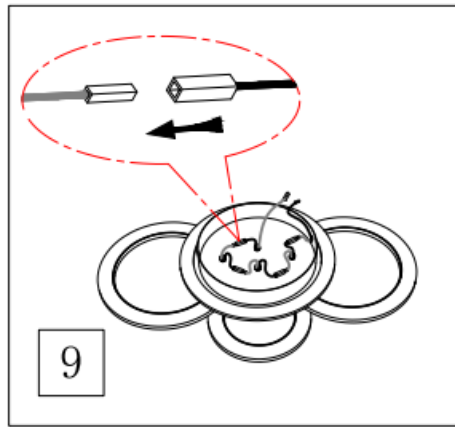
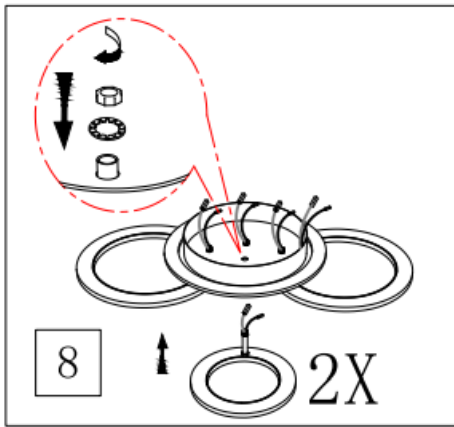
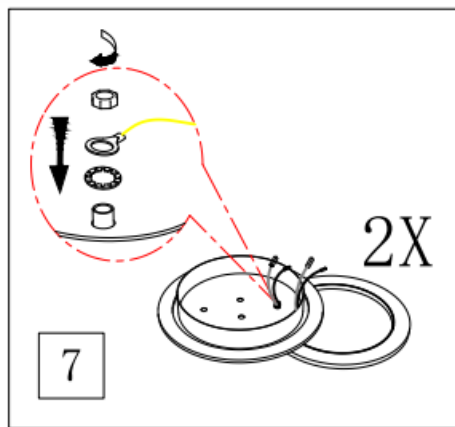
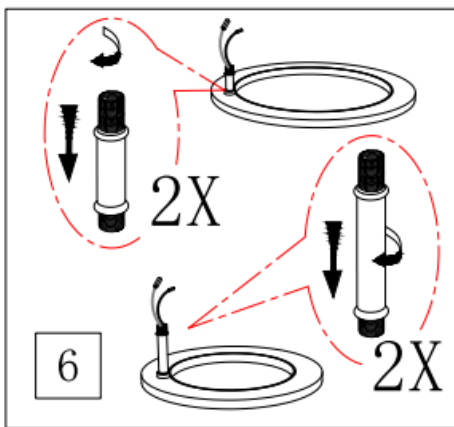
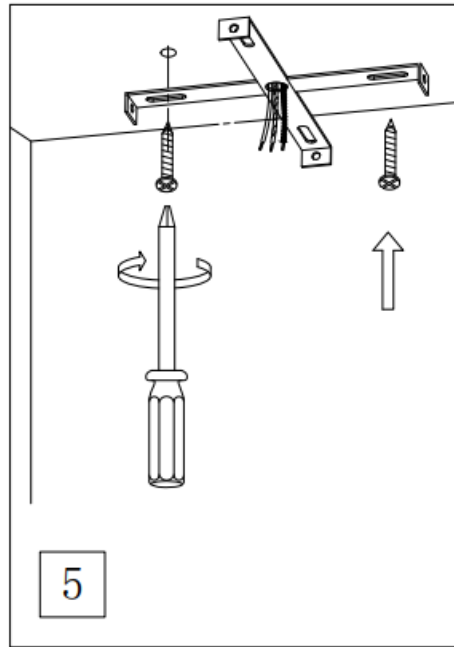
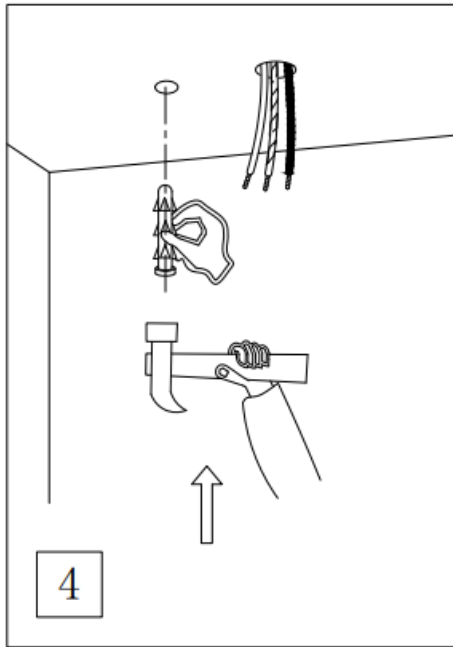

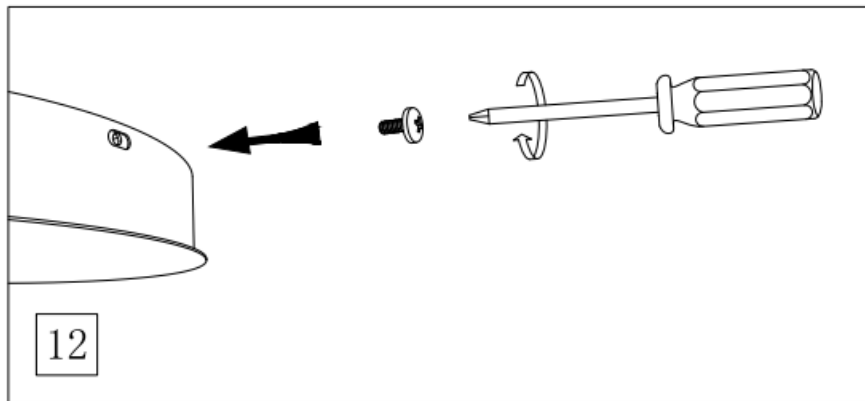
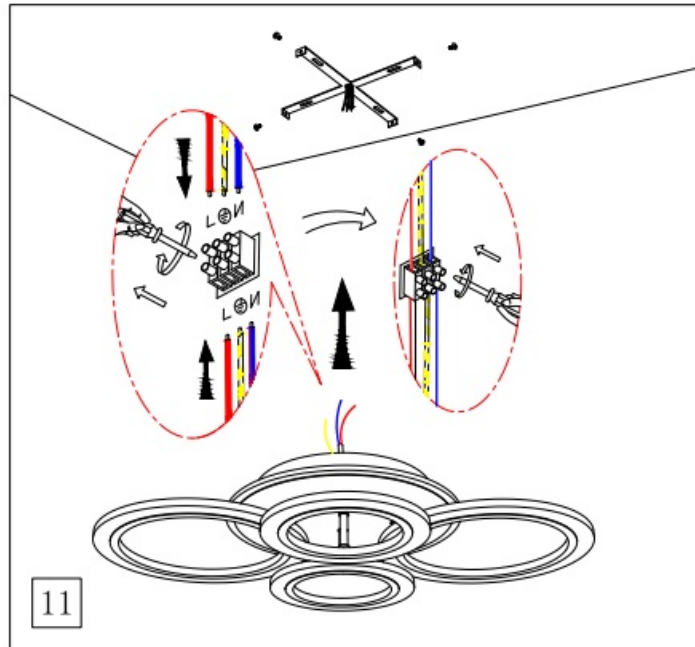

Documents / Resources

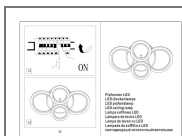

[ManoMano Modern LED Ceiling Lamp With Variable Intensity](#) [pdf] Installation Guide
 Modern LED Ceiling Lamp With Variable Intensity, Modern, LED Ceiling Lamp With Variable Intensity, Lamp With Variable Intensity, Variable Intensity, Intensity

References

- [GOECOLIGHTING - Luminaires d'intérieur haut de gamme en France – goecolighting](#)
- [User Manual](#)

[Manuals+.](#) [Privacy Policy](#)

This website is an independent publication and is neither affiliated with nor endorsed by any of the trademark owners. The "Bluetooth®" word mark and logos are registered trademarks owned by Bluetooth SIG, Inc. The "Wi-Fi®" word mark and logos are registered trademarks owned by the Wi-Fi Alliance. Any use of these marks on this website does not imply any affiliation with or endorsement.