



Manhattan 161435 2600 Series Speaker System Instructions Manual

[Home](#) » [Manhattan](#) » Manhattan 161435 2600 Series Speaker System Instructions Manual 

Contents

- [1 Manhattan 161435 2600 Series Speaker System](#)
- [2 Instructions](#)
- [3 Regulatory Statement](#)
- [4 FAQs](#)



Manhattan 161435 2600 Series Speaker System



Instructions

Important: Read before use.

1. Plug the 3.5 mm stereo plug into the output of the audio source, and plug the USB cable into an active USB

port.

2. Increase the volume on the audio source to 100%. Use the speaker's in-line volume control to adjust the volume to the desired level.

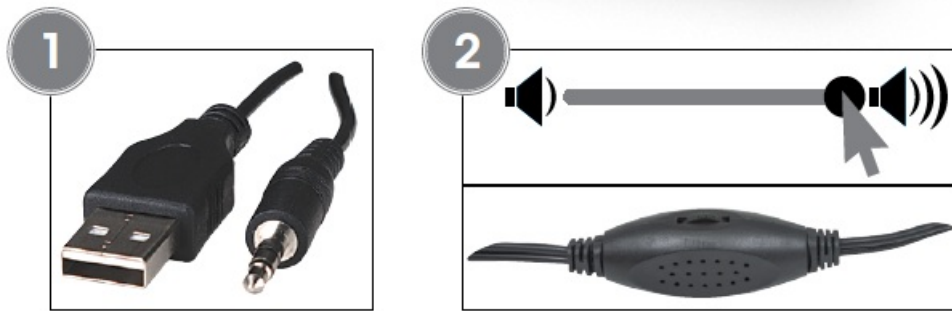

For specifications, go to manhattanproducts.com.

For additional benefits:

Scan to register your product warranty or go to: register.manhattanproducts.com/r/161435

Waste Electrical & Electronic Equipment

Disposal of Electric and Electronic Equipment (applicable in the E.U. and other countries with separate collection systems)

This symbol on the product or its packaging means that this product must not be treated as unsorted household waste. In accordance with EU Directive 2012/19/EU on Waste Electrical and Electronic Equipment (WEEE), this electrical product must be disposed of in accordance with the user's local regulations for electrical or electronic waste. Please dispose of this product by returning it to your local point of sale or recycling pickup point in your municipality.

Regulatory Statement

This equipment has been tested and found to comply with the limits for a Class B digital device, pursuant to Part 15 of Federal Communications Commission (FCC) Rules. These limits are designed to provide reasonable protection against harmful interference in a residential installation. This equipment generates, uses, and can radiate radio frequency energy, and if not installed and used in accordance with the instructions may cause harmful interference to radio communications. However, there is no guarantee that interference will not occur in a particular installation. If this equipment does cause harmful interference to radio or television reception, which can be determined by turning the equipment off and on, the user is encouraged to try to correct the interference by one or more of the following measures:

- reorient or relocate the receiving antenna;
- increase the separation between the equipment and the receiver;
- connect the equipment to an outlet on a circuit different from the receiver;
- or consult the dealer or an experienced radio/TV technician for help.

This device complies with the requirements of CE 2014/30/EU and/or 2014/35/EU. The Declaration of Conformity is available at: support.manhattanproducts.com/barcode/161435

North & South America

IC Intracom Americas
550 Commerce Blvd. Oldsmar, FL 34677 USA

Asia & Africa

IC Intracom Asia
4-F, No. 77, Sec. 1, Xintai 5th Rd.
Xizhi Dist., New Taipei City 221, Taiwan Europe

IC Intracom Europe

Löhbacher Str. 7 D-58553 Halver, Germany

FAQs

What is the Manhattan 161435 2600 Series Speaker System?

The Manhattan 161435 2600 Series Speaker System is a high-quality speaker system designed for immersive audio experiences.

What are the key features of this speaker system?

The speaker system features powerful sound output, multiple connectivity options, and a sleek design.

How many speakers are included in the package?

The package includes two speakers, designed to provide stereo sound.

Is the Manhattan 161435 2600 Series Speaker System compatible with different devices?

Yes, it is compatible with a wide range of devices such as computers, laptops, smartphones, and tablets.

What is the power output of these speakers?

These speakers offer a maximum power output of 20 watts for clear and dynamic audio.

Do they have built-in volume control?

Yes, the speakers have built-in volume control for easy adjustment.

Can I mount these speakers on the wall?

Yes, these speakers come with mounting options for wall installation, providing flexibility in placement.

Is there a warranty for the Manhattan 161435 2600 Series Speaker System?

Warranty coverage may vary, so please check the warranty details provided by the manufacturer or retailer at the time of purchase.

What should I do if I encounter technical issues?

If you experience technical issues, refer to the troubleshooting section in the user manual or contact Manhattan customer support for assistance.

Can I connect these speakers wirelessly?

Some models within the 2600 Series may offer wireless connectivity options, so check the product specifications for details.

Is there a user manual available for these speakers?

Yes, you can find the user manual for these speakers on the official Manhattan website or through authorized Manhattan dealers.

Where can I purchase the Manhattan 161435 2600 Series Speaker System?

You can purchase the Manhattan 161435 2600 Series Speaker System through authorized retailers, electronics stores, or online marketplaces.

Download This PDF Link: [Manhattan 161435 2600 Series Speaker System Instructions Manual](#)