



MAKIE 2AD4XMICX EleMent Wave Microphone Systems User Guide

[Home](#) » [MAKIE](#) » MAKIE 2AD4XMICX EleMent Wave Microphone Systems User Guide 

MAKIE 2AD4XMICX EleMent Wave Microphone Systems User Guide



Contents

- 1 IMPORTANT SAFETY INSTRUCTIONS –
- 2 Hookup Diagrams
- 3 EleMent Wave Front, Rear & Side Panels
- 4 FRONT, REAR & SIDE PANEL DESCRIPTIONS
- 5 GETTING STARTED
- 6 TECHNICAL SPECIFICATIONS
- 7 WARRANTY AND SUPPORT
- 8 Documents / Resources
 - 8.1 References
- 9 Related Posts

IMPORTANT SAFETY INSTRUCTIONS –

1. Read, follow, and keep these instructions. Heed all warnings.
2. Do not expose to extreme cold or heat.
3. Do not expose to rain, use it in water, or in damp or wet conditions.
4. Do not expose to any excessive dust and other foreign particles.
5. Keep clean by washing outside with a dry cloth.
6. Keep in the case when not in use.
7. Never attempt to disassemble.
8. Mackie cannot be held responsible for any damage caused by improper use or modifications.
9. This device complies with Part 15 of the FCC Rules [and contains license-exempt transmitter(s)/ receiver(s) that comply with Innovation, Science and Economic Development Canada's licenseexempt RSS(s)]. Operation is subject to the following two conditions:
 1. this device may not cause harmful interference, and
 2. this device must accept any interference received, including interference that may cause undesired operation.
10. **NOTE:** This equipment has been tested and found to comply with the limits for a Class B digital device, pursuant to part 15 of the FCC Rules. These limits are designed to provide reasonable protection against harmful interference in a residential installation. This equipment generates, uses, and can radiate radio frequency energy and, if not installed and used in accordance with the instructions, may cause harmful interference to radio communications.

WARNING — The battery (battery or batteries or battery pack) shall not be exposed to excessive heat such as sunshine, fire or the like.

CAUTION — Danger of explosion if battery is incorrectly replaced. Replace only with the same or equivalent

type.  High sound pressure. Hearing damage risk. Do not listen at high volume levels for long periods. However, there is no guarantee that interference will not occur in a particular installation. If this equipment does cause harmful interference to radio or television reception, which can be determined by turning the equipment off and on, the user is encouraged to try to correct the interference by one or more of the following measures:

- Reorient or relocate the receiving antenna.
- Increase the separation between the equipment and the receiver.
- Connect the equipment into an outlet on a circuit different from that to which the receiver is connected.

- Consult the dealer or an experienced radio/TV technician for help.

Duration, per day in hours	Sound Level
8	90 dB
6	92 dB
4	95 dB
3	97 dB
2	100 dB
1.5	102 dB
1	105 dB
0.5	110 dB
0.25 or less	115 dB

CAUTION: Changes or modifications to this device not expressly approved by LOUD Audio, LLC. could void the user's authority to operate the equipment under FCC rules.

11. Exposure to extremely high noise levels may cause permanent hearing loss. Individuals vary considerably in susceptibility to noise-induced hearing loss, but nearly everyone will lose some hearing if exposed to sufficiently intense noise for a period of time. The U.S. Government's Occupational Safety and Health Administration (OSHA) has specified the permissible noise level exposures shown in the chart. According to OSHA, any exposure in excess of these permissible limits could result in some hearing loss:



Correct disposal of this product: This symbol indicates that this product should not be disposed of with your household waste, according to the WEEE directive (2012/19/EU) and your national law. This product should be handed over to an authorized collection site for recycling waste electrical and electronic equipment (EEE). Improper handling of this type of waste could have a possible negative impact on the environment and human health due to potentially hazardous substances that are generally associated with EEE. At the same time, your cooperation in the correct disposal of this product will contribute to the effective usage of natural resources. For more information about where you can drop off your waste equipment for recycling, please contact your local city office, waste authority, or your household waste disposal service.

Hookup Diagrams

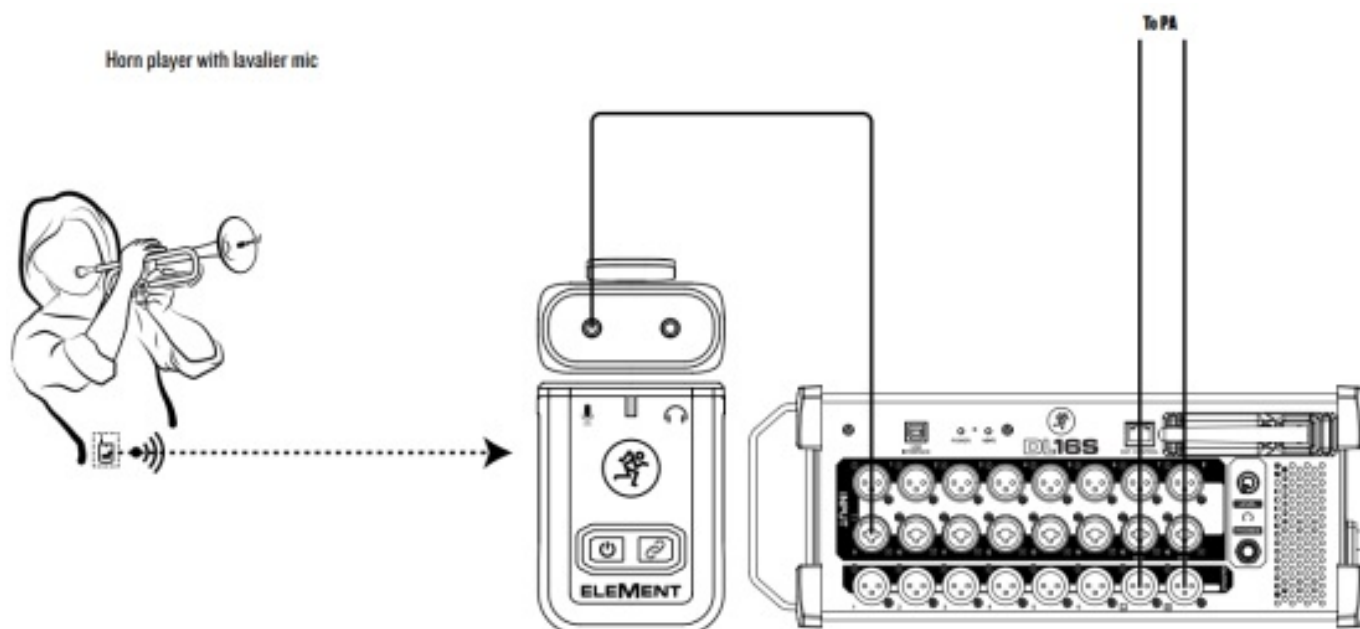
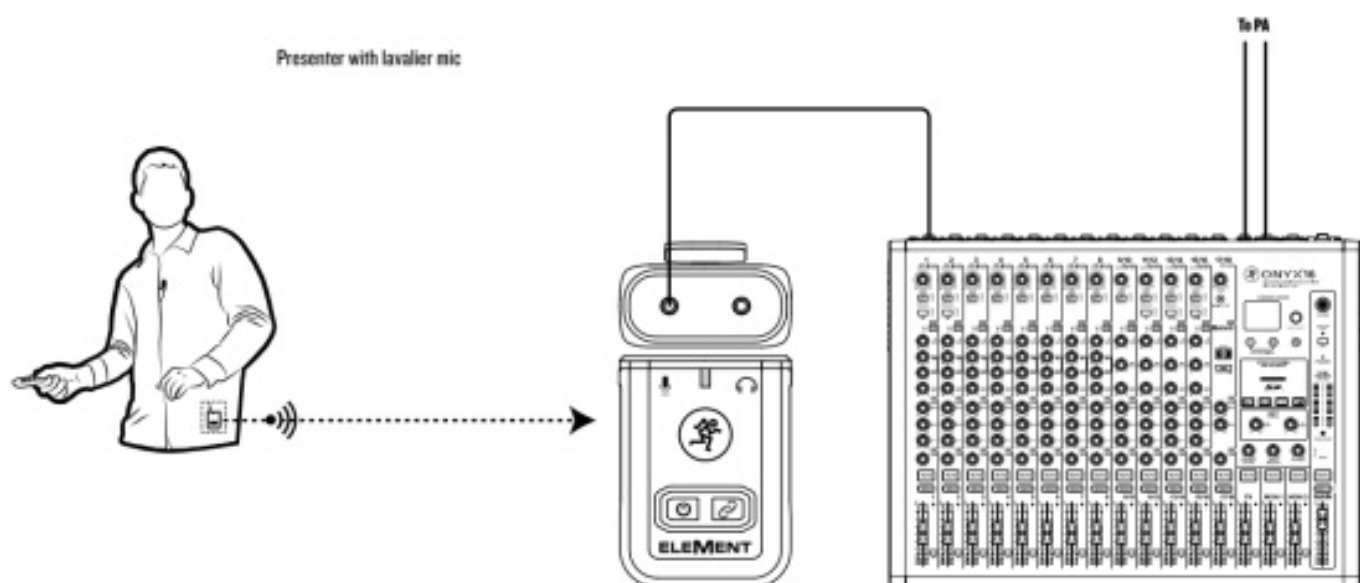
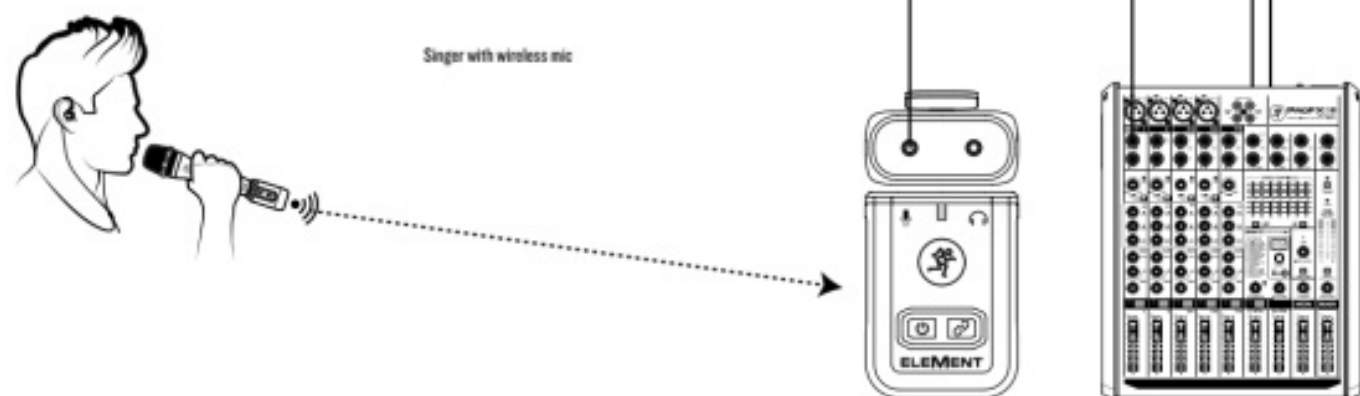

Newscaster with wireless mic / cold-shoe mounted camera

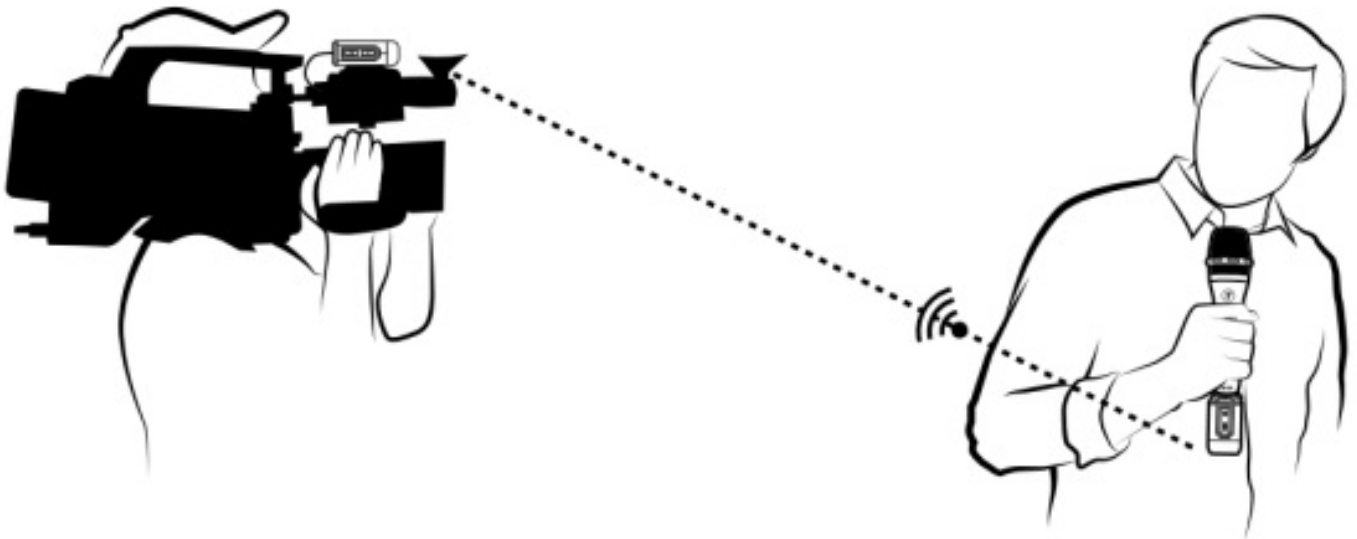

EleMent Wave Front, Rear & Side Panels

Receiver

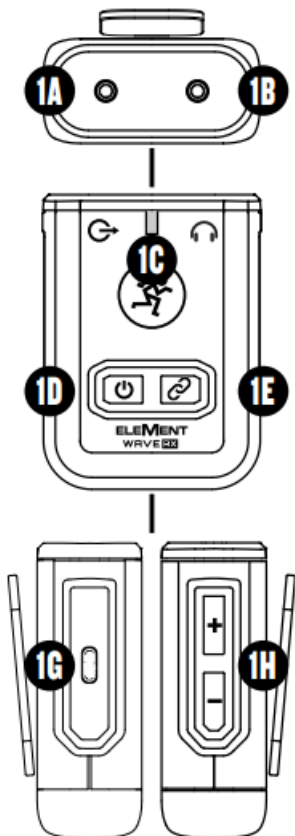

Lavalier Transmitter

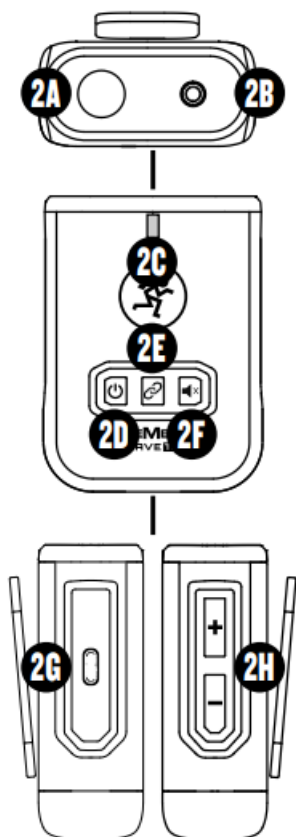

XLR Transmitter

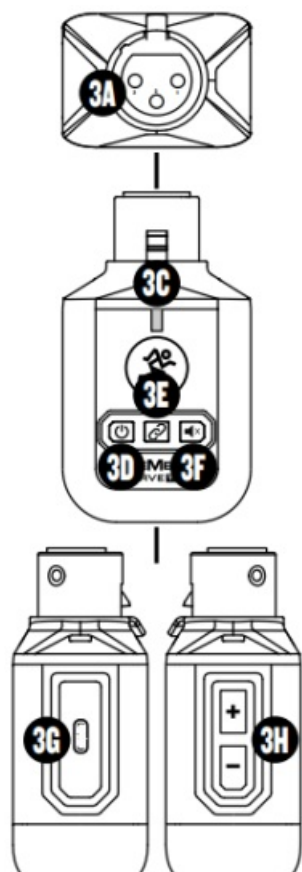

FRONT, REAR & SIDE PANEL DESCRIPTIONS

RECEIVER

- **A.** 1/8" Main Output This 1/8" connector supplies the output to a mixer, streaming or recording device.

- **B. Phones Jack** This 1/8" connector supplies the output to stereo headphones.
- **C. Status LED** This LED indicates the status of the unit, including battery level, device pairing, mute position and more.
- **D. Power** Turns EleMent Wave on and off.
- **E. Pair** This momentary switch initiates pairing.
- **G. USB C Connector** This connector is used for charging the unit.
- **H. Volume** Adjusts the overall output level.

LAVALIER TRANSMITTER

- **A. Internal Mic** Built-in mic for immediate use.
- **B. Mic Input** Connect a lavalier mic using an 1/8" connector.
- **C. Status LED** This LED indicates the status of the unit, including battery level, device pairing, mute position and more.
- **D. Power** Turns EleMent Wave on and off.
- **E. Pair** This momentary switch initiates pairing.
- **F. Mute** This momentary switch mutes the mic.
- **G. USB C Connector** This connector is used for charging the unit.
- **H. Volume** Adjusts the input level.

MIC TRANSMITTER

- **A. Mic Input** Connect a balanced mic using an XLR connector.
- **C. Status LED** This LED indicates the status of the unit, including battery level, device pairing, mute position and more.
- **D. Power** Turns EleMent Wave on and off.
- **E. Pair** This momentary switch initiates pairing.
- **F. Mute** This momentary switch mutes the mic.
- **G. USB C Connector** This connector is used for charging the unit.
- **H. Volume** Adjusts the input level.

GETTING STARTED

1. Read and understand the Important Safety Instructions on page 2.
2. Connect the 1/8" main output of the receiver to the input of a mixer, streaming or recording device.
3. Connect a mic to the transmitter's mic input.
4. Power on the receiver and transmitter. They should arrive already paired.
If not, please refer to the owner's manual for full instructions.
5. Make sure the master volume, level and gain controls are all the way down.
6. Talk, sing, or play the instrument at the same volume as it would be during normal use... and keep it going!
7. Raise the input (transmitter) and output (receiver) levels, as well as the gain on the mixer until it clips, then turn it down a notch or two.
8. Raise the mixer's channel and main faders to a comfortable listening level.

TECHNICAL SPECIFICATIONS

EleMent Wave	
Wireless Technology	2.4 GHz Digital Wireless with 128-bit encryption
Operational Range	70M LOS
Dynamic Range	>105 dB
Battery Technology	Internal rechargeable LiON (or similar) – 3.7V, 450mAh
Battery Life	Seven hours of use before charging required
Analog Output Level (Base-X)	Adjustable pad: 0 dB / –12 dB / –24 dB
Transmitter Pairing	One-button
Power Requirements Size (H x W x D)	5 VDC 2A XLR Transmitter XLR-Sender: 1.6 x 1.0 x 3.3 in // 41 x 25 x 84 mm Lav Transmitter Lavalier-Sender: 1.1 x 1.5 x 2.0 in // 28 x 38 x 51 mm Receiver
Weight	XLR Transmitter XLR-Sender: 0.09 lb // 0.04 kg Lav Transmitter Lavalier-Sender: 0.07 lb // 0.03 kg Receiver : 0.07 lb // 0.03 kg

WARRANTY AND SUPPORT

Visit WWW.MACKIE.COM to:

- Identify WARRANTY coverage provided in your local market.

Please keep your sales receipt in a safe place.

- Retrieve a full-version, printable OWNER'S MANUAL for your product.
- DOWNLOAD software, firmware and drivers for your product (if applicable).
- REGISTER your product.
- CONTACT Technical Support.

19820 NORTH CREEK PARKWAY #201 • BOTHELL, WA 98011 • USA

Phone: 425.487.4333 • Toll-free: 800.898.3211 • Fax: 425.487.4337

Part No. 2053698 Rev. C 09/21 ©2021 LOUD Audio, LLC. All Rights Reserved.

Documents / Resources



[MAKIE 2AD4XMICX EleMent Wave Microphone Systems](#) [pdf] User Guide
LAVX, 2AD4XLAVX, MICX, 2AD4XMICX, 2AD4XMICX EleMent Wave Microphone Systems, 2
AD4XMICX, EleMent Wave Microphone Systems

References

-  [MACKIE](#)