



MAJORITY K2 Bluetooth Soundbar Instruction Manual

[Home](#) » [MAJORITY](#) » MAJORITY K2 Bluetooth Soundbar Instruction Manual 

Contents

- [1 MAJORITY K2 Bluetooth Soundbar](#)
- [2 Product Information](#)
- [3 Product Usage Instructions](#)
- [4 Controls And Functions](#)
- [5 Instructions Guide](#)
 - [5.1 Wall Mounting and Auto-Power Off](#)
 - [5.2 Using the RCA Audio Cable](#)
- [6 Connecting to the Mains Supply](#)
- [7 Bluetooth Operation](#)
- [8 Troubleshooting](#)
- [9 Specification](#)
- [10 Support](#)
- [11 Warranty](#)
- [12 Safety Information](#)
- [13 Documents / Resources](#)
 - [13.1 References](#)
- [14 Related Posts](#)

MAJORITY

MAJORITY K2 Bluetooth Soundbar



Product Information

Specifications

- Model: Bluetooth Soundbar KK22-BBAR-WBLHKT
- Bluetooth Version: 5.0 + EDA
- Wireless Subwoofer
- Power Output: 70W
- Power Source: External DC adapter 12V/1A

Controls and Functions

The soundbar and remote control have various controls and functions:

Soundbar Controls

- Power Button (1)
- Mode Button (2)
- Volume Up/Next Button (3)
- Volume Down/Previous Button (4)
- Line In (5)
- USB Function (6)
- HDMI ARC Input (7)
- Subwoofer Output (8)
- FM Antenna (9)
- Optical Input (10)
- DC Power Input (11)
- Wall Bracket (12)

Remote Control Functions

- Power On/Off Button (13)
- Volume Up Button (14)
- Back Step Button: Use in AUX or Bluetooth mode to go back a track (15)
- Play/Pause Button (16)
- Volume Down Button (17)
- Bass Increase Button (18)
- EQ Button: Press to adjust the equalizer, hold to turn soundbar LED light on/off (19)
- Bass Decrease Button (20)
- Mode Button: Switch between modes (21)
- Forward Step Button: Use in AUX or Bluetooth mode to go forward a track (22)
- Treble Increase Button (23)
- Treble Decrease Button (24)

Subwoofer Controls

- DC Adapter Input (25)
- Power Switch (26)

What's In The Box?

- Majority K2 Soundbar (27)
- Subwoofer (28)
- Remote Control (29)
- 3.5mm to 3.5mm Audio Cable (30)
- RCA Cable (31)
- HDMI Cable (32)
- Power Adapter x 2 (33)

Product Usage Instructions

Wall Mounting

The Majority K2 Soundbar can be mounted on a wall using appropriate fittings for your wall type. The wall mounting brackets are located at the rear of the unit. Please note that the fittings are not included and will need to be sourced separately.

Auto-Power Off Function

The Majority K2 Soundbar has an automatic power off mode. It will go into sleep mode after 180 minutes if the TV is turned off.

Using the RCA Audio Cable

1. Connect the RCA Stereo Audio Cable to the TV's stereo RCA (L/R) audio output socket.
2. Connect the other end of the audio cable to the "LINE IN" input sockets (Ref.5) on the side of the soundbar.
3. Press the MODE button on the remote control (Ref.21) or on the unit (Ref.2) to select LINE mode.

Troubleshooting: If you are not receiving a picture, please ensure that the RCA cable is connected to the “output” RCA ports on your TV. If your TV does not have “output” RCA ports, please use an alternative connection method.

Using the ARC Input

To use the ARC input, you will need an audio source with an ARC audio output and an HDMI ARC cable (included).

1. Connect the ARC audio cable from the ARC input on the soundbar (Ref.7) to the ARC output on your audio source.

FAQ

Q: How do I register my product for warranty?

- **A:** You can register your product online for a free 3-year extended warranty at www.majority.co.uk.

Q: What is the power output of the subwoofer?

- **A:** The subwoofer has a power output of 70W.

Q: Can I mount the soundbar on any type of wall?

- **A:** Yes, you can mount the soundbar on any type of wall using appropriate fittings for your wall type. Please note that the fittings are not included.

Q: How long does it take for the soundbar to go into sleep mode?

- **A:** The soundbar will go into sleep mode after 180 minutes if the TV is turned off.

Controls And Functions

Side View + Back View

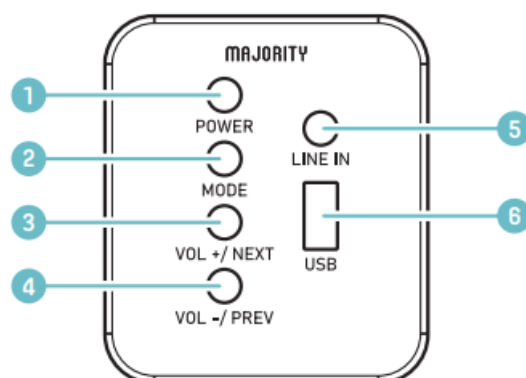

1. Power

2. Mode
3. Volume +/Next
4. Volume-/Previous
5. Line In
6. USB Function

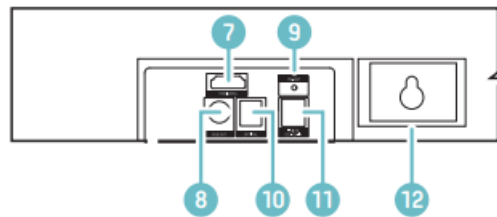

7. HDMI ARC Input
8. Subwoofer Output
9. FM Antenna
10. Optical Input
11. DC Power Input
12. Wall Bracket

- **Remote Control**

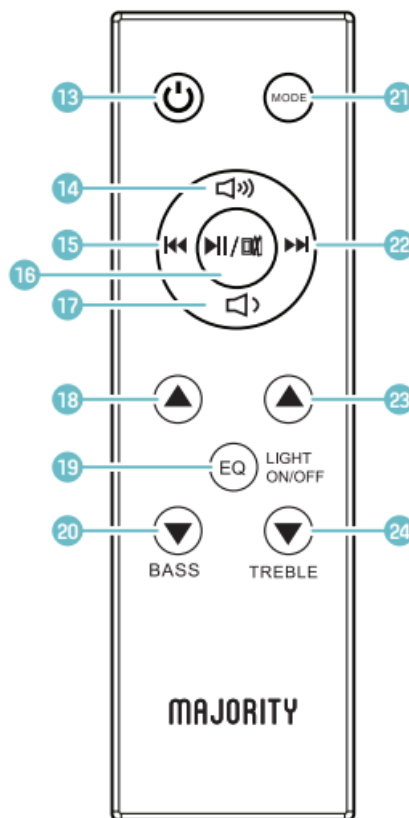

13. **Power** On/Off
14. **Volume +**
15. **Back step:** Use in AUX or Bluetooth mode to go back a track
16. **Play/Pause**
17. **Volume -**
18. **Bass** increase
19. **EQ:** Press the button to adjust the equaliser Press and hold the button to turn the soundbar LED light on and off. EQ settings can be changed in any play mode
20. **Bass** decrease

21. **Mode:** Switch between modes
22. **Forward step:** Use in AUX or Bluetooth mode to go forward a track
23. **Treble** increase
24. **Treble** decrease
 - **Subwoofer**

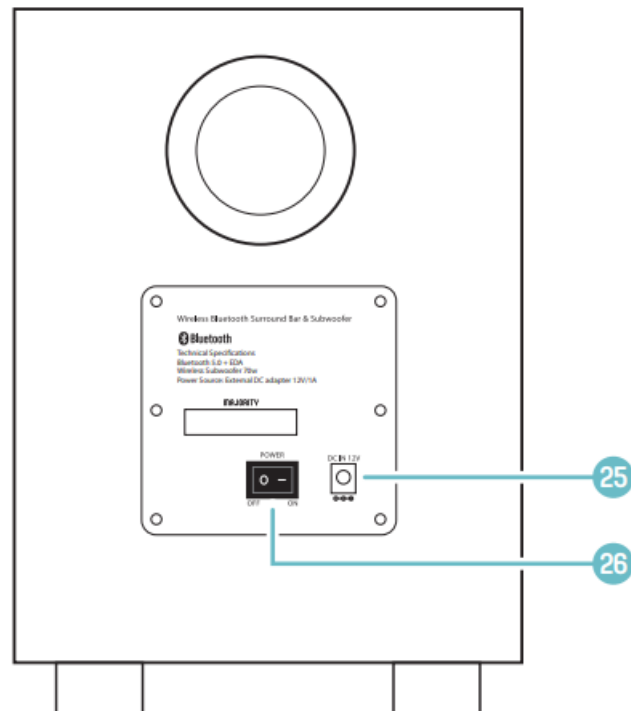

25. DC adapter input
26. Power Switch

- **What's In The Box?**
- **Box Contents**

27. Majority K2 Soundbar
28. Subwoofer
29. Remote Control
30. 3.5mm to 3.5mm Audio Cable
31. RCA Cable
32. HDMI Cable
33. Power Adapter x 2

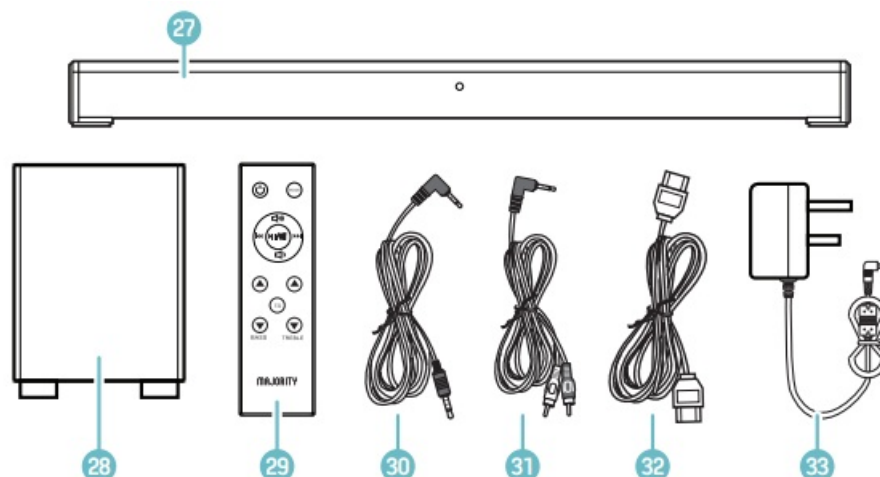

Wall Mounting and Auto-Power Off

Wall Mounting

- The Majority K2 can be mounted to a wall using the appropriate fittings for your wall type by using the wall mounting brackets positioned at the rear of the unit. As these differ between wall types the fittings are not included.
- To wall mount the K2 soundbar, the appropriate fittings for your application will need to be sourced
- Auto power off function

Automatic Power Off Mode

- The Majority K2 Soundbar will automatically go into sleep mode after 180 minutes if the TV is off.

Using the RCA Audio Cable

- Connect the RCA Stereo Audio Cable to connect the TV's stereo RCA (L/R) audio output socket.
- Connect the audio output cable to the side of the soundbar via the 'LINE IN' input sockets (Ref.5).
- Then press MODE on the remote control (Ref.21) or on the unit (Ref.2) to select LINE mode.
- Troubleshooting: If you are not receiving a picture, please ensure that the RCA cable is connected to 'output' RCA ports on your TV
- If your TV does not have 'output' RCA ports, please use an alternative connection method

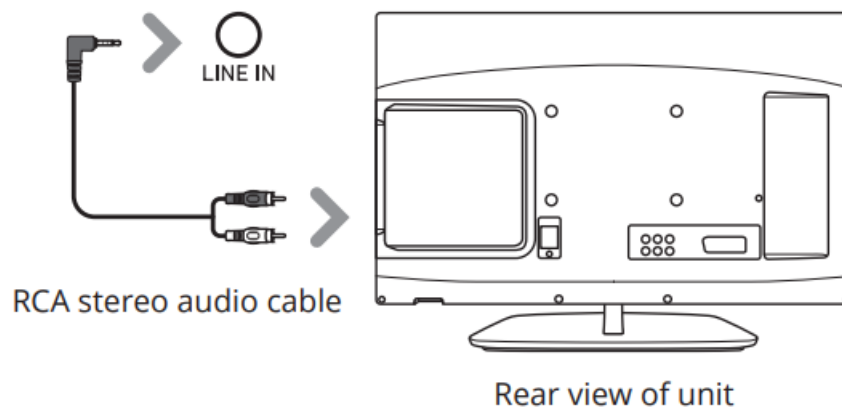

Using the ARC Input

- You will need: an audio source with an ARC audio output and an HDMI ARC cable (included).
- Connect the ARC audio cable from the ARC input on the soundbar (Ref.7) to the ARC output on your audio source.

Switch on the soundbar

- Press the MODE button on the remote control (Ref.21) or on the unit (Ref.2) until ARC mode is selected.
- Using the native controls on your connected device, ensure the audio settings are set to ARC or HDMI Audio

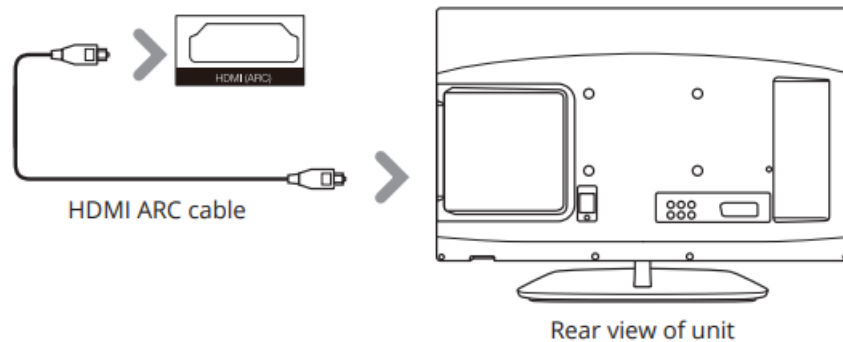

Using the Optical Input

- You will need: An audio source with an Optical Audio Output and a
- Digital Optical Audio cable (not included).
- Connect the Optical cable from the soundbar (Ref.10) to your audio source
- Switch on the soundbar. Press the MODE button on the remote control (Ref.21) or on the unit (Ref.2) until OPTICAL mode is selected.

How do I set the correct Audio settings for Optical mode?

- When using the soundbar in Optical mode, or when using the soundbar with an App such as Netflix or Amazon Prime, you may experience sound issues if you have your audio settings set up incorrectly.
- Using the native controls on your connected device, make sure the audio settings are set to PCM or Optical Audio.
- This setting can be found within your TV's sound settings, most likely under 'Additional Settings' within the Sound menu, where you will find options for 'PCM/Dolby Digital/DTS/DTS Neo 2:5'.

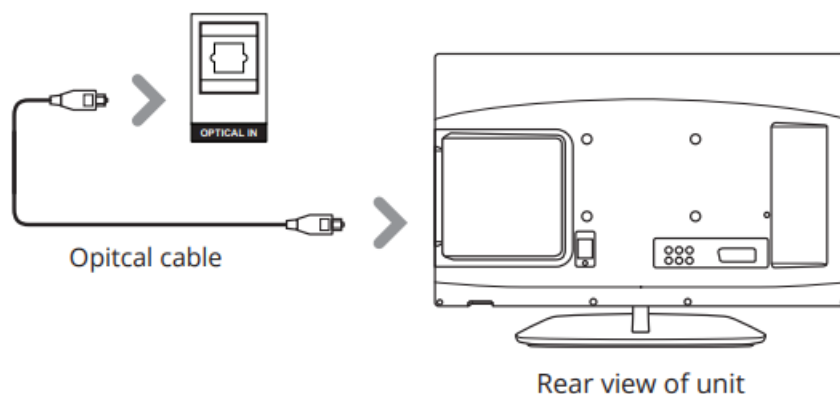

Using the MP3 LINK Connection (Line In)

- Plug one end of a 3.5mm audio input cable (included) into the Line In input on the unit (Ref.5). Before use, disconnect any cables connected to the Stereo RCA Inputs
- Plug the other end of the cable into the audio output/headphone output on your audio source
- Switch on the soundbar
- Press the Mode button repeatedly on the soundbar (Ref.2) or on the remote control (Ref.21) until LINE in mode is selected.

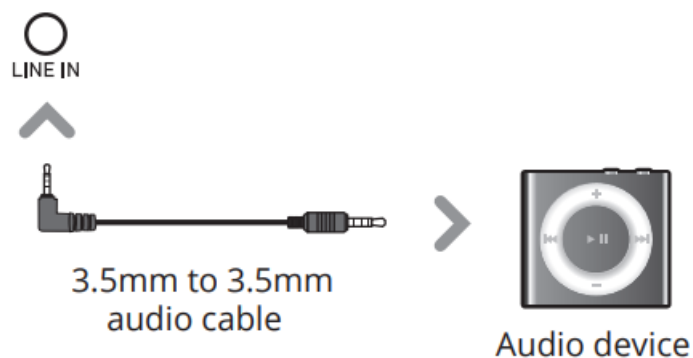

Connecting to the Mains Supply

- Ensure that the power supply voltage is within the range of 100V~240V.
- Any other voltage may cause damage to the unit
- Unwind the mains cable to its full length
- Connect the mains plug to a mains socket
- Make sure the mains plug is fully inserted into the mains socket
- Connect the adapter to the unit via the DC input Socket (Ref.11).

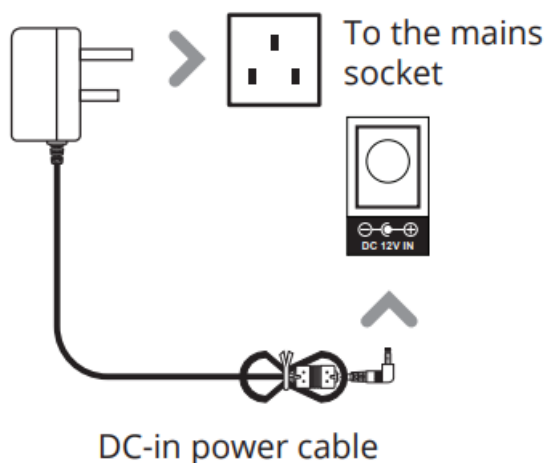

- Ensure all audio connections of the unit are connected before connecting to the mains power socket
- Unplug the power cord from the outlet when the unit is use for an extended period of time.

Connecting the Soundbar and Subwoofer

- **Please note:** The soundbar and subwoofer must be within a 10 metre range of each other in order to be successfully connected.
- The sub-woofer and soundbar will wirelessly connect to each other for a surround sound experience. This allows you to place the sub-woofer within the corner of the room to ensure that the sound from your TV fills the room.
- To connect them together, please ensure that your soundbar is being mains powered and switched 'ON' for initial set up. To do this, press the Power button (Ref.1) on the unit or the POWER button on the remote control (Ref.13).
- Follow by plugging the subwoofer into a power source, and turning it ON via the power switch (Ref.26)
- The sub-woofer and soundbar should then automatically connect via wireless Bluetooth connectivity.
- If you are having connectivity issues, please move the sub-woofer closer to the soundbar for set up.

Bluetooth Operation

Pairing a Bluetooth Device for the First Time

- Press the POWER button on the unit (Ref.1) or the POWER button on the remote control (Ref.13) to switch on the unit.
- Select and press the MODE button repeatedly on the remote control until in Bluetooth mode (Ref.21) or press the Mode button (Ref.2) repeatedly on the soundbar to enter Bluetooth mode
- Using the native controls on your Bluetooth device, select the “Majority Ben Nevis II+” in your Bluetooth settings to pair.
- If your device requests a password, enter the default “0000”. Refer to the user manual for your specific device for instructions on pairing and connecting Bluetooth devices
- When successfully paired and connected, a beep will issue from the unit. After initial pairing, the unit will stay paired unless unpaired manually by the user
- If your device should become unpaired or you find it is unable to connect, repeat the above steps.

FM Mode

- Press the MODE button on the remote control (Ref.21) or on the soundbar (Ref.2) until FM mode is selected.
- Ensure that the wire aerial on the back panel of the soundbar is extended.
- In FM mode, press and hold the ‘Play/Pause’ button on the remote (Ref.16) to begin searching for available FM stations.
- After the search is complete, the soundbar will save the stations with good signal. To scroll through these saved stations, use the ‘Previous/Next’ buttons on the remote control (Ref.15/Ref.22).

Please note:

- If you are having trouble with receiving stations, complete another auto-scan and adjust the aerial if required

Troubleshooting

If you encounter an issue with your soundbar, please refer to the following checklist

Observation	Potential Cause/Solution
No power/function	Check that the power is switched on at the wall Check that the power adaptor is properly connected to the power outlet
No sound	Check that cables are properly installed If they are, please try connecting to your TV using an alternative cable Check unit is switched on and in correct mode
No sound in Bluetooth mode	Check that your Bluetooth device is paired Check whether external device requires password "0000" to start with.
Function disturbance	Switch off and unplug the unit. Leave for 2 minutes and switch on again If a particular mode is causing problems, please try an alternative connection to your TV such as Optical or Bluetooth
Remote control function issues	Check whether the battery needs replacing, and replace if necessary Check whether there are obstacles blocking the remote sensor
Sound issues – buzzing when using Optical Mode, Netflix or Amazon Prime	Ensure that the audio settings on your TV are set to 'PCM'. See page 8 for details.

Specification

Power Supply	DC 12V/1A
Power Consumption	75W
Power Output (max)	75W*2 + 75W Subwoofer
Frequency Response	+/- 3dB
Bluetooth	V30
Dimension (WxHxD)	76.2 x 5.3 x 6.9 cm sound bar 28 x 19.7 x 19.7 cm sub woofer

Support

If you require further assistance with your new soundbar, please contact our support team on the Majority website: www.majority.co.uk/support

Warranty

- All products come with a standard 12 month warranty All items must be registered on www.majority.co.uk for the warranty to be valid Once on the web page, use the menu to find "Register Your Product".
- You will also be given the chance to extend your warranty for an additional 24 months, free of charge.

Safety Information

1. Read these instructions.
2. Keep these instructions. Instructions are also available for download at www.majority.co.uk
3. Heed all warnings
4. Follow all instructions
5. Do not clean the apparatus near or with water
6. Do not block any ventilation openings. Install in accordance with the manufacturer's instructions
7. Do not install near any heat sources such as radiators, heat registers, stoves, or other apparatus (including amplifiers) that produce heat.
8. Protect the power from being walked on or pinched particularly at plugs, convenience receptacles, and the point where they exit from the apparatus.
9. Only use attachments/accessories specified by the manufacturer.
10. Unplug this apparatus during light storms or when unused for long periods of time.
11. Refer all servicing to qualified service personnel. Servicing is required when the apparatus has been damaged in a way, such as power-supply cord or plug is damaged, liquid has been spilled or objects have fallen into the apparatus, the apparatus has been exposed to the rain or moisture, does not operate normally or has been dropped.
12. No naked flame sources, such as lit candles, should be placed on the apparatus.
13. Dispose of used electrical products and batteries safely according to your local authority and regulations.

ADDITIONAL WARNINGS

- The apparatus shall not be exposed to dripping or splashing and no objects filled with liquid, such as vases, shall be placed on the apparatus.
- Main plug is used to disconnect device and it should remain readily operable during intended use. In order to disconnect the apparatus from the main mains completely, the mains plug should be disconnected from the main socket outlet completely.
- Battery shall not be exposed to excessive heat such as sunshine, fire or the like.

RECYCLING ELECTRICAL PRODUCTS

- You should now recycle your waste electrical goods and in doing so help the environment.
- This symbol means an electrical product should not be disposed of with normal household waste.
- Please ensure it is taken to a suitable facility for disposal when finished with.
- **IMPORTANT:** Please read all instructions carefully before use and keep for future reference.
- Risk of electric shock.
- Do not open
- Read all instructions carefully before use and keep for future reference
- When servicing, use only identical replacement parts
- **IMPORTANT:** Please read all instructions carefully before use and keep for future reference
- www.majority.co.uk
- **Register your product online for a FREE 3 year extended warranty at:** www.majority.co.uk

Documents / Resources

	<p>MAJORITY K2 Bluetooth Soundbar [pdf] Instruction Manual K2, K2 Bluetooth Soundbar, Bluetooth Soundbar, Soundbar</p>
---	--

References

- [M Soundbars, DAB Radio & Internet Radio range | Now in over 3 Million Homes](#)
- [M Support - Majority](#)
- [User Manual](#)