



Maisto 615547 RC Tech Remote Controlled Car Instructions

[Home](#) » [Maisto](#) » Maisto 615547 RC Tech Remote Controlled Car Instructions 📄

Maisto 615547 RC Tech Remote Controlled Car Instructions



Contents

- 1 [Radio Control Vehicles](#)
- 2 [Battery use](#)
- 3 [Troubleshooting](#)
- 4 [Disposal of batteries](#)
- 5 [Documents / Resources](#)
 - 5.1 [References](#)
- 6 [Related Posts](#)

Radio Control Vehicles

WARNING! Not suitable for children under the age of 36 months due to danger of swallowing small parts. Choking hazard! Please keep this owner's instruction manual for future reference. It contains important

information.

We reserve the right to improve/revise the product specifications without notice.

Class 1 LED Product

Contents:

- RC Vehicle x 1
- RC Transmitter x 1
- Owner's Instruction Manual x 1

Battery Requirement:

Vehicle: 4 x 1.5V "AAA" LR03/R03 batteries.

Transmitter: 2 x 1.5V "AAA" LR03/R03 batteries.

Battery installation for the Transmitter: (Refer to Diagram 1)

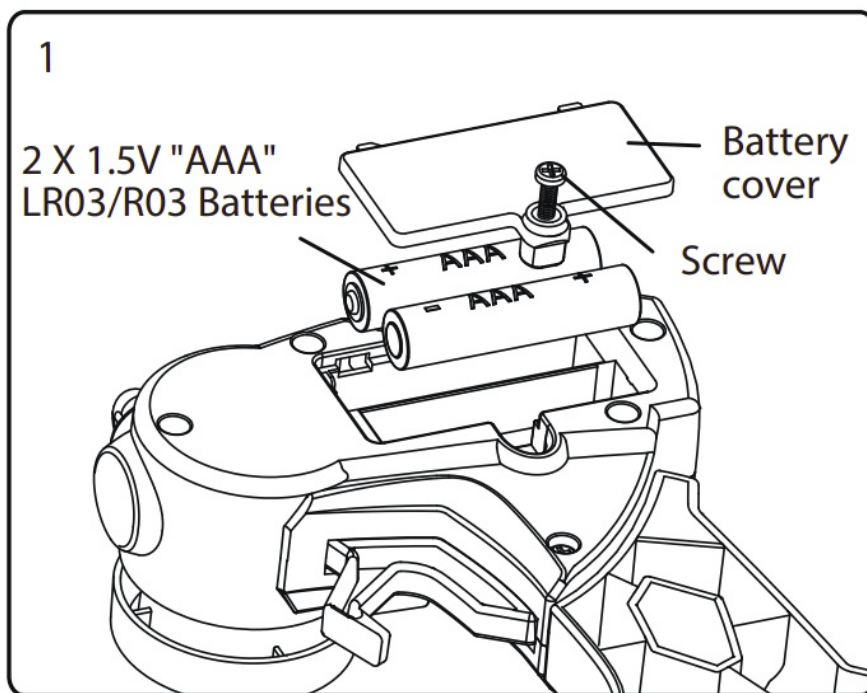

1. Use a screwdriver to loosen the screw on the battery cover and to open the battery cover. (Screwdriver is not included.)
2. Install 2 new 1.5V "AAA" LR03/R03 batteries with correct polarity (+/-) as shown inside the battery compartment.
3. Install the battery cover and then tighten the screw on the battery cover.

Battery installation for the Vehicle: (Refer to Diagram 2)

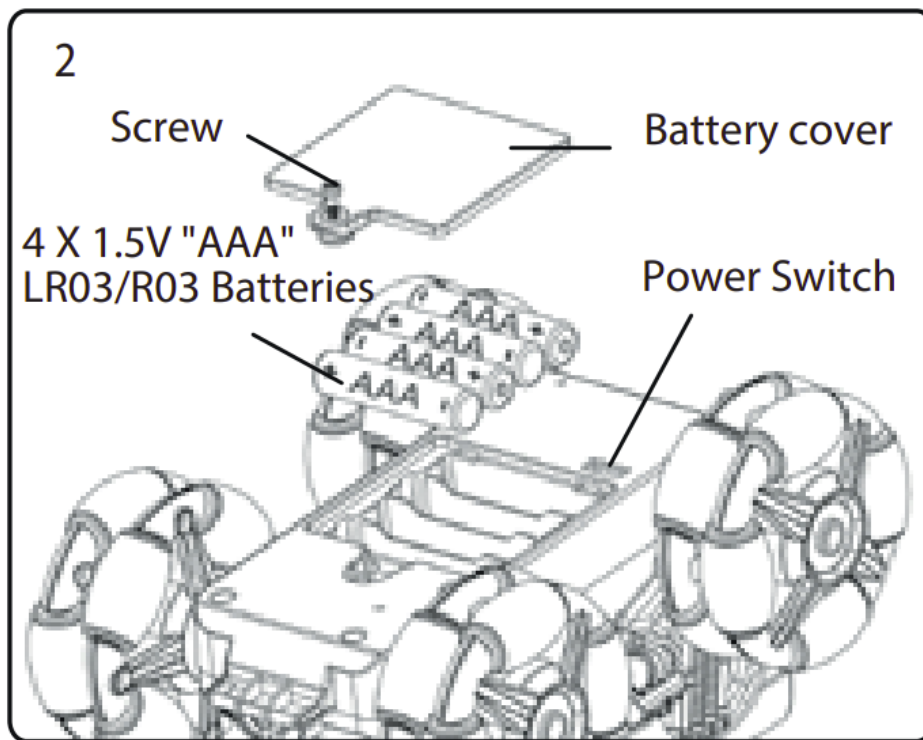

Battery installation for the Vehicle: (Refer to Diagram 2)

1. Switch OFF the power of the vehicle.
2. Use screwdriver to loosen the screw on the battery cover and to open the battery cover. (Screwdriver is not included).
3. Install 4 new 1,5V "AAA" LR03/LR03 battery with correct polarity (+/-) as shown inside the battery compartment.
4. Install the battery cover and then tighten the screw on the battery cover.

How to play: (Refer to Diagram 3 & 4)

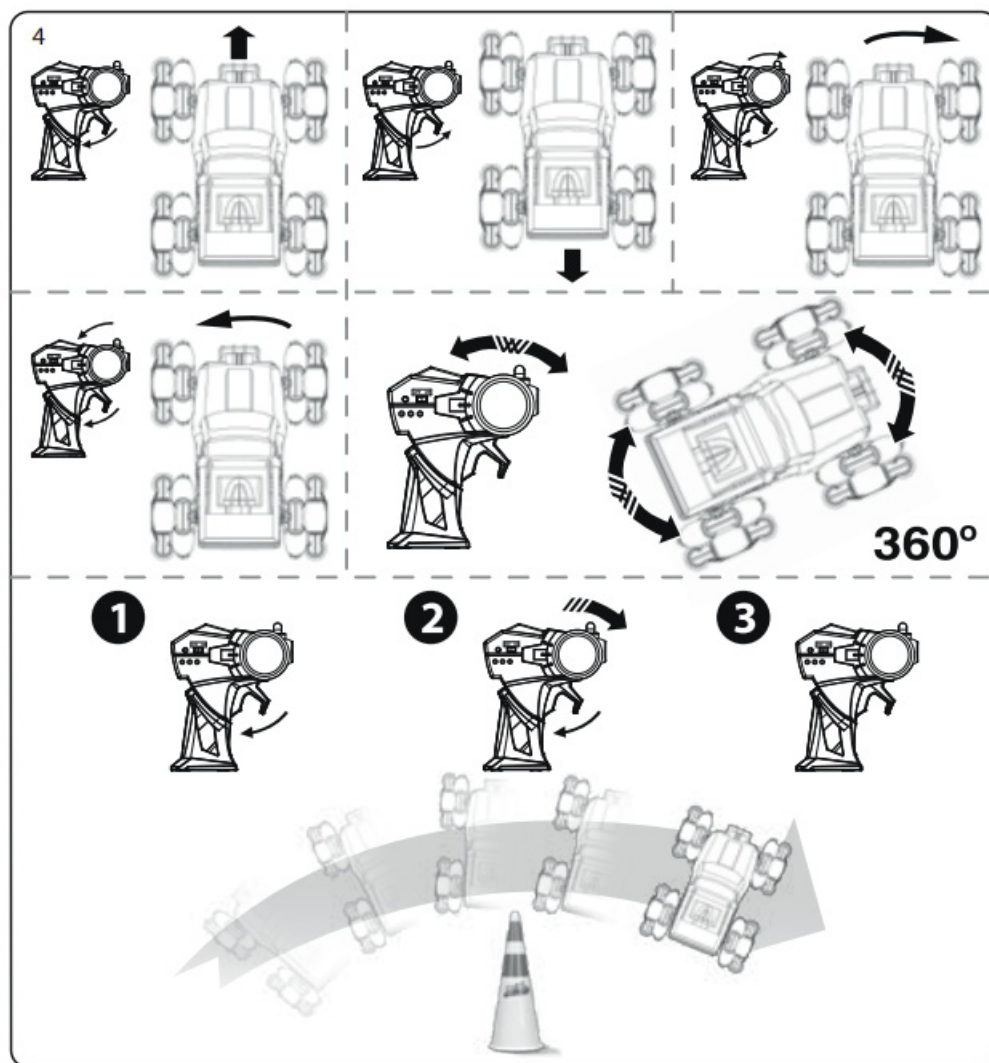
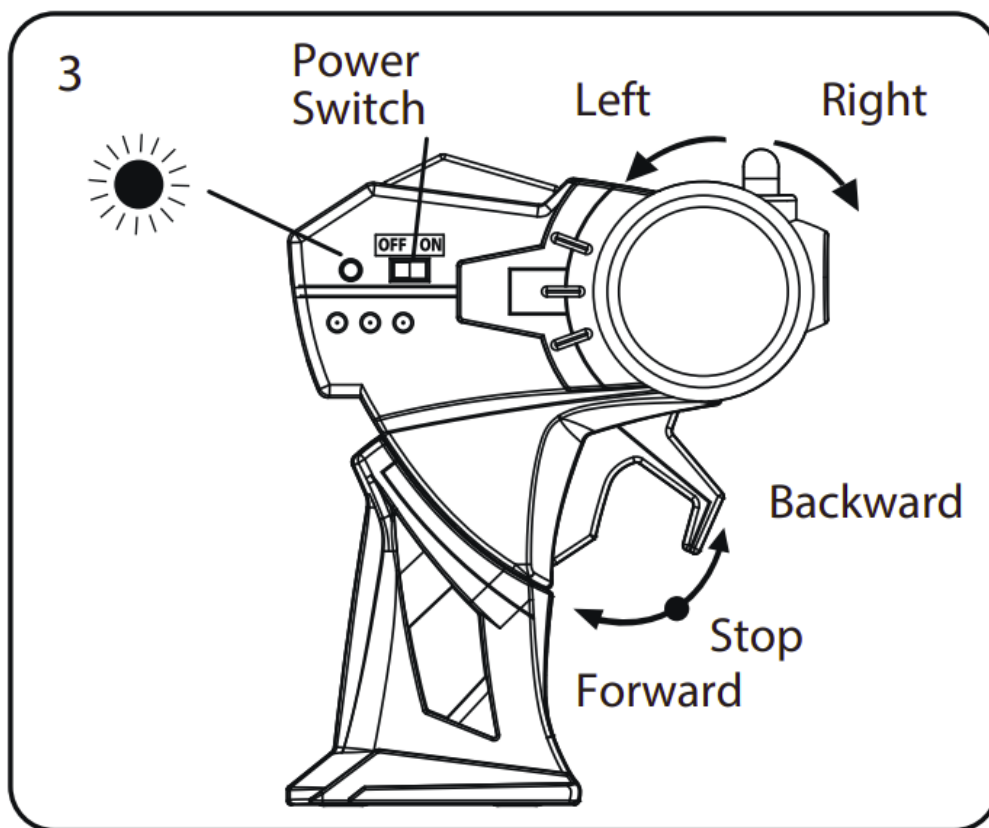

1. Set the "Power Switch" on the controller and vehicle to ON position, the "Power LED" on the controller will flash less than 3 seconds then stay on, meaning the automatic frequency matching between the controller and the

vehicle is completed.

2. If the "Power LED" of the controller flares for more than 3 seconds, switch off both the vehicle and controller, then turn them on-again.
3. Pull the trigger in the transmitter to drive the vehicle forward. Push the trigger in the transmitter to drive the vehicle backward.
4. Pull or push the trigger in the transmitter and turn the steering wheel to control the vehicle turn to left or right.
5. Turn the steering wheel to left or right to control the vehicle spin 350°.
6. Try different combinations of the trigger and steering wheel to perform different sideways drifting stunt actions.
7. The vehicle will get into self protection mode and out of control if keep driving spin 350° for a long time, switch off both the vehicle and controller, then turn them on again can resume play.
8. The vehicle will be out of control when the batteries have run out power, then need to replace new batteries.
9. Turn the switch of the controller and vehicle to OFF position when not in play.

Performance tips:

1. Do not drive the vehicle on grass, sand or go through water.
2. Do not drive the vehicle in windy or rainy weather.
3. Do not drive the vehicle into any hard object.
4. Keep fingers, hair and loose clothing away from the vehicle.
5. The operating range can be affected by a variety of factors:
 - a) Weak controller or vehicle batteries.
 - b) Interference from other items that emit radio frequency signals such as another R/C item on the same frequency, CB radios, cordless phones, high voltage transmitter, etc.
6. Outdoor usage is recommended in order to get an optimal control range.

Battery use

1. Alkaline batteries are recommended.
2. Only batteries of the same or equivalent type as recommended are to be used.
3. Do not mix alkaline, standard or rechargeable batteries.
4. Do not mix old and new batteries or different types of batteries.
5. Non-rechargeable batteries are not to be charged.
6. If rechargeable batteries are to be used, they are only to be charged by an adult.
7. Rechargeable batteries are to be removed from the product before they are charged.
8. Be sure to insert batteries with correct polarities and always follow the battery manufacturer's instructions.
9. Remove all batteries from the product when not in use for long periods of time.
10. Exhausted batteries are to be removed from the product.
11. The supply terminals are not to be short-circuited.
12. Dispose of batteries properly. Do not dispose of batteries in fire – it may cause them to explode or leak, causing injury or damage.
13. Battery change must only be made by adults.

Cautions:

1. Do not attempt to disassemble the products.
2. Do not operate the vehicle with the same frequency as other players in same location. This will interfere and cause the vehicle to lose control.
3. Make sure the batteries are installed with correct polarity (+/-) as shown inside the battery compartment.
4. Remove the package, take out all accessories and assemble the product before giving it to children to play

Troubleshooting

Problem	Cause	Correction
No function	Low battery level Battery polarities are reversed The wheels are obstructed by foreign objects	Replace with new batteries Insert the batteries with correct polarities as shown on the battery compartment Remove foreign objects on the vehicle/wheels
Drive slow / Poor turning signal	Low battery level The wheels are obstructed by foreign objects	Replace with new batteries Remove foreign objects on the vehicle/wheels
Poor distance control	Low battery level Strong interference of surroundings	Replace with new batteries Move to a better location for playing

Environmental notes:

- The whole product does not belong to household waste at the end of the product life.
- You can return it to collection points for the recycling of electronic and electrical instruments.
- The symbol on the item instruction manual, hangtag or packing shows this clearly.
- Materials should be recycled according to their respective markings.
- Recycling of old devices or other re-use of materials contained therein represents an important contribution to environmental protection.
- Please ask your local community for the correct collection point.
- Please retain this sheet and address for future use, as they contain important information.

Disposal of batteries

Batteries should not be disposed of in the household waste. As the consumer, you are legally obliged to return batteries containing harmful substances and all other used batteries.

You can hand in your old batteries at public collection points in your area or wherever batteries are sold.

You will find these chemical abbreviations along with a crossed-out refuse bin on batteries containing harmful substances:

- **Pb** = Battery contains lead
- **Cd** = Battery contains cadmium
- **Hg** = Battery contains mercury

CE Declaration

Hereby, May Cheong Group declares that the radio equipment type 82521 is in compliance with Directive 2014/53/EU. The full text of the EU declaration of conformity is available at the following internet address:
<http://www.maycheonggroup.com.hk/web/declaration-of-conformity/>.

- **Frequency:** 2.4 GHz
- **Transmitting frequency band:** 2.4–2.4835 GHz
- **Max allowed transmitting power:** <10 mW

Maahantuoja/Importör/Importer:
Tammer Brands Oy, Viinikankatu 36, 33800 Tampere, Finland



Documents / Resources

	<p>Maisto 615547 RC Tech Remote Controlled Car [pdf] Instructions 615547 RC Tech Remote Controlled Car, 615547, RC Tech Remote Controlled Car, Remote Controlled Car, Controlled Car, Car</p>
---	---

References

- [MayCheongGroup](#)