



MAGNUSSEN HOME D4209 20 Rectangular Dining Table Instruction Manual

[Home](#) » [MAGNUSSEN HOME](#) » MAGNUSSEN HOME D4209 20 Rectangular Dining Table Instruction Manual 

Contents

- [1 MAGNUSSEN HOME D4209 20 Rectangular Dining Table](#)
- [2 ASSEMBLY INSTRUCTIONS](#)
- [3 Documents / Resources](#)
- [4 Related Posts](#)



MAGNUSSEN HOME D4209 20 Rectangular Dining Table



CAUTION: PLEASE READ ALL INSTRUCTIONS BEFORE STARTING THE ASSEMBLY OF THIS PRODUCT. THESE PIECES ARE HEAVY. IN ORDER TO PREVENT PERSONAL INJURY AND ENSURE THAT THIS PRODUCT IS NOT DAMAGED DURING THE ASSEMBLY PROCESS, IT IS STRONGLY RECOMMENDED THAT YOU ENLIST THE ASSISTANCE OF ONE OR MORE PEOPLE.

WARNING PROTECTIVE GLIDE IS PLACED UNDER LEGS OF FURNITURE TO RESIST SCRATCHES TO FLOOR SURFACE. SOME FLOOR SURFACES CAN BE EXTRA SENSITIVE TO MARKING. IF YOU ARE NOT SURE CONSULT WITH YOUR DEALER.

ASSEMBLY INSTRUCTIONS

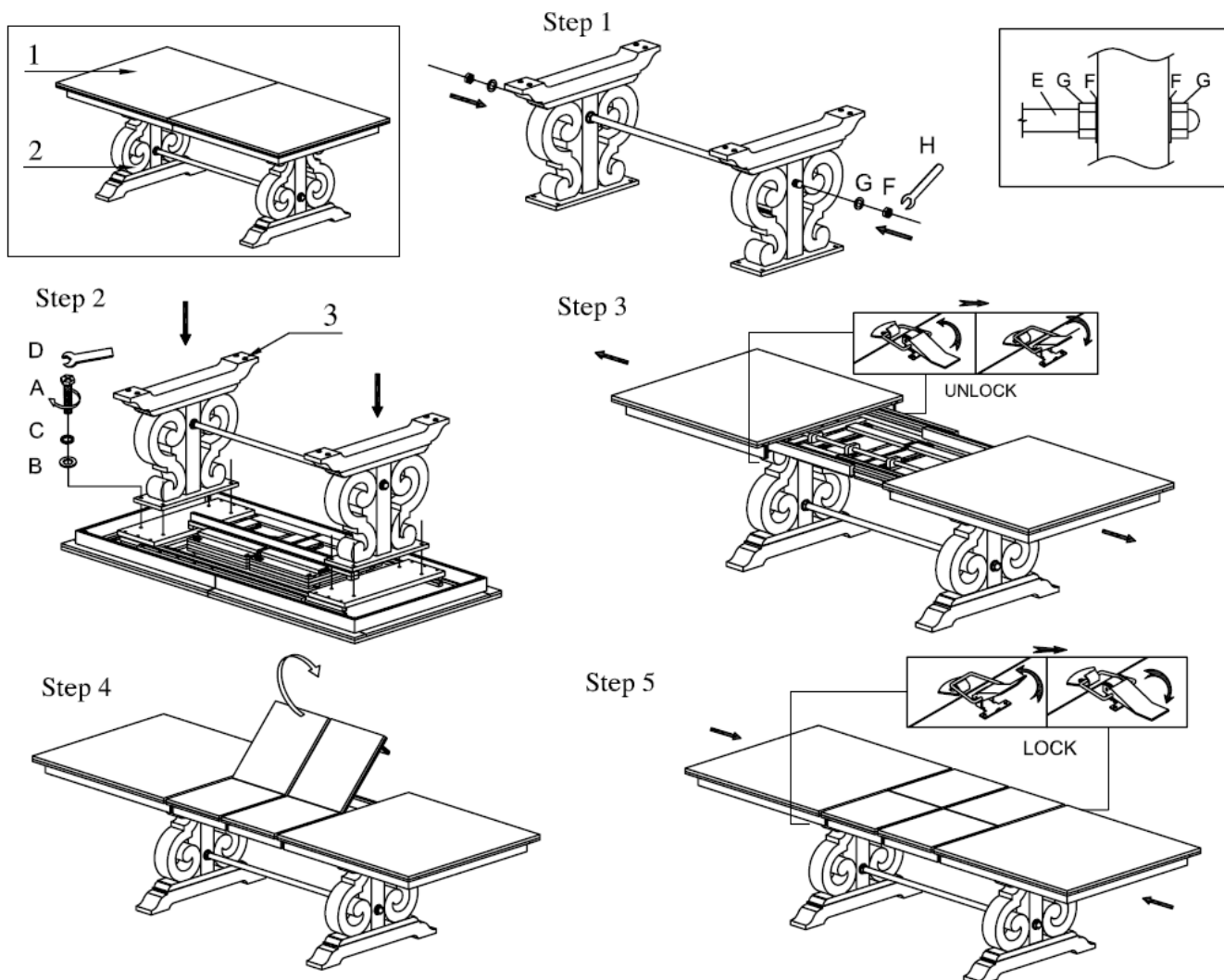

LIST OF PARTS AND HARDWARE:

No.	Description	Q'ty
1	Table top	1
2	Leg frame	2
3	Leveler	8
4	Leaf	2
5	Lock	6

LIST OF PARTS AND HARDWARE:

No.	Description	Q'ty
A	Bolt $\Phi 5/16'' \times 50\text{mm}$	8
B	Flat washer $\Phi 9/\Phi 22\text{mm}$	8
C	Lock washer $\Phi 9/\Phi 11\text{mm}$	8
D	Wrench 12mm	1
E	Metal rail $\Phi 32 \times 1490\text{mm}$	1
F	Flat washer $\Phi 34/\Phi 62\text{mm}$	4
G	Nut M32	4
H	Wrench 45mm	1



[MAGNUSEN HOME D4209 20 Rectangular Dining Table](#) [pdf] Instruction Manual
D4209, 20 Rectangular Dining Table, D4209 20 Rectangular Dining Table