



MACHENIKE HG510W Pro Wireless Gamepad Controller User Guide

[Home](#) » [MACHENIKE](#) » MACHENIKE HG510W Pro Wireless Gamepad Controller User Guide 

Contents

- [1 MACHENIKE HG510W Pro Wireless Gamepad Controller](#)
- [2 WARRANTY](#)
- [3 WHAT'S IN THE BOX](#)
- [4 CARE & MAINTENANCE](#)
- [5 BUTTONS LAYOUT](#)
- [6 CONNECTION](#)
- [7 COMPATIBILITY](#)
- [8 COMPATIBILITY](#)
- [9 ABOUT KEYLINKER](#)
- [10 FEATURES](#)
- [11 EXTENDED FUNCTIONS](#)
- [12 EXTENDED FUNCTIONS](#)
- [13 TECH SPECS](#)
- [14 CONTROL PART](#)
- [15 OTHER](#)
- [16 Documents / Resources](#)
- [17 Related Posts](#)

MACHENIKE HG510W Pro Wireless Gamepad Controller



Please read the manual carefully before using this product and keep it for reference.

WARRANTY

Cautions:

- Do not spray flammable insecticides and other sprays near the gamepad.
- Do not put liquids on the gamepad such as water or juice! It may cause the keys to malfunction or be damaged.
- Do not plug or unplug the USB cable with wet hands.
- Do not use it in humid or hot places, such as bathrooms.
- Do not use it in places which are easy to fall ,dusty(beach) or have magnetic fields.
- Do not put it on the top of heat-generating equipment such as heat dissipation.

Operating Precautions:

- Do not use excessive force as this can cause hand fatigue and buttons attrition.
- If you feel sore on wrists or fingers during using, Please adjust your posture and strength or temporarily stop using it.
- If your hands feeling not well during using, please stop using, continued use may cause skin rash or other allergic reactions.

WHAT'S IN THE BOX

- 1x Controller



- 1x User Guide



- 1x USB charging data cable

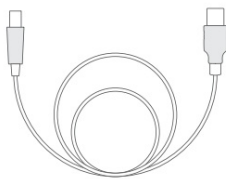

CARE & MAINTENANCE

- Please use soft duster or damp cloth to clean the gamepad.
- Do not use solvent, e.g.: gas, thinner, alcohol, kitchen detergent, chemical wipes...It may cause deformation and color fallout.
- Do not use wet rag wipe this gamepad which will cause internal damage.

BUTTONS LAYOUT

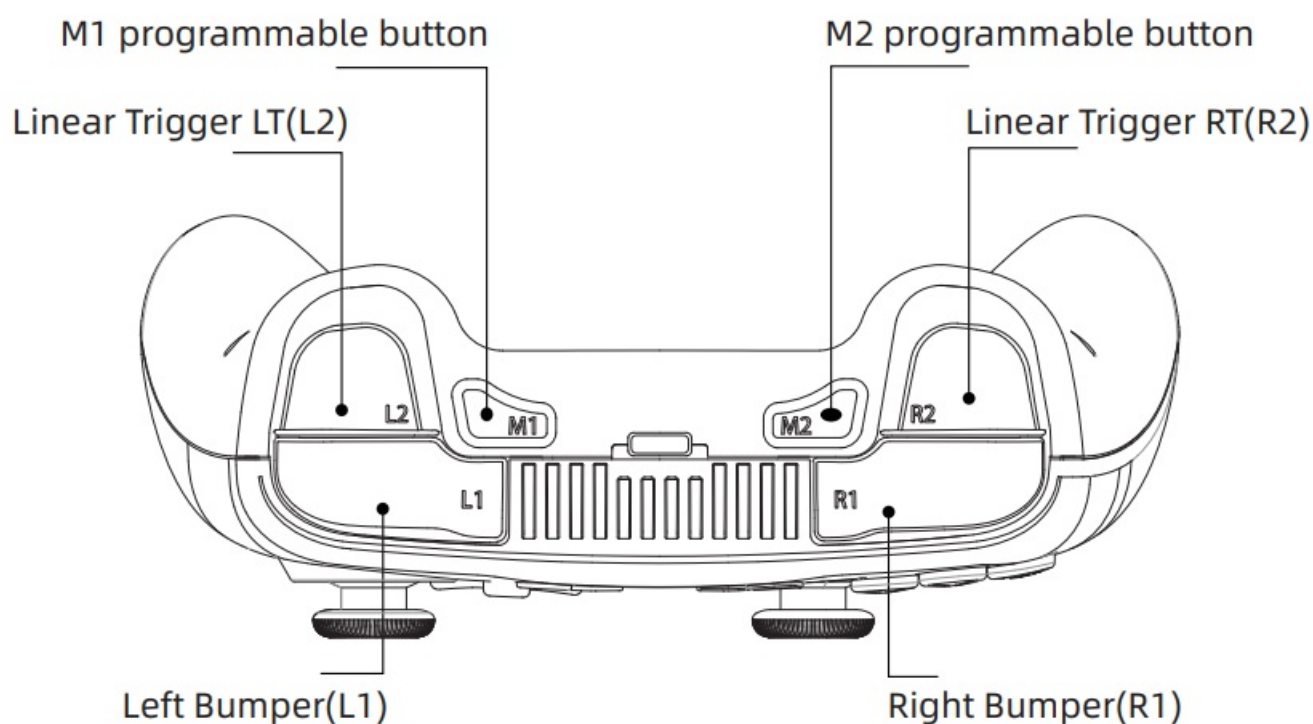
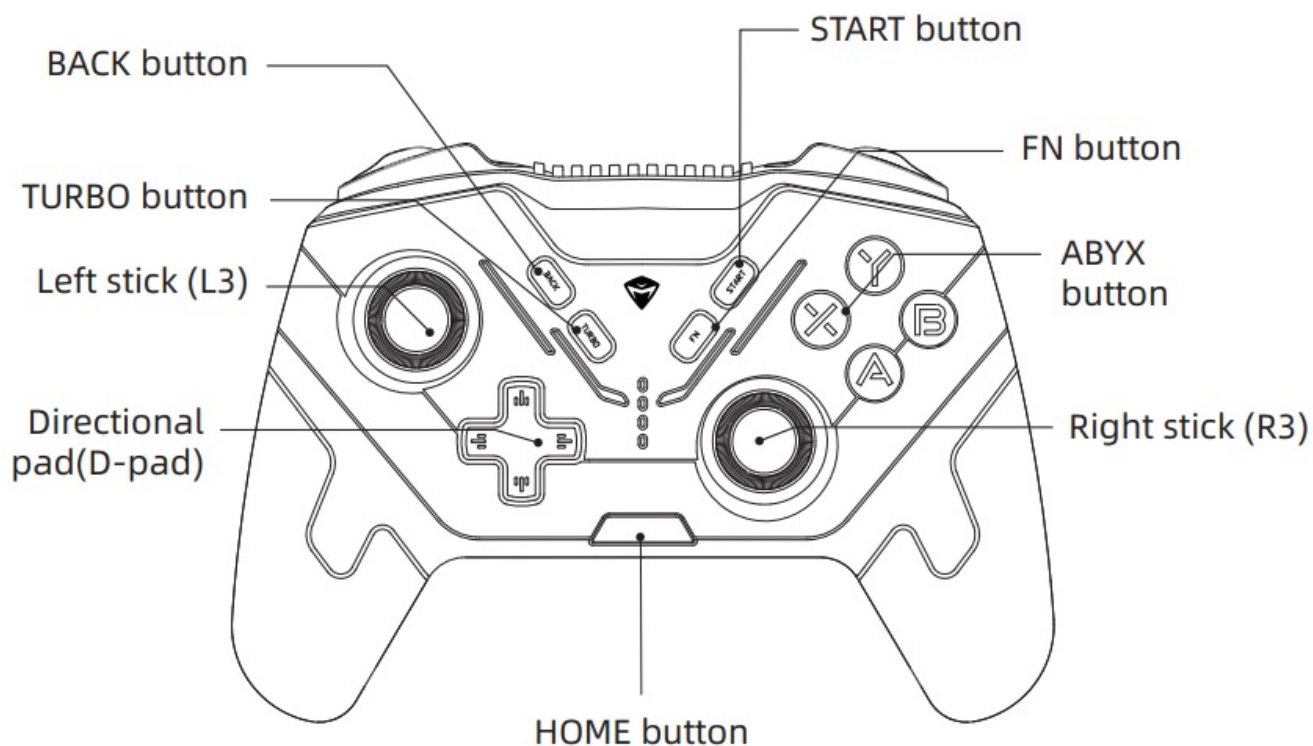

CONNECTION

- The product has wake-on function, please select the corresponding device mode before connecting wirelessly.
- **X**: Wireless Xinput mode/PC mode-the name of the device: Xbox Wireless Controller.
- **D**: Wireless Dinput/Android mode-device name: MACHENIKE HG510W;

- **S:** Switch mode-the name of the device: Pro Controller;
- **V:** Apple IOS mode-device name: Xbox Wireless Controller;
- **Enter pairing mode:** Press and hold the Home button for 3 seconds in the off state, and when the indicator light flashes quickly, you will enter the pairing mode, just connect the corresponding device name above.
- **Change the pairing device:** Press and hold the Home button for 5 seconds to turn off the controller, then select the mode corresponding to the device, and press the Home button for 3 seconds to enter the pairing mode and pair again.
- **Wired connection:** Use the USB cable to connect the device directly.

COMPATIBILITY

Xinput Mode-Windows 8/10/11

Windows operating system compatible with Xinput mode and S mode.

- Xinput mode is widely used in 3A games and latest games of Microsoft and Steam platform.
- S mode is Switch Pro, It can operate in Windows system, switch on gyroscope function through Steam. The use experience and compatibility depend on the adaptation of different.

Connection – Wireless Connection

1. When the controller is turned off, drag the “game mode switch slider” to the X gear.
2. Press and hold the Home button for 3 seconds, until the 1# indicator flashes, that means the device enter to pairing mode.
3. Turn on Settings in Windows OS – Bluetooth and other devices – Add device- Bluetooth.



4. Select “Xbox Wireless Controller” in the searched Bluetooth devices, and the controller indicator light on means the connection is successful.
5. When you do not use it please press and hold the Home button to turn it off, or it will automatically turn off after 10 minutes.
6. The gamepad has Bluetooth memory function. When the next time you use it, you can wake up the controller by press the Home/LB+RB button for 1 second, it will automatically connect to the computer.

Connection – Wired Connection

When the power is off, directly connect the computer or mobile phone with the data cable.

COMPATIBILITY

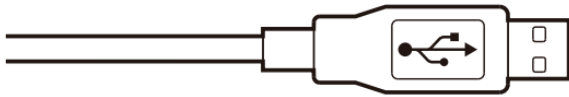

Switch mode-NINTENDO SWITCH

- In s mode, press and hold FN+A buttons for three seconds to switch to the Switch controller layout.
- In S mode, this device support switch, and PC to connect.
- Support use HOME button to wake on controller and remote console wake on .
- The controller support Gyro motion control . It needs to be turned on in the game settings that support this feature.
- Linear stroke function is not supported, due to the limitation of the Switch platform, not a product issue.
- Games that are not compatible with Switch Pro are also not compatible with this device. It is a game limitation, not a product issue.

Connection – Wireless Connection

1. When the controller is turned off, drag the “game mode switch slider” to the S gear.
2. Press and hold the Home button for 3 seconds, until the 2# indicator flashes, that means the controller enter to pairing mode.
3. On Switch homepage -turn on the gamepad- change the grip/order, and wait for it to appear.

Connection – Wired Connection

1. Turn on the wired mode in the Switch settings, and insert the Switch console into the official standard multifunctional dock.
2. It directly connect to the dock and the gamepad through cable when the controller is turned off.

V Mode – For iOS (For iPhone and iPad)

- The trigger Support linear stroke function, requires game compatibility.
- Support HOME button to wake-on the controller and quick connect.
- Configure the controller by Key linker app . check Key linker introduction for more details.
- Compatible with ios15 system version. Please refer to the official iOS system instructions for any subsequent changes to the relevant permissions.

Connections Steps—Wireless Connection

1. When the gamepad is turned off, drag the “game mode switch slider” to the V gear.
2. Press and hold the Home button for 3 seconds, until the 3# indicator flashes, that means the device enter to pairing mode.

3. Turn on the phone settings – Bluetooth, search and connect “Xbox Wireless Controller”

Note: This mode can only be used if the game supports gamepad operation.

ABOUT KEYLINKER

Introduction

Machenike is committed to creating an awesome gaming experience for every gamer. Since there are many platforms support gamepads, and every gamer and even every different game may require different settings to match the game operation. Machenike Key linker supports custom settings for gamepad buttons, trigger , macros and joystick etc.

Download APP-Android/Harmony OS/IOS

- Download the APP and the relevant updated software on Machenike official website.
- URL: <https://global.machenike.com/>
- Please download the Android version for Harmony OS.



Connection steps

1. After download KEYLINKER APP on the phone , when it is started at the first time , the relevant permission application pops up and needs to be confirmed according to the prompts.
2. Turn on the gamepad in any mode, you can search for “HG510W_APP” in the Key linker software homepage.
3. Click “HG510W_APP” to connect and enter the custom interface.

FEATURES

- Multi-platform compatibility, PC, Switch, IOS, Android, Harmony OS ;
- Switch modes via ‘Game mode switch slider’;
- Adjustable brightness & zone light settings;
- Configure your controller via Key linker APP;

EXTENDED FUNCTIONS

Brightness Adjustment

- Press FN + D-pad ←/→ to reduce/enhance the overall light backlighting of the controller.
- Press Fn+ Turbo buttons to change the V-band effect, cycling through constant light/breathing/motion/off.

Vibration Intensity Adjustment

Press Fn + D-pad ↑/↓ to lower/raise the vibration intensity of the controller, adjustable in four steps from 0-3.

Battery Display

- There are four indicator lights on the gamepad, which display the remaining battery power in real time. During pairing and some function adjustments, it will be temporarily used as a function indicator, and will return to the battery display function after 2 seconds.
- The gamepad has a built-in 600mAh lithium battery, which can last about 8-10 hours.

Motion Sensor Control Simulation Function

Press Fn+R3 buttons to turn on/off the motion sensor control simulation of the right stick, which is accompanied by three blinking lights.

EXTENDED FUNCTIONS

Programmable Button Configures Macro

- **Configures macro via controller**
 1. When the controller is connected, press the Fn + M1/M2 button at the same time. Lights start to flow from the V-shaped indicator strip, indicating that it has entered the macro recording state. If it does not flash, please repeat the operation.
 2. Setting the function buttons in sequence. (A/B/X/Y/up/down/left/right/L1/L2/R1/R2 and left right stick)
 3. 42 motions (=21 actions) can be settled. When it is completed, press M1/M2 button again to save. At this time, Lights stop to flow from the V-shaped indicator strip.
- **Configures macro via Key linker App**
 1. Enter the interface in the APP, and select M1/M2 button to record.
 2. Click the recording button to start the recording function. Note: The V-shaped indicator strip of controller will not flash.
 3. Set the function keys in turn, and adjust the duration of each action, and click "Apply" to save the settings in the gamepad.

TURBO Function

Buttons that support TURBO function: A/B/X/Y/Up/Down/Left/Right/L1/L2/R1/R2

Manual TURBO function: When turns on the manual TURBO, you need to press A button to trigger the function.

Turn on the TURBO function: Press Turbo+ A buttons and release. The A button will activate the manual rapid fire function. Press Turbo+ A again, and the A button will activate the automatic rapid fire function. Press Turbo+ A again to turn it off.

TRUBO Speed Adjustment

Press and hold the TURBO button , Right stick up to speed up the rapid fire speed , Right stick down to slow down the rapid fire speed.

TECH SPECS

Executive Standard	Q/0212LSKJ0910-2019
Working Current	10-40mA
Sleep Mode Current	10uA-50uA
Vibration Current	80-130mA
Input Power	5.0V 500mA
Battery Capacity	3.7V/860mAh
Charging Time	About 2-4 hours
Using Distance Range	8M

CONTROL PART

Directional pad (D-pad)*1 Set	This is a raised plus sign-shaped toggle that resides between the left and right sticks.
A, B, X, Y buttons *4Pcs	Mechanical micro switch
Home button *1Pc	Turn on the console or controller
Left and right stick *2Pcs	Hall electromagnetic joystick
Left and right bumper/ triggers *4Pcs	L1.R1.L2.R2. Three-position adjustable linear trigger
TURBO Button *1Pc	Rapid fire mode button
Multi-function button *1Pcs	Support screenshot, light band setting and other function settings in different modes.
Programmable button *2Pcs	Custom programmable M1/M2 back button
The product will go to sleep in about 5 minutes without any operation, the controller light will go out.	

OTHER

DC In Wired Device Connected	USB-A to USB-C
USB Cable Length	About 1 Meter

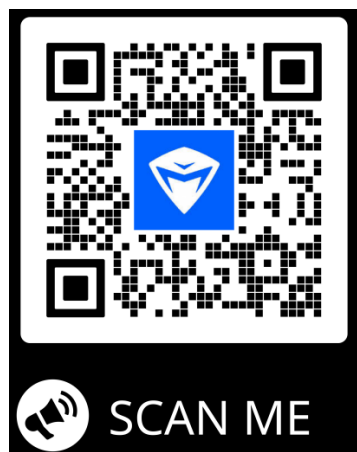



Documents / Resources

	<p>MACHENIKE HG510W Pro Wireless Gamepad Controller [pdf] User Guide HG510W Pro Wireless Gamepad Controller, HG510W Pro, Wireless Gamepad Controller, Gamepad Controller, Controller</p>
--	--

[Manuals+.](#)