



m2cloud m2sn204 Logtrack USB Bluetooth Data Logger User Manual

[Home](#) » [m2cloud](#) » m2cloud m2sn204 Logtrack USB Bluetooth Data Logger User Manual 



USER MANUAL V1

Contents

- 1 Products Contents**
- 2 Main Function**
- 3 Specification**
- 4 LCD Display Overview**
- 5 Software Configuration**
- 6 Replace battery**
- 7 FCC Compliance Statement**
- 8 Documents / Resources**
 - 8.1 References**

Products Contents

LOGTRACK USB Bluetooth Data Logger x1
User manual x1

Main Function

- Temperature measurement and recording
- Export data report as PDF/CSV file through USB
- IP65 waterproof
- LCD display
- Alarm checking
- Replaceable battery
- Bluetooth connetion

Specification

Model	m2sn204
Sensor	Internal temperature sensor
Battery	CR2450, 3V, 500mAh, replaceable
Battery Life	12 months
Size	99.5*50*11.8mm
Weight	50g
Waterproof Level	IP65
Operation Temperature	-30°C~+55°C
Temperature Accuracy	±0.5°C (-20°C~+40°C); ±1°C (others)
LCD Display Resolution	0.1°C
Memory Maximum	1920 recording points
Time Zone	Users programmable, UTC +00:00 (default)
Log Interval	Users programmable, 5 mins (default)
Log Duration	Users programmable, 90 days (default)
Start Delay	Users programmable, 30 mins (default)
Alarm Preset	Users programmable, 2°C-8°C
Data Interface	USB 2.0
Temperature Unit	°C



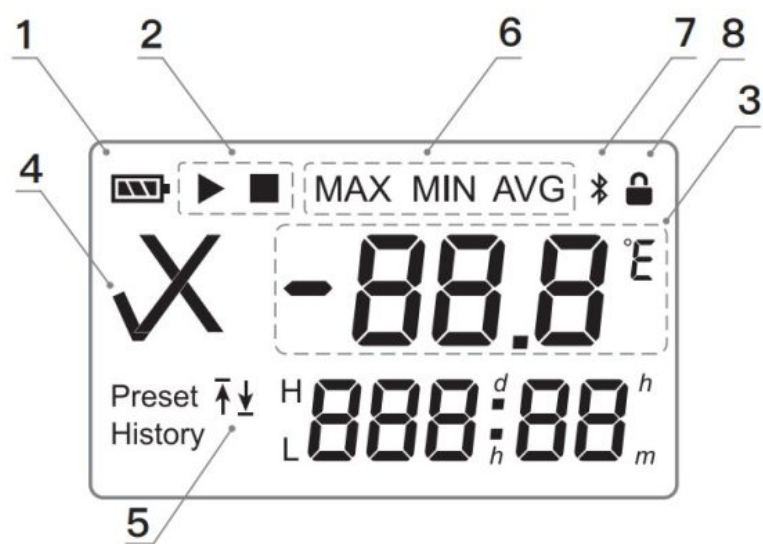

LCD Display Overview



Overview

No./ Icon	Function	Instruction
1	Battery level	 Battery low, Please replace the battery promptly. Battery replacement may result in the loss of the time settings. Please reconfigure the parameters after replacing battery.
2	Recording state	▶ Recording ■ Stopped
3	Temperature data	Display the last recorded temperature data
4	Alarm state	Normal: ✓ Alarm: ✕
Preset	Alarm preset value	The high/low temperature alarm setting
5	Status Connection	Show when Bluetooth connected , hide when disconnect
6	Historical data analysis	MAX/MIN/AVG
7	Bluetooth status	Show when Bluetooth is working proper
8	Lock status	Show when set password

Display Examples

1		The device is recording, and there are alarms. The last recorded temperature is 8.7°C. The remaining data to record is 90 days.
2		During the data recording, the average temperature is 8.4°C, and the recording duration is 12 days.
3		During the data recording, the minimum temperature is 1.3°C, and the cumulative time of exceeding the preset lowest alarm temperature lasts 6 hours and 45 minutes.
4		During the data recording, the maximum temperature is 8.7°C, and the cumulative time of exceeding the preset highest alarm temperature lasts 5 hours and 25 minutes.



Software Configuration

If you want to use LOGTRACK software to configure LOGTRACK USB, please download from www.logtrack.io/softwares, then install and open the software.

Connect logger to USB port of computer, software will connect and sync the logger automatically, then user could start configuring

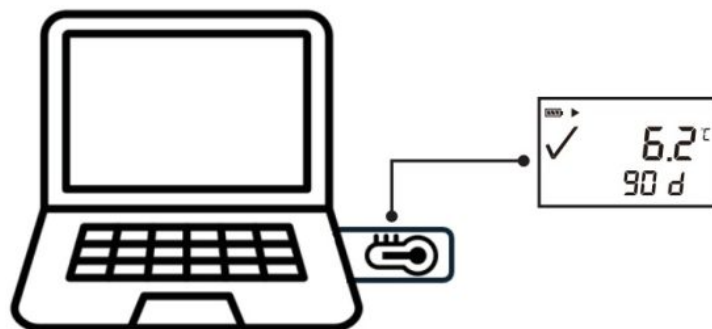

Replace battery

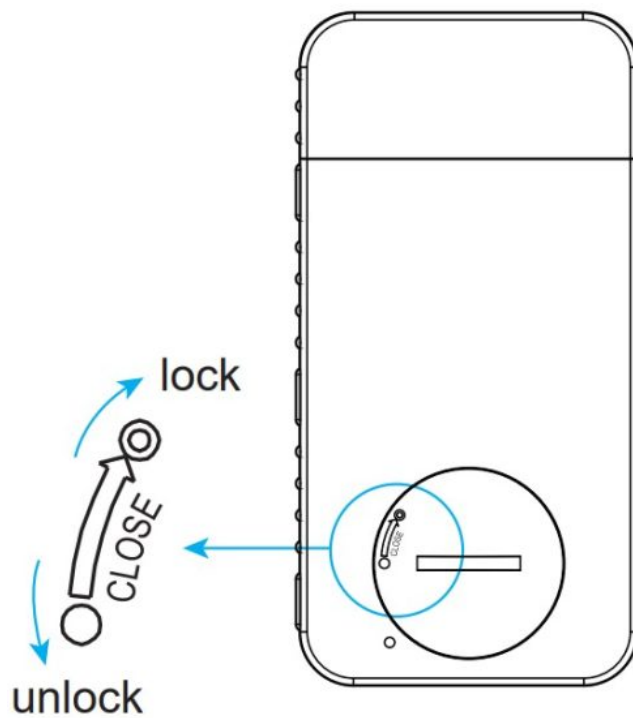

Note:

Battery replacement may result in the loss of the time settings. Please reconfigure the parameters after replacing battery.

FCC Compliance Statement

This device complies with part 15 of the FCC Rules. Operation is subject to the following two conditions:

(1) This device may not cause harmful interference.

(2) this device must accept any interference received, including interference that may cause undesired operation.

This device has been tested and found to comply with the limits for a Class B digital device, pursuant to Part 15 of the FCC Rules. These limits are designed to provide reasonable protection against harmful interference in a residential installation. This equipment generates, uses and can radiated radio frequency energy and, if not installed and used in accordance with the instructions, may cause harmful interference to radio communications. However, there is no guarantee that interference will not occur in a particular installation. If this equipment does cause harmful interference to radio or television reception, which can be determined by turning the equipment off and on, the user is encouraged to try to correct the interference by one or more of the following measures:

- Reorient or relocate the receiving antenna.
- Increase the separation between the equipment and receiver.
- Connect the equipment into an outlet on a circuit different from that to which the receiver is connected.
- Consult the dealer or an experienced radio/TV technician for help.

Caution: Changes or modifications not expressly approved by the party responsible for compliance could void the user's authority to operate the equipment.



	<p>m2cloud m2sn204 Logtrack USB Bluetooth Data Logger [pdf] User Manual M2SN204, 2BLSJ-M2SN204, 2BLSJM2SN204, m2sn204 Logtrack USB Bluetooth Data Logger, m2sn204, Logtrack USB Bluetooth Data Logger, USB Bluetooth Data Logger, Bluetooth Data Logger, Data Logger</p>
---	--

References

- [User Manual](#)

[Manuals+.](#) [Privacy Policy](#)

This website is an independent publication and is neither affiliated with nor endorsed by any of the trademark owners. The "Bluetooth®" word mark and logos are registered trademarks owned by Bluetooth SIG, Inc. The "Wi-Fi®" word mark and logos are registered trademarks owned by the Wi-Fi Alliance. Any use of these marks on this website does not imply any affiliation with or endorsement.