



**Combination Smoke  
and Carbon Monoxide Alarm**  
USER MANUAL

MODEL: SC200/SC220/SC240



Smartie International LLC  
Email: [support@aegislink.co.uk](mailto:support@aegislink.co.uk)

F.1.05.SC2003

This user manual contains important information regarding the installation and operation of your combination smoke and carbon monoxide alarm. Please take a few minutes to thoroughly read this manual which should be saved for future reference. If you are installing this smoke and carbon monoxide alarm for use by others, you must leave this manual—or a copy of it—with the end user.

## Introduction

This combination smoke and carbon monoxide alarm conforms with UL 217 and UL 2034 standards and is designed to detect both smoke and carbon monoxide.

## Package Contents

Alarm Unit × 1  
Mounting Bracket × 1  
Screw × 2  
Anchor Plug × 2  
User Manual × 1

## Product Features

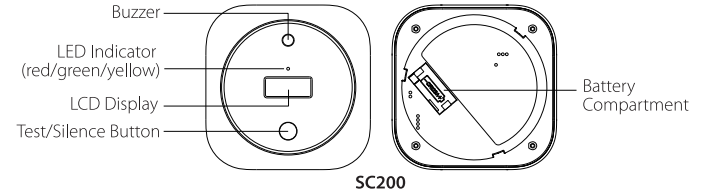

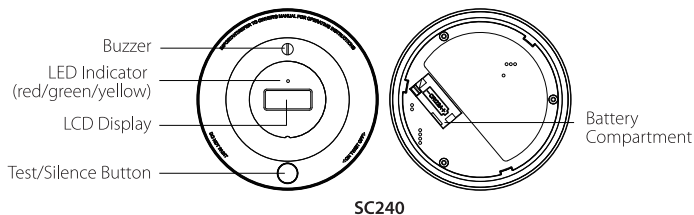
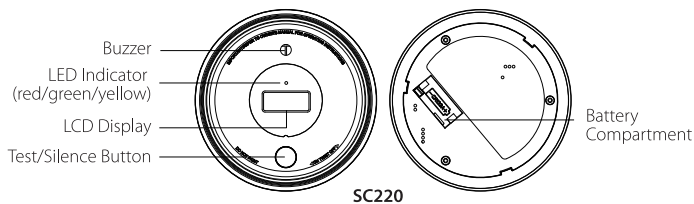

## Test/Silence Button

The test/silence button is used to test the unit's electronics and to silence the unit during an alarm. When testing the alarm weekly, press the test button until you hear a short beep, indicating that the alarm has entered the test mode. Please refer to the "Alarm Test" section for further information. The alarm goes back to the standby mode after testing.

**Note:** After a test has begun, the alarm will sound and the LED will flash red. This does not indicate that smoke/CO is present.

## Silence Mode

### Smoke Silence Mode:

Press the test button during an alarm to have the unit enter silence mode for 9 minutes. If the smoke concentration has reached an alarm level, after the silence time has expired, this unit will continue to alarm until the smoke concentration decreases to a safe, low level. Otherwise, the alarm will enter the normal mode after 9 minutes.

### CO Silence Mode:

Press the test button during an alarm to have the unit enter silence mode. If the CO density still exceeds the alarm threshold, the unit will re-enter alarm state. Otherwise, the unit will exit the silence mode after 9 minutes and resume normal operation.

## Buzzer

The alarm will sound when there is smoke or CO present, when testing the alarm, and when there is a fault.

## LED Indicator

The LED indicator will flash in conjunction with the buzzer. Therefore, it will flash during the following states: when powering on, in standby mode, during smoke or CO alarm states, when exiting an alarm state, during test mode, when there is low battery, in silence mode, when there is a fault and when the unit is at the end of its life.

## Low Battery

The LED indicator will flash yellow together with one beep every 60 seconds. If you press the test button when there is low battery, the low battery signal will temporarily cease for 10 hours.

## End of Life

Once the maximum lifetime (10 years) is reached, the alarm will deliver 3 beeps and the LED indicator will flash yellow 3 times every 60 seconds. This end-of-life signal can be temporarily silenced for 22 hours by pressing the test button.

The end-of-life silence feature can only be used for a total of 30 days. After 30 days, the end-of-life signal cannot be silenced.

## Basic Safety Information

### ⚠ IMPORTANT!

1. DANGERS, WARNINGS, AND CAUTIONS ALERT YOU TO IMPORTANT OPERATING INSTRUCTIONS OR TO POTENTIALLY HAZARDOUS SITUATIONS. PAY SPECIAL ATTENTION TO THESE SITUATIONS.
2. THIS COMBINATION SMOKE & CARBON MONOXIDE ALARM IS ONLY APPROVED FOR HOME USE.
3. THIS CARBON MONOXIDE ALARM IS DESIGNED TO DETECT CARBON MONOXIDE FROM ANY SOURCE OF COMBUSTION.
4. CONSTANT EXPOSURES TO HIGH OR LOW HUMIDITY MAY REDUCE BATTERY LIFE.
5. SMOKE ALARMS ARE NOT TO BE USED WITH DETECTOR GUARDS UNLESS THE COMBINATION HAS BEEN EVALUATED AND FOUND SUITABLE FOR THAT PURPOSE.

### ⚠ CAUTION!

THIS SMOKE & CARBON MONOXIDE ALARM HAS TWO SEPARATE ALARMS WHICH WORK INDEPENDENTLY. THE CARBON MONOXIDE ALARM IS NOT DESIGNED TO DETECT FIRE OR ANY OTHER GAS. IT WILL ONLY INDICATE THE PRESENCE OF CARBON MONOXIDE GAS AT THE SENSOR. CARBON MONOXIDE GAS MAY BE PRESENT IN OTHER AREAS. THE SMOKE ALARM WILL ONLY INDICATE THE PRESENCE OF SMOKE THAT REACHES THE SENSOR. THE SMOKE ALARM IS NOT DESIGNED TO DETECT GAS, HEAT OR FLAMES.

### ⚠ WARNING!

1. NEVER IGNORE ANY ALARM. FAILURE TO RESPOND CAN RESULT IN SERIOUS INJURY OR DEATH.
2. THE SILENCE FEATURE IS ONLY FOR YOUR CONVENIENCE AND WILL NOT CORRECT A PROBLEM. ALWAYS CHECK YOUR HOME FOR A POTENTIAL PROBLEM AFTER ANY ALARM. FAILURE TO DO SO CAN RESULT IN INJURY OR DEATH.
3. TEST THIS SMOKE/CO ALARM ONCE A WEEK. IF THE ALARM EVER FAILS TO TEST CORRECTLY, REPLACE IT IMMEDIATELY! IF THE ALARM CANNOT WORK PROPERLY, IT WILL NOT ALERT YOU TO A PROBLEM.
4. THIS PRODUCT IS INTENDED FOR USE IN ORDINARY INDOOR LOCATIONS OF FAMILY LIVING UNITS. IT IS NOT DESIGNED TO MEASURE CO LEVELS IN COMPLIANCE WITH OCCUPATIONAL SAFETY AND HEALTH ADMINISTRATION (OSHA) COMMERCIAL OR INDUSTRIAL STANDARDS. INDIVIDUALS WITH MEDICAL CONDITIONS THAT MAY MAKE THEM MORE SENSITIVE TO CARBON MONOXIDE MAY CONSIDER USING WARNING DEVICES WHICH PROVIDE AUDIBLE AND VISUAL SIGNALS FOR CARBON MONOXIDE CONCENTRATIONS UNDER 30 PPM. FOR ADDITIONAL INFORMATION ON CARBON MONOXIDE AND YOUR MEDICAL CONDITION CONTACT YOUR PHYSICIAN.
5. THE REPLACEMENT DATE THAT APPEARS ON THE DEVICE IS THE DATE BEYOND WHICH THE DEVICE MAY NO LONGER DETECT CARBON MONOXIDE ACCURATELY AND SHOULD BE IMMEDIATELY REPLACED.
6. THIS DEVICE IS DESIGNED TO PROTECT INDIVIDUALS FROM THE ACUTE EFFECTS OF CARBON MONOXIDE EXPOSURE. IT MAY NOT FULLY SAFEGUARD INDIVIDUALS WITH SPECIFIC MEDICAL CONDITIONS. IF IN DOUBT, CONSULT A MEDICAL PRACTITIONER.

## Installation Positioning

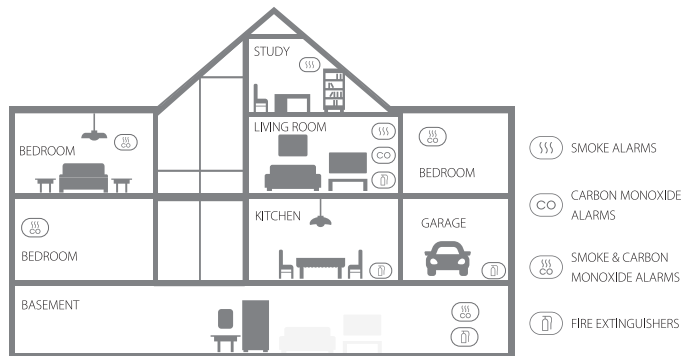

**NOTE: If a smoke alarm is installed in a kitchen, ensure it has an accessible silence button, and install it as far away from the stove and sink as possible to avoid false alarms.**

1. Prioritize the installation of a smoke alarm in the bedroom and walkways, and make sure you can hear the alarm from all sleeping areas. In a home with several bedrooms, install an alarm in every bedroom. If you install only one smoke alarm in your home, install the alarm near to all bedrooms where possible, and not in a basement or furnace room.
2. Install an alarm above the stairway and on every floor of the house.
3. Smoke, heat and anything burning will spread horizontally after rising to the ceiling, so install the alarm in the middle of the ceiling where possible. Ensure that the alarm is installed at the minimum distance away from corner.
4. If an alarm cannot be installed in the middle of a ceiling, install it at a distance of 20 inches (50 cm) away from the corners of the room.

5. If an alarm is installed onto a wall, a distance of 4–12 inches (10–30 cm) should be kept below the ceiling.
6. If the length of a room or hall is beyond 30 feet (900 cm), several alarms should be installed in the same room.
7. When the wall or ceiling is angled, the alarm needs to be installed within 3 feet (90 cm) of the highest wall or ceiling point (measured horizontally) in the room.

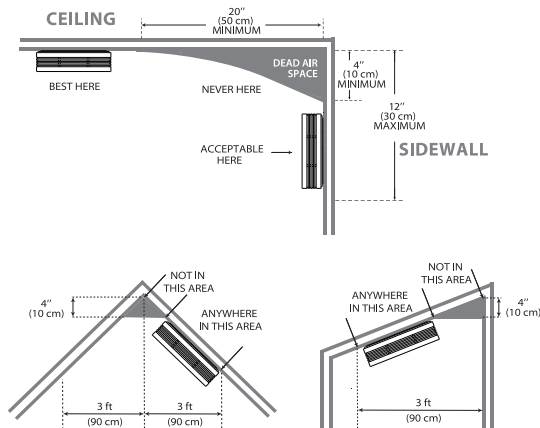

## **⚠ WARNING!**

1. THIS ALARM SHOULD BE INSTALLED BY A COMPETENT PERSON.
2. ALARMS SHOULD NOT BE USED AS A SUBSTITUTE FOR PROPER INSTALLATION, USE AND MAINTENANCE OF FUEL BURNING APPLIANCES INCLUDING APPROPRIATE VENTILATION AND EXHAUST SYSTEMS.
3. TO PREVENT INJURY, THIS DEVICE SHOULD BE SECURELY ATTACHED TO THE CEILING OR WALL IN ACCORDANCE WITH THE INSTALLATION INSTRUCTIONS.
4. BATTERIES SHOULD NOT BE EXPOSED TO EXCESSIVE HEAT SUCH AS DIRECT SUNLIGHT, FIRE, ETC.

## **How to Install This Alarm**

### **⚠ IMPORTANT!**

THIS COMBINATION SMOKE/CO ALARM IS DESIGNED TO BE MOUNTED ON THE CEILING OR WALL.

### **⚠ WARNING!**

FAILURE TO PROPERLY INSTALL AND ACTIVATE THIS ALARM WILL PREVENT PROPER OPERATION OF THE ALARM AND WILL PREVENT ITS RESPONSE TO FIRE HAZARDS OR CO.

## **Locations to Avoid**

**WARNING** - THIS PRODUCT IS INTENDED FOR USE IN ORDINARY INDOOR LOCATIONS OF FAMILY LIVING UNITS. IT IS NOT DESIGNED TO MEASURE CO LEVELS IN COMPLIANCE WITH OCCUPATIONAL SAFETY AND HEALTH ADMINISTRATION (OSHA) COMMERCIAL OR INDUSTRIAL STANDARDS.

1. Do not install in garages, kitchens, furnace rooms or bathrooms! Do not install within 5 ft (1.5 m) of cooking appliances.
2. Do not install within 3 ft (0.9 m) of the following: The door to a kitchen, or a bathroom that contains a tub or shower, forced air supply ducts used for heating or cooling, ceiling or whole house ventilating fans, or other high air flow areas. Avoid excessively dusty, dirty or greasy areas. Dust, grease or household chemicals can contaminate the alarm's sensors, causing the alarm to not operate properly.
3. Place the alarm where drapes or other objects will not block the sensors. Smoke and CO must be able to reach the sensors to accurately detect these conditions. Do not install in peaks of vaulted ceilings, "A" frame ceilings or gabled roofs. Keep out of damp and humid areas.
4. Install at least one (1) foot away from fluorescent lights, as electronic noise may cause nuisance alarms.
5. Do not place in direct sunlight and keep out of insect-infested areas. Extreme temperatures will affect the sensitivity of the smoke/CO alarm.
6. Do not install in areas where the temperature is colder than 40°F (4.4°C) or hotter than 100°F (37.8°C), such as garages and unfinished attics.
7. Do not install in areas where the relative humidity (RH) is above or lower than 10%. Place away from doors and windows that open to the outside.
8. Smoke alarms are not to be used with detector guards unless the combination (alarm and guard) has been evaluated and found suitable for that purpose.

## Installation Method

1. To turn on the alarm, remove the battery insulating film from the battery compartment.
2. Use the mounting bracket to mark the screw holes on the ceiling or the wall.
3. Drill holes at the two marks using an appropriately-sized drill bit. Insert the anchor plugs and screw the mounting bracket using the screws provided.
4. Attach the alarm to the mounting bracket and turn clockwise to lock the alarm.
5. Test the alarm according to the steps in the section below.

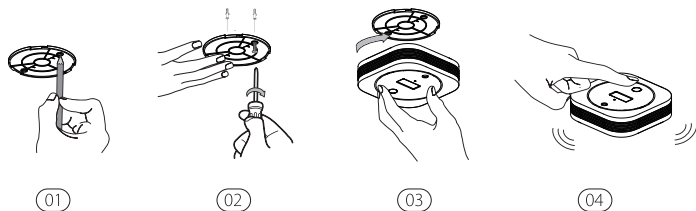

## Alarm Test

The alarm must be properly attached to the mounting bracket before it can be tested.

1. Press the test/silence button.
2. The alarm will emit 2 sets of 3 long beeps followed by 2 sets of 4 quick beeps.
3. The LED will flash red during the audible signal.
4. After testing, the alarm will automatically enter standby mode.

**NOTE:** The test function accurately tests the alarm's smoke sensing circuit without the need to test with smoke and CO. If your alarm fails to emit an audible test signal, refer to the troubleshooting guide at the end of this manual immediately. Never use an open flame to test this device.

## LCD Indicator and Audible Alarm

Modus	LCD Display	LED Indicator	Audible Alarm	Remarks
Powering On		Runs through 8 cycles (yellow/green/red) in sequence.	1 quick beep.	Make sure the battery is installed correctly and the device is turned on.
Standby Mode		Flashes green once every 60 seconds.	None.	None.

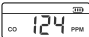
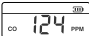
<b>Alarm Mode</b>	Unit detects smoke and initiates an alarm.	-	Flashes red 3 times every 4 seconds.	3 long beeps every 4 seconds.	Dangerous smoke concentration is detected. Open nearby windows and doors, and immediately move to fresh air.
	Unit detects CO and initiates an alarm.		A CO concentration ranging from 30 to 999 ppm has been present for a certain time period. The LED indicator flashes red 4 times every 5.8 seconds.	4 quick beeps repeating every 5.8 seconds.	Dangerous CO concentration is detected, and has reached the alarm status. Open nearby windows and doors, and immediately move to fresh air.
	Unit detects CO (alarm not initiated).		A CO concentration level ranging from 30 to 999 ppm has been detected, but for less than the allotted detection period. The LED indicator flashes green once every 60 seconds.	None.	Dangerous CO concentration is detected, but has not reached the alarm status. Potentially dangerous CO conditions exist.  Please search for the CO source first. Open nearby windows and doors, and immediately move to fresh air.

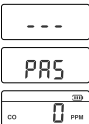
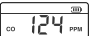
	Unit detected smoke and initiated an alarm.	-	The LED indicator flashes green once every second for 5 seconds.	None.	Alarm cancellation: when the smoke concentration level drops below the alarm threshold, the alarm signal will stop. Then, the alarm goes back to the standby mode.
	Unit detected CO and initiated an alarm.	-	The LED indicator flashes green once every second for 5 seconds.	None.	Alarm cancellation: when the CO concentration level drops below the alarm threshold, the alarm signal will stop. Then, the alarm goes back to the standby mode.
<b>Test Mode</b>			2 sets of 3 red flashes followed by 2 sets of 4 red flashes.	2 sets of 3 long beeps followed by 2 sets of 4 quick beeps.	Press the test/silence button.
<b>Silence Mode</b>	-	-	Flashes red 3 times every 4 seconds.	None.	Smoke silence mode: After 9 minutes, the unit will exit silence mode.
		-	Flashes red 4 times every 5.8 seconds.	None.	CO silence mode: After 9 minutes, the unit will exit silence mode.

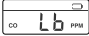
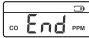
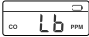
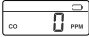
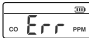
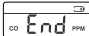

		Flashes yellow once every 60 seconds.	None.	Silence mode during low battery: After 10 hours, the unit will exit silence mode.
		Flashes yellow 3 times every 60 seconds.	None.	Silence mode during the end of cycle: After 22 hours, the unit will exit silence mode.
	-	Flashes green 3 times.	None.	Exiting silence mode.
Low Battery	 	Flashes yellow once every 60 seconds.	One beep every 60 seconds.	Replace the unit immediately.
Fault		Flashes yellow 2 times every 60 seconds.	2 beeps every 60 seconds.	Please clean your alarm and see if it is working normally. If "Err" continues to display, the unit has malfunctioned and must be replaced immediately.
End of Life		Flashes yellow 3 times every 60 seconds.	3 beeps every 60 seconds.	Replace the unit immediately.

## Technical Specifications

Power Supply	Replaceable 3 V CR123A lithium battery
Sensor Type	Smoke: Photoelectric
	CO: Electrochemical
Safety Standards	UL 217 and UL 2034
CO Sensitivity	70 ppm: 60–240 minutes
	150 ppm: 10–50 minutes
	400 ppm: 4–15 minutes
Coverage Area	215–430 sq. ft (20–40 m <sup>2</sup> )
Operating Temperature	40–100°F (4.4–37.8°C)
Operating Relative Humidity	10%–85% (non-condensing)
Alarm Loudness	≥ 85 dB at 10 ft (3 m) @ 3.2 ± 0.3 kHz pulsing alarm
Silence Duration	About 9 minutes

### NOTES

- 1. Battery life is calculated on the current ratings in the weekly test mode and standby mode. If its operation mode changes to an alarming condition, the battery life will be decreased accordingly.*
- 2. This alarm functions between 40 and 100°F (4.4 and 37.8°C). Prolonged exposure to lower or higher temperatures can reduce battery life and affect device performance. We do not recommend operating the device beyond its temperature range.*

## Maintenance

To keep your alarm in good working order, follow these simple steps:

1. Verify the unit's alarm sound and indicator are working properly by testing the unit once a week.
2. As a minimum your alarm should be cleaned once every 3 months: Remove the unit from the ceiling and clean the alarm cover and vents with your vacuum cleaner fitted with the soft brush attachment to remove dust and dirt.
3. Never use detergents or other solvents to clean the unit.
4. Avoid spraying air fresheners, hair spray or other aerosols near the alarm.
5. Do not paint the unit. Paint will seal the vents and interfere with the sensor's ability to detect fire/CO.
6. Never attempt to disassemble the unit or clean inside. Doing so will void your warranty.
7. When removed, place the smoke/CO alarm back in its proper location as soon as possible, to assure continuous protection from fire/CO.
8. When household cleaning supplies or similar contaminants are used, the area should be ventilated.

## Troubleshooting

PROBLEM	SOLUTION
Your combination smoke and carbon monoxide does not sound during testing.	<ul style="list-style-type: none"><li>• Please ensure the battery is properly installed in the alarm.</li><li>• Make sure you push the test/silence button firmly.</li></ul>
False alarms triggered intermittently or when residents are cooking, taking showers, etc.	<ul style="list-style-type: none"><li>• Check the location of your alarm (see "Installation Positioning").</li><li>• Clean the alarm (see "Maintenance").</li></ul>

LED flashes yellow and the alarm sounds 1 beep every 60 seconds.	The battery is low. <b>Replace the battery immediately.</b>
LED flashes yellow 2 times every 60 seconds with 2 beeps.	The alarm is malfunctioning. Please clean your alarm or push the test/silence button once to attempt to reset the unit. If the problem still occurs, <b>replace the alarm immediately.</b>
LED flashes yellow 3 times every 60 seconds with 3 beeps.	The maximum lifetime (10 years) is reached. Push the test/silence button once to silence for 22 hours. <b>Replace the alarm immediately.</b>

## Environmental Protection

Waste electrical products should not be disposed of with household waste. Please recycle where facilities exist. Check with Local Authority or retailer for recycling advice.



## Manufacturer and Service Information

Smartie International LLC  
Address: 160 Greentree Dr, Dover, DE 19904, USA  
Email: support@aegislink.co.uk