

## 01 发射机产品介绍

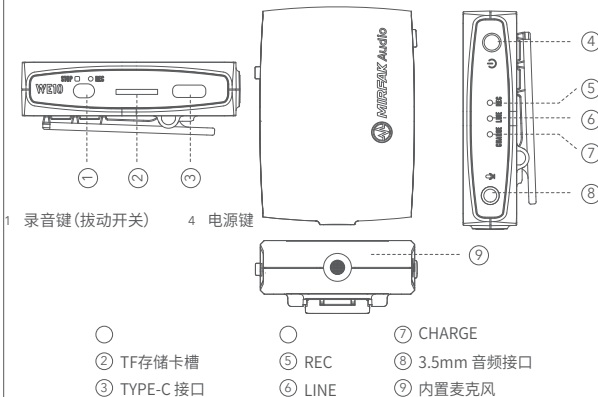

WE10 使用说明书

## 02 发射机操作说明

1. 电源键长按3S开机，长按3S关机，连续3击进入对码状态。
2. 录音键拨动到REC(靠近存储接口)开始录音，拨动开关拨动到STOP(靠近存储接口)远离停止。
3. 存储接口内置TF卡槽，最大可以支持64G扩展内存。
4. 音频接口为标准的3.5mm 4极音频接口，用于外接的麦克风。如果没有外接麦克风，则使用内置麦克风。
5. REC(蓝色)指示录音状态，用于显示是否在录音。
6. LINE(蓝色)指示对码状态，用于指示发射机与接收机的连接是否完好
7. CHARGE(蓝色)指示充电状态，充电时候蓝灯常亮，充满电后蓝灯灭灯。
8. Type-C接口为本机充电接口，支持标准的Type-C充电的，充电电压为5V,0.4A
9. 麦克风采用全指向的咪芯，适用距离30CM以内。
10. 电池采用内置500mah聚合物电池，充电时间为100分钟左右，可以使用超过3.5h。

## 03 接收机产品介绍



## 04 接收机操作说明

1. 电源键长按3S开机，长按3S关机，连续3击进入对码状态。
2. 增益调节键为增益大小调节按键，可以在-18db,-6db,0,+3db,+6db这5个档位之间循环切换。
3. 低切键为低切按键，可以在0Hz,170Hz,230Hz之间循环切换。
4. 静音键为静音按键，可以让接收机静音，默认静音功能关闭。轻轻短按即可开启静音功能。
5. Type-C接口为本机充电接口，支持标准的Type-C充电的，充电电压为5V,0.3A。
6. 音频接口1为音频输出接口，通过配置的音频线，可以将发射机传输过来的语音信号输出到类似手机，单反照相机等设备里面。
7. 音频接口2为监听接口，使用耳机等设备，可以实时监听发射机的麦克风的语音信号
8. 电池采用内置350mah聚合物电池，充电时间为80分钟左右，可以使用超过4h。

## 01 Transmitter Overview

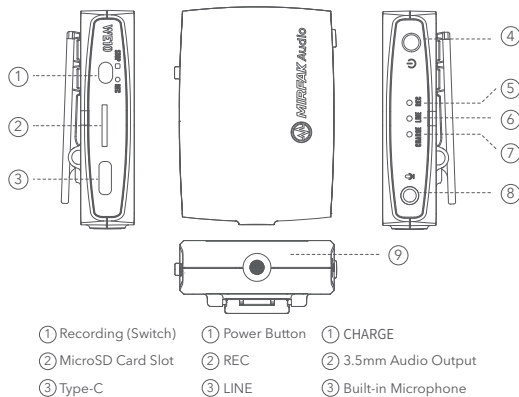

WE10 User Manual

## 02 Transmitter Operating Instructions

1. Press the power button for 3s to turn on or turn off the transmitter, triple-press to enter code matching mode.
2. Turn the recording button to REC(close to the storage interface) to start recording, turn the record button to STOP(away from the storage interface) to stop recording.
3. The storage interface has a MicroSD card slot, which can support up to 64G.
4. The audio interface is a standard 3.5mm 4-pole audio interface for external microphones. If there are no external microphones, please use the built-in microphone.
5. The REC(blue) indicates the recording status and is used to show whether the recording is in progress.
6. The LINE( blue) indicates the status of code matching, which is used to indicate whether the connection between the transmitter and the receiver is intact.
7. The CHARGE( blue) indicates the charging status. The blue light is always on when charging, and is off when fully charged.
8. This machine adopts Type-C charging interface, supports standard Type-C charging, and the charging voltage is 5V,0.4A.
9. The microphone uses an omnidirectional condenser microphone, and the working distance is within 30cm.
10. The battery uses a built-in 500mah polymer battery, the charging time is about 100 minutes, and it can be used for more than 3.5 hours.

## 03 Receiver Overview

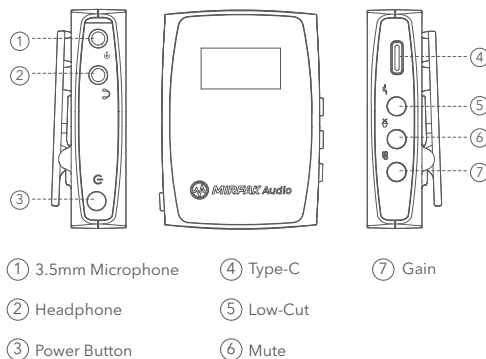

## 04 Receiver Operating Instructions

1. Press the power button for 3s to turn on or turn off the receiver, triple-press to enter code matching mode.
2. The gain button is to adjust the gain, which can be cyclically switched between -18db, -6db, 0, +3db, and +6db.
3. The low-cut button is to adjust the frequency, which can be cyclically switched between 0Hz, 170Hz, and 230Hz.
4. The mute button is to mute the receiver, and the mute function is off by default. Press lightly to turn on the mute function.
5. The Type-C interface is the charging interface, which supports standard Type-C charging, and the charging voltage is 5V, 0.3A.
6. The 3.5mm Microphone① is an audio output interface, through the configured audio cable, the transmitted voice signal can be output to devices like mobile phones, DSLR, and other devices.
7. The Headphone② is an monitoring interface, using headphones, you can monitor the voice signal of the Transmitter in real time.
8. The Receiver uses a built-in 350mah polymer battery, the charging time is about 80 minutes, and it can be used for more than 4hours.

尺寸：90\*65MM  
材质：105G铜版纸