

# 20A Waterproof Solar Controller

## User's Manual



### III. Machine product schematic

Schematic diagram of machine and function introduction of each part.

#### 1. Front of the machine

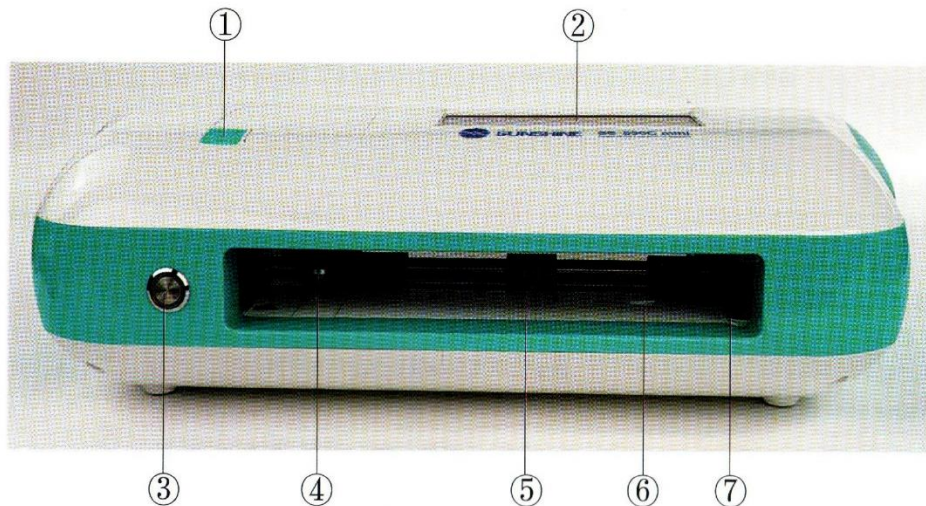

- ①. Replace knife holder button
- ②. LCD display
- ③. Start switch (note: press the switch once when the machine is turned on, the blue light will turn on, and the machine needs to be pressed for 3 seconds to turn off the power before the machine shuts down)
- ④. Knife holder (mounting blade, used for cutting materials)
- ⑤. Platen roller (pressing paper cutting material front and rear movement)
- ⑥. Automatic sensing device
- ⑦. Aligner(Able to perform positioning function when the material is inserted)

#### 2. Back of machine



- ⑧ Power connector (interface to connect to the machine's power adapter).

### 3. Machine power adapter

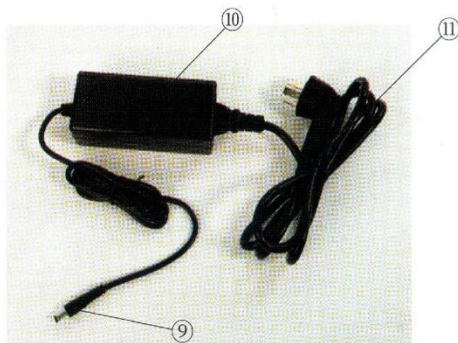

- ⑨. Power cable socket (direct corresponding to the ⑧-position machine power socket, plugged in)
- ⑩. Power adapter (power input AC110-220V wide-band voltage input DC24V=2.75A)
- ⑪. Power cable (connecting power connector)

## IV. Basic operation of the machine

1. The LOGO interface will be displayed when the machine is turned on.

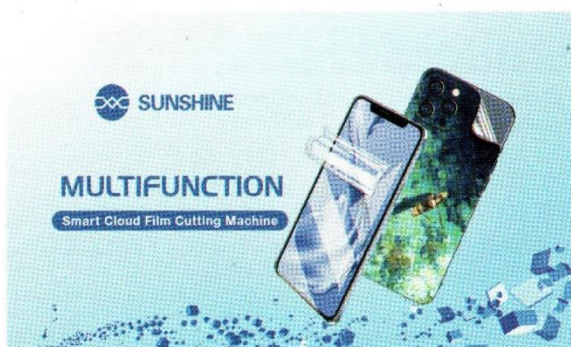

Startup screen



Home

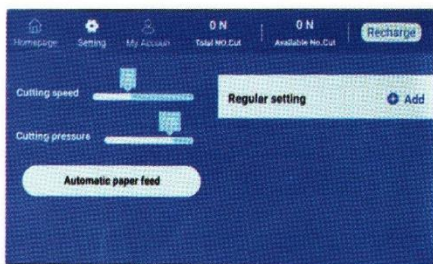

Machine adjustment parameters



Personal center



## 2. Knife holder mounting and adjustment

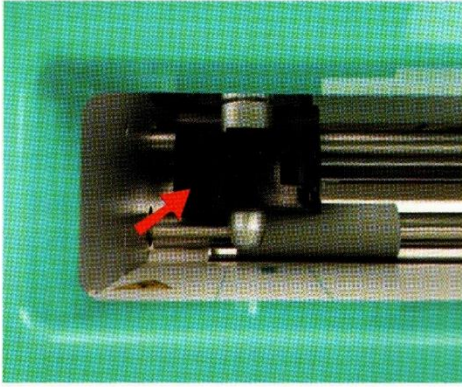

There are 10 gear positions in the knife holder (represented by 123456789AB). The larger the number of the knife tip gear, the longer the extended knife tip, which means the thicker the material that can be cut.

The default knife tip gear of the machine is 5, and other gears can be adjusted according to different material requirements. For example (taking cutting TPU front film as an example, according to the default knife holder gear 5 speed 1 pressure Standard cut for the number of 75, if the material is cut through. Then we need to reduce the knife holder gear to 4 gears, otherwise, if there is no cutting and penetration, we need to adjust Adjust the knife holder to 6 gears.

### Installation of knife holder clamping

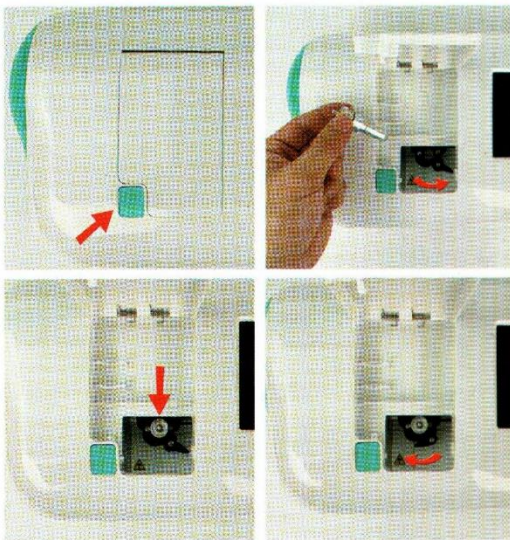

Press the button to open the cover, you can see the knife holder, open the lock to the right, replace the knife holder, and turn the lock back to the left to lock the knife holder.

Incorrectly clamped way can result in the knife and the holder are not in contact with the material, so that the material is not cut or the cut is lower worn.

## 3. Material placement

### 3-1. Automatic induction of materials

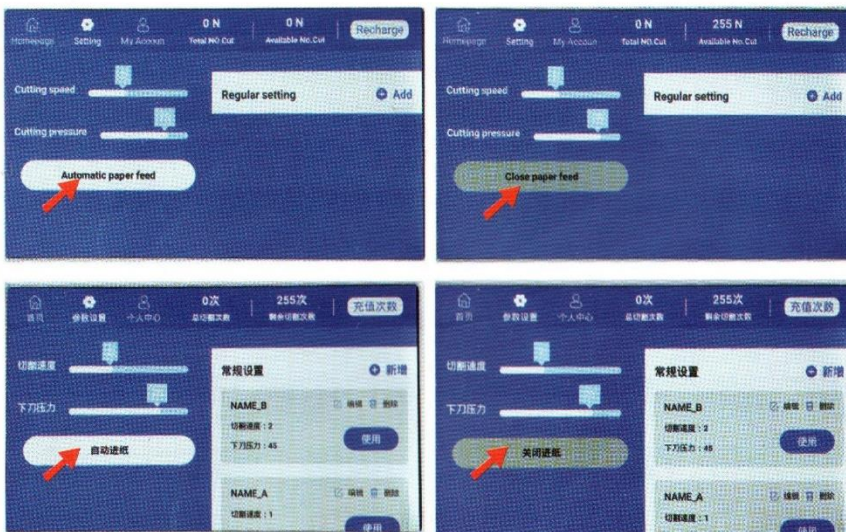



- ①. WIFI operation mode: Click the parameter setting "Open paper feed" on the main screen, and the "Close paper feed" button is displayed, and the automatic paper feed function has been turned on.



- ②. Mobile APP operation mode: Click the parameter setting "Automatic paper feed", and the "Close paper feed" button is displayed, the automatic paper feed function has been turned on.

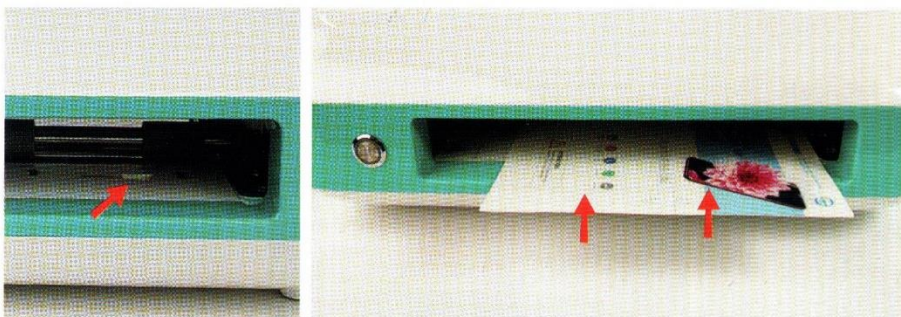

Cover the sensor with the front film and press the roller forward, The material is placed along the automatic sensing device in the middle of aligner, and the machine will automatically push the material to the starting position of cutting. You can proceed to the next cutting operation. (Note: It is not recommended to use the automatic paper feeding method for the rear film).

### 3-2. Manually feed materials

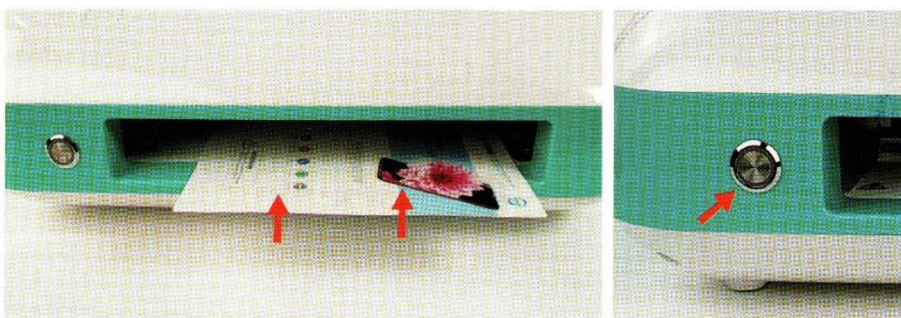

- Step 1: The material is pushed along the middle of aligner and pushed directly to the bottom to hold the blade;  
Step 2: Press the power button once to cut the material in and proceed to the next cutting operation.



## V. Software operation

### 1. Wifi connection operation method



Connect to wifi, Enter the serial number,Serial number login

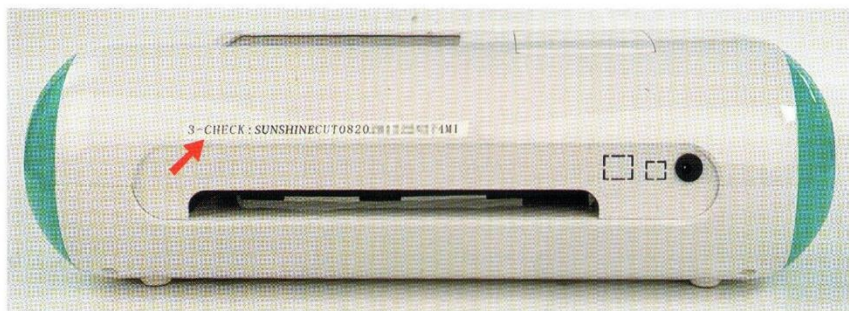

Enter the serial number and click OK to enter the system



Enter the homepage to cut. Select the category to be cut and go to the next page. Select the category you want. After the machine is successfully connected, you can select the categories that need to be cut in the software, such as: mobile phone front film, mobile phone back film, watches, headphones, etc.





After selecting the model, a single mobile phone model of this brand of mobile phone will appear under the sub-category of each model. According to the customer's needs, select the specific model of a single mobile phone, or you can directly search for the desired model through the mobile phone search.



Use search to find the desired model

The relative file model will also appear after the search character. Then select the corresponding phone model and enter the data preview interface.

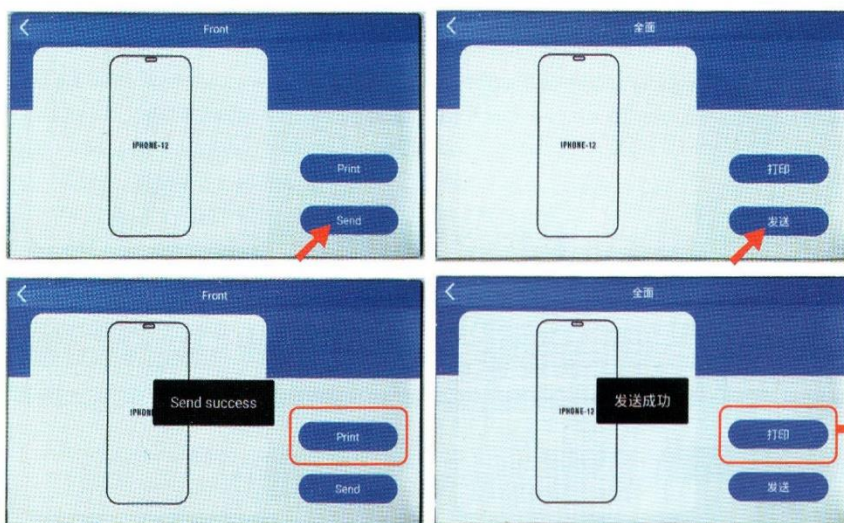
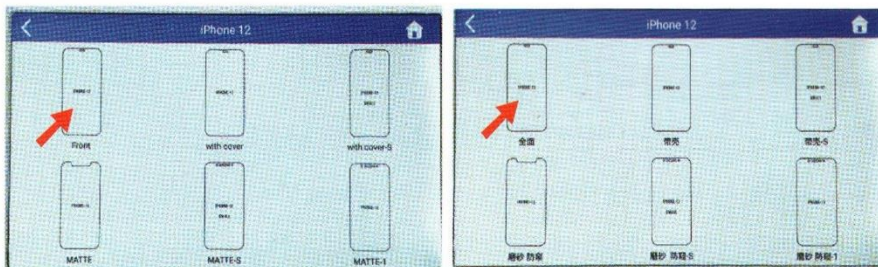

Note: The print button of the system is for the extended use of the follow-up DIY printing function and is not currently open.

After entering the interface of the mobile phone preview, you can see a preview of the line data that needs to be cut. There are vector graphics and corresponding shapes and models that need to be cut. Click to send.

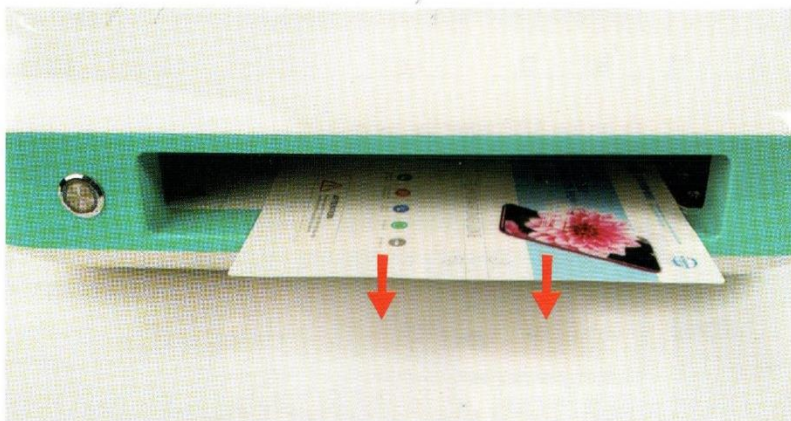

The software will prompt to send successfully. Output data to the mobile phone film cutting machine via Wifi, The machine starts working to cut out the finished product. The cutting operation is completed!

## 2. Bluetooth connection APP operation method



Software APP installation, divided into Android mobile phone and IOS system mobile phone. Android phones can be installed by scanning the QR code or by searching our software "CutFilm" icon in the application market. The needs of the IOS system are installed through Apple's APP Store, and the "CutFilm" application is directly searched for the icon to install.

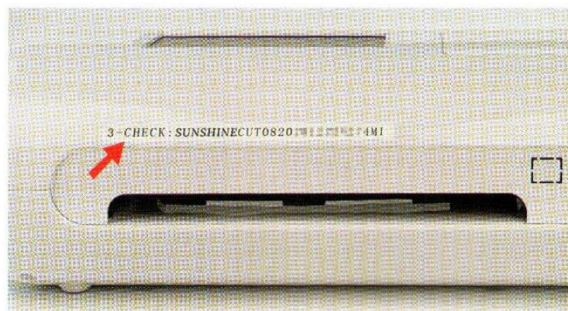

Open the APP, enter the serial number on the back of the machine to log in.



The machine Bluetooth display connection is successful. Explain that the machine and APP are connected.



Enter the homepage to cut. Select the category to be cut and go to the next page.

Select the category you want. After the machine is successfully connected, you can select the categories that need to be cut in the software, such as: mobile phone front film, mobile phone back film, watches, headphones, etc.

For example, after clicking the mobile phone front film command, select the mobile phone brand model type.

Such as. Apple, Samsung, Huawei and other brand models. Click on the model to go to the next option.

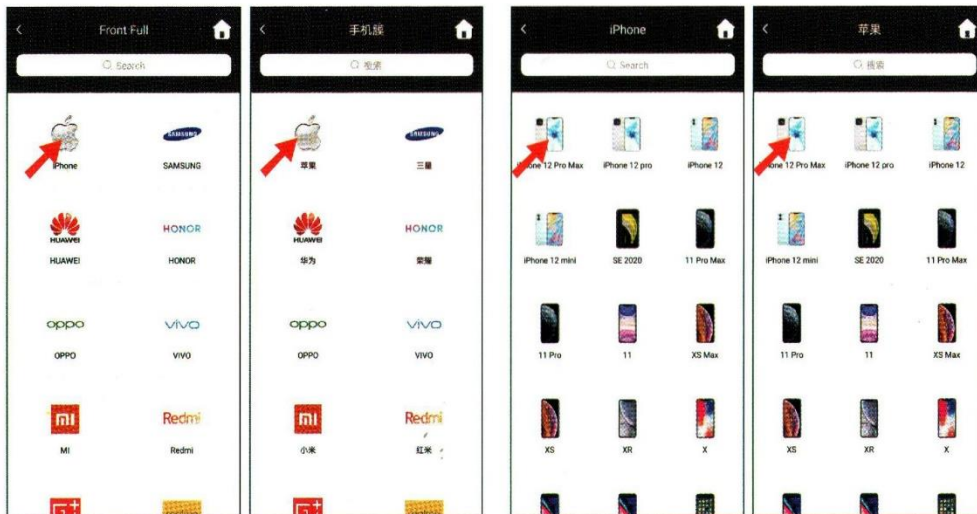

After entering the interface of the mobile phone preview, you can see a preview of the line data that needs to be cut. There are vector graphics and corresponding shapes and models that need to be cut. Click to send.

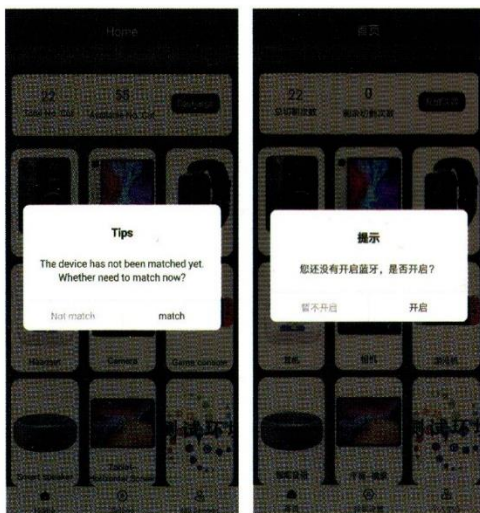

After the login interface is successful, the software will detect if your phone has the Bluetooth settings turned on. If the phone has Bluetooth enabled, it will automatically skip and will not prompt.

If the phone does not have Bluetooth turned on, you will be prompted to turn on Bluetooth.

After turning on the Bluetooth function, go to the Bluetooth connection and search interface. Search for connected machine Bluetooth.

At this time, the machine should be in the boot state, the software will automatically prompt the Bluetooth status of the machine, click on the link to Bluetooth.

It shows that the match is successful and the Bluetooth connected.

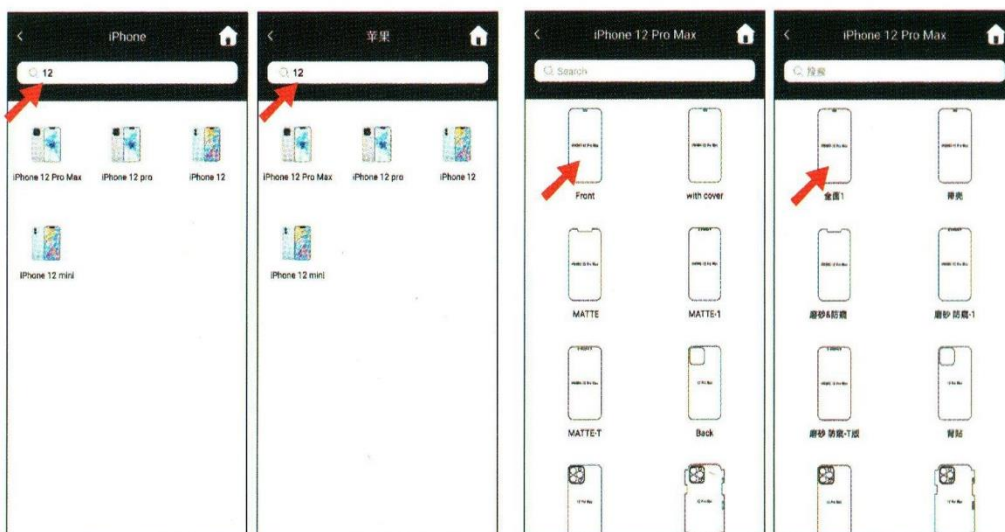



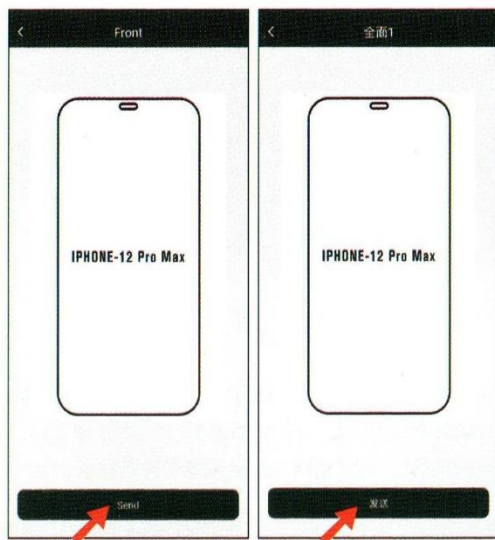

The relative file model will also appear after the search character. Then select the corresponding phone model and enter the data preview interface. After entering the interface of the mobile phone preview, you can see a preview of the line data that needs to be cut. There are vector graphics and corresponding shapes and models that need to be cut. Click to send.

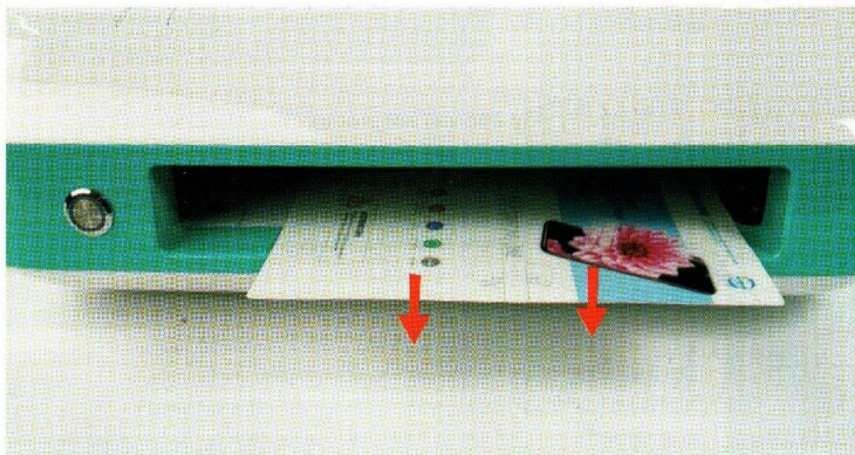

The software will prompt to send successfully. Output data to the mobile phone film cutting machine via Bluetooth. The machine starts working to cut out the finished product. The cutting operation is completed!

## VI. Operation of the machine

The above steps need to be completed before the machine is officially cut:

Connect the power supply → turn on the power supply → install the knife holder and the knife → put the material pressure → Log in to the main screen system of the machine.



Blue light 蓝灯

1. Connect the power cable and turn on the power, (The machine presses the power switch to display the blue light, and the power is turned on after the screen is lit). Detect installed knives and placed materials (After the knife holder is adjusted according to the instruction. The material can be installed according to the instructions in Section).



2. Go to the page for cutting



3. Select cutting data



Choose mobile phone

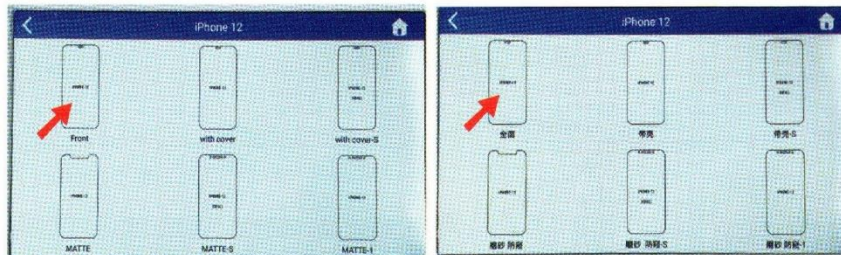

Select specific



Send data

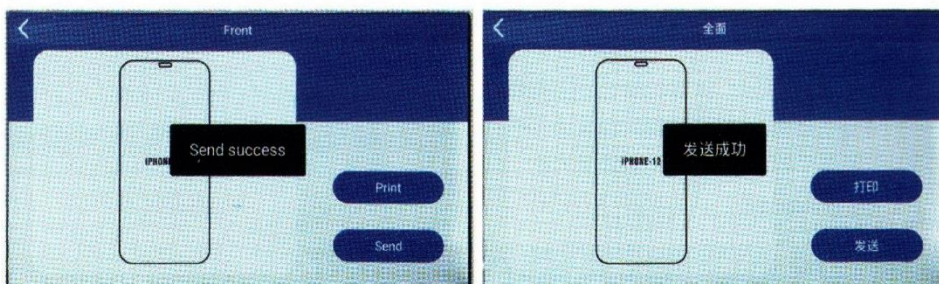

The software will prompt that the transmission is successful and the machine will start working for cutting.



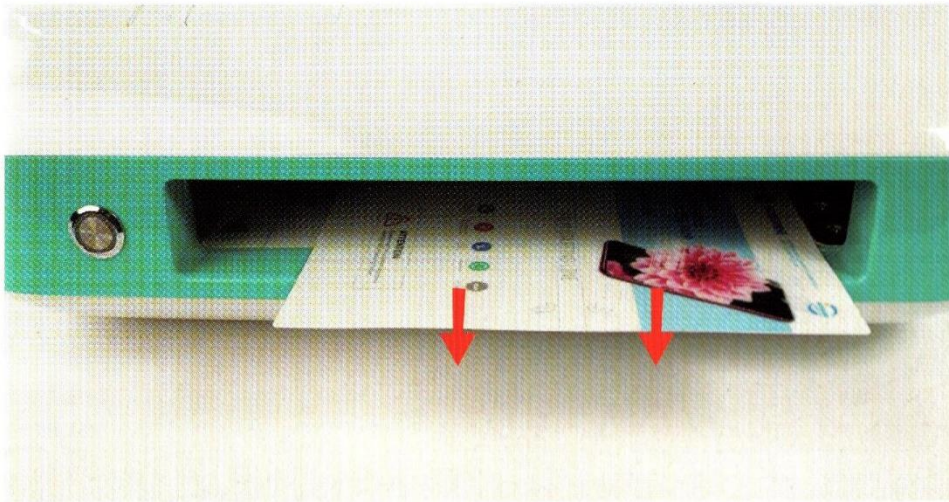

After the machine receives the data, it will automatically start cutting according to the path, After the cutting, the material is automatically withdrawn and the cutting is completed.

Recharge operation method of film cutting machine cutting times

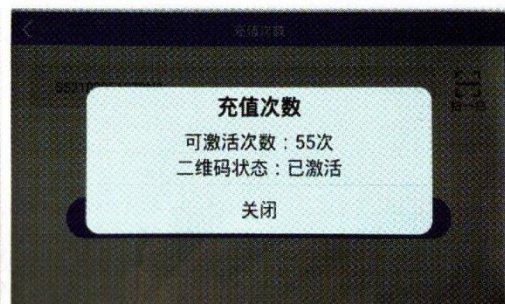
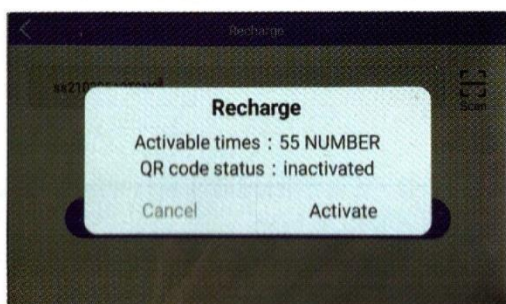
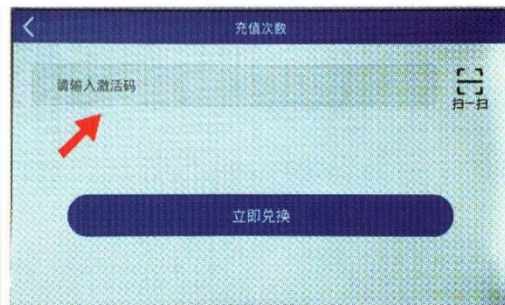
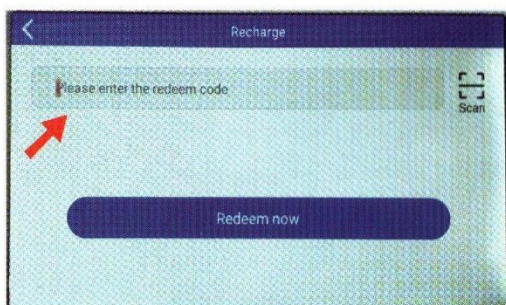

Locate the recharge code on the label on the back of the film package, scratch off the coating, enter the recharge code or scan via mobile APP recharge by QR code



## Recharge operation method of film cutting machine cutting times



Locate the recharge code on the label on the back of the film package, scratch off the coating, enter the recharge code or scan via mobile APP recharge by QR code