

SA-75

USER'S GUIDE

Safety Precautions
Before trying to use the keyboard, be sure to read the separate "Safety Precautions".

CASIO

MA0312-A Printed in China

Be sure to read this User's Guide and keep it on hand for future reference. Parents or guardians should make sure that young children using this instrument are familiar with the contents of this User's Guide.

GUIDELINES LAID DOWN BY FCC RULES FOR USE OF THE UNIT IN THE U.S.A. (not applicable to other areas)

NOTICE

This equipment has been tested and found to comply with the limits for a Class B digital device, pursuant to Part 15 of the FCC Rules. These limits are designed to provide reasonable protection against harmful interference in a residential installation. This equipment generates, uses and can radiate radio frequency energy and, if not installed and used in accordance with the instructions, may cause harmful interference to radio communications. However, there is no guarantee that interference will not occur in a particular installation. If this equipment does cause harmful interference to radio or television reception, which can be determined by turning the equipment off and on, the user is encouraged to try to correct the interference by one or more of the following measures:

- Reorient or relocate the receiving antenna.
- Increase the separation between the equipment and receiver.
- Connect the equipment into an outlet on a circuit different from that to which the receiver is connected.
- Consult the dealer or an experienced radio/TV technician for help.

FCC WARNING

Changes or modifications not expressly approved by the party responsible for compliance could void the user's authority to operate the equipment.

Important Information for Parents!

Parents should please note the following important information before letting children use this product.

- Before using the optional AD-1 Adaptor to power the unit, be sure to check the AC Adaptor for any damage first. Carefully check the power cord for breakage, cuts, exposed wire and other serious damage. Never let children use an AC adaptor that is seriously damaged.
- Never attempt to recharge batteries.
- Do not use rechargeable batteries.
- Never mix batteries of different types.
- Never mix old batteries with new ones.
- Use only the batteries recommended in this manual or equivalent batteries.
- Always make sure that positive (+) and negative (–) poles are facing correctly as indicated near the battery compartment.
- Remove batteries as soon as they show any sign of going dead.
- Do not short-circuit the battery terminals.
- The product is not intended for children under 3 years.
- Use only CASIO AD-1 adaptor.
- The AC adaptor is not a toy.
- Be sure to disconnect the AC adaptor before cleaning the product.



CASIO ELECTRONICS CO., LTD.
Unit 6, 1000
North Circular Road
London NW2 7JD, U.K.
This mark is valid in the EU countries only.
Please keep all information for future reference.



This recycle mark indicates that the packaging conforms to the environmental protection legislation in Germany.
Esta marca de reciclaje indica que el empaquetado se ajusta a la legislación de protección ambiental en Alemania.

CASIO COMPUTER CO., LTD.
6-2, Hon-machi 1-chome
Shibuya-ku, Tokyo 151-8543, Japan

Low Batteries

Any of the symptoms listed below can indicate that battery power is too low. Replace batteries as soon as possible whenever you experience any of the following.

- Dim power indicator
- Low sound volume
- Distorted sound
- Loss of output when playing at loud volume
- Sudden power loss when playing at loud volume
- Sudden output of sound when no keyboard key is pressed
- Output of a tone different from the one that is selected
- Incorrect play of patterns or built-in tunes
- Sudden loss of sound output
- Dim display figures
- Dimming of display figures when playing at loud volume

Care of your keyboard

Avoid heat, humidity or direct sunlight.

Do not overexpose the instrument to direct sunlight, or place it near an air conditioner, or in any extremely hot place.

Do not use near a TV or radio.

This instrument can cause video or audio interference with TV and radio reception. If this happens, move the instrument away from the TV or radio.

Do not use lacquer, thinner or similar chemicals for cleaning.

Clean the keyboard with a soft cloth dampened in a weak solution of water and a neutral detergent. Soak the cloth in the solution and squeeze until it is almost dry.

Power Supply

The two-way power supply of this keyboard lets you use either batteries or household AC power. Always be sure to turn off power whenever you are not using the keyboard.

Battery Power

Be sure to turn keyboard power off before loading batteries.

Battery Replacement

- Remove the battery compartment cover by sliding it in the direction of the arrow indicated in the figure.
- Load 5 AA-size batteries into the battery compartment.
 - Make sure that the positive (+) and negative (–) ends are facing correctly.
- Replace the battery compartment cover by sliding it.
- Loading batteries while power is turned on will cause the keyboard to malfunction. If this happens, turn power off and then back on again.

Battery Life

Approximately six hours with R6P (SUM-3) manganese batteries (normal temperature and optimum volume setting). Note that battery life can be shortened by playing at high volume or by very cold temperatures.

AC Power

Use only the AC adaptor model specified for this keyboard.

AC Adaptor Model: AD-1

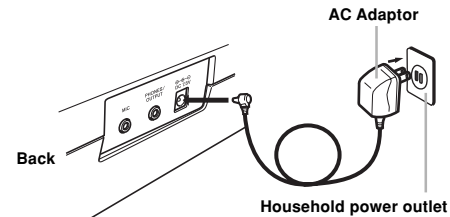

WARNING

- Take care to avoid damage to the power cord. Never place heavy objects on the cord and keep it away from heat. A damaged power cord creates the danger of fire and electrical shock.
- Use only the AC adaptor model specified for this keyboard. Use of any other AC adaptor model creates the danger of fire and electrical shock.

CAUTION

- Always unplug the AC adaptor from the power outlet if you do not plan to use the keyboard for a long time, such as when leaving on a trip, etc.
- When not using the keyboard, turn off power and unplug the AC adaptor from the power outlet.

IMPORTANT!

- Be sure that keyboard power is turned off before connecting or disconnecting the AC adaptor to it.
- The AC adaptor may become warm to the touch after long-term use. This is normal and does not indicate malfunction.

Connections

Using the Phones/Output Jack

Before connecting headphones or other external equipment, be sure to first turn down the volume settings of the keyboard and the connected equipment. You can then adjust volume to the desired level after connections are complete.

[Rear Panel]

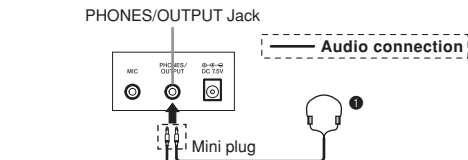

Connecting Headphones (Figure ❶)

Connecting headphones cuts off output from the keyboard's built-in speakers, so you can play even late at night without disturbing anyone.

Musical Instrument Amplifier (Figure ❷)

Use a commercially available connecting cord to connect the keyboard to a musical instrument amplifier.

Using the Headset Mike

Connecting the accompanying headset mike to the MIC jack on the back of the keyboard makes it possible for you to sing along with built-in tunes.

<Parts>

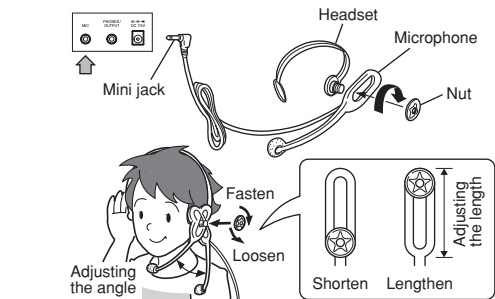

IMPORTANT!

- If the microphone gets too close to the speaker, you may experience a howling noise called "feedback". When this happens, move the microphone away from the speaker.

General Guide

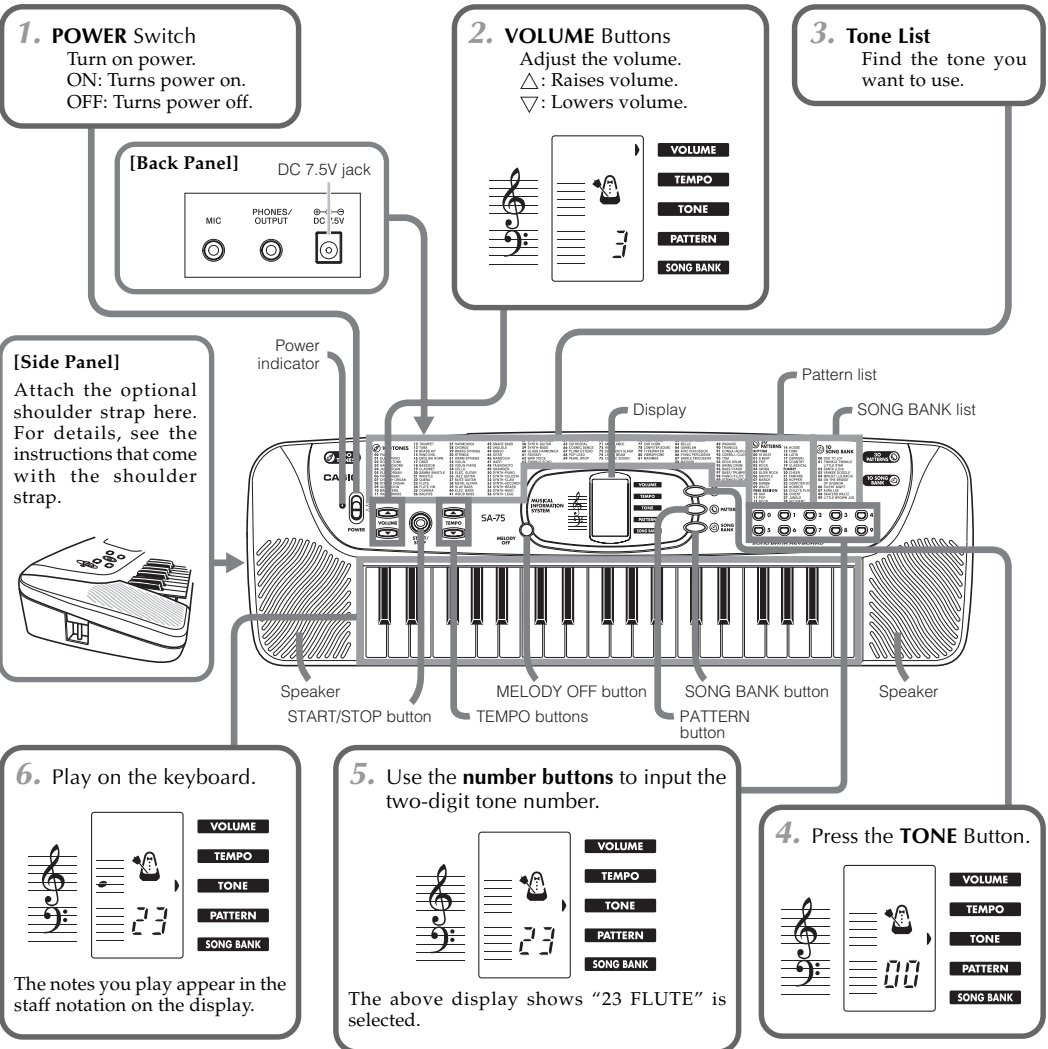

NOTE

- The tone "00 PIANO" is always selected whenever you turn on power.
- Volume can be set to a value from 1 to 5. The volume level is always set to 5 whenever you turn on power.
- Whenever you first press either the Δ or ∇ VOLUME button the current setting value appears on the display. Press one of the buttons while the current setting is displayed to actually change the volume setting.

Tones

Some tones actually assign two or more different sounds to the keyboard. The sound produced when you press a key depends on where the key is located, as illustrated below.

