



POLARIS RANGER 2019+

TAIL LIGHT

PLUG & PLAY MULTI-FUNCTION



INSTRUCTION MANUAL



RAVEK

POLARIS RANGER 2019+

PLUG & PLAY MULTI-FUNCTION TAIL LIGHT

Part #: 64-109

Fitment: POLARIS RANGER 2019+

TOOLS NEEDED:



Side Cutter Pliers



Push Pin Pliers



Heat Gun / Lighter



Ratchet



10mm Deep Well Socket

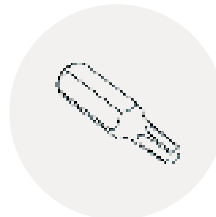

T-30 Torx



T-40 Torx

PARTS INCLUDED:

- UTV Multi-function Tail Light (1x)
- Main Harness (1x)
- Tail light Harness (2x)
- Tail light Extension Harness (1x)
- Work Light Harness (1x)
- Battery Positive Harness (1x)
- Battery Negative Harness (1x)
- Rocker Switch (1x)
- Rocker Switch Adapter (1x)
- Zip Tie (10x)
- Adhesive Promotor Wipe (2x)
- Rubbing Alcohol Wipe (2x)
- Heat Shrink (1x)
- Dielectric Grease (1x)

INSTALL VIDEO TUTORIAL

DON'T LIKE INSTRUCTIONS?

VISIT OUR WEBSITE
TO ACCESS THE
VIDEO TUTORIAL.



GENERAL NOTES

- Throughout this process, be sure to keep track of any screws or fasteners you remove as they will be re-installed in the same location.
- Make sure your vehicle is off and key is out of the ignition before starting.
- Dielectric grease is provided, and you can use it for added protection.

1

PREP THE VEHICLE

i

Using PUSH PIN PLIERS remove the two push pins in the underside of the rocker switch panel area. [SEE FIGURE 1A]

NOTE: Open the panel and let it rest (do not unplug any of your rocker switches). [SEE FIGURE 1B]. Choose an open rocker switch slot where you'll install your switch to in a future step, remove the cover by pushing out.

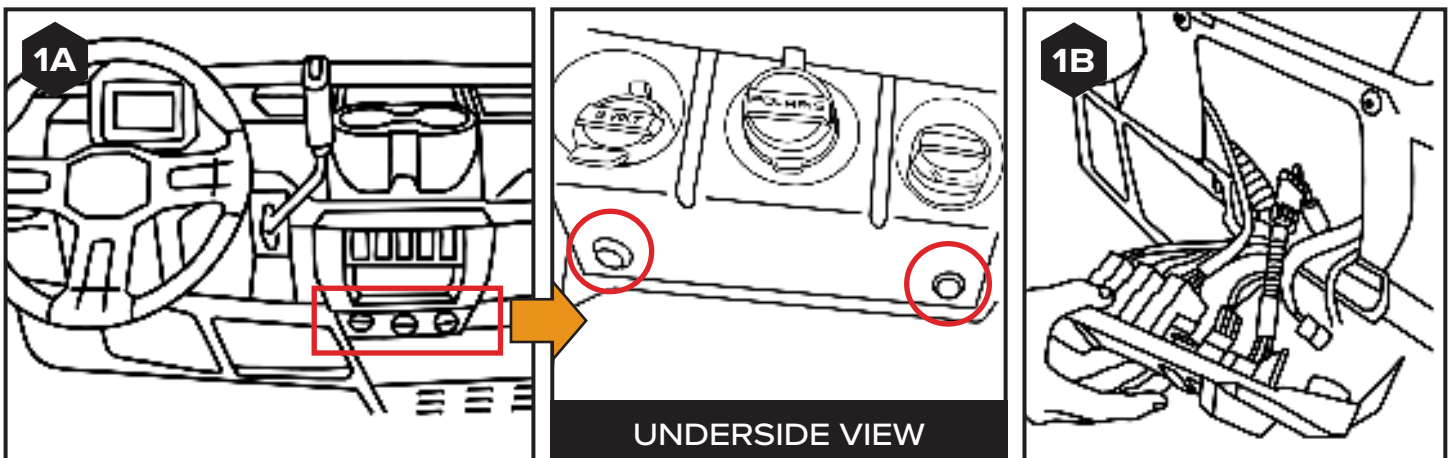



Remove the two push pins holding the lower dash panel using PUSH PIN PLIERS. [SEE FIGURE 1C]

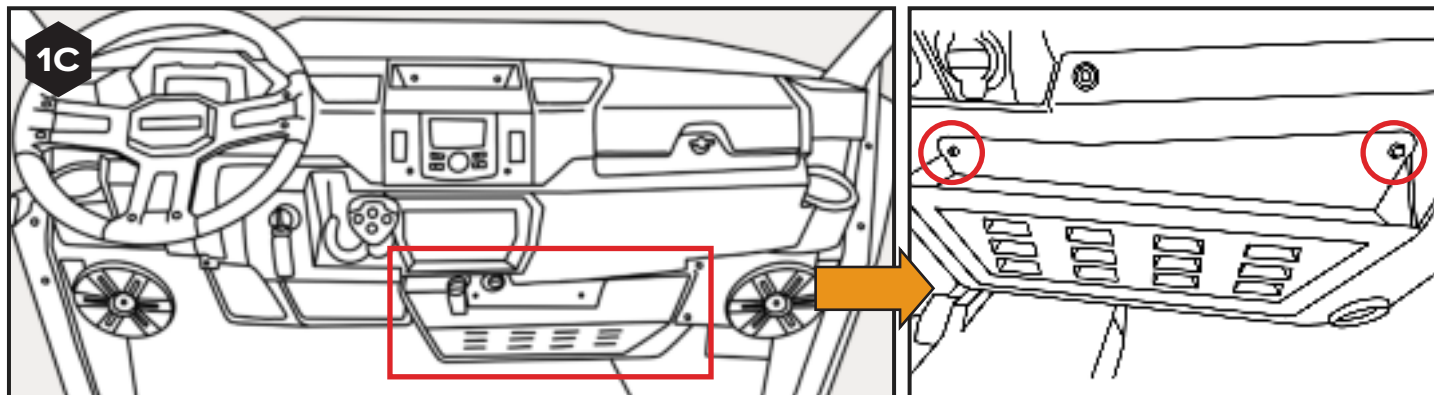

Using PUSH PIN PLIERS remove the 10 push pins holding the center tunnel panel. [SEE FIGURES 1D-1K]

NOTE: If your Ranger has air conditioning (HVAC), you'll need to disconnect the air ducts from the center tunnel panel before removing it. Gently slide the ducts out of their slots.

NOTE: If your Ranger has two rows of seats; remove the center tunnel panel located in the rear using PUSH PIN PLIERS to remove the 6 push pins holding the panel. [SEE FIGURES 1L-1N]

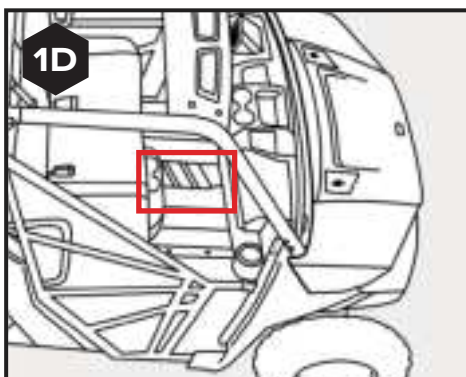

FRONT CENTER TUNNEL PANEL

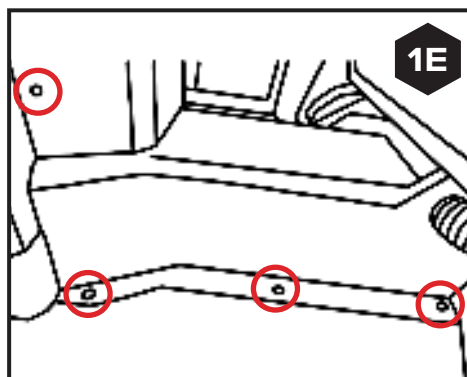

PASSENGER'S SIDE

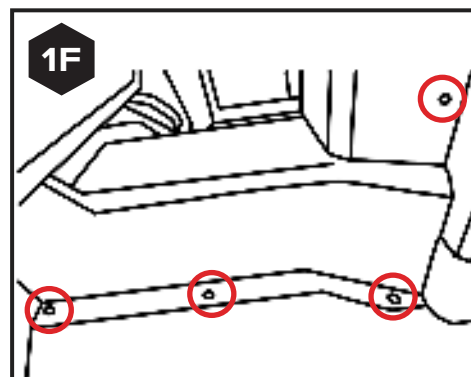

DRIVER'S SIDE

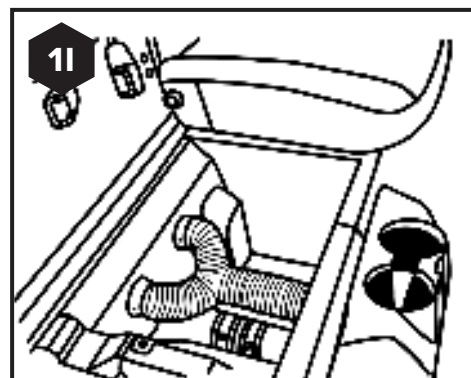
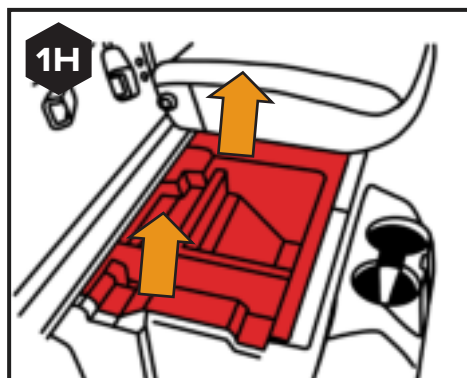
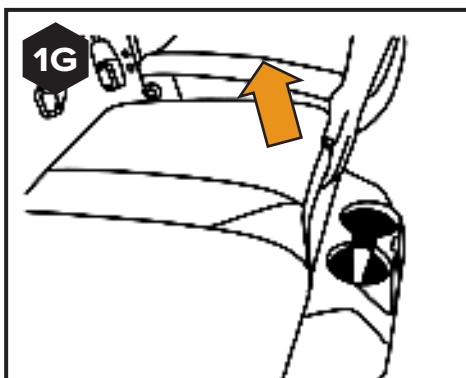

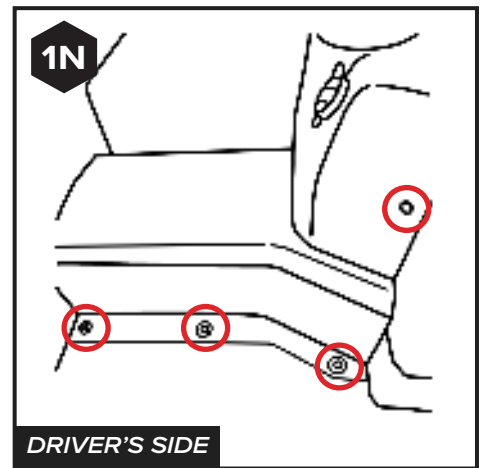
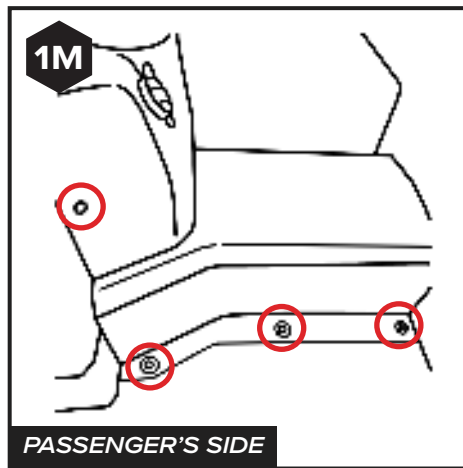
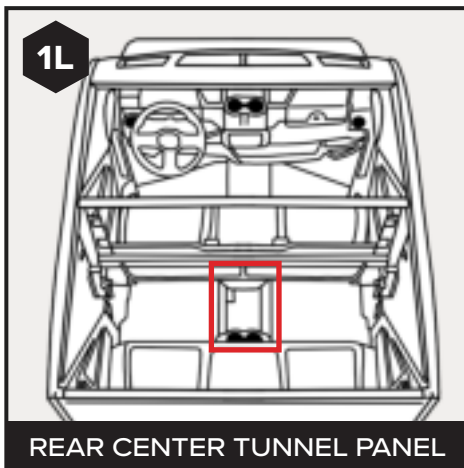
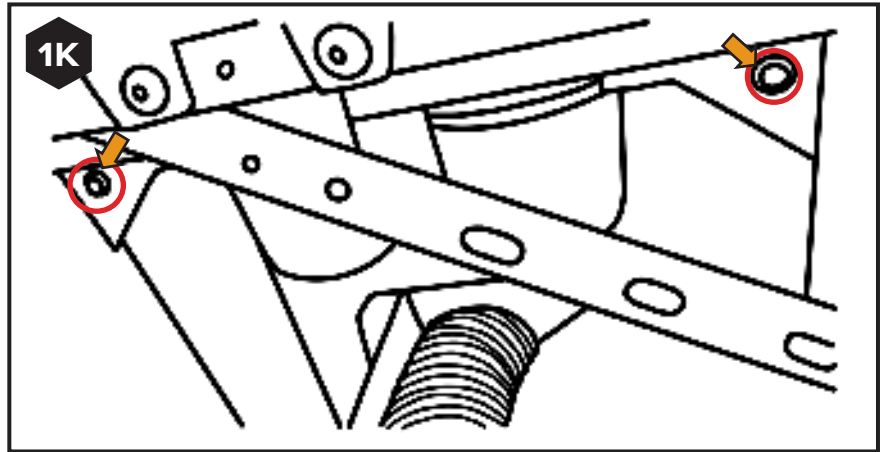
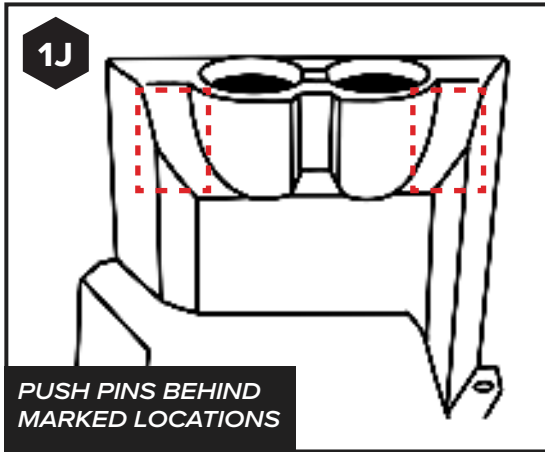

iv

Open the tail gate and remove the tail lights using a 10MM SOCKET and RATCHET and set aside. [SEE FIGURES 1O - 1R]

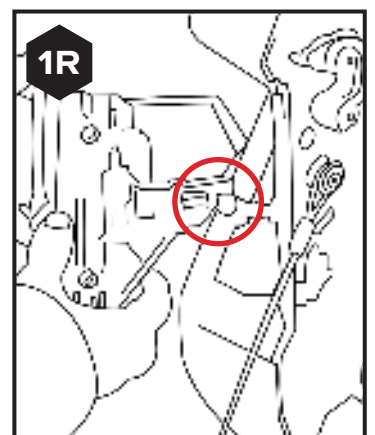
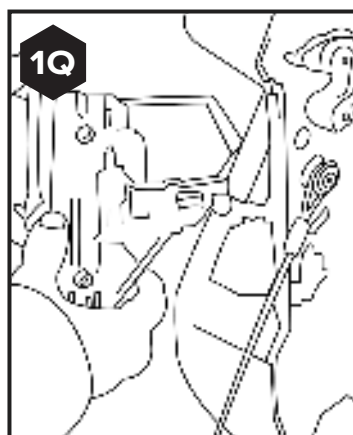
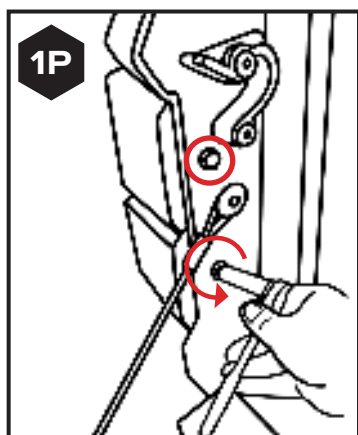
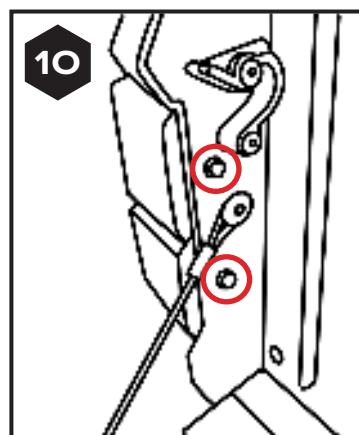

i

Wipe your lower tailgate half using one of the rubbing alcohol wipes provided. Let dry.

Wipe the same surface with one of the adhesive promoter wipes provided. Let dry. [SEE FIGURES 2A-2C]

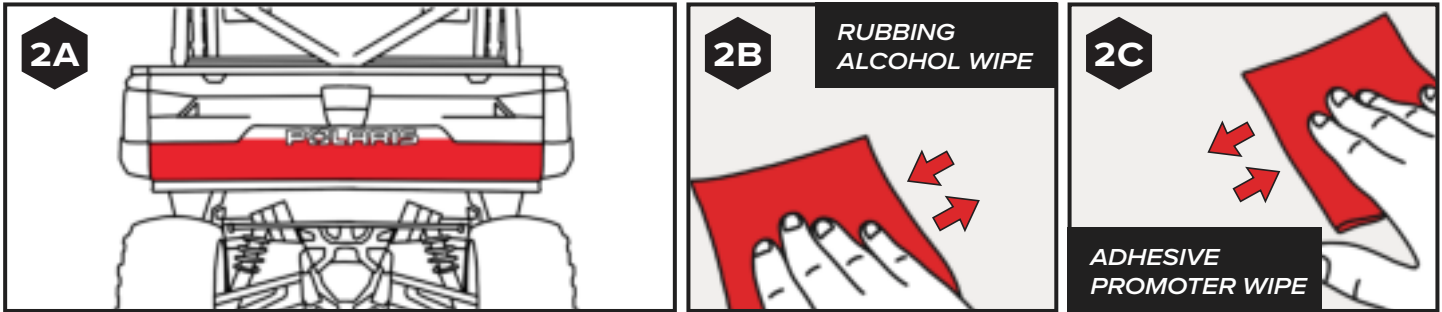

ii

Locate the four mounting clips provided in the kit. [SEE FIGURE 2D]

Clean the back surface of the mounting clips using a rubbing alcohol wipe. Let dry. [SEE FIGURE 2E]

Wipe down the surface of the mounting clips with the adhesive promoter wipe. Let dry. [SEE FIGURE 2F]

Place the double sided tape on to the back surface of the mounting clips and place them on the back of the light. [SEE FIGURE 2D - 2I]

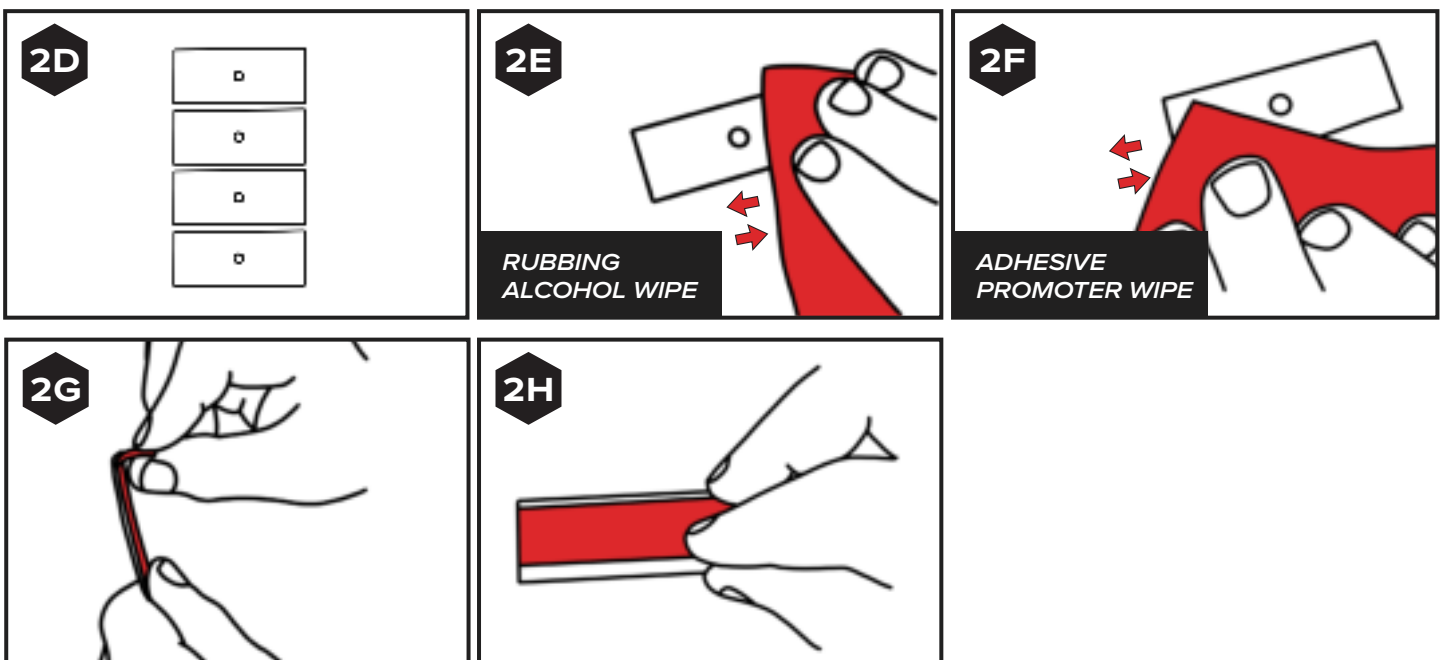

2I

SPACE OUT CLIPS EVENLY



iii

Peel off the double sided tape protective film and stick the light to the clean tailgate surface. [SEE FIGURE 2J]

NOTE: Install the light so the RAVEK logos on the end caps are right side up. [SEE FIGURE 2K]

2J

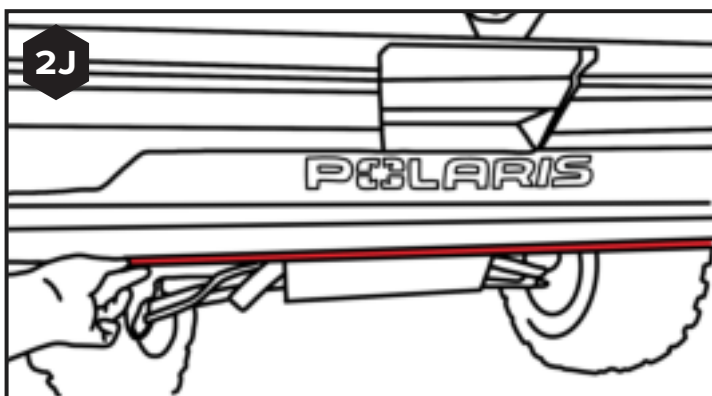

2K

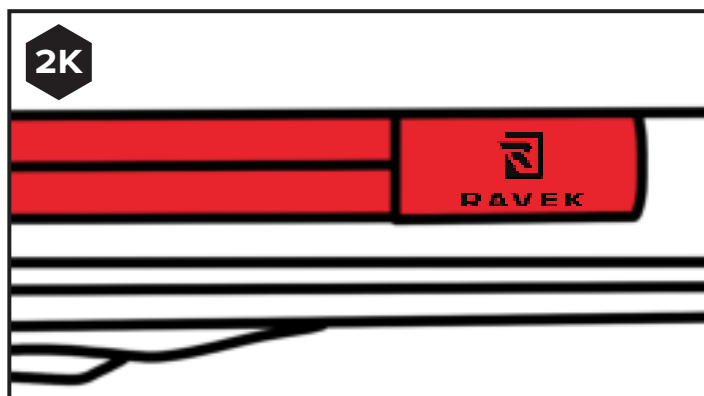

3

MAKE YOUR CONNECTIONS

i

Grab both of your Tail Light Harnesses and plug them in line to your OEM tail light and harness. [SEE FIGURE 3A]

NOTE: If additional accessories are plugged into the tail light already, connect the Multi-function Tail Light Harness closest to the OEM tail light.

3A

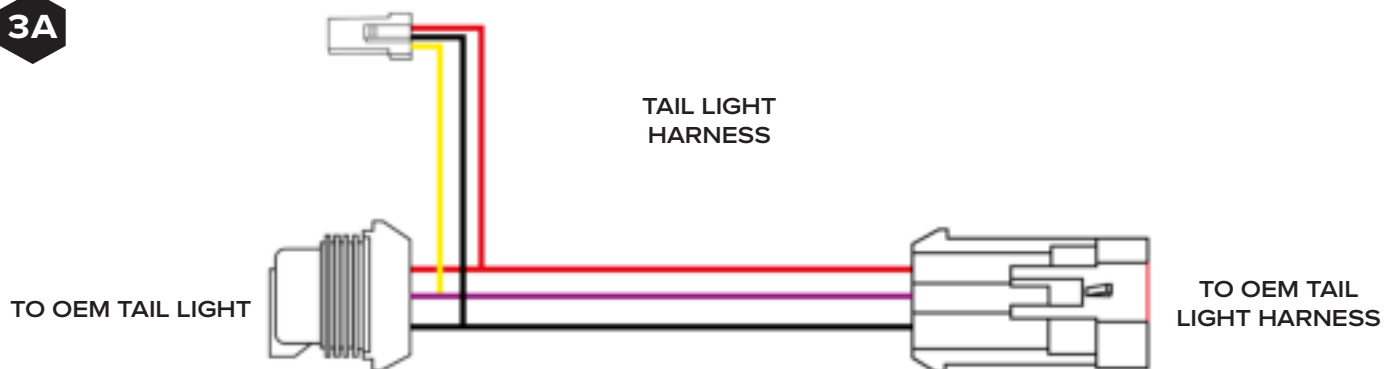



Grab your Tail Light Extension Harness and plug in each labeled connector to the corresponding Tail Light Harness, routing the Tail Light Extension Harness underneath the tailgate. [SEE FIGURES 3B-3E AND DIAGRAM A]

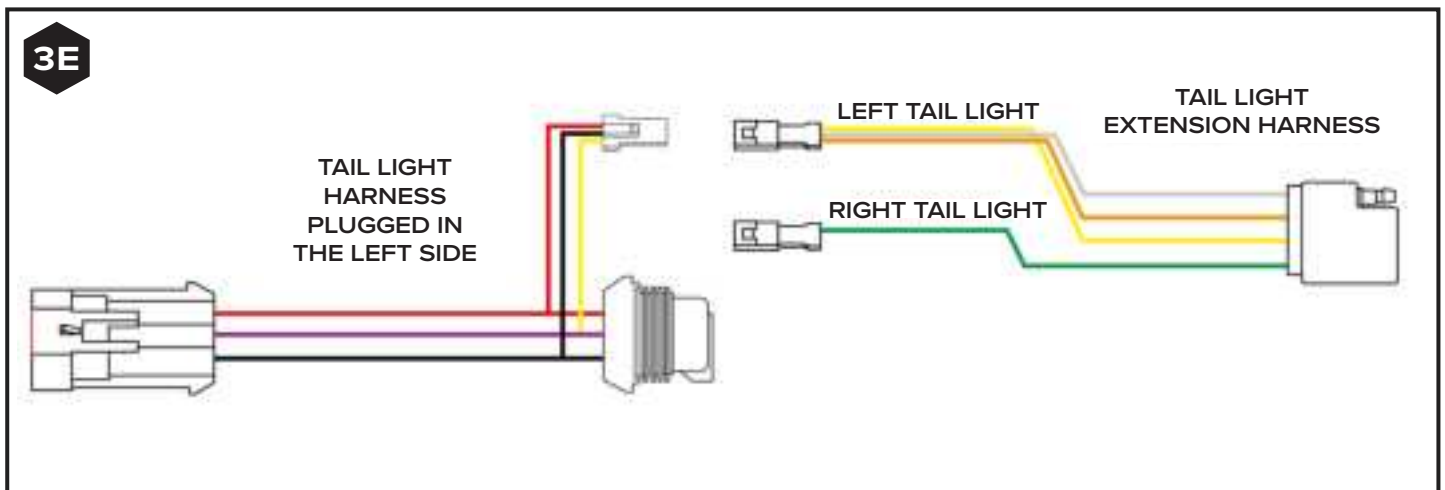
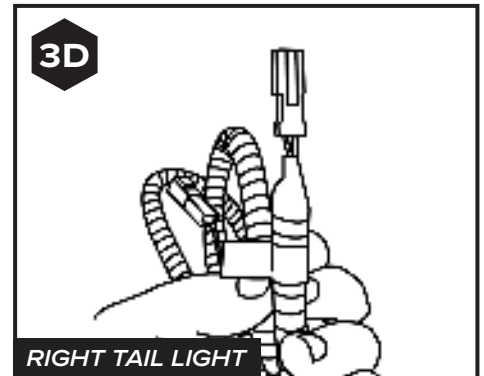
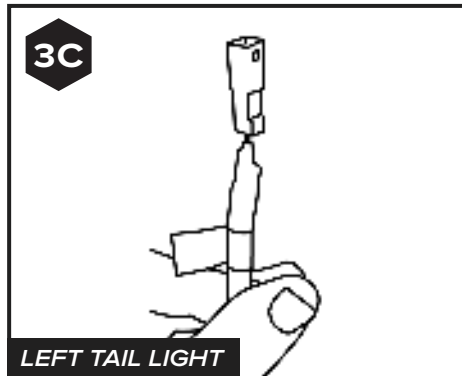
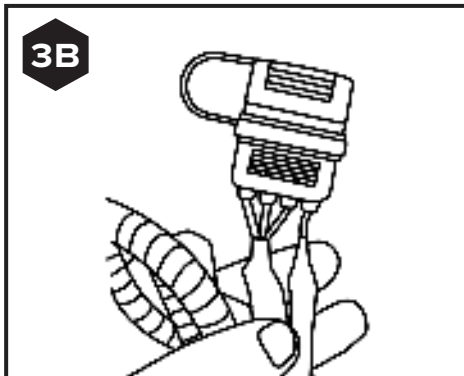

Set your Main Harness (harness with the controller box) in the engine compartment and make the following connections [SEE FIGURES 3F-3H]:

- Plug in the 1-pin connector coming out the white wire on the Main Harness to the Work Light Harness (harness with relay)
- Plug in the trailer connector coming out the Main Harness to the connector on the Tail Light Extension Harness on the middle of the Ranger
- Plug in the 4 pin connector coming out the Main Harness to the connector on the light connector on the light to the left side of the Ranger

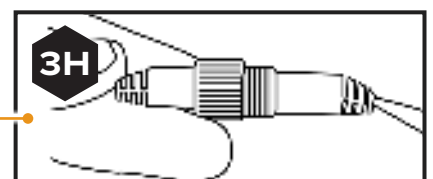
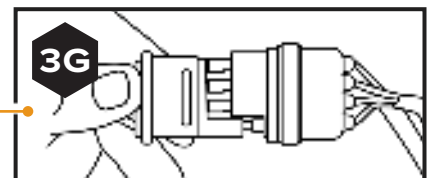
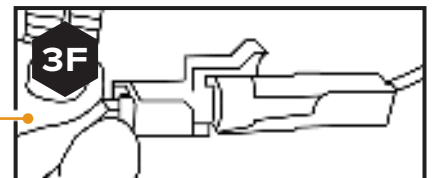

i

Disconnect your battery accessory terminal under your Ranger middle seat using a 10MM DEEP WELL SOCKET and a RATCHET. [SEE FIGURES 4A-4F]

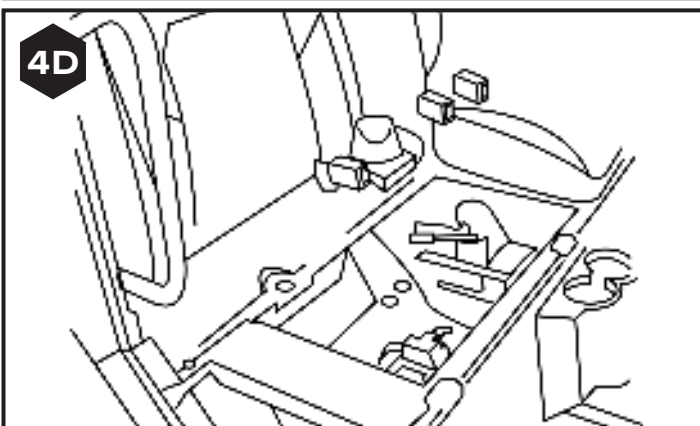
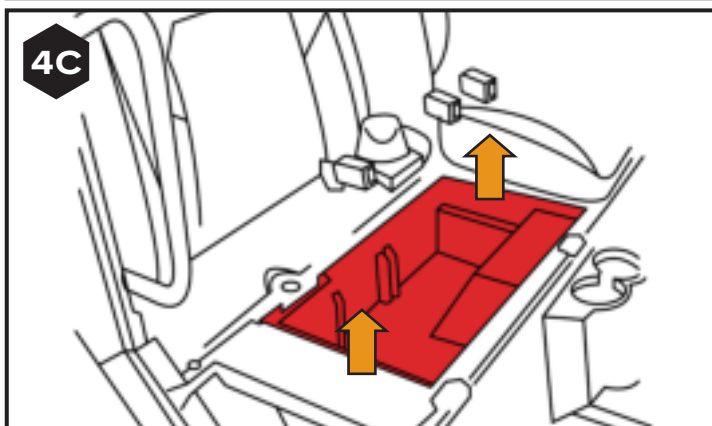
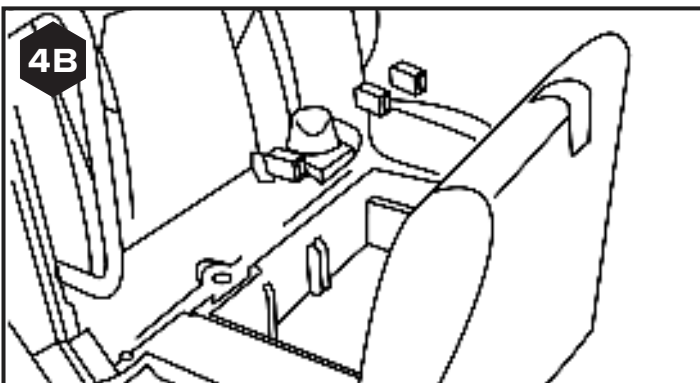
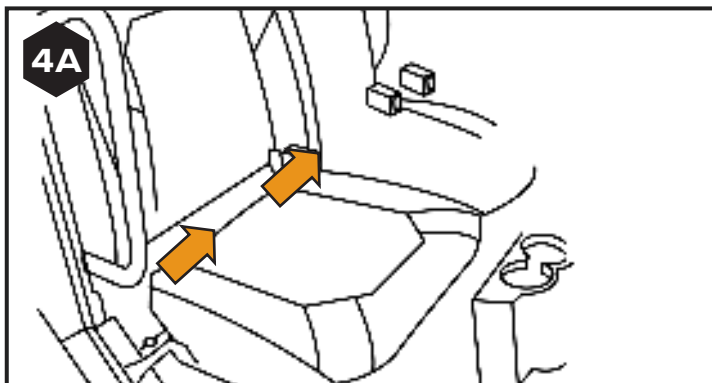

DISCONNECT NEGATIVE BATTERY TERMINAL FIRST

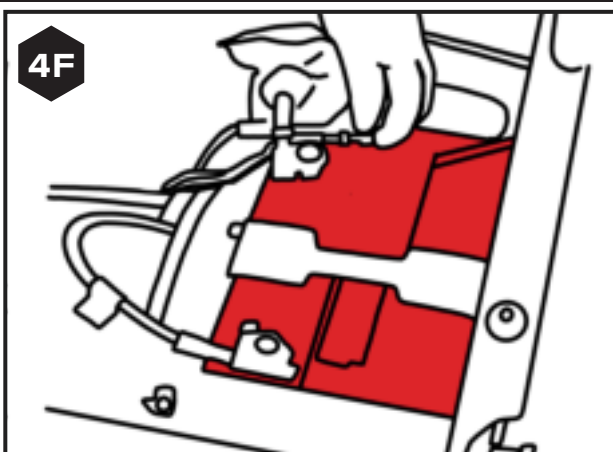

ii

Grab both your Battery Negative and Battery Positive Harnesses. Hook the ring terminal to the corresponding accessory battery terminal and re-install 10mm nut on positive and negative battery terminals. [SEE FIGURES 4G AND 4H]

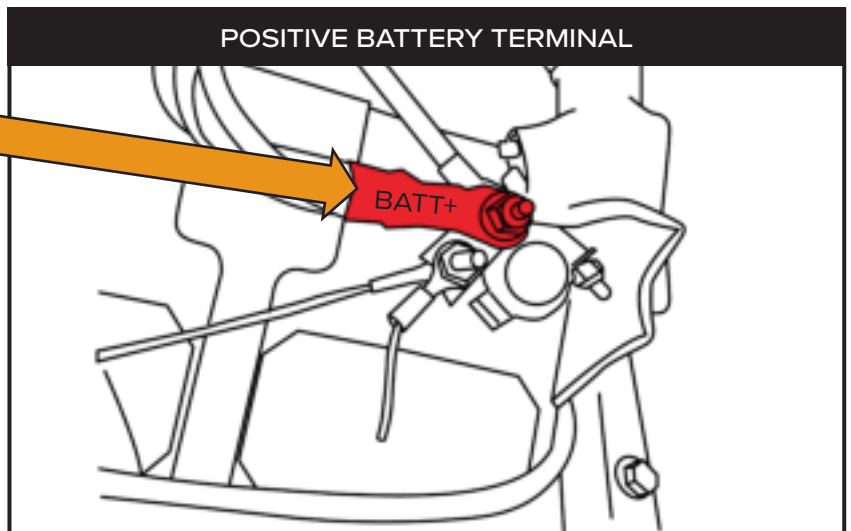
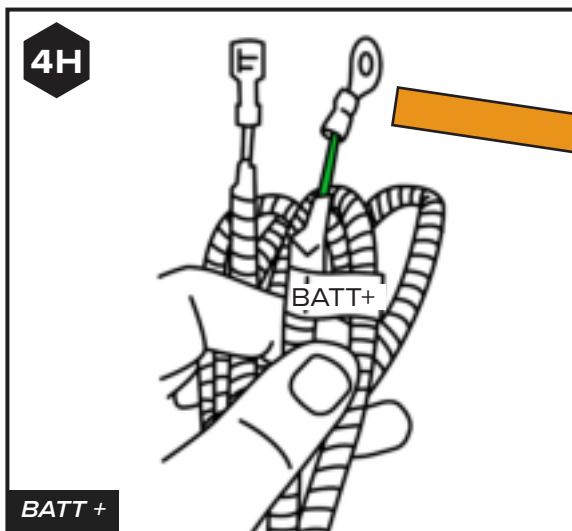
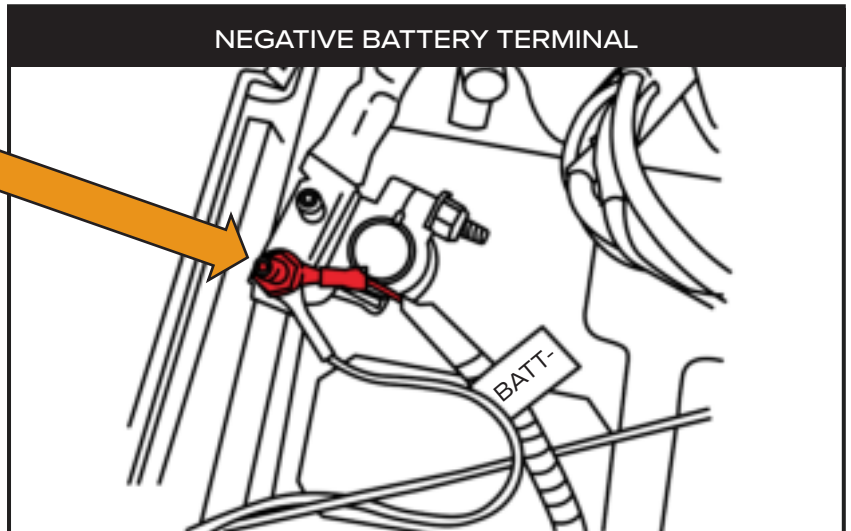
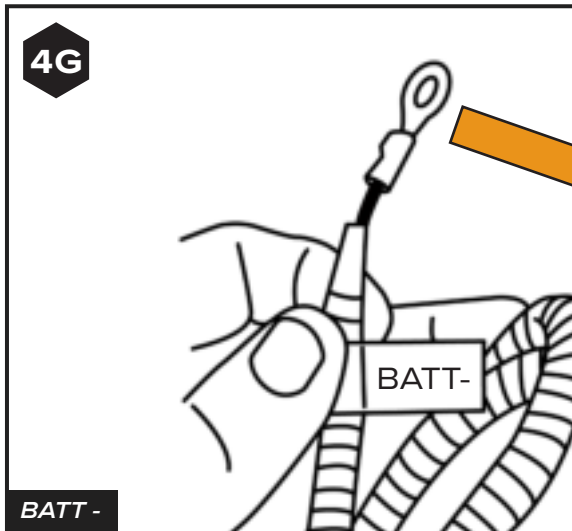

Grab the red spade connector on the Work Light Harness, the two black spade connectors from the Battery Negative Harness, and the green spade connector from the Battery Positive Harness, and bundle all four spade connectors together.

Route all four spades to the open rocker switch location referenced in step 1.i. [SEE FIGURES 4I-4N AND DIAGRAM A]

NOTE: Be sure to keep all wiring away from hot or moving components.

4I

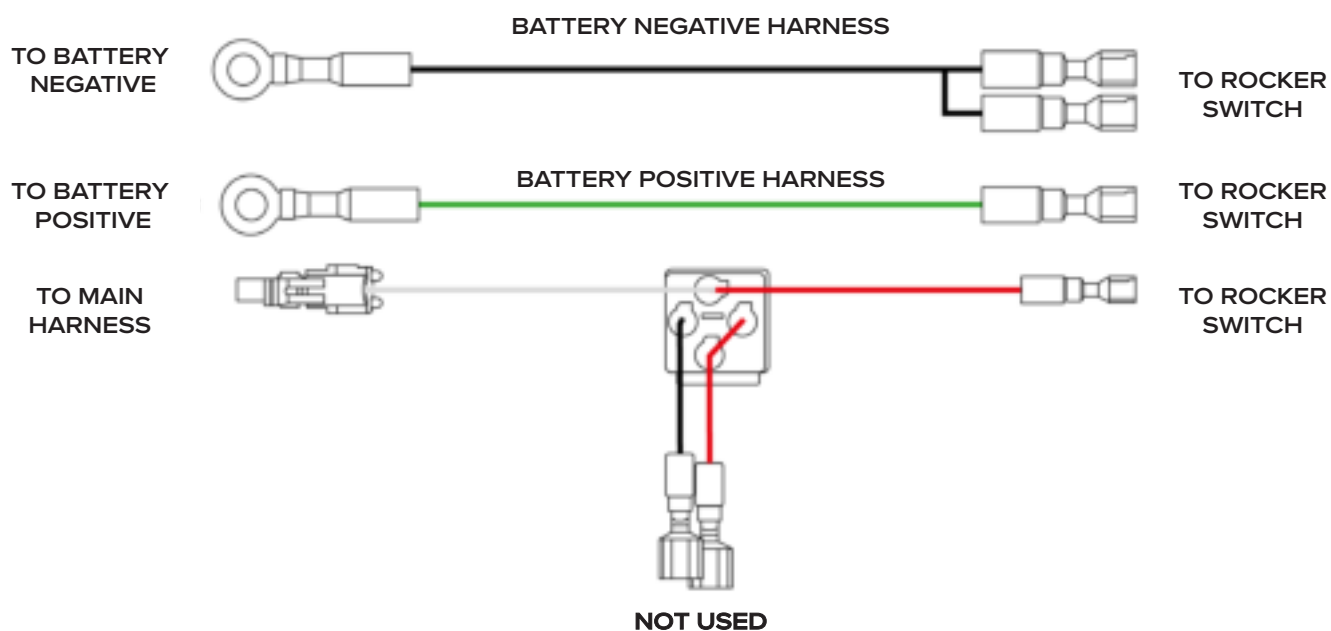

4J

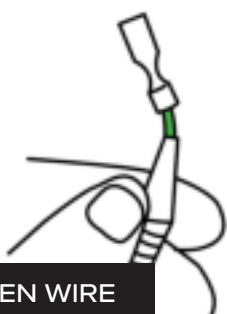

GREEN WIRE

4K

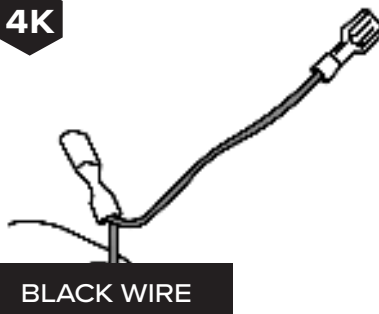

BLACK WIRE

4L



RED WIRE

4M

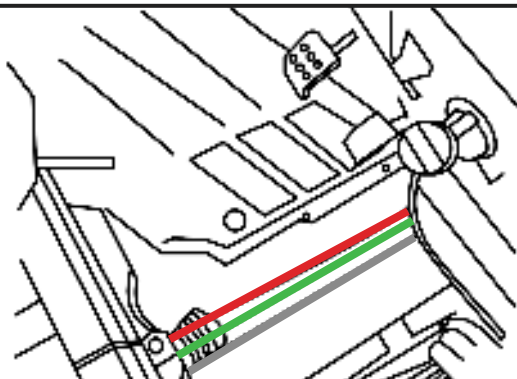

WIRES BEING ROUTED TO THE SWITCH PANEL

4N

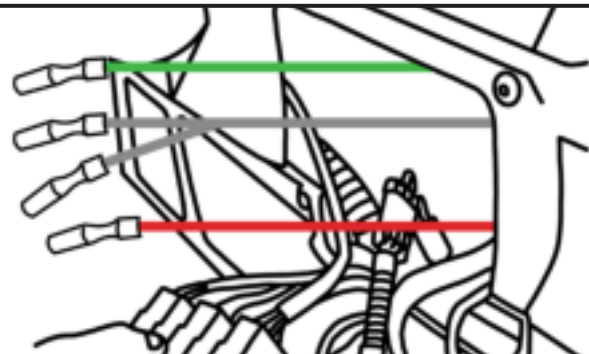

WIRES ROUTED TO SWITCH PANEL TO REACH ROCKER SWITCH

iv

Grab your rocker switch and install the rocker switch adapter. This is done by sliding the adapter onto the rocker switch from the backside until it clicks. [REFERENCE FIGURES 4O & 4P]

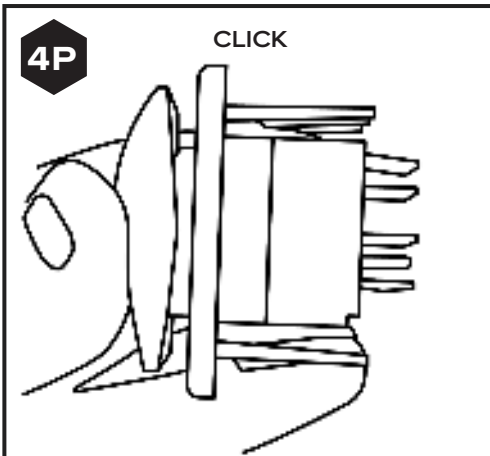
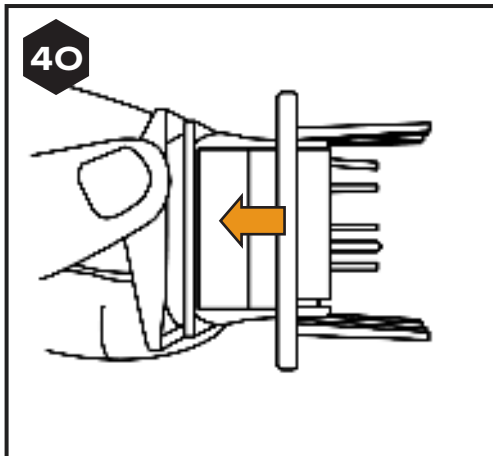

v

Reference diagram below to connect each spade connector to the appropriate spade terminal on the backside of the rocker switch.

4Q

- Plug in main ground spade connector to PIN #7 (BLACK WIRE)
- Plug in ground jumper spade connector to PIN #8 (BLACK WIRE)
- Plug in power (green spade connector) to PIN #2 (GREEN WIRE)
- Plug in the red spade connector on the Work Light Harness to PIN #3 (RED WIRE)

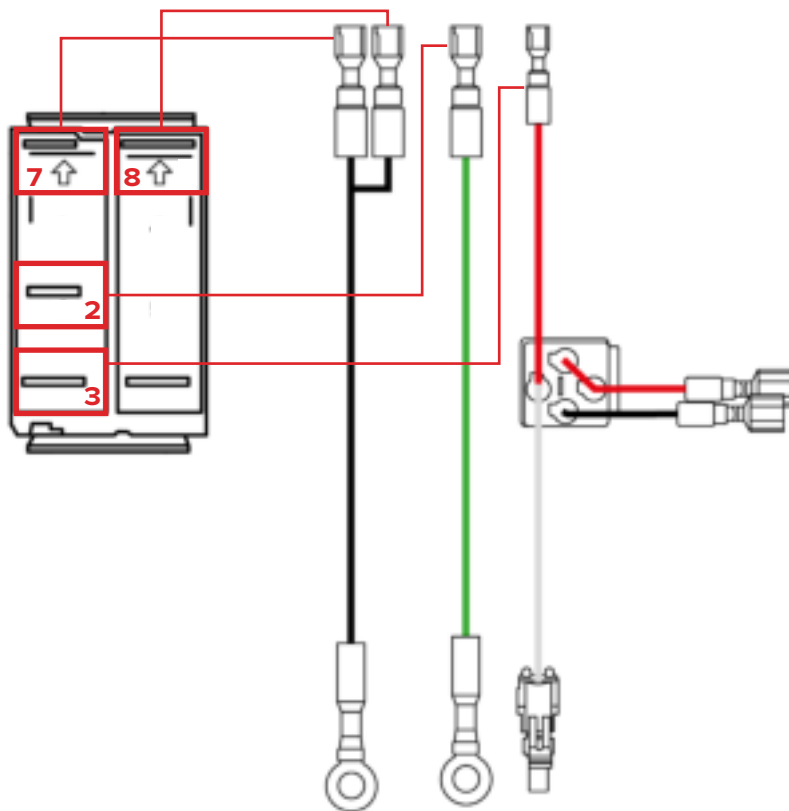



Now is time to confirm light works as designed:

- Red Running Light
- Brake Light
- White Work Light (with vehicle on or off)

NOTE: *If you have a turn signal kit hooked up to your Ranger; verify the turn signal feature built in to the light.*

5

TIDY UP YOUR MACHINE



Go over all your wiring and secure it to the different frame tubes and OEM harnesses. [REFERENCE DIAGRAM A FOR OVERVIEW OF WIRING]

NOTE: *Stay away from hot or moving components.*



Once all of your wiring is secured with the help of the zip ties, cut all the excess zip ties using side cutter pliers.



With your wiring neatly routed and secured to the Ranger, reverse steps 1.i. - 1.v. to reinstall the different Ranger components.



RAVEK
BUILT FOR MORE

WHY RAVEK

Stock UTVs don't come with enough storage, lighting, comfort, and protection. That's why we started RAVEK.

We live to design, manufacture, and test innovative SxS upgrades that elevate the riding experience. Here's what you can expect from us:

- Durable products built to last (100% lifetime guarantee)
- UTV upgrades thoughtfully designed & tested by riders
- Outstanding installation support (videos & USA customer service)
- Constant flow of epic riding content (check out our social media)

We're confident your RAVEK product will earn its place on your machine. Please call or e-mail us if we can help.

- Harry & Ricky (Brothers & Owners)

MESSAGE FROM THE DESIGNER

When I designed the UTV Multi-function Tail Light, I thought about all the aspects a UTV rider needs: added visibility, sleek look, and easy installation. This product checks all the boxes, which is why I love it. It makes your machine look meaner and makes you and your ride crew safe at night on the trails.



RAVEK
BUILT FOR MORE