

GPU Option Kit Installation Guide

Slot 3 / 4 / 5 / 6

NVIDIA | AMD (Single Slot x 16 GPUs)

Slot 1 / 2 / 7 / 8

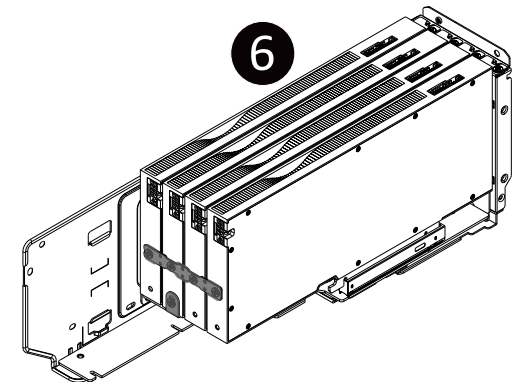
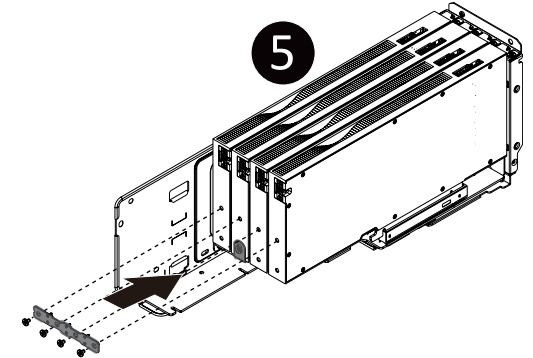
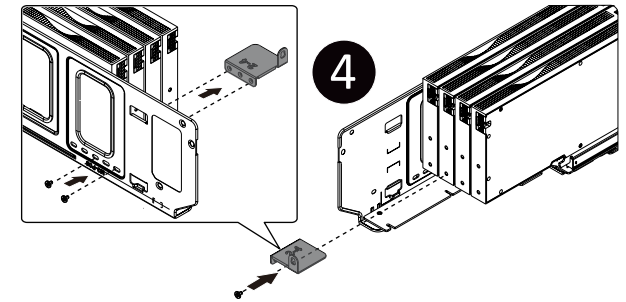
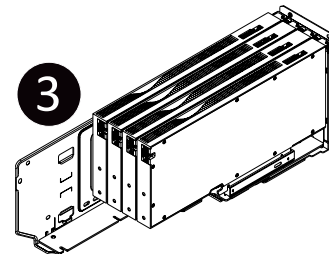
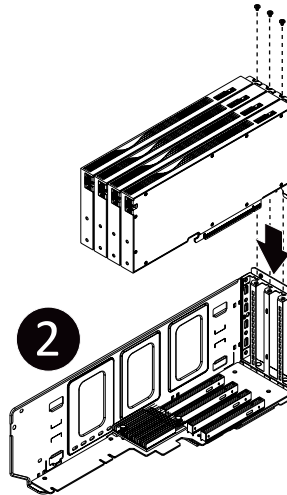
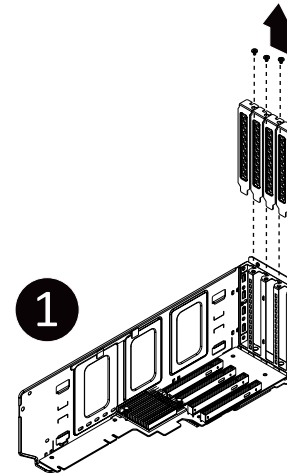
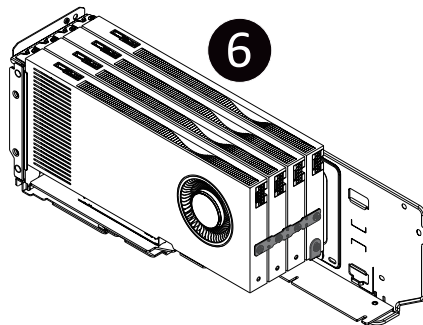
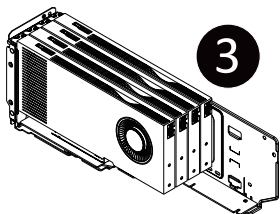
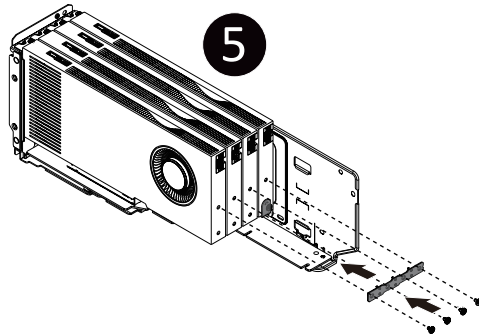
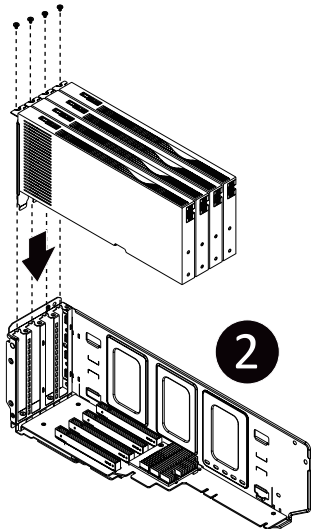
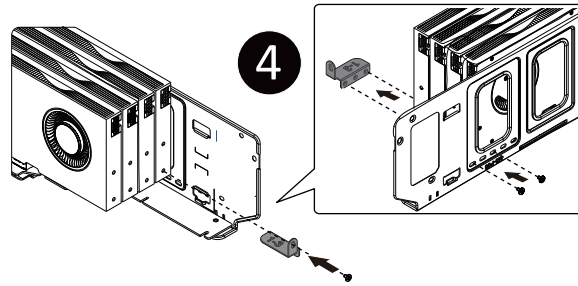
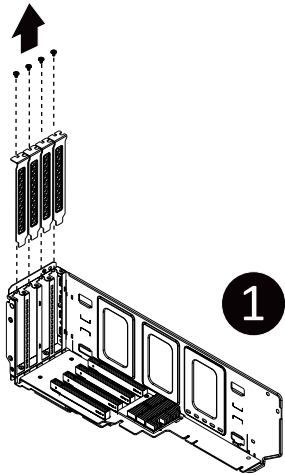

GPU Option Kit Installation Guide

Slot 3 / 4 / 5 / 6

NVIDIA | AMD | Intel Gaudi3 (Dual Slot x 8 GPUs)

Slot 1 / 2 / 7 / 8

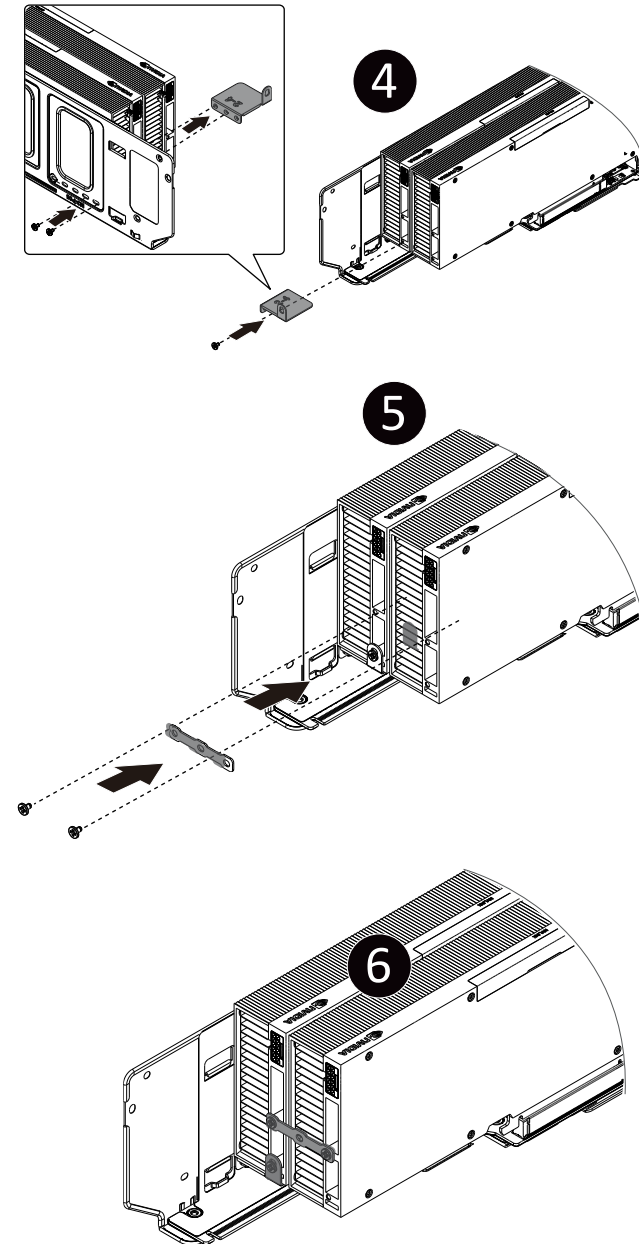
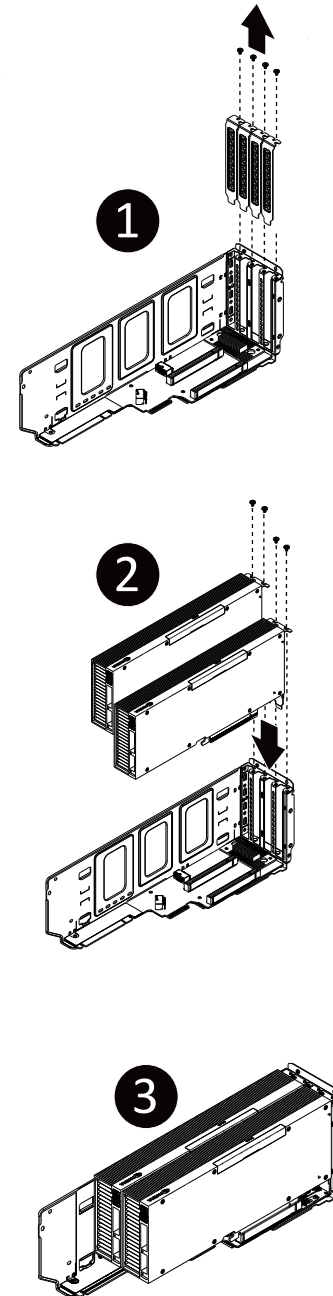
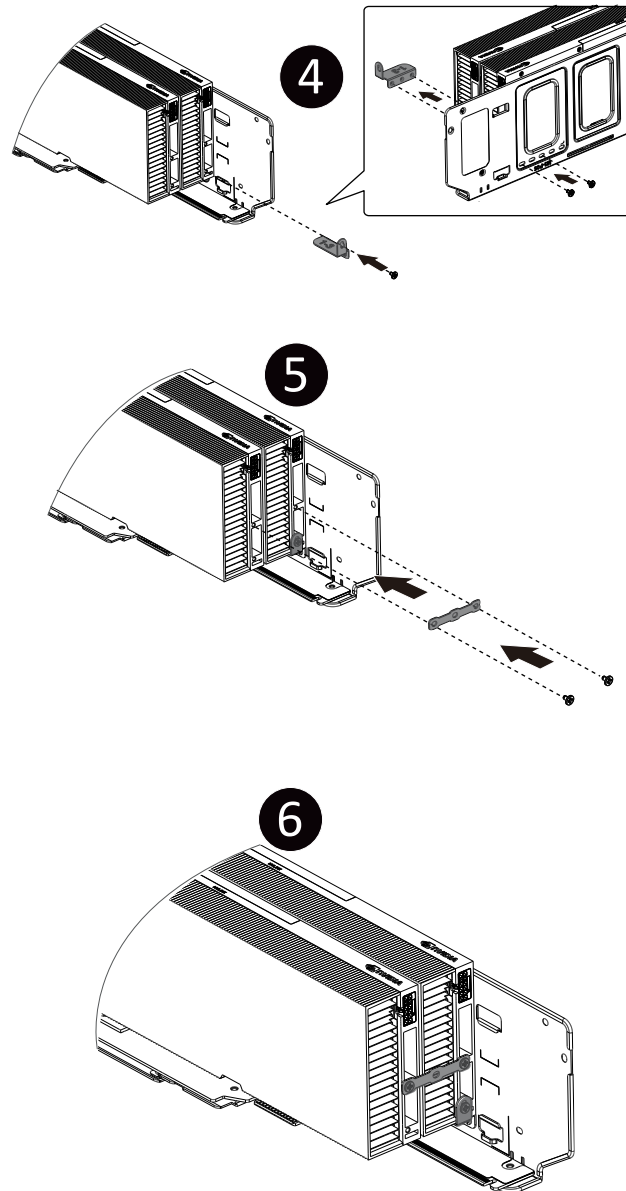
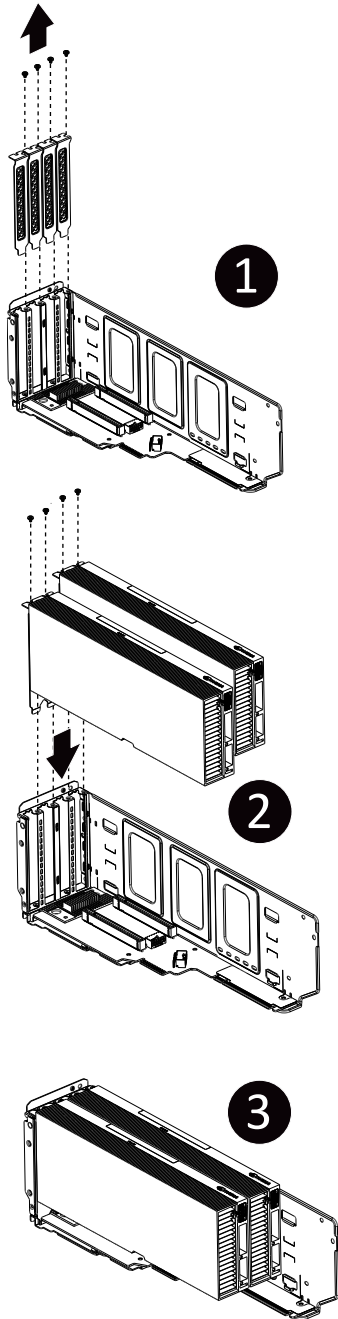

GPU Option Kit Installation Guide

Slot 3 / 4 / 5 / 6

NVIDIA (Dual Slot x 4 GPUs | H200 x1)

Slot 1 / 2 / 7 / 8

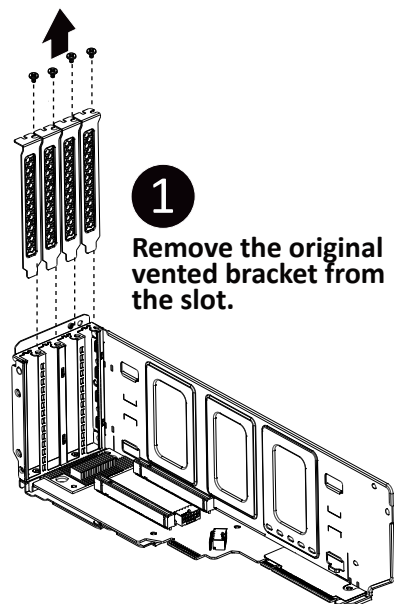

3 Secure it firmly with the screws (both inner and outer sides)

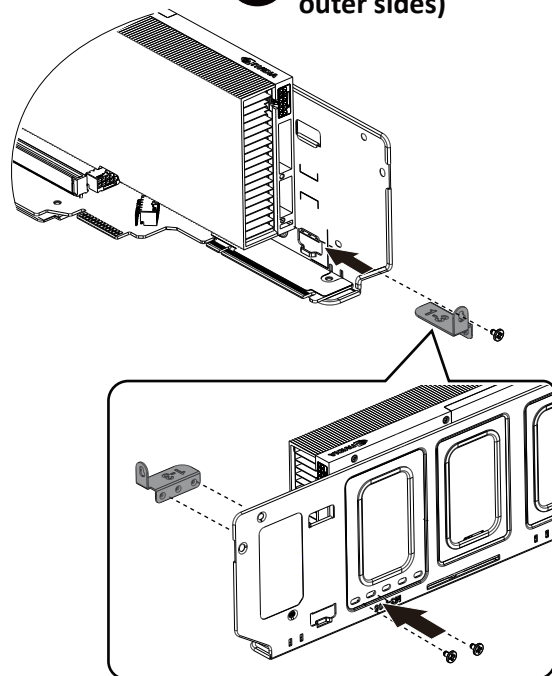

2 Install two solid (non-vented) brackets in place of the removed ones.

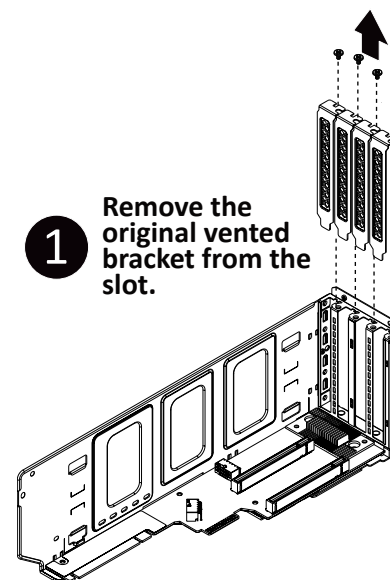
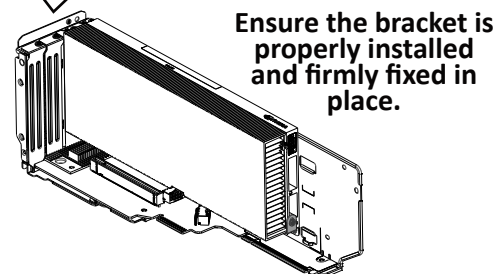
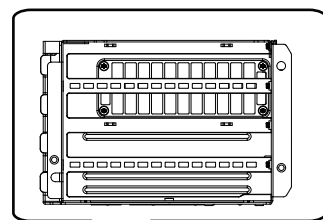
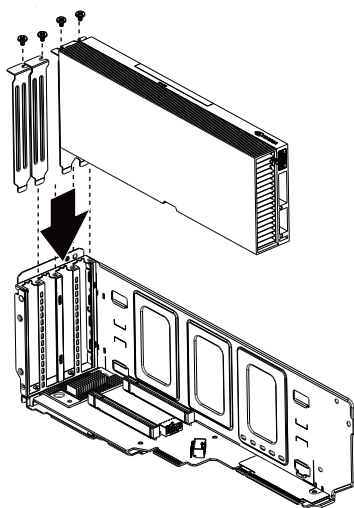

1 Remove the original vented bracket from the slot.

2 Install two solid (non-vented) brackets in place of the removed ones.

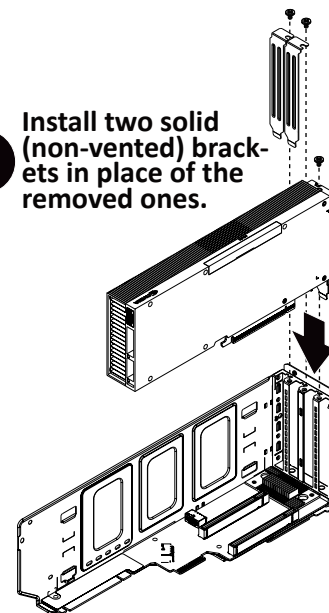

3 Secure it firmly with the screws (both inner and outer sides)

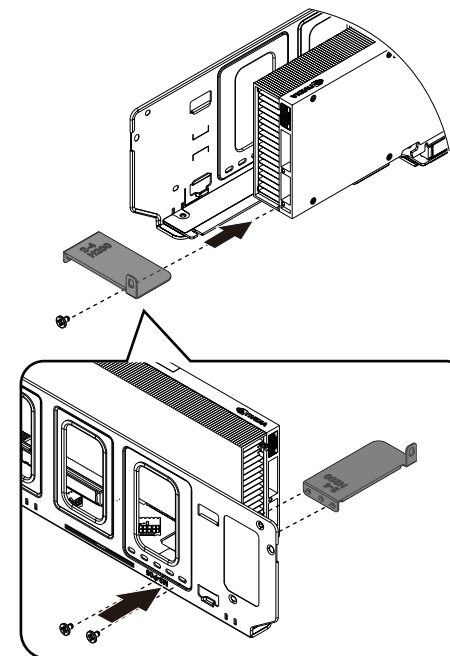

4

Ensure the bracket is properly installed and firmly fixed in place.

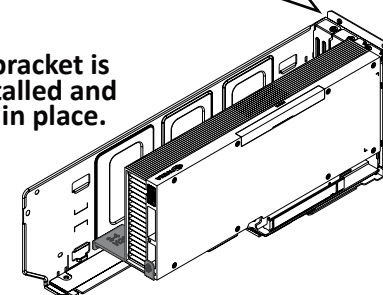
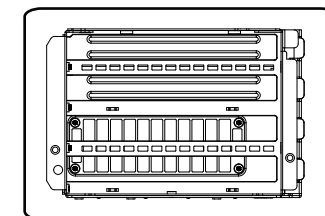

Applicable Models: G294-A21 / S41 / S45 / Z21 / Z41

GPU Option Kit Installation Guide

Slot 3 / 4 / 5 / 6

NVIDIA (Dual Slot x 4 GPUs, NVIDIA NVLINK Bridge | H200 x2)

Slot 1 / 2 / 7 / 8

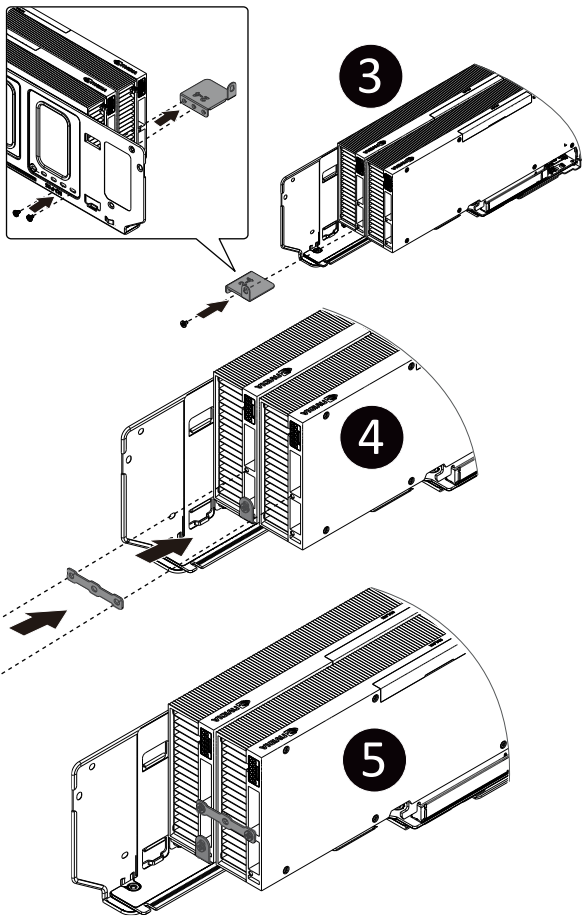
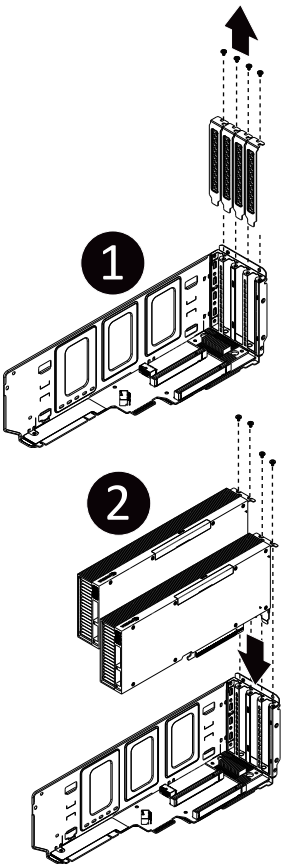
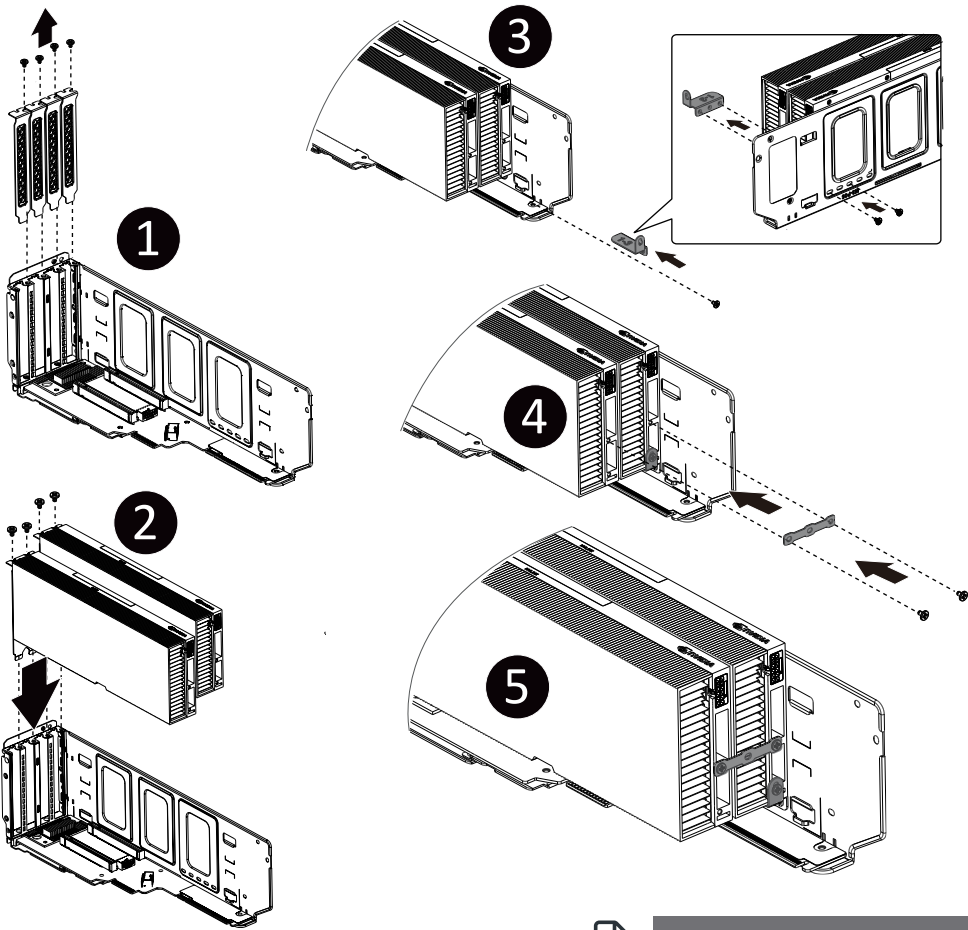

NVIDIA NVLINK Bridge

Applicable Models: G294-A22 / S42 / Z22 / Z42

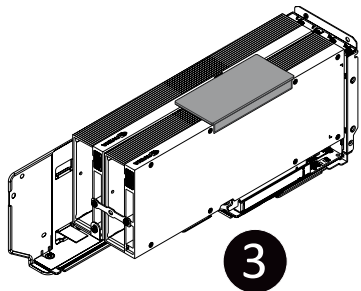
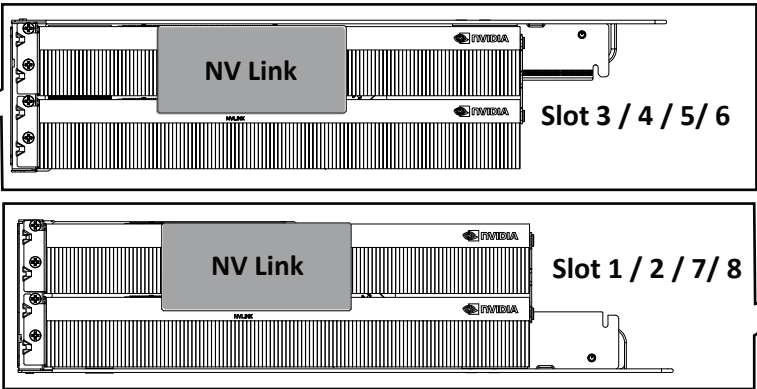
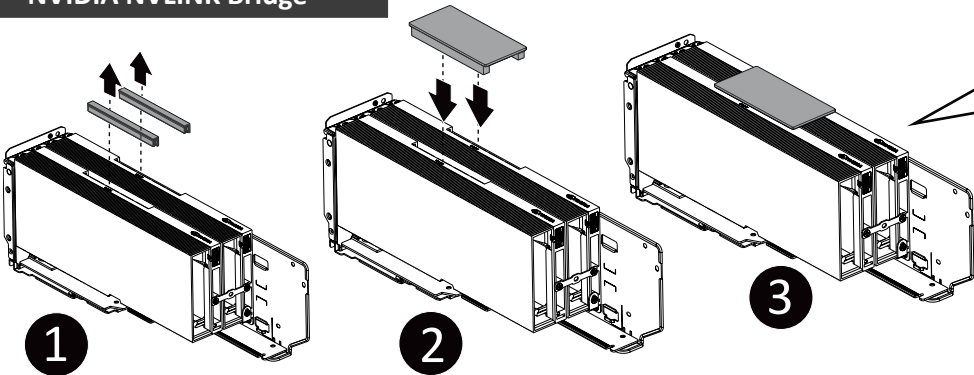

GPU Option Kit Installation Guide

Slot 3 / 4 / 5 / 6

NVIDIA (Dual Slot x 4 GPUs | RTX Pro 6000 | Non-Vented Bracket)

Slot 1 / 2 / 7 / 8

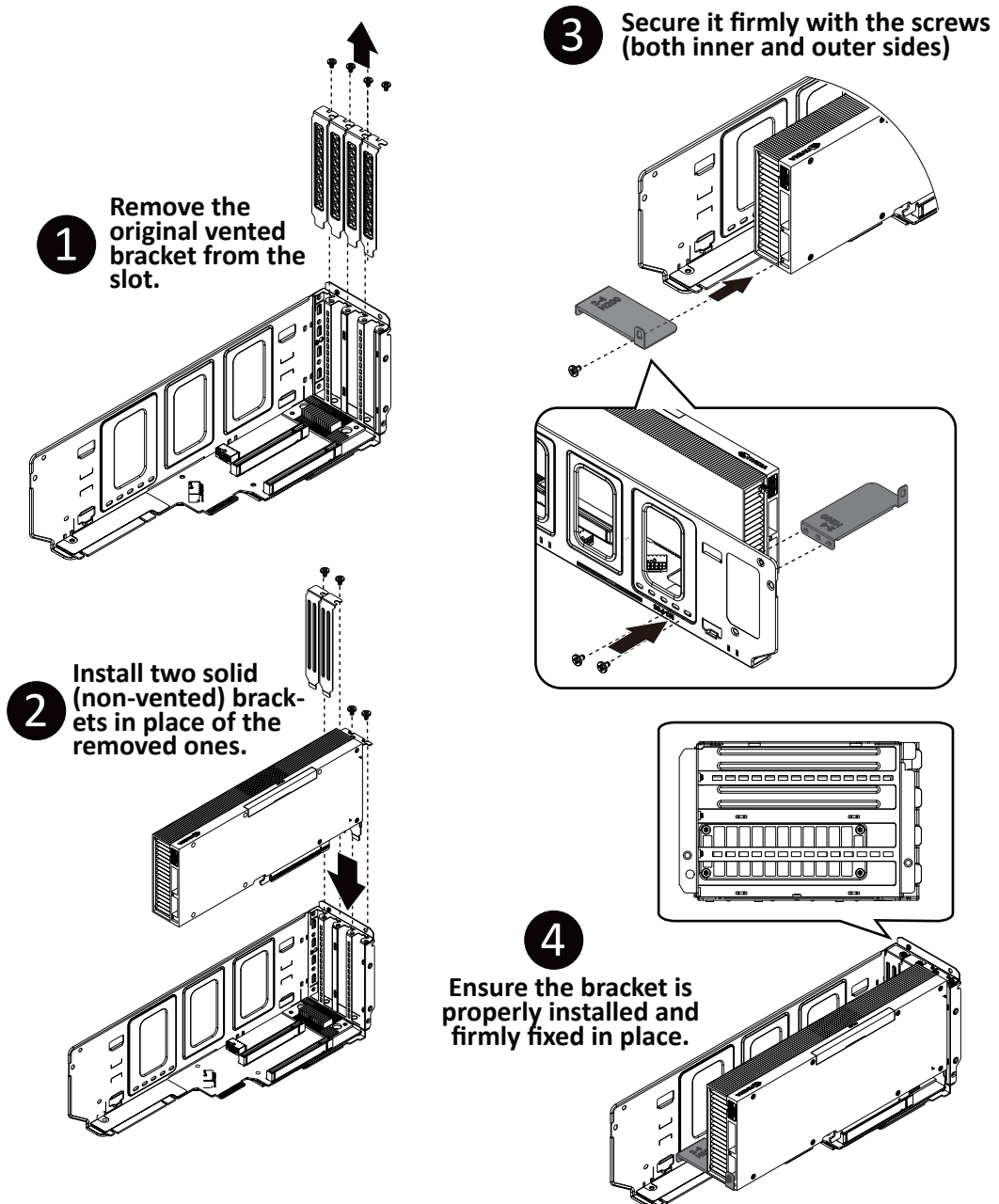
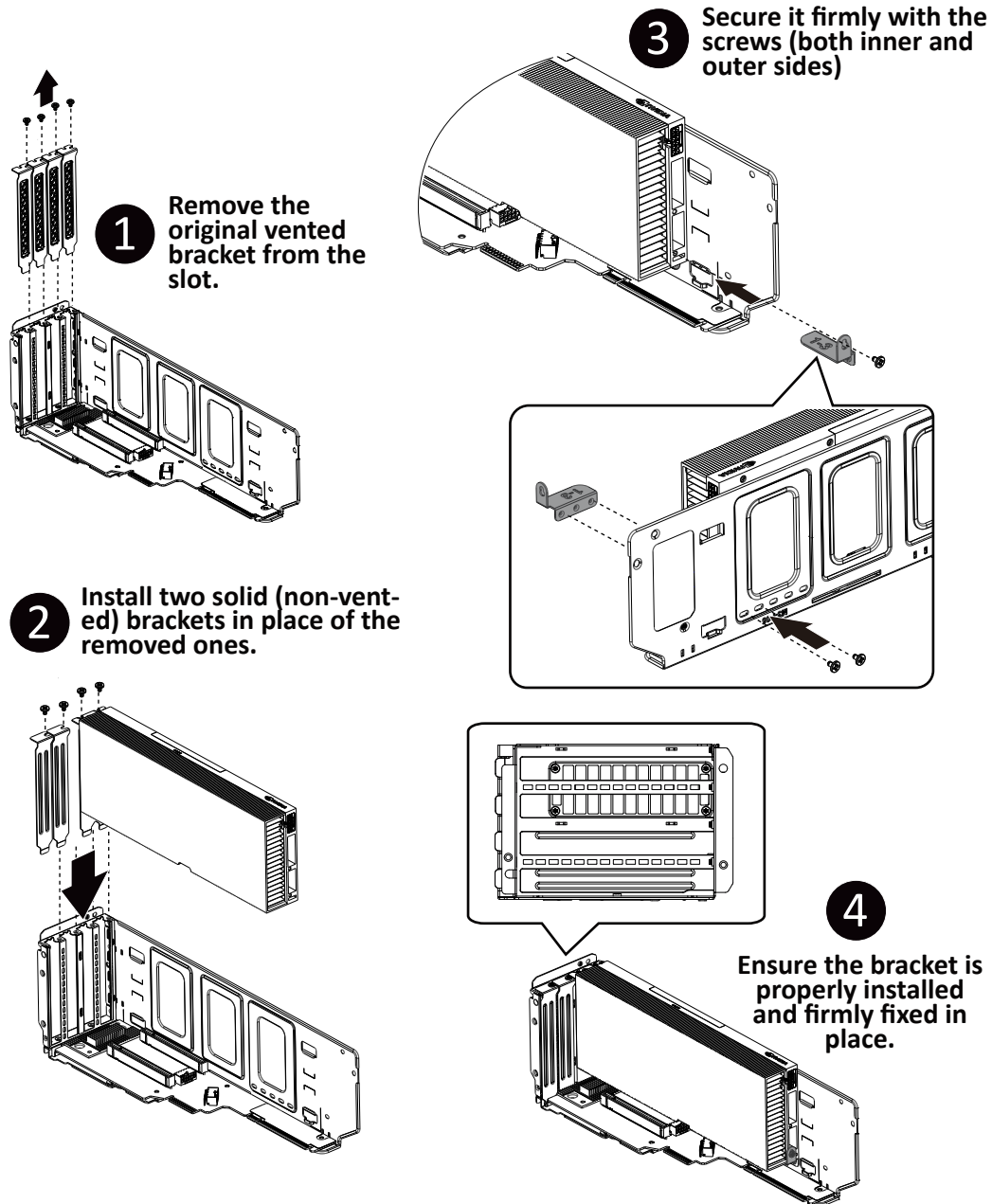

Applicable Models: G294-A21 / S41 / S45 / Z21 / Z41

GPU Option Kit Installation Guide

Slot 3 / 4 / 5 / 6

NVIDIA (Dual Slot x 4 GPUs | RTX Pro 6000 | Vented Bracket)

Slot 1 / 2 / 7 / 8

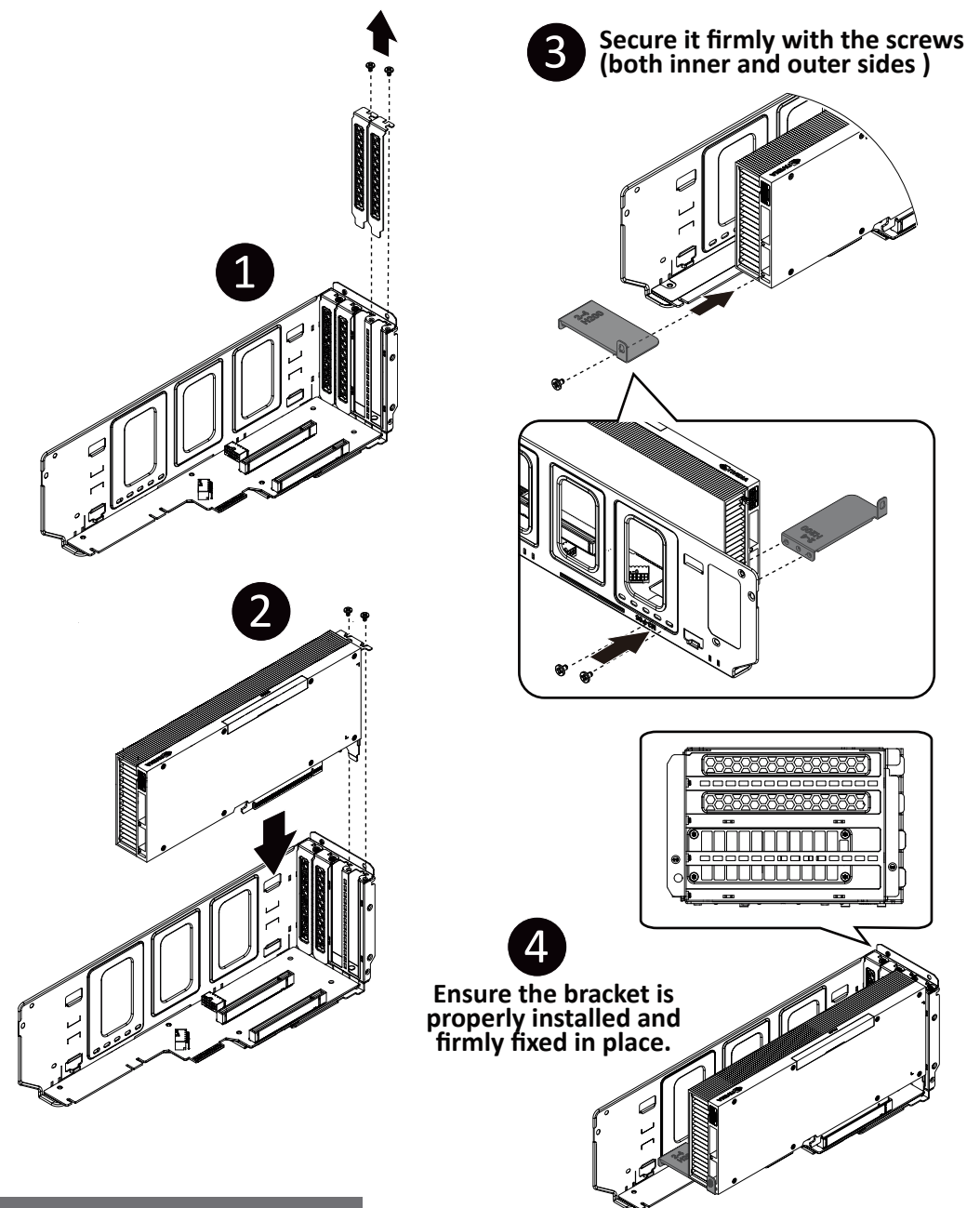
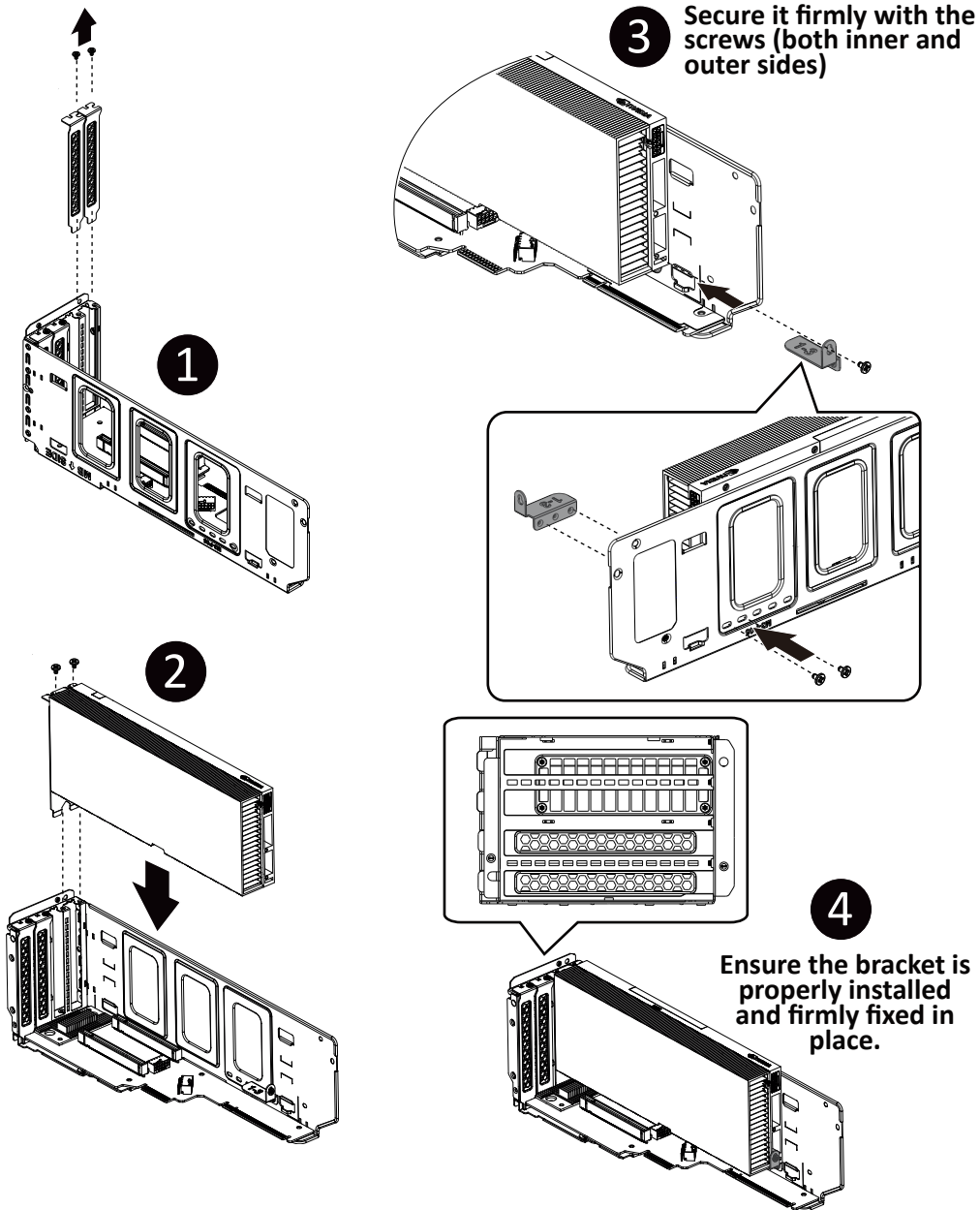

Applicable Models: G294-A21 / S41 / S45 / Z21 / Z41