

# INSTRUCTIONS FOR USE

nella®  
**KIND**

Single-Use

Single-Use Vaginal Speculum  
with Integrated LED Light Source

FROM



REF NSRL096 REF NSRL024



Instructions for Use

## DESCRIPTION

The Nella KIND is a single-use vaginal speculum with integrated sidewall retractors.

## INTENDED USE

The Nella KIND Single-Use is intended to dilate the vagina and expose the interior of the vagina and exterior of the cervix during gynecologic examinations and procedures.



## WARNINGS AND CAUTIONS

WARNING: Speculum is provided clean but not sterile.

WARNING: Inspect speculum prior to every use. Do not use if damaged.

WARNING: Treat used vaginal specula as biohazardous infectious material. Dispose of used vaginal specula in suitable disposable unit or in accordance with local regulations.



In this document, indicates conditions or practices that could lead to illness, injury, or death ("WARNING").



In this document, indicates conditions or practices may result in minor or moderate injury to the user or patient or damage to the equipment or other property ("CAUTION").



Consult Instructions for Use.



Federal law restricts this device to sale by or on the order of a medical professional.



Do not use if packaging is damaged.



Not made with natural rubber latex.



Fragile



Store at room temperature.



Store out of direct sunlight.



Product Identifier



Lot Identifier



Date of Manufacture



Medical Device



Do not re-use, Single-use device



Use by Date



This way up

## DIRECTIONS FOR USE

Always inspect Nella Single-Use for integrity prior to use.

Do not use if any flaws or signs of damage are found.

Nella Single-Use is shipped in the **locked** position.

① Slide the switch (A) up so it is in the unlocked position.

② Activate the integrated LED Light Source by pulling the activation ring (B) located along the upper bill just prior to use and dispose of ring.

③ Insert into vaginal canal and open by depressing thumb tab (C).

When opened sufficiently, slide switch (A) down to lock bills in position.

④ If necessary, increase open angle by further pushing down thumb tab (C).

⑤ To unlock, slide switch (A) up to unlock bills.

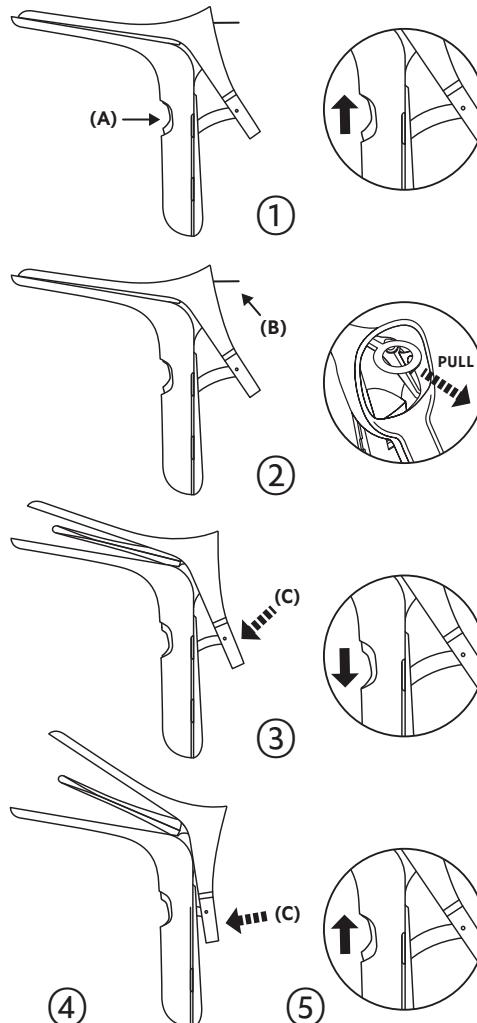

## WARRANTY

Please visit [ceekwomenshealth.com/warranty](https://ceekwomenshealth.com/warranty) for warranty information. Ceek Women's Health should be notified immediately of any defective units.

## MANUFACTURER

Ceek Women's Health  
2175 NW Raleigh Street, Suite 110  
Portland, OR 97210

[ceekwomenshealth.com](https://ceekwomenshealth.com)  
1-855-559-CEEK

Report any potential serious incidents to Ceek Women's Health and the competent authority of the clinic's member state.

Made in Malaysia

Patents:  
[ceekwomenshealth.com/patents](https://ceekwomenshealth.com/patents)

© 2018–2023 Ceek Women's Health

NSUIFUR1-2023