

Creator Series Mount Box

Product Manual

Welcome to Creator Series Mount Boxes

Thank you for purchasing this Creator Series Mount Box.

Creator Series, Monitor Audio's fourth-generation of architectural speakers pushes the boundaries of integrated speaker solutions by including advanced acoustics technologies, and clever functional design elements. Increasing the flexibility of any Creator Series speaker, the all-new Mount Boxes allow a contemporary surface-mount, 'on-wall' and 'on-ceiling' solution, where fully integrated options might be more difficult to install.

If you need any further assistance, please contact our technical team at monitoraudio.com/support

Contents

Welcome to Creator Series Mount Boxes	1
Whats in the Box	2
Using with CI Amplifiers	2
Flush Mounting	4
Raised Mounting	6
Specifications	8

What's in the Box

Included with the Creator Series Mount Boxes, you will get the following:

1 x Creator Series Mount Box

1 x Grille

4 x Self adhesive feet for raised mounting

4 x Self adhesive foam stickers to cover the screws to maintain an airtight seal.

1 x Drill Template

1 x QSG

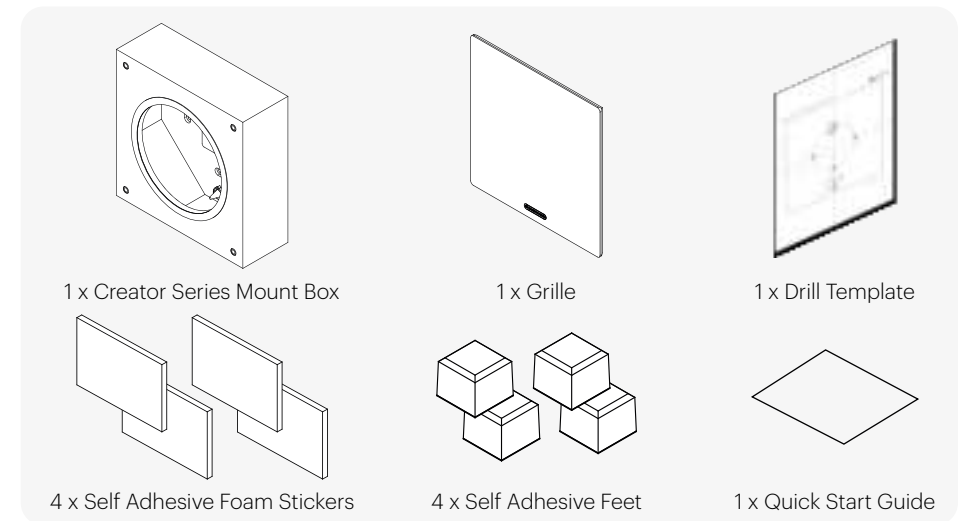

Using with CI Amplifiers

When using the Mount Boxes with the Creator Series speakers and our Installation Amplifiers, there are dedicated EQ and protection presets already created in our speaker library. These ensure optimum performance of the loudspeaker in the Mount Box.

The library can be downloaded from the Installation Amplifiers product page here:

EQ & Protection Presets



Flush Mounting

This mounting option is to be used when the cable is recessed into the wall/ ceiling.

Once the locations have been decided based on the recommended AV or coverage guidelines follow these few simple steps to secure the Mount Boxes on the wall or ceiling.

NOTE - Check there are no pipes or cables in the wall or ceiling.

NOTE - If you are unsure of the ability to provide a secure and safe fixing for the mount box and speaker, please seek the advice from a professional installer.

NOTE - Minimum recommended screw specification is No 10 pan head screw.

1. Use the template to mark the fixing points and cable through hole.

Make note of the key hole bracket location as this is the first fixing point.

2. Drill the holes required using the appropriate drill and depth depending on wall construction and fixing type.
3. Put a screw into the wall/ ceiling where the key hole bracket is on the Mount Box, leaving it proud from the wall/ ceiling by approx 5mm.
4. Cut the grommet on the Mount Box to accept the size of cable being used to ensure an air tight finish.
5. Feed the speaker cable through the grommet on the mount box.
6. Slot the Mount Box over the first screw and tighten a little if necessary.
7. With the Mount Box held in place by the key hole fixing, secure it using the remaining fixing points.
8. Check that it is aligned correctly, if not, loosen the screws slightly and rotate accordingly.
9. To ensure the screw holes do not leak air, cover them with the supplied stickers.
10. Fit the Quik-Link from the speaker packaging onto the speaker cable.
11. Attach the Quik-Link on to the speaker.
12. Fit the speaker into the Mount Box.
13. Fit the Mount Box Grille onto the Mount Box, ensuring it is pressed securely in place. There is no need to use the grille supplied with the speaker.

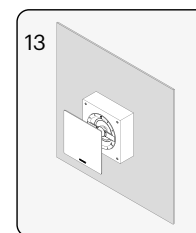
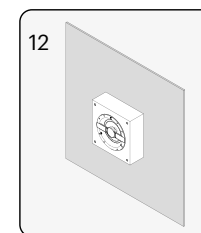
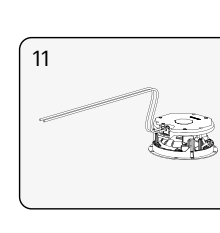
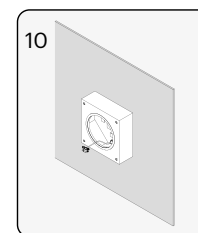
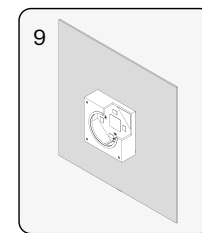
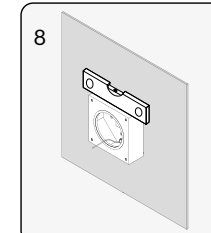
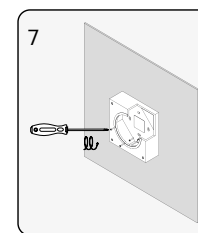
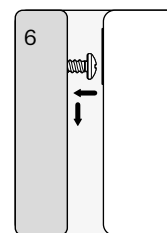
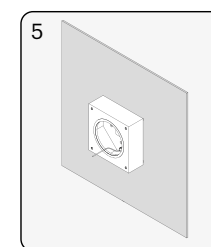
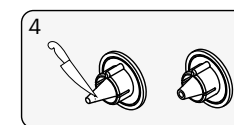
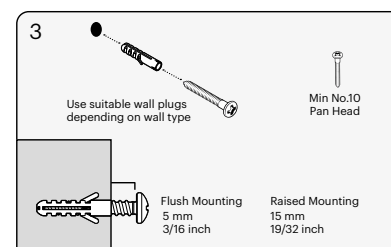
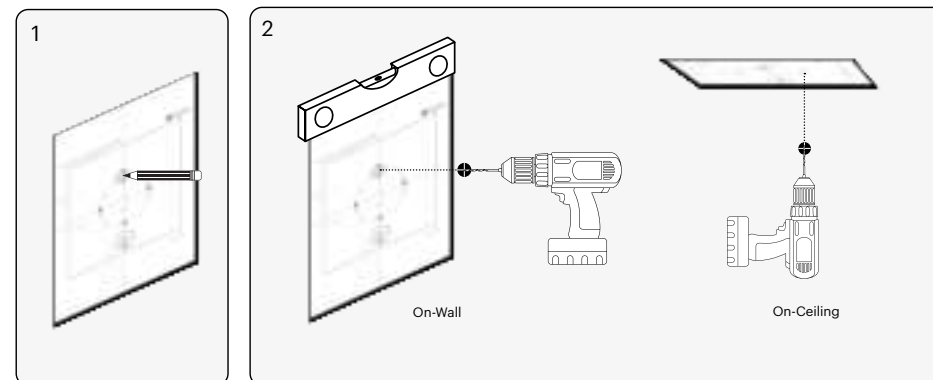

Raised Mounting

This mounting option is to be used when the cable is outside of the wall/ ceiling or it is very uneven.

Once the locations have been decided based on the recommended AV or coverage guidelines follow these few simple steps to secure the Mount Boxes on the wall or ceiling.

NOTE - Check there are no pipes or cables in the wall or ceiling.

NOTE - If you are unsure of the ability to provide a secure and safe fixing for the mount box and speaker, please seek the advice from a professional installer.

NOTE - Minimum recommended screw specification is No 10 pan head screw.

1. Use the template to mark the fixing points and cable through hole.
Make note of the key hole bracket location as this is the first fixing point.
2. Drill the holes required using the appropriate drill and depth depending on wall construction and fixing type.
3. Put a screw into the wall/ ceiling where the key hole bracket is on the Mount Box, leaving it proud from the wall/ ceiling by approx 5mm.
4. Add the supplied feet to stand the Mount Box away from the wall/ ceiling.
5. Cut the grommet on the Mount Box to accept the size of cable being used to ensure an air tight finish.
6. Feed the speaker cable through the grommet on the mount box.
7. Slot the Mount Box over the first screw and tighten a little if necessary.
8. With the Mount Box held in place by the key hole fixing, secure it using the remaining fixing points.
9. Check that it is aligned correctly, if not, loosen the screws slightly and rotate accordingly.
10. To ensure the screw holes do not leak air, cover them with the supplied stickers.
11. Fit the Quik-Link from the speaker packaging onto the speaker cable.
12. Attach the Quik-Link on to the speaker.
13. Fit the speaker into the Mount Box.
14. Fit the Mount Box Grille onto the Mount Box, ensuring it is pressed securely in place. There is no need to use the grille supplied with the speaker.

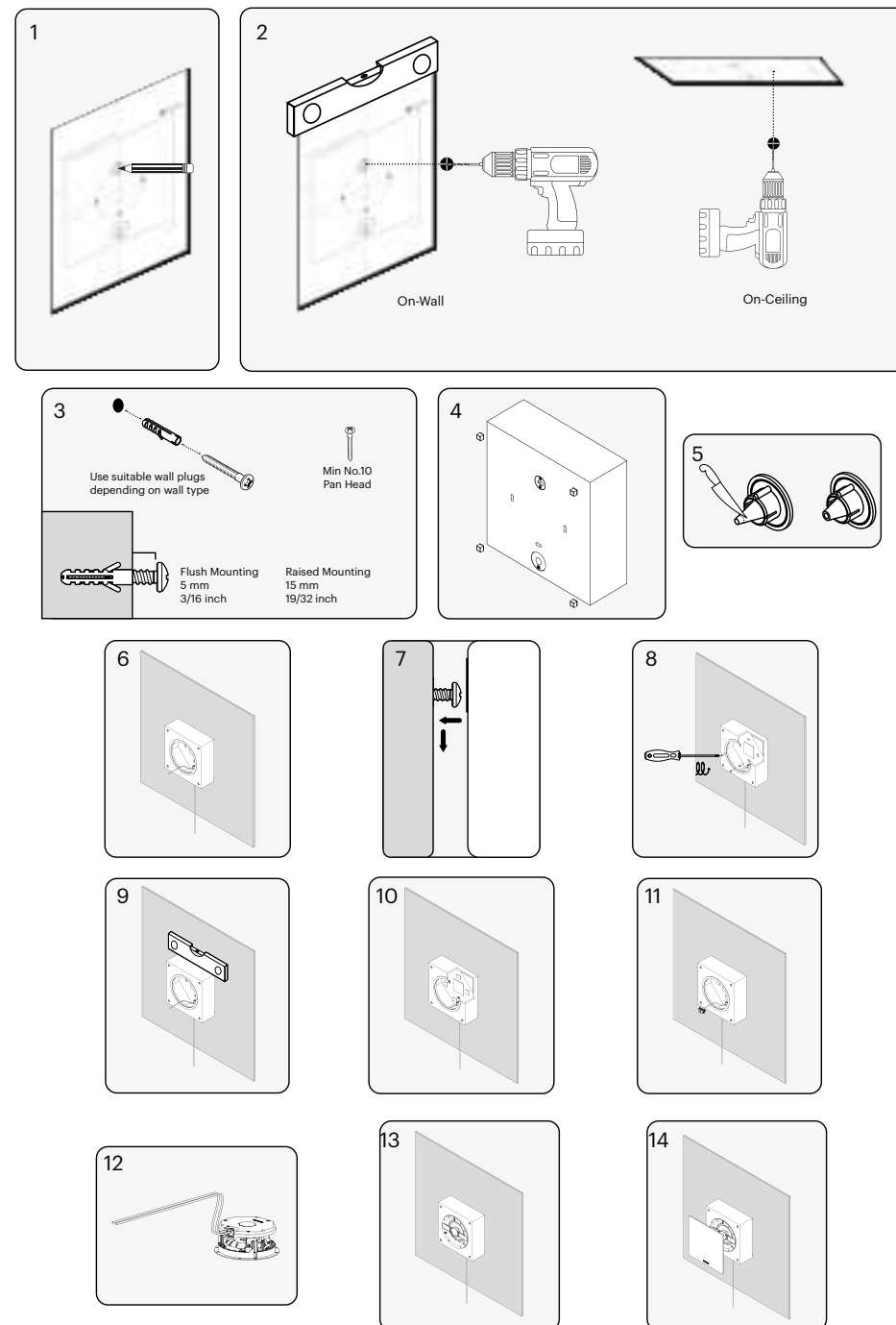

Specifications

Model Name	WM	CS	CM	CL	CL-D
For use with (products)	W1M / W2M / W3M	C1S / C2S	C1M / C2M / C2M-T2X	C1L / C2L / C2L-T2X	C3L / C3LA
Available Finishes	Satin White Matte Black	Satin White Matte Black	Satin White Matte Black	Satin White Matte Black	Satin White Matte Black
External Dimensions with all accessories fitted (H x W x D)	619 x 290 x 113 mm (24¾ x 11⅞ x 4⅞")	280 x 280 x 127mm (11 x 11 x 5")	320 x 320 x 127mm (12⅝ x 12⅝ x 5")	360 x 360 x 127mm (14⅜ x 14⅜ x 5")	360 x 360 x 186mm (14⅜ x 14⅜ x 7⅝")
Minimum screw specification	No.10 Pan Head Screw	No.10 Pan Head Screw	No.10 Pan Head Screw	No.10 Pan Head Screw	No.10 Pan Head Screw
Weight (Product, Each)	4.4 kg (9 lb 11 oz)	2.9 kg (6 lb 6 oz)	3.3 kg (7 lb 4 oz)	3.9 kg (8 lb 10 oz)	4.9 kg (10 lb 13 oz)
Sold As	Single	Single	Single	Single	Single

Monitor Audio reserves the right to alter specifications without notice.

Quik-Link: EP Patent Application No. 23822438.0

Listen Again.

Monitor Audio Ltd.
24 Brook Road
Rayleigh, Essex
SS6 7XJ
England
Tel: +44 (0)1268 740580
Email: info@monitoraudio.group

monitoraudio.com