

08 Connect the X-axis Motor Cable

Insert the motor cable (short Orange 6 Pin cable) upward into the bottom groove on the left side of the X-axis to tighten it. Note that the cable buckle faces towards you.

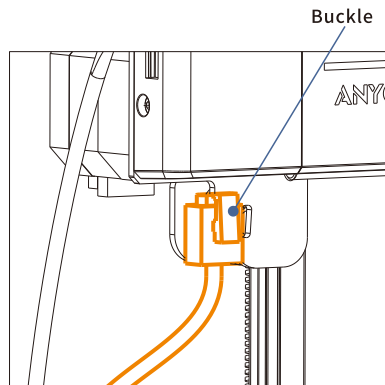
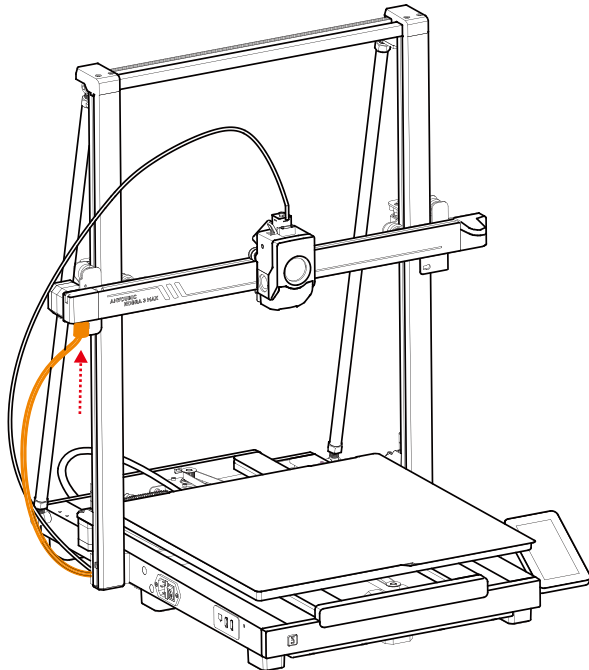

09 Cable Holder Installation

1. Press down the cable holder to secure it to the groove on the left side of the X-axis.
2. Insert the printhead cable into the cable holder.

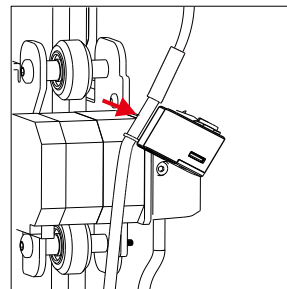
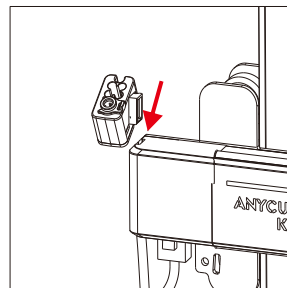
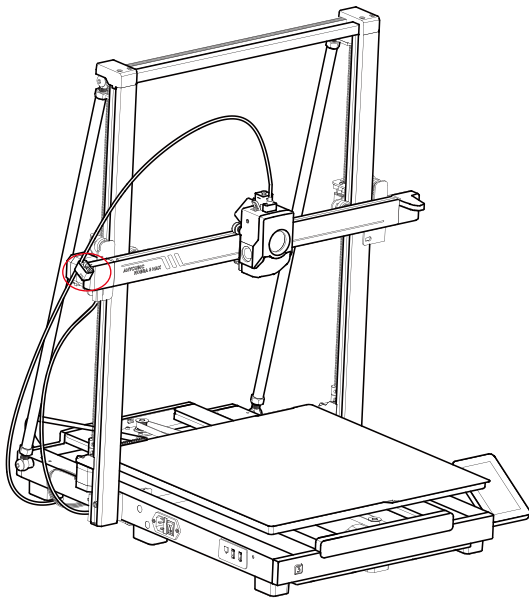

10 Filament Tube Connection (skip this step for multicolor printing)

1. Insert one end of the filament tube into the hub above the printhead and the other end into the cable holder.
2. Snap the filament tube and printhead cable into the cable organizer.

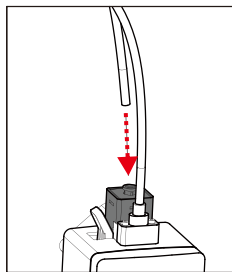
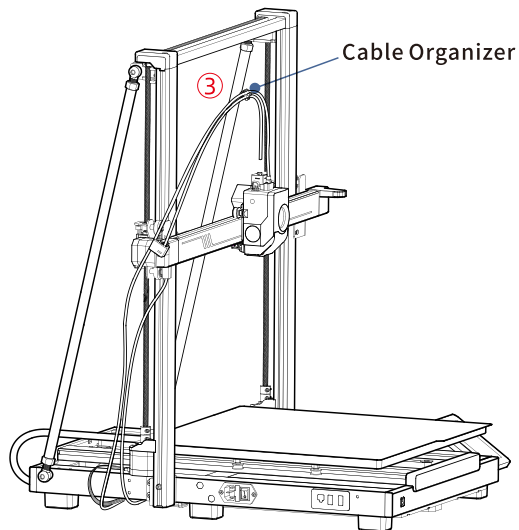

①

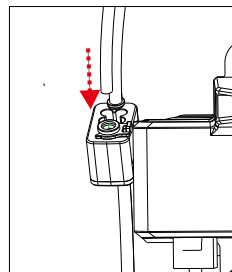

②