

2.Ap Mode:

Select AP Mode at upper right corner on the App. Please make sure the red light blink slowly, and the device is in AP mode. After entering your WIFI password and connect your phone to door sensor's WiFi hotspot then press "Connect Now".

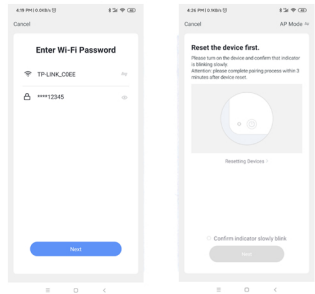

Connecting :

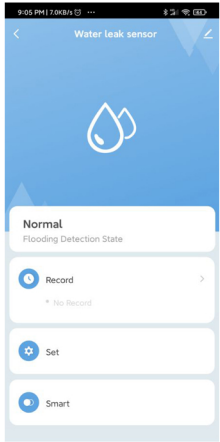
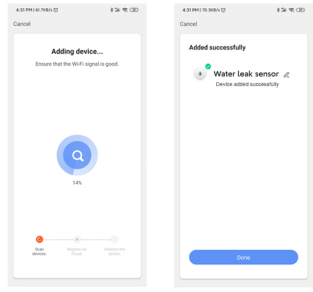

Phone Notification Setting
(America,Canada, United Kingdom,China Supported Only)

You can set Phone notification through Adding Automation Soenano.

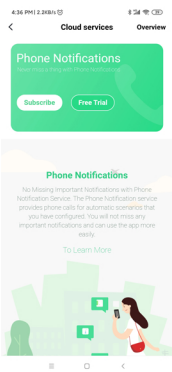

Note: This is optional paid features,non-product standard functionz.

Share & Push Notification

Sharing: Share your devices to other people. Select Profile menu as below and choose Device Sharing.

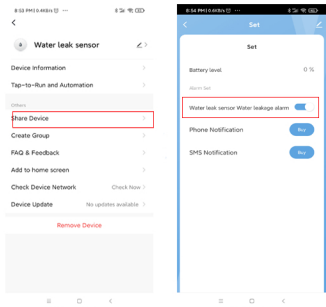

Push Notification: Choose Settings tap on top right corner and turn on the Push Notification

LED State

Device Status	LED State
Smart-Wi-Fi Mode	LED rapidly blinks
AP Mode	LED slowly blinks

Smart Water Sensor
INSTRUCTION



Product configuration

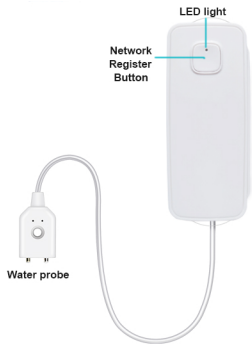

Main Function:

Detect water leakage
APP notice
Alarm volume 80dB

Specifications

Battery: AAA1.5V x 2
Standby current: ≤5uA
Protocol:IEEE 802.11b/g/n
Wireless Range: 50m
Operating Temperature: 0℃ ~ 55℃
Operating Humidity: 20% ~85%
Storage Temperature: -10℃~60℃ (14°F~140°F)
Storage Humidity: 0%~90%
Standby time: 6 - 10 months
Wireless Type: 2.4GHz
Size:Main body: 93mm x40mm x20 mm
Small body: 93mm x 13mm x 20 mm
Cable length: 1m



Tuyasmart



Smartlife

Download App

- 1.Android Smart Phone: download"Smart Life"from GooglePlay.
- 2.IOS iphone: download"Smart Life" from App Store.
3. Scan this QR to download the APP



Run App

- 1.Run "Smart Life" from your smartphone
- 2.Register and login

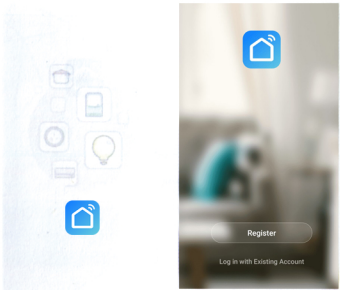

Note: Open the phone settings to ensure smart life app notifications permission is turned on.

Add Flood Sensor

Select Device Type, select "Sensor" in the list to add the "Flood Detector (WiFi)"

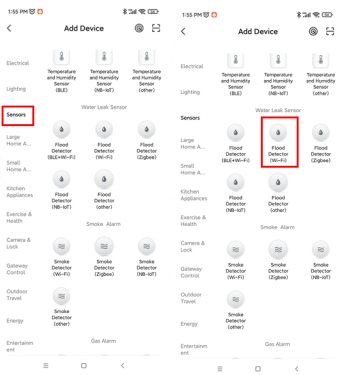

Network Configuration

Remove the insulation sheet to the WI-FI configuration network mode, the red light flashes quickly.

If the wifi configuration mode fails or cannot connect to the network, press the Reset button for 6 seconds to enter the AP Mode, the red light will flash slowly. If you still can't connect, press Reset button again for 8 seconds to restore the factory settings, then judge the red light status as flashing quickly or slowly.

