

**8 drawers dresser**

# Assembly Instructions



## Safety And Care Advice

**Important – Please read these instructions fully before starting assembly.**

1. Please check if all the components and tools listed out are received.
2. Please remove all fittings from the plastic bags and separate them into homologous groups.
3. Please keep children and animals away from the working areas; swallow small parts may cause suffocation.
4. Please make sure you have enough space to lay out the parts before starting.
5. Do not stand on the product, which could cause damage.
6. Please assemble the product as close to its final position as possible.
7. Do not place furniture directly in front of radiators, fires, or any other source of heat.
8. The assembly will be easier with 2 people.
9. Please dispose of all packaging carefully and responsibly.

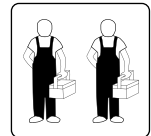

### General care and maintenance

1. Please clean with a damp cloth or mild detergent, do not use bleach or abrasive cleaners.
2. Do not allow the spill to stay on the surface for a long time.
3. Do not clean with products containing the following: acetone (e.g., nail varnish remover), ammonia (e.g.bleach), or sodium hydroxide(e.g., caustic soda, drain, and oven cleaners).
4. If the product is accidentally exposed to the irritating liquid, rinse thoroughly with clean water.
5. Mats can be used to protect surfaces from moisture and heat.
6. Please check whether there are missing screws in the product regularly.
7. The product should not be discarded with household waste, and please take it to your local authority waste disposal center.

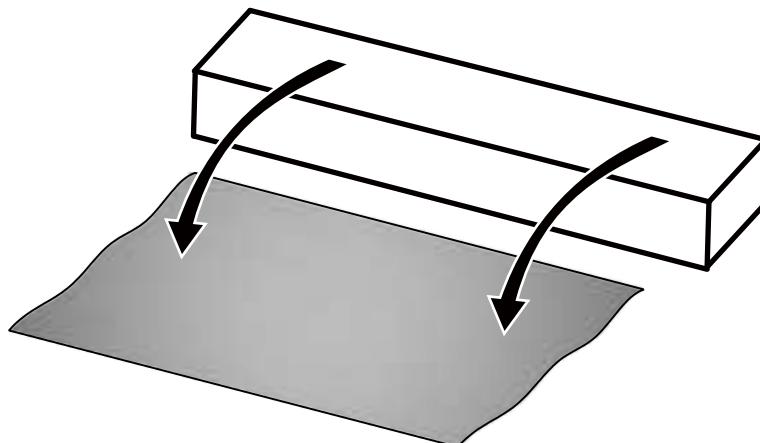

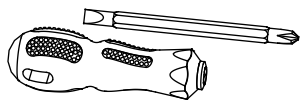
**Q**

1x

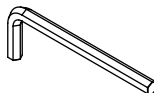
**R**

1x

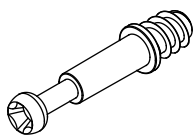
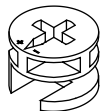
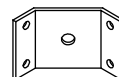
**A** $\varnothing 6 \times 35$  mm  
54x**B** $\varnothing 15 \times 10$  mm  
54x**C** $\varnothing 8 \times 30$  mm  
20x**D**

4x

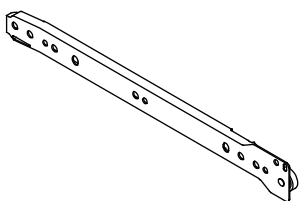
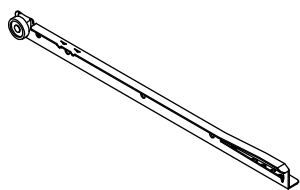
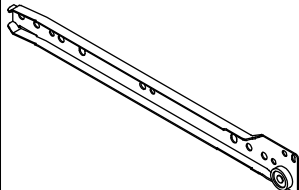
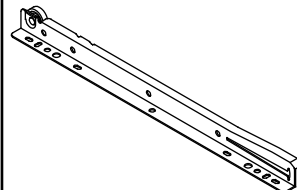
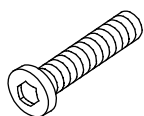
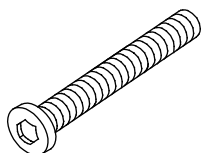
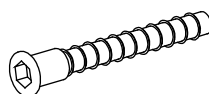
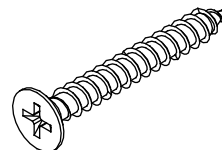
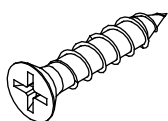
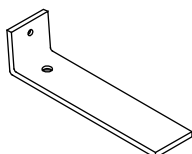
**CL**12 inch  
8x**DL**12 inch  
8x**CR**12 inch  
8x**DR**12 inch  
8x**E** $\varnothing 6 \times 25$  mm  
4x**F** $\varnothing 6 \times 40$  mm  
4x**G** $\varnothing 6 \times 50$  mm  
6x**H** $\varnothing 4 \times 35$  mm  
48x**I** $\varnothing 4 \times 25$  mm  
2x**J**

2x

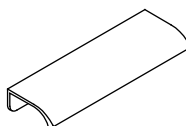
**K**

8x

**L**Colored screws  
 $\varnothing 3.5 \times 12$  mm  
16x

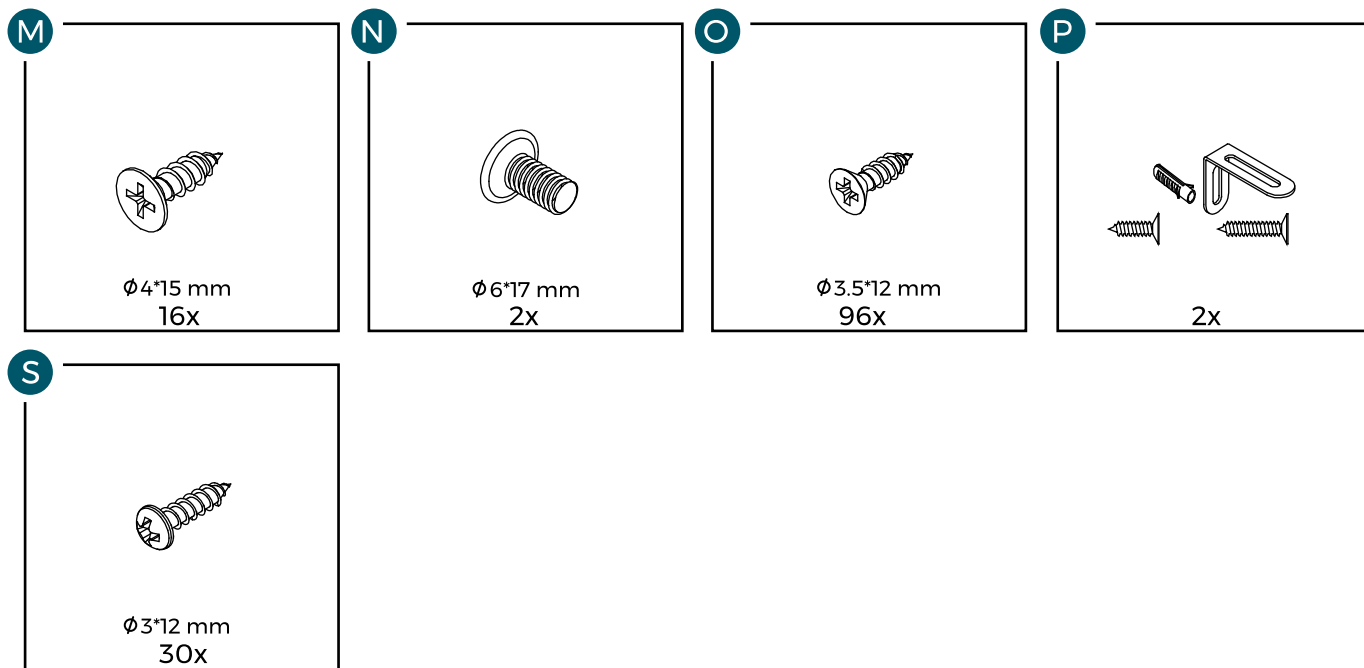

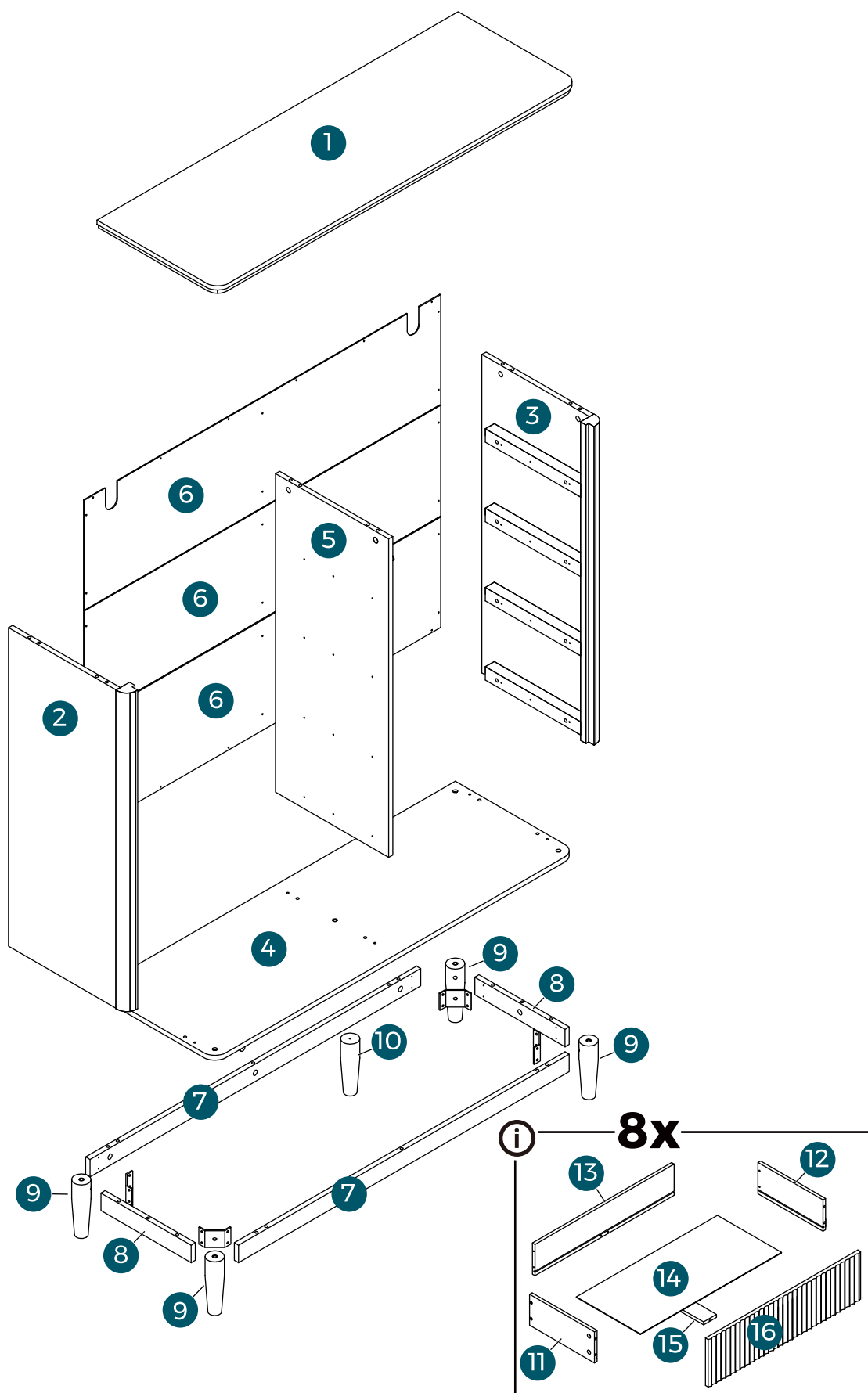

# 1

CL x 4pcs

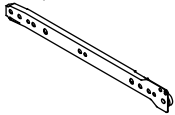

O x 12pcs

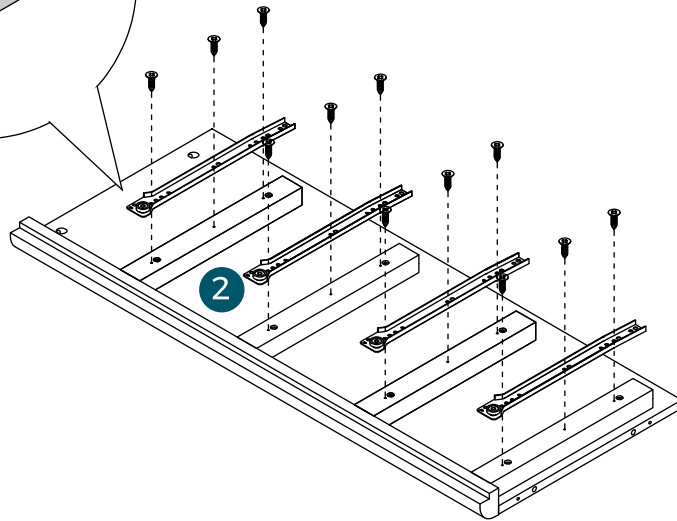
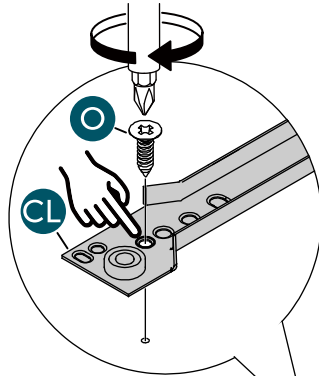

# 2

CR x 4pcs

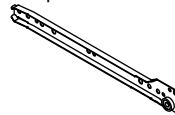

O x 12pcs

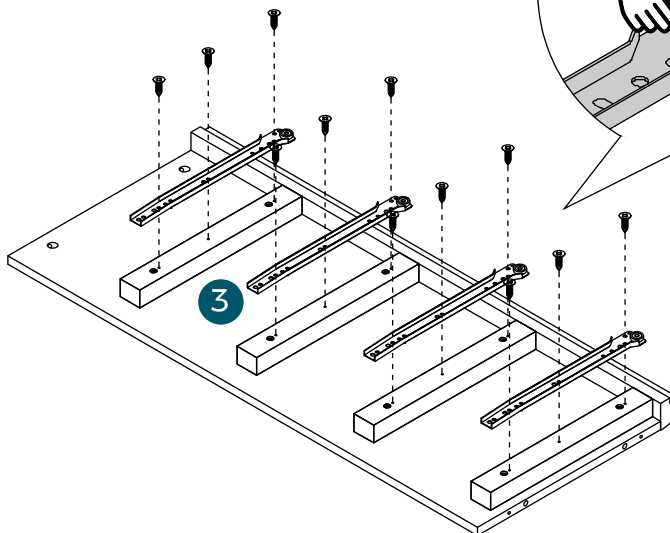
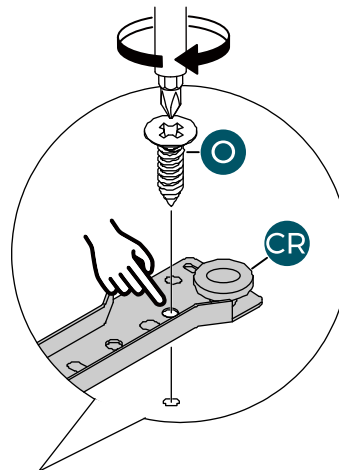

# 3

CL x 4pcs

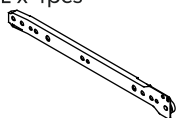

CR x 4pcs

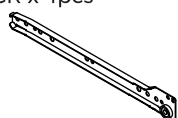

O x 24pcs

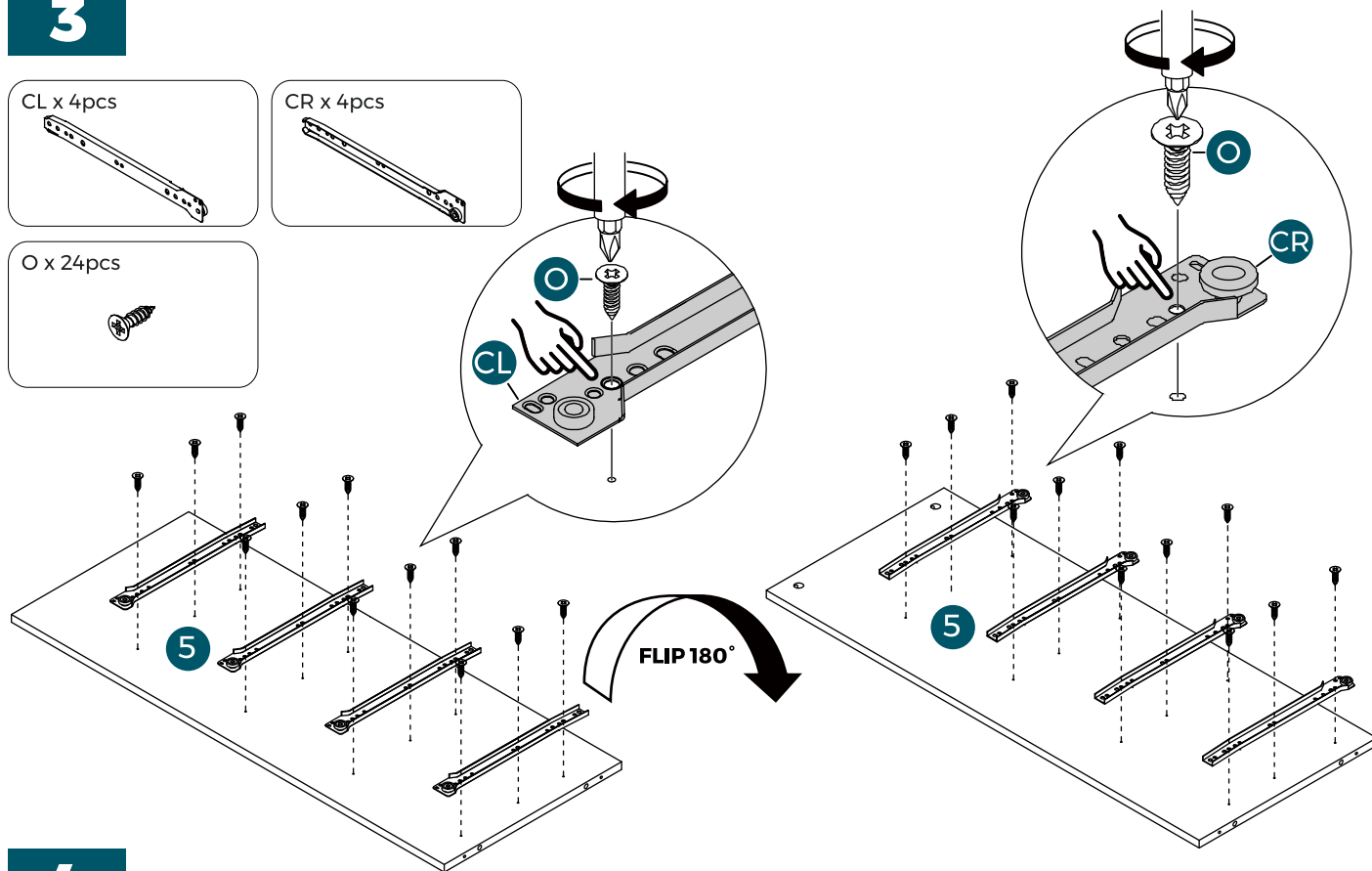

# 4

A x 14pcs

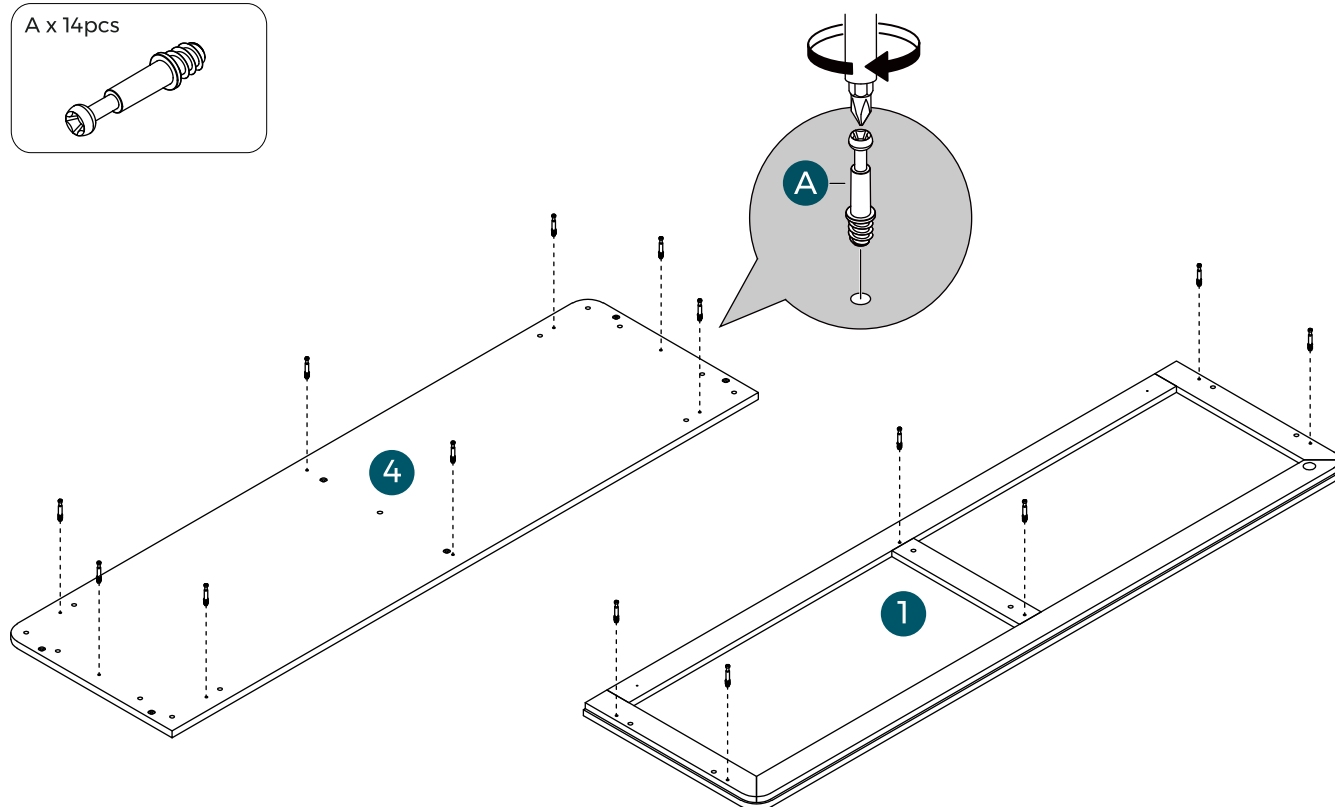
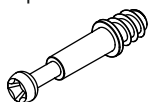

# 5

B x 8pcs



C x 8pcs

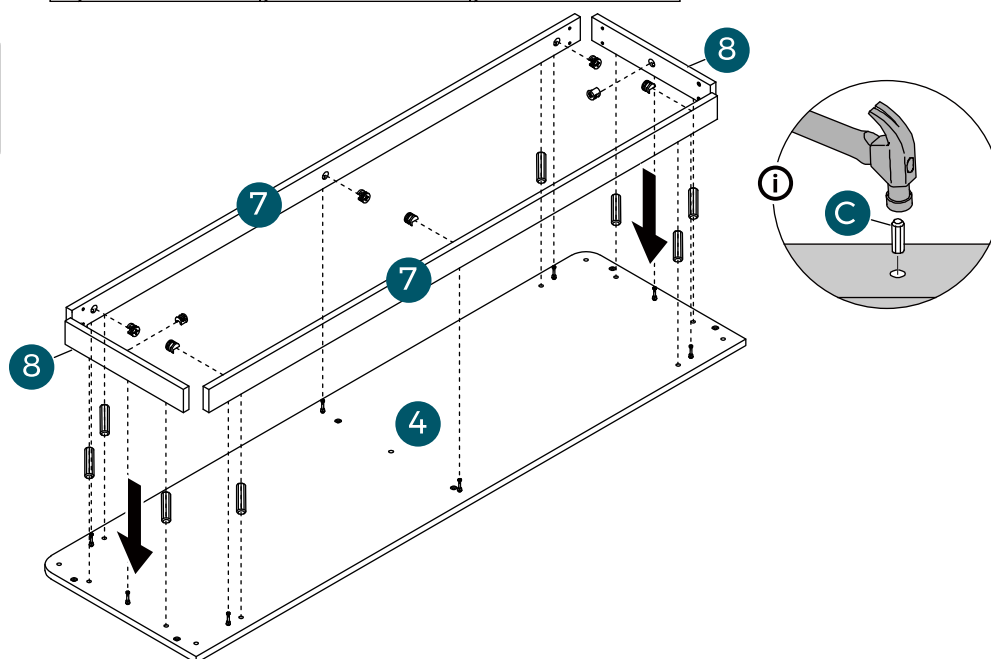
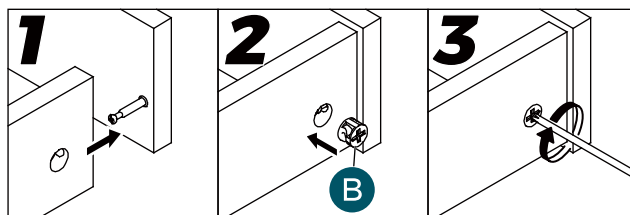

# 6

D x 4pcs



F x 4pcs



M x 16pcs

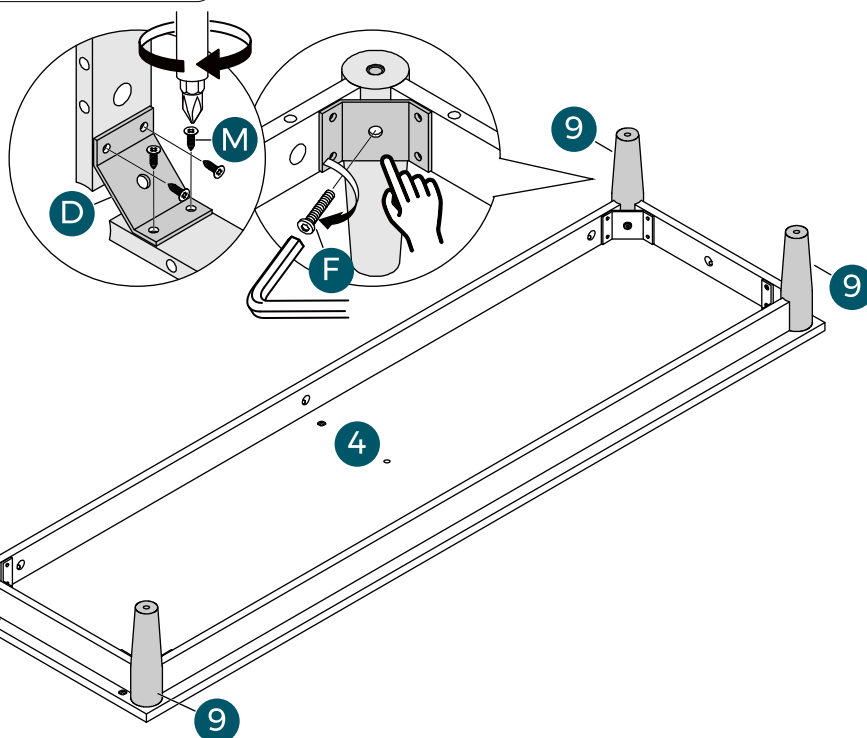



# 7

I x 2pcs



J x 2pcs

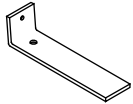

N x 2pcs



**i** Start by securing the “N” screws, followed by the “I” screws. As no pilot holes have been drilled in the front of the wooden legs, driving in the “I” screws will require more force. Please exercise caution.

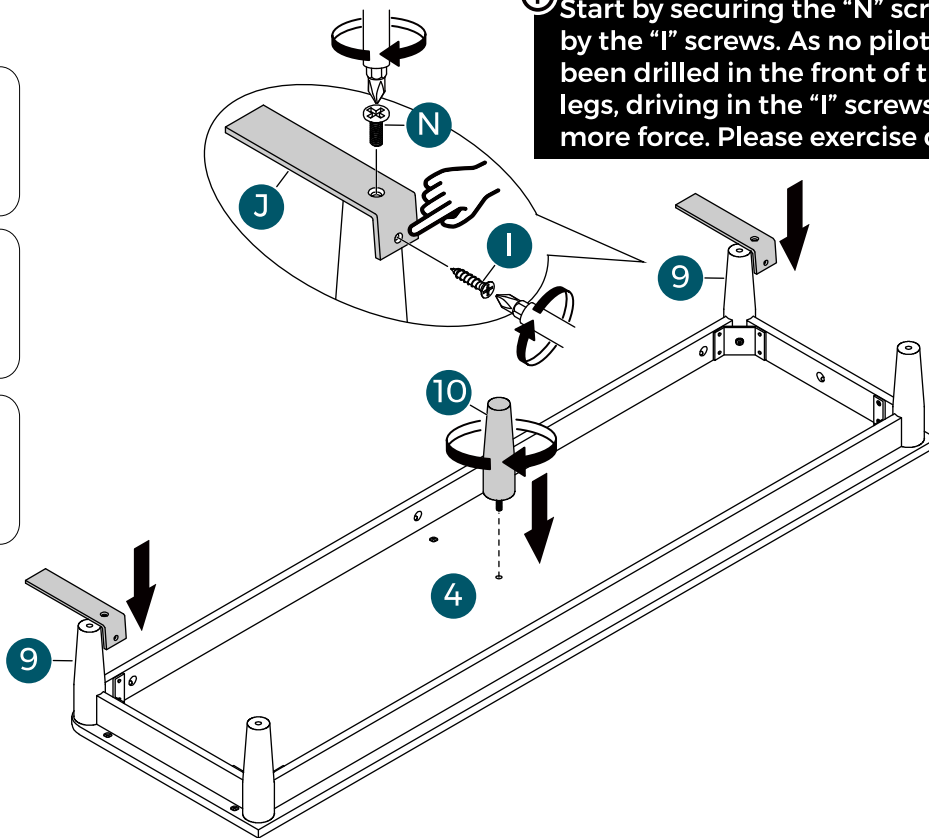

# 8

E x 4pcs

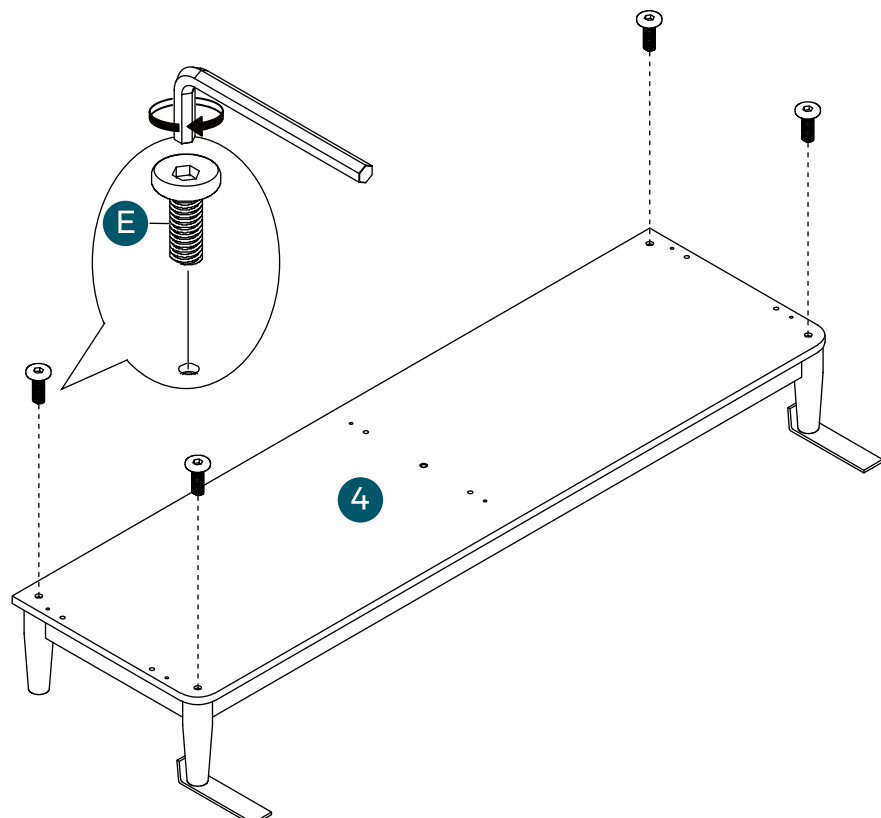

9

C x 4pcs



G x 4pcs

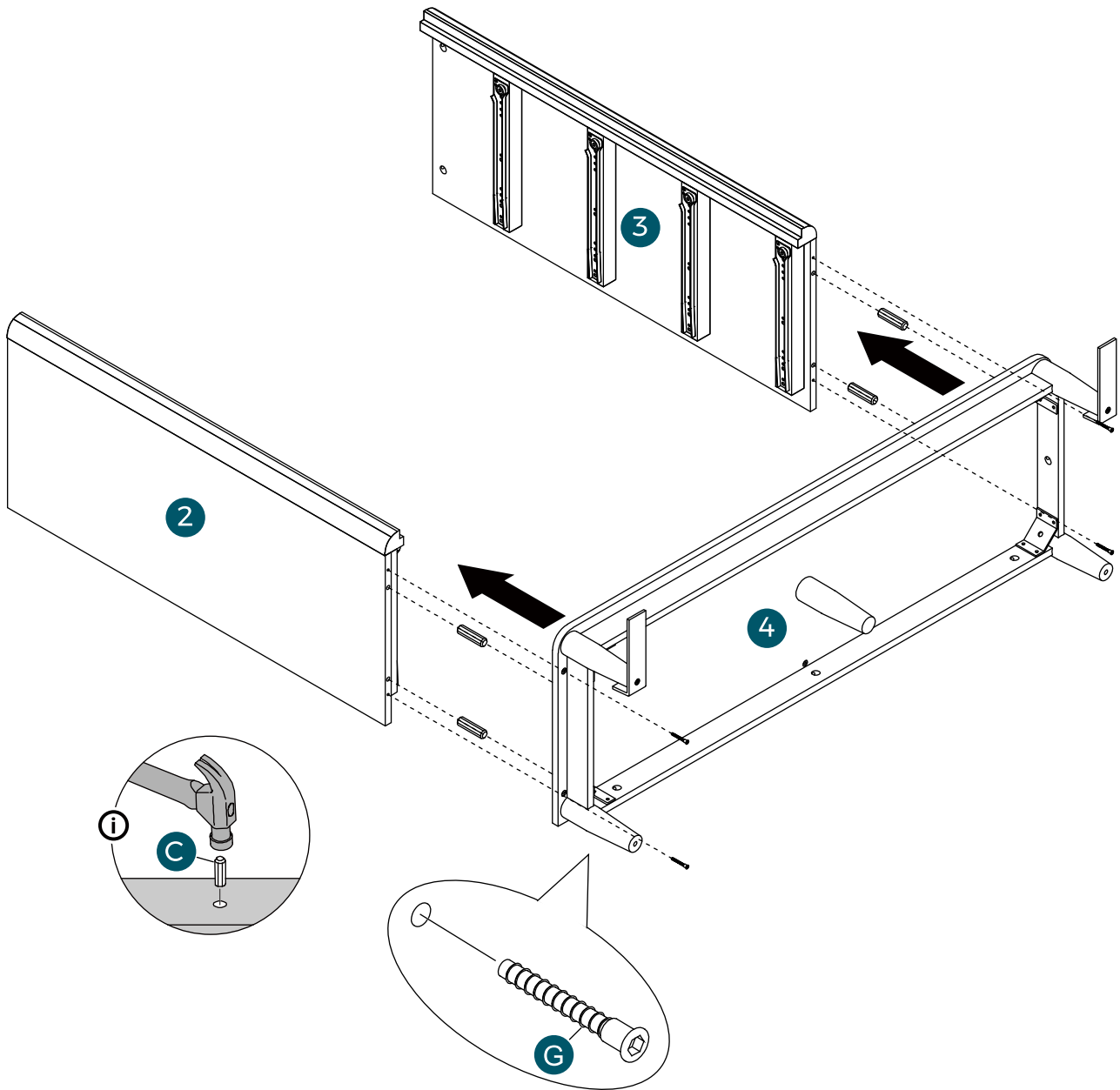
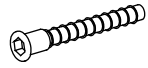

10

C x 2pcs



G x 2pcs

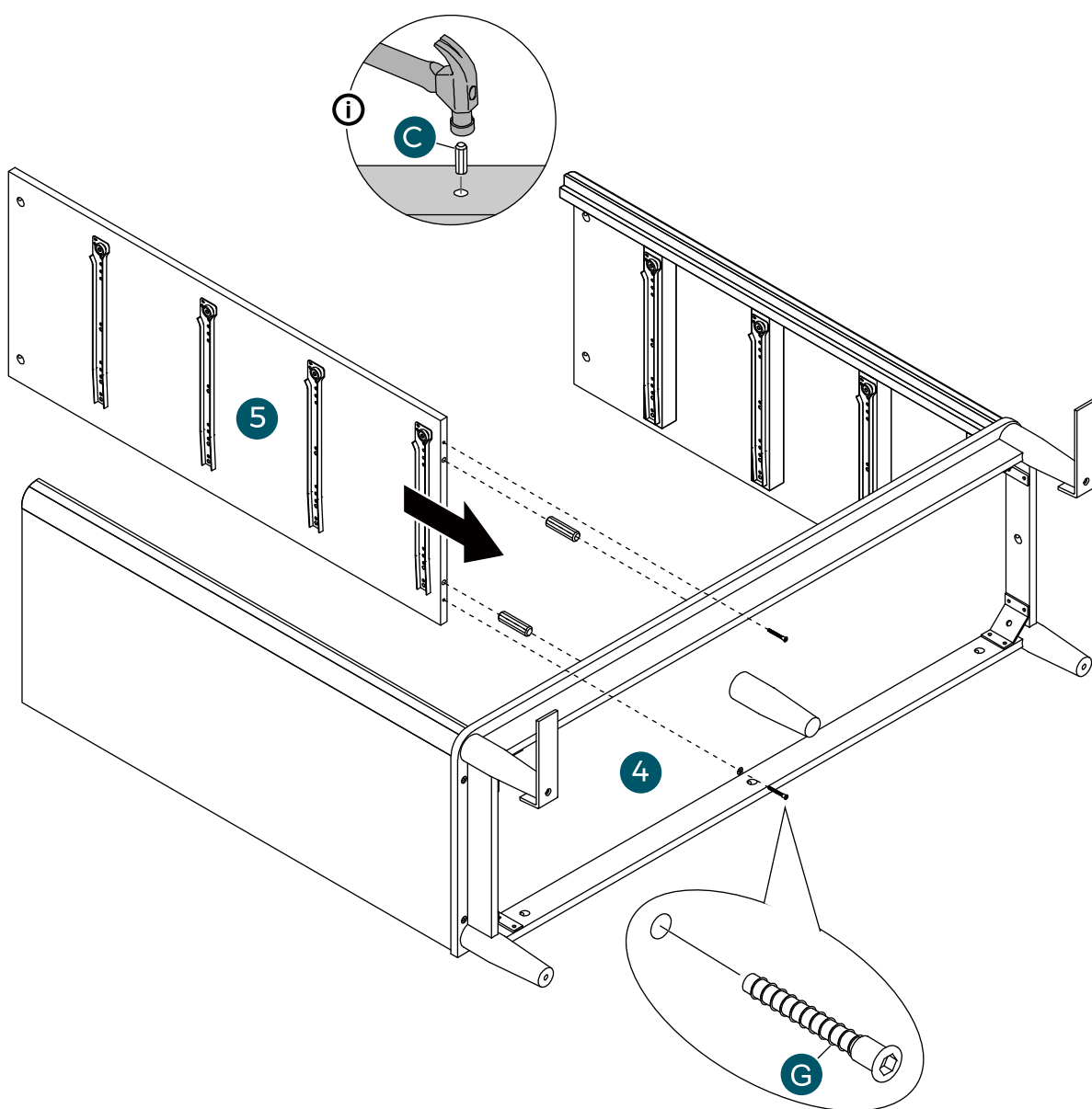
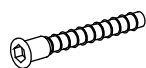

# 11

B x 6pcs



C x 6pcs

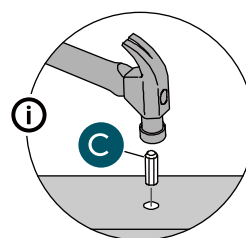
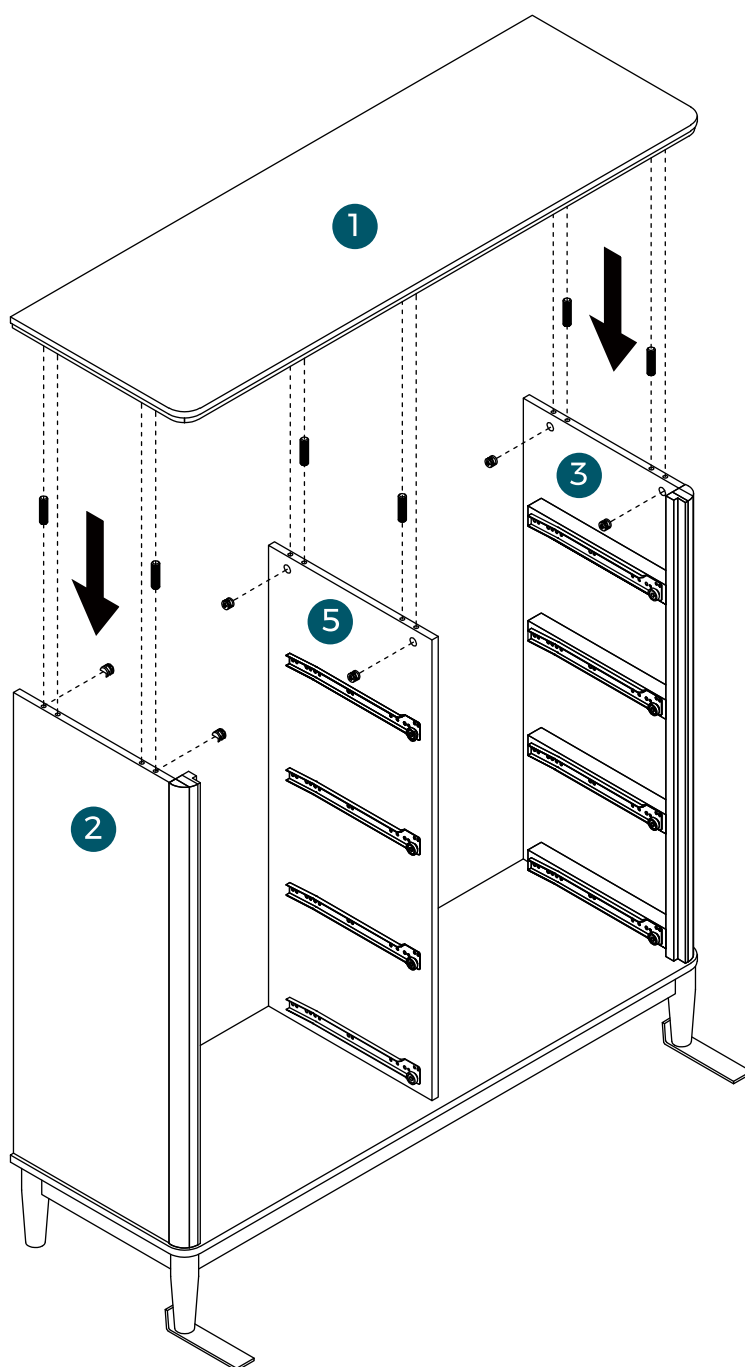
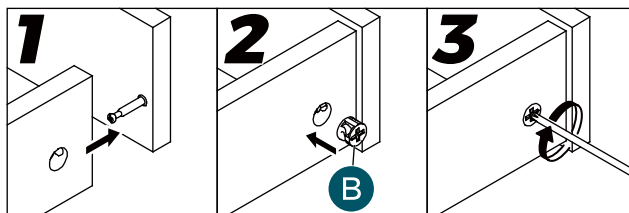

# 12

S x 30pcs



**FAILURE TO FOLLOW ALL DIRECTIONS ON THIS PAGE  
MAY RESULT IN UNEVEN DOOR ALIGNMENT**

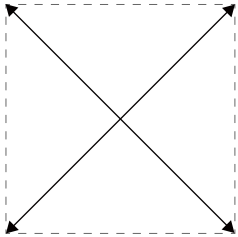

Begin by installing all of the screws along one edge of the back panel. Next, using a square or tape measure, make sure that the cabinet is square. (If using a tape measure, the distance from one corner, diagonally to the other corner should be the same in both directions.) If not, apply gentle pressure to the diagonally opposite corners to shift case into alignment. Re-measure to ensure equal distances. Install the remaining screws, starting with the corners.

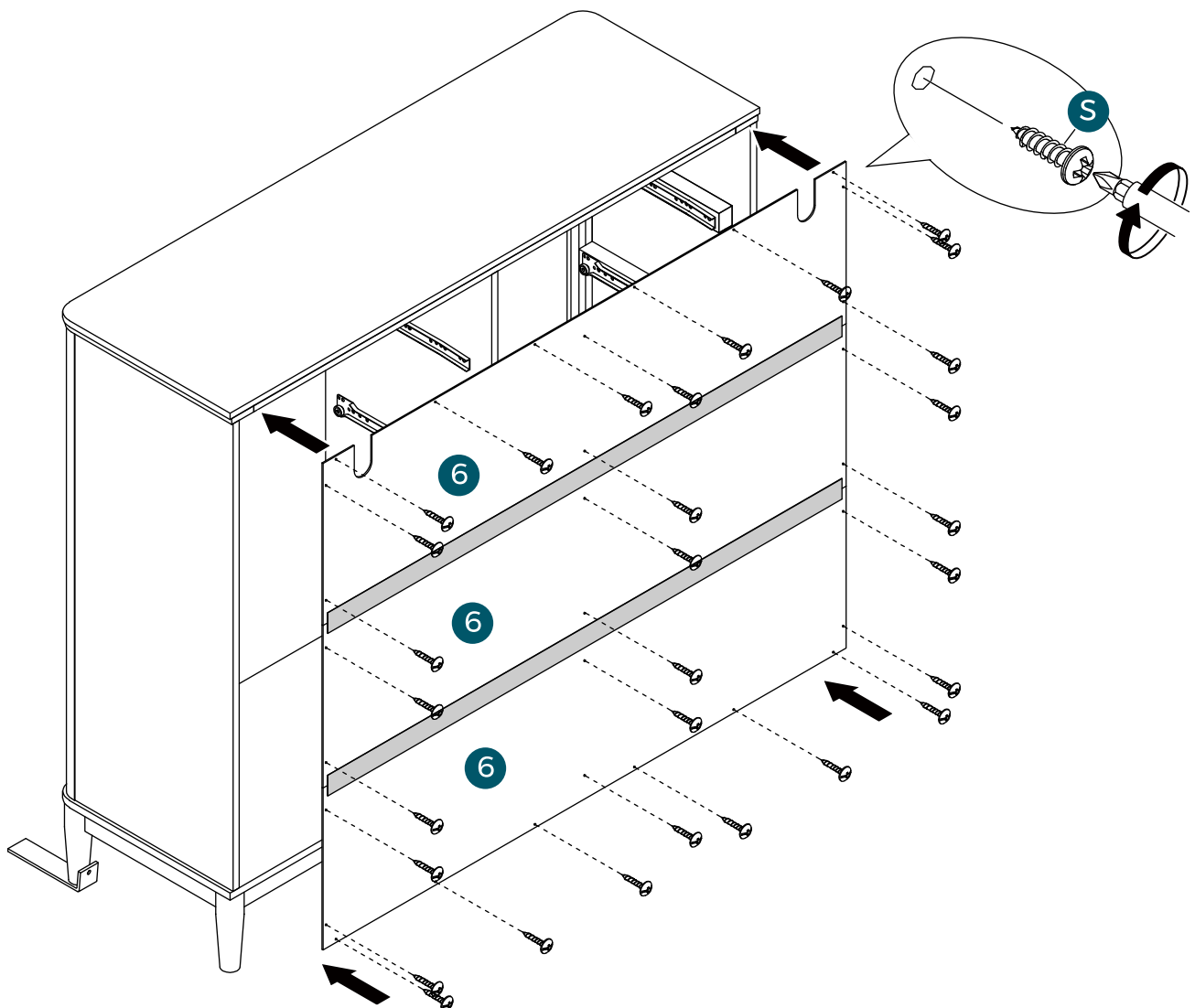

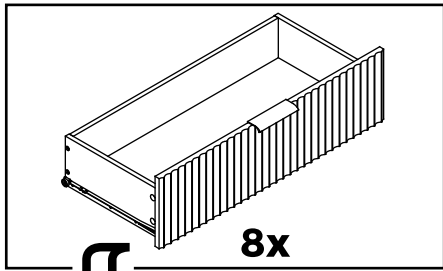

**13**

H x 32pcs

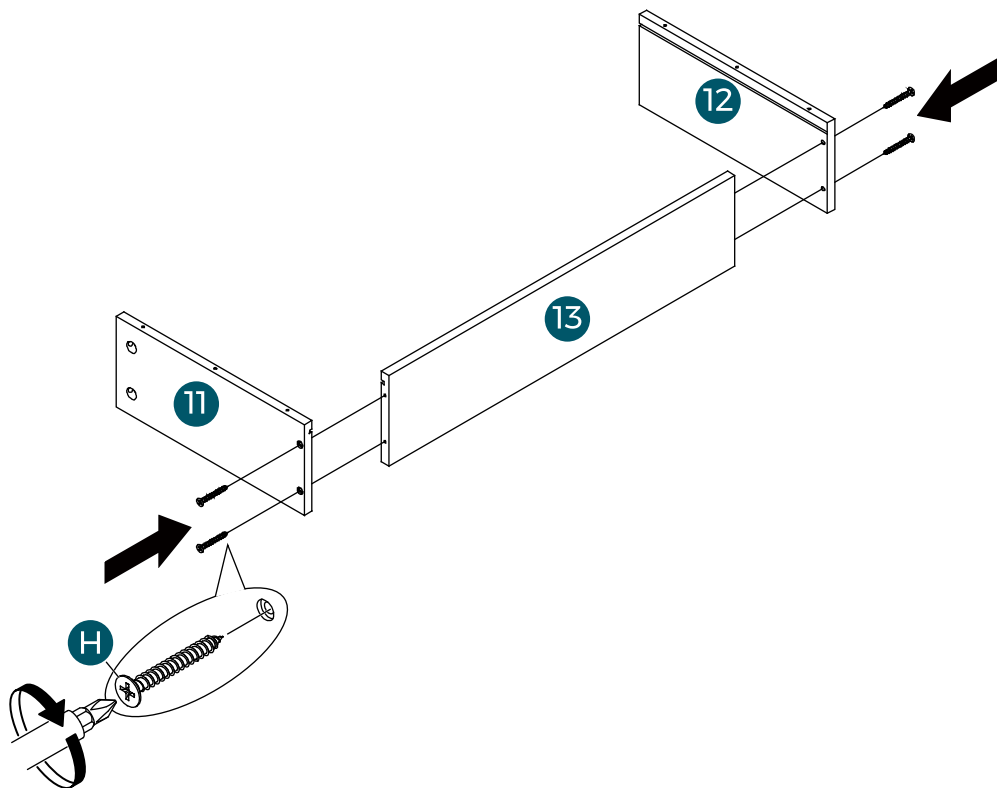

# 14

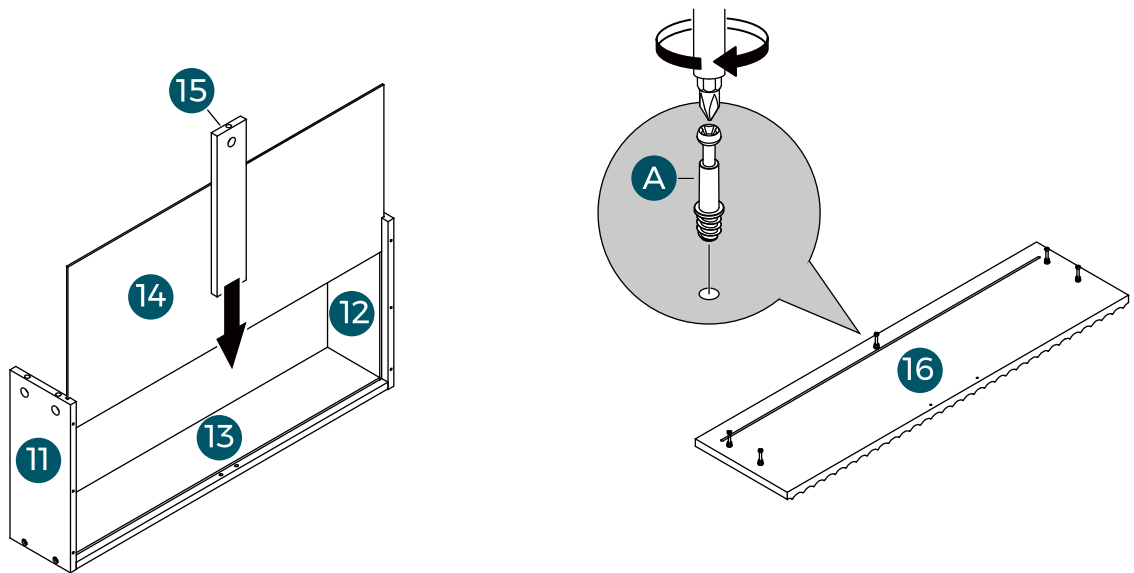
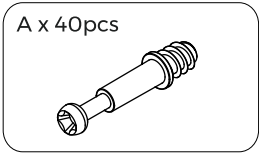

# 15

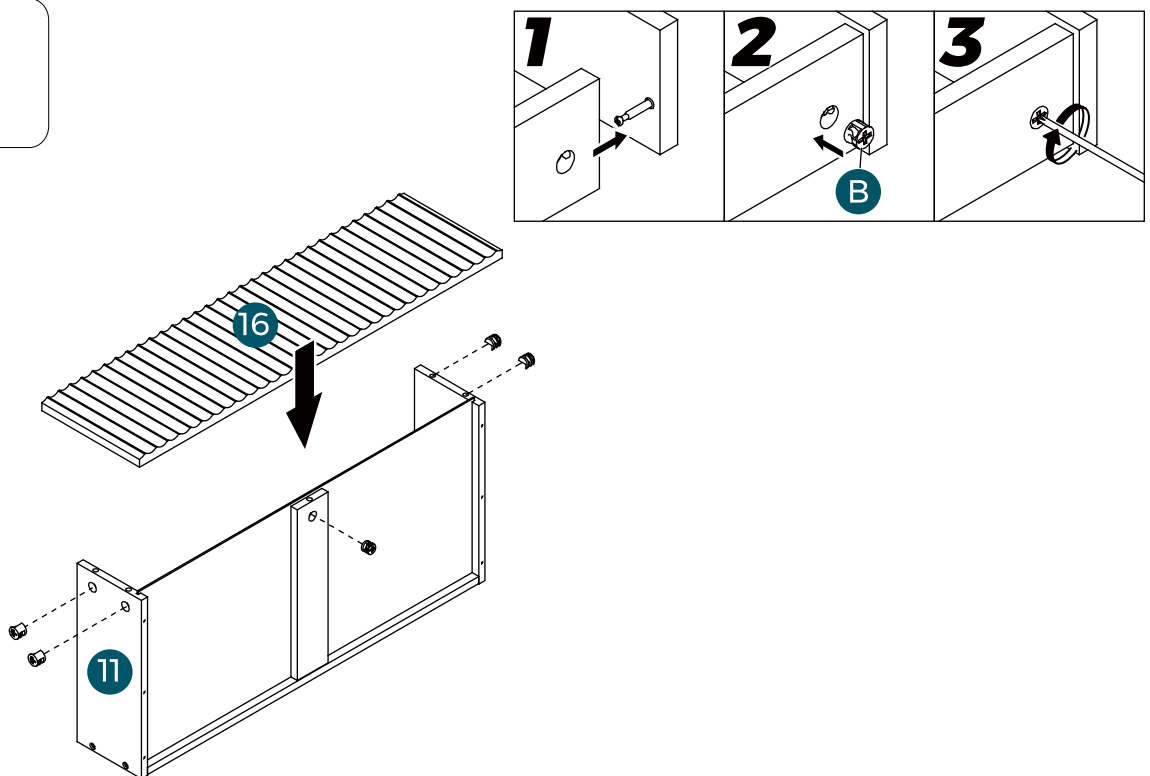
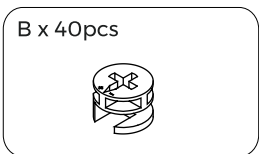

# 16

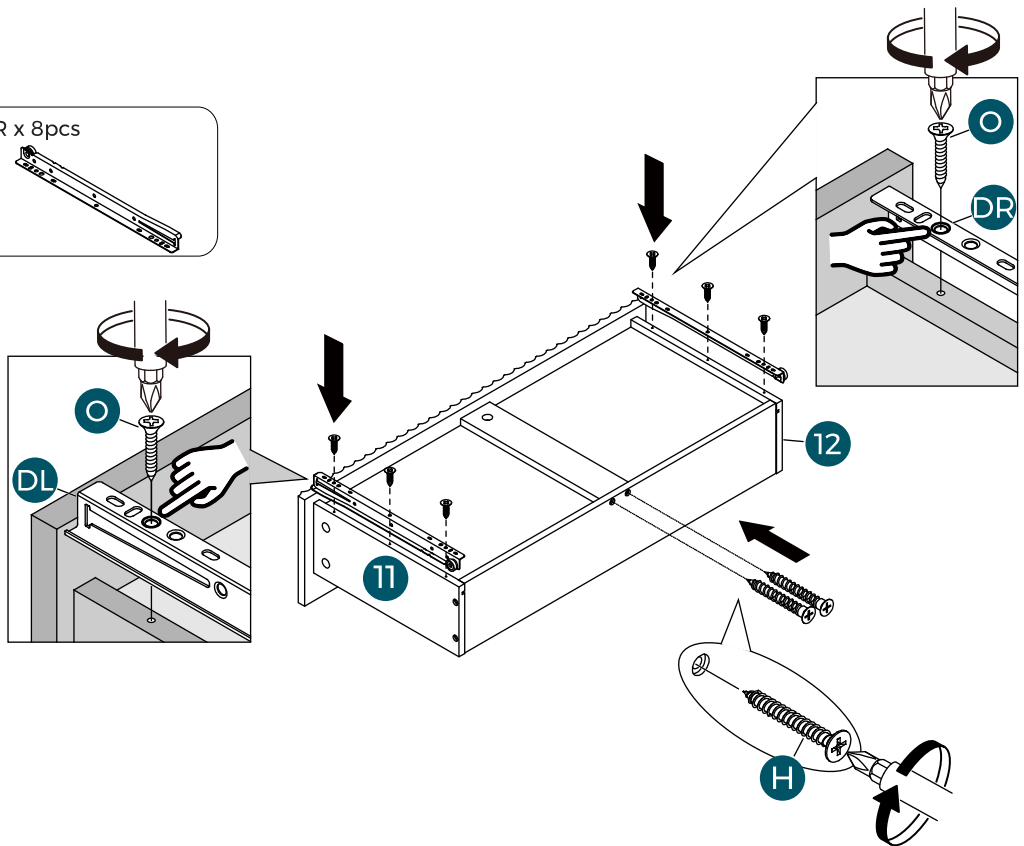
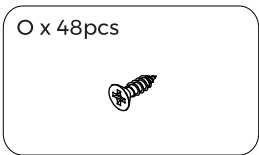
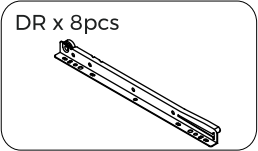
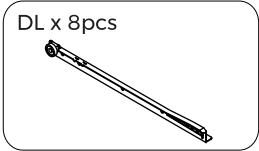

# 17

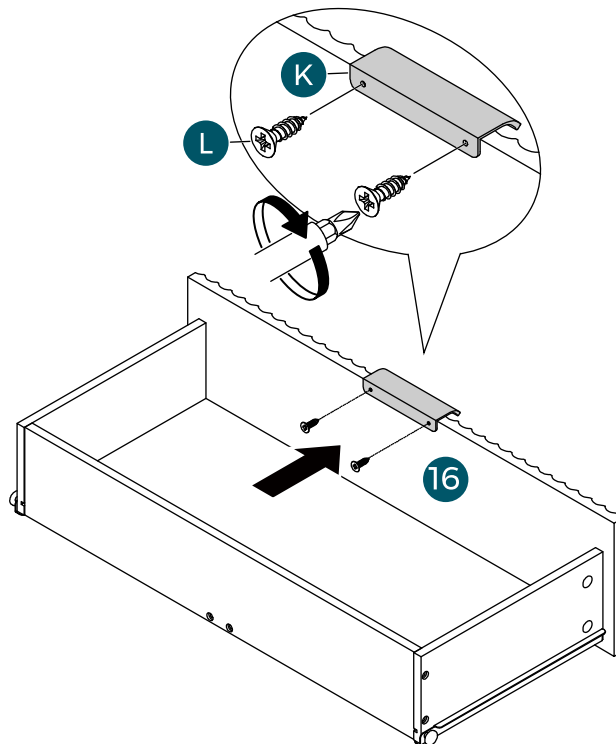
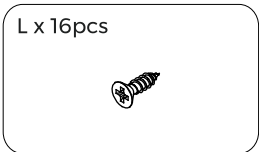
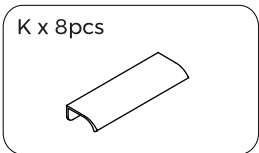





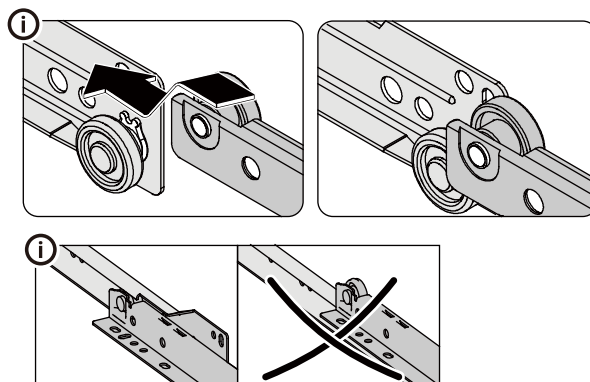
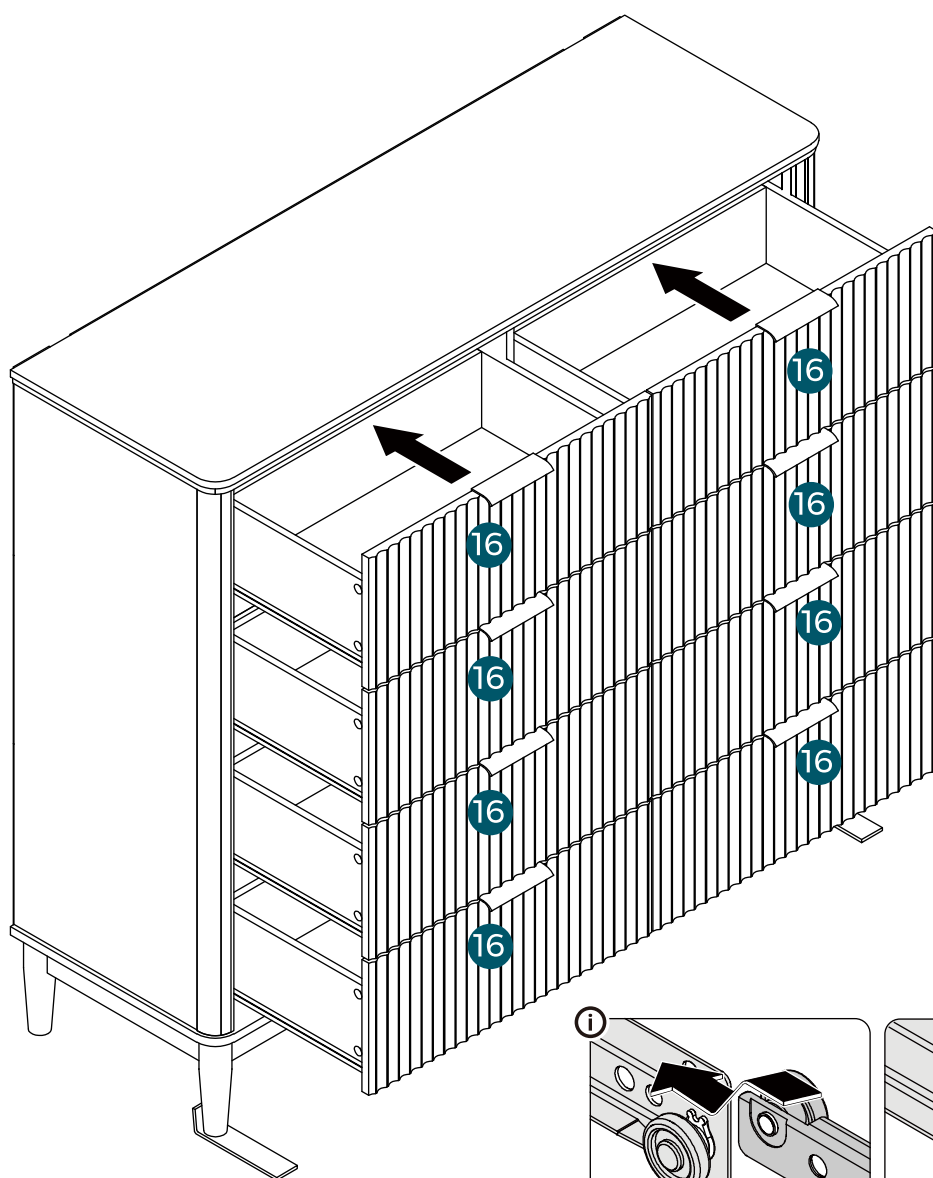

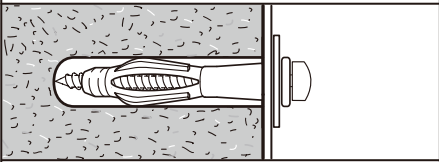
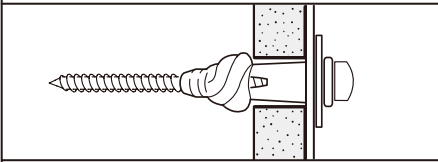
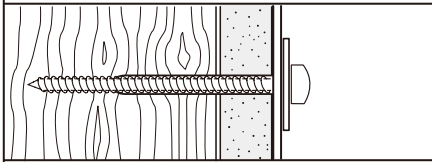

18

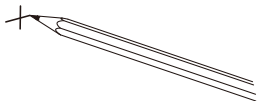
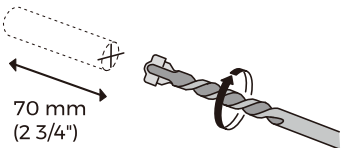
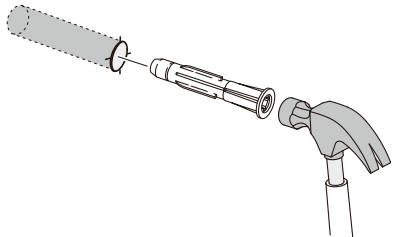
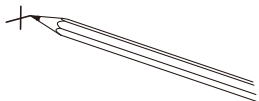
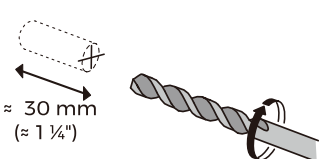
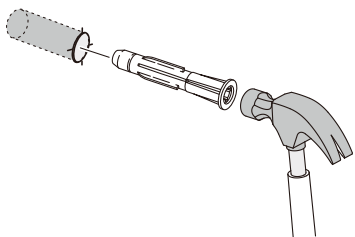
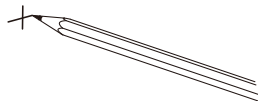

The screw and plug supplied can be used with most solid (A) and hollow(B) walls.  
 For solidwood (C) use the screw without plug.  
 If you are uncertain, please seek professional advice.

A	B	C
		
<p>Ø 8 mm (5/16")</p> 	<p>Ø 8 mm (5/16")</p> 	<p>Ø 3 mm (1/8")</p> 
<p><b>1</b></p>  <p><b>2</b></p>  <p>70 mm (2 3/4")</p> <p><b>3</b></p> 	<p><b>1</b></p>  <p><b>2</b></p>  <p>≈ 30 mm (≈ 1 1/4")</p> <p><b>3</b></p> 	<p><b>1</b></p>  <p><b>2</b></p>  <p>≈ 30 mm (≈ 1 1/4")</p>

# 19

P x 2pcs

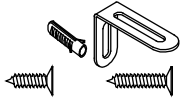

**WARNING** In order to prevent overturning this product must be used with the wall attachment device provided.

