

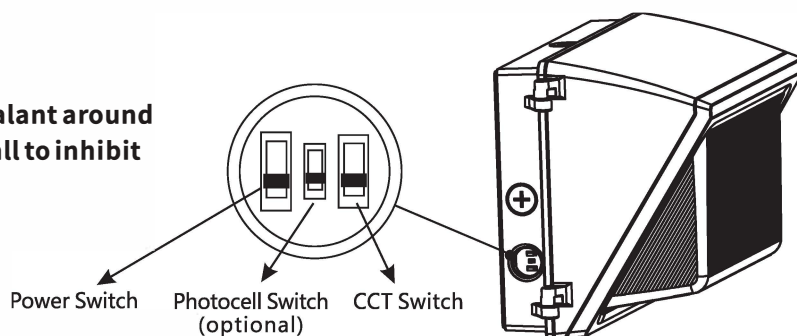

Operating temperature: -104°C to 122°C
Input voltage range: 120-277V, 50/60 HZ

Note: Add a bead of exterior grade silicone sealant around the perimeter of the wall pack on the wall to inhibit any moisture from attachment bolts.



Junction Box Installation

1.

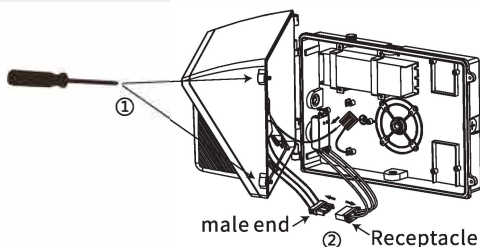

1. Unscrew the 2 screws on the right with a screwdriver
2. Unplug the male and female connector and ground terminal, remove the main body

2.

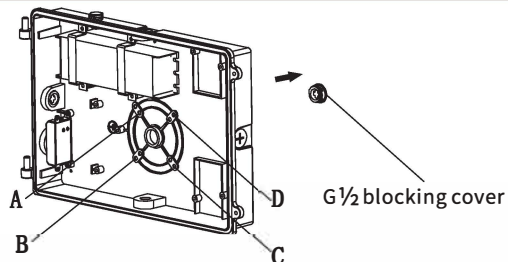

1. Open the G 1/2 blocking cover at the back cover and drill through ABCD four holes

3.

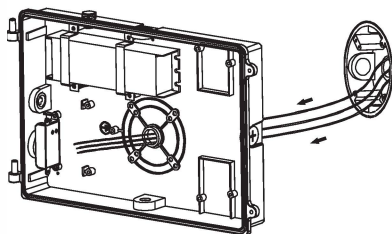

1. The back cover is fixed on the junction box, and the cables in the box are introduced into the cavity of the back cover

4.

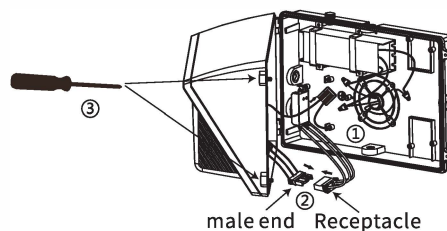

1. Connect the cable to the corresponding L/N/GND of the driver
2. Plug in the male and female connectors and connect the ground terminal
3. Tighten the screws with a screwdriver.

Hose Installation

1.

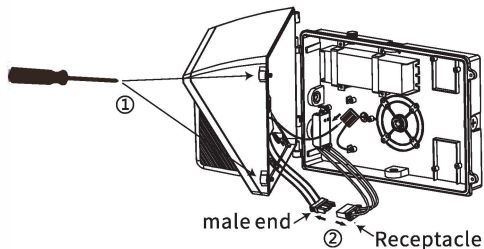

1. Unscrew the 2 screws on the right with a screwdriver
2. Unplug the male and female connector and ground terminal, remove the main body

2.

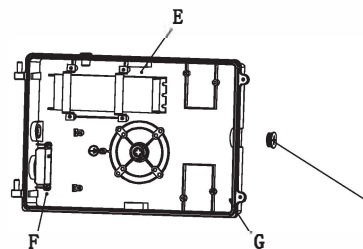

1. Open the side G 1/2 blocking cover, drill through the three holes of EFG, and fix the back cover.

3.

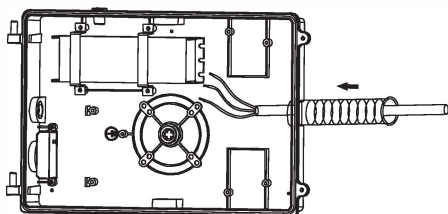

1. Insert the hose into the side hole and route the cable

4.

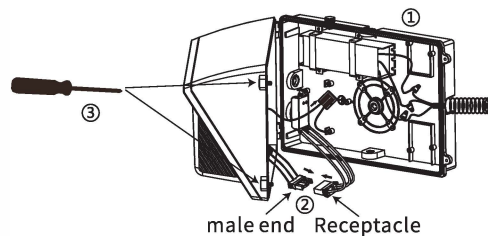

1. Connect the cable to the corresponding L/N/GND of the driver
2. Plug in the male and female connectors and connect the ground terminal
3. Tighten the screws with a screwdriver.

General Wiring Diagram

CAUTION: Turn off electrical power at fuse or circuit breaker box before wiring fixture to the power supply.

Connecting panels to AC source supply:
All units must be individually connected to the AC supply.

Black = Line
White = Neutral
Green = Ground

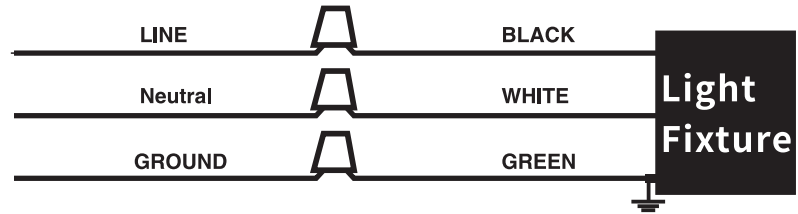

1: Surge Protection Device Diagram

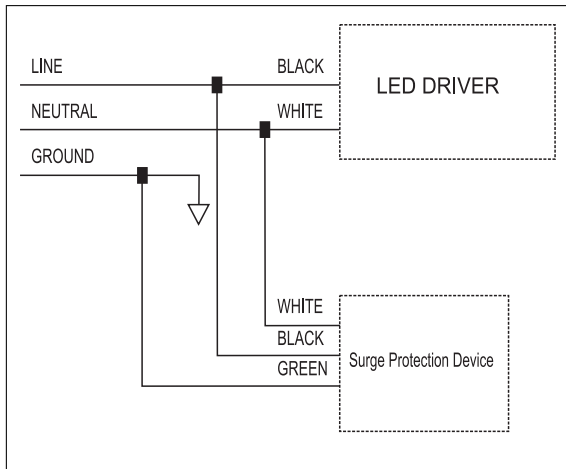

2: Emergency Battery Backup Wiring Diagram

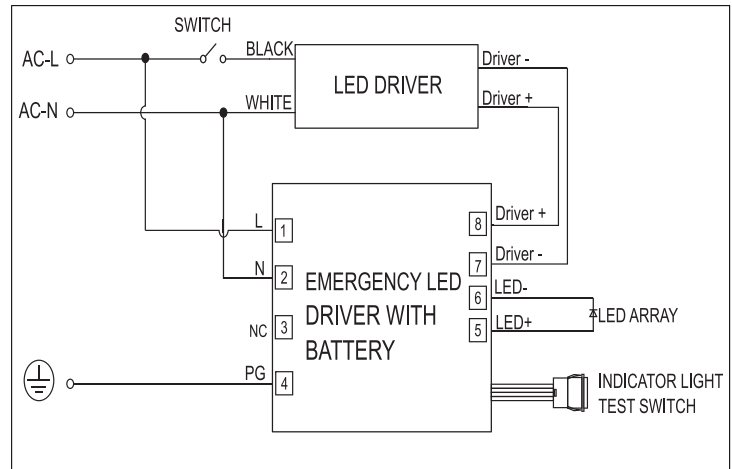

3: Photocell Diagram

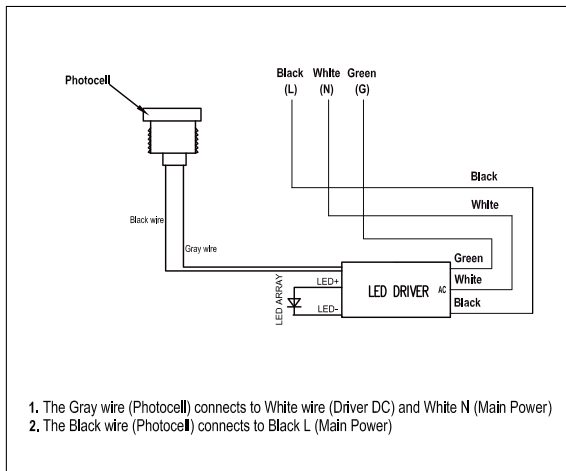

4: Microwave sensor wiring Diagram

