

**PLEASANT LITTER EXPERIENCE
FOR BOTH CATS & CAT FANCIERS**

+ Smart Cat Litter Box +
User Manual



FOR THE FIRST USE

1. Please place the device on a firm and flat ground.
2. Please add litter below MAX line after placing the device well.
3. Please power on the device and wait it to finish self-check. Then it is ready to use.



INSTRUCTIONS FOR THE FIRST USE

Unpacking:

Turn over the carton to cut the tape from the bottom, then turn over the carton to pull up the carton vertically.

Placement:

Place the device on the flat ground and make sure all four feet of the product contact the flat and hard surface. To avoid the cat identification sensor malfunction, please keep a 1 ft clear space for the device if the object is over 2 inches tall.

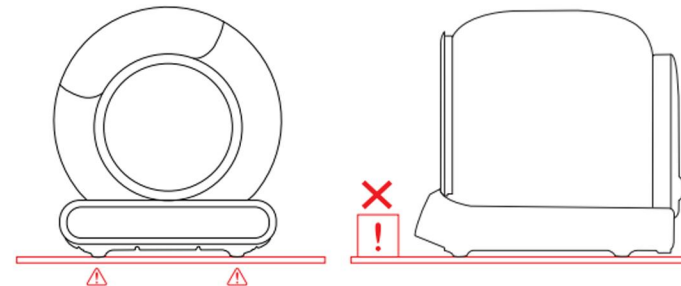

Notice:

- ✓ The four feet of the product must be in contact with a firm flat ground!
- ✗ Place the machine on the soft carpet.
- ✗ Place the two front feet of the device on the cat litter mat or rug.

Content

English.....	01-32
German.....	33-64
French.....	65-96
Italian.....	97-128
Spanish.....	129-160

What is in the box?

Power Adapter with Anti-bite Cord x1
 Manual x1
 mat x1
 Garbage Bag x2 roll

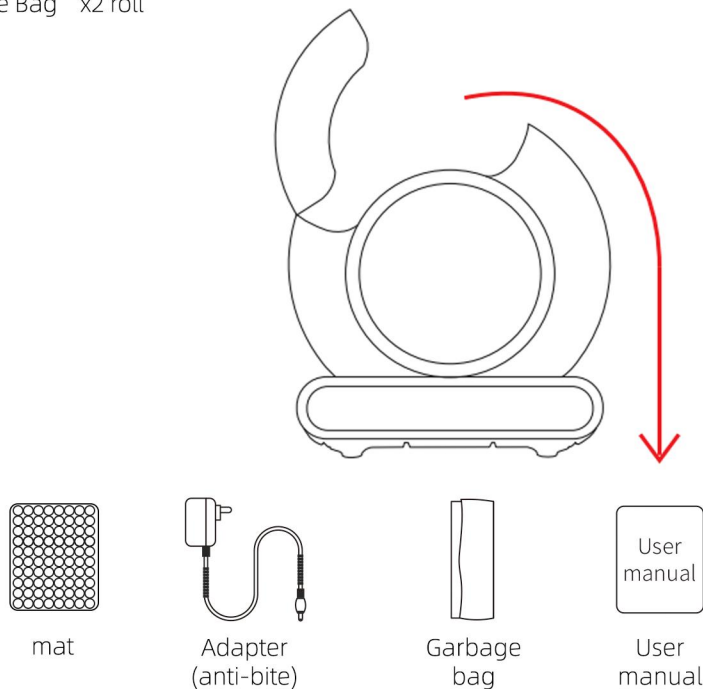

Notice:

Please review the installation instructions of garbage bags, or scan the code below to watch the video.

Product presentation

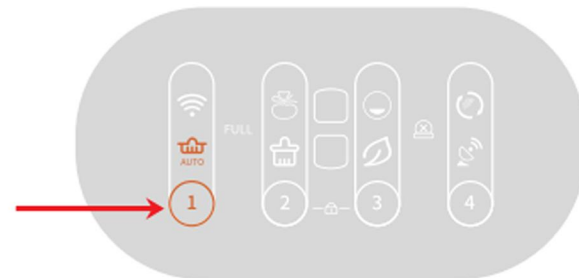

Category	Function	Operation	Status	Prompt tone
wifi	Clean	Click the button "2"	Start cleaning immediately	one ring
	Replace litter	Press the button "4" for 2 seconds	Start replacing cat litter	Long ring for 1"
	Auto cleaning	Click the button "1"	Start Auto cleaning	one ring
	Remove odor	Click the button "3"	Start purifying the air	one ring
	Join network	Press the button "1" for 2 seconds	Reset WiFi to start join network	Long ring for 1"
	Leveling	Press the button "3" for 2 seconds	Leveling the cat litter	Long ring for 1"
	Change garbage bag	Press the button "2" for 2 seconds	Adjust the barrel angle to the bag changing position	Long ring for 1"
	Lock/Unlock	Press the button "2" + "3" for 2 seconds	Locked/Unlock	Long ring for 3"
	Fault lamp	Lighting	Barrel is not installed or it cannot run	
	WiFi lamp	Lighting	The device is connected	
Indicator		Flash	The device is trying to connect to the network	
		Unlit	The device is not connected	
	Waste full lamp	Lighting	Remind users to replace garbage bag when the waste bin is almost full	

Placement and power up

Power-up and self-test

1. Power on: Please use the original adapter to power the litter box and make sure the voltage of the socket is stable and the power supply is good.
2. Self-test: The litter box will perform a self-test within 6 minutes. After the self-test, the Auto mode is enabled by default and the automatic lighting lamp lights up. The litter box can start working normally.

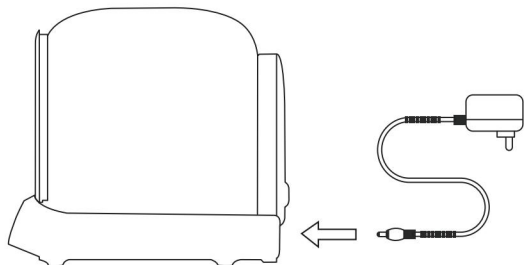

Notice:

1. Do not move the litter box when it is powered on. Lifting the litter box for more than 5 seconds will trigger the gravity protection lock (all cleaning and litter replacement operations will not be performed). It is necessary to actively perform litter leveling or wait 30 minutes to automatically reset the "per forma calibration" and then resume normal work2. The user can choose to use the litter box without infrared sensor. In this mode, the gravity sensors work normally. And the litter box is designed with the structure of a cat without claws, which makes it safe to use3. During the self-test, the error indicator lights up, indicating that "the self-test failed, Please check the installation of the bari after turning off the power, then turn on the power again and perform the self-test again.

Power On and Self-Test

1. Power On: Please use the original adapter to power the litter box and make sure the voltage of the socket is stable and the power supply is good.
2. Self-Test: The litter box will perform a self-test within 6 minutes. After the self-test, the Auto mode is enabled by default and the automatic lighting lamp lights up. The litter box can start working normally.

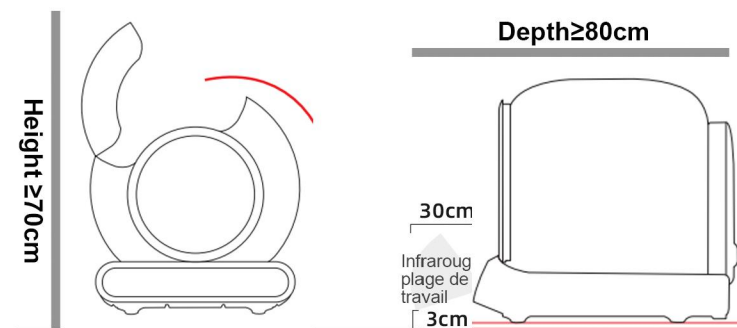

Add litter sand

Make sure the litter height is between the MAX and MIN lines (the amount of sand can be adjusted according to the actual situation).

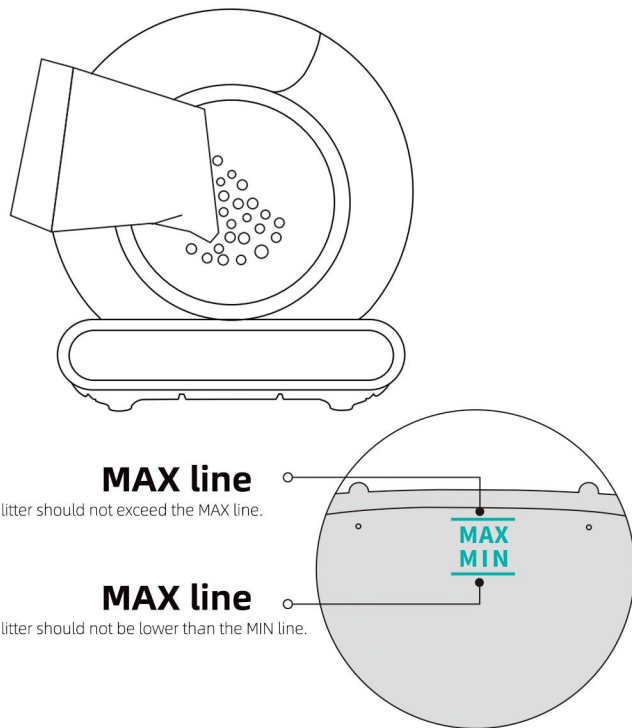

Start using

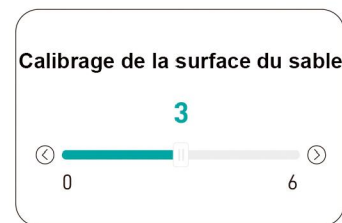

Le côté droit est bas
Augmenter la valeur



Le côté gauche est bas
Diminuer la valeur

Notice:

1. For the first time, it can be mixed with litter to help cats adapt to the new litter box. 2. It is recommended that the tofu litter and mixed litter do not exceed 3 kg, the mineral litter does not exceed 4.5 kg, and the amount of other litters is in between. 3. After adding the litter, if the litter is not smoothed, the litter box will enter the gravity lock (all the litter cleaning and replacement actions will not be performed). It is necessary to actively perform litter leveling or wait 30 minutes to automatically perform calibration, and then resume normal work.

App Installation



Method 1: You can scan the above QRCode with your mobile phone



Method 2: You can download "tuya" App from the Appstore.

Networking:

Confirm that the phone is connected to 2.4G WiFi, then turn on the Bluetooth and Location

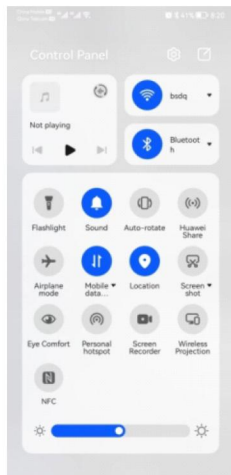

Press "Auto" for 2 seconds, when the WiFi indicator starts flashing, the device is ready to be connected.

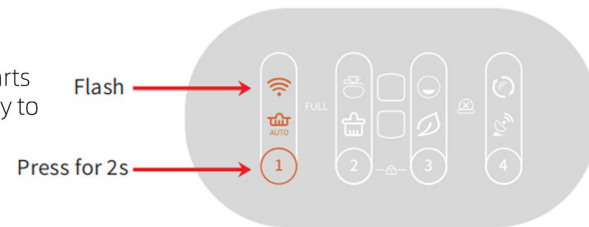

Open the App to add equipment or let the App scan automatically.

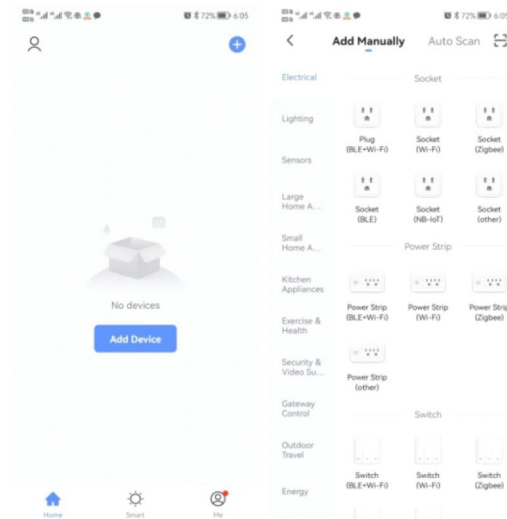

Press "Next" after scanning the device.

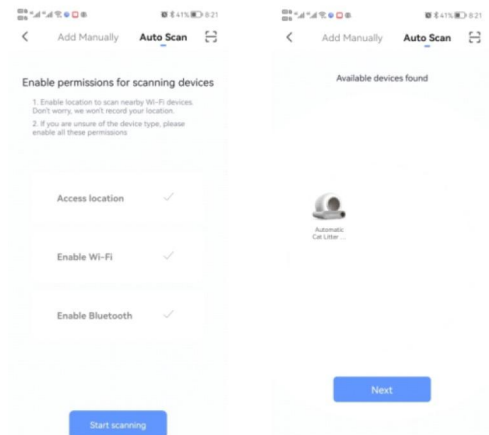

Press "Next" after entering the WiFi password and wait to connect.

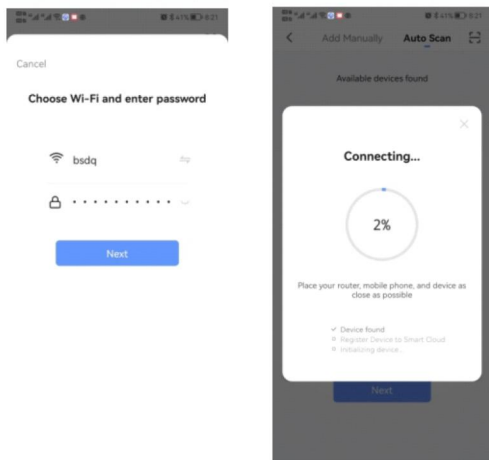

Enter APP after connecting.

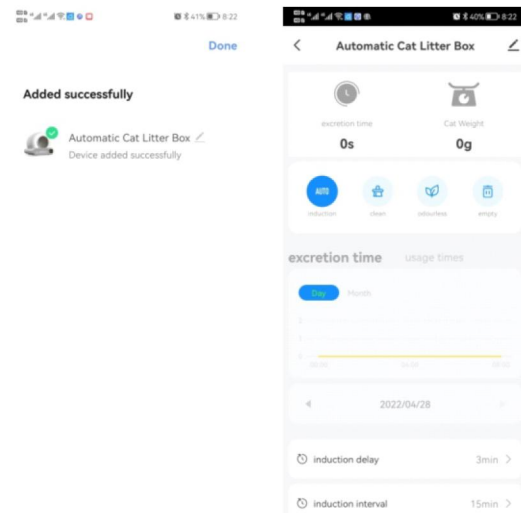

Notice:

If the network configuration fails or a timeout message is displayed, please follow the connections fix process as below:

1. WiFi, Bluetooth, and Location switch are enabled simultaneously.
2. WiFi connection is in the 2.4G band network. The product can not recognize the 5G band network.
3. WiFi indicator is flashing during network configuration.
4. WiFi network in your home is functioning.
5. WiFi password is correct.
6. WiFi signal is weak and the WiFi needs to be closer to the device.
7. The router connects to many wireless devices, causing IP address conflicts.

OPERATING INSTRUCTIONS

Auto Mode:

Click "Auto" on the panel or the App to start auto-sensing for cats in /out and auto cleaning. It is the default mode once the device has powered-on and self-checked.

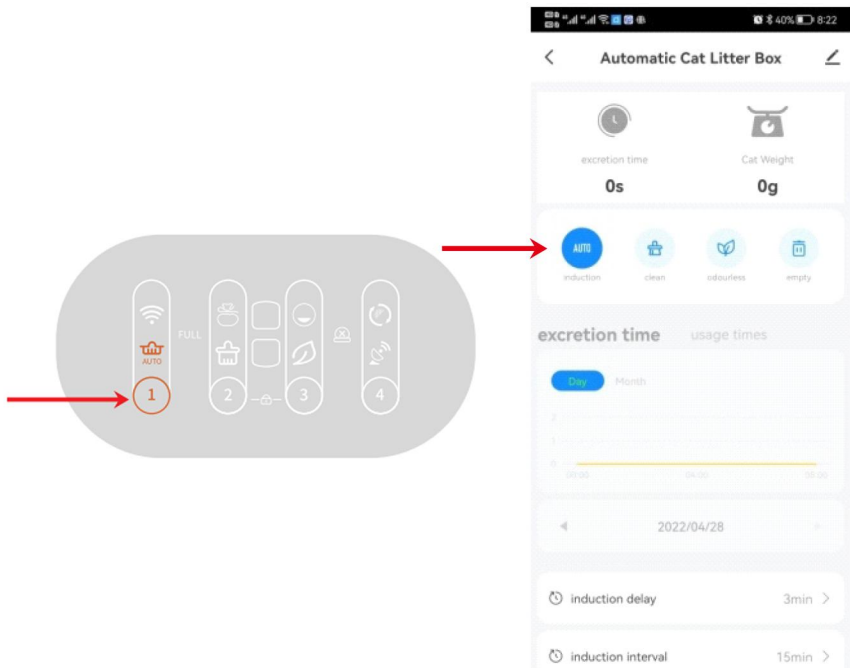

Notice:

1. Please click "Auto" on the panel or the App to turn-off the auto-sensing feature if the cat is less than 2.2 lb (1kg) or the cat is pregnant. When the device needs cleaning, you will need to click "Clean" to start the cleaning process.
2. To clean litter quicker, you can adjust the "cleaning wait time" in the App, for example, 1 minute, in that way you can clean as quickly as possible and reduce the smell. For families with two or more cats, you can adjust the "cleaning interval" in the App to avoid repeated ineffective cleaning of the device.
3. If the cat enters the bin for more than 10 seconds, the cat is considered to have potty behavior. After the cat leaves for 3 minutes, the automatic cleaning procedure will be performed. (The default interval between cleanups is 15 minutes to prevent the device from cleaning too frequently during multiple cats' use. The device might not work after the second cat pees; the interval of two pees is less than 15 minutes.)
4. If the App froze, please check the network status or re-configure the network, or click the corresponding button on the App and repeat once or twice.

clean Mode:

Click "Clean" on the panel or the App to start clearing process.

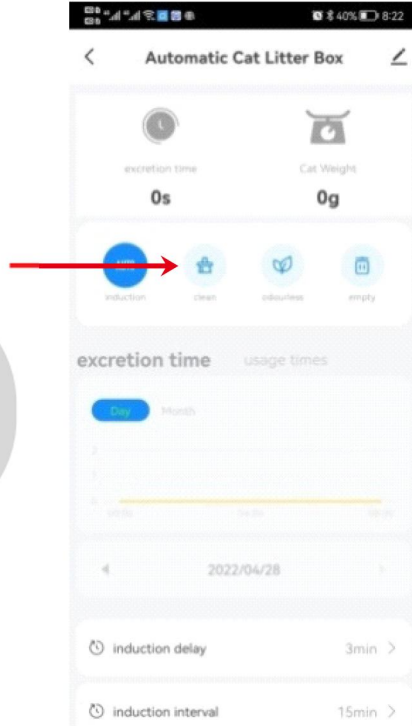
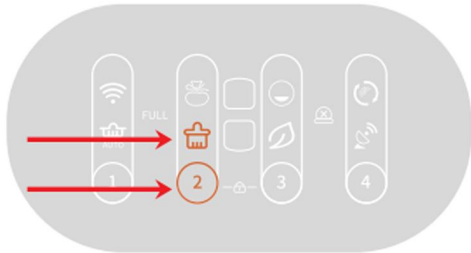

Notice:

1. During the clearing process, all keys will be disabled. If you need to perform other functions please wait until the clearing process is complete.
2. Extend the cleaning time in the phone App when the cat has diarrhoea. It allows the cat litter to take enough time to clump and reduces the pollution of soft feces to the bin.
3. If you have restarted the device, the waiting time of the "Cleaning" procedure will be restored to the default by 3 minutes, which can be reset in the APP if necessary. (setting range: 0 to 60 minutes)
4. Extend the interval between two cleanings when you have multiple cats, preventing repeated device cleaning.
5. If you have restarted the device, the interval time between two clearings will be restored to the default by 15 minutes, which can be reset in the APP if necessary. (setting range: 0 to 120 minutes)

Replace litter:

1. Replace the garbage bag with a new one (the original one is already full of polluted litter and bacteria)
2. Make sure the remaining litter is close to the MLN line (to avoid the overflow when the bin rotates)
3. Press "Replace Litter" for 2 seconds, then wait for the device to clear the rest litter (about 3 minutes)
4. Replace the garbage bag with a new one again after clearing litter

Notice:

1. Click "Replace Litter" again to cancel if you clicked it by mistake or forgot to replace the garbage bag.
2. For fine mineral litter, when replacing the bag (step ①), you can hold the "Clean" button for 2 seconds to avoid the overflow from the bag opening. The litter bin will rotate 90 degrees counter-clockwise to ensure that the opening of the bag is upward when replacing. After replacing the garbage bag, repeat 3 and 4.

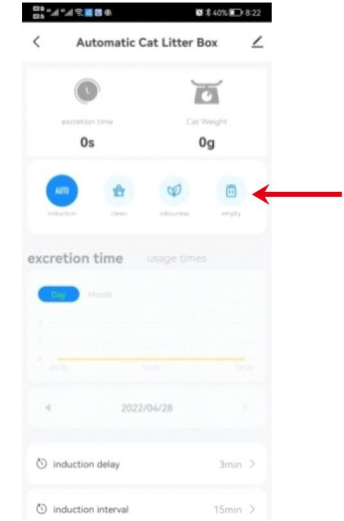
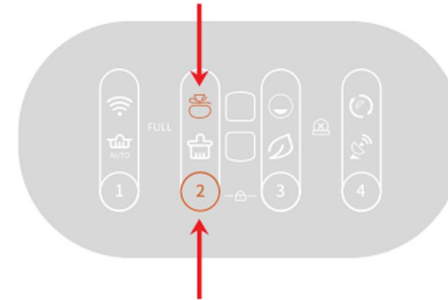
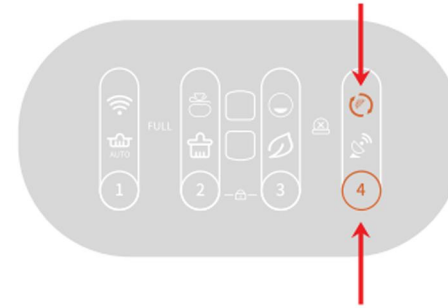

Remove Odor:

Methode 1:

Klicken Sie auf "Geruch entfernen" auf dem Bedienfeld oder klicken Sie auf "Geruchsfrei" auf Ihrer Telefon-App.

Methode 2

Stellen Sie die regelmäßige Arbeit in Ihrer Telefon-App ein.

Notice:

1. The device will remove odor automatically for 30 minutes after every cleaning.
2. It will stop once the cat enters and continue to work after the cat leaves.

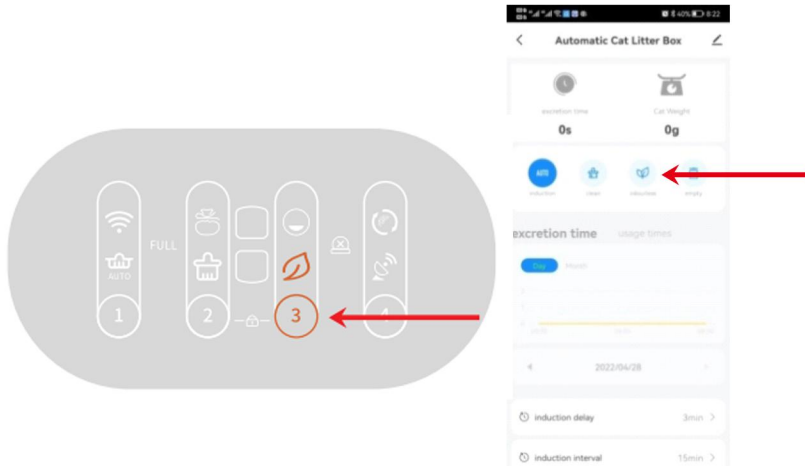

Cleaning and Maintenance

Replacing garbage bags

1. Press "Clean"  for 2 seconds, adjust the trash can to the bag changing angle and remove the bag a used garbage bag

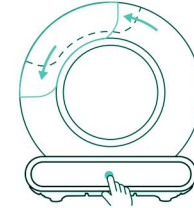

2. The litter box stays at the bag changing angle for 60 seconds, then it returns automatically. If the garbage bag replacement is not completed within 60 seconds, it can work again after the litter box returns to its original position.



3. le trou du cordon de serage du nouveau sac à dos est aligné avec l'extrémité de la pince, et le bord inférieur de l'ouverture du sac est coincé sous la pince située à cet endroit.

Cleaning and Maintenance

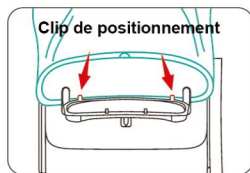
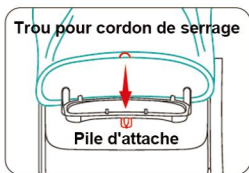

4. Wrap the mouth of the new trash bag around the trash can door frame and pull the drawstring.

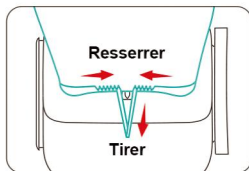

5. Pressez le cordon dans la pile d'attaches, serrez-le et enroulez-le.

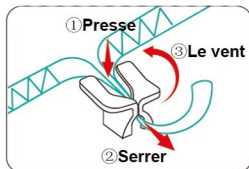

Cleaning and maintenance

6. Clean the back of the garbage bag to prevent it from being caught by the trash can lid. Close the trash can and confirm that the bag is attached.

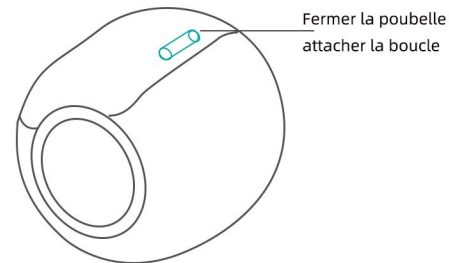

Before you begin, make sure the trash can is closed and secured

Notice:

1. For the first time, it can be mixed with litter to help cats adapt to the new litter box. 2. It is recommended that the tofu litter and mixed litter do not exceed 3 kg, the mineral litter does not exceed 4.5 kg, and the amount of other litters is in between. 3. After adding the litter, if the litter is not smoothed, the litter box will enter the gravity lock (all the litter cleaning and replacement actions will not be performed). It is necessary to actively perform litter leveling or wait 30 minutes to automatically perform calibration, and then resume normal work.

Notice:

- 1.The "Full" indicator is only for reference. The "Full" indication may vary depending on the catlitter volume, density, and fluidity, You can adjust the delay of the "Full" sign on the App basedon your preferences. The default is 0 (there is still a little space in the bag for garbage), and themaximum value is 15.
- 2.Ifyou have restarted the machine, the delay of the "Full" prompt will be restored to the default.which is0.It can be reset in the APPifnecessary.
- 3.Normally, the waste bin storage capacity of 1 cat can be up to 15 days, and for 3 cats can be upto 5 days. Users can replace the garbage bag every five days, depending on the actualsituation.

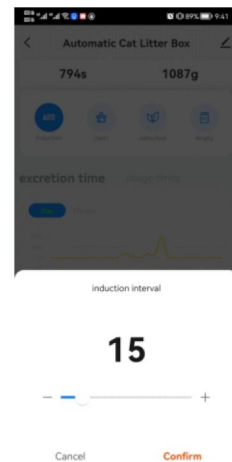
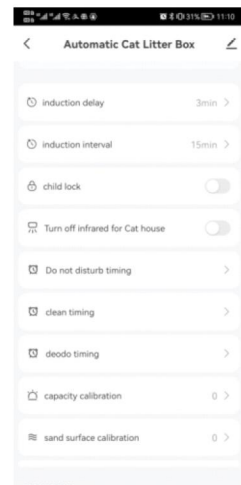

Cleaning and Maintenance

1. Power off the device first!
2. Open the buckle of the barrel compartment and lift the bin.
3. Wash and dry the barrel before placing it back on the base!

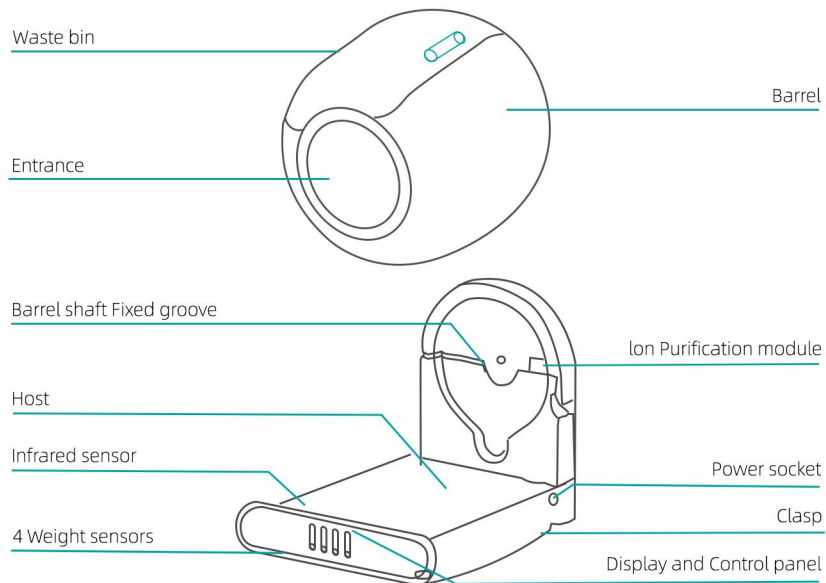

Notice:

If the indicator of the Bin sign is on, please restart the machine or click "Clean".

Lock the Panel:

Press the "Auto" and "Remove Odor" at the same time for more than 2 seconds to turn on and off the "Child Lock". You can also use the "ChildLock" button on the App.

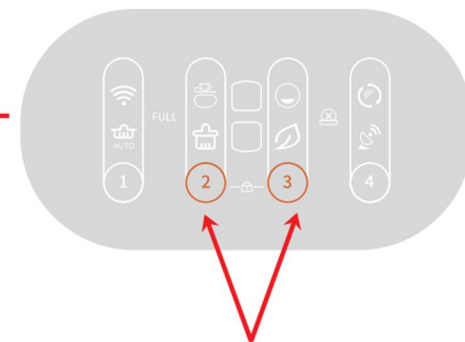
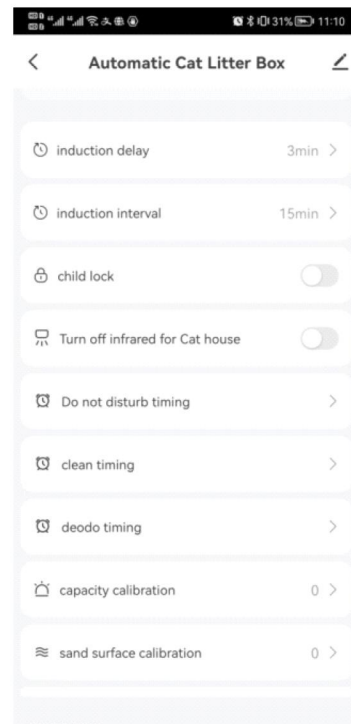

"auto" + "Remove odor" 2 seconds

Timing:

Sleep Mode

When the device is placed in the bedroom, you can set in the App "Do notDisturb Timing" to prevent the night-time activation of the device.

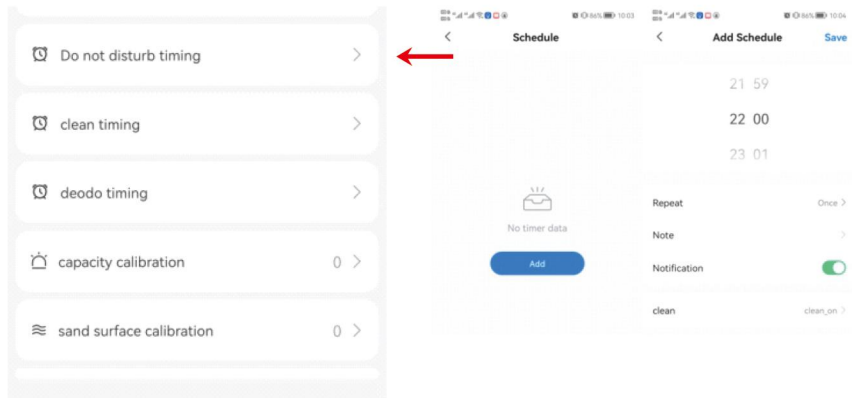

Notice:

1. When the DND (Do not Disturb) mode is on, the light on the panel will be off. Touch any button to exit the DND (Do not Disturb) mode.
2. If the device is clearing when setting DND (Do not Disturb), it will enter the DND (Do not Disturb) stage after the cleaning is complete.

Scheduled cleaning:

Regular cleanup

Set the device to clean regularly in the App "Clean Timing"

Timing Odor

Set the device to remove odor regularly in the App "Deodo Timing."

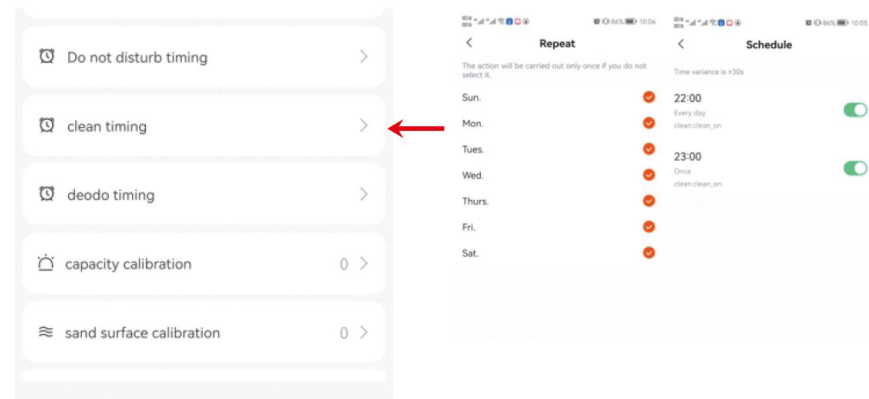

Notice:

Suppose the execution time of these scheduled procedures overlaps with the DND (Do not Disturb). In that case, the product will first perform odor cleaning and then return to DND mode.

CIRCUIT DIAGRAM

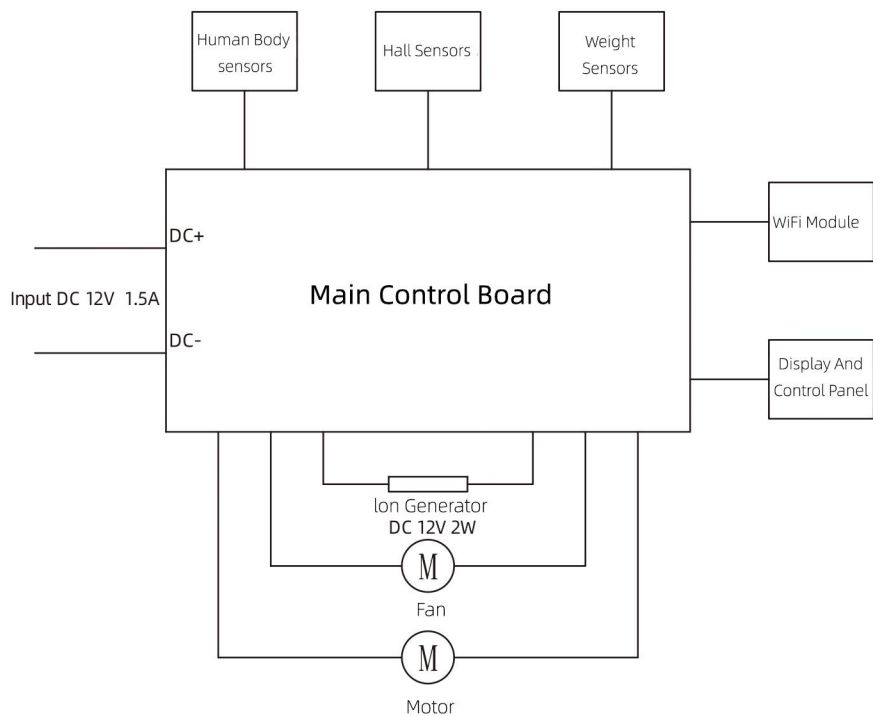

PARAMETERS AND SPECIFICATIONS

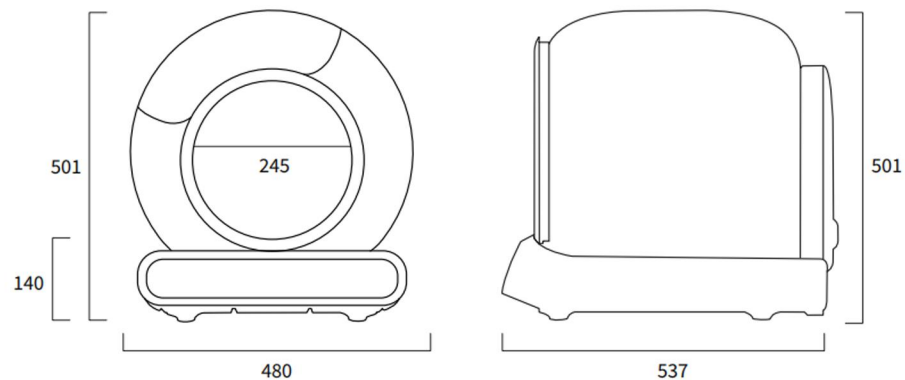

Product Name
Smart Cat Litter Box

Product Model
MSP-04

Whole Machine Size
480(W) X 537(D) X 501(H)mm

Rated Voltage
DC12V

vRated Power
≤18W

Suggested Pet Type
Cat

Frequently asked questions

1. Is this product a plug-in product?

Yes, our product is a plug-in model.

2. Where is the automatic cleaning cat litter box suitable for use?

After taking out the cat litter box, place it on a flat ground and confirm that all four legs of the product are in contact with the ground.

3. What should I do if the cat refuses to use the cat litter box?

You can refuse to power the cat litter box, and at the same time remove the urine leakage device on the outer ring of the silo, use the old cat litter, and gradually guide it slowly. After it adapts, turn on the power supply and urine leakage device again.

4. How to prevent cats from excreting soft feces in the cat litter box?

Adjust the "cleaning wait time" in the APP to more than 5 minutes, so that the cat feces have enough time to clump, thereby reducing the contamination of the ball bucket by soft feces.

5. When do you need to change the cat litter?

For a cat, it is recommended to completely replace the cat litter every 15 days. At the same time, you can also make irregular supplements according to the cat's use and the cleanliness of the cat litter.

6. What type of cat litter is suitable for this product?

This product is suitable for cat litter with a length of less than 11mm, including tofu cat litter, mixed cat litter, bentonite cat litter and mineral cat litter. No matter which type of cat litter you choose, as long as it meets this requirement, it can be used safely.

7. Where can I buy garbage bags?

The garbage bags used for new products are already available in our store, and you can place an order according to your needs.

8. How much litter should I put in the cat litter box?

The height of the cat litter in your cat litter box should be moderate, and it is recommended not to be higher than the maximum height or lower than the minimum height. There are scale lines in the cat litter box, which will remind you and can be adjusted according to your cat's usage habits.

9. What is the length of the power cord of the product?

The length of the power cord is 1.5 meters, and you can choose a suitable placement according to your needs.

10. The silicone pad of the product has bumps and bumps, what causes it?

The raised area of the silicone pad is normal. It is made of silicone material. Cat urine is alkaline with a pH value of 7.0-7.5. If the silicone is flat, cat urine will corrode over time, and then the silicone will break. So we modified the product to allow the silicone enough room to stretch so the cat urine doesn't corrode and crack over time. It just flattens out over time.

11. Why does the cat litter box keep turning after it is powered on?

The cat litter box keeps turning because after each power failure and power on, an automatic detection is performed and the barrel compartment returns to its initial position, which takes about 1 minute.

12. How can a multi-cat household prevent repeated cleaning of the product?

Adjust the "cleaning interval" in the APP, for example, to more than 30 minutes, so that the product will not be repeatedly cleaned and the effect is poor.

13. How often should the automatic cleaning cat litter box be cleaned?

We recommend cleaning the drum and trash can (except the electrical part) every 20 days, please refer to the manual.

14.Can this drum be washed?

Yes, the drum itself can be washed. But please note that the base at the bottom contains electronic components, so do not soak it in water, avoid spraying water directly on the base part, and protect the electronic components.

15.What languages does this app support?

Our app supports multiple languages, including English, Spanish, Italian, French, German, etc. You can choose the corresponding language according to your country or region.

16.What is the return policy?

We guarantee a lifetime warranty. (Within one year) Free replacement of damaged parts to ensure the quality and reliability of our products. If you have any questions, please contact our team.

Note:

Please note that when using, please avoid mentioning the silver ring, as it is easy to chip and damage.