



B010-V1.0

Mini PT AHD Wired Security Camera

Quick Guide

User Manual

Amazon: love@hiseeu.com

Aliexpress: support@hiseeu.com

Web: www.hiseeu.com

Tel: + 1917 688 2228

Please read this quick guide thoroughly before using and keep it well for future reference.

Important Notes

Before using, you need to read these important notes to avoid inconveniences caused.

1. Before returning the unit or any inconvenience has been caused, please contact us without hesitation, we will help you in no time, because we value our customer first, and commit to satisfying our customer with best tech support
2. It can not work Separately, He must be used in combination with a DVR.
3. This is a wired camera, not wireless camera We describe it very clearly that this is wired camera on the product listing, wired system has better stable connection than wireless system, and if you really want to return the item, please pack the package well and send it back to amazon.
4. TVI mode on hiseeu YXVR-8/YXVR-16 allows for one-way audio functionality. The ASIN of the XVR is: B0C8TKQWPD/B0C8TFRR93

Table of Contents

Product Feature.....	01
Product Overview.....	02
Connections.....	04
Camera Installation.....	04
Add to Hiseeu YS XVR	06
Add to other brand DVR.....	11

1. Introduction

1.1 Product features

This series of cameras adopt new generation sensor with high sensitivity and advanced circuit design technology. It features high resolution, low image distortion and low noise, etc, which makes it suitable for surveillance system and image processing system.

- High performance CMOS sensor and high resolution bring high-quality image
- Low illumination
- Control camera pan and tilt in DVR and APP (The DVR must support coaxial control)

1.2 Product Overview

Camera Type : PT Mini Dome Camera

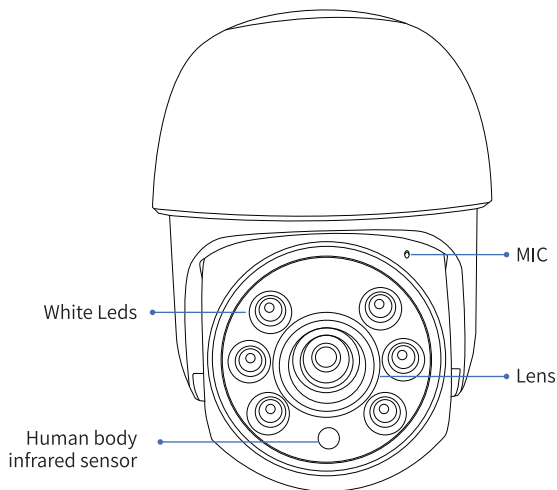

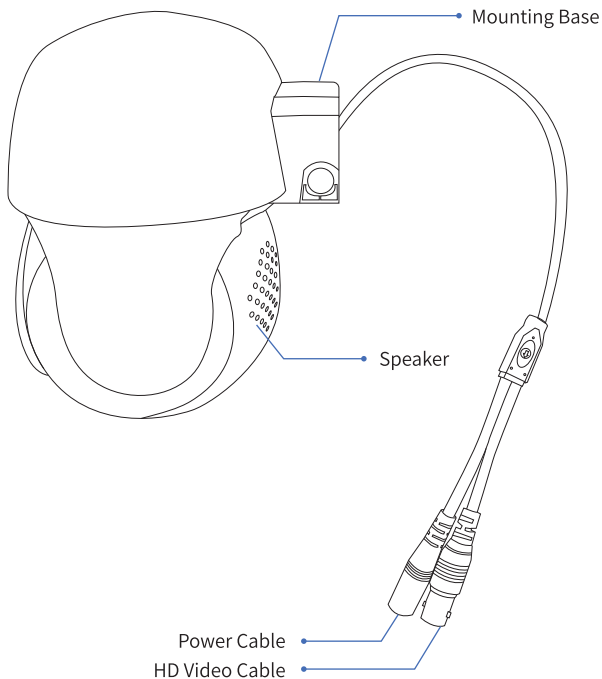

1.2.1 Connections

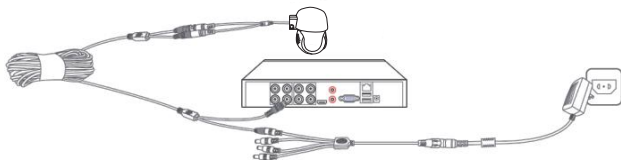

Please try to connect camera and DVR to test and set camera video before installing the camera, This process is only for connection. Please prepare the DVR, the power adapter and the video cable in advance.

1.2.2 Camera installation

- 1) Drill the screw holes in the wall according to the camera location sticker
- 2) Hammer the supplied plastic expansion bolt into the screw holes.
- 3) Fix the camera mount to the wall with supplied screws.
- 4) Insert the camera into the camera bracket
- 5) Connect the camera and the video/power cable.

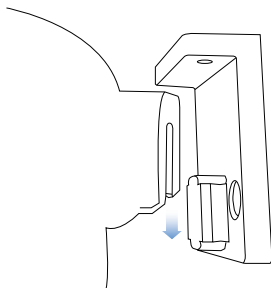
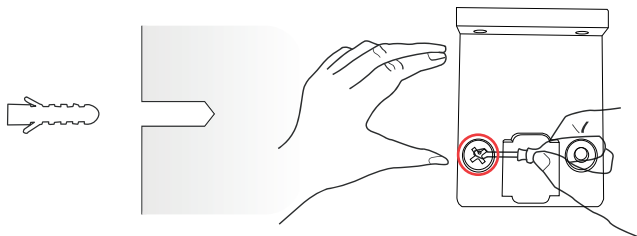

1.3 Add to the DVR/XVR

1.3.1. Add to Hiseeu YS XVR

Please note that The factory setting of our PT camera's **VIDEO SETTING** is **AHD mode**, however, this product can only have one-way audio function in TVI mode in Hiseeu's XVR, so we have to change the **VIDEO SETTING** to TVI mode first.

Move the mouse and click the **“Control PTZ”**

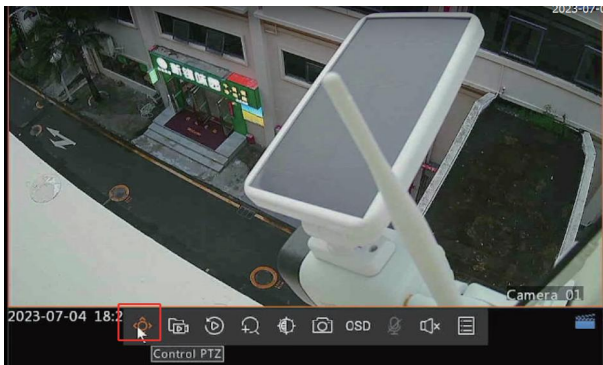

1. Click the **OSD Menu Control** , then click the arrows to the Menu
Then click the icon to select the **VIDEO SETTING**



3. Select the **VIDEO SETTING** and click the arrow to enter.

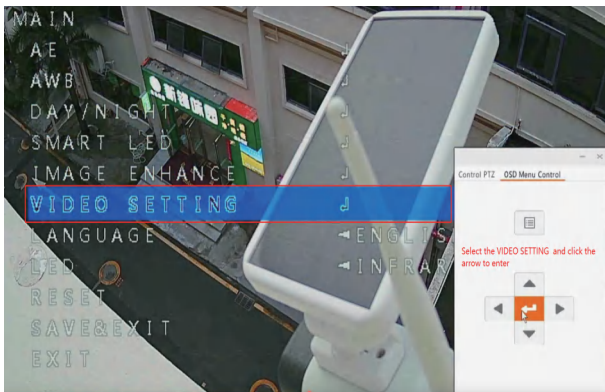

4. Then Select the **“TVI”** on the HD, then click the **RETURN** and the **EXIT** back to the Version

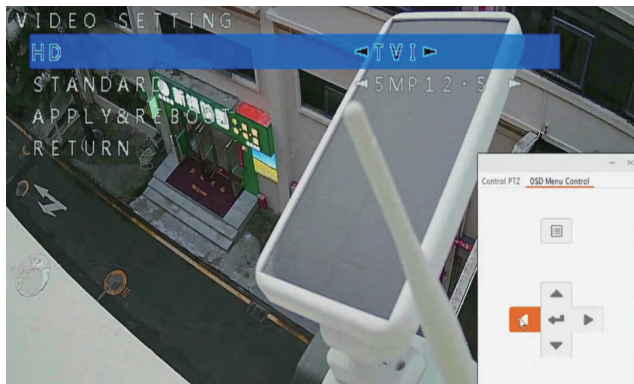

5. Finally Turn Audio On



1.3.2 Add to other brand DVR

If the connection is good, the video does not display properly, you need to change your **VIDEO SETTING** to **AHD** mode. Then it can output the picture normally. If you have questions about this procedure, you can contact your DVR seller, or contact us. We will definitely solve it for you.



Amazon: love@hiseeu.com

Aliexpress: support@hiseeu.com

Web: www.hiseeu.com

Tel: + 1917 688 2228