

# ***a1000***

3-Axis Gimbal for Mirrorless Camera

Guilin Feiyu Technology Incorporated Company

User Manual EN V2.2

# 1. Product Overview

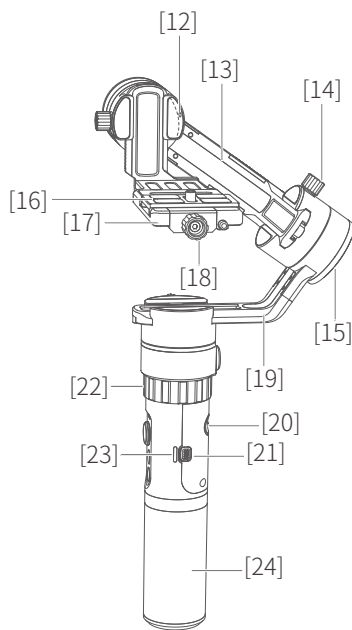
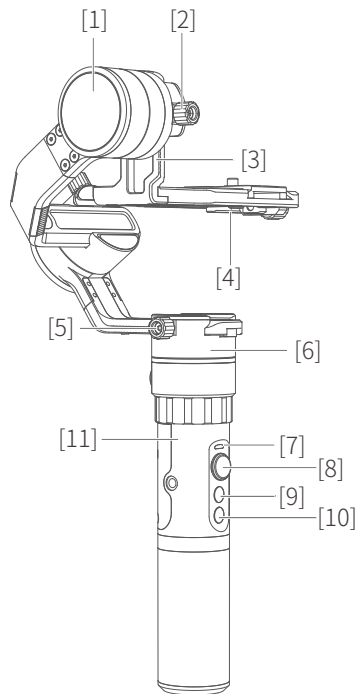

- [1] Tilting axis
- [2] Tilting lock screw
- [3] Sliding arm
- [4] Thumb screw
- [5] Panning lock screw
- [6] Panning axis
- [7] Status indicator
- [8] Joystick
- [9] Function button
- [10] Shutter button
- [11] Socket connector
- [12] Shutter cable socket
- [13] Cross arm
- [14] Rolling lock screw
- [15] Rolling axis
- [16] Quick-release clamp
- [17] Adapter(Clamping plate)
- [18] Clamp block thumb screw
- [19] Vertical arm
- [20] Trigger button
- [21] USB interface
- [22] Retaining ring
- [23] Charging indicator
- [24] Handle

## Included Accessories

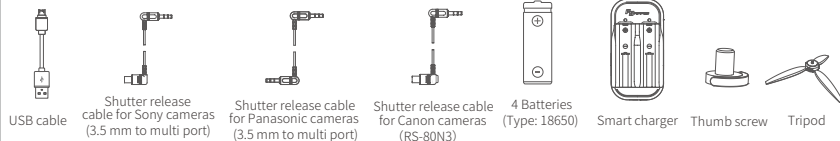

## Double-hand Accessories

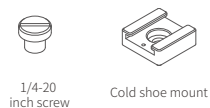

## Install the handle

### Single Handle

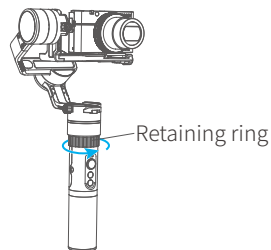
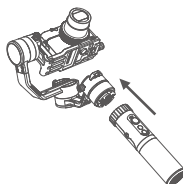

### Double-hand foldable set (Optional)

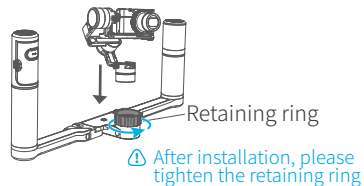
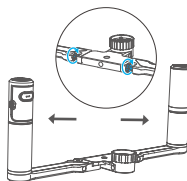
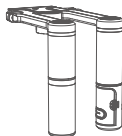

## 2. User Guide

Attention: please read the following instructions before powering on the gimbal.

### 1 Insert the batteries

Prior to use, please be sure to fully charge the batteries.

Remove the handle, insert 2 pcs 18650 batteries and tighten the handle.

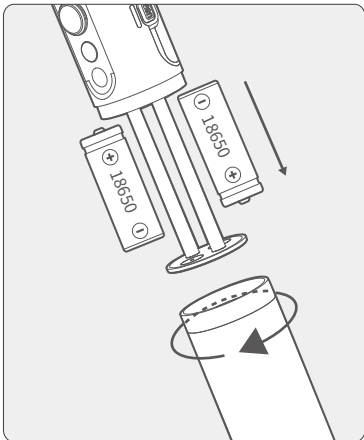

### 2 Attach camera or smartphone

Take the Panasonic DMC-GH4 camera for example

Place the camera correctly on the quick-release clamp and tighten the camera with the thumb screw, finally, place quick-release clamp into the clamping plate, tighten the clamp block thumb screw.

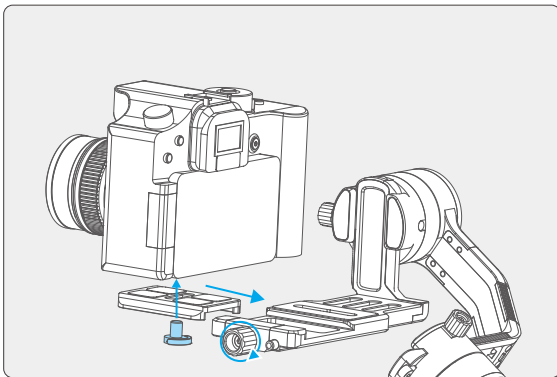

### Take the Sony camera for example

Place the camera correctly on the clamping plate and use the thumb screw to secure the camera through the middle chute at the bottom of clamping plate.

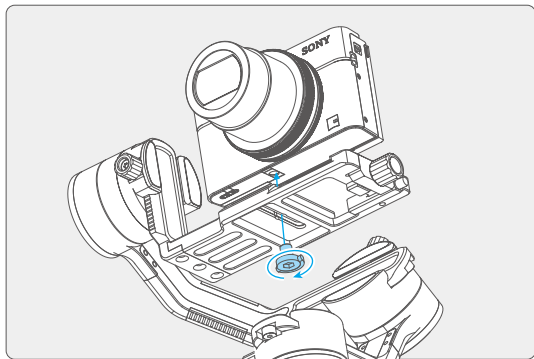

### Take the smartphone for example

First use the smartphone adapter (optional) to install the phone, and place them correctly on the clamping plate, use the thumb screw to secure the phone through the middle chute at the bottom of clamping plate.

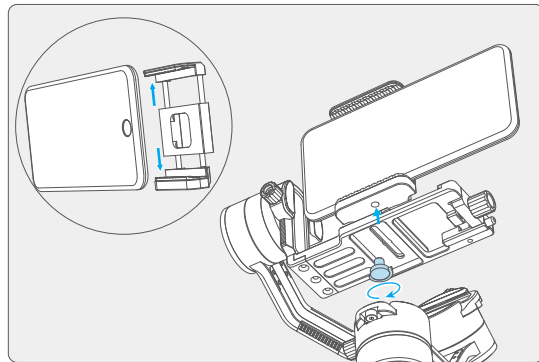

## 3 Balance Adjustment

Turn on the gimbal after adjusting the center of gravity balance of the three axis.(refer to chapter "9. Balance Adjustment" for more details)



Note: center of gravity imbalance can lead to poor performance or even failure of the gimbal to operate at all.

## 4 Power on/Power off

**Power on:** long press the function button and release it when the green light is on and you hear a tone.

**Power off:** long press the function button and release it when the red light changes from quick flashing to constant and you hear a tone.

## 3. Functions Modes

### Instructions of Button

Function button	Function	Explanation
Single tap	Panning Mode / Lock Mode	Single tap to switch between panning mode and lock mode
Double tap	Panning and Tilting mode	Under panning and tilting mode, control the rolling axis by moving the joystick to the left or right, and the control angle is $-30^{\circ} \sim +30^{\circ}$
Triple tap	Rotate 180° in horizontal	Make the camera lens rotate $180^{\circ}$
Quadruple tap	Autorotation Mode	Enter autorotation mode
Five tap	Initialization	Enter initialization
Trigger button	Function	Explanation
Long press	Lock	In the panning mode or panning and tilting mode, press and hold the button to enter the lock mode, release it to return previous mode
Double tap	Reset	Return to panning mode, tilting and rolling to return to initial level

## Explanation of indicator status

The current mode of the gimbal can be identified by the indicator status.

Indicator status	Mode / Status
Blue light flashes once	Panning mode
Blue light flashes twice	Panning and Tilting mode
Blue light constant on	Lock mode / Initialize the gimbal
Blue light keeps flashing	Initialization failure / Malfunction
Red light flashes three times	Low power
Red light keeps flashing	Entering power off



In case of low power, the indicator will light red and flash 3 times every 5 seconds. Please charge gimbal or replace the battery.

## Modes

### Panning Mode (Default mode)

Tilting and rolling direction are fixed, and the camera lens moves according to the hand movement of the user.

### Panning and Tilting Mode

The rolling direction is fixed, and the camera lens moves according to the hand movement of the user.

### Lock Mode

The orientation of the camera is fixed.

### Reset

Return to panning mode, tilting and rolling to return to initial level.

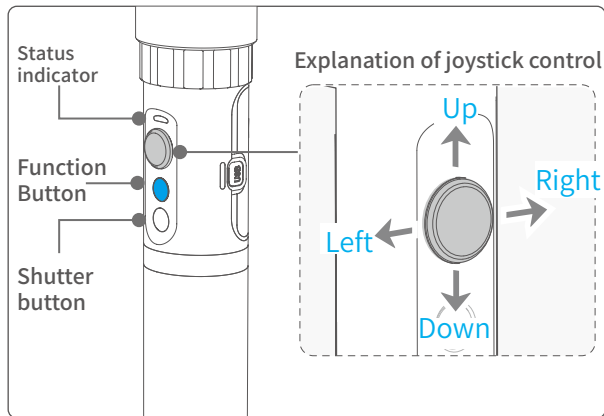

## Autorotation Mode

1. Quadruple tap on function button, gimbal will access the autorotation mode .
2. Set the gimbal start rotation position: pull the tilting axis or panning axis to the start position by hand, click the function button to record.
3. Pull the gimbal (which can be rotated more than one turn) according to the rotation path you want to set, and then click the function button to record the end position .The gimbal will go to the start position and start the automatic rotation. Using the gimbal autorotation function with a camera, timelapse photography functioning can be used to achieve special movement timelapse photography.

**Other operations:** click the function button to exit the autorotation mode during automatic rotation. The speed setting is made by Feiyu ON App.

**Note:** both the panning and tilting directions can be rotated.

### Annexed parameter table:

Gimbal speed setting reference table

a1000 Rotate Speed
12 seconds / turn
18 seconds / turn
24 seconds / turn
30 seconds / turn
1 minute / turn
2 minutes / turn
4 minutes / turn
8 minutes / turn
15 minutes / turn
30 minutes / turn
1 hour / turn (default)
4 hours / turn
8 hours / turn

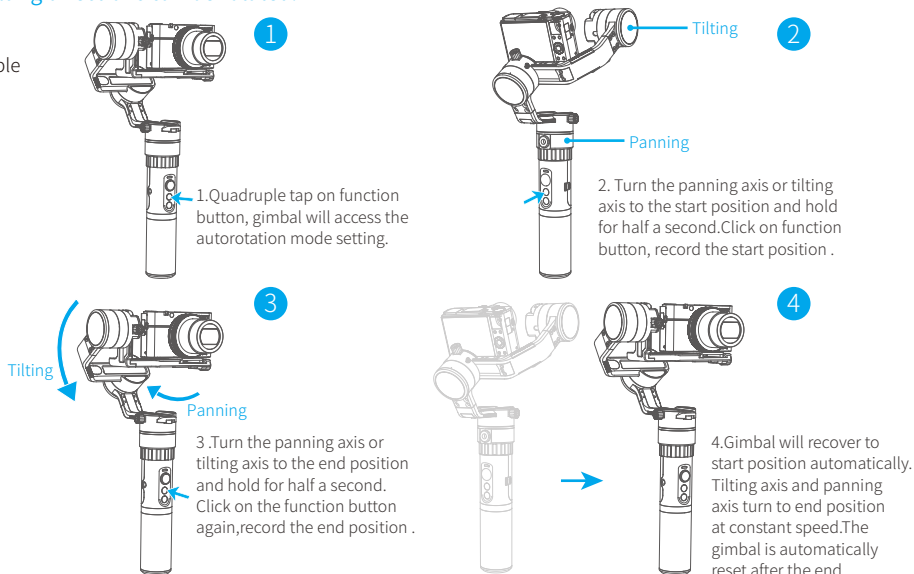



## Manual Lock

Adjust the camera by hand to the desired angle and hold in place for half a second. (The tilting axis and panning axis in the lock mode can be manual lock and the tilting axis can be manual lock in the panning mode.) Take the tilting axis as an example :

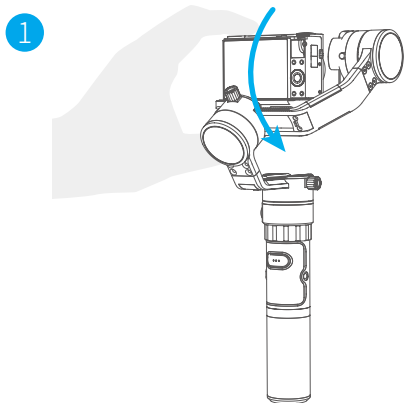

Hold the camera and change its angle in tilting axis direction.

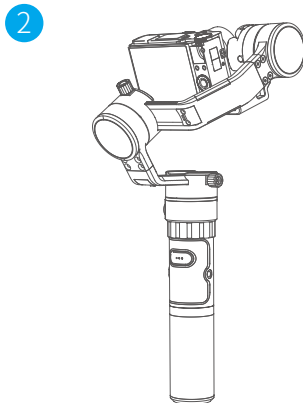

Keep this position for half a second, the current angle will be locked manually.

## Photograph

The shutter button can take pictures via the shutter release cable.

**Manual photograph:** click the shutter button to focus, click again within 3s to take pictures. If there is no operation within 3s, the focus state is cleared.

**Automatic continuous shooting:** Shutter button long press 3s or more, gimbal "drop" sound and enter the automatic continuous shooting mode, the default 5s shot once. One tap the shutter button to exit the automatic continuous shooting mode. (you can enter the Feiyu On App to setting the photographic interval time)

## 4. Charging

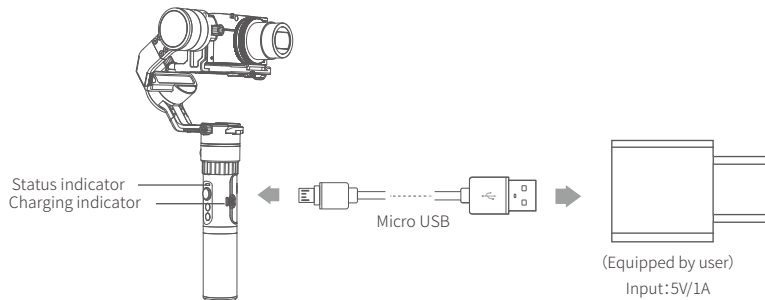

### Explanation of Charging indicator status

Indicator status	Mode / Status
Blue light, red light is off	Stop charging
The blue and red light are flashing	The voltage of two batteries balance adjustment (If the two batteries voltage difference between the larger, the process takes a long time)
The blue and red light	Charging

## 5. Download and connect App

### 1 Download "Feiyu ON" and install it.

(1) iOS version:



(2) Android version:

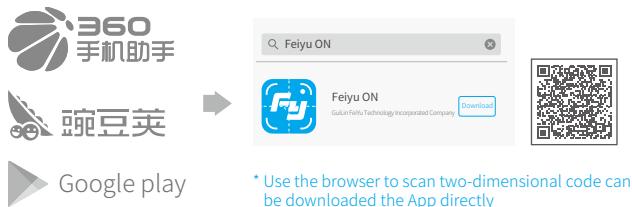

### 2 Connecting App

Start the App on your smartphone, follow the instructions to connect the smartphone with gimbal via bluetooth.

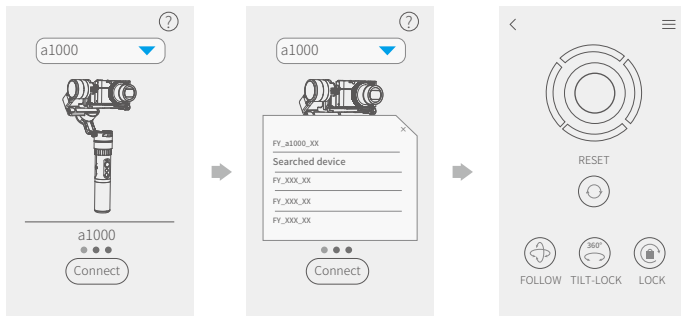

## 6. Gimbal initialization

You can initialize your gimbal when:

- (1) when camera is not level
- (2) if not used for a long period of time
- (3) in case of extreme temperature variations

### Adjusting steps:

1

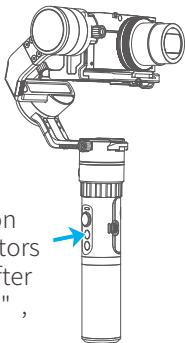

Five tap function button, the motors stop working after the voice "drop", the blue light is always on.

2

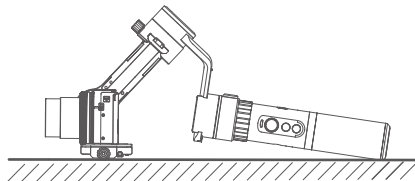

Place the gimbal still on a desktop. The gimbal will automatically initialize when it detects being static. The blue light cycles three flashes and then initialization ends.

3

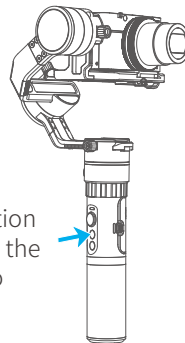

After the initialization is successful, click the function button to wake up.

Note: if the initialization is not successful for a long time, long press the function button to turn off the gimbal, restart it and then initialize.

## 7. Firmware Upgrade

(1) Option 1: connect the gimbal with PC via micro USB cable, and then upgrade the firmware.

Please visit the official website [www.feiyu-tech.com](http://www.feiyu-tech.com) to download the relevant software for upgrading, including USB driver, firmware upgrade software and product firmware, and install the relevant software, decompress the firmware files. Firmware upgrade according to the firmware upgrade instructions.

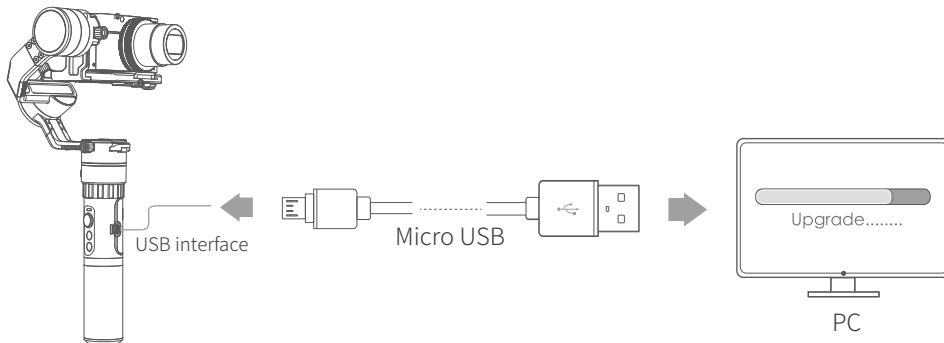

(2) Option 2: connect the gimbal with smartphone via bluetooth, and then upgrade the firmware.

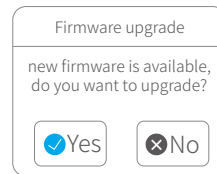
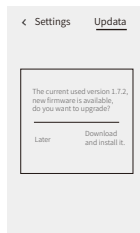

## 8. Parameters

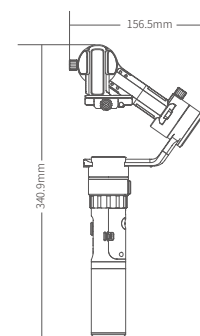
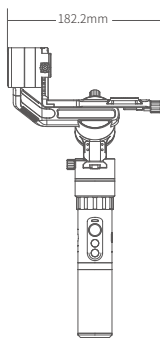

Titling Angle	360°
---------------	------

Rolling Angle	360°
---------------	------

Panning Angle	360°
---------------	------

Tilting Increments	2°/s ~ 75°/s
--------------------	--------------

Panning Increments	3°/s ~ 150°/s
--------------------	---------------

Life Time	10 Hours (Center of gravity balance)
-----------	--------------------------------------

Load weight	150g~1700g
-------------	------------

Adaption camera	SONY A7s(16~35mm lens) , SONY 5100 , SONY (DSC-RX100M5 , DSC-RX100M4 , DSC-RX100M3) , α6000 , Yi 4K Action Camera , Yi Action Camera , Panasonic LUMIX GH4 Camera and other similar size camera of the total weight less than 1000g (including lenses and other accessories)(Gopro5、 Gopro4 etc. with a fixed device that has a 1 / 4-20 inch threaded hole)
-----------------	--

Adaption smartphone	iPhone 6 , iPhone 6s , iPhone 7 , iPhone 6 Plus , iPhone 6s Plus , iPhone 7 Plus , Android phone 4.7 inch~5.7 inch (Need smartphone adapter)
---------------------	--

Weight	910g(Not including the accessories of batteries,camera,camera lens and ect.)
--------	--

## 9. Balance Adjustment

### STEP 1 Balance adjustment of the tilting axis

Adjust the center of gravity of the camera in two steps to the axis of rotation of the tilting axis.

- (1) Adjust the center of gravity position of the tilting axis up and down: Set the camera lens down vertically with the hand arm maintaining level as shown in figure ①. Let go and observe the state of rotation. Adjust the balance by moving the sliding arm up and down (Refer to figure ② ③).

\* After adjustment, be sure to tighten the lock screw.

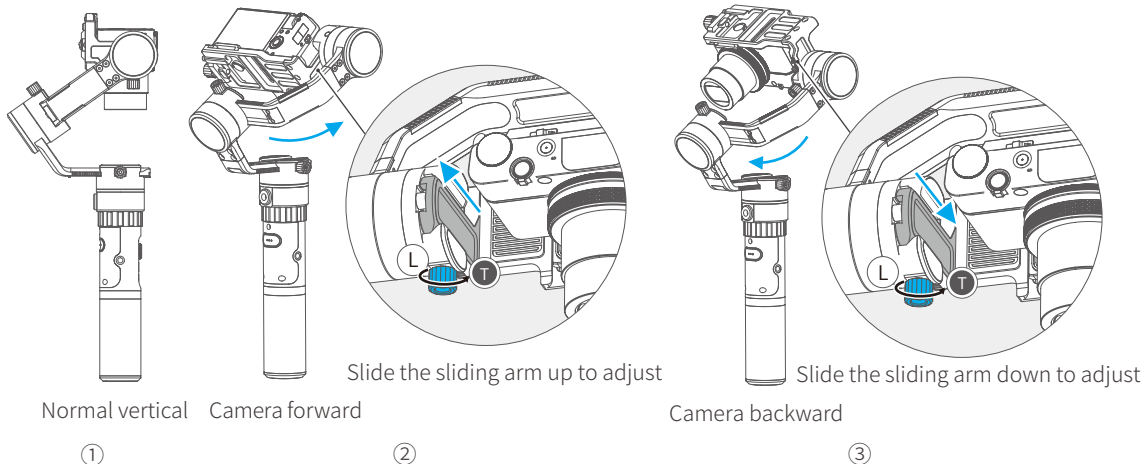

- (2) Adjust the center of gravity position of the tilting axis forward and backward: With the camera in the upright position with the lens pointing forward and the hand arm maintaining a level state as shown in figure ①, let go and observe the state of rotation. Loosen the screw on the bottom of the clamping plate and adjust the balance by sliding the quick-release clamp up and down (Refer to figure ② ③).

\* After adjustment, be sure to tighten the lock screw.

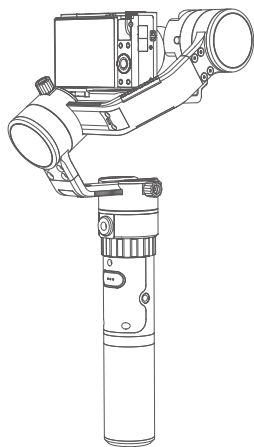

Balanced

①

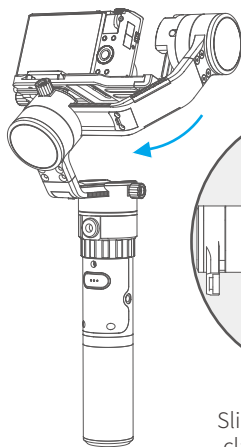

Camera forward

Clamp block thumb screw

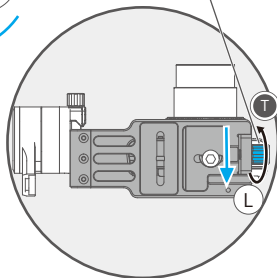

Slide the quick-release clamp down to adjust

②

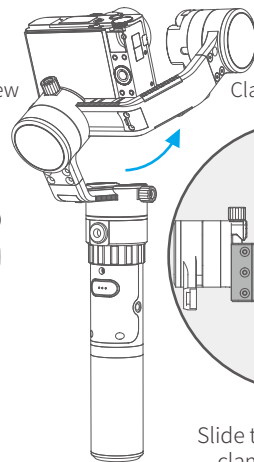

Camera backward

Clamp block thumb screw

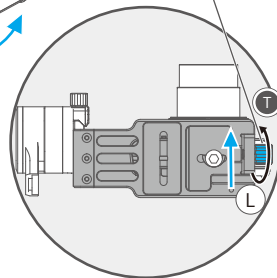

Slide the quick-release clamp up to adjust

③



## STEP 2 Balance adjustment of the rolling axis

When the balance adjustment of tilting axis completed, the balance of the rolling axis can be adjusted: Keep the gimbal socket connector vertical to the ground with the hand-held control handle as shown in figure ①, let go and observe the balance. Loosen the lock screw and slide the cross arm left and right to adjust the roll (Refer to figure ② ③).

\* After adjustment, be sure to tighten the lock screw.

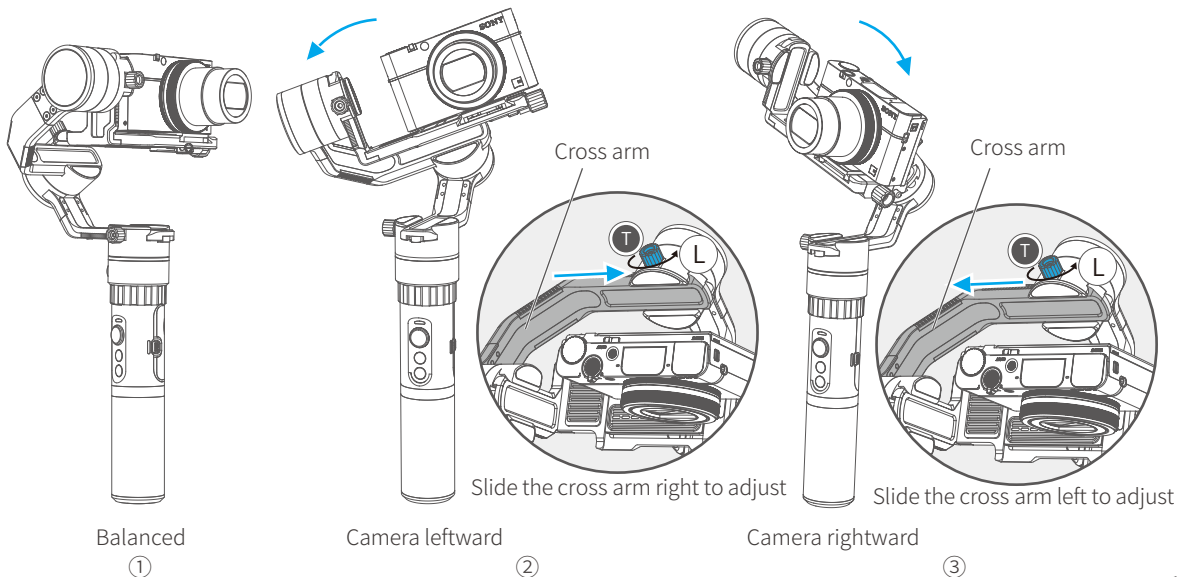

### STEP 3 Balance adjustment of the panning axis

When the balance adjustment of tilting axis and rolling axis is completed, the balance of the panning axis can be adjusted. Keep the gimbal socket connector horizontal with the ground with the hand-held control handle as shown in figure ①, let go and observe the state of rotation. Loosen the lock screw on the panning and slide the vertical arm forward and backward to adjust. (Refer to figure ② ③)

\* After adjustment, be sure to tighten the lock screw.

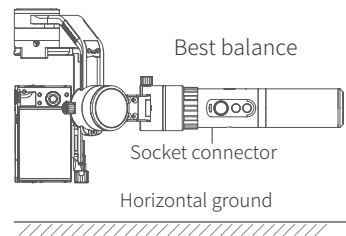

①

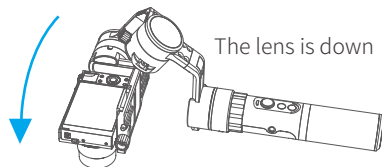

The lens is down

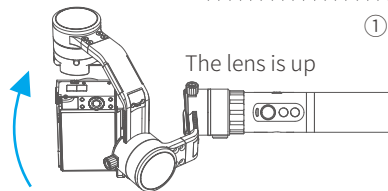

The lens is up

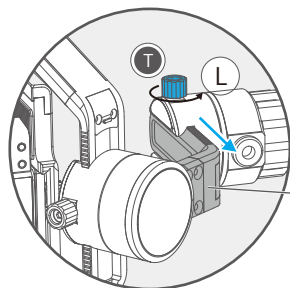

Vertical arm

②

Slide the vertical arm backward to adjust

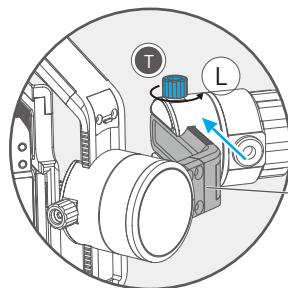

Vertical arm

③

Slide the vertical arm forward to adjust

## DISCLAIMER

Prohibit any user for any illegal purpose. Users will be responsible for all behaviors of purchase and use products.

The Company assumes no liability for any risks related to or resulting from the debug and use of this product (including the direct, indirect or third-party losses).

For any unknown sources of using, we will not be at any services.

The updating and changes of product firmware and program may cause changes in function descriptions in this user manual, please read the instructions carefully before upgrading the firmware and use the corresponding user manual.

You can get the latest user manual from the official website: [www.feiyu-tech.com](http://www.feiyu-tech.com)

Feiyu Tech reserves the right to amend this manual and the terms and conditions of use the gimbal at any time.

### Attention

- Please correctly assemble the gimbal in accordance with the diagram.
- Please install the phone before powering on the gimbal.
- When the gimbal is not in use or placed on the table, please ensure it is powered off.
- Remove the battery when not in use for a long time.

## Guilin Feiyu Technology Incorporated Company

---

**Website:** [www.feiyu-tech.com](http://www.feiyu-tech.com)

**E-mail:** [service@feiyu-tech.com](mailto:service@feiyu-tech.com)

**Tel:** +86 (0)773 2320866

---

Due to software and hardware improvements, your actual product might differ from the descriptions and pictures in this user manual. You can get the latest user manual from the official website.

For more information, please visit our official website

