



# Sewing Machine

Model Number MD 17329

## Quick Start Guide

# Electrical connections

1. Plug the connector on the power cable supplied into the socket **9** on the machine.
2. Plug the mains connection into the mains power point.
3. Switch the sewing machine on with the power switch **10**. The power switch turns both the sewing machine and the sewing light on.

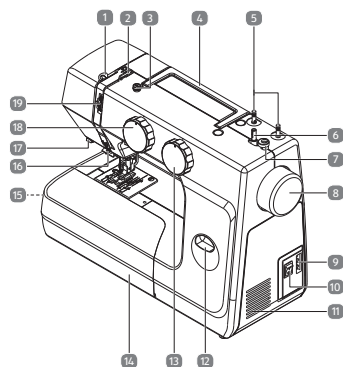

## Winding thread onto the bobbin

You can use the sewing machine to wind thread on to the bobbins easily.

- To do so, take the thread from the spool and route it around the winding thread guide **3** to the bobbin.

The exact procedure for winding thread on to the bobbin is described in the following points:

1. Place the spool of thread on the spool holder.  
Use the second spool holder when working with fine thread, as instructed in the previous section.
2. Route the thread from the spool around the winding thread guide, as illustrated.
3. Feed the end of the thread through the hole in the bobbin, as illustrated, and wind the thread around the bobbin a few times by hand.

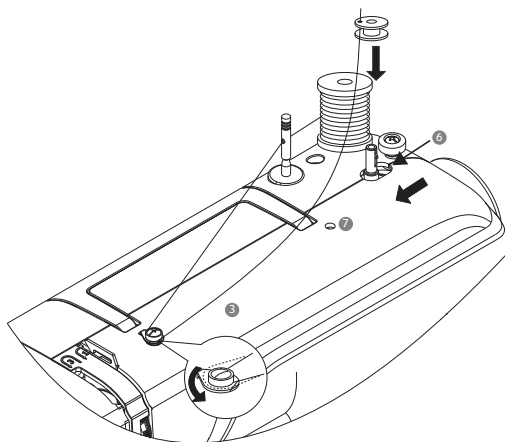

## Diagram of the upper thread guide

The diagram summarises the route of the upper thread.

The numbers indicate the sequence of the steps in the threading process.

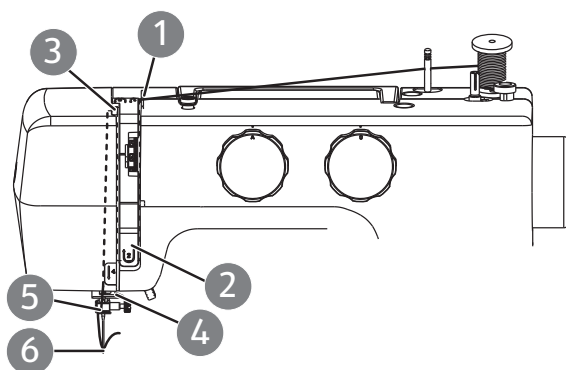

**NOTICE!** For more information about the numbering please refer to the more detailed instruction manual on page 9 - 11.