

INSIGNIA™

Front Control Dishwasher

NS-DWRF2SS3/NS-DWRF2WH3

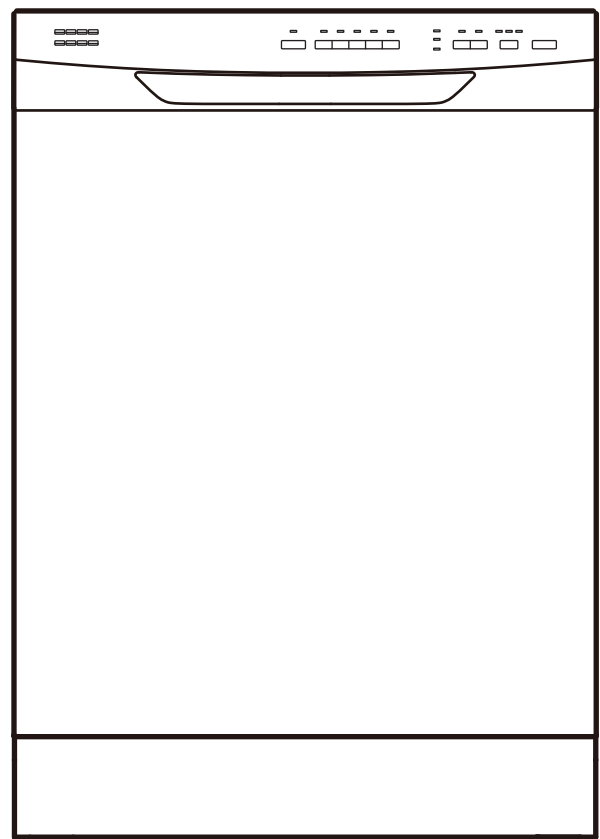

Before using your new product, please read these instructions to prevent any damage.

INSIGNIA™

Introduction	2
IMPORTANT SAFETY INSTRUCTIONS	3
Features	4
Package contents	4
Main components	4
Installing and setting up your dishwasher	5
Before using your dishwasher	5
Finding a suitable location	5
Providing a proper power supply	5
Understanding your dishwasher's features	5
How your dishwasher cleans	5
Wash cycle selections	5
Filter system	5
Smart wash system	5
Using your dishwasher	6
Using the control panel	6
Basic operation	7
Preparing and loading dishes	7
Adding a dish	10
Filling the detergent dispenser	10
Filling the rinse aid dispenser	11
Improving performance	12
Using rinse aid	12
Water temperature	12
Heat dry option	12
Water pressure	12
Maintaining your dishwasher	13
Cleaning the stainless steel panel	13
Cleaning the control panel	13
Cleaning the stainless steel inner door and tub	13
Cleaning the filters	13
Cleaning the door and tub gaskets	14
Cleaning the air gap	15
Protecting your dishwasher for long periods	15
Troubleshooting	16
Error codes	16
Specifications	18
ONE-YEAR LIMITED WARRANTY	19

Introduction

Congratulations on your purchase of a high-quality Insignia product. Your NS-DWRF2SS3 or NS-DWRF2WH3 represents the state of the art in dishwasher design and is designed for reliable and trouble-free performance.

IMPORTANT SAFETY INSTRUCTIONS



This symbol indicates that dangerous voltage constituting a risk of electric shock is present within your dishwasher.



This symbol indicates that there are important operating and maintenance instructions in the literature accompanying your dishwasher.

WARNING - When using your dishwasher, follow basic safety precautions, including the following:

- 1 Read these instructions.
- 2 Keep these instructions.
- 3 Heed all warnings.
- 4 Follow all instructions.
- 5 Clean only with a damp cloth.
- 6 Do not block any ventilation openings. Install in accordance with the manufacturer's instructions.
- 7 Make sure that the available AC power matches the voltage requirements of this appliance.
- 8 Refer all servicing to qualified service personnel. Servicing is required when the appliance has been damaged in any way or it does not operate normally.



WARNING

Electric Shock Hazard

Failure to follow these instructions can result in electric shock, fire, or death.

WARNING-DANGER

- 1 Never allow children to play with, operate, or crawl inside the dishwasher.
- 2 Turn off the dishwasher before carrying out user maintenance on it.
- 3 If a component part is damaged, it must be replaced by the manufacturer, its service agent, or similar qualified persons in order to avoid a hazard.
- 4 This appliance is intended to be used in a household and similar environments.

Basic precautions before use:

- Read all instructions before using the dishwasher.
- The manual does not cover every possible condition and situation that may occur.
- Use the dishwasher only for intended function as described in this manual.
- When loading items to be washed:
- Load sharp items and knives so that they are not likely to damage the door seal and tub.
- Load sharp items and knives with the handles up to reduce the risk of cut-type injury.
- Do not wash plastic items unless they are marked dishwasher safe or the equivalent. If not marked, check with manufacture for recommendation. Items that are not dishwasher safe may melt and create a potential fire hazard.
- If the dishwasher drains in to a garbage disposal, make sure that disposal is completely empty before running dishwasher.
- Do not tamper with the controls.
- Do not operate your dishwasher before it is properly installed in the cabinet.
- Do not touch the heating element during or immediately after use, especially if the sanitize option has been selected.

- Do not let children abuse, sit, or stand on the door or racks of the dishwasher.
- Under certain conditions, hydrogen gas may be produced in a hot water system that has not been used for two weeks or more. HYDROGEN GAS IS EXPLOSIVE. If the hot water system has not been used for such a period, before using, turn on all hot water faucets and let water flow from each for several minutes. This will release any accumulated hydrogen gas. Hydrogen gas is flammable. Do not smoke or use an open flame during this time.
- Do not store or use combustible materials, gasoline, or other flammable vapors and liquids in the vicinity of this or any other appliance.
- Use only detergents or rinse agents recommended for use in a dishwasher and keep them out of the reach of children.
- Keep young children and infants away from the dishwasher when it is operating.
- Do not use the dishwasher if it has a damaged power line or plug, and do not plug the dishwasher into a damaged outlet. Failure to observe these instructions may result in electrical shock.
- Remove the door to the washing compartment when removing an old dishwasher from service or discarding it.
- To reduce the risk of injury, do not allow children to play in or on a dishwasher.

SAVE THESE INSTRUCTIONS

Features

Package contents

- Dishwasher
- Drain hose
- Installation kits
- *User Guide*
- *Installation Guide*

Main components

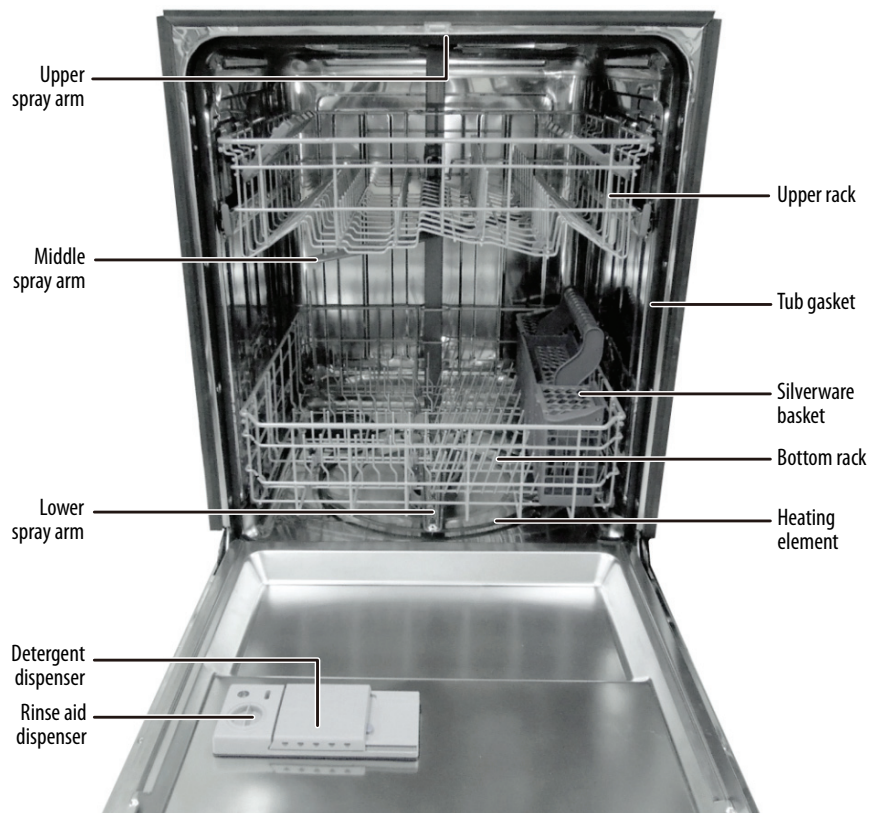

Installing and setting up your dishwasher

- 1 Water supply temperature should be between 120° ~ 149° F (49° ~ 65° C).
- 2 Dispose of the discarded appliance and packing material properly.
- 3 The dishwasher must be electrically grounded or it can result in a risk of electric shock.
- 4 If there is any damage to the dishwasher, please contact Customer Service. Do not attempt to repair or replace any part by yourself.

For information on installing and setting up your dishwasher, refer to the *Installation Guide* provided.

Before using your dishwasher

- 1 Remove the interior packing.
- 2 Remove all twist-ties and tape from the racks and spray arms.
- 3 Clean the interior surface with lukewarm water using a soft cloth.

Finding a suitable location

- This dishwasher is designed to be built-in.
- The dishwasher door must be able to fully open.

Providing a proper power supply

Check your local power source. This dishwasher requires a 120 V, 60 Hz power supply. Refer to the *Installation Guide* for additional information.

Understanding your dishwasher's features

How your dishwasher cleans

The dishwasher fills with water, covering the filter area at the bottom. Water is then pumped through the various filter and spray arms, spraying a mixture of hot water and detergent against the soiled surfaces of your dishes and silverware. Soil particles are separated and go down the drain as the dirty water is drained and replaced with clean water. The number of water fills is determined by the cycle selected.

Wash cycle selections

Cycle times are approximate and will vary with options selected. Hot water is necessary to activate dishwasher detergent and melt fatty food soils.

An automatic sensor checks the incoming water temperature and, if it is not hot enough, the timer will be delayed to allow for the water to heat for the main wash of all cycles.

Filter system

Your dishwasher has a multiple filter system which includes four separate filter meshes. It separates dirty water and clean water into different chambers. The multiple filter system helps your dishwasher to get better performance with less water and less energy.

Smart wash system

Your dishwasher has a smart wash system, under the normal wash, which selects the wash cycle based on how large and how soiled the load, permitting your dishwasher to clean more efficiently every time. When a partial load of lightly soiled dishes is placed in the unit, a short wash cycle is automatically selected. When a full load of heavily soiled dishes is placed in the unit, a heavy wash cycle is automatically selected.

Using your dishwasher

Using the control panel

Your dishwasher’s control panel is located on the front of the door. The door must be closed to make settings and operate the dishwasher.

Power

Turn the power on and off by pressing the power button.



Cycles

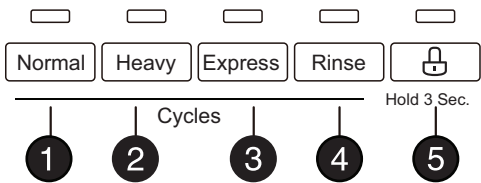

Select a cycle based on the type of dishes to be washed and the level of soil on the dishes. Cycle times are approximate and will vary with options selected. The timer will be delayed to allow for the water to heat for the main wash of all cycles if the sensor detects the water is not hot enough. Below is water use and cycle times under standard conditions.

#	CYCLE	DESCRIPTION	APPROXIMATE WATER USE	CYCLE TIME
1	Normal	Use for regularly soiled dishes or silverware. Uses sensors to determine the soil level of the load, then adjusts the wash cycle to optimized wash performance, water, and energy usage.	3–5.9 gal. (11.4–22.5 l)	108–120 min.
2	Heavy	Use for hard-to-clean, heavily soiled dishes, pots, and pans.	6.9 gal. (26.1 l)	138 min.
3	Express	Use for lightly soiled and pre-rinsed dishes and silverware.	4 gal. (15.1 l)	60 min.
4	Rinse	This cycle is for pre-rinsing dishes or glasses. This is only a rinse that keeps food from drying on your dishes and reduces odor buildup in your dishwasher until you are ready to wash a full load. Do not use detergent.	2 gal. (7.6 l)	20 min.
5	(child lock)	Use to lock all controls to prevent children from accidentally changing the dishwasher cycle or starting the dishwasher. Press the Child Lock button for three seconds to activate or cancel the child lock. The indicator light turns on or off.	n/a	n/a

Options

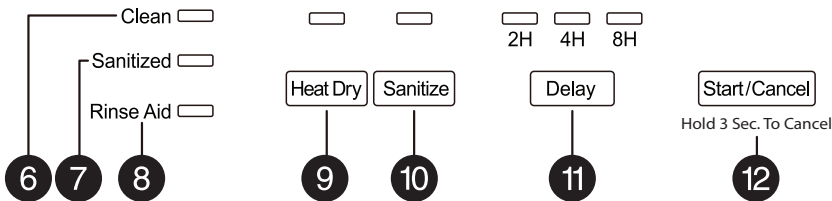

- **6 - Clean:** Turns on after a cycle is finished. Turns off when the door is opened for five minutes or any button is pressed.
 - **7 - Sanitized:** Turns on when a sanitized cycle is finished. Turns off when the door is opened for five minutes or any button is pressed.
 - **8 - Rinse Aid:** Turns on when you need to add rinse aid.
- Heat Dry and Sanitize options can add enhancements to the cycle selected.

Note: The selection of multiple options with a single cycle does not add significantly more time to the cycle than selecting a single option. The dishwasher automatically incorporates the selected options into the appropriate parts in the cycle.

- **9 - Heat Dry:** Turns on to indicate that heat dry has been selected and will be used during the drying process.

- **10 - Sanitize:** Use to sanitize your dishes and glassware. Maintains the water temperature at 158° F (70° C) max., and is available with the Normal and Heavy cycles.

Notes:

- Certified residential dishwashers are not intended for licensed food establishments.
- The sanitize cycle is NSF certified.

- **11 - Delay:** Press repeatedly to delay the start of the selected wash cycle until the delay time indicator you want is on. You can select 2, 4, or 8 hours delay. After you select the delay time you want, press **Start/Cancel** once, the delay begins to count down.

Important: If you open the door while delay is in effect, you must close the door, then press **Start/Cancel** to begin the cycle from that point, otherwise the dishwasher will stop the delay and will beep as a reminder to resume the delay. To cancel the delay and begin the cycle before the delay period is complete, press and hold **Start/Cancel** for three seconds.

- **12- Start/Cancel:** Press to start the dishwasher after you have selected a cycle and options (if desired). The cycle indicator stays on and the option indicator stays on.
If you don't press **Start/Cancel** after closing the door, the dishwasher pauses.
Press **Start/Cancel** to continue with the cycle.
To cancel a running cycle, press and hold **Start/Cancel** for three seconds. The dishwasher will run a one minute countdown and then begin draining. The dishwasher then returns to standby status.
To load more dishes or pause the dishwasher while it's already running, open the door. A safety mechanism stops the cycle. For additional information, see [Adding a dish on page 10](#).

CAUTION: To avoid injury, open the door slowly and carefully, and keep your face away from the dishwasher. There is a possibility of hot steam from inside the dishwasher.

Note: To silence the beeping of the buttons, press the Normal and Express buttons at the same time. That will silence all of the button beeps except the error code warning beeps. Error code beeps will still function. To turn the button beeps back on, press the Normal and Express buttons at the same time again.

Basic operation

- 1 Load the dishwasher (See [Preparing and loading dishes on page 7](#)).
- 2 Add detergent (See [Filling the detergent dispenser on page 10](#)).
- 3 Add rinse aid, if needed (See [Filling the rinse aid dispenser on page 11](#)).
- 4 Close the door.
- 5 Select the cycle you want (See the [Using the control panel on page 6](#)). The indicator will flash when the selection is made.
- 6 Select the options you want. The indicator will flash when the selection is made.
- 7 To start, press **Start/Cancel** on the control pad.

Preparing and loading dishes

Preparing dishes for washing

- Scrape away large pieces of food, bones, pits, toothpicks, and similar items. The continuous filtered wash system will remove the remaining food particles.

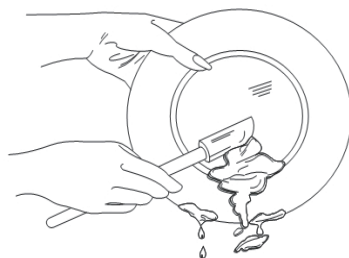

- Burned-on foods should be loosened before loading.
- Empty liquids from glasses and cups.
- Foods such as mustard, mayonnaise, vinegar, lemon juice, and tomato-based products may cause discoloration of stainless steel and plastics if allowed to sit for a long period of time. Unless the dishwasher is to be operated at once, it is best to rinse off these types of foods.
- If the dishwasher drains into a garbage disposal, be sure the disposal is completely empty before starting the dishwasher.

Loading the upper rack

The upper rack is designed for cups, glasses, small plates, bowls, and plastic items marked dishwasher-safe. For best results, place the items with the soiled surface facing down or toward the center. Tilt them slightly for better drainage.

Note: Make sure that the loaded dishes do not interfere with the rotation of the middle spray arm, which is located just below the upper rack. You can check this by rotating the middle spray arm by hand.

Loading suggestions are shown below:

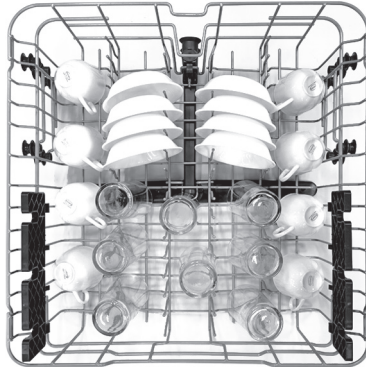

8 place settings

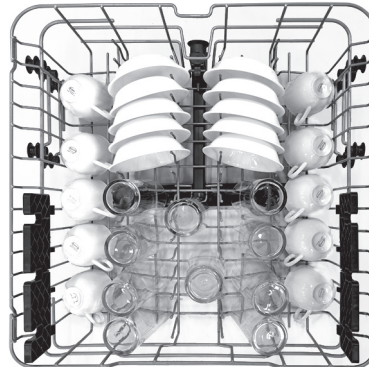

10 place settings

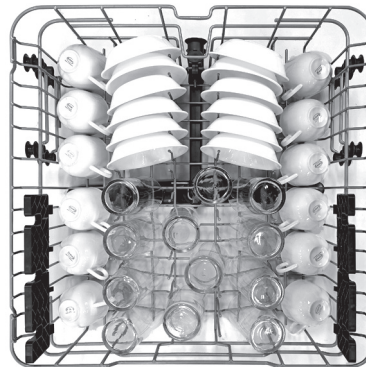

12 place settings

Loading the bottom rack

The bottom rack is designed to accommodate plates, bowls, saucers, and cookware. Large items should be placed along the edge, with the inside facing down, so they do not interfere with the middle or lower spray arms or prevent the detergent dispenser from opening.

The fold-down tines in the bottom rack make easy loading for those extra large and hard-to-fit items. The tines may be left up for normal use or folded down for more flexible loading. Fold down for more space to load large pots or pans. See [Fold-down tines](#) on page 10.

Loading suggestions are shown below:

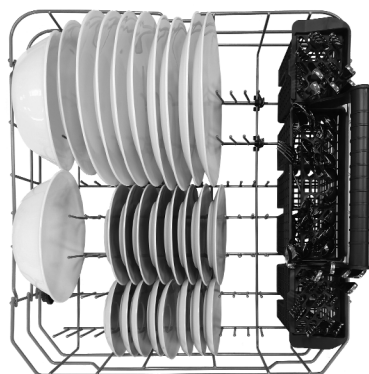

8 place settings

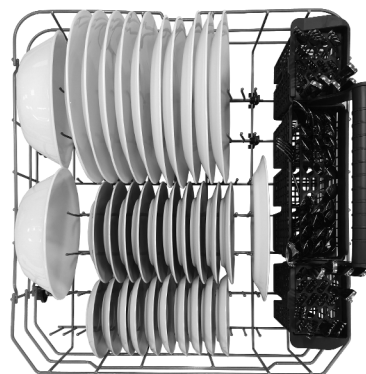

10 place settings

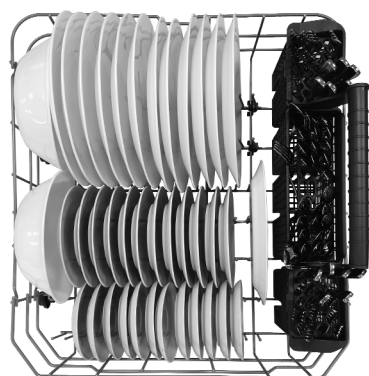

12 place settings

Loading the silverware basket

The silverware basket is divided into three separate sections, which can be placed in either the upper or lower racks. The basket fits small forks, spoons, knives, large spoons, and large forks.

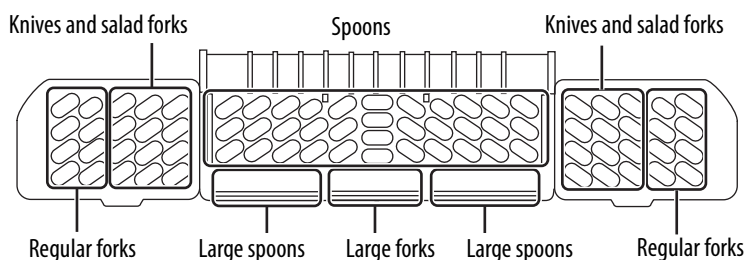

CAUTION: Make sure that nothing protrudes through the bottom of the silverware basket to block the lower spray arm.



Fold-down tines

The fold-down tines in the bottom rack make easy loading for those extra large and hard-to-fit items. The tines may be left up for normal use or folded down for more flexible loading. Fold down for more space to load large pots or pans.

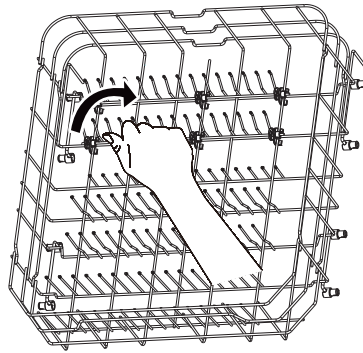

Adding a dish

CAUTION: TO AVOID BURN INJURY: Open the door slowly and wait until the spray arms and wash action stop. Hot water may splash out of the dishwasher. Failure to do so may result in injury.

Before adding dishes, refer to [Preparing and loading dishes](#) on page Z for instructions on loading. Once a cycle has started, you can add more dishes before the main wash portion of the wash cycle has started. To determine this, check the detergent dispenser in the door after the door has been opened. If the detergent dispenser is still closed, you can add more dishes. If it is open, you can add dishes to the dishwasher if the dish quantity is small. If the quantity is large, restart the cycle. Also see information on **Start/Cancel** in the [Basic operation](#) section on page Z.

To add or remove items after the wash cycle starts:

- 1 Open the door slightly and wait a few seconds until the wash action stops before completely opening.
- 2 Add the item.
- 3 Close the door, and press **Start/Cancel** on the control pad. The cycle automatically resumes.

Filling the detergent dispenser

- 1 Push the detergent dispenser cover latch inwards to open the detergent cup. The cover is spring-loaded and will pop open automatically.

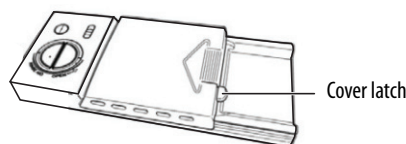

- 2 Add detergent (dry powder, liquid, or packets) to the cup. If using a packet, make sure the packet is below the edges of the detergent cup and the cover can close properly.

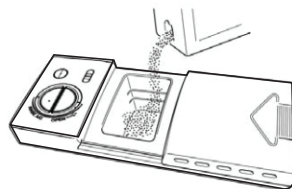

- 3 Close the detergent dispenser cover.

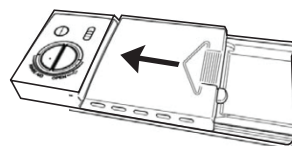

The amount of detergent required depends on the water hardness. Refer to the following table for the recommended amount.

Cycle	Soft Water (0-3 grains)	Medium Hard Water (4-8 grains)	Hard Water (9-12 grains)	Very Hard Water (over 12 grains)
Normal Heavy Express	2 tsp. (main wash cup 1/4 full)	5 tsp. (main wash cup fill to line above regular)	8 tsp. (main wash cup completely full)	Main wash cup completely full (water softener recommended)

Filling the rinse aid dispenser

Your dishwasher is designed to use a liquid rinse aid. The use of a rinse aid greatly improves drying performance after the final rinse. Do not use a solid or bar-type rinse aid. Under normal conditions, the rinse aid will last approximately one month. Try to keep the dispenser full, but do not overfill it.

- 1 Turn the rinse aid dispenser cap 1/4 turn counterclockwise and lift it out.

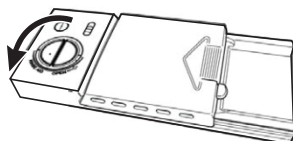

- 2 Add rinse aid until the liquid touches the indicated fill level. Do not overfill, since this can cause oversudsing. Wipe up any spills with a damp cloth. The dispenser holds enough for 30 to 140 washes, depending on the dial setting.

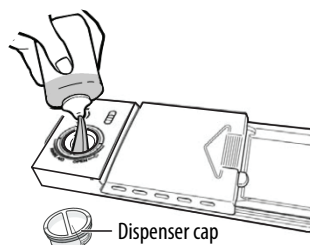

- 3 Adjust the rinse aid dial, if necessary. See [Using rinse aid](#) on page 12 for information on proper adjustment of the rinse aid setting.

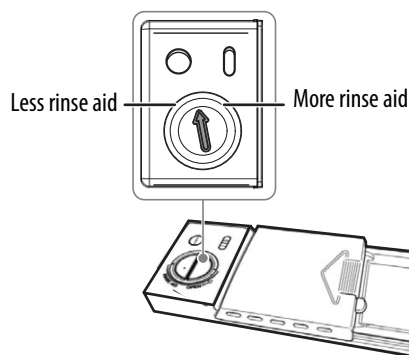

- 4 Replace the cap and turn it 1/4 turn clockwise.

Improving performance

Using rinse aid

Rinse aid greatly improves drying and reduces water spots and filming. Without rinse aid, your dishes and dishwasher interior will have excessive moisture. In addition, the heated dry option will not perform as well without rinse aid. The rinse aid dispenser, located next to the detergent cup, automatically releases a measured amount of rinse aid during the last rinse.

If spotting and poor drying is a problem, increase the amount of rinse aid dispensed by rotating the dial to a higher number. The dial is located under the dispenser cap.

If the rinse aid is low, the rinse aid light turns on at the beginning and end of the cycle indicating that it is time to refill. Refer to [Filling the rinse aid dispenser](#) on page 11.

Water temperature

Hot water is required for optimum dishwashing and drying results. Water entering the dishwasher should be at least 120° F (49° C) to achieve satisfactory results.

To check the water temperature entering the dishwasher:

- 1 Turn on the hot water faucet near the dishwasher and let it run for several minutes.
- 2 Hold a thermometer (a candy or meat thermometer will work) in the water stream to check the temperature. If temperature is below 120° F (49° C), have a qualified person raise the hot water heater thermostat setting.

Important: To make sure that the water entering the dishwasher is hot, run hot water from the nearest hot water faucet to clear cool water from the pipe before starting the cycle.

Heat dry option

CAUTION: Plastic dishes could melt/deform due to the heat, especially if placed in the lower rack.

The heat dry option, when used with a rinse aid, enhances drying performance. If you do not choose the heat dry option, items in your load may not be completely dry at the end of the cycle.

Water pressure

For optimum performance, the hot water supply line for your dishwasher must provide water pressure of at least 20 psi and not more than 100 psi. You may experience low water pressure during high-demand periods, such as when laundry or showers are in use while you are washing the dishes. To eliminate this problem, wait until hot water demand is reduced before starting the dishwasher.

Maintaining your dishwasher

CAUTION: TO AVOID BURN INJURY: Allow the heating element to cool before attempting to clean the interior of your dishwasher.

Cleaning the stainless steel panel

Clean the stainless steel door and plastic handle regularly with a soft cloth and standard household cleaner to remove dirt and debris monthly.

CAUTION: Do not use appliance wax, polish, bleach, or products containing chlorine to clean the stainless steel door.

Cleaning the control panel

Clean the control panel gently with a soft, lightly dampened cloth.

Cleaning the stainless steel inner door and tub

The tub is made of stainless steel. It will not rust or corrode, even if the dishwasher should be scratched or dented. Clean the spots on the steel inner door and tub with a damp non-abrasive cloth.

Cleaning the filters

The filters are designed to collect debris and need to be cleaned monthly to maximize wash performance.

- 1 Remove the bottom rack.



- 2 Rotate the cylinder filter, then lift it out.

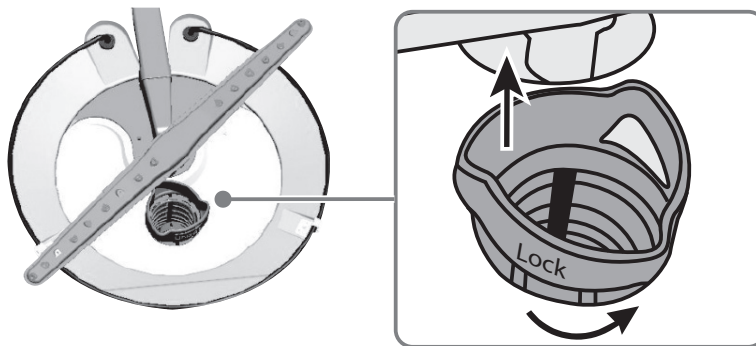

- 3 Lift the fine filter from the bottom of the tub.

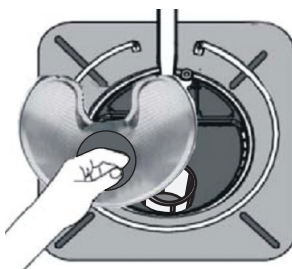

- 4 Take out the plastic and fabric filter.

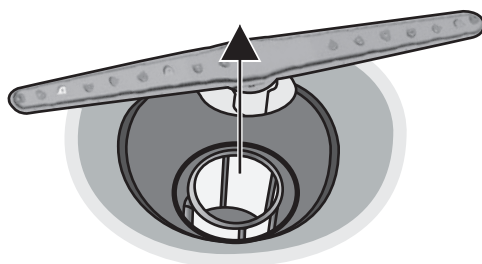

- 5 Flush the filters by holding them under running water.



- 6 Replace the fabric filter.
- 7 Replace the fine filter.
- 8 Replace the cylinder filter and lock into place.
- 9 Replace the bottom rack.

Cleaning the door and tub gaskets

Clean the door gasket with a damp cloth to remove food particles regularly.

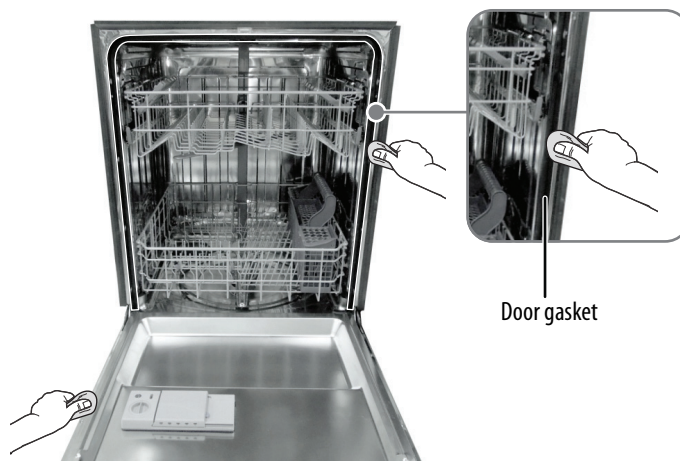

The inside of the dishwasher is self-cleaning under normal use. If needed, the tub gasket can be cleaned with a damp cloth. Use a brush to clean the opening in the end of the gasket.

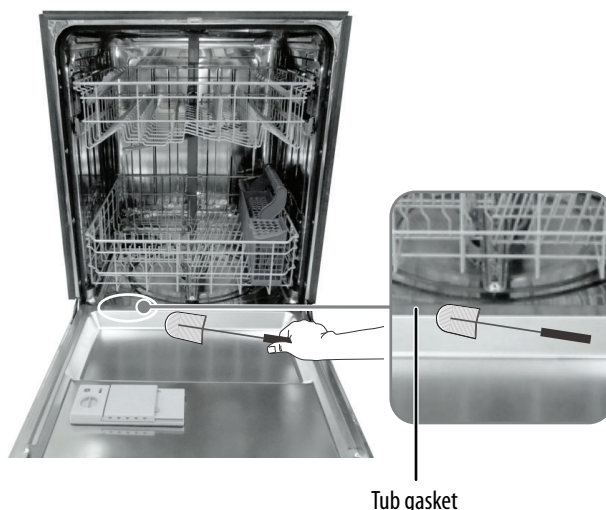

Cleaning the air gap

An *air gap* is an external plumbing device that is not actually part of your dishwasher. Some state or local plumbing codes require the installation of a drain air gap between the dishwasher and the home drain system. It is usually located on the countertop near the sink or the dishwasher.

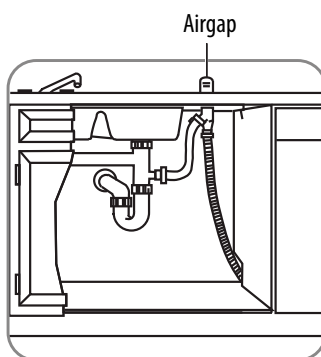

If there is an air gap installed with your dishwasher, make sure that it is clean so the dishwasher will drain properly. Before you clean the air gap, turn off the dishwasher, then remove the plastic air gap cover and clean with a toothpick.

Protecting your dishwasher for long periods

Your dishwasher should be protected from freezing if you plan to leave it for extended periods in an unheated place. Have a qualified person do the following:

To disconnect service:

- 1 Turn off the electrical power to the dishwasher at the supply source by moving fuses or tripping the circuit breaker.
- 2 Turn off the water supply.
- 3 Place a pan under the inlet valve, then disconnect the water line from the inlet valve and drain it into a pan.
- 4 Disconnect the drain line from the pump and drain the water into a pan.

To restore service:

- 1 Reconnect the water, drain, and electrical power.
- 2 Turn on the water and the electrical power supply.
- 3 Fill the detergent cup and the rinse aid cup and run the dishwasher through a heated-wash cycle.
- 4 Check all connections to make sure that they do not leak.

Troubleshooting

Refer to this table to correct minor issues before calling for service.

Error codes

CODE	MEANING	POSSIBLE CAUSE	POSSIBLE SOLUTION
Rinse light blinks and your dishwasher beeps for 15 seconds	The water flow is insufficient or the water pressure is too high	<ul style="list-style-type: none"> Water faucet is not opened Water pressure is too low The drain hose is plugged Other (parts failure of inlet or drain system) 	<ul style="list-style-type: none"> Make sure that the water is turned on to the dishwasher Make sure that the water pressure is 20~100 psi Check the drain hose Contact Customer Service
Express and rinse lights blink and your dishwasher beeps for 15 seconds	Abnormal heating		<ul style="list-style-type: none"> Contact Customer Service
Heavy light blinks and your dishwasher beeps for 15 seconds	Overflow or leak sensor activated	<ul style="list-style-type: none"> A leak Too much water in the tub 	<ul style="list-style-type: none"> Turn off water to your dishwasher, then check the filter system for blockage. Unblock if necessary. If there is no water in the tub, contact Customer Service
Heavy and express lights blinks and your dishwasher beeps for 15 seconds			<ul style="list-style-type: none"> Contact Customer Service
Heavy, express, and rinse lights blink and your dishwasher beeps for 15 seconds			<ul style="list-style-type: none"> Contact Customer Service
Normal, heavy, and rinse lights blink and your dishwasher beeps for 15 seconds	Communication exception or issue	<ul style="list-style-type: none"> The display board can't receive or the main board can't send a signal for longer than 20 seconds 	<ul style="list-style-type: none"> Contact Customer Service

Note: After resolving an error code issue, cycle the power on the dishwasher using the power button on the dishwasher control panel. If the error code persists, you may need to cycle the power to the dishwasher by resetting the circuit breaker that powers the dishwasher.

Important:

- If an overflow occurs, turn off the main water supply before calling for service.
- If there is water in the base pan because of an overflow or small leak, the water should be removed before restarting the dishwasher.

PROBLEM	POSSIBLE CAUSE	POSSIBLE SOLUTION
The dishwasher won't start	The door may not be closed properly.	Make sure that the door is closed and latched.
	The power is off or not connected.	Make sure that the power is connected and turned on. If your home has a wall switch above the dishwasher that powers the dishwasher outlet, make sure that the wall switch is in the On position.
	The delay start option is selected.	Refer to the "11- Delay" section on page 7.
	The child lock is activated.	Deactivate the child lock. Refer to the "Child lock" section under <u>Cycles</u> on page 6.
	The wall switch is not turned on.	Some dishwashers have a wall switch mounted above the counter that controls the dishwasher. Make sure that this switch is turned on.
The dishwasher beeps eight times at the end of the cycle	This is normal and indicates that the wash cycle is complete.	

PROBLEM	POSSIBLE CAUSE	POSSIBLE SOLUTION
The rinse aid light is on	The rinse aid level is low.	Add rinse aid.
The dishwasher runs too long	The dishwasher is connected to a cold water supply.	Make sure that the dishwasher is connected to a hot water supply. If not, change the water supply to a hot water source.
	The cycle time varies, depending on the soil level of the dishes.	When heavy soil is detected, the wash times will be longer.
	Some cycles and options take longer.	This is normal.
The dishes are not clean enough	The water pressure is too low.	Make sure that the water pressure is above 20 psi. Use your dishwasher when water demand is low.
	The inlet water temperature is too low.	Make sure that the dishwasher is connected to a hot water supply. If not, change the water supply to a hot water source. Use your dishwasher when hot water demand is low.
	The water temperature may be too low at the start of the wash cycle.	Run the hot water in the sink for 30 seconds or until the water runs hot, then start the dishwasher.
	Dishes are too close together.	Reload the dishwasher as shown in Preparing and loading dishes on page 7.
	Improper use of detergent.	Add detergent depending on the water hardness and washing cycle you choose. Use fresh detergent.
	The selected cycle is not suitable for the soil level on the dishes.	Choose a different cycle with a longer washing time.
	The spray arms are blocked.	Make sure that the spray arms are not blocked and are free to rotate.
The dishes are not dry enough	The rinse aid dispenser is empty or the setting is too low.	Fill the rinse aid dispenser. Increase the rinse aid setting.
	Dishes are loaded improperly.	Reload the dishwasher as shown in Loading the upper rack on page 8 and Loading the bottom rack on page 9.
	The cycle you chose did not include drying.	Choose a cycle with drying.
Spots and filming on dishes	Water hardness is too high	For extremely hard water, install a water softener.
	Dishes are loaded improperly.	Reload the dishwasher as shown in Loading the upper rack on page 8 and Loading the bottom rack on page 9.
	Old or damp rinse aid powder is used.	Use fresh, liquid rinse aid.
	The rinse aid dispenser is empty or the setting is too low.	Fill the rinse aid dispenser. Increase the rinse aid setting.
Etching	Too much detergent being used.	Use less detergent if you have soft water.
	The inlet water temperature exceeds 150° F (65.6° C).	Lower the inlet water temperature.
Detergent left in dispenser cup	Detergent may be too old.	Use fresh detergent.
	The spray arm is blocked.	When you load the dishes, make sure that the spray arms are not blocked.
The detergent dispenser will not close	Improper operation of the detergent cover.	Add detergent and rinse aid only as indicated in this manual. See Filling the detergent dispenser on page 10.
Water remains in the dishwasher.	The previous cycle has not finished or has been interrupted.	Make sure that the current cycle is finished.

PROBLEM	POSSIBLE CAUSE	POSSIBLE SOLUTION
The dishwasher does not drain properly.	The drain is clogged.	Check the air gap (if so equipped). Make sure that the disposer is empty (if so connected).
	The drain hose is kinked.	Make sure that the drain hose is not kinked and is properly connected.
	The garbage disposal inlet port is plugged.	Check the inlet port to the disposal unit to make sure that it is not plugged. If a new disposal unit was installed, make sure its plastic inlet port is open.
Suds in the tub	Used the wrong type of detergent.	Make sure that you use only detergents approved for automatic dishwashers.
	The rinse aid cup is overfilled.	Add rinse aid only to the indicated fill level.
The dishwasher leaks	Excessive suds caused by using the wrong type of detergent.	Make sure that you use only detergents approved for automatic dishwashers.
	The dishwasher is not level.	Level the dishwasher (refer to the <i>Installation Manual</i>).
There are black or gray marks on the dishes	Aluminum utensils have rubbed against the dishes.	Hand wash aluminum items. Remove aluminum markings by using a mild abrasive cleaner.
The interior of the tub is stained	Coffee or tea stains.	Use a spot cleaner to remove the stains.
	Food or beverage stain.	Some tomato products may cause this. Running a rinse only cycle immediately after loading will help this.
Noises	Detergent cup opening/drain pump.	This is normal.
	A hard object or piece of food is in the dishwasher during the wash cycle.	If the noise continues after the cycle is complete, call for service. If the object is a piece of food that can be broken down by the wash cycle, the noise will stop.
The dishwasher won't fill	The water valve is turned off.	Turn on the water valve.
	The door may not be closed completely.	Make sure that the door is closed and latched.

Specifications

Capacity	Maximum 12 place settings
Dimensions (WxDxH)	23 15/16 x 25 1/4 x 33 13/16 in. (60.6 x 64 x 85.8 cm)
Power requirements	120V~60Hz
Current	8.4A
Water pressure	Between 20 and 100 psi (138 and 689 kPa)
Noise (dB)	51 dB

ONE-YEAR LIMITED WARRANTY

Definitions:

The Distributor* of Insignia branded products warrants to you, the original purchaser of this new Insignia-branded product ("Product"), that the Product shall be free of defects in the original manufacture of the material or workmanship for a period of one (1) year from the date of your purchase of the Product ("Warranty Period").

For this warranty to apply, your Product must be purchased in the United States or Canada from a Best Buy branded retail store or online at www.bestbuy.com or www.bestbuy.ca and is packaged with this warranty statement.

How long does the coverage last?

The Warranty Period lasts for 1 year (365 days) from the date you purchased the Product. Your purchase date is printed on the receipt you received with the Product.

What does this warranty cover?

During the Warranty Period, if the original manufacture of the material or workmanship of the Product is determined to be defective by an authorized Insignia repair center or store personnel, Insignia will (at its sole option): (1) repair the Product with new or rebuilt parts; or (2) replace the Product at no charge with new or rebuilt comparable products or parts. Products and parts replaced under this warranty become the property of Insignia and are not returned to you. If service of Products or parts are required after the Warranty Period expires, you must pay all labor and parts charges. This warranty lasts as long as you own your Insignia Product during the Warranty Period. Warranty coverage terminates if you sell or otherwise transfer the Product.

How to obtain warranty service?

If you purchased the Product at a Best Buy retail store location or from a Best Buy online website (www.bestbuy.com or www.bestbuy.ca), please take your original receipt and the Product to any Best Buy store. Make sure that you place the Product in its original packaging or packaging that provides the same amount of protection as the original packaging.

To obtain warranty service, in the United States and Canada call 1-877-467-4289. Call agents may diagnose and correct the issue over the phone.

Where is the warranty valid?

This warranty is valid only in the United States and Canada at Best Buy branded retail stores or websites to the original purchaser of the product in the country where the original purchase was made.

What does the warranty not cover?

This warranty does not cover:

- Food, beverage, and/or medicine loss/spoilage.
- Customer instruction/education
- Installation
- Set up adjustments
- Cosmetic damage
- Damage due to weather, lightning, and other acts of God, such as power surges
- Accidental damage
- Misuse
- Abuse
- Negligence
- Commercial purposes/use, including but not limited to use in a place of business or in communal areas of a multiple dwelling condominium or apartment complex, or otherwise used in a place of other than a private home.
- Modification of any part of the Product, including the antenna
- Display panel damaged by static (non-moving) images applied for lengthy periods (burn-in).
- Damage due to incorrect operation or maintenance
- Connection to an incorrect voltage or power supply
- Attempted repair by any person not authorized by Insignia to service the Product
- Products sold "as is" or "with all faults"
- Consumables, including but not limited to batteries (i.e. AA, AAA, C etc.)
- Products where the factory applied serial number has been altered or removed
- Loss or Theft of this product or any part of the product
- Display panels containing up to three (3) pixel failures (dots that are dark or incorrectly illuminated) grouped in an area smaller than one tenth (1/10) of the display size or up to five (5) pixel failures throughout the display. (Pixel based displays may contain a limited number of pixels that may not function normally.)
- Failures or Damage caused by any contact including but not limited to liquids, gels or pastes.

REPAIR REPLACEMENT AS PROVIDED UNDER THIS WARRANTY IS YOUR EXCLUSIVE REMEDY FOR BREACH OF WARRANTY. INSIGNIA SHALL NOT BE LIABLE FOR ANY INCIDENTAL OR CONSEQUENTIAL DAMAGES FOR THE BREACH OF ANY EXPRESS OR IMPLIED WARRANTY ON THIS PRODUCT, INCLUDING, BUT NOT LIMITED TO, LOST DATA, LOSS OF USE OF YOUR PRODUCT, LOST BUSINESS OR LOST PROFITS. INSIGNIA PRODUCTS MAKES NO OTHER EXPRESS WARRANTIES WITH RESPECT TO THE PRODUCT, ALL EXPRESS AND IMPLIED WARRANTIES FOR THE PRODUCT, INCLUDING BUT NOT LIMITED TO ANY IMPLIED WARRANTIES OF AND CONDITIONS OF MERCHANTABILITY AND FITNESS FOR A PARTICULAR PURPOSE, ARE LIMITED IN DURATION TO THE WARRANTY PERIOD SET FORTH ABOVE AND NO WARRANTIES, WHETHER EXPRESS OR IMPLIED, WILL APPLY AFTER THE WARRANTY PERIOD. SOME STATES, PROVINCES AND JURISDICTIONS DO NOT ALLOW LIMITATIONS ON HOW LONG AN IMPLIED WARRANTY LASTS, SO THE ABOVE LIMITATION MAY NOT APPLY TO YOU. THIS WARRANTY GIVES YOU SPECIFIC LEGAL RIGHTS, AND YOU MAY ALSO HAVE OTHER RIGHTS, WHICH VARY FROM STATE TO STATE OR PROVINCE TO PROVINCE.

Contact Insignia:

1-877-467-4289

www.insigniaproducts.com

INSIGNIA is a trademark of Best Buy and its affiliated companies.

*Distributed by Best Buy Purchasing, LLC

7601 Penn Ave South, Richfield, MN 55423 U.S.A

©2022 Best Buy. All rights reserved.

INSIGNIA™

For product inquiries, please contact us with the information below:

1-877-467-4289

www.insigniaproducts.com

INSIGNIA is a trademark of Best Buy and its affiliated companies.

Distributed by Best Buy Purchasing, LLC

7601 Penn Ave South, Richfield, MN 55423 U.S.A.

©2022 Best Buy. All rights reserved.

V2 ENGLISH
22-0653