

Translation of the original operating instructions

LDS3000, LDS3000 AQ

Mass spectrometer module

Catalog No.
560-300, 560-600

From software version
MS-Modul 2.72

jjqa54en1-10-(1911)



INFICON GmbH

Bonner Strasse 498

50968 Cologne, Germany

Table of Contents

1 About these instructions	7
1.1 Other associated documents	7
1.2 Target groups	7
1.3 Warnings.....	7
1.4 Definition of terms.....	8
2 Safety	11
2.1 Intended use	11
2.2 Owner requirements	11
2.3 Duties of the operator	12
2.4 Dangers	13
3 Shipment, Transport, Storage	15
4 Description.....	16
4.1 Function	16
4.2 Device setup	17
4.2.1 Entire device (LDS3000).....	17
4.2.2 Entire device (LDS3000 AQ).....	18
4.2.3 Connection block	22
4.2.4 MSB box	22
4.2.5 Markings on the device	25
4.3 Technical data	25
4.4 Factory settings	26
5 Mounting LDS3000.....	29
5.1 Adjust the position of the connections to the installation dimensions.....	29
5.2 Installing the mass spectrometer module on the test system	30
5.3 Select connection ULTRA, FINE, or GROSS	31
5.4 Establish component connection	32
5.5 Establish electrical connections.....	33
6 Mounting LDS3000 AQ (Accumulation).....	34
6.1 Adjust the position of the connections to the installation dimensions.....	34
6.2 Installing the mass spectrometer module on the test system	35
6.3 Select components and connect.....	36
6.4 Establish electrical connections.....	39

7 Operation LDS3000	40
7.1 Switching the device on	40
7.2 Default settings	41
7.3 Selecting a unit for the leak rate	42
7.4 Select device for pressure	43
7.5 Select Compatibility Mode	43
7.6 Select operation mode	45
7.7 Select gas type (mass)	46
7.8 Calibrating the device	46
7.8.1 Time and general preferences	46
7.8.2 Internal Calibration Configuration and Start	49
7.8.3 External Calibration Configuration and Start	49
7.8.4 Start external dynamic calibration	52
7.8.5 External calibration with sniffer line SL3000XL	54
7.8.6 Check the calibration	55
7.8.6.1 Calibration using the internal calibration leak test	55
7.8.6.2 Calibration using the external calibration leak test	55
7.8.7 Entering the calibration factor	56
7.8.7.1 Calibration factor sniffing	56
7.8.7.2 Calibration factor vacuum	56
7.8.8 Setting machine and sniff factor	57
7.8.8.1 Setting machine and sniff factor manually	57
7.8.8.2 Setting machine and sniff factor using machine calibration	58
7.9 Starting and stopping the measurement	58
7.10 Loading and saving parameters	59
7.11 Copying measurement data, deleting measurement data	60
7.12 Suppressing gas backgrounds with "ZERO" functions	60
7.13 Measurement result display with signal filters	61
7.14 Control of the Gas Ballast Valve of the Backing Pump	62
7.15 Selecting display limits	63
7.16 Setting trigger values	63
7.17 Setting capillary surveillance	63
7.18 Set the rotation speed of the turbo molecular pump	64
7.19 Cathode Selection	65
7.20 Settings for the XL sniffer adapter	65

7.21 Resetting the settings	68
8 Operation LDS3000 AQ (Accumulation).....	69
8.1 Switching the device on	69
8.2 Default settings	69
8.3 Selecting a unit for the leak rate	70
8.4 Select device for pressure	71
8.5 Select Compatibility Mode	71
8.6 Making basic settings via the wizard	73
8.7 Determine peak	74
8.8 Store leak rate of calibration leaks.....	75
8.9 Calibrating the device	76
8.9.1 Time and general preferences	76
8.9.2 Entering the calibration factor	77
8.9.3 Calibration factor vacuum	77
8.9.4 Calibrating.....	77
8.10 Perform ZERO	80
8.11 Setting machine and sniff factor	81
8.11.1 Setting machine and sniff factor manually	81
8.12 Carrying out a measurement	82
8.13 Loading and saving parameters	83
8.14 Copying measurement data, deleting measurement data	83
8.15 Adjust "Zero time factor AQ"	84
8.16 Selecting display limits.....	84
8.17 Set the rotation speed of the turbo molecular pump.....	84
8.18 Cathode Selection	85
8.19 Resetting the settings	85
9 Using the expansion module (LDS3000, LDS3000 AQ).....	87
9.1 Selecting the type of expansion module	87
9.2 Settings for I/O module IO1000	87
9.2.1 General interface settings	87
9.2.2 Assigning inputs and outputs	88
9.2.2.1 Assigning the digital inputs of the I/O module	95
9.2.2.2 Assigning the digital outputs of the I/O module.....	97
9.3 Settings for bus module BM1000.....	99
10 Warning and error messages (LDS3000, LDS3000 AQ).....	100

10.1 Illustration of error codes with the help of the status LEDs.....	108
11 Operating CU1000 (optional).....	109
11.1 Touchscreen elements	109
11.1.1 Measurement display elements	109
11.2 Elements of the error and warning display	112
11.3 Settings and functions	112
11.3.1 Touch screen settings.....	113
11.3.2 Operator types and authorizations.....	116
11.3.2.1 Logging out the operator	117
11.3.3 Functions	118
11.3.3.1 Resetting the settings.....	118
11.3.3.2 Recording data.....	118
11.3.3.3 Calling up information	119
11.3.4 Updating the software	123
11.3.4.1 Updating the software of the control unit.....	123
11.3.4.2 Checking and updating the software version of the MSB box.....	123
11.3.4.3 Updating the software of the I/O module.....	124
12 Maintenance	126
12.1 Maintenance at INFICON	126
12.2 General maintenance information.....	126
12.3 Maintenance plan	127
12.4 Maintenance work.....	128
12.4.1 Change oil reservoir of turbo molecular pump	128
13 Decommissioning the measuring instrument.....	133
13.1 Shutting down the leak detector	133
13.2 Disposing of the mass spectrometer module.....	133
13.3 Returning the mass spectrometer module.....	133
14 Appendix.....	134
14.1 CE Declaration of Conformity	134
14.2 Declaration of Incorporation.....	135
14.3 Declaration of Contamination	136
14.4 RoHS	137

1 About these instructions

This document applies to the software version stated on the title page.

Product names may occur in the document, which are added for identification purposes only and belong to the respective owner of the rights.

This operating manual describes the installation and operation of the LDS3000 mass spectrometer module. It is available in two variants:

- LDS3000
- LDS3000 AQ (accumulation), switchable to all other operating modes.

1.1 Other associated documents

Operating Manual Control Unit CU1000	jina54
Operating instructions bus module	jiqb10
Operating instructions I/O module	jiqc10
Operating instructions XL sniffer adapter	jinxa54
Interface protocols	jira54

1.2 Target groups

These operating instructions are intended for the owner and for technically qualified personnel with experience in leak detection technology and integration of leak detection devices in leak detection systems. In addition, the installation and use of the device require knowledge of electronic interfaces.

1.3 Warnings

DANGER

Imminent hazard resulting in death or serious injuries

WARNING

Hazardous situation resulting in potential death or serious injuries

CAUTION

Hazardous situation resulting in minor injuries

NOTICE**Hazardous situation resulting in damage to property or the environment**

1.4 Definition of terms

**Mention of helium in the manual**

The device is a helium leak detector. If you want to use a forming gas instead of helium to detect the hydrogen contained therein, the information for helium also applies to hydrogen.

Accumulation

In connection with leak testing, it is about the enrichment of tracer gas over a definable period of time. This allows the detection of small leak rates without the use of a vacuum chamber. Helium or forming gas can be used.

When you talk about "AQ" in this manual, it's about accumulation mode. It is only available for devices in the AQ version.

Automatic tuning / mass setting

This function adjusts the mass spectrometer so that a maximum leak rate indicator is achieved. In order to detect a maximum ion current with the ion detector, the control computer adjusts the voltage for accelerating the ions within the selected mass range accordingly.

During each calibration, there is an automatic adjusted.

Operation mode

The leak detector distinguishes between the operation modes "vacuum" and "sniffing". With the operation mode "vacuum", generally the tracer gas flows into the test object. The pressure in the test object is less than the ambient pressure.

In the operation mode "sniffing" the tracer gas flows out from the test object and is extracted with a sniffer probe. The pressure in the test object is greater than the ambient pressure.

FINE

FINE denotes the connection to the turbo molecular pump for inlet pressures up to 0.4 mbar. This is also used for the "sniffing" operation mode.

Forming gas

Forming gas is a collective term for gas mixtures of nitrogen and hydrogen.

GROSS

GROSS denotes the connection to the turbo molecular pump with the lowest sensitivity. This allows high inlet pressures (up to 15 mbar).

Internal helium background

The measurement system of the leak detector also contains a residual amount of helium. This creates an internal measurement signal component (background signal), which overlaps the display of the leak right from the beginning and thus disturbs the search for leaks.

So that this background signal can be suppressed, an internal "background suppression" can be activated with the factory settings.

Minimum detectable leak rate

The minimum detectable leak rate which can be detected by the leak detector under ideal conditions ($< 5 \times 10^{-12}$ mbar l/s).

ULTRA

ULTRA denotes the connection to the turbo molecular pump for the measurement range with the highest sensitivity at inlet pressures below 0.4 mbar (adjustable).

Background signal

Helium or hydrogen (as part of water) are natural components of air.

Operation mode "Vacuum": Before any leak detection, a certain amount of the adjusted tracer gas is already in the volume on the surfaces of the test chamber, supply lines, and even in the leak detector itself. This certain amount of tracer gas generates a measurement signal which is called the "Background signal". The ongoing evacuation of the test chamber continuously reduces this background signal.

Operation mode "Sniffing": Ambient air is continuously fed into the leak detector via the sniffer line. The amount of helium or hydrogen occurring naturally in air creates a constant background signal.

Foreline pressure

Pressure of the backing pressure between the turbo molecular pump and the backing pump.

ZERO

There is helium that is weakly bound to the surfaces of a specimen as a natural part of the ambient air and is pumped bit by bit into the measurement system of the leak detector. It produces a slowly decreasing measurement signal.

If you want to hide this background signal or the display of existing leaks, then use the ZERO function.

2 Safety

2.1 Intended use

The device is a modular leak detector for installation in industrial leak testing unit systems. The tracer gases that can be measured with the device are helium and hydrogen (forming gas).

The LDS3000 is suitable for overpressure and negative pressure testing, whereby in addition to the test in vacuum, a local test with a sniffer line is also possible.

The LDS3000 AQ is intended for the measurement of test gases when enriched in an external measuring chamber, but can also be rebuilt for all other purposes.

- ▶ You must install, operate and service the device only in compliance with these operating instructions.
- ▶ Comply with application limits, see "Technical Data".

Improper use

Avoid the following, non-intended uses:

- Use in radioactive areas
- Pumping down of explosive, aggressive, corrosive, flammable, toxic or reactive substances
- Pumping down of condensible fluids and vapors
- Aspiration of liquids into the device
- Operation with excessive gas loads
- Operation with excessive foreline pressure
- Operation at too high ambient temperature
- Flushing with excessive flushing rate
- Usage of the pumps in plants where sudden loads and vibrations or periodic forces act upon the pump

2.2 Owner requirements

The following notes are for companies or any person who is responsible for the safety and effective use of the product by the user, employee or third party.

Safety conscious operation

- Operate the device only if it is in perfect technical condition and has no damage.
- Only operate the device in accordance with this instruction manual, in a safety and risk conscious manner.
- Adhere to the following regulations and observe their compliance:

- Intended use
 - General applicable safety and accident prevention regulations
 - International, national and local standards and guidelines
 - Additional device-related provisions and regulations
- Only use original parts or parts approved by the manufacturer.
- Keep this instruction manual available on site.

Personnel qualifications

- Only instructed personnel should be permitted to work with and on the device. The instructed personnel must have received training on the device.
- Make sure that authorized personnel have read and understood the operating instructions and all other applicable documents.

2.3 Duties of the operator

- Read, observe, and follow the information in this manual and in the work instructions provided by the owner. This concerns in particular the safety and warning instructions.
- Always observe the complete operating instructions for all work.
- If you have any questions about operation or maintenance that are not answered in this manual, please contact Customer Service.

2.4 Dangers

The measuring instrument was built according to the state-of-the-art and the recognized safety regulations. Nevertheless, improper use may result in risk to life and limb on the part of the user or third parties, or damage to the measuring instrument or other property may occur.

Hazards due to liquids and chemicals

Liquids and chemical substances can damage the instrument.

- Comply with application limits, see "Technical Data".
- Do not suck up liquids with the instrument.
- Avoid sniffing gases, such as hydrogen, above the lower explosion limit. The allowable composition of venal gas mixtures can be read in the safety data sheets of the respective manufacturers.
- Only use the device away from areas with a risk of explosions.

Permanent magnets

Permanent magnets in the device pose a hazard to health. Cardiac pacemaker may be affected in their function.

- Keep a sufficient distance from the device.
- Always comply with the distances recommended by the pacemaker manufacturer without fail.

Dangers from electric power

The device is operated with electrical voltages of up to 24 V. Inside the device there are voltages that are considerably higher. There is a danger to life from the contact of conductive parts inside the device.

- Disconnect the device from the power supply prior to any installation and maintenance work. Make sure that the electric power supply cannot reconnected without authorization.
- Before starting the leak test, disconnect electrically operated test objects from the power supply.

The device contains electric components that can be damaged from high electric voltage.

- Make sure before connecting to the power supply that the supply voltage is 24 V +/- 5 %.

Kinetic energy

If the rotating parts in the turbo molecular pump are blocked because of some damage, high centrifugal forces must be absorbed. If this is not successful, the mass spectrometer module will breakaway and possibly cause damage to property or personal injury.

- Make sure the mount of the mass spectrometer module is able to absorb a braking torque of 820 Nm.

Injury from bursting objects

There is risk of injury from bursting objects causes by a test object notwithstanding the vacuum pressure when a test object is connected.

- Take appropriate precautions.

**Danger due to
imploding measuring
chamber**

An external measuring chamber connected to an LDS3000 AQ is pumped off at approximately 60 sccm. Within normal measurement times (2 - 30 seconds) no dangerous negative pressure is generated.

If the measuring chamber is leak-proof, but not vacuum resistant, and continues to pump, it may implode. This can occur, for example, in a 1-liter measuring chamber after about 10 minutes.

- Do not continue pumping a measuring chamber after the measuring time has expired.
- Consider suitable protective measures!

3 Shipment, Transport, Storage

Scope of delivery

Item	Quantity
Mass spectrometer module ¹⁾	1
Plug for 24V connection	1
Pressure sensor PSG500	1
Self-locking nuts	4
Plug for Output	1
Plug for Gauges Exit	1
Inlet module (LDS3000 AQ version only)	1
Adapter DN16 with throttle ²⁾ (LDS3000 AQ version only)	1
Instruction manual	1
USB flash drive with instructions, 3D drawings and videos	1

1.) Includes either 560-300 LDS3000 or 560-600 LDS3000 AQ (accumulation).

2.) See "Select components and connect [► 36]".

► Please check the delivery for completeness after receiving the device.

Transport

NOTICE

Damage due to unsuitable packaging material

Transport in unsuitable packaging material can damage the device.

- Transport the device only in the original packaging material.
- Keep original packaging material.

NOTICE

Damage to property due to missing attachment of the vibration damper

- Secure the vibration damper with the transport screws to prevent damage due to vibration.

Storage

- Always store the device in compliance with the technical data, see "Technical Data".

4 Description

4.1 Function

Objective	<p>The mass spectrometer module is a detection device for the test gases helium and hydrogen. Integrated in test systems, the device is used to detect gas being emitted from a test object in order to indicate leaks.</p> <p>The device can be used both as a vacuum leak detector and a sniffer leak detector. Sniffer lines with different lengths are available for the sniffer mode.</p>
Mode AQ (Accumulation)	<p>In order to be able to detect small leak rates without the use of a vacuum chamber, devices for the AQ mode are connected to an external measuring chamber. In the external measuring chamber, the tracer gas is enriched (accumulation).</p> <p>The test object filled with helium or forming gas under pressure is brought into the measuring chamber or pressurized in the measuring chamber. If there is a leak in the test object, the concentration of helium or forming gas in the measuring chamber will increase. This increase is measured and output as a leak rate.</p>
Device Interfaces	<p>The mass spectrometer module is part of the leak detection system LDS3000 and LDS3000 AQ. Es can be operated in a test system together with a bus module or I/O module and a data cable without additional INFICON accessories.</p> <p>The MSB box outputs data on digital interfaces to the control unit CU1000, I/O module IO1000 or bus module BM1000.</p>
Other accessories	<p>With the available accessories XL sniffer adapter and sniffer line SL3000XL, it is possible to capture leaks at a larger distance from the expected leak if the detection limit is deteriorated (operation in "high flow" mode).</p>

4.2 Device setup

4.2.1 Entire device (LDS3000)

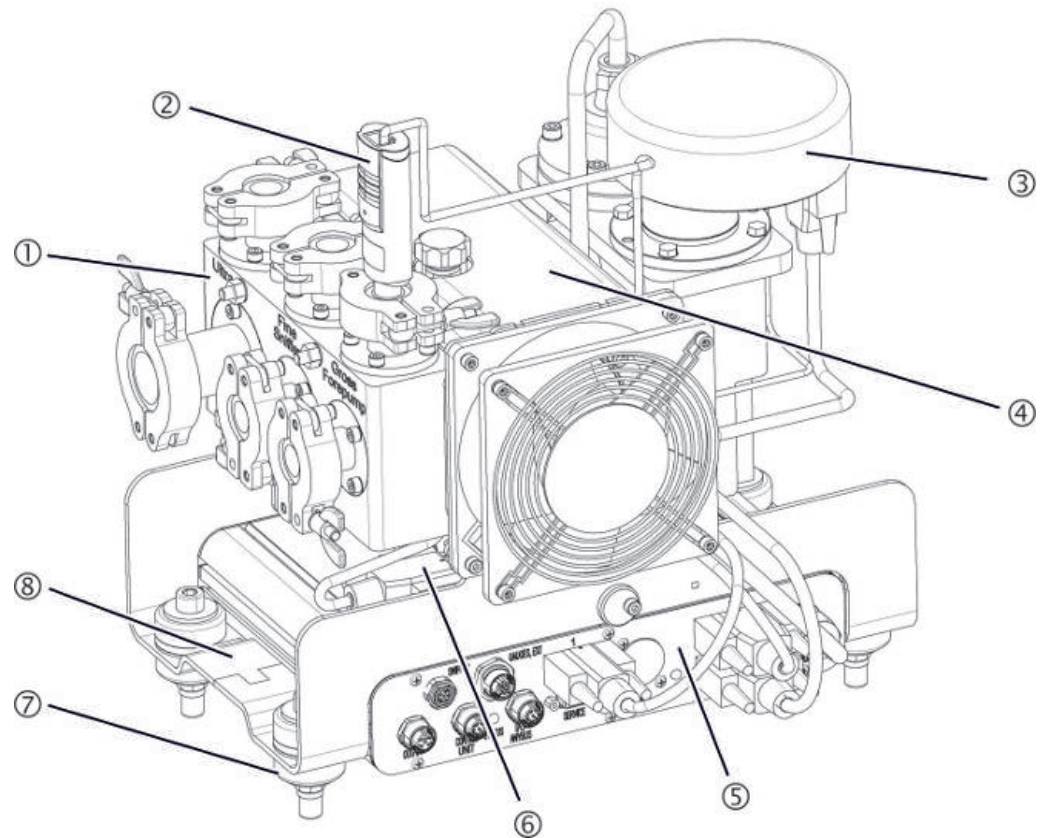

Fig. 1: Mass spectrometer module LDS3000

1	Connection block. Connections for test system, backing pump, pressure sensor PSG500, internal calibration leak and sniffer line, see also "Connection block [22]".
2	Pressure sensor PSG500 for measuring the pressure of the backing pump
3	Preamplifier of the mass spectrometer module
4	Turbo molecular pump with cooling unit
5	MSB box. Interfaces to the mass spectrometer module (see "MSB box [22]")
6	Inverter for turbo-molecular pump
7	Fasteners for installing the mass spectrometer module in a test system
8	Rating plate containing mass spectrometer module specifications

4.2.2 Entire device (LDS3000 AQ)

In the accumulation version, the mass spectrometer module is integrated into a special measurement setup by hardware and software.

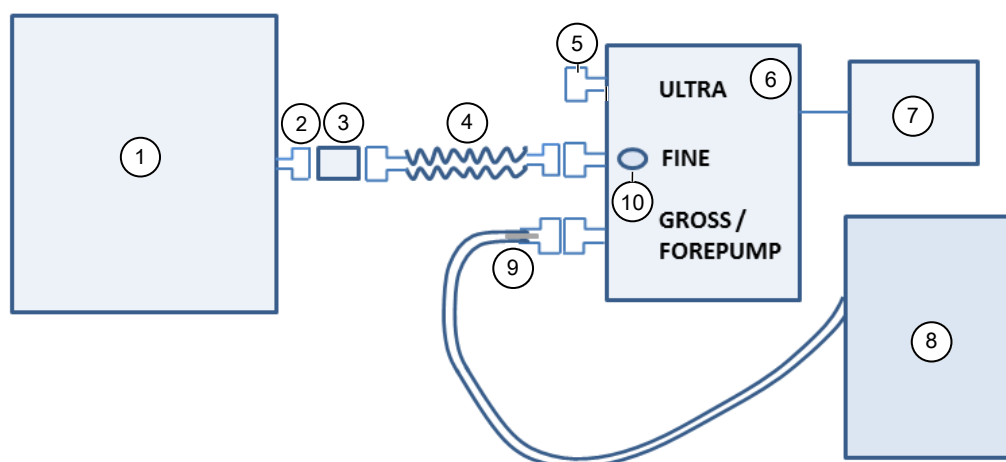

Fig. 2: Accumulation: Overview of the structure

1	Measuring chamber with fan. Not included in delivery.
2	ISO-KF DN16 (Screw-in). Not included in delivery. You can obtain the screw-in via the INFICON homepage under "Vacuum Components".
3	Inlet module
4	Corrugated tube. Not included in delivery. You can obtain the corrugated hose via the INFICON homepage under "Vacuum Components".
5	Blank flange
6	Mass spectrometer module
7	Power supply 24 V
8	Dry backing pump with separate power supply. Not included in delivery. You can order the "Diaphragm pump LDS AQ" from INFICON under the order number 560-630, furthermore the "DIN Rail Power supply 24 V, 10 A" under the order number 560-324.
9	GROSS throttle flange
10	Pressure sensor PSG500 for measuring the inlet pressure
11	Not illustrated: ISO-K centering rings and seals. Not included in delivery. You can get them from INFICON's homepage under "Vacuum Components".

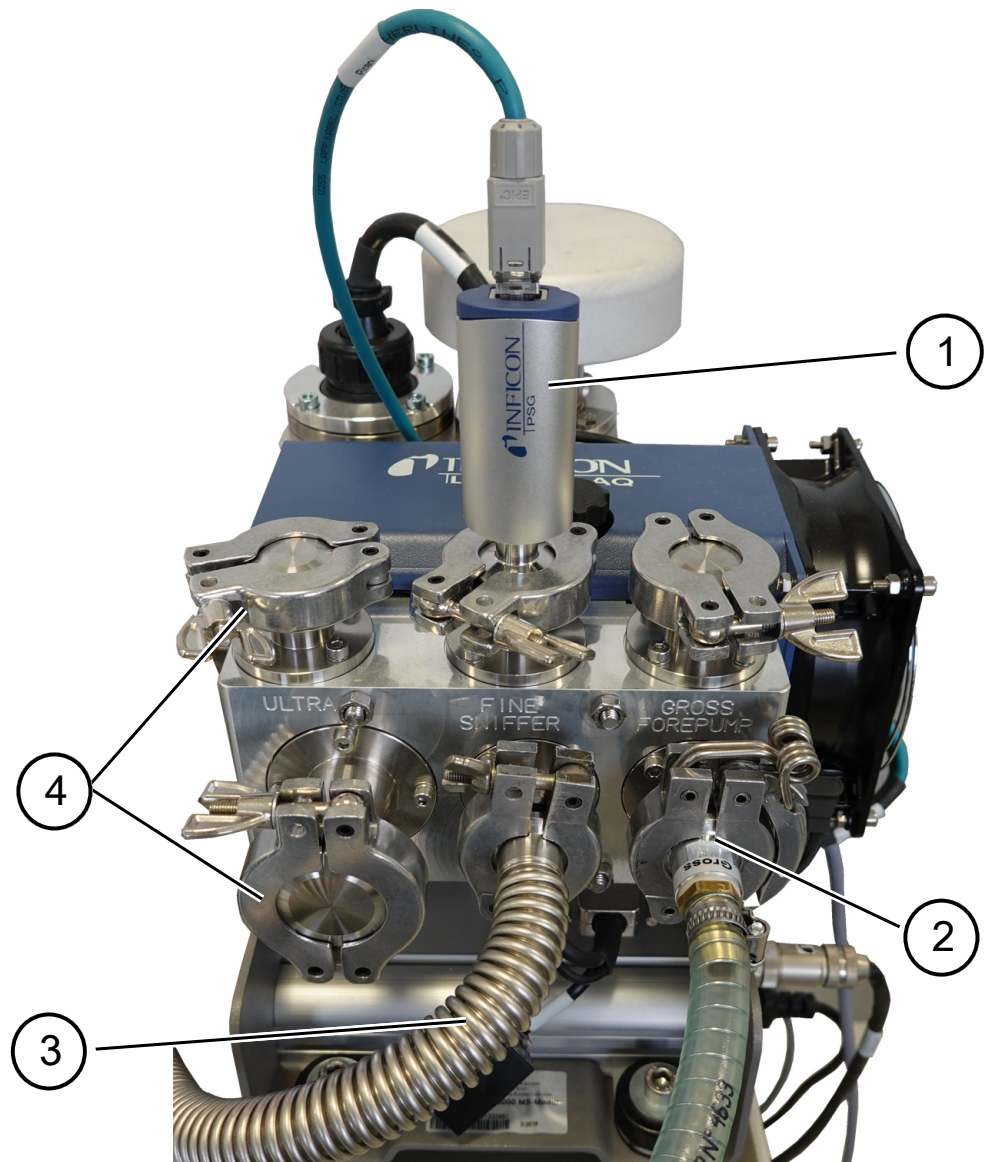

Fig. 3: Mass spectrometer module (execution accumulation)

1	Pressure sensor PSG500 for measuring the inlet pressure
2	GROSS throttle flange with connecting hose to backing pump
3	Corrugated hose to the measuring chamber
4	ULTRA connections blind flanged

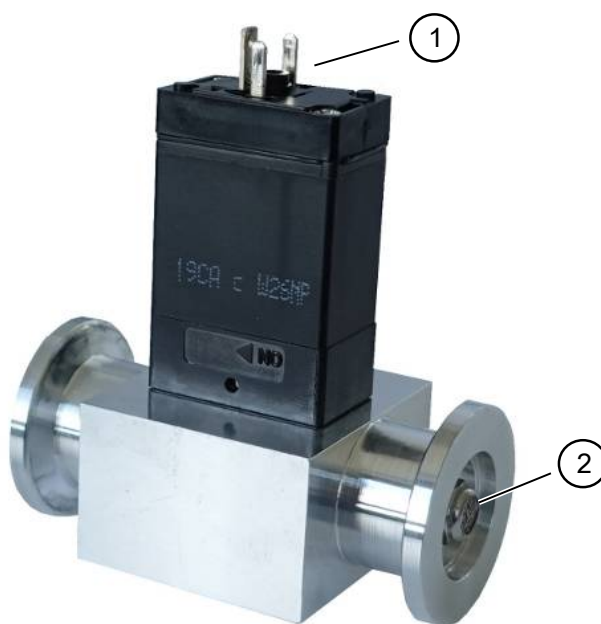

Fig. 4: Inlet module

- | | |
|---|---|
| 1 | Electrical connection for the inlet module. The inlet module does not require an electrical connection for connection to a measuring chamber. When using a two-chamber system, the inlet module valve can be switched by applying 24V. Further information can be obtained from the INFICON Service if required. |
| 2 | Filter. A cleaning of the filter is not provided. Available as a replacement filter from INFICON under the order number 200009701 (10 pieces). Dirty filters replace with a socket wrench, 8 mm. Just unscrew the filter. Do not loosen any more screws. Calibrate after changing the filter.

The inlet module is connected to the measuring chamber with the filter side. |

Accessories of the customer

To complete the measurement setup, missing parts can be provided by the customer. If you want to use your own backing pump, make sure it is a dry backing pump with a gas flow greater than 60 sccm and a base pressure of less than 5 mbar. It should have its own power supply.

If you want to use your own control unit, please note that the wizard for performing the measurement settings, calibrating and setting the ZERO function is only located on the INFICON CU1000 control unit.

See also "Select components and connect [► 36]".

Optional accessories from INFICON

With the exception of the measuring chamber, the required parts are also offered by INFICON.

- Control unit CU1000 (including wizard for carrying out important settings)
- I/O1000 (The I/O module is a device interface between a leak detector and an external controller)

- BM1000 (The bus module is a device interface between e.g. the MSB box of the mass spectrometer module LDS3000 and an external controller.)
- Corrugated hose, available on the homepage of INFICON under "Vacuum components".
- ISO-KF connections (eg screw-in flange), available on the homepage of INFICON under "Vacuum components".
- ISO-K centering rings and seals, available on the homepage of INFICON under "Vacuum components".
- DIN rail power supply 24V, 10A from INFICON (catalog number 560-324) for the dry backing pump of INFICON
- Dry backing pump from INFICON (catalog number 560-630)

Connection for hose ID 10 mm

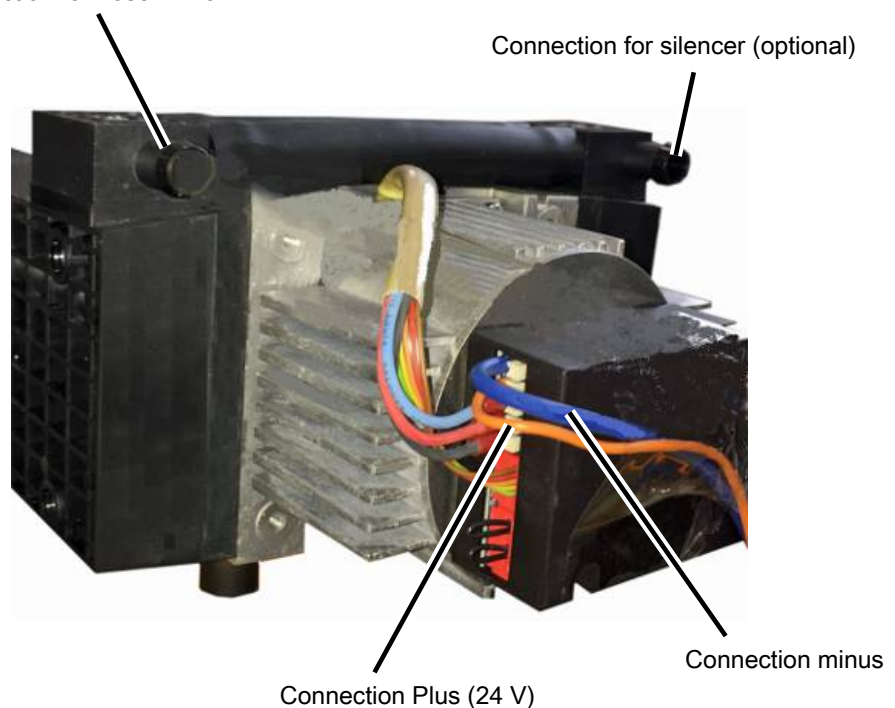

Fig. 5: INFICON backing pump

4.2.3 Connection block

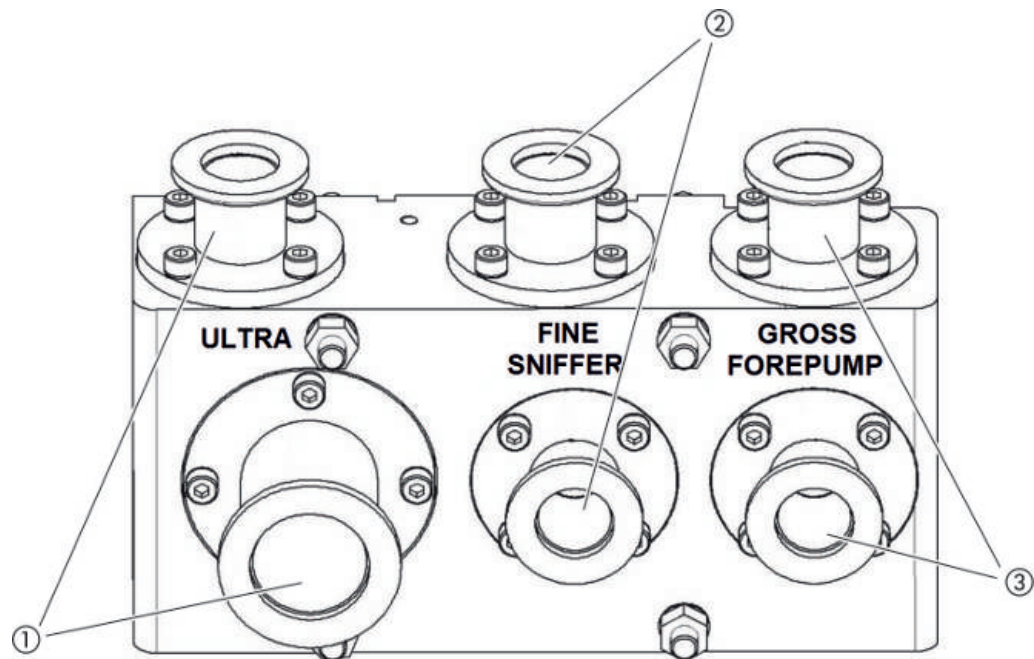

Fig. 6: Connection block

1	Connection ULTRA	3	Connection GROSS/FOREPUMP
2	Connection FINE/SNIFFER		

4.2.4 MSB box

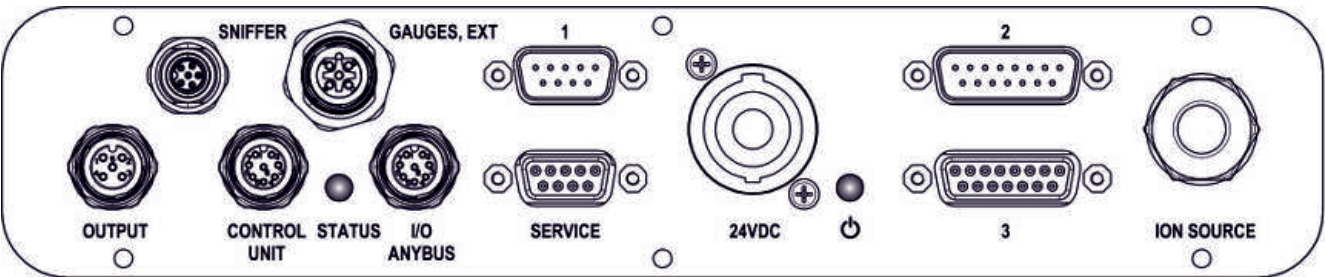

Fig. 7: MSB box connections

OUTPUT

Connection for gas ballast and three valves

Connection plug arrangement	
1	Valve 2 (gas ballast), 24 V, max.1 A
2	Valve 3 (not used, reserve)
3	Valve 4 (not used, reserve)
4	Valve 6 (not used, reserve)
5	GND

SNIFFER

Electrical connection for the sniffer line

GAUGES, EXT

Connection for optional external service gauges (0 - 10 V / 0 - 20 mA) for INFICON service

Connection plug arrangement	
1	+24-V-Output, max. 200 mA
2	Input for P3 service gauge, 0 - 10 V
3	GND
4	Reference to input for P3 service gauge
5	20 mA input for P3 service gauge

1 (See also Figure MSB box)

Connection for pressure sensor PSG500, calibration leak and suppressor on the preamplifier (premounted, three-core cable)

24VDC

Connection for 24 V power supply pack used to supply mass spectrometer module, control unit, I/O module and bus module.

2 (See also Figure MSB box)

Connection for inverter turbo molecular pump and fan turbo molecular pump (premounted, two-core cable)

ION SOURCE

Connection for ion source

3 (See also Figure MSB box)

Connection for preamplifier

Power LED / Status LED

The Power LED and Status LED indicate the status of the device.

Power LED	Status LED	Meaning
Off	Red	Device not ready for operation
Green	Blue	Turbo molecular pump is starting
Green	Orange	Emission is switched on
Green	Green	Emission is stable

Power LED	Status LED	Meaning
Green	Violet	Rotation speed of the turbo molecular pump is not within the normal range
Green	Error codes of the status LED	Different activities of the unit
Green, flashes slowly		Supply voltage < 21.6 V
Green, flashes fast		Supply voltage > 26.4 V
Green, flashes	Off	Software is being updated
Green	Green, flashes	Software is being updated

SERVICE

RS232 connection for INFICON Service

I/O / ANYBUS

CONTROL UNIT

Connection for I/O or bus module or control unit

The connections "I/O Anybus" and "Control Unit" have the same functions. You have the choice of connecting:

- Control unit CU1000 + I/O module IO1000
- Control unit CU1000 + bus module BM1000

STATUS

Status LED

The Power LED and Status LED indicate the status of the unit.

4.2.5 Markings on the device

DANGER

Permanent magnets in the device pose a hazard to health. Cardiac pacemaker may be affected in their function.

- ▶ Keep a sufficient distance from the device.
- ▶ Always comply with the distances recommended by the pacemaker manufacturer without fail.



Device cannot be scrapped with the normal domestic waste.

4.3 Technical data

Mechanical data

Electrical data

	560-300, 560-600
Power input	max. 10 A

Physical data

	560-300, 560-600
Response time in Sniffer mode	Gross: < 5 s, Fine/Ultra: < 1 s
Maximum inlet pressure	0,2 mbar - 18 mbar
Run-up time	150 s
Detectable gases	Helium, hydrogen
Minimum detectable leak rate vacuum mode	5E-12 mbar l/s
Minimum detectable leak rate sniffer mode	1E-7 mbar l/s
Detectable masses	4He, H2, mass 3 (e.g. H-D, 3He or H3)
Ion source	2 longlife Iridium filaments, Yttrium-oxide coated

	560-600 (AQ mode)
Minimum detectable leak rate forming gas or helium	1×10^{-7} mbar l/s
Measurement range	6 decades
Pressure in test chamber	1 atm
Time constant of the leak rate signal	< 1 s

Ambient conditions

	560-300, 560-600
Permissible ambient temperature (during operation)	10 °C ... 45 °C
Max. altitude above sea level	2000 m
Permissible magnetic field max.	7 mT
Max. relative humidity above 40 °C	50%
Max. relative humidity from 31 °C to 40 °C	80% ... 50% (decreasing linearly)
Max. relative humidity to 40 °C	80%
Storage temperature	-20 °C ... 60 °C
Pollution degree	II

4.4 Factory settings

Parameter	Factory setting
AO upper limit exp.	1×10^{-5}
Operation mode	Vacuum AQ ¹⁾
AQ chamber volume	1 l ¹⁾
AQ measurement time	10 s ¹⁾
Zero time factor AQ	4 ¹⁾
Bus module address	126
Clogged pressure capillary monitoring - with XL Sniffer Adapter (low flow)	0.4 mbar 0.2 mbar
Broken pressure capillary monitoring - with XL Sniffer Adapter (low flow)	2 mbar 0.6 mbar
Clogged pressure capillary monitoring - with XL Sniffer Adapter (High Flow)	150 mbar
Broken pressure capillary monitoring - with XL Sniffer Adapter (High Flow)	400 mbar

Parameter	Factory setting
Pressure unit (interface)	mbar
Emission	On
Filter leak rate threshold	1×10^{-10}
Filter ZERO time	5 s
Filter mode	I•CAL
Gas percentage in H ₂ (M3, He)	100 % 5 % H ₂ (-, 100 % He) ¹⁾
Gas ballast	Off
I/O module log	ASCII
Calibration request	On
Calibration factor VAC/SNIF Mx (for vacuum, sniffing and all masses)	1.0
Cathode selection	Auto Cat1
Compatibility mode	LDS3000 AQ ¹⁾
Config. Analog output 1	Leak rate mantissa
Config. Analog output 2	Leak rate exponent
Config. Analog output scaling	0.5 V / decade
Configuration of digital outputs	Pin 1: Trigger 1, inverted Pin 2: Trigger 2, inverted Pin 3: Trigger 3, inverted Pin 4: Trigger 4, inverted Pin 5: Ready Pin 6: Error, inverted Pin 7: CAL request, inverted Pin 8: Open, inverted
Configuration of digital Inputs	Pin 1: Select dyn. / normal CAL Pin 2: Sniff Pin 3: Start/Stop, inverted Pin 4: ZERO Pin 5: External CAL Pin 6: Internal CAL Pin 7: Clear Pin 8: ZERO update Pin 9: – Pin 10: –
Leak rate unit SNIF, (display and interface)	mbar l/s

Parameter	Factory setting
Leak rate unit VAC, (display and interface)	mbar l/s
Leak rate upper limit VAC (interface)	1.0×10^{-1}
Leak rate lower limit VAC (interface)	1.0×10^{-12}
Leak rate upper limit SNIF (interface)	1.0×10^{-1}
Leak rate lower limit SNIF (interface)	1.0×10^{-8}
Fan mode	Fan always on
Machine factor in standby	Off
Machine factor / Sniff factor	1.0 (for all masses)
Mass	4
Module on the I/O connection	IO1000
Nominal state TMP	On
calibration leak external SNIF	9.9×10^{-2}
calibration leak external VAC	9.9×10^{-2}
calibration leak internal	9.9×10^{-2}
Open calibration leak internal	Off
Sniffer line detection	On
Sniffer key ZERO	On
Language	English
TMP rotation speed	1500 1000 ¹⁾
Trigger level 1 (2, 3, 4)	1×10^{-5} mbar l/s 5×10^{-5} (1×10^{-5}) mbar l/s ¹⁾
Preamplifier test at CAL	On
Maintenance warning	Off
ZERO with start	Off
ZERO mode	Suppress everything

1) in AQ mode

5 Mounting LDS3000

5.1 Adjust the position of the connections to the installation dimensions

Select location

Select the most helium-free environment possible for the measurement setup. For reliable measurements with the device, the helium content in the air must be less than 10 ppm.

By nature, air contains 5 ppm (0.0005%) helium.

Mount MSB box

In order to ideally match the installation position space, the MSB box can be turned and rotated.

The MSB box is seated in two guide rails and can be pushed into the housing from the left or from the right. It can also be rotated, if necessary, so that the labels are upside down.

The locking washer must be released to pull out the MSB box.

If the MSB box is to be pushed into housing from the other side, the locking washer must also be tightened on the other side of the housing. An appropriate threaded hole is available.

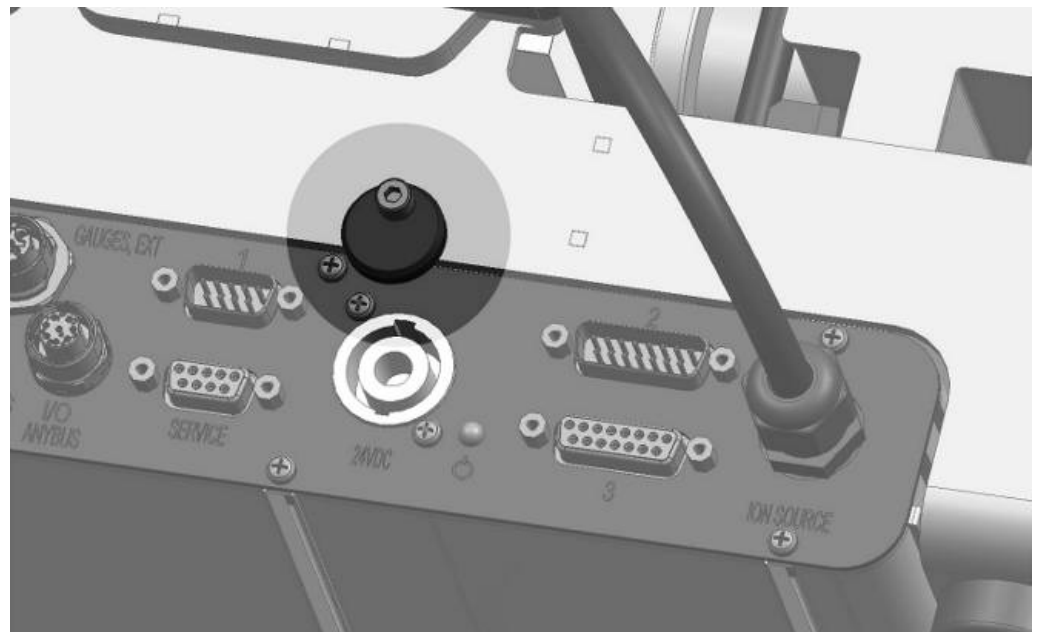

Fig. 8: Lock

5.2 Installing the mass spectrometer module on the test system

The mass spectrometer module can be mounted in any position.

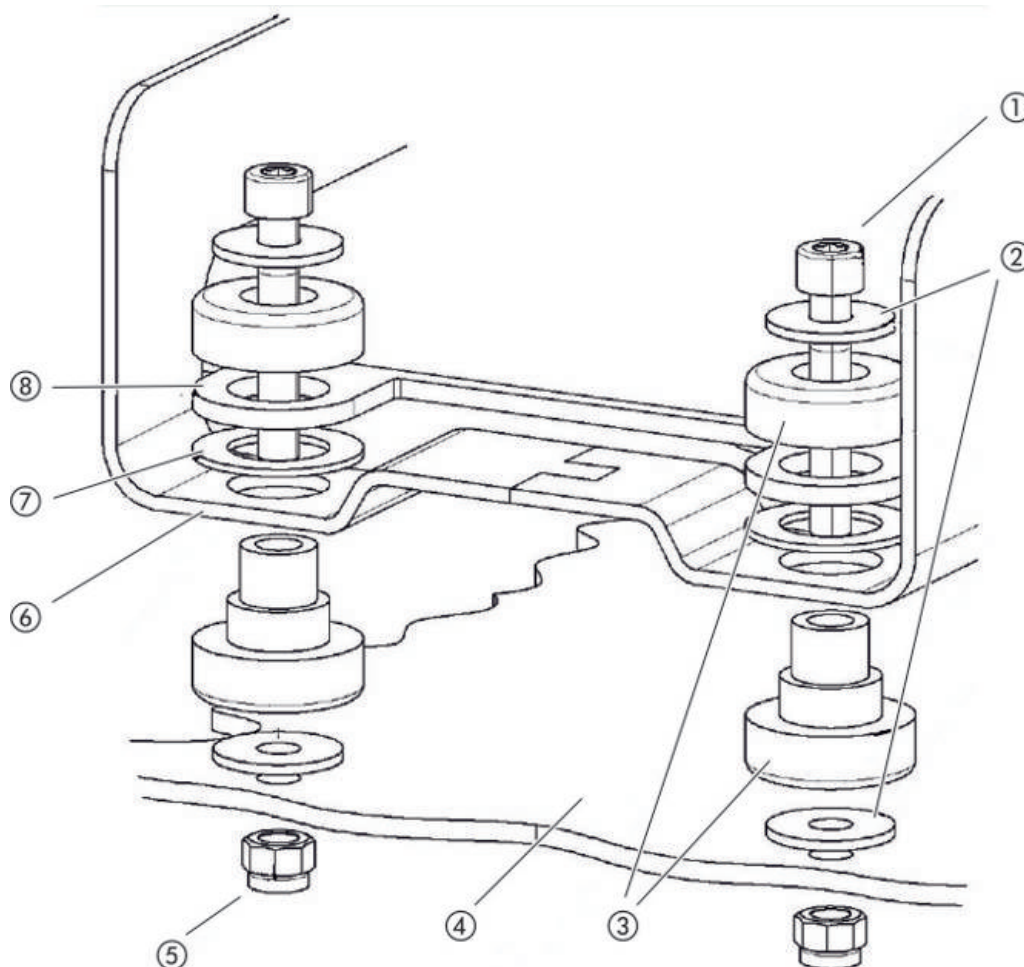

Fig. 9: Components of a fastener

1	Hexagon socket head screw M8 x 50	5	Nut M8 (self-locking)
2	Washer	6	Base frame
3	MO bearing	7	Spring rubber
4	Test system	8	MSB box guide

You will need:

- Self-locking nuts M8
- Open-end wrench, SW13
- Allen wrench SW6
- Holes for installation inside the test system

In delivery condition, the bearings are attached to the base frame with the hexagon socket screws and transport nuts. Use the supplied self-locking nuts for the installation of the mass spectrometer module – not the transport nuts.



The background must be stable.

WARNING

Severe injuries due to mass spectrometer module breaking out

If not screwed down properly, the mass spectrometer module can be caused to break out if the rotor of the turbo molecular pump suddenly locks up. This can result in injuries of the most severe kind.

- ▶ Make sure the mount of the mass spectrometer module is able to absorb a braking torque of 820 Nm.

- 1 Drill through-holes:
 - X distance: 283 mm
 - Y-distance: 121,5 mm
 - Through hole in sheet: Ø 9 mm
 - Fixing screws: M8 x 50
- 2 Remove transport nuts.
- 3 Place the mass spectrometer module on top of the through-holes and screw it down using the fasteners as shown in the upper figure .

5.3 Select connection ULTRA, FINE, or GROSS

The operation mode of the vacuum connection and the rotation speed of the turbo molecular pump define:

- Minimum detectable leak rate (MDLR)
- Constantly permissible inlet pressure (p_{\max})
- Pumping speed (S)

The following information applies to the use of helium as a tracer gas.

To reach the MDLR, the following conditions must be met:

- The LDS3000 must be in operation for at least 20 minutes.
- Ambient conditions must be steady (temperature, no vibrations/shocks, clean environment)
- The specimen must be operated with switched-off ZERO until to the background is stable. The ZERO function may be switched on only after that.

Connection		Turbo molecular pump rotation speed	
		1000 Hz	1500 Hz
ULTRA	MDLR:	5×10^{-12} mbar l/s	1×10^{-11} mbar l/s
	p_{\max} :	0.2 mbar	0.2 mbar
	p_{\max} short-term (< 3 s):	0.2 mbar	0.4 mbar
	S:	5 l/s	6 l/s
FINE	MDLR:	1×10^{-11} mbar l/s	5×10^{-11} mbar l/s
	p_{\max} :	0.9 mbar	0.4 mbar
	p_{\max} short-term (< 3 s):	0.9 mbar	0.7 mbar
	S:	1.8 l/s	2.5 l/s
GROSS	MDLR:	1×10^{-9} mbar l/s	2×10^{-8} mbar l/s
	p_{\max} :	18 mbar	15 mbar
	S:	depends on the backing pump	

Exceedance of the constantly permissible inlet pressure generates the warning "TMP overheating".

NOTICE

Material damage due to pressure surges

Pressure surges exceeding the maximum inlet pressure will damage the mass spectrometer module.

- Do not exceed the maximum inlet pressure.

- 1 Set the operation mode vacuum connection and the rotation speed turbo molecular pump in accordance with the physical vacuum conditions found in the test system.
- 2 Connect the mass spectrometer module to the "ULTRA", "FINE" or "GROSS" connections on the vacuum system of the test system.
- 3 Set the rotation speed of the turbo molecular pump.

5.4 Establish component connection

- 1 Connect pressure sensor PSG500 to one of the GROSS/FOREPUMP connections.
- 2 Connect the backing pump to the second GROSS/FOREPUMP connection.
- 3 For sniffer mode, connect the sniffer line to one of the FINE-/SNIFFER connections.
- 4 If available, connect internal calibration leak 560-323 to the second free flange (FINE or ULTRA) of the vacuum connection.

When using a sniffer valve: For the device to operate correctly upon opening of the sniffer valve, no additional line can be connected between the connection block and the sniffer valve or between the sniffer valve and the sniffer line.

5.5 Establish electrical connections

All electrical connections run from and to the MSB box.

NOTICE

Material damage if power supply pack has the wrong specifications or is connected improperly

A power supply pack that has the wrong specifications or is connected improperly can destroy the unit.

- Use a suitable power supply pack: Use a power supply pack that supplies an output voltage with electrically protective separation, output voltage: 24 V +/- 5%, current capacity: min. 8 A
- If the short-circuit current of the power supply pack is > 10 A, connect a fuse between power supply pack and mass spectrometer module.
- Use a power cable with a large enough cross section.

- 1** Connect the 24 V power cable to the included plug (connections: +24 V on 1+ and GND on 1-).
- 2** Connect the power cable to the socket "24VDC".
- 3** Connect the control unit to the socket "Control Unit".
- 4** Connect the I/O or bus module to the Socket "I/O" .
- 5** Connect pressure sensor PSG500 and, if used, calibration leak 560-323 on the cable of socket "1". For socket 1 see "MSB box [► 22]".
- 6** Connect the sniffer line to the socket "Sniffer" .
- 7** Connect gas ballast valve to the socket "Output".

6 Mounting LDS3000 AQ (Accumulation)

6.1 Adjust the position of the connections to the installation dimensions

Select location

Select the most helium-free environment possible for the measurement setup. For reliable measurements with the device, the helium content in the air must be less than 10 ppm.

By nature, air contains 5 ppm (0.0005%) helium.

Mount MSB box

In order to ideally match the installation position space, the MSB box can be turned and rotated.

The MSB box is seated in two guide rails and can be pushed into the housing from the left or from the right. It can also be rotated, if necessary, so that the labels are upside down.

The locking washer must be released to pull out the MSB box.

If the MSB box is to be pushed into housing from the other side, the locking washer must also be tightened on the other side of the housing. An appropriate threaded hole is available.

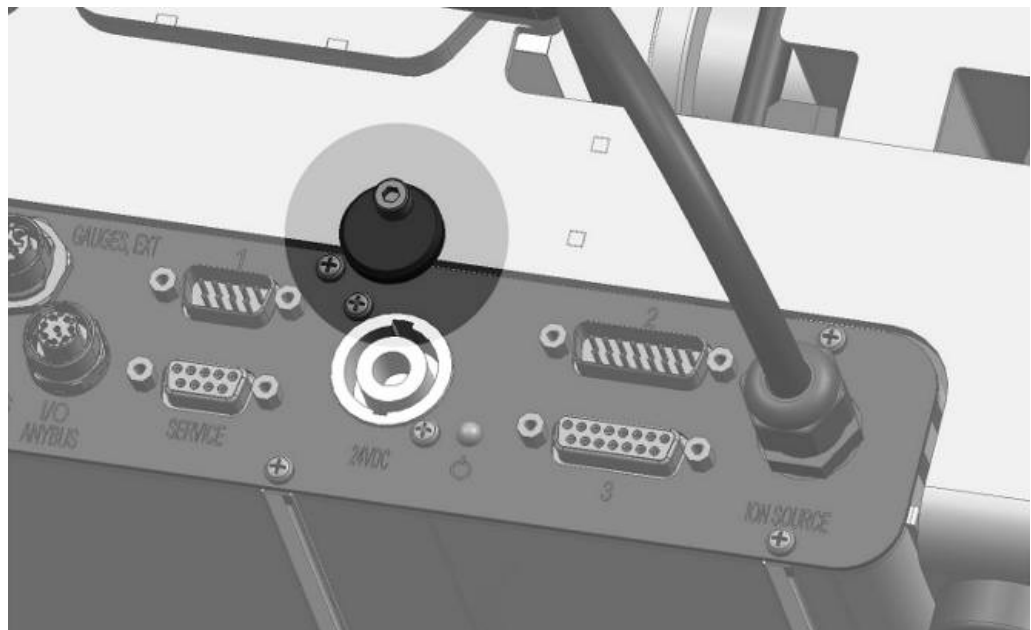

Fig. 10: Lock

6.2 Installing the mass spectrometer module on the test system

The mass spectrometer module can be mounted in any position.

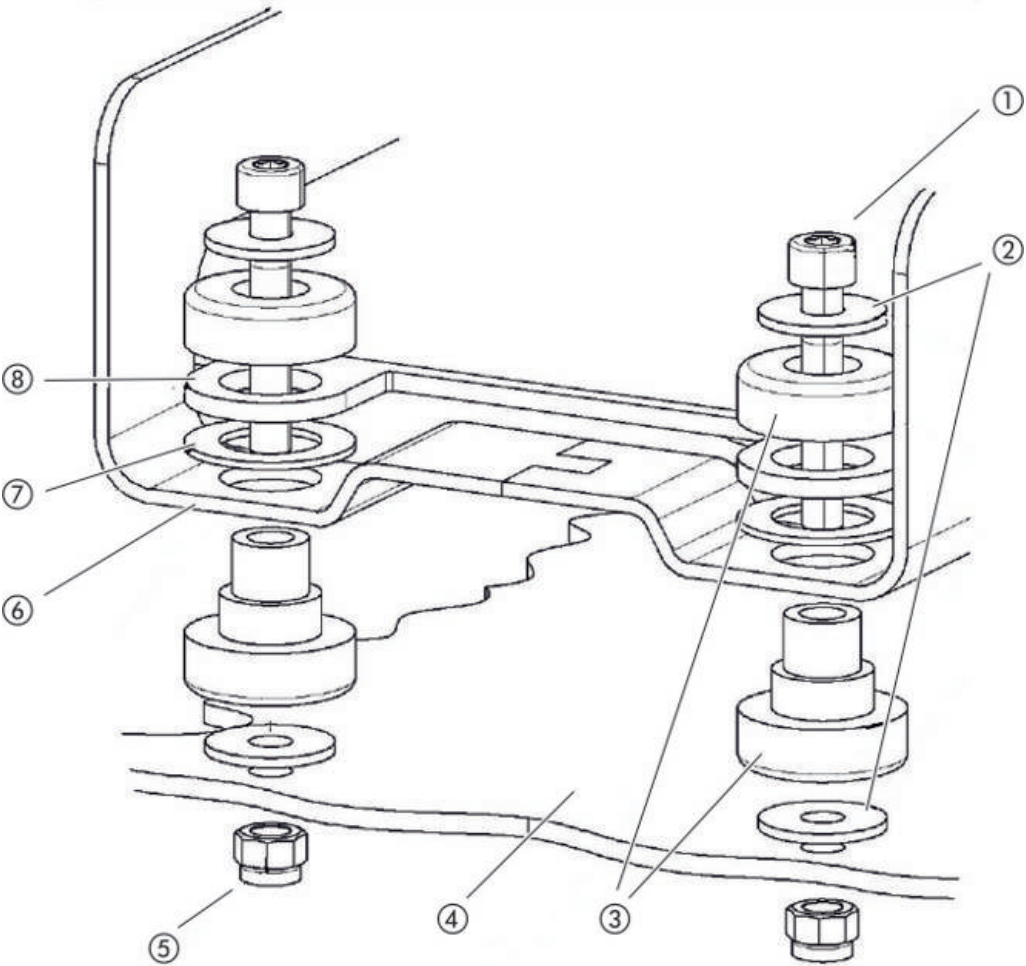

Fig. 11: Components of a fastener

1	Hexagon socket head screw M8 x 50	5	Nut M8 (self-locking)
2	Washer	6	Base frame
3	MO bearing	7	Spring rubber
4	Test system	8	MSB box guide

You will need:

- Self-locking nuts M8
- Open-end wrench, SW13
- Allen wrench SW6
- Holes for installation inside the test system

In delivery condition, the bearings are attached to the base frame with the hexagon socket screws and transport nuts. Use the supplied self-locking nuts for the installation of the mass spectrometer module – not the transport nuts.



The background must be stable.

WARNING

Severe injuries due to mass spectrometer module breaking out

If not screwed down properly, the mass spectrometer module can be caused to break out if the rotor of the turbo molecular pump suddenly locks up. This can result in injuries of the most severe kind.

- Make sure the mount of the mass spectrometer module is able to absorb a braking torque of 820 Nm.

- 1 Drill through-holes:
 - X distance: 283 mm
 - Y-distance: 121,5 mm
 - Through hole in sheet: Ø 9 mm
 - Fixing screws: M8 x 50
- 2 Remove transport nuts.
- 3 Place the mass spectrometer module on top of the through-holes and screw it down using the fasteners as shown in the upper figure .

6.3 Select components and connect

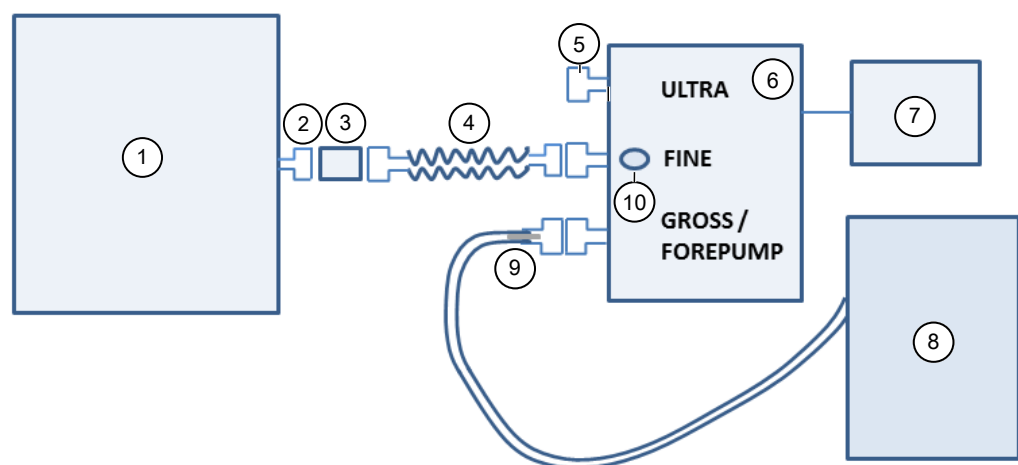

Fig. 12: Accumulation: Overview of the structure

1	Measuring chamber with fan. Not included in delivery.
---	---

2	ISO-KF DN16 (Screw-in). You can obtain the screw-in via the INFICON homepage under "Vacuum Components".
3	Inlet module
4	Corrugated tube. Not included in delivery. You can obtain the corrugated hose via the INFICON homepage under "Vacuum Components".
5	Blank flange
6	Mass spectrometer module
7	Power supply 24 V
8	Dry backing pump with separate power supply. Not included in delivery. You can order the "Diaphragm pump LDS AQ" from INFICON under the order number 560-630, furthermore the "DIN Rail Power supply 24 V, 10 A" under the order number 560-324.
9	GROSS throttle flange
10	Pressure sensor PSG500 for measuring the inlet pressure
11	Not illustrated: ISO-K centering rings and seals. Not included in delivery. You can get them from INFICON's homepage under "Vacuum Components".

- ✓ You have the INFICON mass spectrometer module (accumulation), a corrugated tube and the connections shown.
 - ✓ You have a dry backing pump with its own power supply.
All dry vacuum pumps can be used with a gas flow of more than 60 sccm at a basic pressure of under 5 mbar. This manual describes how to use the dry INFICON backing pump (catalog number 560-630).
 - ✓ You have a suitable measuring chamber.
Information about the measuring chamber can be obtained from INFICON.
Note that a measuring chamber that is leak-proof but not vacuum-resistant can implode if it is pumped further out than usual measuring times. See also "Carrying out a measurement [► 82]".
- 1 Connect the pressure sensor PSG500 to the FINE connector.
 - 2 Connect a corrugated tube to the FINE port on the mass spectrometer module.
 - 3 Connect the open end of the corrugated tube to the measuring chamber via the inlet module.
 - 4 Install the GROSS throttle flange at the GROSS / FOREPUMP port of the mass spectrometer module.
 - 5 Connect the open end of the GROSS throttle flange hose to the backing pump.
 - 6 Establish the electrical connection of the backing pump.
When using the INFICON backing pump (catalog number 560-630), proceed as follows:
 - ⇒ Determine if the plus and minus terminals on the terminal block are already connected to cables by the manufacturer.

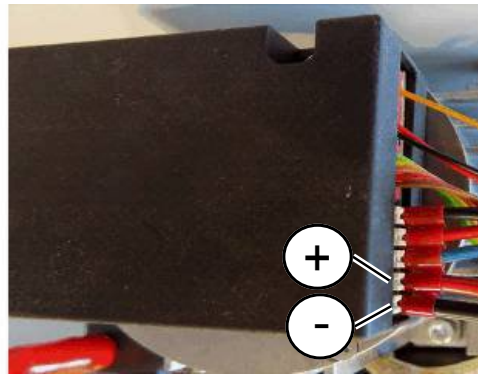

Fig. 13: Connection strip on the dry backing pump of INFICON

- ⇒ If so, connect plus and minus cables to a DC power source, 24 V +/- 10%, 5 A.
- ⇒ If not, insert the positive and negative cables with ferrules 8 mm AWG 18 with red insulation into the corresponding terminals and then connect the cables to a DC power source, 24 V +/- 10 %, 5 A.



The backing pump exhaust air opening should be as far as possible from the test chamber.

See also

📄 Entire device (LDS3000 AQ) [► 18]

6.4 Establish electrical connections

All electrical connections run from and to the MSB box.

NOTICE

Material damage if power supply pack has the wrong specifications or is connected improperly

A power supply pack that has the wrong specifications or is connected improperly can destroy the unit.

- Use a suitable power supply pack: Use a power supply pack that supplies an output voltage with electrically protective separation, output voltage: 24 V +/- 5%, current capacity: min. 8 A
- If the short-circuit current of the power supply pack is > 10 A, connect a fuse between power supply pack and mass spectrometer module.
- Use a power cable with a large enough cross section.

- 1** Mount the 24 V power supply cable to the enclosed plug (connections: +24 V on 1+ and GND on 1-).
- 2** Connect the power supply cable to the "24VDC" socket.
- 3** Connect the operating unit to the "Control Unit" socket.
- 4** Connect the I/O or bus module to the "I/O" socket.
- 5** Connect the pressure sensor PSG500 to the cable of socket 1. For socket 1 see "MSB box [► 22]" .

7 Operation LDS3000

You can use the following accessories in combination with the mass spectrometer module:

- Control unit CU1000
- Bus module BM1000
- I/O module IO1000



With the available accessories XL sniffer adapter and sniffer line SL3000XL, it is possible to capture leaks at a larger distance from the expected leak if the detection limit is deteriorated (operation in "high flow" mode).

LDS3000 AQ devices can also be used if they are not operated in AQ mode.

Additional information on the control unit, the modules and the XL sniffer adapter is included in the documents:

- Operating Manual Control Unit CU1000
- Operating instructions I/O module IO1000
- Operating instructions bus module BM1000
- Operating instructions XL sniffer adapter
- Interface protocols LDS3000

The paths listed in the following sections refer to the operation of the mass spectrometer module with the control unit CU1000. If the bus module or the I/O module is used, the actions must be implemented within the scope of the protocol that is used.

The path information for the control unit always starts in the main menu.

WARNING

Danger to life and material damage due to unsuitable operating conditions

There is danger to life due to unsuitable operating conditions. The device can become damaged.

- ▶ Avoid changing the position of the device in an abrupt manner.
- ▶ Avoid extreme external vibrations and impact.

7.1 Switching the device on

- 1 Switch on the backing pump.
 - 2 Establish the power supply to the mass spectrometer module.
- ⇒ System starts up automatically.

- ⇒ If an XL Sniffer Adapter and the CU1000 are connected, you will be asked after run-up, whether the "XL Sniffer Adapter" operation mode should be set. This does not apply to devices in AQ mode.



Longer run-up time for devices in AQ mode

To counteract falsification of the measurement results by an increased background value, the warm-up time after switching on is about 10 minutes.

Wait at least 60 minutes before determining the peak or before calibrating.

See also "Carrying out a measurement [► 82]".

7.2 Default settings

Language selection

Select the display language. The factory setting is English. (The display on the handle of the SL3000XL sniffer line shows messages in English instead of in Russian and Chinese.)

German, English, French, Italian, Spanish, Portuguese, Russian, Chinese, Japanese

Control unit	Settings > Set up > Control unit > Language
LD protocol	Command 398
ASCII protocol	*CONFig:LANG

Setting date and time

Setting the date

Format: DD.MM.YY

Control unit	Settings > Date/Time > Date
LD protocol	Command 450
ASCII protocol	*HOUR:DATE

Setting the time

Format: hh: mm

Control unit	Settings > Date/Time > Time
LD protocol	Command 450
ASCII protocol	*HOUR:TIME

7.3 Selecting a unit for the leak rate

Leak rate unit display

Selecting the leak rate unit in the display for vacuum or sniff	
0	mbar l/s (factory setting)
1	Pa m ³ /s
2	atm cc/s
3	Torr l/s
4	ppm (not VAC, not AQ)
5	g/a (not VAC, not AQ)
6	oz/yr (not VAC, not AQ)
7	sccm (AQ only)
Control unit	Display > Units (display) > Leak rate device VAC (SNIF)
LD protocol	Command 396 (vacuum)
	Command 396 (sniffing)
ASCII protocol	Command *CONFig:UNIT:VACDisplay
	Command *CONFig:UNIT:SNDisplay

Leak rate unit interface

Selecting the leak rate unit of the interfaces for vacuum or sniff	
0	mbar l/s (factory setting)
1	Pa m ³ /s
2	atm cc/s
3	Torr l/s
4	ppm (not VAC)
5	g/a (not VAC)
6	oz/yr (not VAC)
7	sccm (AQ only)
Control unit	Settings > Set up > Interfaces > Units (interface) > Leak rate device VAC (SNIF)
LD protocol	Command 431 (vacuum)
	Command 432 (sniffing)
ASCII protocol	Command *CONFig:UNIT:LRVac
	Command *CONFig:UNIT:LRSnif

7.4 Select device for pressure

Pressure unit interface

Selecting the pressure device of the interfaces	
0	mbar (factory setting)
1	Pa
2	atm
3	Torr
Control unit	Settings > Set up > Interfaces > Units (interface) > Pressure unit
LD protocol	Command 430 (Vacuum/Sniff)
ASCII protocol	Command *CONFig:UNIT:Pressure

7.5 Select Compatibility Mode

To retrofit an existing leak detection system LDS1000 / LDS2010 with a LDS3000, activate the appropriate compatibility mode:

- Compatibility mode for LDS1000 or
- Compatibility mode for LDS2010

When changing to a compatibility mode all parameters are to be reset to factory settings and the device is to be restarted. The language is displayed according to the factory setting. To change the language, see "Default settings [► 41]".

If you want to use the LDS3000 later in normal operation mode, make sure to save your parameters on a USB flash drive, see "Loading and saving parameters [► 59]". You can load the saved parameters again after you have switched to normal operation.

Compatibility mode for LDS1000

Compatibility mode for LDS2010

Mode LDS3000

Mode XL Sniffer Adapter

Mode AQ (This mode is only available for AQ devices. It is preset for AQ devices. Switching to other modes is possible.)

Control unit	Settings > Set up > Compatibility > Compatibility mode
LD protocol	Command 2594 (dec)
ASCII protocol	Command *CONFig:COMP

The following table shows the functional differences between and common features of LDS2010 and LDS3000:

	LDS2010	LDS3000
Trigger outputs	without joint reference	with joint reference
other outputs	with joint reference	with joint reference
Trigger 1 (sniffer LED, relay exit, audio signal)	Control of sniffer LED, PWM audio outputs an the control unit for active speakers	Control of sniffer LED, audio outputs an the control unit for active speakers
Limit Low / High (serial interfaces, display, analogue output)	Limit Low affects all outputs, Limit High only the display	separately adjustable for interface protocols, display and analog outputs
Gas ballast (3 settings)	<p>OFF: Switches the gas ballast valve of the pump module off.</p> <p>ON: Switches the gas ballast valve of the pump module on until the next mains-off.</p> <p>If "CAL fashion" is unequal to 3 (menu item 26), the gas ballast valve can be controlled with digital input DynCAL.</p> <p>F-ON: Fixed on enables switching the gas ballast valve on permanently (power failure-proof and independent of the digital inputs).</p>	<p>0 = Off</p> <p>1 = on, but controllable via digital input on IO1000</p> <p>2 = on, but not controllable via digital input on IO1000</p>
Control mode	LOCAL, RS232, RS485	None, control is also possible from all control locations.
LDS1000 compatibility mode 9.2	other functions	Default values and error messages (default values are output via interface, the touchscreen shows the original message - -> reason: new hardware can cause errors that did not exist with previous models)
Correcting the leak rate in Standby (machine factor)	adjustable (yes/no)	adjustable (yes/no)
ZERO with start		starting with V1.02 like LDS2010
Opening the sniffer valve	in SNIF after start	in SNIF after start
Rotation speed of turbo molecular pump	only 2 rotation speeds adjustable	Adjustable via serial interface from 750 Hz to 1500 Hz, via operator unit 1000 Hz and 1500 Hz
Address RS485	Yes, because bus capable	No, because not bus capable
Sniffer key on/off	selectable	selectable

	LDS2010	LDS3000
Default value for int. calibration leak	1E-15 mbar l/s	9.9E2 mbar l/s
Default value ext. calibration leak VAC/SNIF mode	1E-7 mbar l/s	9.9E2 mbar l/s
Setting range for int. calibration leak	10E-7	1E-9 ... 9.9E-1 mbar l/s
Machine factor adjustment	manually	manually/automatically
Machine / sniff factor value range	Machine factor: 1E-3...9.9E+3 Sniffer factor: 1E-3...9.9E+3	Machine factor: 1E-4...1E+5 Sniffer factor: 1E-4...1E+4
Pressure: Capillary surveillance 20		available, pressure adjustable
Analog output	fixed characteristics	freely configurable
Calibration request	Preamplifier temperature change 5 K or 30 min	Preamplifier temperature change 5 K or 30 min. or TMP rotation speed changed
Pressure / leak rates units (VAC/ SNIF) for all interfaces	yes	Control unit and rest separated
User permissions	3 levels over PIN on the control unit or key switch	4 levels through control unit or optional key switch
Key-operated switch	permanently installed	can, if required, be connected externally, see "Assigning the digital inputs of the I/O module [► 95]" (Key switch)

7.6 Select operation mode

The device has the following operation modes:

- Vacuum mode
- Sniffer mode
- XL Sniffer Adapter (sniffing mode with a high flow rate, XL Sniffer Adapter required).

The device automatically switches over to the "XL Sniffer Adapter" if you connect an XL Sniffer Adapter.



The LDS3000 AQ is preset to "AQ".

- If necessary, you can reset "AQ" under "Compatibility Mode".

Select operation mode

0	VAC (vacuum)
1	SNIF (sniffing)
2	Operation mode XL Sniffer Adapter
Control unit	Operation mode vacuum operation or sniffing mode: Main menu > Features > VAC / SNIF Operation mode XL Sniffer Adapter: Settings > Set up > Accessories > XL Sniffer Adapter
LD protocol	Command 401
ASCII protocol	Command *CONFig:MODE

7.7 Select gas type (mass)

The machine, calibration and sniff factor are dependent on the configured mass and are saved in the mass spectrometer module.

2	H ₂ (Hydrogen, forming gas)
3	³ He or deuterated hydrogen (HD), not in AQ mode
4	⁴ He (Helium) (factory setting)
Control unit	Settings > Mass
LD protocol	Command 506 with value 2 (3, 4)
ASCII protocol	Command *CONFig:MASS 2 (3, 4)



For devices with AQ mode: The easiest way to change the gas type is via the wizard.

7.8 Calibrating the device

7.8.1 Time and general preferences

NOTICE

Incorrect calibration because of operating temperature that is too low

Calibrating the device in the cold state can deliver incorrect measurement results.

► For optimum accuracy the device should have been turned on at least 20 minutes previously.

It is recommended to calibrate the device once per shift in the desired operating modes and for the desired gases. Thereafter you can switch between the operation modes and gases without re-calibrating.

Additionally applicable for operation with the XL Sniffer Adapter:

The device should be calibrated once per shift in LOW FLOW and in HIGH FLOW. Thereafter you can switch between the different flows without re-calibrating.

Calibration is also required after the following actions:

- Sniffer line replacement
- Filter replacement
- Prompt for calibration by the system

Switching off the preamplifier test

The device tests the installed preamplifier during calibration. You can switch off of the amplifier test. This increases the speed of the calibration, but reliability drops off.

0	OFF
1	ON
Control unit	Settings > Set-up> MS-module > Preamplifier > Test > Preamplifier test with CAL
LD protocol	Command 370
ASCII protocol	Command *CONFig:AMPTest (ON,OFF)

Enabling calibration request

If Calibration request is enabled, the device will prompt the operator to perform a calibration 30 minutes after it has been switched on and in case of temperature changes greater than 5°C.

0	OFF
1	ON
Control unit	Functions > CAL > Settings > CAL request. > Calibration request or Settings > Set-up> CAL request. > Calibration request
LD protocol	Command 419
ASCII protocol	*CONFig:CALREQ (ON,OFF)

Calibration warning Wrn650

The warning message Wrn650 "Calibration within the first 20 minutes is not recommended" can be allowed or suppressed.

0	OFF (suppressed)
---	------------------

1	ON (allowed)
Control unit	Functions > CAL > Settings > CAL request. > Calibration warning W650 or Settings > Set-up> CAL request. > Calibration warning W650
LD protocol	Command 429
ASCII protocol	*CONFig:CALWarn ON (OFF)

Calibration Features

The device can be calibrated in all its operation modes. A distinction is made between internal and external calibration.

Internal calibration can be performed using the optional built-in test leak. A separate calibration leak is needed for external calibration.

External calibrations have the advantage that they can be performed under conditions such as pressure and measuring time, which are similar to the later measurement.

internal	<ul style="list-style-type: none"> - with internal calibration leak - autotune (mass adjustment) - determine the calibration factor with the steady signal of the test leak - amplifier test - determination of the background. Adjust if necessary after calibrating the machine or sniffer factor, see "Setting machine and sniff factor [► 57] " - Not with the XL Sniffer Adapter
external	<ul style="list-style-type: none"> - Vacuum operation: with external calibration leak in test equipment - Sniffing mode: with external calibration leak - Consideration of the characteristics of the testing equipment (pressure, partial flow ratio) - Amplifier test - Autotune (mass adjustment) - Determine the calibration factor after the signal of the calibration leak has settled - Determination of the background
external-dynamic	<ul style="list-style-type: none"> - with external calibration leak in test equipment - Consideration of the characteristics of the testing equipment (pressure, partial flow ratio, measuring time) - Measuring time according to the dynamic waveform - Amplifier test

- Determine the calibration before the signal of the test leak has settled
- Determination of the background

7.8.2 Internal Calibration Configuration and Start

Prerequisite for the calibration with the internal calibration leak is the one-time entry of the leak rate of the calibration leak.

Leak rate of internal calibration leak

Define the leak rate of the calibration leak you wish to use during calibration. Calibration will not be possible unless you enter the value here.

1E-9 ... 9.9E-1 mbar l/s

Control unit	Settings > Configuration > Operating Mode > Vacuum > Reference leak int. > Calibration leak internal or Features > CAL > Settings > Calibration leak int.
--------------	---

LD protocol	Command 394
-------------	-------------

ASCII protocol	Command *CONFig:CALleak:INT
----------------	-----------------------------

Opening/closing the calibration leak

Opening/closing the calibration leak. This is automatically carried out with the internal calibration. If the calibration leak is opened using the control unit or the interface, then no internal calibration can take place. The calibration leak must first be closed again in this case.

0	close
---	-------

1	Open
---	------

Control unit	Functions > Valves > Open internal calibration leak
--------------	---

LD protocol	Command 12
-------------	------------

ASCII protocol	Command *STATus:VALVE:TestLeak (ON, OFF)
----------------	--

► Start calibration

Operating unit: Features > CAL > Intern

LD protocol: 4, Parameter 0

ASCII protocol: *CAL:INT

IO1000: CAL internal, see "Settings for I/O module IO1000 [► 87]"

⇒ Calibration is performed automatically.

7.8.3 External Calibration Configuration and Start

Requirement for the calibration with the external calibration leak is the one-time entry of the leak rate of the calibration leak and an open calibration leak.

In vacuum mode, the calibration leak is installed in or on the test system and opened before calibration.

In Sniffer mode, sniffing with the sniffer line is always performed on the open calibration leak.

Leak rate of external calibration leak vacuum

Define the leak rate of the calibration leak you wish to use during calibration.

Calibration will not be possible unless you enter the value here.

A specific leak rate must be set for each gas (mass).

1E-9 ... 9.9E-2 mbar l/s

Control unit

Settings > Set up > Operation modes > Vacuum > Ext. calibration leak > Mass 2 (3, 4) > external calibration leak VAC H2 (M3, He)

or

Functions > CAL > Settings > Ext. calibration leak (for current mass in selected unit)

LD protocol

Command 390

ASCII protocol

Command *CONFig:CALleak:EXTVac (for current mass in selected unit)

Leak rate of external calibration leak sniffing

Define the leak rate of the calibration leak you wish to use during calibration.

Calibration will not be possible unless you enter the value here.

A specific leak rate must be set for each gas (mass).

1E-9 ... 9.9E-2 mbar l/s

Control unit

Settings > Set up > Operation modes > Sniffing > Ext. calibration leak > Mass 2 (3, 4) > external calibration leak SNIF H2 (M3, He)

or

Functions > CAL > Settings > Ext. calibration leak (for current mass in selected unit)

LD protocol

Command 392

ASCII protocol

Command *CONFig:CALleak:EXTSniff (for current mass in device selected unit)

► LD and ASCII protocol: The status must be queried via: Command 260 or *STATus:CAL

- 1 Open external calibration leak or hold sniffer line to calibration leak.
- 2 Start measurement.
- 3 Wait until leak rate signal is tuned and stable.

- 4** Start calibration:
Control unit: Features > CAL > Extern
LD protocol: 4, Parameter 1
ASCII protocol: *CAL:EXT
IO1000: see the figure below.
⇒ Request to "close calibration leak"
- 5** Vacuum mode: Close calibration leak inside the test system.
Sniffer mode: Remove sniffer line from calibration leak.
⇒ Leak rate signal decreases.
- 6** Confirm measured background value is stable:
Control unit: "OK"
LD protocol: 11, Parameter 1
ASCII protocol: *CAL:CLOSED
IO1000 see the figure below.
⇒ Calibration is completed if:
Control unit: Old and new calibration factor are displayed
LD protocol LD instruction 260 provides 0 (READY)
ASCII protocol: Command *STATus:CAL? provides IDLE
IO1000 see the figure below.

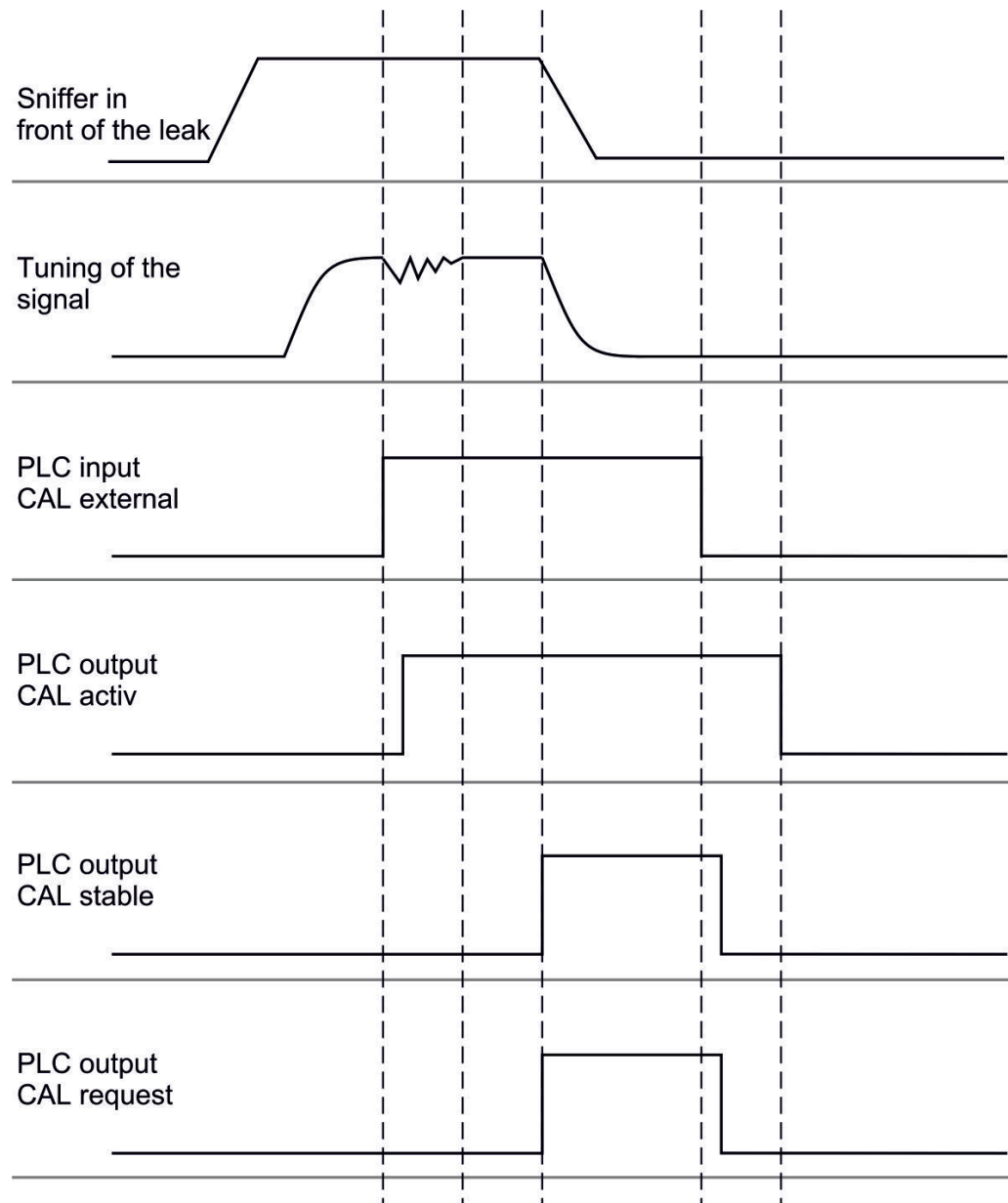

Fig. 14: External calibration with IO1000 using the example of sniffer line SL3000XL, description of PLC inputs and outputs: "Assigning inputs and outputs [► 88]"

7.8.4 Start external dynamic calibration

To taken into account the special time and pressure conditions of a test bench a dynamic calibration can be performed. No auto tuning takes place in the calibration mode. The time between opening the external calibration leak and activating the calibration can be selected so that it is optimally suited to the normal measurement sequence of the plant.

Requirements: One-time input of the leak rate of the calibration leak and an open calibration leak, see "External Calibration Configuration and Start [► 49]".

LD and ASCII protocol: The status must be queried via: Command 260 or *STATus:CAL?

- 1 Open external calibration leak or hold sniffer line to calibration leak.

- 2** Start measurement.
- 3** Wait until the leak rate signal is optimally suited to the normal measurement sequence of the plant.
- 4** Start calibration:
Control unit: Features > CAL > Dynamic
LD protocol: 4, Parameter 2
ASCII protocol: *CAL:DYN
IO1000 see the figure below.
⇒ Request to "close calibration leak"
- 5** Vacuum mode: Close calibration leak inside the test system.
Sniffer mode: Remove sniffer line from calibration leak.
⇒ Leak rate signal decreases.
- 6** Confirm measured background value:
Control unit: "OK"
LD protocol: 11, Parameter 1
ASCII protocol: *CAL:CLOSED
IO1000 see the figure below.
⇒ Calibration is completed if:
Control unit: Old and new calibration factor are displayed
LD protocol LD instruction 260 provides 0 (READY)
ASCII protocol: Command *STATUS:CAL? provides IDLE
IO1000 see the figure below.

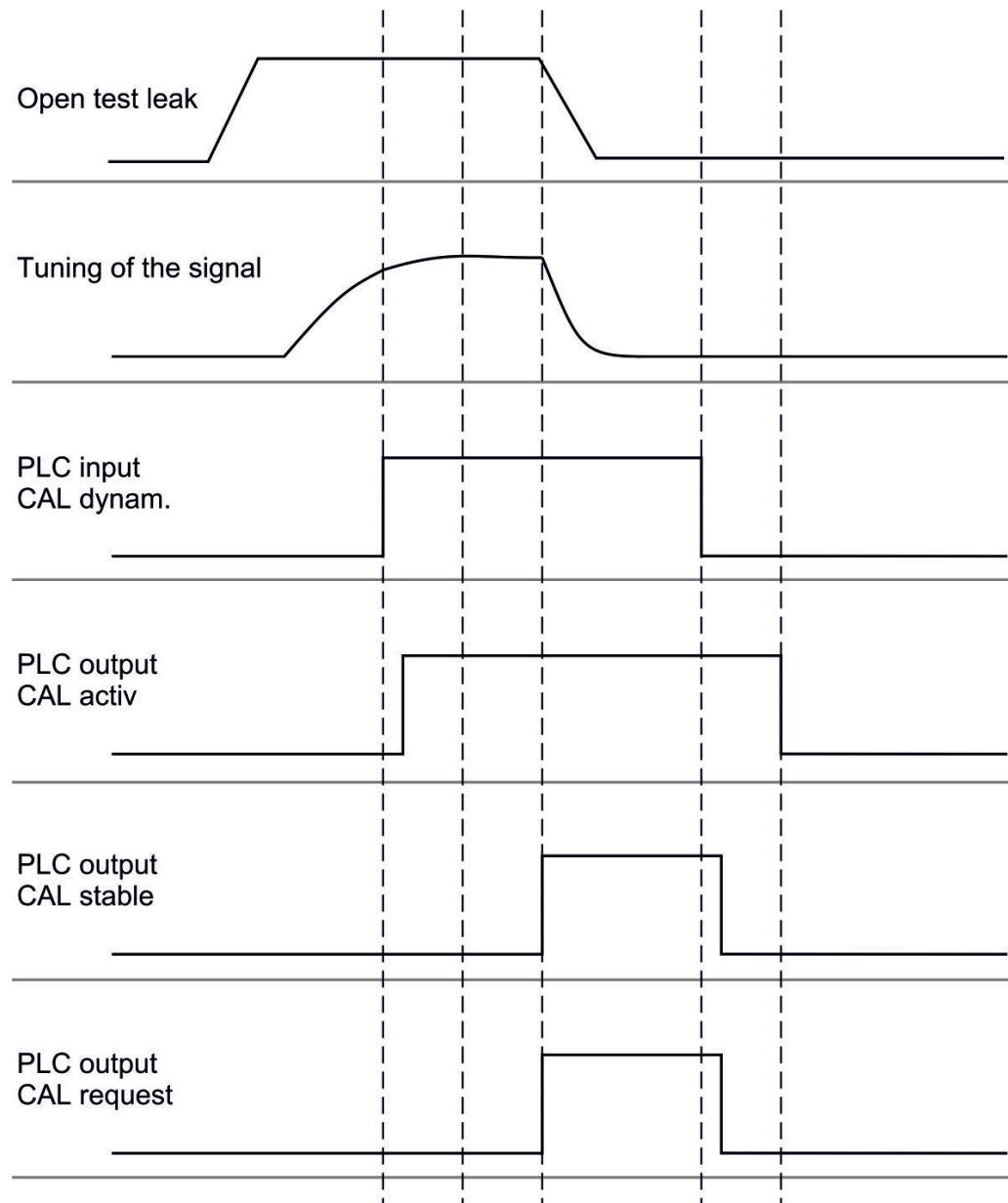

Fig. 15: Fig. 7 External dynamic calibration with IO1000 using the example of sniffer line SL3000XL, description of PLC inputs and outputs: "Assigning inputs and outputs ▶ 88]"

7.8.5 External calibration with sniffer line SL3000XL

The procedure complies with that of external or external dynamic calibration in sniffer mode.

Low flow and high flow must be calibrated separately.

To ensure optimal calibration with hydrogen or forming gas for low flow and high flow, the calibration leak must meet the following requirements:

- 100 % H₂: LR > 1 x 10⁻⁴
- Forming gas (95/5): LR > 2 x 10⁻³

For calibration, we recommend our calibration leak with catalog number 12322.

7.8.6 Check the calibration

To check whether a re-calibration is necessary, check the already existing.

7.8.6.1 Calibration using the internal calibration leak test

The test is only possible with the setting "Mass 4".

► Start test:

Control unit: Features > CAL > Test int.

LD protocol: 4, Parameter 4

ASCII protocol: *CAL:PROOFINT

IO1000: CAL test internal, see "Settings for I/O module IO1000 [► 87]"

⇒ Test is performed automatically.

7.8.6.2 Calibration using the external calibration leak test

► LD and ASCII protocol: The status must be queried via: Command 260 or *STATus:CAL

1 Open external calibration leak or hold sniffer line to calibration leak.

2 Wait until leak rate signal is tuned and stable.

3 Start test:

Control unit: Functions > CAL > Test ext.

LD protocol: 4, Parameter 5

ASCII protocol: *CAL:PROOFEXT

IO1000 compare figure in "External Calibration Configuration and Start [► 49]".

⇒ Request to "close calibration leak"

4 Vacuum mode: Close calibration leak inside the test system.

Sniffer mode: Remove sniffer line from calibration leak.

⇒ Leak rate signal decreases.

5 Confirm measured background value is stable:

Control unit: "OK"

LD protocol: 11, Parameter 1

ASCII protocol: *CAL:CLOSED

IO1000 compare figure in "External Calibration Configuration and Start [► 49]".

⇒ Test is completed if:

Control unit: Result is displayed

LD protocol: As with the other steps, the status must be queried

ASCII protocol: As with the other steps, the status must be queried

IO1000 compare figure in "External Calibration Configuration and Start [► 49]".

7.8.7 Entering the calibration factor

The calibration is usually determined by the appropriate calibration routine. Therefore, it is usually not necessary to adjust the calibration factor manually.

An incorrectly set calibration inevitably leads to wrong leak rate indicator!

7.8.7.1 Calibration factor sniffing

Entry of the calibration factors for masses 2, 3, 4 in low flow and in high flow.

The values will be overwritten during the next calibration.

"High Flow-" or XL settings are available only in operation mode "XL Sniffer Adapter".

The calibration factor for low flow also applies to sniffer applications that are not carried out in the operation mode "XL sniffer adapter".

The calibration factors are managed separately to earth and to "High Flow" and "Low Flow".

0.01 ... 100

Control unit	Settings > Set up > Operation modes > Sniffing > Calibr. factor > mass 2 (3, 4, 2 XL, 3 XL, 4 XL) > calibration factor SNIF H2 (M3, He, XL H2, XL M3, XL He)
LD protocol	Commands 519, 521
ASCII protocol	Command *FACtor:CALSniff or *FACtor:CALSDL for the current mass

7.8.7.2 Calibration factor vacuum

Also applies to devices in AQ mode.

Entry of calibration factors for masses 2, 3, 4.

The values will be overwritten during the next calibration.

0.01 ... 5000

Control unit	Settings > Set up > Operation modes > Vacuum > Calibr. factor > mass 2 (3, 4) > calibration factor VAC H2 (M3, He)
LD protocol	Command 520
ASCII protocol	Command *FACtor:CALVac

7.8.8 Setting machine and sniff factor

The internal calibration will only calibrate the measurement system of a mass spectrometer module that is uncoupled from the test system. If the measurement system is operated in parallel to an additional pump system after an internal calibration though (following the partial flow principle), the measurement system will indicate a leak rate that is too low based on the partial flow ratio. With the help of a corrective machine factor for vacuum mode and a sniff factor for sniffer mode, the measurement system indicates the actual leak rate. The factors are taken into consideration along with the ratio of effective pumping speed of the measurement system in a comparison to the pumping speed of the measurement system on the test system.

7.8.8.1 Setting machine and sniff factor manually

- ✓ Mass spectrometer module calibrated internally.
 - 1 Measure external calibration leak using the test system.
 - ⇒ The device indicates a leak rate that is too low based on the partial flow ratio.
 - 2 Setting machine or sniff factor, see below.
 - ⇒ The device indicates the actual leak rate.

Setting the machine factor



Devices in AQ mode:

The machine factor "1" is preset. This setting should not be changed.

Corrects a possible deviation between internal and external calibration in vacuum mode.

Should be at value 1.00 without the option internal calibration leak. After the value is changed, the leak rate resulting from the change is displayed. This simplifies adjustment.

Value range 1E-4...1E+5

Control unit	Settings > Set up > Operation modes > Vacuum > Machine factor > Mass 2 (3, 4) > machine factor VAC H2 (M3, He)
LD protocol	Command 522
ASCII protocol	Command *FACTOR:FACMachine

Setting the sniff factor

Corrects a possible deviation between internal and external calibration in sniffer mode

Value range 1E-4...1E+4

Control unit	Settings > Set up > Operation modes > Sniffing > Sniff factor Mass 2 (3, 4) > Sniff factor H2 (M3, He)
LD protocol	Command 523
ASCII protocol	Command *FACtor:FACSniff

7.8.8.2 Setting machine and sniff factor using machine calibration

- ✓ Internal calibration leak connected.
- ✓ External calibration leak installed in or on the test system and closed.
- ✓ Leak rates of internal and external calibration leak are entered.
- ✓ LD and ASCII protocol: The status must be queried via: Command 260 or *STATus:CAL
 - 1** Start machine calibration.
 Control unit: Functions > CAL > Machine (Sniffer)
 LD protocol 4, Parameter 3
 ASCII protocol: *CAL:FACtor_Machine, *CAL:FACtor_Snif
 IO1000 see figure in "External Calibration Configuration and Start [► 49]"
 - ⇒ Internal calibration is performed automatically.
 - ⇒ Request "Open calibration leak" (external calibration leak).
 - 2** Open external calibration leak and valve (if present) between the leak detector and the system.
 - 3** Confirm tuned and stable leak rate signal.
 Control unit: "OK"
 LD protocol: 11, Parameter 1
 ASCII protocol: *CAL:ACKnowledge
 IO1000 see figure in "External Calibration Configuration and Start [► 49]"
 - ⇒ Request "Close calibration leak" (external calibration leak).
 - 4** Close external calibration leak. Leave existing valve open.
 - 5** Confirm tuned and stable leak rate signal.
 Control unit: "OK"
 LD protocol: 11, Parameter 1
 ASCII protocol: *CAL:CLOSED
 IO1000 see figure in "External Calibration Configuration and Start [► 49]"
 - ⇒ Machine or sniff factor is determined.

7.9 Starting and stopping the measurement

Switches between measuring and standby operation

START = Standby --> Measuring

STOP = Measuring --> Standby	
Control unit	Functions > Start/Stop
LD protocol	Commands 1, 2
ASCII protocol	Command *STArT, *STOp
During the measurement	During standby
ZERO is possible.	ZERO is not possible.
The trigger outputs switch depending on the leak rate and the trigger threshold.	The output at the trigger outputs is: Leak rate value exceeded threshold.
Sniff is possible.	Sniff is not possible.
External calibration is started during the activation of digital input CAL.	Internal calibration is started during the activation of digital input CAL.
In vacuum mode, the machine factor can be activated or deactivated during the correction of the leak rate for Standby. The sniffer valve is closed in Sniffer mode in Standby. The Sniff factor is therefore canceled in this setting.	
0	OFF (machine factor is not considered in Standby.)
1	On (machine factor is considered in Standby.)
Control unit	Settings > Set up > Operation modes > LR correction > Machine factor in standby
LD protocol	Command 524
ASCII protocol	–

Enable/disable correction of the leak rate in Standby

7.10 Loading and saving parameters

You can use a USB flash drive on CU1000 to backup and restore the control unit and mass spectrometer module parameters.

Save parameter:

- "Functions > Data > Parameter > Save > Save parameter"

Loading parameters:

- ✓ The currently set compatibility mode must match the compatibility mode in the parameter file. See also Select Compatibility Mode [► 43].
- "Functions > Data > Parameter > Load > Load parameter"

7.11 Copying measurement data, deleting measurement data

The measurement data can be saved to a USB flash drive with CU1000.

- "Functions > Data > Recorder > Copy > Copy files"

The measurement data can be deleted on the CU1000.

- "Functions > Data > Recorder > Delete > Delete files"

7.12 Suppressing gas backgrounds with "ZERO" functions

"ZERO" can be used to suppress undesired helium backgrounds. If "ZERO" is enabled, the currently measured leak rate value will be interpreted as a helium background and subtracted from all subsequently measured values. The background value suppressed by "ZERO" is adjusted automatically if the background changes inside the device. The background value is automatically adjusted depending on the set ZERO time, except for filter setting I•CAL, see "Measurement result display with signal filters [► 61]".

Activating and deactivating <variable linkid="658744588" name="1035">ZERO</variable>

Activating/deactivating "ZERO"

0	ON
1	Off

Control unit	Function > ZERO > ZERO
LD protocol	Command 6
ASCII protocol	Command *ZERO

Activating and deactivating "ZERO with start"

ZERO with Start suppresses the helium background automatically when a measurement is started.

0	ON
1	Off

Control unit	Settings > ZERO/Filter > ZERO > ZERO with start
LD protocol	Command 409
ASCII protocol	Command *CONFig:ZEROSTART

Setting ZERO mode

Determines the degree of the helium background suppressed by ZERO (only with filter "fixed" and "2-stage").

0	all decades
---	-------------

1	1 – 2 decades
2	2 – 3 decades
3	2 decades
4	3 – 4 decades
5	19/20 of the helium background are suppressed
Control unit	Settings > ZERO/Filter > ZERO > ZERO > mode
LD protocol	Command 410
ASCII protocol	Command *CONFig:DECADEZero

Deactivating the ZERO key on the sniffer

Deactivation of the ZERO key (ZERO adjustment) prevents that the measurement is influenced inadvertently.	
0	ON
1	Off
Control unit	Settings > Set up > Operation modes > Sniffing > Sniffer > Keys > ZERO key sniffer
LD protocol	Command 412
ASCII protocol	Command *CONFig:BUTSniffer

7.13 Measurement result display with signal filters

Select signal filter

With the signal filters, the leak rate indicator regarding slope and noise behavior can be influenced.

- Generally select signal filter I•CAL for the operation mode "Vacuum".
- Generally select signal filter I-Filter for the operation mode "Sniff".
- If the signal filter should simulate the time behavior of older units, then select filter "Fixed" or "2-Zone".

I•CAL	The leak rates are averaged at time intervals that are optimized for the range of the leak rates. The algorithm used offers excellent sensitivity and response time. Use of this setting is strongly recommended.
fixed	The leak rates are averaged at fixed intervals of 0.2 seconds.
2-zone	The filter is compatible with LDS1000 and LDS2000. The averaging period is switched depending on the filter leak rate threshold.
I-Filter	Filter optimized for sniffer mode. (Default with XL Sniffer Adapter set)

	I-Filter slope suppress.	Same as I-Filter, but with additional slope suppression. The edge suppression corrects the measurement changes during the warm-up phase.
	Control unit	Settings > ZERO/Filter > Filter > Filter mode
	LD protocol	Command 402
	ASCII protocol	Command *CONFig:FILTER
Setting the filter leak rate threshold	Leak rate background in mbar l / s for the averaging period. The averaging period is 10.24 s below this value. Above this value, the averaging period is 160 ms. Setting applies only to filter "2-stage".	
	1E-11 ... 9.9E-3	
	Control unit	Settings > ZERO/Filter > Settings > Filter 2-zone
	LD protocol	Command 403
	ASCII protocol	Command *CONFig:LRFilter
Setting filter ZERO time	Update interval for the offset value with negative leak rate signal (except for I•CAL filter).	
	Resolution 0.1 s (50 = 5.0 s)	
	Control unit	Settings > ZERO/Filter > Settings filter > ZERO time
	LD protocol	Command 411
	ASCII protocol	Command *CONFig:ZEROTIME

7.14 Control of the Gas Ballast Valve of the Backing Pump

The mass spectrometer module can control an electric 24 V gas ballast valve of the backing pump via the "Output" connection.

Controlling the gas ballast valve	Controlling the gas ballast valve using digital outputs.	
	0	Off
	1	On
	2	Continuously on
	Control unit	Functions > Valves > Gas Ballast
	LD protocol	Command 228
	ASCII protocol	–

7.15 Selecting display limits

Display range

Lowering and raising the display limits:

If very small leak rates are not of interest for your application, raising the lower limit of the display can facilitate the assessment of the leak rate indicator.

- up to 15 decades in VAC
- up to 11 decades in SNIF
- up to 8 decades in AQ mode

If an unsuitable setting causes the usable range to be less than the decade, the upper limit is shifted until a visible decade remains.

Note: The current display limits are shown in the control unit when setting between the two parameters. Using the command 399 with the LD protocol the current display limit can be read out.

Control unit	Display > Display limits
LD protocol	Command 397
ASCII protocol	Command: *CONFig:DISPL_LIM:HIGH Command: *CONFig:DISPL_LIM:LOW

7.16 Setting trigger values

The mass spectrometer module has four independent trigger values. If the measured leak rate exceeds the set trigger values, the corresponding digital outputs of IO1000 are activated.

In addition, exceeding the Trigger 1 on the control unit is highlighted.

In the AQ mode, the calculation at the recommended measuring time refers to the trigger value 1.

1 / 2 / 3 / 4

Control unit	Setting > Trigger > Trigger 1 (2, 3, 4) > Trigger level
LD protocol	Command 385
ASCII protocol	Command *CONFig:TRIGger1 (2, 3, 4)

7.17 Setting capillary surveillance

Pressure value capillary clogged

You set a minimum pressure value in order to detect if the 25/300-sccm capillaries are blocked. If the value is fallen short of, the system issues warning 540. Error message 541 is output with strong lower deviation.

1E-3 ... 18 mbar

**Pressure value
capillary broken**

Control unit	Settings > Set up > Operation modes > Sniff > Capillary > Blocked > Pressure capillary blocked
LD protocol	Command 452
ASCII protocol	Command *CONFig:PRESSLow
You set a maximum pressure value in order to detect if the 25/300-sccm capillaries are blocked. If the value is exceeded, the system issues warning 542.	
1E-3 ... 18 mbar	
Control unit	Settings > Set up > Operation modes > Sniff > Capillary > Broken > Pressure capillary broken
LD protocol	Command 453
ASCII protocol	Command *CONFig:PRESSHigh

**Detection of a missing
sniffer line**

Automatic detection of a missing sniffer line. This function should be deactivated if a sniffer line that is not automatically detected is used.	
0	ON
1	Off
Control unit	Settings > Set up > Operation modes > Sniff > Sniffer > Messages > Sniffer line detection
LD protocol	Command 529
ASCII protocol	–

7.18 Set the rotation speed of the turbo molecular pump

**Rotation speed of turbo
molecular pump**

In some applications, it may be advisable to reduce the rotation speed of the turbo-molecular pump, to increase the sensitivity of the device. As a result, however, the maximum allowable inlet pressure decreases at the GROSS, FINE and ULTRA connections. After changing the rotation speed recalibration is required!



For devices with AQ mode: Do not change the set 1000 Hz.

Rotation speed of turbo molecular pump in Hertz

1000

1500

Control unit	Settings > Set up > MS module > TMP > Settings > TMP rotational speed
LD protocol	501
ASCII protocol	*CONFig:SPEEDTMP

7.19 Cathode Selection

Selecting a cathode

The mass spectrometer includes two cathodes. In the factory setting the device uses cathode 1. If it is defective, the device automatically switches to the other cathode. With this setting it is possible to select a certain cathode.

0	CAT1
1	CAT2
2	Auto Cat1 (automatic switching to cathode 2, factory setting)
3	Auto Cat2 (automatic switching to cathode 1)
4	OFF
Control unit	Settings > Set up > MS module > Ion source > Cathode selection
LD protocol	530
ASCII protocol	*CONFig:CATHode *STATus:CATHode

7.20 Settings for the XL sniffer adapter

For operation with the XL Sniffer Adapter you have to use the

- SL3000XL sniffer line,
- Select the "XL Sniffer Adapter" operation mode, see "Select operation mode [► 45]".

Function of right sniffer key

Activate or deactivating the right key of the SL3000XL sniffer line (switching between low flow and high flow). Deactivating the key prevents an inadvertent influencing of the measurement.

Control unit	Settings > Set up > Operation modes > Sniff > Sniffer > Keys > Sniffer flow key
LD protocol	Command 415
ASCII protocol	Command *CONFig:HFBUTTON

Search Function

When the search function is activated, the alarm is automatically connected to Trigger 2 as soon as it is switched to High Flow.

- Switched-off Search Function: Alarm, when Trigger 1 is exceeded.

- Switched-on Search Function and operation in Low Flow: Alarm, when Trigger 1 is exceeded.
- Switched-on Search Function and operation in High Flow: Alarm, when Trigger 2 is exceeded.

0	Off
---	-----

1	ON
---	----

Control unit	Setting > Trigger > Search
--------------	----------------------------

LD protocol	Command 380
-------------	-------------

ASCII protocol	Command *CONFig:SEARCh
----------------	------------------------

In the SL3000XL the following are dependent on the trigger used; the leak rate bar, changing the background lighting, the beeper and changing the sniffer tip lighting.

Sniffer LEDs:

Brightness

Set the brightness of the LEDs designed to illuminate the spot under examination. This setting refers to the measurement process without LED alarm configuration, see below.

From "0" (off) to "6" (max.)

Control unit	Settings > Set up > Operation modes > Sniff > Sniffer > LED > Sniffer LED brightness
--------------	--

LD protocol	Command 414
-------------	-------------

ASCII protocol	Command *CONFig:BRIGHtNess
----------------	----------------------------

Sniffer LEDs: Alarm configuration

Behavior of the LEDs on the sniffer, when trigger value 1 is exceeded.

Off	No response
-----	-------------

Flashing	The LEDs are flashing
----------	-----------------------

Brighter	The LEDs shine with maximum brightness.
----------	---

Control unit	Settings > Set up > Operation modes > Sniff > Sniffer > LED > Sniffer LED alarm config.
--------------	---

LD protocol	Command 413
-------------	-------------

ASCII protocol	Command *CONFig:LIGHtAlarm
----------------	----------------------------

Sniffer beep: Alarm configuration

Response by the beep on the sniffer if the trigger value is exceeded.

Off	No response
-----	-------------

Trigger	Acoustic signal / vibration alarm
---------	-----------------------------------

Control unit	Settings > Set up > Operation modes > Sniff > Sniffer > Beep > Sniffer Beep
--------------	---

LD protocol	Command 417
-------------	-------------

	<table> <tr> <td>ASCII protocol</td><td>Command *CONFig:BEEP</td></tr> </table>	ASCII protocol	Command *CONFig:BEEP				
ASCII protocol	Command *CONFig:BEEP						
Display of the hydrogen percentage	<p>The sniffing with forming gas involves the use of hydrogen. The hydrogen percentage is taken into consideration with this specification. This will increase the displayed leak rate by the corresponding factor. You can also set the gas percentage for other gases (M3, He).</p> <p>0 ... 100%</p> <table> <tr> <td>Control unit</td><td>Settings > Set up > Operation modes > Sniff > Gas percentage > Mass2 > Gas percentage H2</td></tr> <tr> <td>LD protocol</td><td>Command 416</td></tr> <tr> <td>ASCII protocol</td><td>Command *CONFig:PERcent</td></tr> </table>	Control unit	Settings > Set up > Operation modes > Sniff > Gas percentage > Mass2 > Gas percentage H2	LD protocol	Command 416	ASCII protocol	Command *CONFig:PERcent
Control unit	Settings > Set up > Operation modes > Sniff > Gas percentage > Mass2 > Gas percentage H2						
LD protocol	Command 416						
ASCII protocol	Command *CONFig:PERcent						
Auto standby interval	<p>Defines the duration in minutes until standby is activated. If the device operates in high flow, the filters of the sniffer line will foul up more quickly. Auto standby switches to low flow for protection. Moving the sniffer line automatically switches the previously selected flow back on.</p> <p>From "0" (off) to "60" (max.)</p> <table> <tr> <td>Control unit</td><td>Settings > Set up > Operation modes > Sniff > Auto standby > Interval auto standby</td></tr> <tr> <td>LD protocol</td><td>Command 480</td></tr> <tr> <td>ASCII protocol</td><td>Command *CONFig:STANDBYDel</td></tr> </table>	Control unit	Settings > Set up > Operation modes > Sniff > Auto standby > Interval auto standby	LD protocol	Command 480	ASCII protocol	Command *CONFig:STANDBYDel
Control unit	Settings > Set up > Operation modes > Sniff > Auto standby > Interval auto standby						
LD protocol	Command 480						
ASCII protocol	Command *CONFig:STANDBYDel						
Pressure value XL capillary clogged (high flow)	<p>You set a minimum pressure value in order to detect if the XL capillary (high flow, 3000 sccm) is blocked. If the value is fallen short of, the system issues warning 550. Error message 551 is output with strong lower deviation.</p> <p>100 ... 300 mbar</p> <table> <tr> <td>Control unit</td><td>Settings > Set up > Operation modes > Sniff > Capillary > Blocked XL > Pressure capillary blocked XL</td></tr> <tr> <td>LD protocol</td><td>Command 455</td></tr> <tr> <td>ASCII protocol</td><td>Command *CONFig:PRESSXLLow</td></tr> </table>	Control unit	Settings > Set up > Operation modes > Sniff > Capillary > Blocked XL > Pressure capillary blocked XL	LD protocol	Command 455	ASCII protocol	Command *CONFig:PRESSXLLow
Control unit	Settings > Set up > Operation modes > Sniff > Capillary > Blocked XL > Pressure capillary blocked XL						
LD protocol	Command 455						
ASCII protocol	Command *CONFig:PRESSXLLow						
Pressure value XL capillary broken (high flow)	<p>You set a maximum pressure value in order to detect a disruption in the XL capillary (high flow, 3000 sccm). If the value is exceeded, the system issues warning 552.</p> <p>200 ... 600 mbar</p> <table> <tr> <td>Control unit</td><td>Settings > Set up > Operation modes > Sniff > Capillary > Broken XL > Pressure capillary broken XL</td></tr> <tr> <td>LD protocol</td><td>Command 456</td></tr> <tr> <td>ASCII protocol</td><td>Command *CONFig:PRESSXLHigh</td></tr> </table>	Control unit	Settings > Set up > Operation modes > Sniff > Capillary > Broken XL > Pressure capillary broken XL	LD protocol	Command 456	ASCII protocol	Command *CONFig:PRESSXLHigh
Control unit	Settings > Set up > Operation modes > Sniff > Capillary > Broken XL > Pressure capillary broken XL						
LD protocol	Command 456						
ASCII protocol	Command *CONFig:PRESSXLHigh						

Select flow

Select low flow or high flow. Comment: The selection can also be made with the right sniffer key or assigned to one of the favorite keys of the control unit.

Small (low flow)

Large (high flow)

Control unit	Settings > Configuration> Operating Mode > Flow > Flow Control or Functions > Flow > Flow Control
--------------	--

LD protocol	Command 229
-------------	-------------

ASCII protocol	Command *CONFig:Highflow
----------------	--------------------------

7.21 Resetting the settings

Mass spectrometer module

The settings of the mass spectrometer module can be reset to factory settings.

0	Load factory settings
---	-----------------------

10	Reset the settings for compatibility mode LDS1000
----	---

11	Reset the settings for compatibility mode LDS2010
----	---

12	Reset the settings for XL sniffer adapter mode
----	--

Control unit	Functions > Data > Parameters > Reset > Control unit settings Functions > Data > Parameters > Reset > MSB settings Functions > Data > Parameters > Reset > Parameter access level
--------------	---

LD protocol	Command 1161
-------------	--------------

ASCII protocol	Command *RST:FACTORY
----------------	----------------------

	Command *RST:SL3000
--	---------------------



For devices with AQ mode: Loading AQ mode reloads the factory settings for the AQ mode, see also Select Compatibility Mode [► 43].

8 Operation LDS3000 AQ (Accumulation)

8.1 Switching the device on

- 1 Switch on the backing pump.
 - 2 Establish the power supply to the mass spectrometer module.
- ⇒ System starts up automatically.
- ⇒ If an XL Sniffer Adapter and the CU1000 are connected, you will be asked after run-up, whether the "XL Sniffer Adapter" operation mode should be set. This does not apply to devices in AQ mode.



Longer run-up time for devices in AQ mode

To counteract falsification of the measurement results by an increased background value, the warm-up time after switching on is about 10 minutes.

Wait at least 60 minutes before determining the peak or before calibrating.

See also "Carrying out a measurement [► 82]".

8.2 Default settings

Language selection

Select the display language. The factory setting is English. (The display on the handle of the SL3000XL sniffer line shows messages in English instead of in Russian and Chinese.)

German, English, French, Italian, Spanish, Portuguese, Russian, Chinese, Japanese

Control unit	Settings > Set up > Control unit > Language
LD protocol	Command 398
ASCII protocol	*CONFig:LANG

Setting date and time

Setting the date

Format: DD.MM.YY

Control unit	Settings > Date/Time > Date
LD protocol	Command 450
ASCII protocol	*HOUR:DATE

Setting the time

Format: hh: mm

Control unit	Settings > Date/Time > Time
LD protocol	Command 450
ASCII protocol	*HOUR:TIME

8.3 Selecting a unit for the leak rate

Leak rate unit display

Selecting the leak rate unit in the display for vacuum or sniff	
0	mbar l/s (factory setting)
1	Pa m3/s
2	atm cc/s
3	Torr l/s
4	ppm (not VAC, not AQ)
5	g/a (not VAC, not AQ)
6	oz/yr (not VAC, not AQ)
7	sccm (AQ only)
Control unit	Display > Units (display) > Leak rate device VAC (SNIF)
LD protocol	Command 396 (vacuum)
	Command 396 (sniffing)
ASCII protocol	Command *CONFig:UNIT:VACDisplay
	Command *CONFig:UNIT:SNDisplay

Leak rate unit interface

Selecting the leak rate unit of the interfaces for vacuum or sniff	
0	mbar l/s (factory setting)
1	Pa m3/s
2	atm cc/s
3	Torr l/s
4	ppm (not VAC)
5	g/a (not VAC)
6	oz/yr (not VAC)
7	sccm (AQ only)
Control unit	Settings > Set up > Interfaces > Units (interface) > Leak rate device VAC (SNIF)
LD protocol	Command 431 (vacuum)
	Command 432 (sniffing)
ASCII protocol	Command *CONFig:UNIT:LRVac
	Command *CONFig:UNIT:LRSnif

8.4 Select device for pressure

Pressure unit interface

Selecting the pressure device of the interfaces	
0	mbar (factory setting)
1	Pa
2	atm
3	Torr
Control unit	Settings > Set up > Interfaces > Units (interface) > Pressure unit
LD protocol	Command 430 (Vacuum/Sniff)
ASCII protocol	Command *CONFig:UNIT:Pressure

8.5 Select Compatibility Mode

To retrofit an existing leak detection system LDS1000 / LDS2010 with a LDS3000, activate the appropriate compatibility mode:

- Compatibility mode for LDS1000 or
- Compatibility mode for LDS2010

When changing to a compatibility mode all parameters are to be reset to factory settings and the device is to be restarted. The language is displayed according to the factory setting. To change the language, see "Default settings [► 69]".

If you want to use the LDS3000 later in normal operation mode, make sure to save your parameters on a USB flash drive, see "Loading and saving parameters [► 83]". You can load the saved parameters again after you have switched to normal operation.

Compatibility mode for LDS1000

Compatibility mode for LDS2010

Mode LDS3000

Mode XL Sniffer Adapter

Mode AQ (This mode is only available for AQ devices. It is preset for AQ devices. Switching to other modes is possible.)

Control unit	Settings > Set up > Compatibility > Compatibility mode
LD protocol	Command 2594 (dec)
ASCII protocol	Command *CONFig:COMP

The following table shows the functional differences between and common features of LDS2010 and LDS3000:

	LDS2010	LDS3000
Trigger outputs	without joint reference	with joint reference
other outputs	with joint reference	with joint reference
Trigger 1 (sniffer LED, relay exit, audio signal)	Control of sniffer LED, PWM audio outputs an the control unit for active speakers	Control of sniffer LED, audio outputs an the control unit for active speakers
Limit Low / High (serial interfaces, display, analogue output)	Limit Low affects all outputs, Limit High only the display	separately adjustable for interface protocols, display and analog outputs
Gas ballast (3 settings)	<p>OFF: Switches the gas ballast valve of the pump module off.</p> <p>ON: Switches the gas ballast valve of the pump module on until the next mains-off.</p> <p>If "CAL fashion" is unequal to 3 (menu item 26), the gas ballast valve can be controlled with digital input DynCAL.</p> <p>F-ON: Fixed on enables switching the gas ballast valve on permanently (power failure-proof and independent of the digital inputs).</p>	<p>0 = Off</p> <p>1 = on, but controllable via digital input on IO1000</p> <p>2 = on, but not controllable via digital input on IO1000</p>
Control mode	LOCAL, RS232, RS485	None, control is also possible from all control locations.
LDS1000 compatibility mode 9.2	other functions	Default values and error messages (default values are output via interface, the touchscreen shows the original message - -> reason: new hardware can cause errors that did not exist with previous models)
Correcting the leak rate in Standby (machine factor)	adjustable (yes/no)	adjustable (yes/no)
ZERO with start		starting with V1.02 like LDS2010
Opening the sniffer valve	in SNIF after start	in SNIF after start
Rotation speed of turbo molecular pump	only 2 rotation speeds adjustable	Adjustable via serial interface from 750 Hz to 1500 Hz, via operator unit 1000 Hz and 1500 Hz
Address RS485	Yes, because bus capable	No, because not bus capable
Sniffer key on/off	selectable	selectable

	LDS2010	LDS3000
Default value for int. calibration leak	1E-15 mbar l/s	9.9E2 mbar l/s
Default value ext. calibration leak VAC/SNIF mode	1E-7 mbar l/s	9.9E2 mbar l/s
Setting range for int. calibration leak	10E-7	1E-9 ... 9.9E-1 mbar l/s
Machine factor adjustment	manually	manually/automatically
Machine / sniff factor value range	Machine factor: 1E-3...9.9E+3 Sniffer factor: 1E-3...9.9E+3	Machine factor: 1E-4...1E+5 Sniffer factor: 1E-4...1E+4
Pressure: Capillary surveillance 20		available, pressure adjustable
Analog output	fixed characteristics	freely configurable
Calibration request	Preamplifier temperature change 5 K or 30 min	Preamplifier temperature change 5 K or 30 min. or TMP rotation speed changed
Pressure / leak rates units (VAC/ SNIF) for all interfaces	yes	Control unit and rest separated
User permissions	3 levels over PIN on the control unit or key switch	4 levels through control unit or optional key switch
Key-operated switch	permanently installed	can, if required, be connected externally, see "Assigning the digital inputs of the I/O module [► 95]" (Key switch)

8.6 Making basic settings via the wizard

We recommend using the AQ Wizard for important settings and calibration. The following information refers to a CU1000 that has been adapted for use with the LDS3000 AQ.

If you want to deviate from the standard settings or want to find out more about interface protocol commands, please refer to further chapters of this manual for details.

AQ Wizard

To start the AQ wizard, press on the display of the CU1000

Main menu > Functions > Assistant

Alternatively press the word "Wizard" at the bottom of the display.

Make your entries in the windows that are called one after the other.

1. Chamber volume
(net volume)
The unit of volume can be selected under Main Menu > Settings > Set up > Op. modes > AQ > Volume unit.
(LD protocol: Command 1763
ASCII protocol: *CONFig:AQ:VOLume)
2. Trigger level 1
(LD/ASCII protocol: See "Setting trigger values [► 63]")
3. Mass
(selection between helium or forming gas)
(LD/ASCII protocol: See "Select gas type (mass) [► 46]")
4. Percentage of gas
(for example, the hydrogen content in forming gas)
(LD/ASCII protocol: See display of hydrogen content in "Settings for the XL sniffer adapter [► 65]")
5. Measurement time
(The time can be freely adjusted, but there is also a recommendation, depending on parameters.)
(LD protocol: Command 1765
ASCII protocol: *CONFig:AQ:TIME)

Alternatively, you can make your settings in the following places:

Main menu > Settings > Set up > Operation modes > AQ

Main menu > Settings > Mass

8.7 Determine peak

To obtain the most accurate measurement results, you should always determine the current "peak" before calibration. At the end of this process, the value for the old anode voltage is replaced by the value for the new anode voltage.

The adjustment uses air-helium or air-hydrogen. An adjustment only with nitrogen is not possible.

The following information about the display refers to a CU1000 that has been adapted for use with the LDS3000 AQ.

- ✓ To prevent falsification of measurement results due to an increased background value, you have waited for at least 60 minutes to warm up.

- 1 Main menu > Functions > CAL > Peak.
- 2 Confirm with "OK".
⇒ The "CAL peak" window opens.
- 3 Remove the calibration leak from the chamber.

- 4 Wait until the background signal is stable.
- 5 To confirm the stable background value and start the adjustment, confirm with "OK".
 - ⇒ (LD protocol: 4, Parameter 7 (peak adjust AQ)
ASCII protocol: *CAL:PEAK)
IO1000: "Peakfind" input
 - ⇒ (LD and ASCII protocol: The status must then be queried via command 260 (State Calibration) or *STATus: CAL)
 - ⇒ After adjustment, the old and new anode voltage are displayed.

8.8 Store leak rate of calibration leaks

Enter the specifications for the used calibration leak once. A specific leak rate must be set for each gas (mass).

Range: 1E-9 ... 9.9E-2 mbar l/s



Minimum size for leak rate of the calibration leak

In order to perform a stable calibration, we recommend a minimum size for the leak rate of the used calibration leak.

If the measurement time proposed by the AQ Wizard is maintained, the leak rate should not fall below the following value:

- When using forming gas, the selected setpoint (Trigger 1)
- When using helium 1/5 of the selected setpoint (Trigger 1)

If the leak rate of the used calibration leak is too small, an error message will be issued to start or finish the calibration.

The following information refers to a CU1000 that has been adapted for use with the LDS3000 AQ.

- ✓ The desired unit in which you want to enter the leak rate is set. If the unit of leak rate displayed in your system differs from the unit indicated on the calibration leak, at least temporarily set the unit as indicated on the calibration leak. See also "Selecting a unit for the leak rate [► 42]".

- 1 Main menu > Functions > CAL > Settings > Ext. calibration leak
- 2 Enter the desired gas and the associated leak rate.
(LD protocol: Command 390
ASCII protocol: *CONFig:CALleak:EXTVac)

8.9 Calibrating the device

8.9.1 Time and general preferences

NOTICE

Incorrect calibration because of operating temperature that is too low

Calibrating the device in the cold state can deliver incorrect measurement results.

- For optimum accuracy the device should have been turned on at least 60 minutes previously.

It is recommended to calibrate the device once per shift in the desired operating modes and for the desired gases. Thereafter you can switch between the operation modes and gases without re-calibrating.

Further, calibration is required after a calibration prompt by the system.

Switching off the preamplifier test

The device tests the installed preamplifier during calibration. You can switch off of the amplifier test. This increases the speed of the calibration, but reliability drops off.

0	OFF
1	ON

Control unit	Settings > Set-up> MS-module > Preamplifier > Test > Preamplifier test with CAL
--------------	---

LD protocol	Command 370
-------------	-------------

ASCII protocol	Command *CONFig:AMPTest (ON,OFF)
----------------	----------------------------------

Enabling calibration request

If Calibration request is enabled, the device will prompt the operator to perform a calibration 30 minutes after it has been switched on and in case of temperature changes greater than 5°C.

0	OFF
1	ON

Control unit	Functions > CAL > Settings > CAL request. > Calibration request or Settings > Set-up> CAL request. > Calibration request
--------------	--

LD protocol	Command 419
-------------	-------------

ASCII protocol	*CONFig:CALREQ (ON,OFF)
----------------	-------------------------

Calibration warning Wrn650

The warning message Wrn650 "Calibration within the first 20 minutes is not recommended" can be allowed or suppressed.	
0	OFF (suppressed)
1	ON (allowed)
Control unit	Functions > CAL > Settings > CAL request. > Calibration warning W650 or Settings > Set-up> CAL request. > Calibration warning W650
LD protocol	Command 429
ASCII protocol	*CONFig:CALWarn ON (OFF)

See also

 Setting machine and sniff factor [► 81]

8.9.2 Entering the calibration factor

The calibration is usually determined by the appropriate calibration routine. Therefore, it is usually not necessary to adjust the calibration factor manually.

An incorrectly set calibration inevitably leads to wrong leak rate indicator!

8.9.3 Calibration factor vacuum

Also applies to devices in AQ mode.

Entry of calibration factors for masses 2, 3, 4.	
The values will be overwritten during the next calibration.	
0.01 ... 5000	
Control unit	Settings > Set up > Operation modes > Vacuum > Calibr. factor > mass 2 (3, 4) > calibration factor VAC H2 (M3, He)
LD protocol	Command 520
ASCII protocol	Command *FACTOR:CALVac

8.9.4 Calibrating

Please also note the general instructions for calibration, see "Calibrating the device [► 46]".

Requirements for all procedures

- You have an external calibration leak.
- The information on the calibration leak is entered, see also "Store leak rate of calibration leaks [► 75]".
- To prevent falsification of measurement results due to an increased background value, you have waited for at least 60 minutes to warm up.
- The current "peak" was determined, see also "Determine peak [► 74]".

Control unit CU1000

- 1 Place the open calibration leak in the measuring chamber and close the measuring chamber.
- 2 Main menu > Functions > CAL > external
 - ⇒ The leak rate of the calibration leak will be displayed and a question to start the calibration.
- 3 To start the calibration confirm with "OK".
- 4 Follow the instructions on the screen.

LD or ASCII protocol, IO1000

- 1 Place the open calibration leak in the measuring chamber and close the measuring chamber.
- 2 For a stable leak rate signal, wait at least the duration of the set AQ measurement time.
- 3 Start the calibration
 - LD protocol: Command 4, Parameter 1
 - ASCII protocol: *CAL:EXT
 - IO1000: Input "CAL external", see also the following figure
 - ⇒ If helium is used, proceed to the last step (no. 8).
- 4 For a background determination of forming gas (hydrogen), then query the status:
 - LD protocol: Command 260 (State Calibration)
 - ASCII protocol: *STATus:CAL
 - ⇒ Wait until it reaches the following state:
 - LD protocol: Command 260 State 75 "WAIT_ZERO_AQ"
 - ASCII protocol: *STATus:CAL? on "CLOSE"
 - IO1000: Input "CAL stable", see also the following figure
- 5 Remove the calibration leak from the measuring chamber and close the measuring chamber.
- 6 For a stable leak rate signal, wait at least the duration of the set AQ measurement time.

- 7 Start the background measurement.
LD protocol: Command 11, Parameter 1 (Continue calibration)
ASCII protocol: *CAL:CLOSED
IO1000: Input "CAL external", see also the following figure
- 8 Then query the status:
LD protocol: Command 260 (State Calibration)
ASCII protocol: *STATus:CAL
 - ⇒ Wait until it reaches the following state:
LD protocol: Command 260 State 0 "READY"
ASCII protocol: *STATus:CAL? on "IDLE"
IO1000: Output "CAL active", see also the following figure
 - ⇒ The calibration is completed.
 - ⇒ In case of error:
LD protocol: Command 260 State 51...59 (error conditions)
ASCII protocol: *STATus:CAL? on "FAIL"
IO1000: Output "Error or Warning"

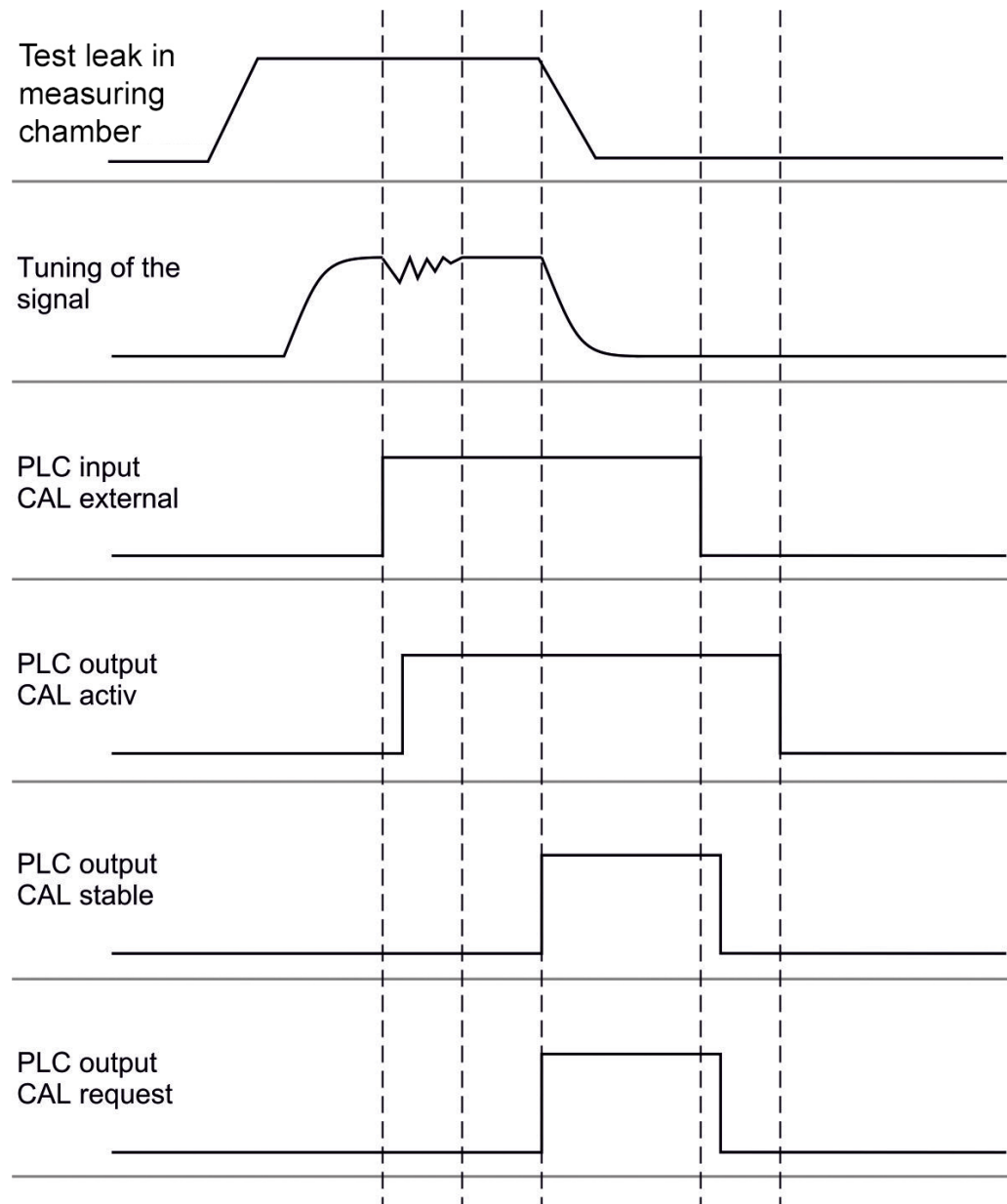

Fig. 16: External calibration with IO1000 on a device for AQ mode. Description of the PLC inputs and outputs see "Assigning inputs and outputs [88]"

8.10 Perform ZERO

After the run-up of the LDS3000 AQ and the choice of forming gas as gas type, the existing hydrogen in the vacuum system initially ensures that a rising curve is visible on the display. This display can be misunderstood as a sign of leakage.

To remove distorting traces of hydrogen, wait about 30 minutes after starting up the device to measure.

To eliminate the residual offset, execute ZERO AQ. ZERO AQ is not used to suppress measurement signals.

- ✓ Mass is hydrogen (forming gas).
If no hydrogen (forming gas) is entered, you can set it under "Main menu > Settings > Mass" or via "Wizard" at the bottom of the measurement window display.
- ✓ There is neither a test specimen nor a calibration leak in the measuring chamber.
 - 1 Main menu > Functions > ZERO AQ
 - 2 Follow the instructions on the screen.
 - ⇒ LD and ASCII protocol: After removing the test specimen or calibration leak, first wait for the measuring time.
 - ⇒ LD protocol: Command 6, Parameter 1; ASCII protocol: *ZERO:ON
 - ⇒ IO1000: Input ZERO

8.11 Setting machine and sniff factor

The internal calibration will only calibrate the measurement system of a mass spectrometer module that is uncoupled from the test system. If the measurement system is operated in parallel to an additional pump system after an internal calibration though (following the partial flow principle), the measurement system will indicate a leak rate that is too low based on the partial flow ratio. With the help of a corrective machine factor for vacuum mode and a sniff factor for sniffer mode, the measurement system indicates the actual leak rate. The factors are taken into consideration along with the ratio of effective pumping speed of the measurement system in a comparison to the pumping speed of the measurement system on the test system.

8.11.1 Setting machine and sniff factor manually

- ✓ Mass spectrometer module calibrated internally.
 - 1 Measure external calibration leak using the test system.
 - ⇒ The device indicates a leak rate that is too low based on the partial flow ratio.
 - 2 Setting machine or sniff factor, see below.
 - ⇒ The device indicates the actual leak rate.

Setting the machine factor



Devices in AQ mode:

The machine factor "1" is preset. This setting should not be changed.

Corrects a possible deviation between internal and external calibration in vacuum mode.

Should be at value 1.00 without the option internal calibration leak. After the value is changed, the leak rate resulting from the change is displayed. This simplifies adjustment.

Value range 1E-4...1E+5

Control unit	Settings > Set up > Operation modes > Vacuum > Machine factor > Mass 2 (3, 4) > machine factor VAC H2 (M3, He)
LD protocol	Command 522
ASCII protocol	Command *FACtor:FACMachine

Setting the sniff factor

Corrects a possible deviation between internal and external calibration in sniffer mode

Value range 1E-4...1E+4

Control unit	Settings > Set up > Operation modes > Sniffing > Sniff factor Mass 2 (3, 4) > Sniff factor H2 (M3, He)
LD protocol	Command 523
ASCII protocol	Command *FACtor:FACSniff

8.12 Carrying out a measurement

WARNING

Danger due to imploding measuring chamber

An external measuring chamber connected to an LDS3000 AQ is pumped off at approximately 60 sccm. Within normal measurement times (2 - 30 seconds) no dangerous negative pressure is generated.

If the measuring chamber is leak-proof, but not vacuum resistant, and continues to pump, it may implode. This can occur, for example, in a 1-liter measuring chamber after about 10 minutes.

- ▶ Do not continue pumping a measuring chamber after the measuring time has expired.
- ▶ Consider suitable protective measures!

- ✓ The device is switched on.
- ✓ The peak has been determined, see “Determine peak [► 74]”.
- ✓ The calibration was done, see “Calibrating [► 77]”.
- ✓ AQ ZERO has been determined, see “Perform ZERO [► 80]”.

- 1** If you are measuring with forming gas, make sure that the device has been running for at least half an hour. This time is needed to perform stable measurements.
 - ⇒ If you measure with helium, this waiting time is about 10 minutes.
- 2** Place the test object in the measuring chamber and close the measuring chamber. The test object should not be placed on the areas that may be leaking.
 - ⇒ Either a test object filled with helium or forming gas under pressure is brought into the measuring chamber or pressurized in the measuring chamber.
 - ⇒ If the test object leaks, the display shows an increasing leak rate.
- 3** Wait for the set measuring time.
 - ⇒ The leak rate is calculated and displayed.
- 4** Remove the test object from the measuring chamber and continue the measurements with step 2.
 - ⇒ Start or stop buttons are not used.

8.13 Loading and saving parameters

You can use a USB flash drive on CU1000 to backup and restore the control unit and mass spectrometer module parameters.

Save parameter:

- ▶ "Functions > Data > Parameter > Save > Save parameter"

Loading parameters:

- ✓ The currently set compatibility mode must match the compatibility mode in the parameter file. See also Select Compatibility Mode [▶ 71].
- ▶ "Functions > Data > Parameter > Load > Load parameter"

8.14 Copying measurement data, deleting measurement data

The measurement data can be saved to a USB flash drive with CU1000.

- "Functions > Data > Recorder > Copy > Copy files"

The measurement data can be deleted on the CU1000.

- "Functions > Data > Recorder > Delete > Delete files"

8.15 Adjust "Zero time factor AQ"

In order to avoid apparently negative leak rates when measuring with forming gas, the leakage rate display is adjusted to 0 after a certain time (zero time factor AQ x measuring time).

Zero time factor AQ can be set under:

Main menu > Settings > Set up > Operation modes > AQ > Measurement time

The default value is 4 and can be changed to 1...10 in integers.

(LD protocol: Command 1767

ASCII protocol: *CONFig:AQ:ZEROTime)

8.16 Selecting display limits

Display range

Lowering and raising the display limits:

If very small leak rates are not of interest for your application, raising the lower limit of the display can facilitate the assessment of the leak rate indicator.

- up to 15 decades in VAC
- up to 11 decades in SNIF
- up to 8 decades in AQ mode

If an unsuitable setting causes the usable range to be less than the decade, the upper limit is shifted until a visible decade remains.

Note: The current display limits are shown in the control unit when setting between the two parameters. Using the command 399 with the LD protocol the current display limit can be read out.

Control unit	Display > Display limits
LD protocol	Command 397
ASCII protocol	Command: *CONFig:DISPL_LIM:HIGH Command: *CONFig:DISPL_LIM:LOW

8.17 Set the rotation speed of the turbo molecular pump

Rotation speed of turbo molecular pump

In some applications, it may be advisable to reduce the rotation speed of the turbo-molecular pump, to increase the sensitivity of the device. As a result, however, the maximum allowable inlet pressure decreases at the GROSS, FINE and ULTRA connections. After changing the rotation speed recalibration is required!



For devices with AQ mode: Do not change the set 1000 Hz.

Rotation speed of turbo molecular pump in Hertz

1000

1500

Control unit	Settings > Set up > MS module > TMP > Settings > TMP rotational speed
LD protocol	501
ASCII protocol	*CONFig:SPEEDTMP

8.18 Cathode Selection

Selecting a cathode

The mass spectrometer includes two cathodes. In the factory setting the device uses cathode 1. If it is defective, the device automatically switches to the other cathode. With this setting it is possible to select a certain cathode.

0	CAT1
1	CAT2
2	Auto Cat1 (automatic switching to cathode 2, factory setting)
3	Auto Cat2 (automatic switching to cathode 1)
4	OFF
Control unit	Settings > Set up > MS module > Ion source > Cathode selection
LD protocol	530
ASCII protocol	*CONFig:CAThode *STATus:CAThode

8.19 Resetting the settings

Mass spectrometer module

The settings of the mass spectrometer module can be reset to factory settings.

0	Load factory settings
10	Reset the settings for compatibility mode LDS1000
11	Reset the settings for compatibility mode LDS2010
12	Reset the settings for XL sniffer adapter mode

Control unit	Functions > Data > Parameters > Reset > Control unit settings Functions > Data > Parameters > Reset > MSB settings Functions > Data > Parameters > Reset > Parameter access level
LD protocol	Command 1161
ASCII protocol	Command *RST:FACTORY Command *RST:SL3000



For devices with AQ mode: Loading AQ mode reloads the factory settings for the AQ mode, see also Select Compatibility Mode [▶ 71].

9 Using the expansion module (LDS3000, LDS3000 AQ)

9.1 Selecting the type of expansion module

Selecting the expansion module

Selecting the type of module connected to the I/O connection	
I/O module	
Bus module	
Control unit	Settings > Configuration > Interfaces > Device Selection > Module on I/O connection or Settings > Configuration > Accessories > Device Selection. > Module on I/O connection
LD protocol	–
ASCII protocol	–

9.2 Settings for I/O module IO1000

9.2.1 General interface settings

Setting the interface protocol

Setting the protocol for the module connected to the I/O connection. This setting can be overwritten with the DIP switch on the IO1000.	
LD	
ASCII	
Binary	
LDS1000	
Control unit	Settings > Set up > Interfaces > Protocol > I/O module protocol
LD protocol	2593
ASCII protocol	*CONFig:RS232

9.2.2 Assigning inputs and outputs

Assigning analog outputs of the I/O module

The analog outputs of I/O module IO1000 can be assigned with different measurement value displays.

Possible functions: see the following table

Control unit	Settings > Set up > Interfaces > I/O module > Analog outp. > Config. Analog outputs 1/2
LD protocol	Commands 222, 223, 224
ASCII protocol	Command *CONFig:REcorder:LINK1 Command *CONFig:REcorder:LINK2 Command *CONFig:REcorder:SCALE Command *CONFig:REcorder:UPPEREXP

Limit values can be defined for the output voltages.

VAC:	Min. 1×10^{-13} ... 1×10^{-1} mbar l/s Max. 1×10^{-12} ... 1×10^{-1} mbar l/s
SNIF:	Min. 1×10^{-9} ... 1×10^{-1} mbar l/s Max. 1×10^{-8} ... 1×10^{-1} mbar l/s

Control unit	Settings > Set up > Interfaces > LR limits
LD protocol	Command 226 (Vac) Command 227 (Snif)
ASCII protocol	Command *CONFig:LIMITS:VAC Command *CONFig:LIMITS:SNIF

Functions, assignment of analog outputs:

Off	The analog outputs are switched off (Output voltage = 0 V).	
Pressure p1 / Pressure p2	1 ... 10 V; 0.5 V / decade; $1 \text{ V} = 1 \times 10^{-3} \text{ mbar}$	
Leak rate mantissa	1 ... 10 V; linear; in the selected unit	Useful only if the other analog output is assigned "Leak rate exponent".
Leak rate exponent	1 ... 10 V; 0.5 V / decade; Step function; $1 \text{ V} = 1 \times 10^{-12}$; in selected unit	Useful only if the other analog output is assigned "Leak rate mantissa" or "Leak rate ma. Hys." is occupied.
Linear leak rate	x ... 10 V; linear; in the selected unit	

The upper limit (= 10 V) is set via the parameter "Upper limit exponent". The lower value is always 0 (leak rate), which corresponds to 0 V output voltage. The exponent of the upper limit can be set in entire decades, such as 1×10^{-4} mbar l/s.

Settings > Set up > Interfaces > I/O module > Analog scale > AO exponent upper limit.

This setting is for both analog outputs, if an appropriate output function is selected. Depending on the selected leak rate unit there is a different absolute limit.

The selected range can be additionally narrowed by the limits, which is valid for all interfaces, see above.

Leak rate log.	x ... 10 V; logarithmic; in the selected unit	
<p>The upper limit (= 10 V) and the scale (V / decades) are set via the parameters "Upper limit exponent" and "Scale for leak rate". For example:</p> <p>Upper limit set to 1 x 10⁻⁵ mbar l/s (= 10 V). Scale set to 5 V / decade. Lower limit is at 1 x 10⁻⁷ mbar l/s (= 0 V).</p> <p>The logarithmic output function of both the slope in V / decade as well as the upper limit (10 V limit) can be set. This results in the minimum displayable value. The following slopes are available: 0.5, 1, 2, 2.5, 3, 5, 10 V/Decade. The higher the selected slope value, the smaller the displayable area. The logarithmic settings are the most useful when several decades can be displayed, so a setting of <10 V / decade. The upper limit is the same for both analog outputs. In both of the following figures the 1 V / decade and 5 V / decade with different upper limit settings are exemplified. Depending on the selected leak rate unit there is a different absolute limit. The selected range can be additionally narrowed by the limits, which is valid for all interfaces, see above.</p>		
Set by interface	The output voltage can be specified for tests with the LD log command 221.	
Leak rate Ma. Hys.	0.7 ... 10 V; linear; in the selected unit	Useful only if the other analog output is assigned "Leak rate exponent". Through an overlap of the mantissa in the range 0.7 to 1.0, a constant jumping between two decades is prevented. 0.7 V corresponds to a leak rate of 0.7 x 10 ^{-x} . 9.9 V corresponds to a leak rate of 9.9 x 10 ^{-x} .
Pressure p1 (1 V / Dec.)/ Pressure p2 (1 V / Dec.)	1 ... 10 V; 1 V / decade; 2.5 V = 1 x 10 ⁻³ mbar; 8.5 V = 1000 mbar	
Leak rate log. H./ Leak rate exp. Inv.	Special function. Use only on the recommendation of INFICON.	

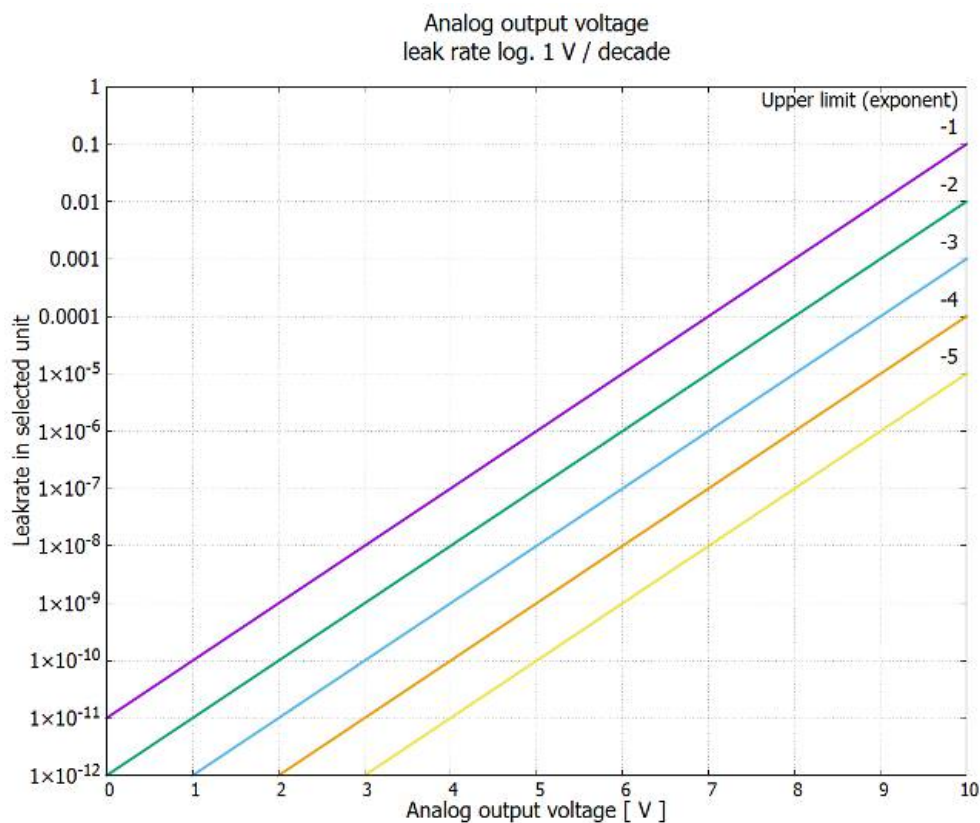

Fig. 17: Analog output voltage leak rate log. 1 V / decade

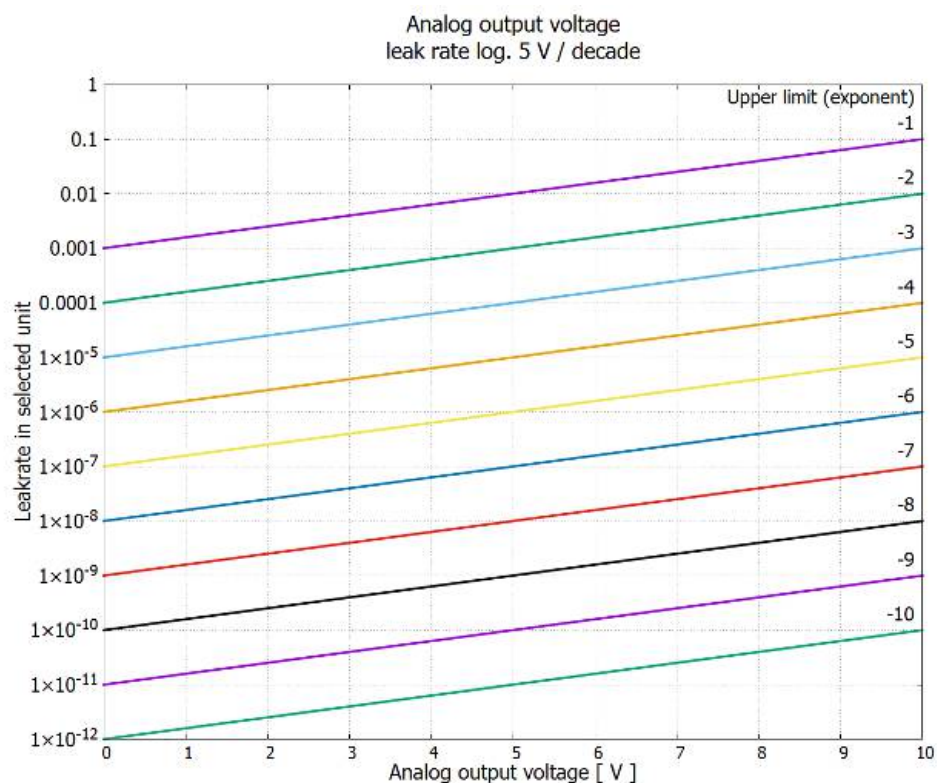

Fig. 18: Analog output voltage leak rate log. 5 V / decade

Output voltages in case of error The following voltages will be applied at the analog outputs in the event of an error:

Compatibility mode	Voltage
LDS1000	0 V

LDS2010	10 V
LDS3000	10.237 V

Configuration (LDS2010-compatible) The following table can be used for the transmission of settings from LDS2010 to LDS3000.

LDS2010 setting. Menu item 22	Analog output channel	Function LDS2010	Function LDS3000	Scaling of the leak rate	Upper limit (10 V = ...)
1	1	Leak rate mantissa in used unit. 1 ... 10 V	Leak rate mantissa	irrelevant	irrelevant
1	2	Leak rate exponent (step function) in used unit. . 1 ... 10 V, 0.5 V / Decade, 1 V = 1E-12	Leak rate exponent	irrelevant	irrelevant
2	1	Leak rate log. in used unit. 1 ... 10 V, 0.5 V / Decade, 1 V = 1E-12	Leak rate log.	0.5 V/dec.	1E6 [used unit]
2	2	Pressure p1 log. in used unit. 1 ... 10 V, 0.5 V / Decade, 1 V = 1E-3 mbar	Pressure p1	irrelevant	irrelevant
3	1	Leak rate mantissa in mbar·l/s 1 ... 10 V	Leak rate mantissa	irrelevant	irrelevant
3	2	Leak rate exponent (step function) in mbar·l/s 1 ... 10 V, -1 V / Decade, 0 V = 1E0 mbar l/s	LR exponent inverted	irrelevant	irrelevant
4	1	Leak rate log. 0 ... 10 V, 1 V / Decade, 0 V = 1E-10 mbar l/s	Leak rate log.	1 V/dec.	1.00E+00
4	2	Pressure p1 log. in mbar 1 V / decade, 2.5 ... 8.5 V, 2.5 V = 1E-3 mbar, 5.5 V = 1E0 mbar	p1 1 V/dec.	irrelevant	irrelevant
5	1	Leak rate mantissa in used unit. 1 ... 10 V rise, 0.7 ... 10 V fall	LR mantissa hyst.	irrelevant	irrelevant
5	2	Leak rate exponent in used unit. 1 ... 10 V, 0.5 V / Decade, 0 V = 1E-14	Leak rate exponent	irrelevant	irrelevant
6	1	Leak rate log. in Pa·m³/s 0 ... 10 V, 1 V/Decade, 0 V = 1E-12 Pa·m³/s = 1E-12 mbar l/s	Leak rate log.	1 V/dec.	1E-2 mbar l/s

LDS2010 setting. Menu item 22	Analog output channel	Function LDS2010	Function LDS3000	Scaling of the leak rate	Upper limit (10 V = ...)
6	2	Pressure p1 log. in Pa 1 V / decade, 2.5 ... 8.5 V, 2.5 V = 1E-3 mbar	p1 1 V/dec.	irrelevant	irrelevant
8	1	Leak rate log. in Pa·m³/s 0 ... 10 V, 1 V/Decade, 0 V = 1E-12 Pa·m³/s = 1E-12 mbar l/s	Leak rate log.	1 V/dec.	1E-2 mbar l/s
8	2	Pressure p2 log. in Pa 1 V / decade, 2.5 ... 8.5 V, 2.5 V = 1E-3 mbar	p2 1 V/dec.	irrelevant	irrelevant
9	1	Pressure p1 log. in Pa 1 V / decade, 2.5 ... 8.5 V, 2.5 V = 1E-3 mbar	p1 1 V/dec.	irrelevant	irrelevant
9	2	Pressure p2 log. in Pa 1 V / decade, 2.5 ... 8.5 V, 2.5 V = 1E-3 mbar	p2 1 V/dec.	irrelevant	irrelevant
10	1	Leak rate log. in mbar l/s 0 ... 8 V, 2 V / Decade, 0 V = 1E-3 mbar l/s	Leak rate log.	2 V/dec.	1E+2 mbar l/s
10	2	Leak rate log. in mbar l/s 0 ... 10 V, 3 V / Decade, 0 V = 1E-3 mbar l/s	Leak rate log.	Special 1	1E+1 mbar l/s
11	1	Leak rate log. in mbar l/s 0 ... 8 V, 2 V / Decade, 0 V = 1E-4 mbar l/s	Leak rate log.	2 V/dec.	1E+1 mbar l/s
11	2	Leak rate log. in mbar l/s 0 ... 10 V, 3 V / Decade, 0 V = 1E-4 mbar l/s	Leak rate log.	Special 1	1E+0 mbar l/s
12	1	Leak rate log. in mbar l/s 0 ... 8 V, 2 V / Decade, 0 V = 1E-5 mbar l/s	Leak rate log.	2 V/dec.	1E0 mbar l/s
12	2	Leak rate log. in mbar l/s 0 ... 10 V, 3 V / Decade, 0 V = 1E-5 mbar l/s	Leak rate log.	Special 1	1E-1 mbar l/s
13	1	Leak rate log. in mbar l/s 0 ... 8 V, 2 V / Decade, 0 V = 1E-6 mbar l/s	Leak rate log.	2 V/dec.	1E-1 mbar l/s
13	2	Leak rate log. in mbar l/s 0 ... 10 V, 3 V / Decade, 0 V = 1E-6 mbar l/s	Leak rate log.	Special 1	1E-2 mbar l/s

LDS2010 setting. Menu item 22	Analog output channel	Function LDS2010	Function LDS3000	Scaling of the leak rate	Upper limit (10 V = ...)
14	1	Leak rate log. in mbar l/s 0 ... 8 V, 2 V / Decade, 0 V = 1E-7 mbar l/s	Leak rate log.	2 V/dec.	1E-2 mbar l/s
14	2	Leak rate log. in mbar l/s 0 ... 10 V, 3 V / Decade, 0 V = 1E-7 mbar l/s	Leak rate log.	Special 1	1E-3 mbar l/s
15	1	Leak rate log. in mbar l/s 0 ... 8 V, 2 V / Decade, 0 V = 1E-8 mbar l/s	Leak rate log.	2 V/dec.	1E-3 mbar l/s
15	2	Leak rate log. in mbar l/s 0 ... 10 V, 3 V / Decade, 0 V = 1E-8 mbar l/s	Leak rate log.	Special 1	1E-4 mbar l/s
16	1	Leak rate log. in mbar l/s 0 ... 8 V, 2 V / Decade, 0 V = 1E-9 mbar l/s	Leak rate log.	2 V/dec.	1E-4 mbar l/s
16	2	Leak rate log. in mbar l/s 0 ... 10 V, 3 V / Decade, 0 V = 1E-9 mbar l/s	Leak rate log.	Special 1	1E-5 mbar l/s
17	1	Leak rate log. in mbar l/s 0 ... 8 V, 2 V / Decade, 0 V = 1E-10 mbar l/s	Leak rate log.	2 V/dec.	1E-5 mbar l/s
17	2	Leak rate log. in mbar l/s 0 ... 10 V, 3 V / Decade, 0 V = 1E-10 mbar l/s	Leak rate log.	Special 1	1E-6 mbar l/s
18	1	Leak rate log. in mbar l/s 0 ... 8 V, 2 V / Decade, 0 V = 1E-11 mbar l/s	Leak rate log.	2 V/dec.	1E-6 mbar l/s
18	2	Leak rate log. in mbar l/s 0 ... 10 V, 3 V / Decade, 0 V = 1E-11 mbar l/s	Leak rate log.	Special 1	1E-7 mbar l/s
20	1	Leak rate lin. In mbar l/s 0 ... 10 V, 1 V = 1 mbar l/s	Linear leak rate	irrelevant	1E1 mbar l/s
20	2	Leak rate log. in mbar l/s 0 ... 4 V, 1 V / Decade, 0 V = 1E-3 mbar l/s	Leak rate log.	1 V/dec.	1E7 mbar l/s
21	1	Leak rate lin. In mbar l/s 0 ... 10 V, 1 V = 1E-1 mbar l/s	Linear leak rate	irrelevant	1E0 mbar l/s

LDS2010 setting. Menu item 22	Analog output channel	Function LDS2010	Function LDS3000	Scaling of the leak rate	Upper limit (10 V = ...)
21	2	Leak rate log. in mbar l/s 0 ... 4 V, 1 V / Decade, 0 V = 1E-4 mbar l/s	Leak rate log.	1 V/dec.	1E6 mbar l/s
22	1	Leak rate lin. In mbar l/s 0 ... 10 V, 1 V = 1E-2 mbar l/s	Linear leak rate	irrelevant	1E-1 mbar l/s
22	2	Leak rate log. in mbar l/s 0 ... 4 V, 1 V / Decade, 0 V = 1E-5 mbar l/s	Leak rate log.	1 V/dec.	1E5 mbar l/s
23	1	Leak rate lin. In mbar l/s 0 ... 10 V, 1 V = 1E-3 mbar l/s	Linear leak rate	irrelevant	1E-2 mbar l/s
23	2	Leak rate log. in mbar l/s 0 ... 4 V, 1 V / Decade, 0 V = 1E-6 mbar l/s	Leak rate log.	1 V/dec.	1E4 mbar l/s
24	1	Leak rate lin. In mbar l/s 0 ... 10 V, 1 V = 1E-4 mbar l/s	Linear leak rate	irrelevant	1E-3 mbar l/s
24	2	Leak rate log. in mbar l/s 0 ... 4 V, 1 V / Decade, 0 V = 1E-7 mbar l/s	Leak rate log.	1 V/dec.	1E3 mbar l/s
25	1	Leak rate lin. In mbar l/s 0 ... 10 V, 1 V = 1E-5 mbar l/s	Linear leak rate	irrelevant	1E-4 mbar l/s
25	2	Leak rate log. in mbar l/s 0 ... 4 V, 1 V / Decade, 0 V = 1E-8 mbar l/s	Leak rate log.	1 V/dec.	1E2 mbar l/s
26	1	Leak rate lin. In mbar l/s 0 ... 10 V, 1 V = 1E-6 mbar l/s	Linear leak rate	irrelevant	1E-5 mbar l/s
26	2	Leak rate log. in mbar l/s 0 ... 4 V, 1 V / Decade, 0 V = 1E-9 mbar l/s	Leak rate log.	1 V/dec.	1E1 mbar l/s
27	1	Leak rate lin. In mbar l/s 0 ... 10 V, 1 V = 1E-7 mbar l/s	Linear leak rate	irrelevant	1E-6 mbar l/s
27	2	Leak rate log. in mbar l/s 0 ... 4 V, 1 V / Decade, 0 V = 1E-10 mbar l/s	Leak rate log.	1 V/dec.	1E0 mbar l/s
28	1	Leak rate lin. In mbar l/s 0 ... 10 V, 1 V = 1E-8 mbar l/s	Linear leak rate	irrelevant	1E-7 mbar l/s
28	2	Leak rate log. in mbar l/s 0 ... 4 V, 1 V / Decade, 0 V = 1E-11 mbar l/s	Leak rate log.	1 V/dec.	1E-1 mbar l/s

LDS2010 setting. Menu item 22	Analog output channel	Function LDS2010	Function LDS3000	Scaling of the leak rate	Upper limit (10 V = ...)
29	1	Leak rate lin. In mbar l/s 0 ... 10 V, 1 V = 1E-9 mbar l/s	Linear leak rate	irrelevant	1E-8 mbar l/s
29	2	Leak rate log. in mbar l/s 0 ... 4 V, 1 V / Decade, 0 V = 1E-11 mbar l/s	Leak rate log.	1 V/dec.	1E-1 mbar l/s
30	1	Leak rate lin. In mbar l/s 0 ... 10 V, 1 V = 1E-10 mbar l/s	Linear leak rate	irrelevant	1E-9 mbar l/s
30	2	Leak rate log. in mbar l/s 0 ... 4 V, 1 V / Decade, 0 V = 1E-11 mbar l/s	Leak rate log.	1 V/dec.	1E-1 mbar l/s

Analog input readout

- No function can be configured for the analog input.
- It is reserved for future applications.
- LD command 220 can be used to read out the voltage value on the analog input.

9.2.2.1 Assigning the digital inputs of the I/O module

The digital inputs PLC-IN 1 ... The available functions can be assigned in any way necessary to the 10 I/O module.

- Active signal: typically 24 V
- Inactive signal: typically 0 V.

The 24V output of the I/O module can be used as an active signal.

Every function can be inverted.

Possible functions: see the following table

Control unit	Settings > Set up > Interfaces > I/O module > Digital inputs > Configuration PLC Input
LD protocol	Command 438
ASCII protocol	*CONFig:PLCINLINK:1 (2 ... 10)

Key-operated switch

An external key switch with up to three switching outputs can be connected via three PLC inputs. The key switch can be used to select the access level of the operator of the control unit.

Button 1 - Operator

Button 2 - Supervisor

Button 3 - Integrator

Example for a suitable key switch: Hopt+Schuler, No. 444-05

Functions, assignment of digital inputs:

Function	Flank/state:	Description
No function	–	No function
CAL dynam.	inactive→ active:	Start external dynamic calibration.
	active→ inactive:	Apply value for background and finish calibration.
CAL external	inactive→ active:	Start external calibration.
	active→ inactive:	Apply value for background and finish calibration.
CAL intern	inactive→ active:	Start internal calibration.
SNIF/VAC	inactive→ active:	Enable sniffer mode.
	active→ inactive:	Enable vacuum mode.
Start	inactive→ active:	Switch to Meas. (ZERO is possible, all trigger outputs switch depending on the leak rate.)
STOP	inactive→ active:	Switch to Standby. (ZERO is not possible, all trigger outputs will return "Leak rate threshold value exceeded".)
ZERO	inactive→ active:	Switch ZERO on.
	active→ inactive:	Switch ZERO off.
ZERO pulse	inactive→ active:	Switching ZERO on or off.
Delete	inactive→ active:	Erase warning or error message / cancel calibration.
Gas ballast	inactive→ active:	Open gas ballast valve.
	active→ inactive:	Close gas ballast valve unless always open.
Selection dyn/ norm	inactive→ active:	External calibration mode with activation of digital input "CAL":
	active→ inactive:	External dynamic calibration (without auto tune, allowing for the measuring times and pump cycle times set via the digital inputs) External normal calibration (with auto tune, not considering the system-specific measuring times and pump cycle times)
Start / Stop	inactive→ active:	Switch to Meas. (ZERO is possible, all trigger outputs switch depending on the leak rate.)
	active→ inactive:	Switch to Standby. (ZERO is not possible, all trigger outputs will return "Fail".)
Key 1	active:	User "Operator"
Key 2	active:	User "Supervisor"
Key 3	active:	User "Integrator"
CAL	inactive→ active:	When set to Standby, the device will start an internal calibration. When set to Meas, the device will start an external calibration.

Function	Flank/state:	Description
TL	inactive→ active:	The internal calibration leak is opened.
	active→ inactive:	The internal calibration leak is closed.
TL Plus	inactive→ active:	The internal calibration leak opens or closes.
XL flow	inactive→ active:	The XL flow is turned on with the XL Adapter.
	active→ inactive:	The XL flow is turned off with the XL Adapter.
CAL Mach	inactive→ active:	Start machine factor calibration
Internal PROOF	inactive→ active:	Start the internal Proof function.
External PROOF	inactive→ active:	Start the external Proof function.
START / STOP impulse	inactive→ active:	Activate Start or Stop.
ZERO update	inactive→ active:	Update or switch on ZERO
	active→ inactive:	No function
Calibration leak open	inactive→ active:	Open calibration leak
	active→ inactive:	Close calibration leak
calibration leak on pulse	inactive→ active:	Open calibration leak if closed, or close if open
	active→ inactive:	No function
Flow	inactive→ active:	Switch flow of SL3000XL to 3000 sccm (XL adapter)
	active→ inactive:	Switch flow of SL3000XL to 300 sccm (XL adapter)
CAL machine	inactive→ active:	Determining the machine factor or of the sniff factor
Internal CAL check	inactive→ active:	Check calibration with internal calibration leak
External CAL check	inactive→ active:	Check calibration with external calibration leak
Start / Stop impulse	inactive→ active:	Switching between measuring operation and standby
Mass 2 / Mass 4	inactive→ active:	Activate mass 4
	active→ inactive:	Activate mass 2
Peakfind	inactive→ active:	Start peak determination (AQ only)

9.2.2.2 Assigning the digital outputs of the I/O module

The digital outputs PLC-OUT 1 ... The available functions can be assigned in any way necessary to the 8 I/O module.

Every function can be inverted.

Possible functions: see the following table

Control unit	Settings > Set up > Interfaces > I/O module > Digital outputs > Configuration PLC Output
LD protocol	Command 263
ASCII protocol	*CONFig:PLCOUTLINK:1 (2 ... 8)

Functions, assignment of digital outputs:

Function	State:	Description
Open	open:	always open
Trigger 1	closed:	Value exceeded leak rate threshold Trigger 1
	open:	Value fell below leak rate threshold Trigger 1
Trigger 2	closed:	Value exceeded leak rate threshold Trigger 2
	open:	Value fell below leak rate threshold Trigger 2
Trigger 3	closed:	Value exceeded leak rate threshold Trigger 3
	open:	Value fell below leak rate threshold Trigger 3
Trigger 4	closed:	Value exceeded leak rate threshold Trigger 4
	open:	Value fell below leak rate threshold Trigger 4
Ready	closed:	Emission switched on, calibration process inactive, no error
	open:	Emission switched off or calibration process active or error
Warning	closed:	Warning
	open:	no warning
Error	closed:	Error
	open:	no error
CAL active	closed:	Device is to be calibrated.
	open:	Device is not to be calibrated.
CAL request	closed:	and no external calibration: Calibration request (with temperature change from 5 °C or 30 minutes after the start-up or if default rotation speed was changed)
	closed:	and external calibration or "CAL check": Request "Open or close external calibration leak"
	open:	no request
Run up	closed:	Run up
	open:	no run-up
ZERO active	closed:	ZERO switched on
	open:	ZERO switched off
Emission on	closed:	Emission switched on
	open:	Emission switched off

Function	State:	Description
Measuring	closed:	Measuring (ZERO is possible, all trigger outputs switch depending on the leak rate.)
	open:	Standby or emission disabled (ZERO is not possible, all trigger outputs will return "Leak rate threshold value exceeded".)
Standby	closed:	Standby (ZERO is not possible, all trigger outputs will return "Leak rate threshold value exceeded".)
	open:	Measuring (ZERO is possible, all trigger outputs switch depending on the leak rate.)
SNIF	closed:	SNIF
	open:	VAC
Error or warning	closed:	Error or warning
	open:	No error or warning
Gas ballast	closed:	Gas ballast is active
	open:	Gas ballast is inactive
Calibration leak open	closed:	calibration leak is active
	open:	calibration leak is inactive
CAL stable	closed:	Calibration completed with calibration leak (see "Time and general preferences [▶ 46]")
	open:	Assignment not stable or calibration is inactive
Cathode 2	closed:	Cathode 2 is active
	open:	Cathode 1 is active

9.3 Settings for bus module BM1000

Address of bus module	Setting the bus module address. (Node address with Profibus, MACID with DeviceNet)	
	0 ... 255	
	Control unit	Settings > Set up > Interfaces > Bus module > Address
	LD protocol	326
	ASCII protocol	–

10 Warning and error messages (LDS3000, LDS3000 AQ)

The instrument is equipped with extensive self-diagnostic functions.

Error messages

Errors are events that the device cannot correct itself and that force interruption of its operation. The error message consists of a number and a descriptive text.

After you have removed the cause of the error, start operation again with the restart key.

Warnings

Warnings warn of instrument modes that can impair the accuracy of measurements. Operation of the device is not interrupted.

Confirm acknowledgment of the warning with the OK key or the right key on the sniffer handle.

The following table displays all the warnings and error messages. It lists possible causes for the malfunction and instructions on how to eliminate these.

Please note that work marked with an asterisk must be carried out only by service staff that is authorized by INFICON.

Warning (Wrn) Error (Err)	Error message LDS3000	Error number		Limit values	Cause
		LDS1000 Protocol	Binary or ASCII protocol compatibilit y mode LDS1000/ LDS2010		
1xx system error (RAM, ROM, EEPROM, clock, ...)					
Wrn102	Timeout EEPROM MSB Box (Parameter number)	84	43		EEPROM on IF board or MSB defective
Wrn104	An EEPROM parameter is initializing	84	43		Following software update or EEPROM defective
Wrn106	EEPROM parameter initializing	84	43		Following software update or EEPROM defective
Wrn110	Clock not set	16	16		Jumper for clock not set, battery drained, clock defective
Wrn122	No response from the BUS module	99	99		Connection to BUS module interrupted

Warning (Wrn) Error (Err)	Error message LDS3000	Error number		Limit values	Cause
		LDS1000 Protocol	Binary or ASCII protocol compatibilit y mode LDS1000/ LDS2010		
Wrn123	Unsupported configuration INFICON from BM1000	99	99		The selected configuration is not supported by the connected INFICON BM1000-fieldbus type.
Wrn125	I/O module not connected	99	99		Connection to I/O module interrupted
Wrn127	Wrong bootloader version	99	99		Boot loader not compatible with application
Err129	Incorrect device (EEPROM)	99	99		EEPROM does not contain any compatible data
Err130	Sniffer not connected	99	99		The sniffer line is not electrical connected. See also "Setting capillary surveillance [► 63]".
Wrn132	SL3000 not supported				Only the SL3000XL may be used with the XL Sniffer Adapter
Wrn150	Pressure sensor 2 is not connected	–	–		Connecting pressure sensor PSG500 to a FINE connection.
Wrn153	The version of the CU1000 software is outdated				Update of CU1000 software recommended
Wrn156	Wrong ID AQ mode				Wrong ID AQ mode
2xx operating voltage error					
Wrn201	U24_MSB too low	24	120	21.6V	24V power supply pack
Wrn202	U24_MSB too high	24	120	26.4V	24V power supply pack
Wrn203	24V_PWR12 voltage out of range (TL_valve/GB_valve)	24	120	20V 30V	Short circuit at valve 1 (calibrated leak) or valve 2 (gas ballast)
Wrn204	24V_PWR34 voltage out of range (valve 3/4)	24	120	20V 30V	Short circuit at valve 3 or valve 4
Wrn205	24V_PWR56 voltage out of range (Sniff_valve/valve6)	24	120	20V 30V	Short circuit at valve 5 (sniff) or valve 6
Wrn221	Internal voltage 24V_RC voltage out of range	24	120	20V 30V	Short circuit 24V at the control unit output

Warning (Wrn) Error (Err)	Error message LDS3000	Error number		Limit values	Cause
		LDS1000 Protocol	Binary or ASCII protocol compatibilit y mode LDS1000/ LDS2010		
Wrn222	Internal voltage 24V_IO voltage out of range	24	120	20V 30V	Short circuit 24V at IO output
Wrn223	Internal voltage 24V_TMP voltage out of range	24	120	20V 30V	Short circuit 24V of the TMP
Wrn224	Internal voltage 24V_1 (Pirani) voltage out of range	24	120	20V 30V	Short circuit 24V Pressure sensor PSG500 (1,2,3), sniffer line
Wrn240	Voltage +15V out of range	24	120		+15V too low, IF board or MSB defective
Wrn241	Voltage -15V out of range	24	120		-15V too low, short circuit at preamplifier, IF board or MSB defective
Err242	+15V or -15V voltage shorted	24	120		+15V or -15V too low, short circuit at preamplifier, IF board or MSB defective
Wrn250	REF5V voltage out of range	24	120	4.5V 5.5V	+15V or 5V too low, short circuit at preamplifier, IF board or MSB defective
Err252	REF5V voltage shorted	24	120		+15V or REF5V too low, short circuit at preamplifier, IF board or MSB defective
3xx detection system (offset preamplifier, preamplifier test, emission, cathode test)					
Wrn300	Anode voltage too low	41	132	7V < the setpoint	Short circuit anode voltage, pressure in mass spectrometer too high, IF board, MSB or ion source defective
Wrn301	Anode voltage too high	40	131	7V > the setpoint	MSB defective
Wrn302	Suppressor voltage too low	39	130	297V	Short circuit suppressor, IF board or MSB defective
Wrn303	Suppressor voltage too high	38	129	363V	MSB defective

Warning (Wrn) Error (Err)	Error message LDS3000	Error number		Limit values	Cause
		LDS1000 Protocol	Binary or ASCII protocol compatibility mode LDS1000/ LDS2010		
Wrn304	Anode-cathode voltage too low	36	127	40V	Short circuit anode-cathode, IF board or MSB defective
Wrn305	Anode-cathode voltage too high	35	126	140V	MSB defective
Err306	Anode voltage faulty	36	127	40 V deviation from the default value	The anode voltage does not match the default value or the set value is outside the allowable setting range.
Wrn310	Cathode 1 is defective	45	136		Cathode defective, line to cathode interrupted, IF board or MSB defective
Wrn311	Cathode 2 is defective	46	137		Cathode defective, line to cathode interrupted, IF board or MSB defective
Err312	Cathode defective	47	138		Cathode defective, line to cathode interrupted, IF board or MSB defective
Wrn332	System helium contaminated				Leak rate too negative (e.g., below - 0.15 * Trigger 1). The reaction time of the warning can be adjusted. See "Adjust "Zero time factor AQ" [84]"
Wrn334	Sudden increase in leak rate				Gross leak
Err340	Emission error	44	135	< 90% of the target value > 110% of the target value	Emission was stable previously, pressure probably too high, message after 15s
Wrn342	Cathode not connected	47	138		Both cathodes defective during self-testing after switch on or plug not connected

Warning (Wrn) Error (Err)	Error message LDS3000	Error number		Limit values	Cause
		LDS1000 Protocol	Binary or ASCII protocol compatibility mode LDS1000/ LDS2010		
Wrn350	Suppressor not connected	39	130		Suppressor cable is not plugged in or defective during the self-test after switching on
Wrn352	Preamplifier not connected				Preamplifier defective, cable not plugged in
Err358	Preamplifier oscillates between 2 ranges				Signal varies too much (see command 1120) Preamplifier defective
Wrn359	Overdriven preamplifier	31	123		Signal too large preamplifier defective
Wrn360	Preamplifier output too low	31	123	<-70 mV at 500 GΩ	Poor ion source or contaminated mass spectrometer
Wrn361	Preamplifier offset too high	31	123	>+/-50 mV at 500 GΩ, >+/-10 mV at 15 GΩ, <+/-10 mV at 470 MΩ, <+/-9 mV at 13 MΩ	Preamplifier defective
Wrn362	Preamplifier range error	31	123		Preamplifier or MSB box defective
Wrn390	500 G outside the range	31	123	450 GΩ 550 GΩ	Preamplifier defective, error at the suppressor, IF board or MSB defective
4xx TMP fault (also temperature)					
Err400	TMP fault number	49	15		
Wrn401	TMP warning number				
Err402	No communication with TMP	49	15		Cable to TMP / TMP defective, IF board or MSB defective
Err403	TMP rotation speed too low	53	142	< 95% of the target value	Pressure too high, TMP defective

Warning (Wrn) Error (Err)	Error message LDS3000	Error number		Limit values	Cause
		LDS1000 Protocol	Binary or ASCII protocol compatibilit y mode LDS1000/ LDS2010		
Err404	TMP current consumption too high	49	2	3A	
Err405	No TMP run-up time	60	61	5 min.	Pressure too high, TMP faulty
Err410	TMP temperature too high	49	2	61°C	Cooling failed, check MSB module operating conditions
Wrn411	High TMP temperature	49	2	60°C	Cooling failed, check MSB module operating conditions
Err420	TMP voltage too high	49	2		Power supply defective, TMP defective
Wrn421	TMP voltage too low				Cable cross-section 24 V supply for MSB modules too low, output current 24-V power supply too low (I < 10 A), power supply defective, TMP defective
Err422	TMP no run-up time	49	2	8 min.	TMP foreline pressure too high, VV pump final pressure too high, leakage high vacuum system, flood valve not close, TMP bearing damage, TMP flawed
Err423	TMP pressure rise	49	2		Inrush of air, flood valve defective or incorrectly dimensioned

5xx Pressure and flow errors

Wrn500	Pressure sensor not connected	58	144	0.5V	Pressure sensor PSG500 P1 not connected, IF board or MSB defective
Wrn502	Pressure sensor 2 not connected				Pressure sensor PSG500 P2 not connected, IF board or MSB defective.
Wrn520	Pressure too high	73	148	18 mbar	Pressure p1 too high
Wrn521	Pressure rise, anode voltage collapse	73	148	< Setpoint - 20V	Pressure p1 too high, message after 1.4s

Wrn522	Pressure rise, emission collapsed	73	148	< 90% of the target value > 110% of the target value	Emission was stable previously, pressure p1 too high, message after 5s
Wrn540	Pressure too low, Sniffer blocked	63	62	Sniffer flow warning parameter	Sniffer clogged, sniffer valve defective, filter clogged
Err541	Sniffer blocked (p1)	62	146		Sniffer blocked, sniffer valve defective (pressure lower than half of the configured warning value), filter clogged
Wrn542	Sniffer broken	64	147		Sniffer broken
Wrn550	Pressure too low, XL Sniffer blocked				Clean or replace the high flow capillary of the sniffer line. Replace dirty filter.
Wrn552	XL Sniffer broken				Replace the high flow capillary of the sniffer line.
Wrn554	XL Sniffer P2 too small	63	62		Pressure on SL3000XL too low in low flow.
Wrn556	Throttle added				Pressure too low (p1)
Err557	Throttle blocked				Pressure too low (p1)
6xx Calibration errors					
Wrn600	Calibration factor too low	81	153	0.01	Calibration leak or machine factor set incorrectly
Wrn601	Calibration factor too high	81	153	10000	Calibrated leak or machine factor set incorrectly, partial flow factor too high
Wrn602	KalFaktor lower than last calibration	81	153	< 50% of the old value	Calibrated leak, machine factor or partial flow factor has changed
Wrn603	KalFaktor higher than last calibration	81	153	> 200% of the old value	Calibrated leak, machine factor or partial flow factor has changed
Wrn604	Int. Cal. not possible, lack of calibration leak control	81	153		calibration leak is not enabled
Wrn605	Difference during calibration too small				Calibration leak defective or signal too weak.

Wrn610	Machine factor too low	81	153	1.00E-04	Machine factor adjustment inaccurate
Wrn611	Machine factor too high	81	153	1.00E+04	Machine factor adjustment inaccurate, partial flow factor too high
Wrn612	Machine factor lower than last time	81	153	< 50% of the old value	Partial flow factor has changed
Wrn613	Machine factor greater than last time	81	153	> 200% of the old value	Partial flow factor has changed
Wrn625	Int. calibration leak not set	0	0		Leak rate of int. calibration leak is still set to factory setting
Wrn626	Ext. Calibration leak not set	0	0		Leak rate of calibration leak is still set to factory setting
Wrn630	Calibration request	0	0		Among other things when changing the speed specification or preamplifier temperature by 5°C since the last calibration
Wrn650	Calibration is not recommended in the first 20 minutes				<p>A calibration during the first 20 minutes after starting (warm-up phase) the leak detector is not recommended.</p> <p>The warning message can be turned off:</p> <ul style="list-style-type: none"> - LD protocol: Bef 429 - ASCII *CONFig:CALWarn (ON,OFF)
Wrn670	Calibration error	81	153		Since a problem has occurred during the calibration, you have to recalibrate.
Wrn671	Peak not found	81	153		The signal was too restless during the peak search. Calibration has been aborted.
Wrn680	Deviation to the calibration detected	0	0		The verification of calibration has shown that you should recalibrate.
7xx temperature errors (preamplifier, electronics)					
Wrn700	Preamplifier temp. too low	33	60	2°C	Temperature too low
Wrn702	Preamplifier temp. too high	32	124	60°C	Temperature too high
Wrn710	MSB temperature too high	54	44	55°C	Temperature too high

Err711	Max. MSB temperature exceeded	54	44	65°C	Temperature too high
8xx not used					
9xx maintenance messages (e.g. TMP)					
Wrn901	Maintenance bearing/lubricant	99	99	3 years	TMP maintenance necessary
Wrn910	Maintenance diaphragm pump	99	99		8000 hour maintenance of diaphragm pump required

10.1 Illustration of error codes with the help of the status LEDs

Any errors or warnings occurring in the MSB box will be indicated both as an error code by the control unit and as a blink code by the Status LED.

The blink code is preceded by a long white signal. This is followed by an error or warning number. An error number is indicated by means of red signals, while a warning number is displayed using orange signals (the orange signals have a strong green tinge, however):

-> Blink code start: long white signal

- Hundreds digit: 0 ... 9 red signals for error or 0 ... 9 orange signals for warnings
- Break: blue signal
- Tens digit: 0 ... 9 red signals for error or 0 ... 9 orange signals for warnings
- Break: blue signal
- Units digit: 0 ... 9 red signals for error or 0 ... 9 orange signals for warnings

The blink code is repeated cyclically.

For example: The pressure is too high.

-> Error code = Warning 520

-> Blink code of the status LED: White (long), 5-orange, blue, 2-orange, blue

11 Operating CU1000 (optional)

11.1 Touchscreen elements

11.1.1 Measurement display elements

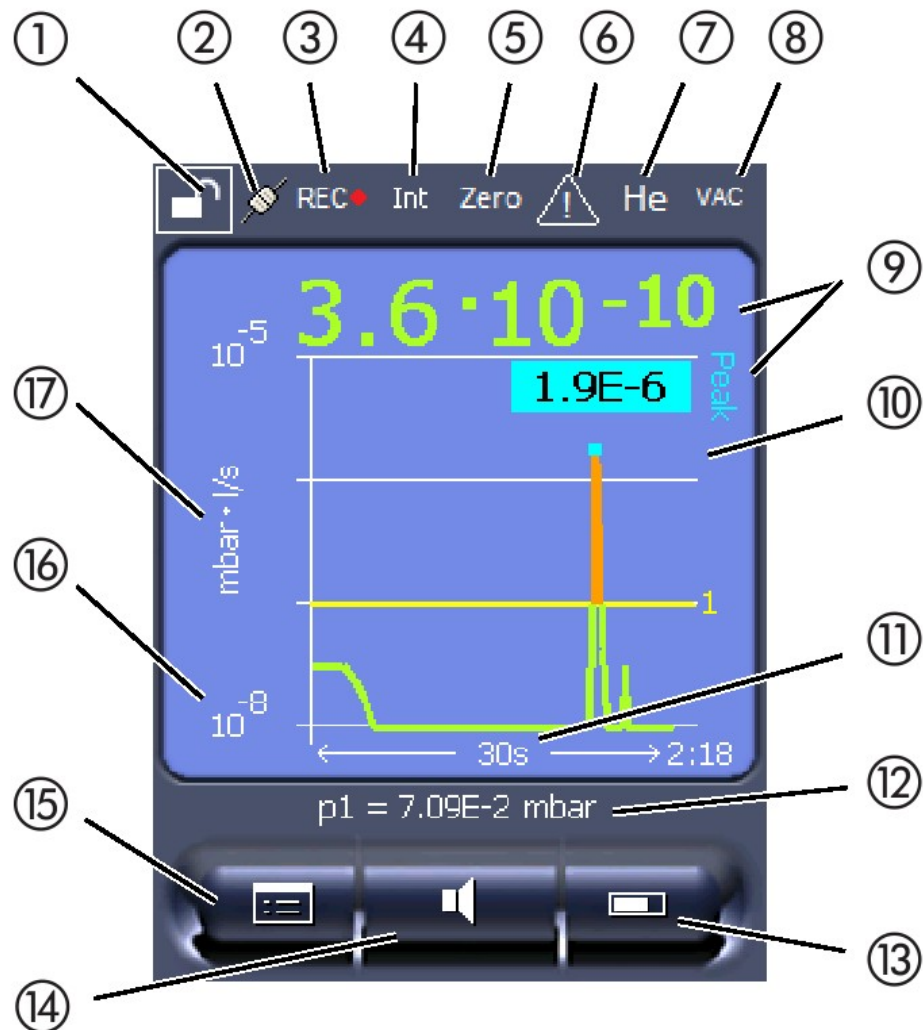

Fig. 19: Measurement display

1	Keyboard lock	2	Communication status	3	Data recording
4	Operator	5	ZERO	6	Message
7	Tracer gas	8	Operation mode	9	Leak rate with peak hold function
10	Graphic representation of the leak rate and the peak hold function	11	Time axis	12	Foreline pressure
13	Button "Favorite 2"	14	Button "Favorite 1"	15	Menu
16	Value axis	17	Value axis		

1 - Keyboard lock

The control unit is locked or unlocked by pressing and holding the icon for the keyboard lock.

2 - Icon for the communication status

- Icon connected: The device communicates with the mass spectrometer module.
- Icon disconnected: The device does not communicate with the mass spectrometer module.

Establish communication:

- 1 Reset control unit.
- 2 Checking the status of the mass spectrometer module.
- 3 Check cable connection.

3 - Icon for the data recording

The measurement is recorded.

4 - Ser

The registered operator is shown abbreviated.

Display	Meaning
Ope	Operator
Sup	Supervisor
Int	Integrator
Ser	Service

For more information, see "Operator types and authorizations [► 116]".

5 - Zero

Background suppression is active.

6 - Caution icon

Active warnings are stored in the unit.

The active warnings can be displayed via the menu "Info > History > Active warnings".

7 - Tracer gas

Set tracer gas and tracer gas concentration percentage.

Display	Meaning
He	Helium (^4He)
H2	Hydrogen

Display	Meaning
M3	E.g. H-D, $_3\text{He}$ or H_3

8 - Operation mode

Configured operation mode

Display	Operation mode
VA	Vacuum
SNIF	Sniffing
LOW FLOW	XL sniffer adapter in LOW FLOW
HIGH FLOW	XL sniffer adapter in HIGH FLOW
Standby	XL sniffer adapter in HIGH FLOW on standby

9 - Leak rate

Current measurement for the leak rate.

10 - Graph

Graphic display of the leak rate $Q(t)$.

11 - Leak rate

Time axis of the leak rate $Q(t)$.

12 - Primary vacuum pressure (not with operation mode XL Sniffer Adapter)

Backing pressure p_1 .

13 - Button "Favorite 2"

You can assign preferred parameters to this button, see "Touch screen settings [▶ 113]". In the figure in "Measurement display elements [▶ 109]", the "Favorite 2" button is assigned the function "Start / Stop", for example.

14 - Button "Favorite 1"

You can assign preferred parameters to this button, see "Touch screen settings [▶ 113]". In the figure in "Measurement display elements [▶ 109]", the button "Favorite 1" is assigned with the function "ZERO", for example.

15 - Icon for the menu

All functions and parameters of the control unit can be accessed using the "Menu" key .

A full display of the menu of the menu is included as a file on the USB flash drive supplied with the LDS3000.

16 - Value axis

Value axis of the leak rate $Q(t)$.

17 - Device of measurement

Device of measurement of the value axis.

11.2 Elements of the error and warning display



You will find an overview of possible errors and warnings in the operating instructions of the LDS3000 (mass spectrometer module), chapter "Warning and error messages".

11.3 Settings and functions

Settings and functions of the control unit are explained in the following. You will find the settings and functions of the mass spectrometer module LDS3000 you can set using the control unit in the operating instructions of the mass spectrometer module.

11.3.1 Touch screen settings

The touch screen grays out the parameters if

- the user is not authorized to modify the values,
- the older version of the software run by mass spectrometer module LDS3000 does not support this parameter.

Scaling of the Q(t)axis

Linear or logarithmic	
Lin.	
Log.	
Control unit	Display > Q(t) axis > Linear or logarithmic
Number of decades with logarithmic view	
1	
2	
3	
4	
Control unit	Display > Q(t) axis > Decades
Autoscale	
Off (When "Off", you can change the appearance by pressing the intersection of the coordinate axes, then flicking and releasing the desired axis with your finger, or by pressing and releasing the end of the desired co-ordinate axis)	
On	
Control unit	Display > Q(t) axis > Auto scale

Scaling of the time axis

Scaling of the time axis	
15 s	240 s
30 s	480 s
60 s	960 s
120 s	
Control unit	Display > Time axis > Time axis scale

Display units

Device of pressure	
Mbar	Atm
Pa	Torr
Control unit	Display > Units (display) > Pressure unit

Measured value display	Type of graphic display	
	Diagram	
	Bar graph	
	Control unit	Display > Measurement view > Measurement view mode
	Numeric representation of the measurements	
Display brightness	Off	
	On	
	Control unit	Display > Measurement view > Show value
	Display brightness	
	20 ... 100%	
Trigger display on the touch screen		
	Control unit	
	Display > Brightness > Display brightness	
	Selection of the trigger (leak rate threshold) displayed on the touch screen.	
	1	
	2	
Assigning favorite buttons	3	
	4	
	Control unit	Settings > Trigger > Trigger sel.
	The favorite buttons offer direct access to individual functions. They can be assigned with access control "Supervisor" or higher by the user.	
	Favorite 1: Middle button (see the figure in "Measurement display elements [► 109]").	
	Favorite 2: Right button	
	Favorite 3: Button on the bottom right of the main menu.	
	CAL	Volume
	ZERO (at AQ instead of ZERO: ZERO AQ)	- - - (= without function)
	Measurement view	Check CAL
	Start/Stop	Flow control
Display of messages on the touch screen	Display settings	(At AQ additionally: AQ Wizard)
	Control unit	Settings > Favorites > Favorite 1 (2, 3)
Display of messages on the touch screen	Warnings and error messages can be displayed on the touch screen.	
	Off	

	On
	Control unit Settings > Set up > Control unit > Messages > Show warnings
Show calibration note	<p>Suppress or allow the calibration note with the following content:</p> <ul style="list-style-type: none"> • Leak rate of the applied calibration leak • No calibration should take place during the first 20 mins <p>OFF (suppressed)</p> <p>ON (allowed)</p>
	Control unit Settings > Set up > Control unit > Messages > Show calibration notes
Show calibration request	<p>The calibration request can be allowed or suppressed.</p> <p>OFF (suppressed)</p> <p>ON (allowed)</p>
	Control unit Settings > Set up > Control unit > Messages > Show calibration request
Display of messages on the touch screen	<p>Warnings and error messages can be displayed on the touch screen.</p> <p>Off</p> <p>On</p>
	Control unit Settings > Set up > Control unit > Messages > Show warnings
Setting the audio alarm	<p>Volume of the headphones or active speaker</p> <p>--- No sound</p> <p>Proportional: The frequency of the audible signal is proportional to the bar graph display or diagram height. The frequency range is 300 Hz to 3300 Hz.</p> <p>Setpoint: The pitch is proportional to the leak rate. The signal sounds if the leak rate exceeds the selected trigger value.</p> <p>Pinpoint: The sound of the acoustic signal changes its frequency within a specific range of leak rates. Range: A decade below the selected trigger threshold up to one decade above. The sound keeps at a constant low and a constant high frequency below and above this range, respectively.</p> <p>Trigger: If the selected trigger threshold is exceeded, a two-pitch signal sounds.</p>
	Control unit Settings > Set up > Control unit > Audio > Audio alarm mode

Behavior with warnings or error messages: If the touch screen shows a warning or an error, then a two-pitch signal sounds simultaneously.

Automatic switch off of the touch screen

The touch screen can be switched off automatically after a specific time without any operation to save energy.

30 s	10 min
1 min	30 min
2 min	1 h ∞ (=never)
5 min	

Control unit	Settings > Set up > Control unit > Energy > Display off after
--------------	---

11.3.2 Operator types and authorizations

There are four different operator types that are distinguished by different authorizations. The integrator is registered ex works.

Additional operators can be registered. The following table shows options for individual operator types to register new operator types.

Operator registration

Viewer	Operator	Supervisor	Integrator
-	Operator	Supervisor	Integrator
	Viewer	Operator	Supervisor
		Viewer	Operator
			Viewer

For the types "Integrator", "Supervisor" and "Operator", a four-digit PIN must be assigned during registration (0000 ... 9999). "0000" is assigned to all operators ex works.

If an operator keeps the pin "0000", this operator will always be registered is during the start up of the system (without PIN query).

A key-operated switch can be used in addition to a PIN if an I/O module is connected. The key-operated switch is connected to the I/O module via three digital inputs (see operating instructions of the LDS3000).

The following table shows the authorizations of individual operator types.

Function	Viewer	Operator	Supervisor	Integrator
Changing parameters	-	x	x	x
Changing the display of error information	-	x	x	x

Function	Viewer	Operator	Supervisor	Integrator
Calling up factory settings	-	-	-	x
Entering maintenance history	-	-	-	x

The menu "Service" is accessible only to INFICON service staff.

Load parameters

The saved/backed-up parameters of control unit CU1000 and of the mass spectrometer module can be loaded from a USB stick.

Control unit

Function > Data > Parameters > Load

Save parameters

The parameters of control unit CU1000 and of the mass spectrometer module can be saved to a USB flash drive.

Control unit

Function > Data > Parameters > Save

Display error information

The type of error information can be set differently for each operator type. The Integrator always receives the complete information.

Number: Message number

text: Brief description

Info: Expanded message information

- Only numbers
- Number and text
- Number, text and info

Control unit

Function > Data > Parameter > Error info
Viewer (Operator, Supervisor)

Parameter list display and change

Parameters can be displayed as an alphabetical list with names and current values. Each list entry is a button which, when pressed, will open the parameter's set-up dialog box.

Control unit

List > Parameters list **or**:

Functions > Data > Parameters > List

Display list of parameter change authorizations

Parameters can be displayed as an alphabetical list with names and current change authorizations. Each list entry is a button which, when pressed, will change access control. Changes are possible in accordance with the hierarchy of the operator.

Control unit

Functions > Data > Parameters >
Parameter Access

11.3.2.1 Logging out the operator

The operator activates access level "Viewer" to log out. "Access Ctrl > Viewer"

11.3.3 Functions

11.3.3.1 Resetting the settings

Mass spectrometer module	The settings of the mass spectrometer module can be reset to factory settings.	
	Control unit	Functions > Data > Parameters > Reset > MSB settings
Access controls	The authorization for changing parameters can be reset to factory setting.	
	Control unit	Functions > Data > Parameters > Reset > Param. access control
Control unit	The control unit settings can be reset to factory settings.	
	Control unit	Functions > Data > Parameters > Reset > Control unit settings

11.3.3.2 Recording data

The data is saved as a TXT file. Each TXT file contains the following information:

- Date created
- Software version
- Serial number
- Start time
- Time stamp (measurement indicates offset in seconds in relation to start time)
- File name
- Time stamp (offset in seconds in relation to start time)
- Leak rate (expressed in selected unit)
- Pressure p1 (expressed in selected unit)
- Device status

Switching on/off	Switching data recording on/off	
	<ul style="list-style-type: none"> • Off • ON 	
	Control unit	Functions > Data > Recorder > Settings > Data recording
Record interval	Time interval between data recordings	
	<ul style="list-style-type: none"> • 100 ms, 200 ms, 500 ms, 1 s, 2 s, 5 s 	
	Control unit	Functions > Data > Recorder > Settings > Record interval

Memory location	The data stored in the control unit can be saved to a USB stick. The memory in the control unit is limited to the recording of a 24-hour measurement.	
	<ul style="list-style-type: none"> • USB flash drive • Control unit 	
	Control unit	Functions > Data > Recorder > Settings > Storage location
Copy data	The data stored in the control unit can be saved to a USB stick. The memory in the control unit is limited to the recording of a 24-hour measurement.	
	<ul style="list-style-type: none"> • USB flash drive • Control unit 	
	Control unit	Functions > Data > Recorder > Copy > Copy files
Deleting data	The data stored in the control unit can be saved to a USB stick. The memory in the control unit is limited to the recording of a 24-hour measurement.	
	<ul style="list-style-type: none"> • USB flash drive • Control unit 	
	Control unit	Functions > Data > Recorder > Delete > Delete files

11.3.3.3 Calling up information

Different information and states of the system can be called up with the info menu.

Measurement values	<ul style="list-style-type: none"> • Preamplifier • Environment • TMP
Temperature	<ul style="list-style-type: none"> • Electronic • TMP
Energy and operating hours	<ul style="list-style-type: none"> • Energy values: Information on consumption values • Operation hours: Display for operating hours • Supply voltages: Information on internal supply voltages • Power supply: Information on the supply voltages of the components
History	<ul style="list-style-type: none"> • Error, error history / warning history • Calibration, calibration history • TMP error, TMP history • Warnings, active warnings • Maintenance, maintenance history
Control unit	<ul style="list-style-type: none"> • Version control unit: Information on the software version

	<ul style="list-style-type: none">• Memory: Information on available memory• Settings: Control unit settings.• Serial port wired: Information on the communication connection• Data exchange: Information on the data exchange between mass spectrometer module and the control unit
Mass spectrometer module	<ul style="list-style-type: none">• MSB (1): Information on the software version• MSB (2): Information on operating parameters• TMP controller (1): Information on the turbo molecular pump• TMP controller (2): Information on the turbo molecular pump, continued• Ion source: Information on the ion source used• Preamplifier: Information on the preamplifier• Preamplifier test: Information on the preamplifier test.
Interfaces	<ul style="list-style-type: none">• I/O module (1): Information on the software version, inputs and outputs• I/O module (2): Visualized information to the digital inputs

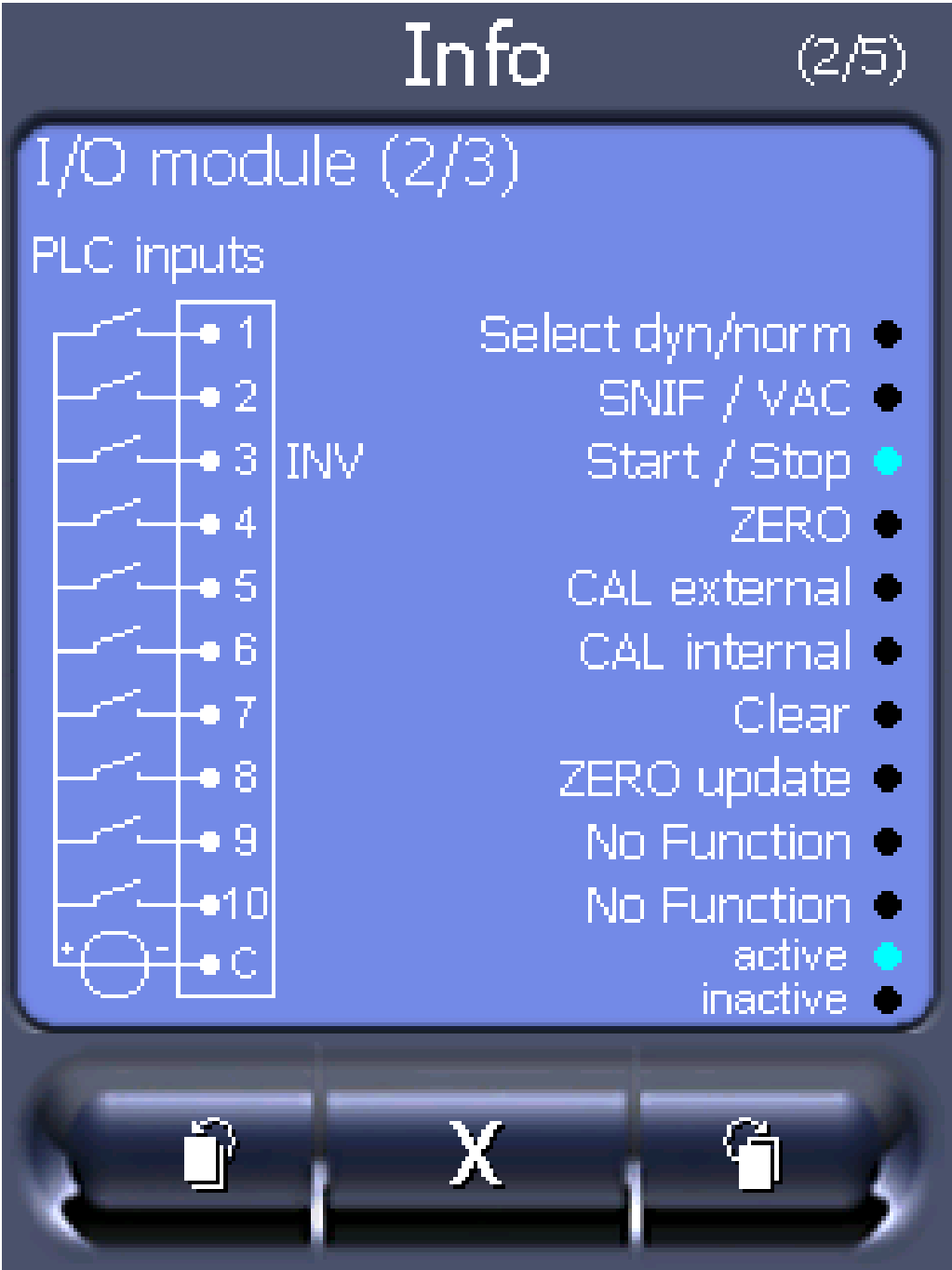

Fig. 20: I/O module (2): Visualized information to the digital inputs

1	Input signal condition	2	Configured function (INV = Function is inverted)
3	Status of the function (active or inactive)		

- I/O module (3): Visualized information to the digital outputs

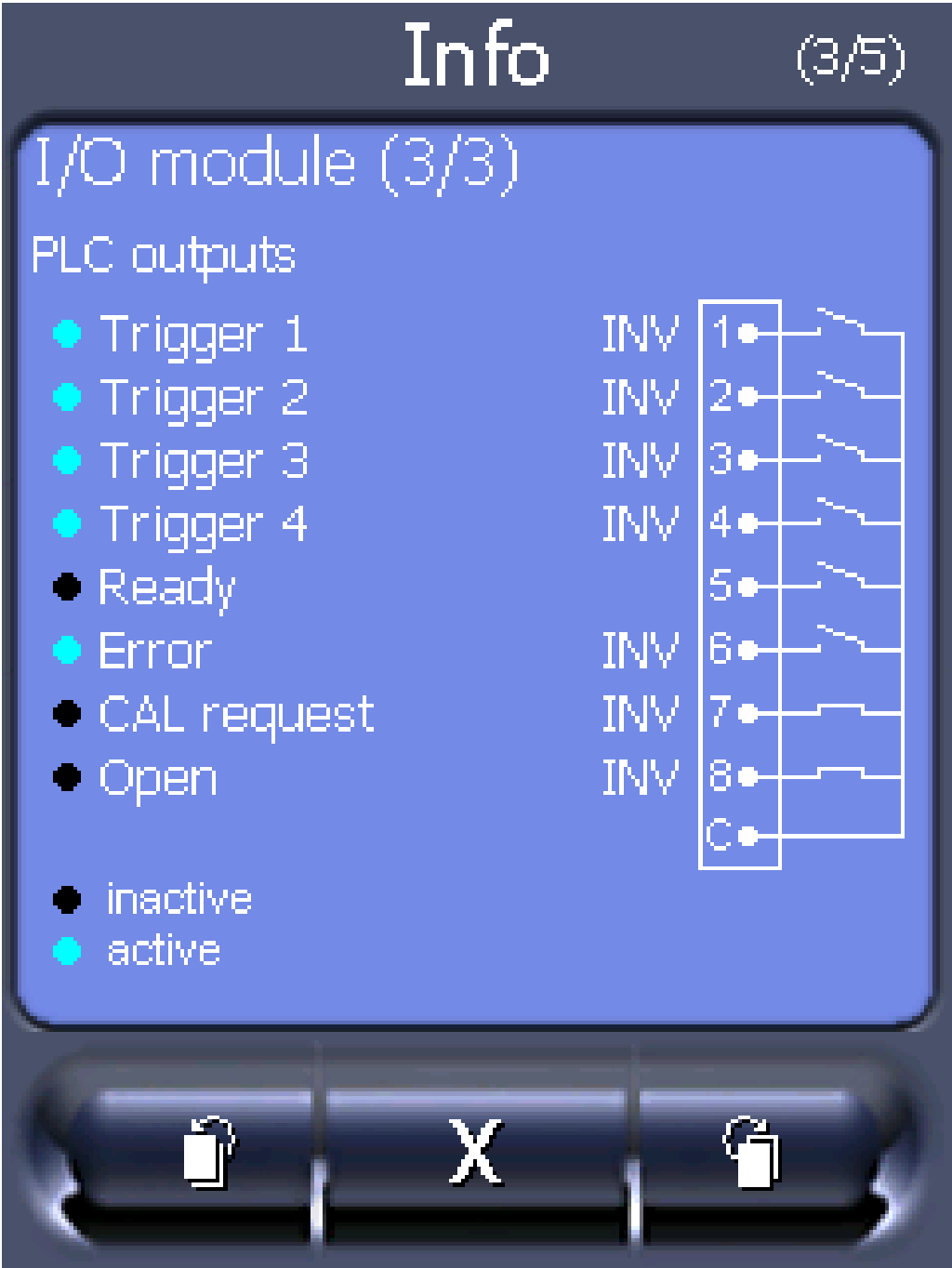

Fig. 21: Visualized information to the digital outputs

1	Configured function (INV = Function is inverted)	2	Output signal condition
3	Status of the function (active or inactive)		

- Bus module (1): Information on the bus module
- Bus module (2): Information on the bus module, continued

11.3.4 Updating the software

Software updates from INFICON are installed with the aid of a USB flash drive. The update function of the device can be found under "Functions > Data > Update".

An update is possible,

- if one or several updates are available on the USB flash drive, but only one update per type at most (control unit, MSB box, I/O module),
- if these parts are also connected free of disturbances and have an update function.

The corresponding buttons in the update menu such as "Control Unit", "MSB Box", and "I/O Module" are active and can be activated individually.

NOTICE

Aborted connection

Data loss due to an aborted connection

- Do not switch off the device and do not remove the USB flash drive while the software is being updated!

- Switch the device off and back on after a software update has taken place.

11.3.4.1 Updating the software of the control unit

The software is included in two files named Handset_IFC_Vx.xx.xx.exe and Handset_IFC_Vx.xx.xx.key.

- 1 Copy the file into the main directory of a USB flash drive.
- 2 Connect the USB flash drive to the USB port on the device.
- 3 Select: "Functions > Data > Update > Control unit".
 - ⇒ Do not switch off the device and do not remove the USB flash drive while the software is being updated!
- 4 Check the version information.
- 5 Select the "Start" button to start the update. Do not switch off the device and do not remove the USB flash drive while the software is being updated!
- 6 Follow the instructions on the touchscreen and wait until the update is complete.

11.3.4.2 Checking and updating the software version of the MSB box

The current software is available from the Inficon support.

The functions of the XL Sniffer adapter set are taken into consideration in system software version 2.11 or higher.

- 1** Copy the file Flash_LDS3000_MSB_Vxx.xx.xxx.bin into the main directory of a USB flash drive.
- 2** Connect the USB flash drive to the USB port on the device.
- 3** Select: "Functions > Data > Update > MSB".
 - ⇒ The display shows information on the current and the new software version as well as on the boot loader.
- 4** Check the version information.
 - ⇒ Select the "Start" button to start the update.
 - ⇒ Do not switch off the device and do not remove the USB flash drive while the software is being updated! Do not switch off the device and do not remove the USB flash drive while the software is being updated!
- 5** Follow the instructions on the touchscreen and wait until the update is complete.
- 6** If the system displays warning 104 or 106, confirm with "C".

11.3.4.3 Updating the software of the I/O module

The software of the I/O module can be updated from the control unit if the mass spectrometer module has the software version "MS module 1.02" or higher.

- 1** Copy the file Flash_LDS3000_IO_Vxx.xx.xxx.bin into the main directory of a USB flash drive.
- 2** Connect the USB flash drive to the USB port on the device.
- 3** Select: "Functions > Data > Update > I/O module"
 - ⇒ The display shows information on the current and the new software as well as on the current boot loader.
- 4** Check the version information.
- 5** Select the "Start" button to start the update.
 - ⇒ Do not switch off the device and do not remove the USB flash drive while the software is being updated!
- 6** Follow the instructions on the touchscreen and wait until the update is complete.
 - ⇒ The following tips are shown after selecting the "Start" button on the touchscreen:
 - Connect and switch on the IO1000.
 - Activate boot mode (switch DIP S2.3 on and off once).
 - When the STATUS LED flashes green, press OK.

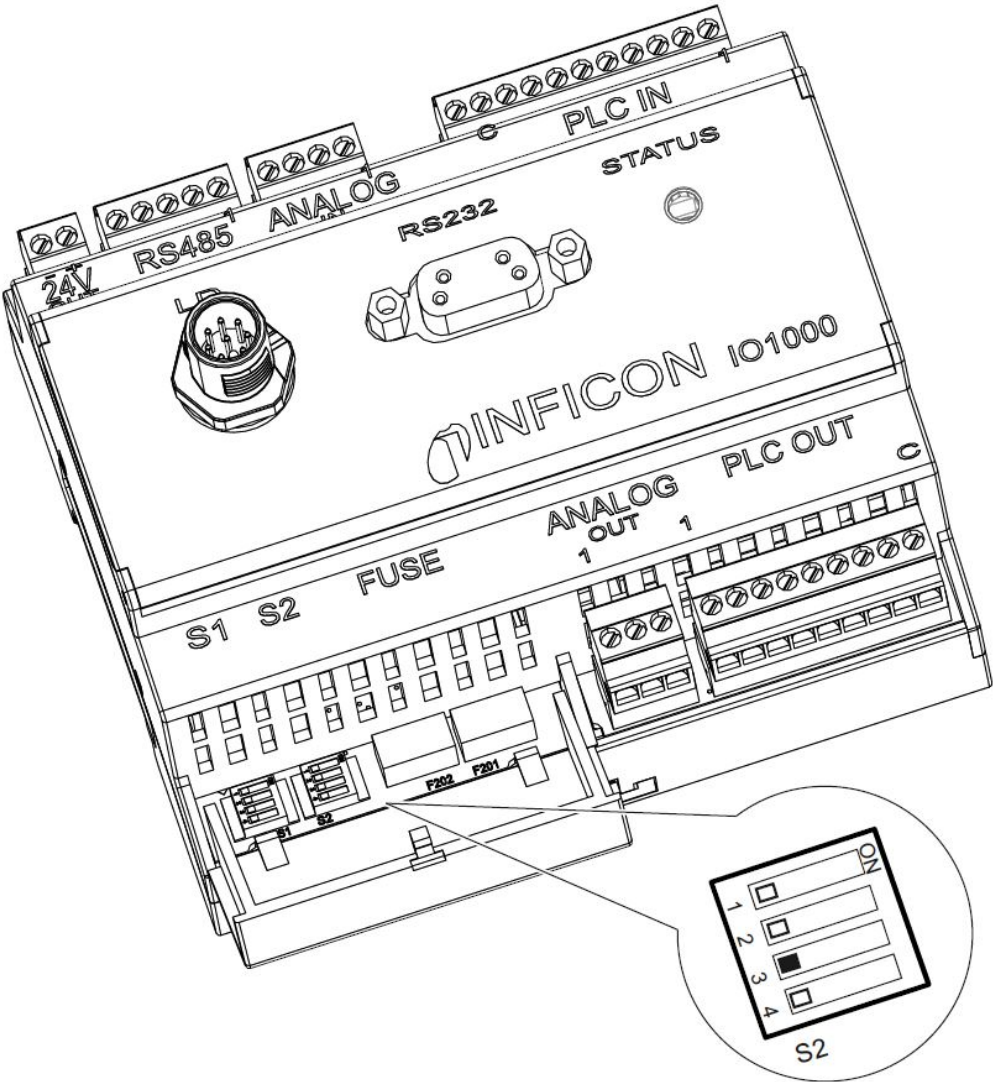

Fig. 22: DIP switch on the I/O module

12 Maintenance

The mass spectrometer module is a leak testing unit that is intended for industrial applications. The device is composed of parts and assemblies that are, for the most part, low maintenance.

Servicing the mass spectrometer module merely requires that you change the oil reservoir of the turbo molecular pump and check the fan on the turbo molecular pump.

We recommend that you sign a service agreement with INFICON or one of INFICON's authorized service partners.

12.1 Maintenance at INFICON

WARNING

Danger to health

Contaminated devices could endanger the health of INFICON employees.

- ▶ Fill in the declaration of contamination completely.
- ▶ Attach the declaration of contamination to the outside of the packaging.

The declaration of contamination is a legal requirement and serves to protect our employees. INFICON sends devices which are sent without a completed declaration of contamination back to the sender. See "Declaration of Contamination [▶ 136]".

12.2 General maintenance information

The maintenance work that needs to be performed on the mass spectrometer module is grouped into three service levels:

- Service level I: Customer without any technical training
- Service level II: Customer with technical and INFICON training
- Service level III: INFICON Service

DANGER

Life threatening hazard from electric shock

High voltages are inside the device. Touching parts where electrical voltage is present can result in death.

- ▶ Disconnect the device from the power supply prior to any maintenance work.

NOTICE

Material damage from pollution

The mass spectrometer module is a precision measurement device. Even little pollution can already damage the device.

- Make sure that the working environment is clean and you use clean tools whenever performing any maintenance work.

12.3 Maintenance plan

If the maintenance work of the maintenance plan is not carried out, the warranty for the mass spectrometer module is void.

Maintenance work	Operating hours	24	8000	16000	24000	36000	Service level
	Duration		1 years	2 years	3 years		
Turbo-molecular pump	Changing the oil wick cartridge, spare part no.: 200003801				X2		II and III
	Replace bearing (recommended)					X2	III
	Clean fan and check for proper operation		1				I and II
Accessories	Clean sniffer valve		X				III
	Calibrate internal calibration leak		X2				III
Internal calibration	Perform internal calibration	X1					I
External calibration	Perform external calibration	X1					I
Leak test MS module	Perform helium leak test on MS module		X				III

X: after operating hours or time period

X1: after operating hours

X2: by duration

1: depending on environment and use

12.4 Maintenance work

12.4.1 Change oil reservoir of turbo molecular pump

Spare part kit oil reservoir	P/N: 200003801
Scope of delivery: Oil reservoir with small O-ring (1 piece), Porex rods (8 pieces), O-ring for cover (1 piece)	
Face spanner	P/N: 551-200

The turbo molecular pump is filled with an operating fluid for the lubrication of the ball bearings. The oil reservoir must be replaced every 2 years at the latest. With extreme strain of the pump or in unclean processes, the lubricant reservoir must be replaced at shorter intervals.

The cover of the oil reservoir can be unscrewed only when the turbo molecular pump is flooded.

Flood the turbo molecular pump

- 1 Shut down mass spectrometer module, see "Decommissioning the measuring instrument [► 133]".
- 2 Wait until turbo molecular pump is drained (at least 1 min).
- 3 Disconnect 24 V power supply pack from MSB box.
- 4 Allow the turbo molecular pump to cool down if necessary.
- 5 Remove turbo molecular pump.
- 6 Open the ventilation screw (1) slowly.

⇒ Turbo molecular pump is flooded until it reaches atmospheric pressure.

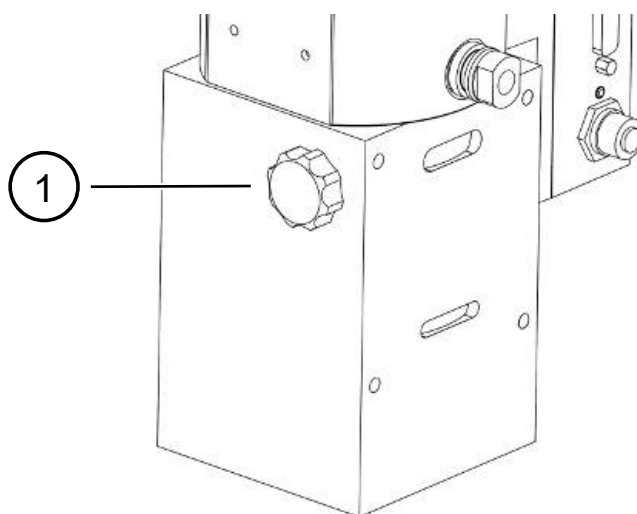

Fig. 23: Turbo molecular pump SplitFlow 80

1	Ventilating screw
---	-------------------

Removing old oil wick cartridge



⚠ WARNING

Danger of poisoning due to harmful substances

The oil wick cartridge and parts of the turbo molecular pump can be contaminated with toxic substances that are contained in the pumped media.

- ▶ Take suitable safety precautions.
- ▶ Decontaminate contaminated parts prior to any maintenance work.
- ▶ Dispose of old oil reservoirs in compliance with applicable regulations.

NOTICE

Damage to the turbo molecular pump due to loosening of screws

To remove the oil reservoir, unscrew only the cover. Do not loosen any screws underneath the cover! Otherwise the pump will be irreparably damaged.

- ✓ Face spanner, P/N: 551-200
 - ✓ Two screwdrivers
 - ✓ Mass spectrometer and turbo molecular pump flooded.
- 1 Unscrew the cover (1) using a face spanner.
 - 2 Use two screwdrivers to lift out the oil reservoir (2). Do not loosen any screws!

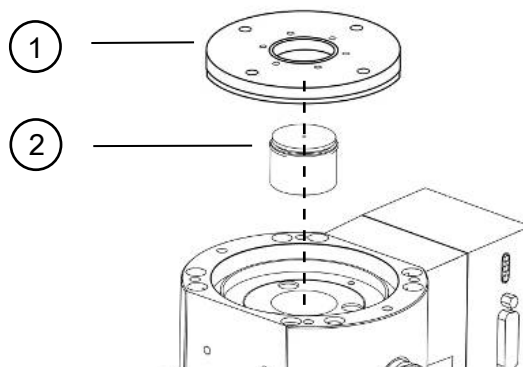

1 Cover

2 Oil reservoir

Exchange Porex rods

NOTICE

Material damage due to cleaning liquids

Cleaning liquids can damage the unit.

- ▶ Do not use any cleaning liquids.
- ▶ Use a clean, lint-free cloth.

✓ Tweezers

✓ Porex rods

- 1 Pull out old Porex rods (1) (8 pieces) with tweezers.
- 2 Remove any contaminants found on the turbo molecular pump and the cover using a clean, lint-free cloth.
- 3 Insert new Porex rods (1) (8 pieces) with tweezers.

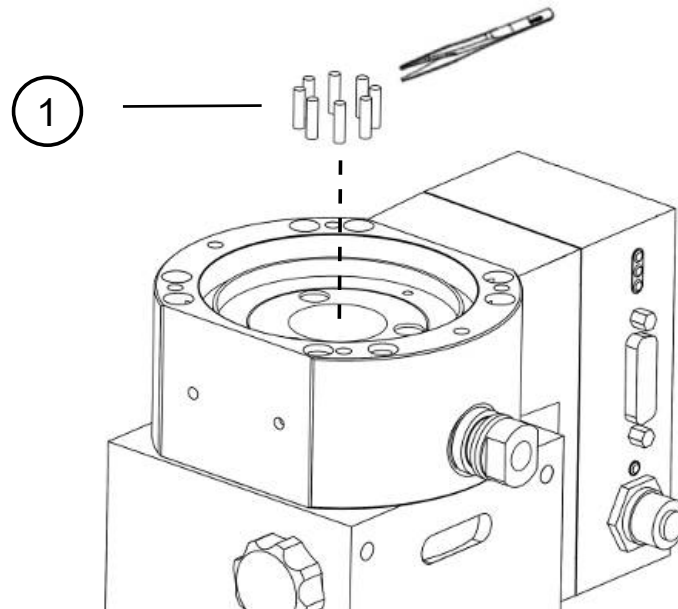

1 Porex rods

Inserting a new oil reservoir

NOTICE

Material damage if o-ring is mounted improperly

An improperly mounted o-ring can cause leaks. The device will experience malfunctions and become damaged.

- Carefully insert the O-ring of the cover.

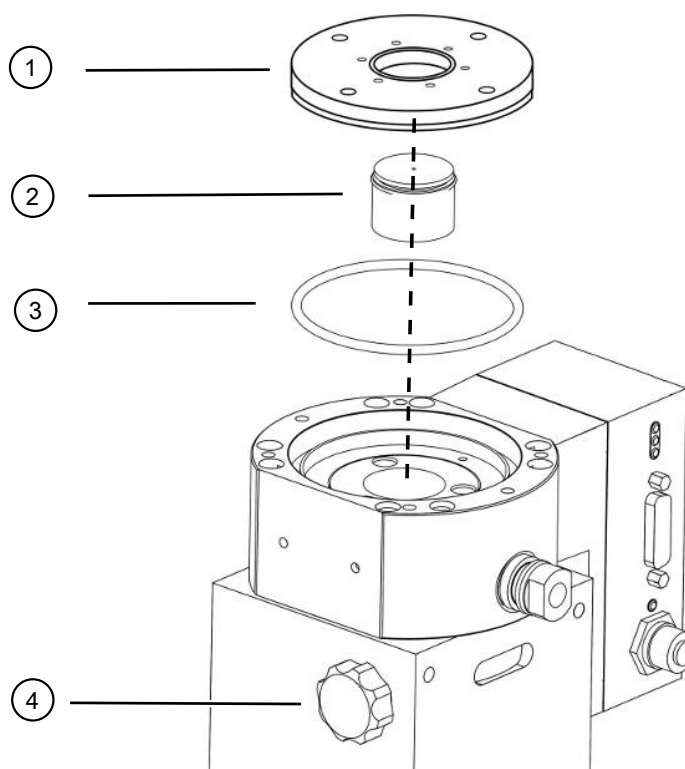

1	Cover	2	Oil reservoir with O-ring
3	O-ring for cover	4	Ventilating screw

- ✓ Face spanner
 - ✓ New O-ring for cover
 - ✓ New oil reservoir
 - ✓ The new oil reservoir contains a sufficient level of operating fluid. Do not fill in any more operating fluid.
- 1 Check the expiration date of the new oil reservoir (2).
 - 2 Do not push the new oil reservoir (2) into the pump at full height, but only up to the O-ring of the oil reservoir.
 - ⇒ The new oil reservoir is correctly positioned by screwing in the cover (1).
 - 3 Remove the old O-ring (3) from the cover.
 - 4 Insert a new O-ring (3) for the cover.
 - ⇒ To prevent the threads from tilting, place the cover (1) on it and slowly turn it counterclockwise until the threaded ends of the cap and pump fit into each other. As soon as this is achieved, the cover will slightly sink back into the pump. This position allows the threads to mesh better.
 - 5 Screw in the cover (1) with a face spanner without any effort.
 - 6 Tighten the cover with a torque of 13 Nm +/-10%.
 - 7 Hand-tighten the ventilation screw (4).
 - 8 Install the turbo molecular pump.
 - 9 Put the mass spectrometer module into operation.

Confirm maintenance work

- ✓ Control unit installed
- ✓ Access = Integrator
- ▶ Confirm maintenance work on control unit: "Access ctrl > Integrator > Maintenance > Maintenance work"

13 Decommissioning the measuring instrument

13.1 Shutting down the leak detector

- 1 Switch off the leak detector on the power supply pack.
- 2 Wait until the turbo molecular pump has stopped running.

13.2 Disposing of the mass spectrometer module

The operator can dispose of the device or it can be sent to INFICON.

The device consists of materials that can be recycled. This option should be exercised to prevent waste and also to protect the environment.

- For disposal, always comply with local and regional environmental and safety regulations.

13.3 Returning the mass spectrometer module



WARNING

Danger due to harmful substances

Contaminated devices could endanger the health. The contamination declaration serves to protect all persons who come into contact with the device.

- Fill in the declaration of contamination completely.

- 1 Please do not hesitate to contact the manufacturer and send a completed declaration of contamination before sending anything to us.
⇒ You will then receive a return number.
- 2 Use the original packaging when returning.
- 3 Before sending the device, attach a copy of the completed contamination declaration. See Declaration of Contamination [► 136].

14 Appendix

14.1 CE Declaration of Conformity



We – INFICON GmbH - herewith declare that the products defined below meet the basic requirements regarding safety and health and relevant provisions of the relevant EU Directives by design, type and the versions which are brought into circulation by us. This declaration of conformity is issued under the sole responsibility of INFICON GmbH.

In case of any products changes made without our approval, this declaration will be void

Designation of the product:

Mass spectrometer module

Models: **LDS3000**
LDS3000 AQ

Catalogue numbers:

560-300

560-600

Cologne, January 16th, 2018

Dr. Döbler, President LDT

The products meet the requirements of the following Directives:

- **Directive 2014/30/EU (Electromagnetic Compatibility)**
- **Directive 2011/65/EC (RoHS)**

Applied harmonized standards:

- **DIN EN 61326-1:2013**
Class A according to EN 55011
- **DIN EN 50581:2013**

Cologne, January 16th, 2018

Bausch, Research and Development

INFICON GmbH
Bonner Strasse 498
D-50968 Cologne
Tel.: +49 (0)221 56788-0
Fax: +49 (0)221 56788-90
www.inficon.com
E-mail: leakdetection@inficon.com

14.2 Declaration of Incorporation



EC DECLARATION OF INCORPORATION

We – INFICON GmbH - herewith declare that the products defined below meet the basic requirements regarding safety and health and relevant provisions of the relevant EC Directives by design, type and the versions which are brought into circulation by us.

In case of any products changes made without our approval, this declaration will be void.

Designation of the product:

Mass spectrometer module

Models: **LDS3000**
LDS3000 AQ

Catalogue numbers:

560-300

560-600

The products meet the requirements of the following Directives:

- **Directive 2006/42/EC (Machinery)**

Applied harmonized standards:

- **EN ISO 12100:2010**
- **EN 61010-1:2010**

The partly completed machinery must not be put into service until the final machinery into which it is to be incorporated has been declared in conformity with the provisions of this Directive (2006/42/EC), where appropriate.

The manufacturer will electronically transmit, in response to a reasoned request by the national authorities, relevant information on the partly completed machinery.

The relevant technical documentation is compiled in accordance with part B of Annex VII.

Authorised person to compile the relevant technical files:

Rene Bausch, INFICON GmbH, Bonner Strasse 498, D-50968 Köln

The following essential health and safety requirements according to Annex II of Directive 2006/42/EC were fulfilled:

1.1.2, 1.1.3, 1.1.5, 1.2.1, 1.2.6, 1.3.1, 1.3.2, 1.3.3, 1.3.4, 1.3.7, 1.5.1, 1.5.2, 1.5.4, 1.5.5, 1.5.6, 1.5.8, 1.5.9, 1.5.10, 1.5.11, 1.5.13, 1.6.1, 1.6.3, 1.7.2, 1.7.3, 1.7.4

Cologne, June 03rd, 2019

Böhm, Vice President LDT

Cologne, June 03rd, 2019

Bausch, Research and Development

INFICON GmbH
Bonner Strasse 498
D-50968 Köln
Tel.: +49 (0)221 56788-0
Fax: +49 (0)221 56788-90
www.inficon.com
E-mail: leakdetection@inficon.com

14.3 Declaration of Contamination

Declaration of Contamination

The service, repair, and/or disposal of vacuum equipment and components will only be carried out if a correctly completed declaration has been submitted. Non-completion will result in delay.
This declaration may only be completed (in block letters) and signed by authorized and qualified staff.

1 Description of product Type _____ Article Number _____ Serial Number _____	2 Reason for return _____ _____
--	--

3 Operating fluid(s) used (Must be drained before shipping.) _____
--

4 Process related contamination of product:	
toxic no <input type="checkbox"/> 1) caustic no <input type="checkbox"/> 1) biological hazard no <input type="checkbox"/> explosive no <input type="checkbox"/> radioactive no <input type="checkbox"/> other harmful substances no <input type="checkbox"/> 1)	yes <input type="checkbox"/> yes <input type="checkbox"/> yes <input type="checkbox"/> 2) yes <input type="checkbox"/> 2) yes <input type="checkbox"/> 2) yes <input type="checkbox"/> 2) yes <input type="checkbox"/>

The product is free of any substances which are damaging to health yes ☐

1) or not containing any amount of hazardous residues that exceed the permissible exposure limits

2) Products thus contaminated will not be accepted without written evidence of decontamination!

5 Harmful substances, gases and/or by-products Please list all substances, gases, and by-products which the product may have come into contact with:			
Trade/product name	Chemical name (or symbol)	Precautions associated with substance	Action if human contact

6 Legally binding declaration: I/we hereby declare that the information on this form is complete and accurate and that I/we will assume any further costs that may arise. The contaminated product will be dispatched in accordance with the applicable regulations.	
Organization/company _____ Address _____ Phone _____ Email _____ Name _____	Post code, place _____ Fax _____
Date and legally binding signature _____	Company stamp _____

Copies:
Original for addressee - 1 copy for accompanying documents - 1 copy for file of sender

14.4 RoHS

Restriction of Hazardous Substances (China RoHS)

有害物质限制条例（中国 RoHS）

	LDS3000, LDS3000 AQ: Hazardous Substance LDS3000, LDS3000 AQ: 有害物质					
Part Name 部件名称	Lead (Pb) 铅	Mercury (Hg) 汞	Cadmium (Cd) 镉	Hexavalent Chromium (Cr(VI)) 六价铬	Polybrominated biphenyls (PBB) 多溴联苯	Polybrominated diphenyl ethers (PBDE) 多溴联苯醚
Assembled printed circuit boards 组装印刷电路板	X	O	O	O	O	O
Magnetic system 磁系统	X	O	O	O	O	O
USB stick U 盘	X	O	O	O	O	O
MSB box housing MSB 机箱	X	O	O	O	O	O
Fan 风扇	X	O	O	O	O	O
Vacuum connection block 真空接线板	X	O	O	O	O	O
<p>This table is prepared in accordance with the provisions of SJ/T 11364. 本表是根据 SJ/T 11364 的规定编制的。</p> <p>O: Indicates that said hazardous substance contained in all of the homogeneous materials for this part is below the limit requirement of GB/T 26572. O: 表示该部件所有均质材料中所含的上述有害物质都在 GB/T 26572 的限制要求范围内。</p> <p>X: Indicates that said hazardous substance contained in at least one of the homogeneous materials used for this part is above the limit requirement of GB/T 26572. X: 表示该部件所使用的均质材料中，至少有一种材料所含的上述有害物质超出了 GB/T 26572 的限制要求。</p> <p>(Enterprises may further provide in this box technical explanation for marking “X” based on their actual circumstances.) (企业可以根据实际情况，针对含 “X” 标识的部件，在此栏中提供更多技术说明。)</p>						

