



# MAKE A DIFFERENCE

## Trunk Upper Basket

**BXG.2120-S** ||  
(INSTALLATION INSTRUCTION)

**ATTENTION** • Please verify all parts are present and read instructions carefully before starting installation.  
• Please feel free to contact your distributor if you have any kind of question about your purchase.

### CONTENTS

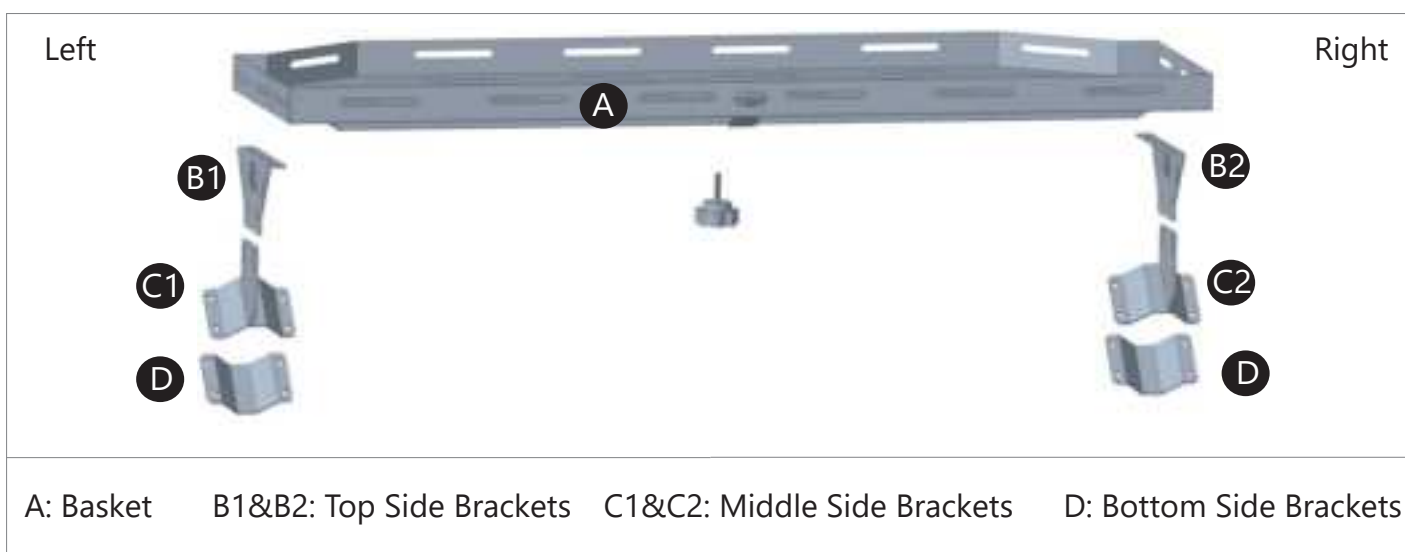

Qty	Part Name	Size(mm)	Picture	Qty	Part Name	Size(mm)	Picture
8	Button Bolts	M8*30		12	Flat Washer	M8*16*1.5	
4	Button Bolts	M8*20		4	Flat Washer	M6*12*1.5	
4	Button Bolts	M6*16		12	Flange Lock Nut	M8	
12	Split Lock Washer	D8		4	Flange Lock Nut	M6	
4	Split Lock Washer	D6		1	Plastic Hand Knobs	M8*20	

### TOOLS REQUIRED

◆ Drive Ratchet Handle

◆ 10mm, 13mm Wrench

◆ 4mm, 5mm Hex Bit Socket

◆ 10mm, 13mm Shallow Socket

To view online instruction, please scan the QR code.



## 3 INSTALLATION INSTRUCTION

Step 1

Find the c-pillar. Recommend to install it in a half c-pillar at the beginning.



Step 2

Assemble the bottom side brackets & the middle side brackets using (8) M8x30 button bolts, (8) split lock washers, (8) flat washers, (8) flange lock nuts.

Repeat this step for the opposite of the c-pillar.

Do not tighten the hardware at this time.



Step 3

Install the top side brackets to the middle side brackets using (4) M8x20 button bolts, (4) split lock washers, (4) flat washers, (4) flange lock nuts. Repeat this step for the opposite of the c-pillar. Tighten all bolts.

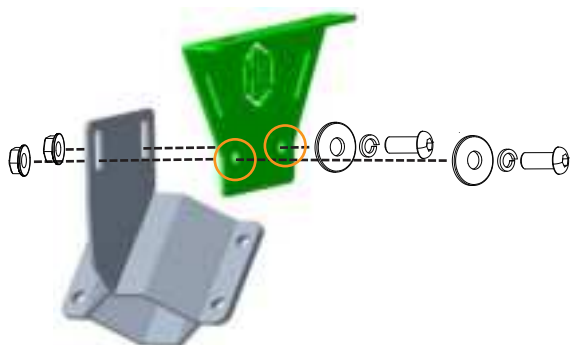

Step 4

Assemble the top side brackets and the basket using (4) M6x16 button bolts, (4) split lock washers, (4) flat washers, (4) flange lock nuts. Repeat this step for the opposite of the basket. Tighten all bolts.

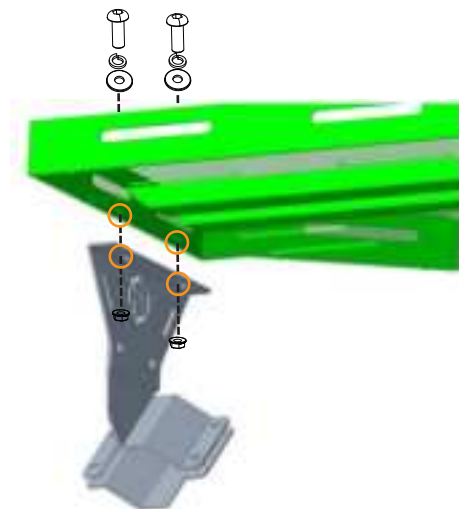

Step 5

Install the plastic hand knobs to the basket. Slide the rail and open the basket when you use.

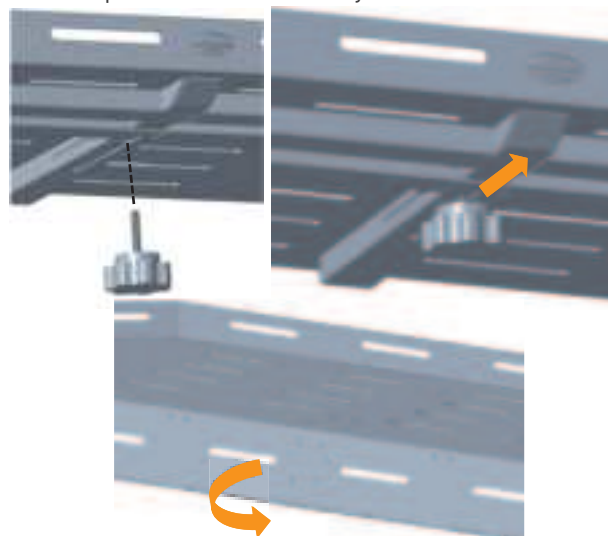

Step 6

Adjust the basket to the suitable position. Tighten all bolts in the step 2.

Step 7

The installation is complete. We hope you enjoy a wonderful off-road life with this quality Hooke Road product!

