



PLEASE SCAN THE QR CODE TO
VIEW YOUR LANGUAGES.



CLOUVOU

Smart Seat

Ergonomic Office Chair

User Manual

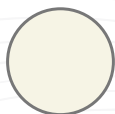

DEAR VALUED **CUSTOMER,**

THANK YOU FOR CHOOSING CLOUVOU! WE ARE VERY HAPPY TO WELCOME YOU TO THE CLOUVOU FAMILY. YOUR PURCHASE OF THE SMARTSEAT MODEL DEMONSTRATES YOUR COMMITMENT TO QUALITY AND COMFORT AND WE ARE CONFIDENT THAT OUR PRODUCT WILL IMPROVE YOUR DAILY WORKING EXPERIENCE.

WE APPRECIATE YOUR TRUST IN OUR BRAND AND LOOK FORWARD TO SERVING YOU AGAIN IN THE FUTURE. IF YOU HAVE ANY QUESTIONS OR NEED ASSISTANCE WITH ANY ISSUES, EITHER WITH THE OPERATION OF THE PRODUCT OR GENERAL PROBLEMS, PLEASE DO NOT HESITATE TO CONTACT OUR CUSTOMER SUPPORT TEAM. WE ATTACH GREAT IMPORTANCE TO CUSTOMER SATISFACTION ♥



support@clouvou.de

Table of Contents

Product Overview	03
Dimensions	04
Specification	04
Introduction	05
Properties	05
Parts and Components	06
Assembly Instructions	07-12
Use	13-14
Care and Maintenance	15
Safety Instructions	15

Please note that it is absolutely necessary to read and follow the safety instructions at the end of the manual carefully. They contain important information to ensure safe use of the product!

PRODUCT OVERVIEW

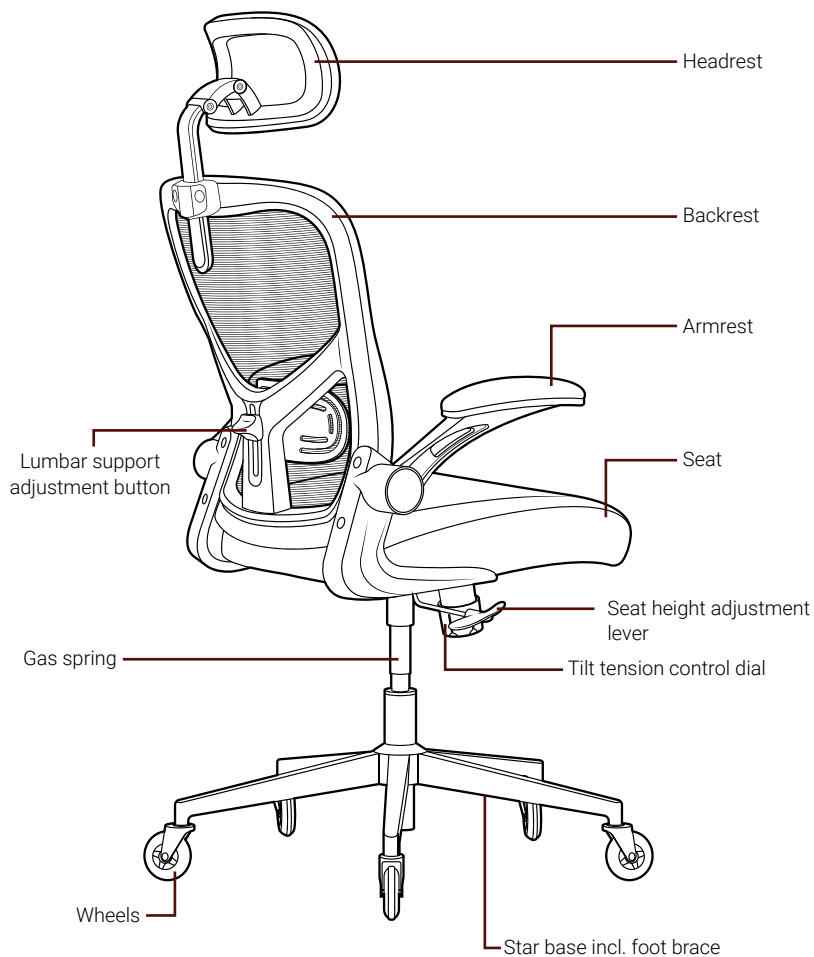

DIMENSIONS



SPECIFICATION

Maximum weight:	150KG
Net weight of the chair:	14KG

Please read the operating instructions carefully and completely and keep them in a safe place so that you can access them at any time. It's important to follow all instructions and notes, as failure to do so may result in injury or damage to property. **The safety instructions are at the end of the manual!**

INTRODUCTION

Get unrivaled comfort and support with our SmartSeat, designed to improve your productivity and well-being during long hours. With features like a 3D headrest made of premium PU leather for maximum functionality and comfort at your desk, unique blade wheels that glide effortlessly on all floor surfaces, a breathable backrest and more. Our premium office chair also features height adjustment and a 360-degree swivel function, giving you the best conditions for a successful working day. The SmartSeat is a reliable companion in your everyday work life that not only looks good, but is also easy on your back. This ergonomic office chair is a perfect addition to any office environment.

PROPERTIES

- Aesthetic design and suitable for any environment
- Height adjustability / 360-degree swivel function
- DualSync-Recline Technology (advanced rocking function)
- 3D PU leather headrest and breathable backrest
- Height-adjustable lumbar support
- Innovative, scratch-free blade wheels
- Flip-up armrests



Scan the QR code for assistance in the form of an assembly video.



PARTS AND COMPONENTS

- A. Wheels x 5
- B. Star base incl. chrome rosette x 1
- C. Foot brace x 5
- D. Gas pressure spring x 1
- E. Seat mechanism x 1
- F. Armrest x 2
- G. Backrest x 1
- H. Seat x 1
- I. Headrest x 1
- J. Frame screw x 5
- K. Mechanism screw x 4
- L. Backrest and headrest screw x 8
- M. Armrest screw x 2
- N. Screw cover x 4
- O. Allen key x 1

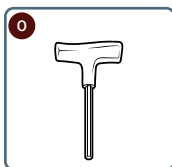
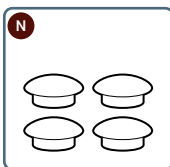
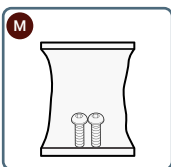
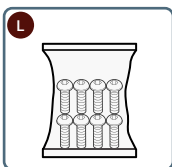
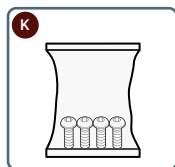
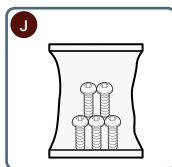
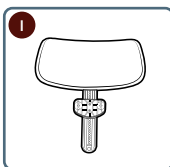
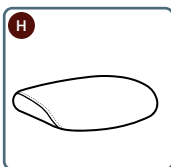
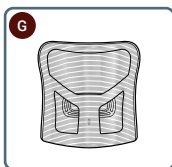
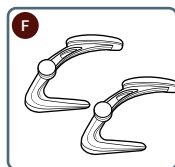
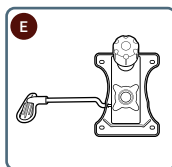
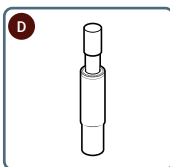
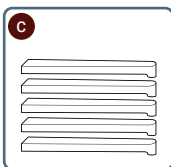
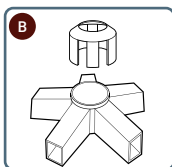
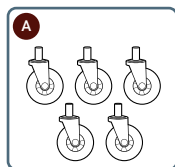

ASSEMBLY INSTRUCTIONS

Step 1: Assemble the entire frame.

Take the star base (Part B). Insert the foot braces (Part C) individually into the star base. Align the foot braces with the respective thread and tighten them with the frame screws (Part J) and the Allen key (Part O).

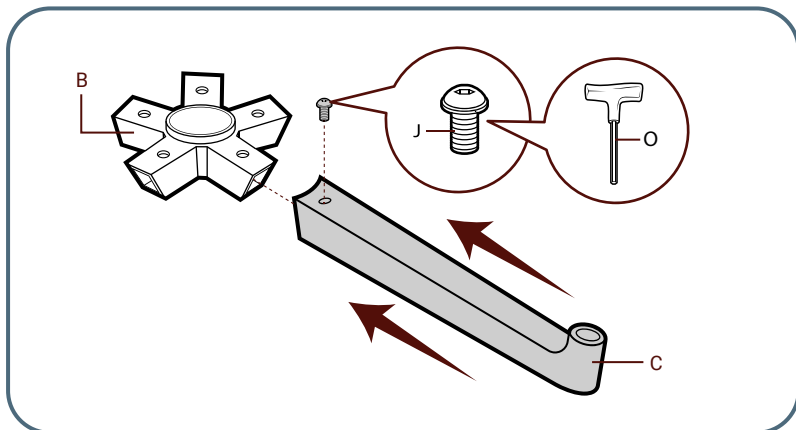

Now press each wheel (Part A) firmly into its respective socket to ensure that it is securely fitted.

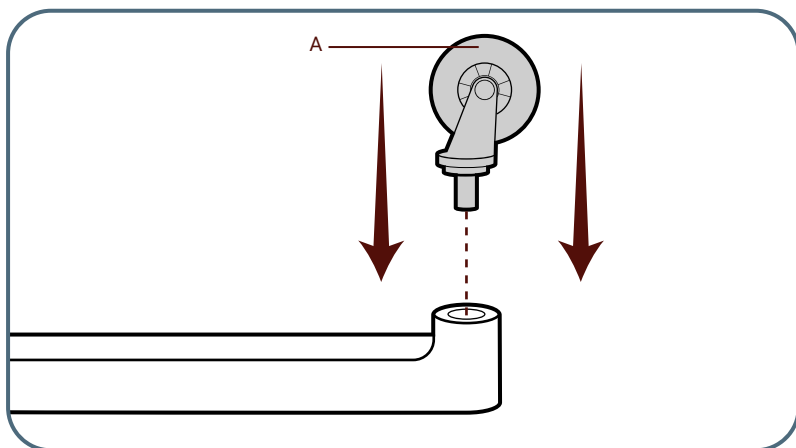

Before you move on to the next step, it is important that you remove the black plastic cap from the gas pressure spring (**Part D**).

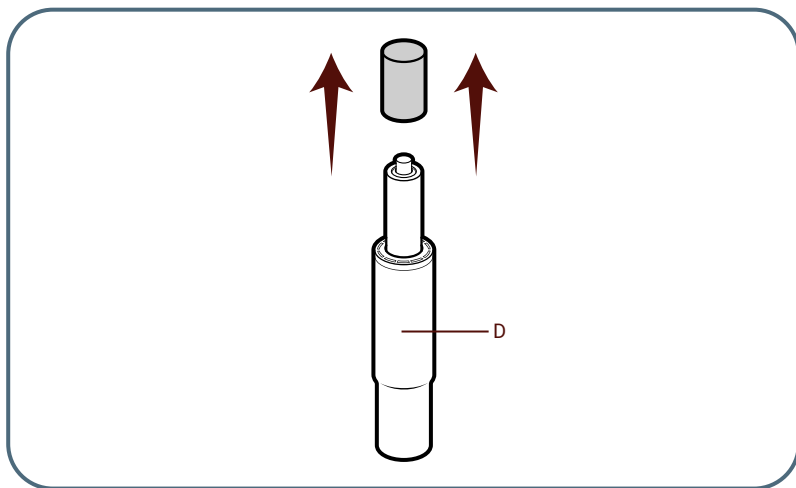

Turn the frame the right way round again and then put the chrome rosette over it. Then insert the gas spring (**Part D**) into the centre hole of the star base.

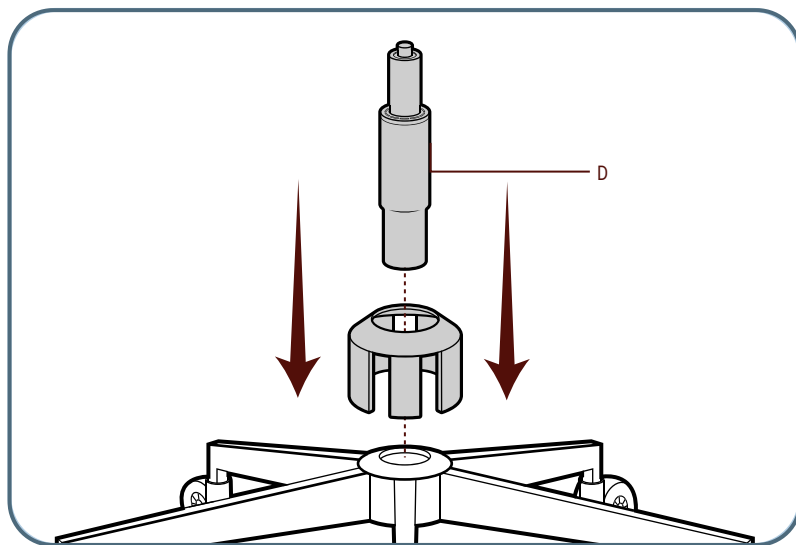

Step 2: Attach the armrests to the seat.

Turn the seat (**Part H**) over and align the armrests (**Part F**), please identify the left and right armrests in advance with the two pre-drilled seat holes on each side.

Tighten them using the armrest screws provided (**Part M** and **Part L**) and the Allen key (**Part O**).

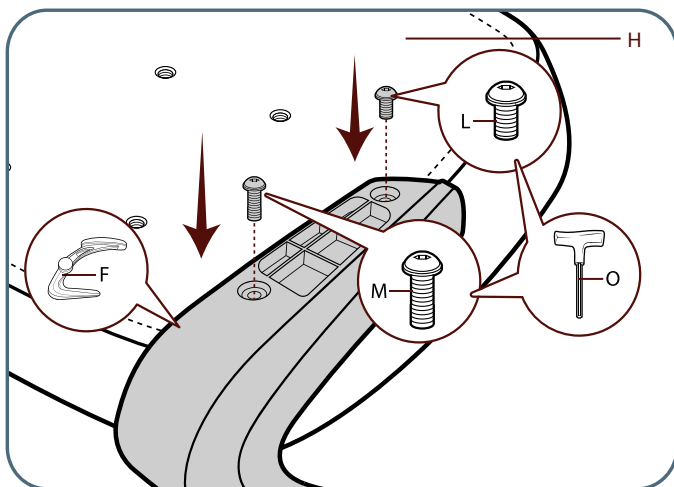
**Step 3: Attach the mechanism to the seat.**

Place the seat mechanism (**Part E**) on the underside of the seat (make sure it is positioned correctly). Tighten the seat mechanism using the mechanism screws (**Part K**) and the Allen key (**Part O**).

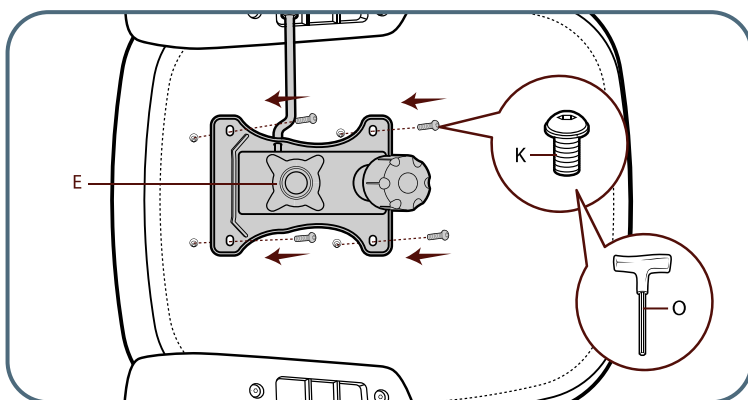

Step 4: Attach the backrest.

Now insert the backrest (**Part G**) between the seat and the backrest base. Align the four threaded holes of the backrest base and the backrest itself and fasten these four points using the backrest screws (**Part L**) and the Allen key (**Part O**). You can now cover the four threads with the four screw covers (**Part N**).

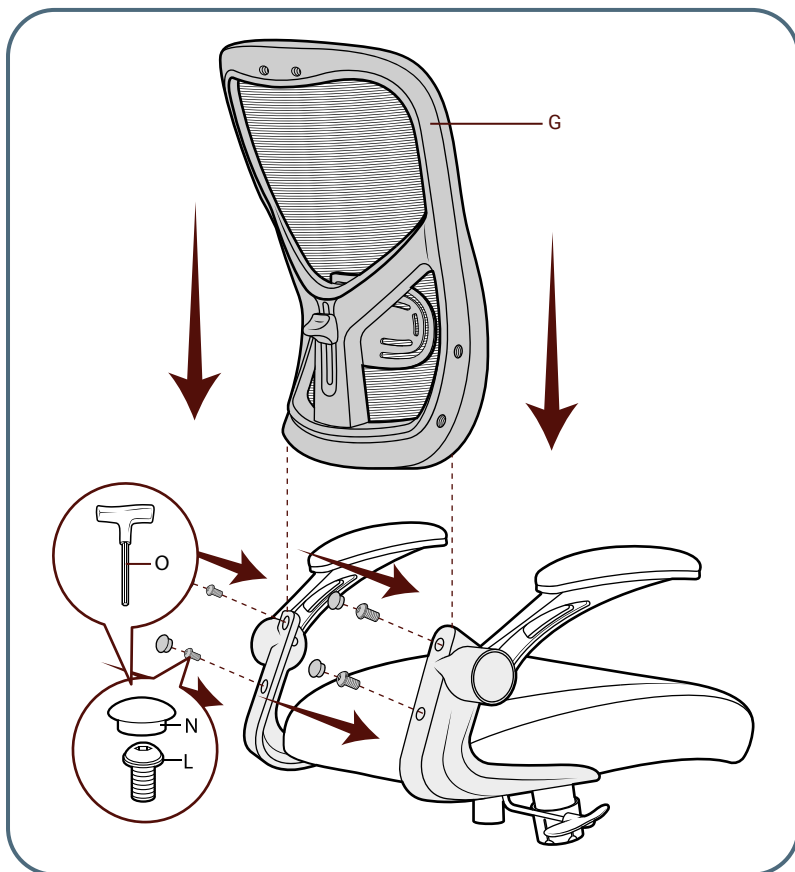

Step 5: Place the seat on the frame.

Now place the entire seat with the opening of the seat mechanism on the gas pressure spring of the lower frame and make sure that the seat is securely fastened.

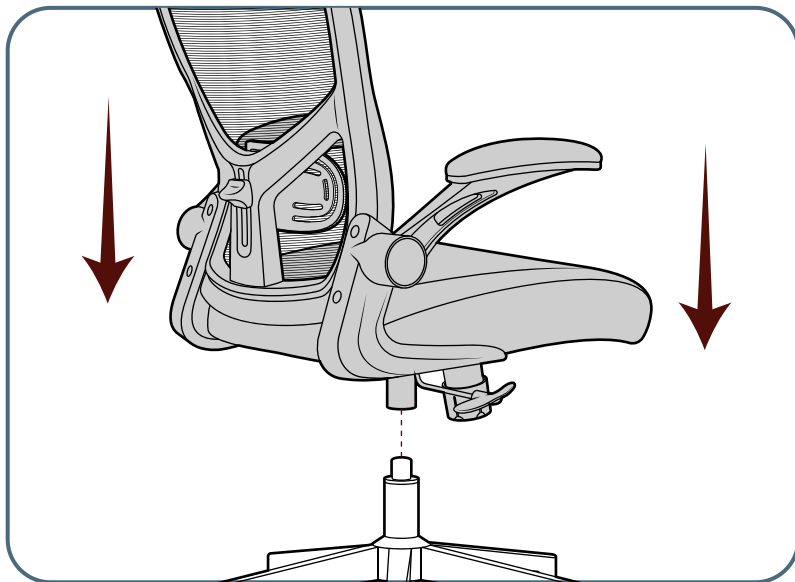

Step 6: Attach the headrest to the backrest.

Take the headrest (**Part I**) and align it with the pre-drilled holes in the backrest. Tighten the headrest screws supplied for the headrest (**Part L**) and the Allen key (**Part O**).

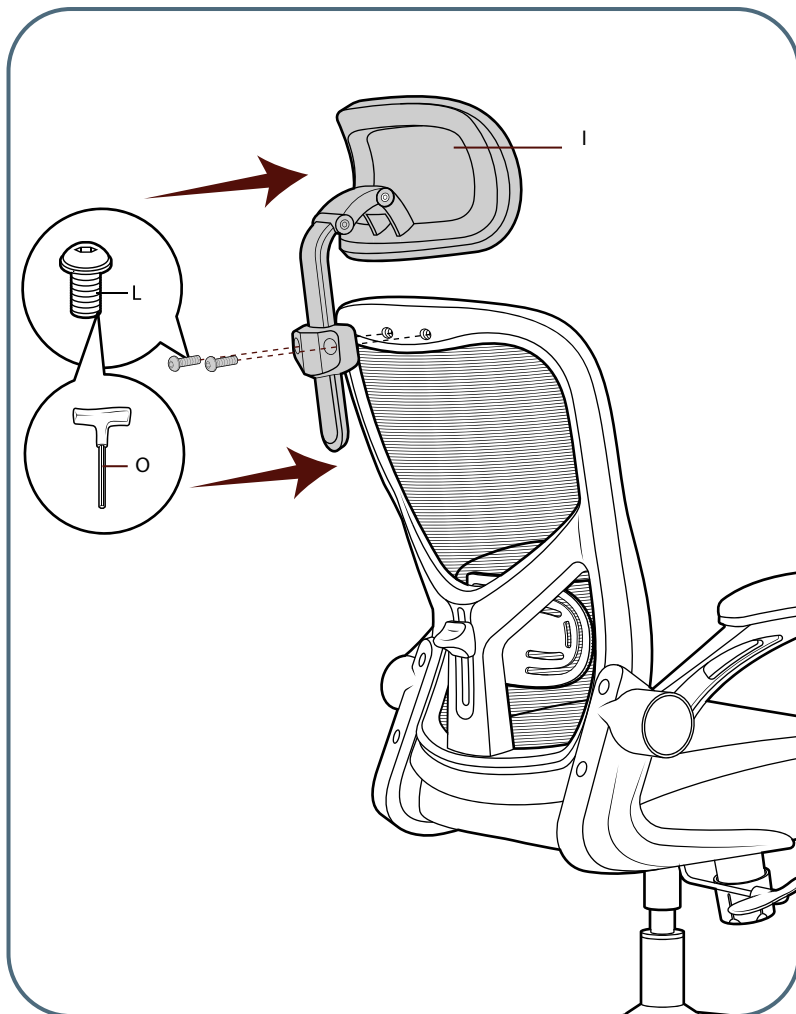

USE

Height Adjustability:

To adjust the height of the chair, use the "lever" under the seat. Turn the lever on the larger side up while sitting on the chair with your full body weight to lower the seat. The lever can be used in a similar way to raise the seat when no weight is on the seat..

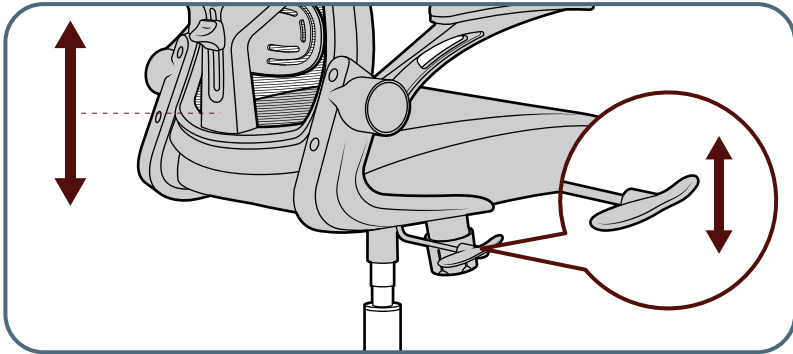

Reclining the Backrest:

The "lever" under the seat can also be used to tilt the backrest from a starting position of 90 degrees to 135 degrees. You can grasp the lever again and pull it out until you hear a "click". Then just lean back and the tilting process begins. There are three stages on the way up to 135 degrees, where you can also lock the tilt position. To lock the backrest, simply push the lever all the way in from the outside. You can also release the lock by pulling the lever all the way out again and leaning back into the backrest with a little more force.

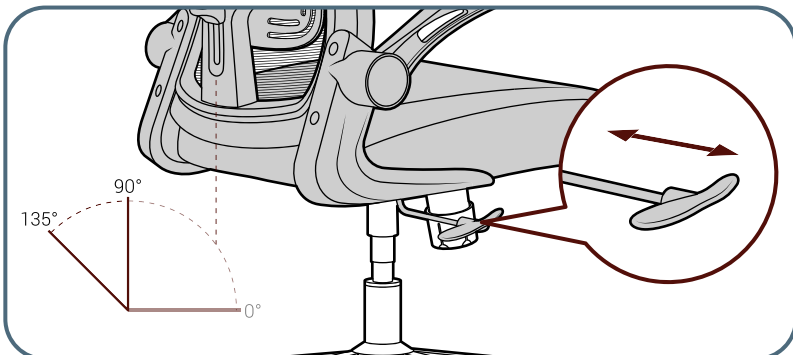

Tilt tension of the Backrest (DualSync-Recline Technology):

Locate the "knob" under the seat. Turn it clockwise to enjoy reduced tilt tension in swivel mode. Turn it counterclockwise to increase the tilt tension of the backrest. Why don't you try which setting works best for you? Our unique DualSync recline technology also allows you to tilt to help you focus. Enjoy tilt mode, where the seat and backrest tilt evenly backward to optimize your sitting experience.

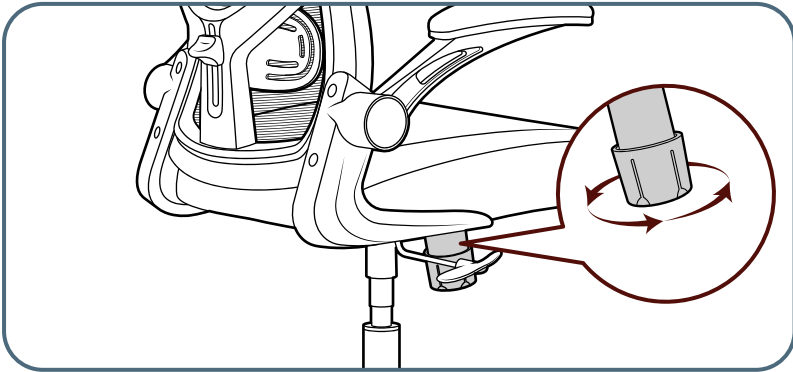

Adjustment of the headrest:

Hold the headrest firmly and pull it up or down to adjust the height. Tilt the headrest forward or backward at the top joint to adjust the angle of the headrest to the desired position. You can also adjust the angle of the headrest at the lower joint to operate the depth adjustment. You can also adjust the resistance of the headrest angle adjustment by turning each joint screw clockwise or counterclockwise with an Allen key.

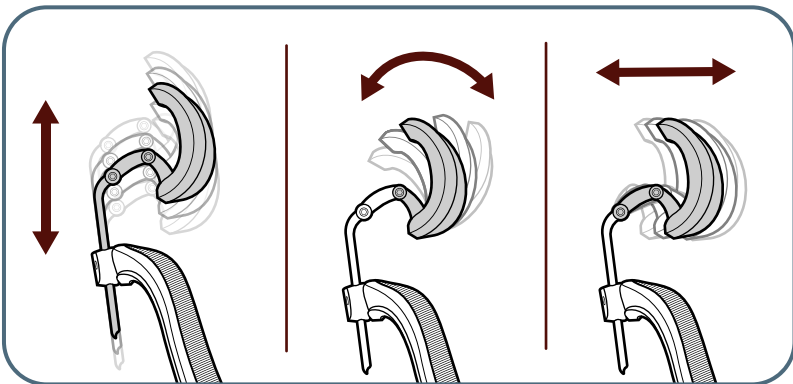

CARE & MAINTENANCE

- For more thorough cleaning, please use mild soap and water. Please avoid aggressive chemicals or abrasive cleaners.
- Dry the chair thoroughly with a clean and dry cloth to avoid moisture damage and dust/dirt.
- Lubricate moving parts such as wheels and adjustment mechanisms regularly with a suitable lubricant to ensure smooth operation.
- Regularly check all screws, bolts and other fixings to ensure that they are tight and secure.
- Inspect the chair for signs of wear, such as cracks or broken parts.
- Please immediately contact our customer support if any parts are damaged. We will replace the affected parts immediately to ensure safety and functionality.
- Do not expose the chair to extreme temperatures, direct sunlight or high humidity to prevent material degradation and loss of function.
- Never clean the gas spring.

SAFETY INSTRUCTIONS

- Never remove the gas spring. Work on the gas springs may only be carried out by trained specialist personnel. Do not open or modify the gas spring in any other way. There is a risk of injury if work is carried out incorrectly.
- Make sure to follow the assembly instructions carefully, as incorrect assembly leads to a risk of injury.
- Be careful with pinch points when adjusting the chair. Keep fingers and clothing away from moving parts.
- Place the chair on a flat and stable surface to prevent it from tipping over.
- The office chair should never be used as a ladder.
- Keep children and babies away from the swivel chair to avoid accidents such as tipping over or injuries caused by rolling. Also never leave pets or children unattended in the vicinity of the chair.
- The wheels are only suitable for soft flooring.
- To ensure safety, we recommend that you do not lean too far back, otherwise the chair may tip and fall over. Be sure to maintain balance to avoid accidents and ensure stable use.
- When no one is sitting on the chair, this chair does not have safety wheels with brakes and will roll easily. Be careful when standing up and sitting down to avoid accidental rolling. Make sure the chair is stable to prevent falls or accidents.
- Attention! The energy accumulators for seat height adjustment may only be replaced and repaired by specialised personnel.

**We wish you much pleasure and relaxation with our office chair.
It will provide you with comfort and support while you work!**





CLOUVOU GmbH

Mittelweg 43

25479 Ellerau

Germany

Model: CLOUVOU SmartSeat

Model No.: B12-0041, B12-0042, B12-0043

E-mail: support@clouvou.de