

Quick User Guide

WiFi Camera



FCC Statement

This device complies with part 15 of the FCC Rules. Operation is subject to the following two conditions.
(1) This device may not cause harmful interference, and
(2) This device must accept any interference received including interference that may cause undesired operation.

Information to User

Note: This equipment has been tested and found to comply with the limits for a Class B digital device, pursuant to part 15 of the FCC Rules. These limits are designed to provide reasonable protection against harmful interference in a residential installation. This equipment generates, uses and can radiate radio frequency energy and, if not installed and used in accordance with the instructions, may cause harmful interference to radio communications. However, there is no guarantee that interference will not occur in a particular installation. If this equipment does cause harmful interference to radio or television reception, which can be determined by turning the equipment off and on, the user is encouraged to try to correct the interference by one or more of the following measures:

- Reorient or relocate the receiving antenna.
- Increase the separation between the equipment and receiver.
- Connect the equipment into an outlet on a circuit different from that to which the receiver is connected.
- Consult the dealer or an experienced radio/TV technician for help.

Important: Change or modifications not expressly approved by the manufacturer responsible for compliance could void the user's authority to operate the equipment.

2

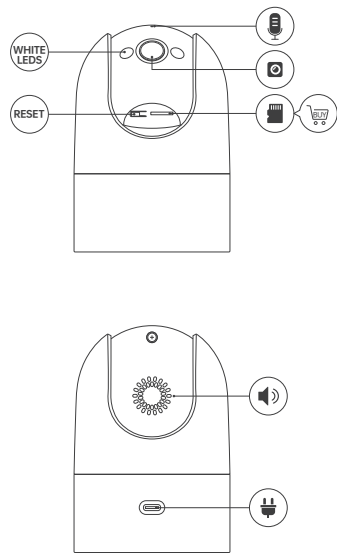

3

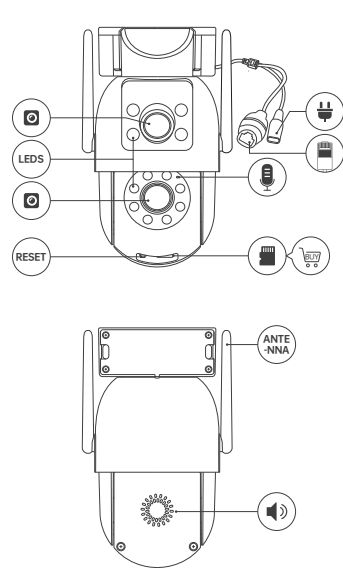

4

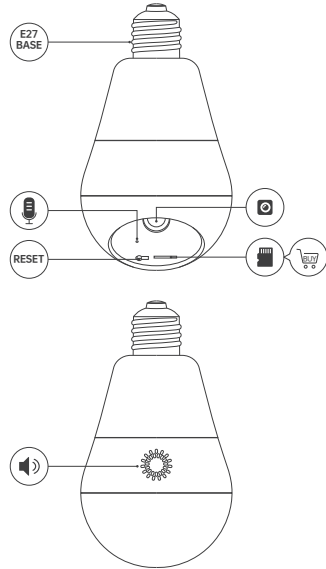

5

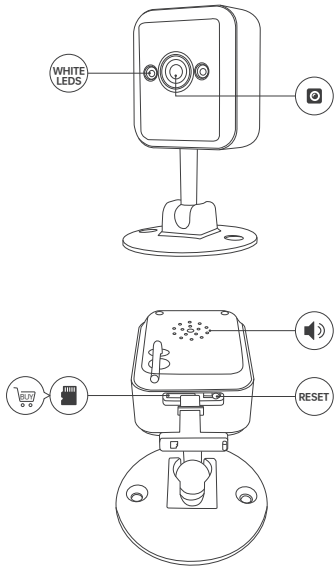

6

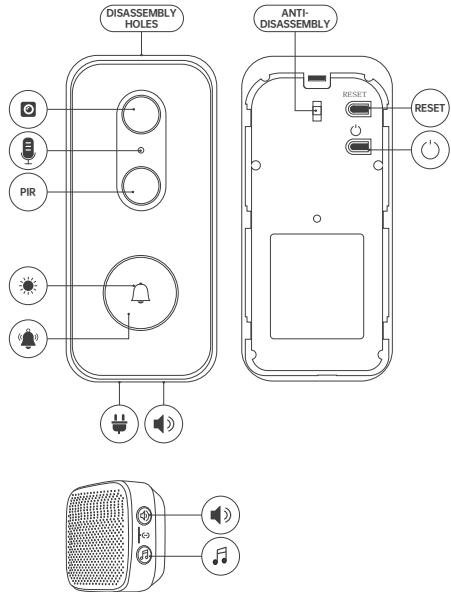

7

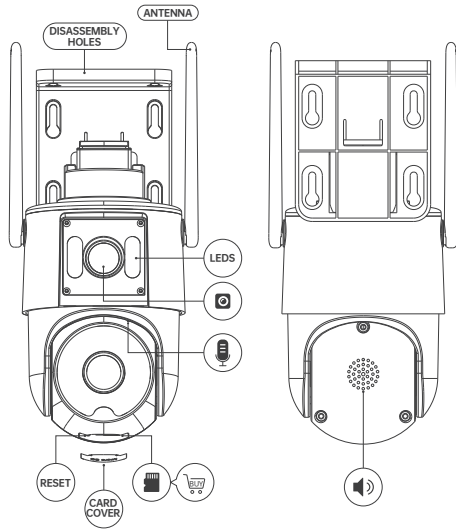

8

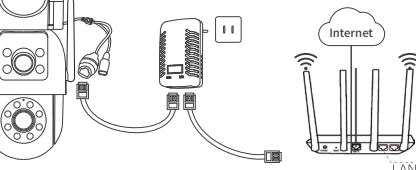
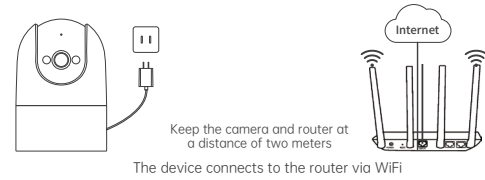

9

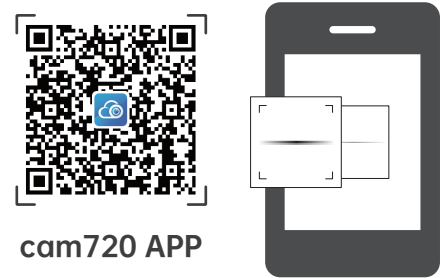

10

Sign up & Login

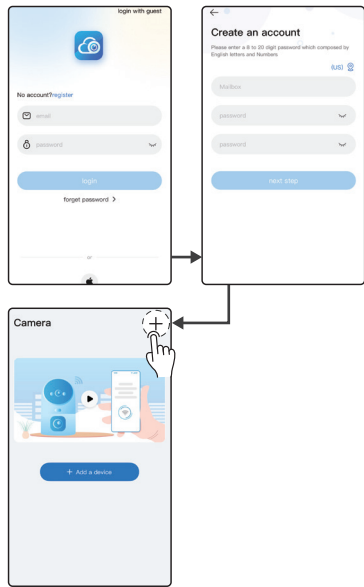

11

WiFi connection

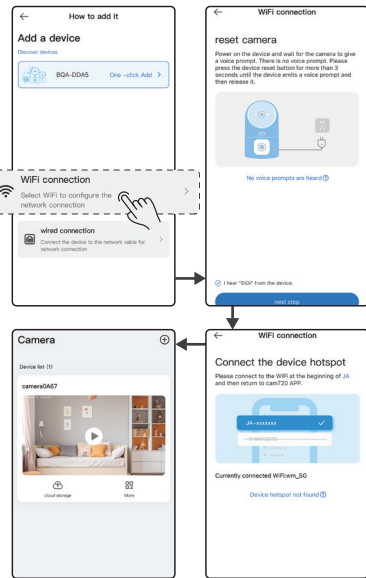

12

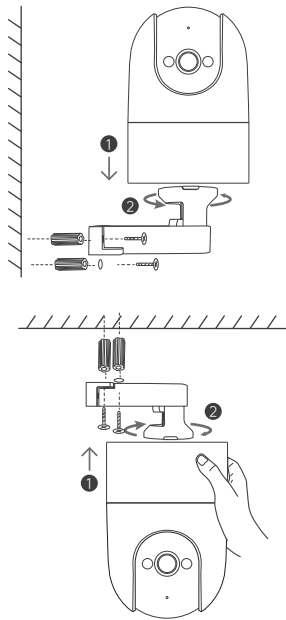

13

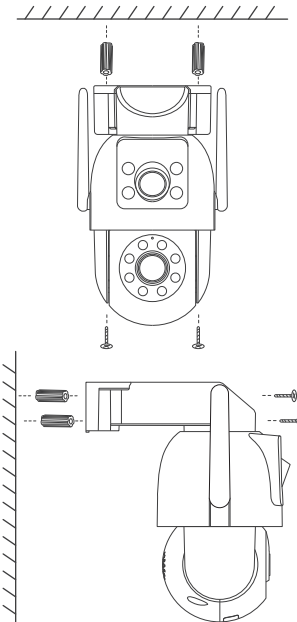

14

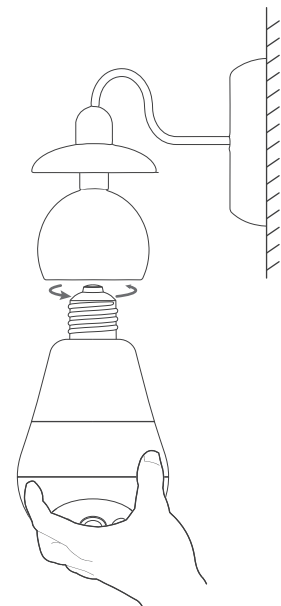

15

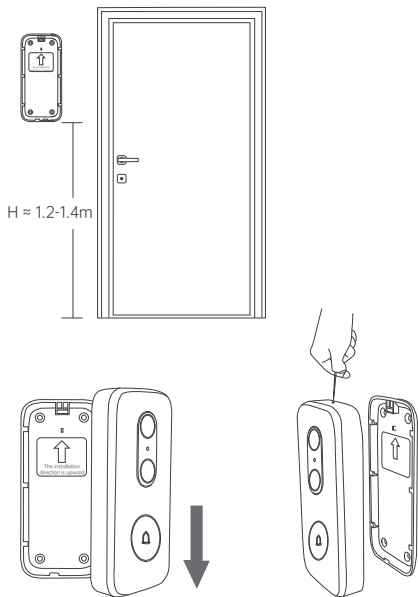

16

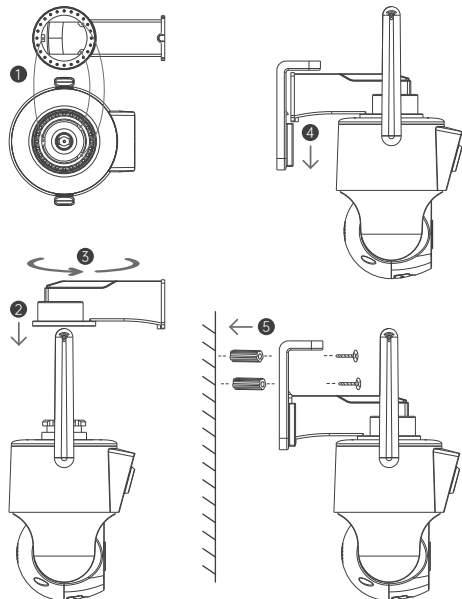

17

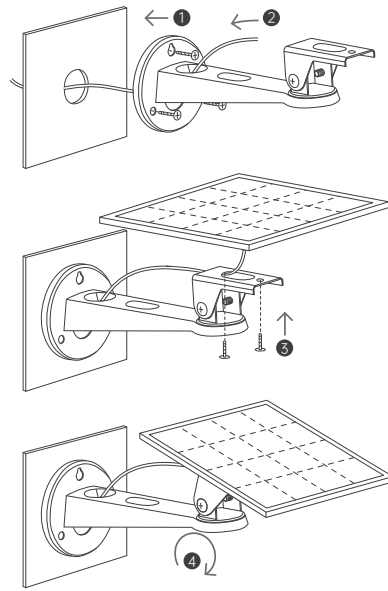

18

ENGLISH

Power On the Camera

Power on the camera and bring it near your router (See page 9).

Get the cam720 App

Scan the QR code or search for "Cam 720" to download and install the APP. Create an account and log in (See page 10 to 11).

Set up the camera

Open the app, select your WiFi connection, and follow the on-screen instructions to complete the setup

Mount the camera

Make sure the mounting surface is strong enough to support three times the weight of the camera. For detailed installation procedures (see pages 13 to 18).

Important Use Notice

1. Offline/Cannot find hotspot/How to reset the camera?

Answer: Press and hold the reset button on the camera. After hearing a beep, try to connect to the camera again.

2. Cannot receive the verification code?

Answer: Please search in the spam box, or try to change an email address to register.

3. Network connection timeout/image abnormality?

Answer: Please restart the camera in the camera APP--settings page--camera parameters.

4. How to store recordings?

Answer: 1. Cloud storage (need to be purchased)
2. Micro SD card: supports 8GB-256GB storage capacity, Fat32 format.

19

日本語

カメラの電源を入れる

電源を接続してカメラの電源を入れ、カメラをルーターの近くに置きます(9ページを参照)。

cam720 アプリを入手

QRコードをスキャンするか、「Cam 720」を検索してAPPをダウンロードしてインストールします。アカウントを作成してログインします(10～11ページを参照)。

カメラをセットアップする

アプリを開き、WiFi接続を選択し、画面の指示に従ってセットアップを完了します。

カメラをインストールする

取り付け面がカメラの3倍の重量を支えるのに十分な強度があることを確認してください。詳しい取り付け手順は(13～18ページを参照)。

重要な使用通知

1. オフライン/ホットスポットが見つかりません/カメラをリセットするにはどうすればよいですか?

回答: カメラのリセットボタンを押したままにして、「ディ」というピープ音が聞こえたら、再度カメラに接続してみてください。

2. 認証コードを受信できませんか?

回答: 迷惑メールボックスを検索するか、別のメールアドレスで登録してみてください。

3. ネットワーク接続タイムアウト・画像異常?

回答: カメラ APP - 設定ページ - カメラパラメータでカメラを再起動してください。

4. 動画の保存方法

回答: 1. クラウドストレージ (購入が必要)
2. マイクロSDカード: 8GB-256GB、Fat32 フォーマットのストレージ容量をサポートします。

20