



NETGEAR.com/support



community.NETGEAR.com

NETGEAR, Inc.

NETGEAR INTERNATIONAL LTD

© NETGEAR, Inc., NETGEAR, the NETGEAR Logo and the Nighthawk logo are trademarks of NETGEAR, Inc. Any non-NETGEAR trademarks are used for reference purposes only.



November 2024



For detailed instructions on alternative setup methods like fixed installation, scan the QR code or visit NETGEAR.com/m3usermanual.

For regulatory compliance information including the EU Declaration of Conformity, visit NETGEAR.com/about/regulatory/.

See the regulatory compliance document before connecting the power supply.

Applicable to 6 GHz devices only: Only use the device indoors. The operation of 6 GHz devices is prohibited on oil platforms, cars, trains, boats, and aircraft, except that operation of this device is permitted in large aircraft while flying above 10,000 feet. Operation of transmitters in the 5.925-7.125 GHz band is prohibited for control of or communications with unmanned aircraft systems.

NETGEAR

QUICK START

NIGHTHAWK® | **M3**

5G MOBILE WIFI HOTSPOT



CONTENTS

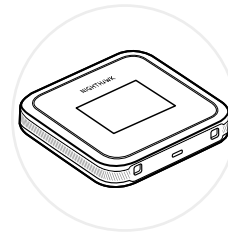

Nighthawk M3
5G Mobile WiFi Hotspot

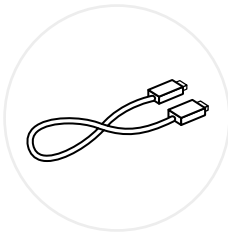

USB cable

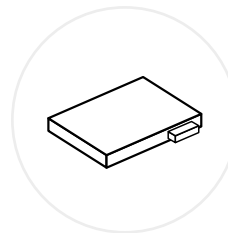

Battery



To purchase a power adapter,
Ethernet dongle, or additional
battery, scan the QR code or visit
NETGEAR.com/mobileaccessories.

REMOVE BATTERY COVER

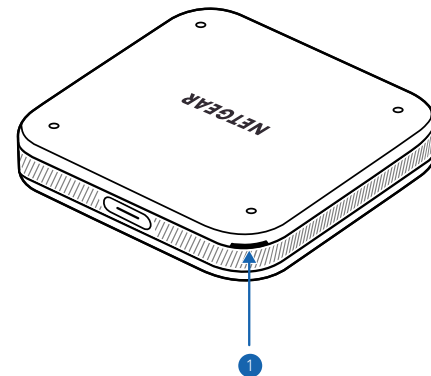

1
Locate the small indent on the corner of the
back cover and gently pry it open

INSTALL THE SIM AND BATTERY

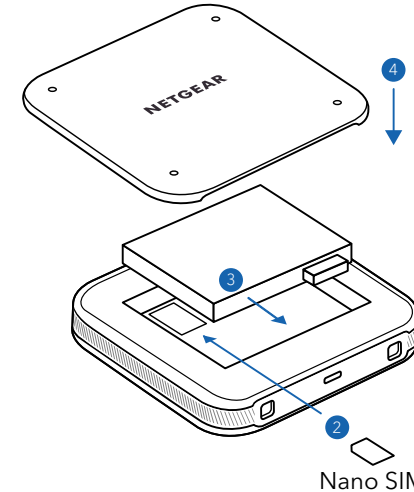

2
Slide the nano SIM
card into its slot

3
Insert the battery
into the device

4
Press to snap the
back cover into place

SET UP YOUR MOBILE WIFI HOTSPOT

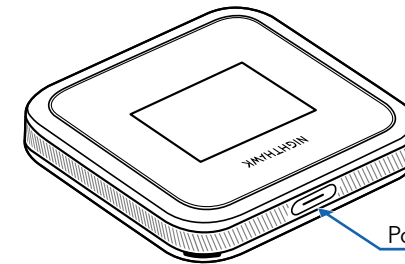

Power/navigation button

Press and hold to power up
Press to wake/navigate

Press and hold the
Power/navigation button
for two seconds to turn on
your hotspot, then follow
the onscreen instructions to
complete setup.

You can also connect to the
hotspot's default WiFi network
with a WiFi device and visit
<http://192.168.1.1> to complete
setup from the web.