

Scan for installation
video



Installation Instructions for K10167

Alternator and power steering pump
bracket for F-body and GTO LS1 engines

Kit contents:

- Mounting plates
- Spacer tubes
- Fasteners
- Idler pulley

Additional parts required:

- Alternator
- Power steering pump with pulley
- Belt. See chart below.

	Belt when using factory Camaro tensioner, with no AC		Belt when using Kwik Performance AC bracket	
Alternator	5.5" power steering pulley	6.0" power steering pulley		
"Large"	77-7/8" K060772	78-5/8" K060780		
"Small"	77" K060764		See AC instructions	
Corvette	77-5/8" K060771			

1. Attach idler pulley to front plate

**Note: Leave all fasteners
finger tight until step 5.**

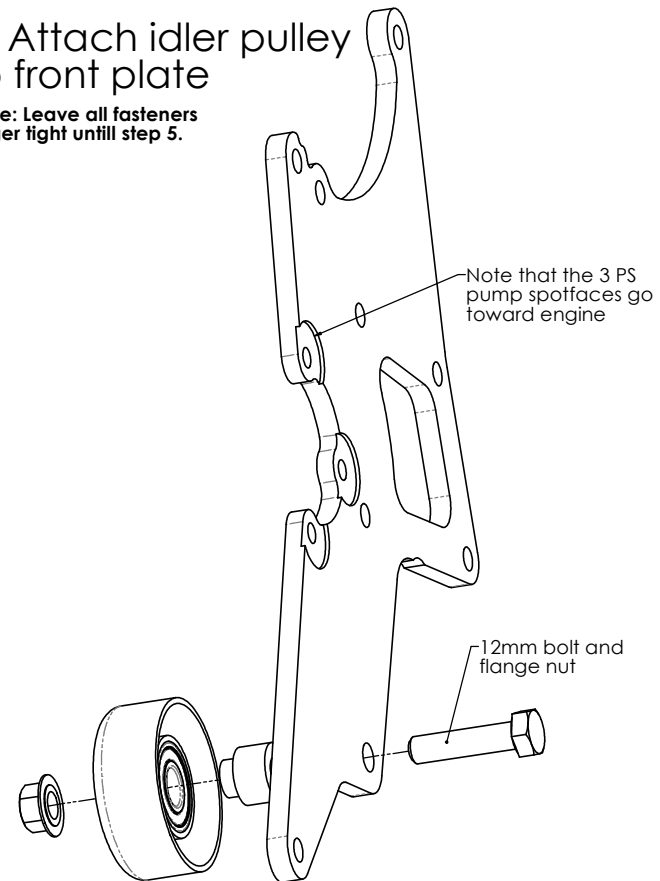

Alternator identification

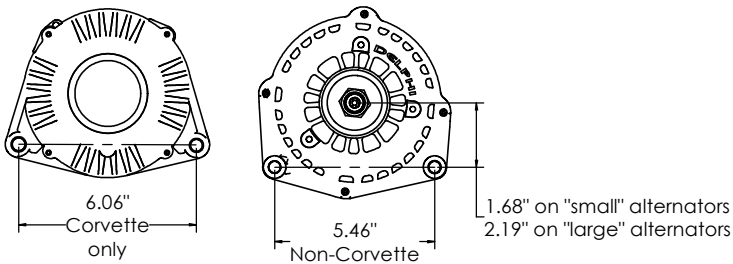

Installation Instructions for: K10167 alternator and power steering pump bracket



2. Mount front plate assembly to engine

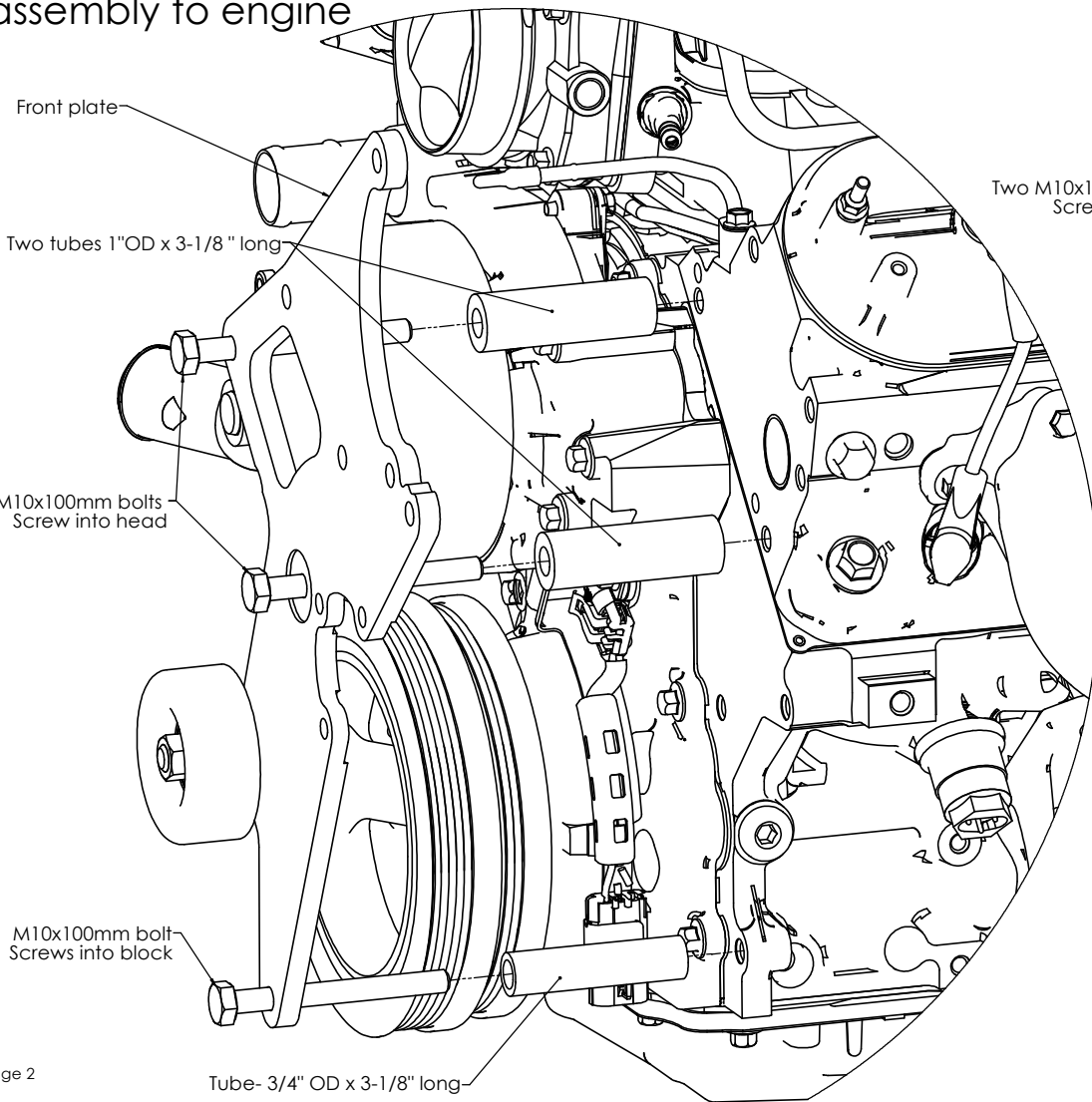

3. Mount rear plate to engine

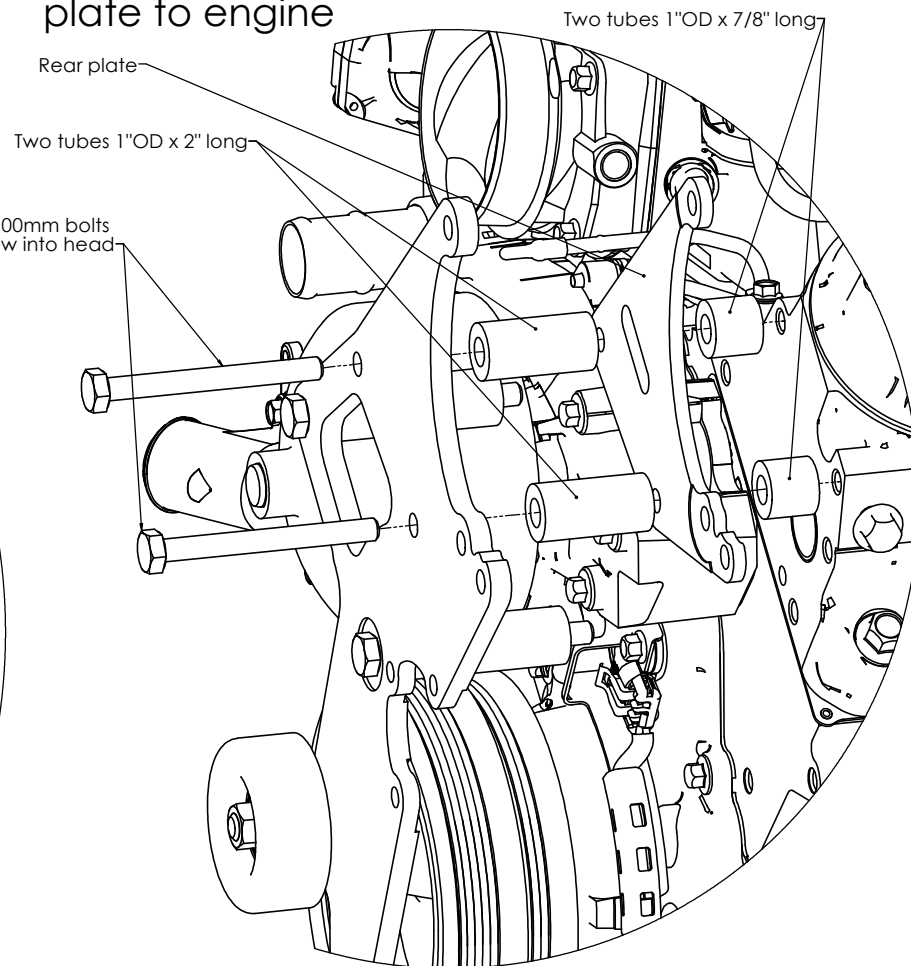

Installation Instructions for: K10167 alternator and power steering pump bracket



4. Mount alternator

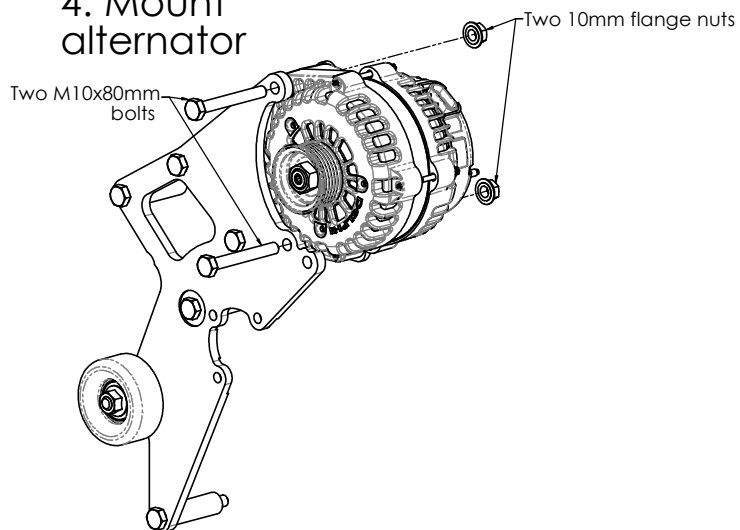

5. Torque fasteners:

Lift up on the front plate to take the weight off of the bolts, then snug up all the bolts.

Torque the bolts to:
10mm: 37 ft-lbs
12mm: 50 ft-lbs

6. Mount power steering pump

8 mm bolts
Torque to 15 ft-lbs

Extra bolts are
provided for
various pumps

Note: Some pulleys have windows in them for access to 8mm bolts. Pulley and pump can be installed as an assembly after torquing all 10mm bolts.

Kwik Performance pumps come with the pulley pre-installed in the correct location and can be bolted on as is.

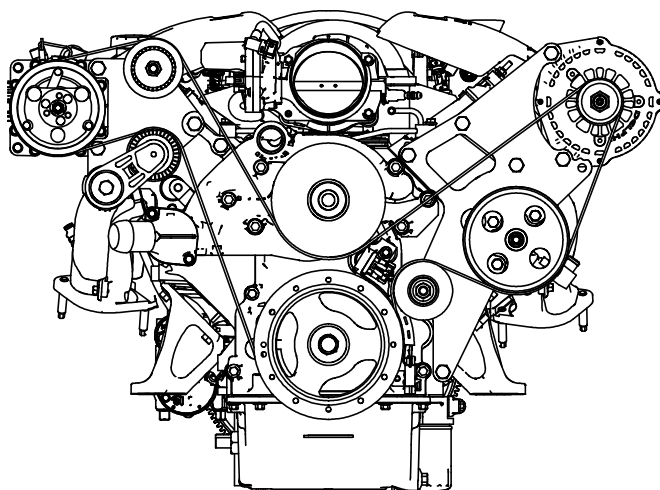
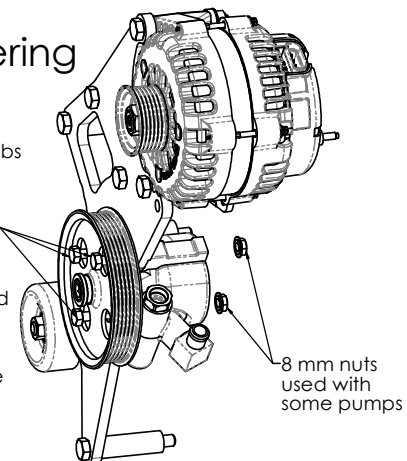

7. Install belt

Note:

See sheet 1 for belt length suggestions

With AC, install belt in rear 6 grooves of 7 groove 4665 compressor.

With AC, install belt in middle 6 grooves of 8 groove 4711 compressor.

Note: For best performance and longest life, the belt lengths suggested by Kwik Performance are the shortest belt that can be reasonably installed.

We recommend the following procedure:

1. When installing the serpentine belt, place the belt around all pulleys as shown in the diagram except for the water pump pulley.
2. Check to see that the belt is in the correct grooves of the AC compressor.
3. Check to make sure that the belt is seated all the way in the grooves of each grooved pulley.
4. Retract the tensioner all the way and slip the belt onto the water pump pulley.
5. Release the tensioner.