



MAKE A DIFFERENCE

Front Bumper

BXG.1068-S
(INSTALLATION INSTRUCTION)

ATTENTION • Please verify all parts are present and read instructions carefully before starting installation.
• Please feel free to contact your distributor if you have any kind of question about your purchase.

CONTENTS

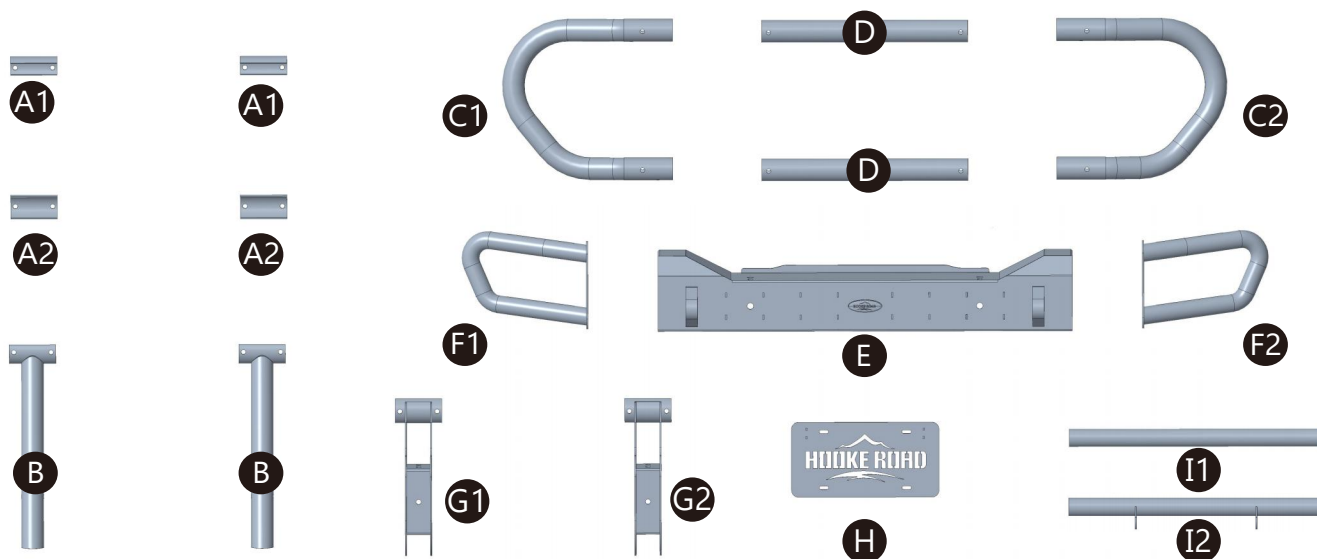

A1&A2: Fixed Plates Bx2: Connect Tubes(1) C1&C2: Bend Tubes Dx2: Short Tubes E: Main Body
F1&F2: Wings G1&G2: Connect Tubes(2) H: License Plate Bracket I1&I2: Long Tubes

Qty	Part Name	Size(mm)	Picture	Qty	Part Name	Size(mm)	Picture
4	Hex Bolt	M12*30		2	Split Lock Washer	D6	
10	Button Bolt	M8*65		4	Flat Washer	15*50	
8	Button Bolt	M8*30		26	Flat Washer	M8*16*1.5	
8	Button Bolt	M8*20		2	Flat Washer	M6*12*1	
2	Button Bolt	M6*16		16	Flange Hex Lock Nut	M8	
26	Split Lock Washer	D8		2	Flange Hex Lock Nut	M6	
2	D-rings						

2 TOOLS REQUIRED

◆ Drive Ratchet Handle

◆ 10mm, 13mm Wrench

◆ 4mm, 5mm Hex Bit Socket

◆ 19mm Wrench

To view online instruction, please scan the QR code.



3 INSTALLATION INSTRUCTION

Step 1

Place the vehicle in park, remove the factory bumper from the frame.



Step 2

Connect Tubes(2) & Long Tubes Assembly

Do not fully tighten to allow adjustability.

• (4) M8x20 Button Bolts

• (4) D8 Lock Washers

• (4) M8x16x1.5 Flat Washers

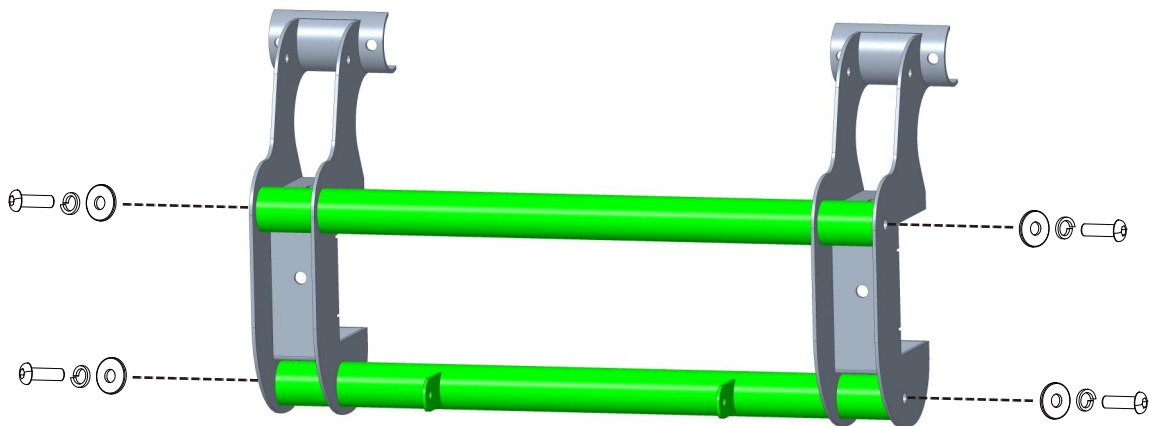

Step 3

Connect Tubes(2) & Main Body Assembly

Do not fully tighten to allow adjustability.

• (6) M8x30 Button Bolts

• (6) D8 Lock Washers

• (6) M8x16x1.5 Flat Washers

• (6) M8 Flange Hex Lock Nuts

Step 3

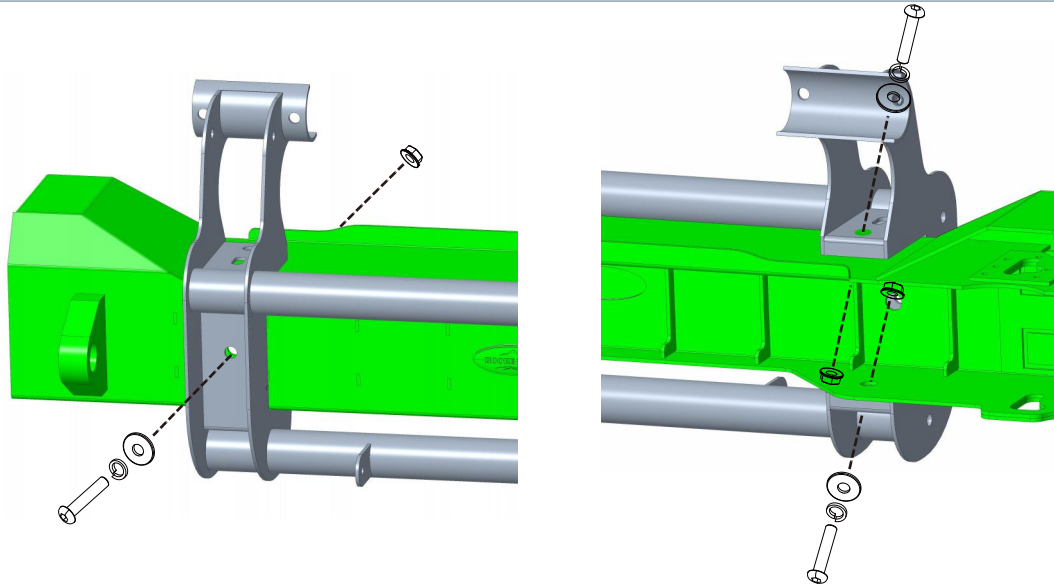

Step 4

The Wings Assembly
Tighten the hardware.

• Main Body

• (4) M8x20 Button Bolts

• (4) D8 Lock Washers

• (4) M8x16x1.5 Flat Washers

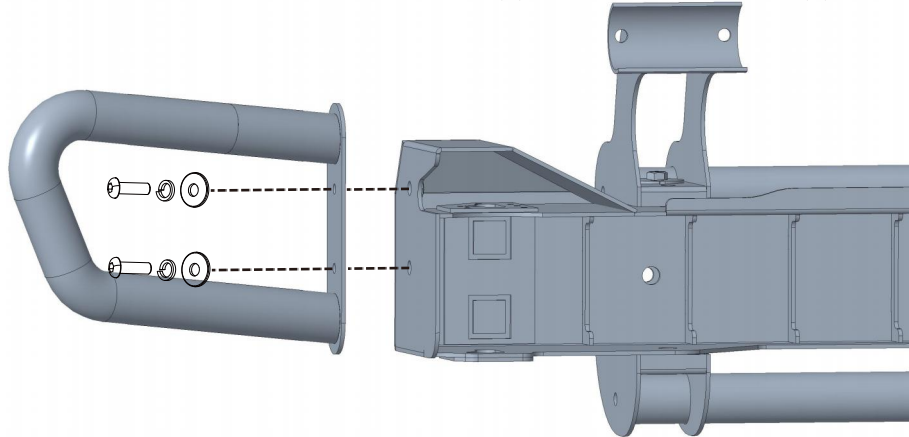

Step 5

The Connect Tubes(1) Assembly
Do not fully tighten to allow adjustability.

• (2) M8x65 Button Bolts

• (2) M8x30 Button Bolts

• (4) D8 Lock Washers

• (4) M8x16x1.5 Flat Washers

• (2) M8 Flange Hex Lock Nuts

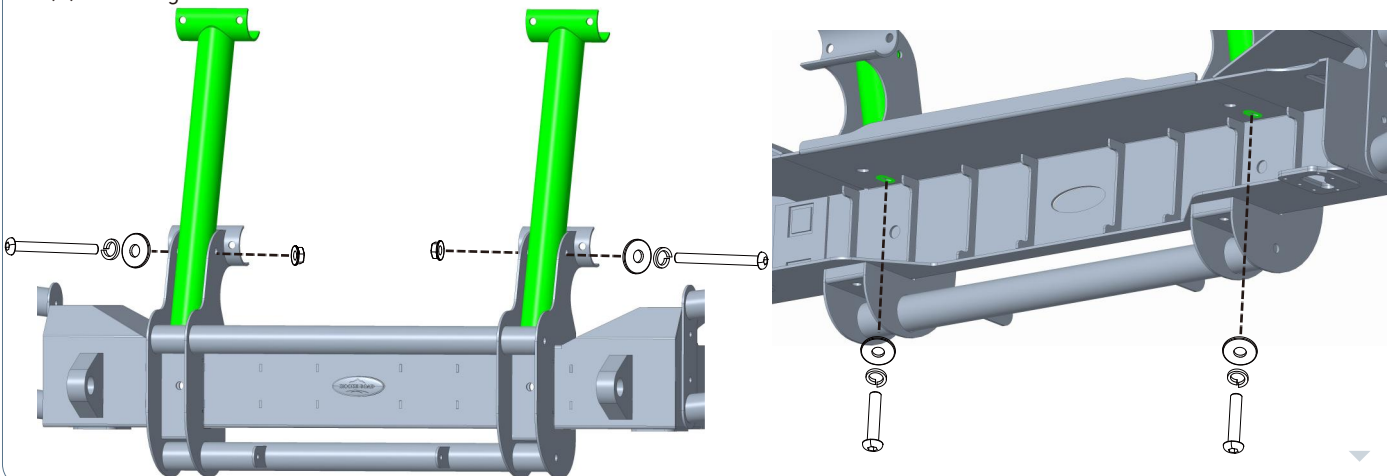

Step 6

Bend Tubes & Short Tubes Assembly
Adjust the accessories to the desired location. **Finally, tighten up all bolts.**

• Fixed Plates

• (8) M8x65 Button Bolts

• (8) D8 Lock Washers

• (8) M8x16x1.5 Flat Washers

• (8) M8 Flange Hex Lock Nuts

Step 6

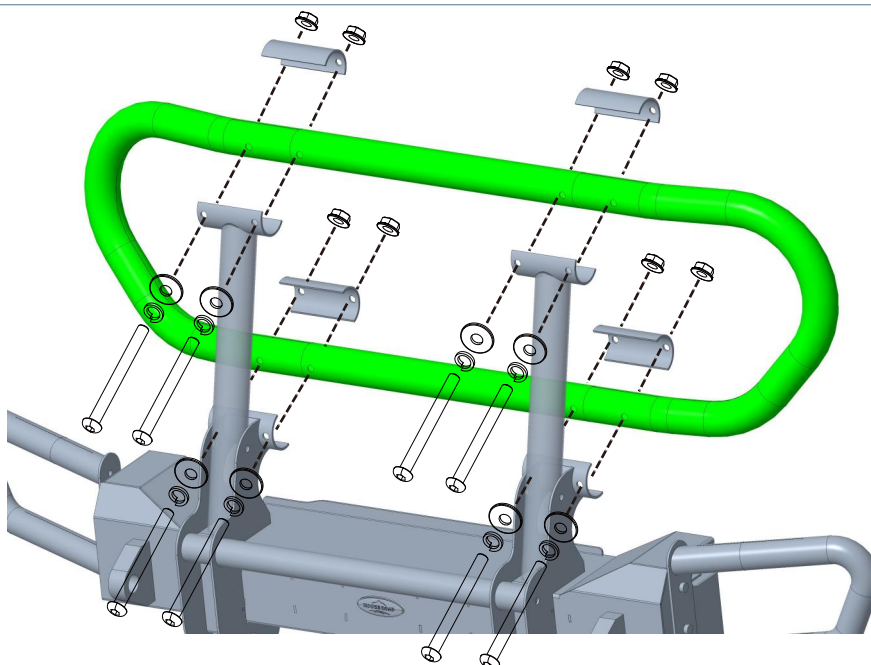

Step 7

The License Plate Bracket Assembly
Tighten the hardware.

- (2) M6x16 Button Bolts
- (2) D6 Lock Washers
- (2) M6x12x1 Flat Washers
- (2) M6 Flange Hex Lock Nuts



Step 8

Install the bumper to the vehicle.

Adjust the bumper to the desired location. **Finally, tighten up all bolts.**

- (4) M12x30 Hex Bolts
- (4) 15x50 Flat Washers



Step 9

The installation is complete. We hope you enjoy a wonderful off-road life with this quality Hooke Road product!

