



LED CRANIUM CANLESS LITE SERIES

LED-RF4D
LED-RF6D
LED-RF8D



TOOLS AND MATERIALS REQUIRED:



Wiring supplies
as required by
your local
Provincial or State
Electrical code

SAFETY PRECAUTIONS:

1. TURN OFF ELECTRICAL POWER BEFORE STARTING INSTALLATION OF LIGHT FIXTURE.
2. THIS PRODUCT MUST BE INSTALLED IN ACCORDANCE WITH THE APPLICABLE INSTALLATION CODE BY A CERTIFIED ELECTRICIAN FAMILIAR WITH LOCAL MUNICIPAL CODES AND REQUIREMENTS.
3. CAUTION-RISK OF ELECTRIC SHOCK. CONSULT A QUALIFIED ELECTRICIAN TO ENSURE CORRECT BRANCH CIRCUIT CONDUCTOR.

PACKAGE CONTENTS

PART	DESCRIPTION	QTY
A	LED disc light	1
B	Mounting screws	2
C	Wire nut	3
D	Mounting plate	1

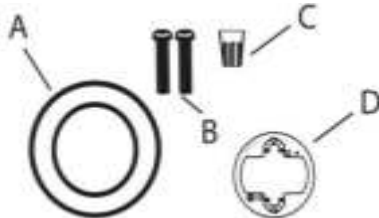

FLUSH MOUNT

This LED light is compatible to be dimmed by LEVITON# 6633, 6633-P, 6672, 6631, 6674, IPL06, LUTRON# DVCL-153P, MACL-153M, CTCL-153P, CTCL-153PD, TGCL-153P, DV-600P. Dimmer compatible for 120V line volt. 277V is non-dimmable. Dimming levels will vary by different dimmer.

WARNING: Wet-rated lighting fixtures are used in places with direct exposure to water. These locations include almost all outdoor lights, including landscape lighting such as path lights and ground wells. Fixtures rated for wet locations use waterproof seals to protect their internal components from moisture. This does not cover the section where the light is mounted to the junction box. If water is entering through the junction box, it will enter the light fixture, and that is classified as an electrical hazard by most municipal and fire departments.

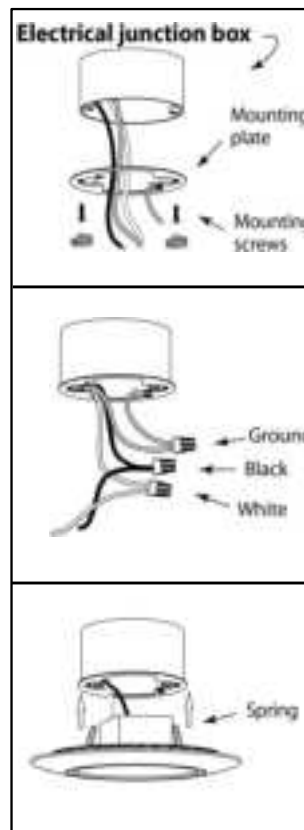

1. Prior to installation, install mounting plate into the electrical junction box with mounting screws. Drive screws completely to the end of the junction box.
2. Connect supply wires to wires on fixture with wire nuts. Connect white to white, black to black, and ground wire to ground wire as grounding connection.
3. Complete the installation by pushing the fixture springs towards the opening in the mounting plate installed on the junction box.

Made in China

Customer service: 888-945-5221

Do not return to the store.