

Bank wall light

INSTRUCTIONS

INCLUDED

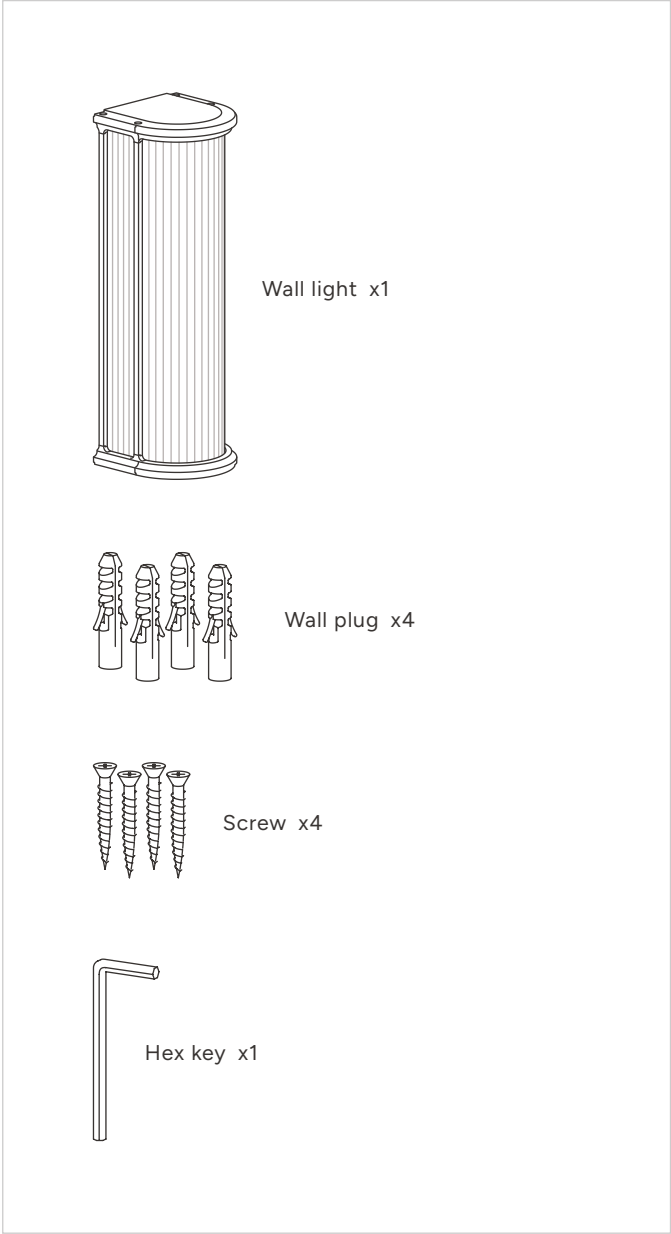

Location	Exterior
Class	Class II
IP rating	IP44
Driver required	No
Fire rating	No
Cable length	N/A
Bulb type	E27
Max wattage	12W
Bulb included	No
Switched	No
Dimmable	Bulb dependent
Rated voltage	230V-250V
Rated frequency	50-60Hz

## Bank wall light instructions

### TOOLS YOU'LL NEED

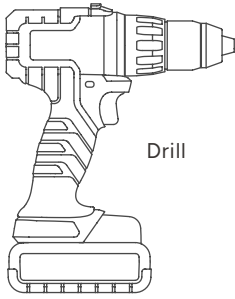

Drill



6mm drill bit

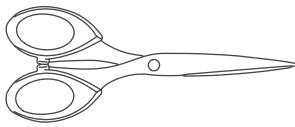

Clippers or scissors

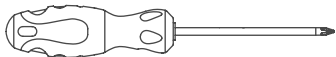

Crosshead screwdriver

## Bank wall light instructions

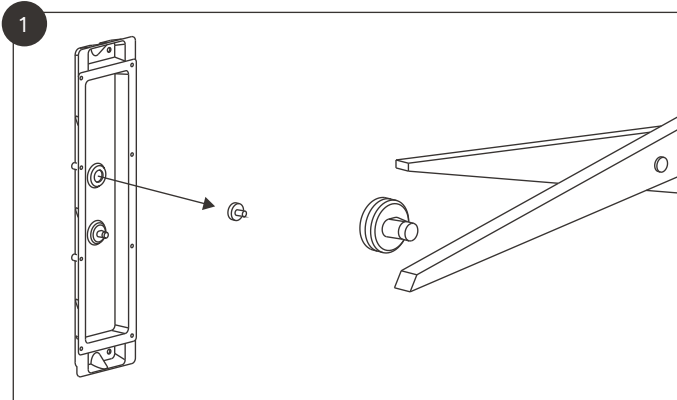

Remove the grommet to cut off the tip.

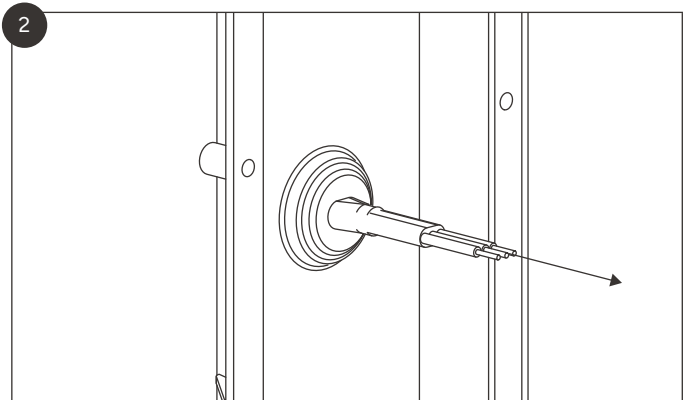

Put the grommet back in and push the wires through it.

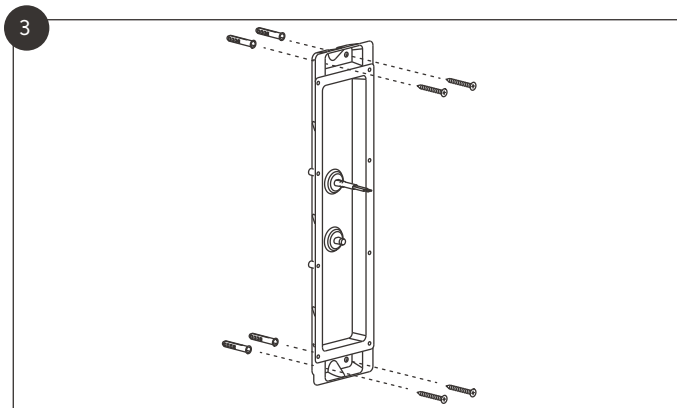

Use the wall plugs and screws provided to attach the mount to the wall.

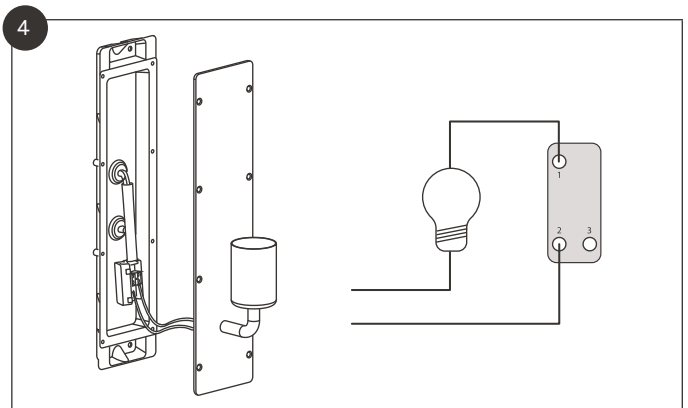

Make all electrical connections inside the terminal box.

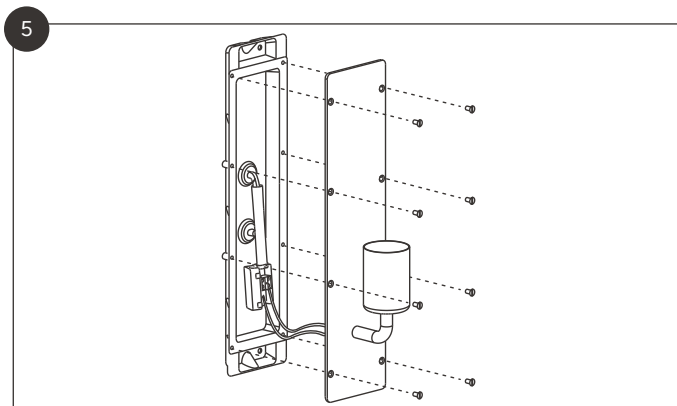

Using the facing screws provided to attach the front plate to the mount.

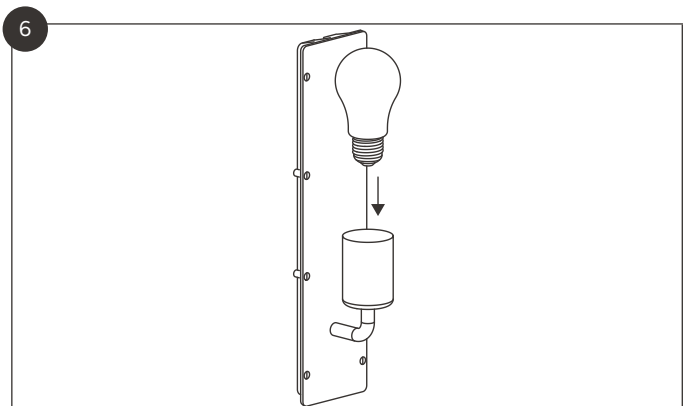

Insert the bulb.

## Bank wall light instructions

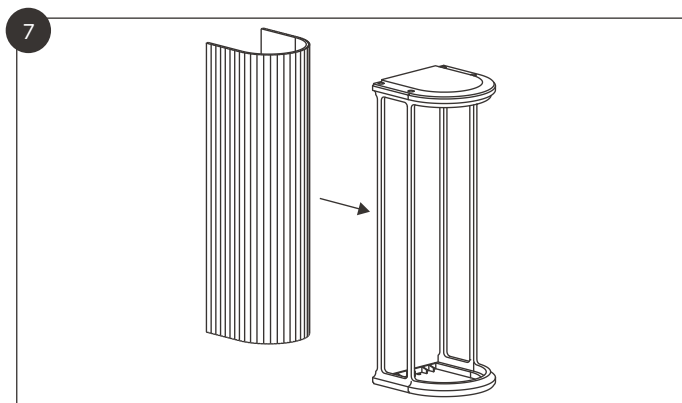

Insert the shade into the frame.

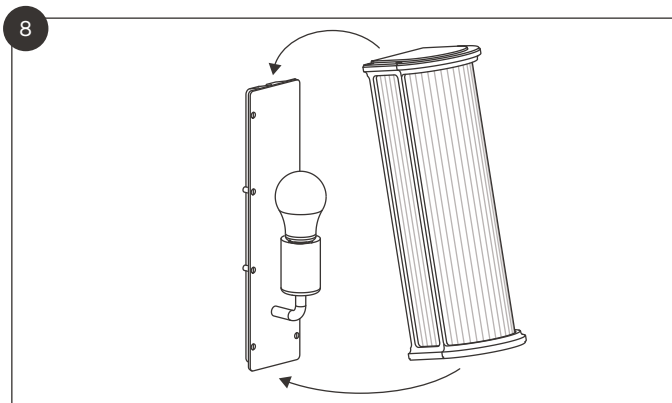

Hook the frame and shade onto the wall mount.

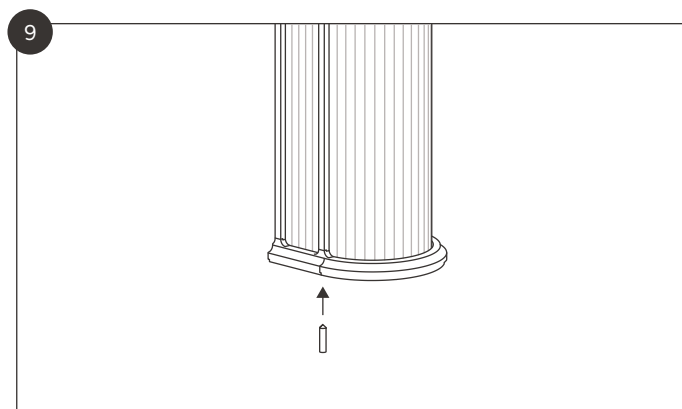

Tighten the grub screws to secure it in place.