



# Multi-Cyclonic Vacuum Cleaner

Model Number VC-460

## INSTRUCTION MANUAL

### AFTER SALES SUPPORT

1300 886 649  
AUS Hotline Costs

[info@tempo.org](mailto:info@tempo.org)

MODEL: VC-460 PRODUCT CODE: 42423 09/2014



# Contents

<b>01</b>	<b>Warranty Details</b>
<b>02</b>	<b>Welcome</b>
<b>03</b>	<b>General Safety Instructions</b>
<b>06</b>	<b>Product Overview</b>
<b>08</b>	<b>Getting Started</b>
<b>09</b>	<b>Instructions</b>
<b>15</b>	<b>Frequently Asked Questions</b>
<b>16</b>	<b>Other Useful Information</b>
<b>17</b>	<b>Repair and Refurbished Goods or Parts Notice</b>

---

## **AFTER SALES SUPPORT**

  1300 886 649  
AUS Hotline Costs

 [info@tempo.org](mailto:info@tempo.org)  
MODEL: VC-460 PRODUCT CODE:42423 09/2014



# STIRLING<sup>®</sup>

**Multi-Cyclonic Vacuum Cleaner**

## Warranty Details

---

The product is guaranteed to be free from defects in workmanship and parts for a period of 36 months from the date of purchase. Defects that occur within this warranty period, under normal use and care, will be repaired, replaced or refunded at our discretion, solely at our option with no charge for parts and labour. The benefits conferred by this warranty are in addition to all rights and remedies in respect of the product that the consumer has under the Competition and Consumer Act 2010 and similar state and territory laws.

Our goods come with guarantees that cannot be excluded under the Australian Consumer Law. You are entitled to a replacement or refund for a major failure and to compensation for any other reasonably foreseeable loss or damage. You are also entitled to have the goods repaired or replaced if the goods fail to be of acceptable quality and the failure does not amount to a major failure.

---

#### AFTER SALES SUPPORT

  1300 886 649  
AUS Hotline Costs

 [info@tempo.org](mailto:info@tempo.org)

MODEL: VC-460 PRODUCT CODE: 42423 09/2014



# Welcome

Congratulations on choosing to buy a STIRLING® product.

All products brought to you by STIRLING® are manufactured to the highest standards of performance and safety and, as part of our philosophy of customer service and satisfaction, are backed by our comprehensive 3 Year Warranty. We hope you will enjoy using your purchase for many years to come.

# General Safety Instructions

Read this manual thoroughly before first use, even if you are familiar with this type of product. The safety precautions enclosed herein reduce the risk of fire, electric shock and injury when correctly adhered to. Keep the manual in a safe place for future reference, along with the completed warranty card, purchase receipt and carton. If applicable, pass these instructions on to the next owner of the appliance.

Always follow basic safety precautions and accident prevention measures when using an electrical appliance, including the following:

## Electrical safety and cord handling

- **Correct voltage:** Make sure your local outlet voltage and circuit frequency correspond to the voltage indicated on the appliance rating label.
- **Safe connection:** Insert the plug firmly into a properly earthed mains socket. Do not alter the plug.
- **Protect from moisture:** To protect against electric shock, do not immerse the cord, plug or the appliance itself in water or other liquid. Ensure your hands are dry before handling the plug or switching on the appliance. Do not use it outdoors or on wet surfaces.
- **Protect the power cord.** Do not kink or damage the power cord. Do not wrap it around the appliance. Do not pull or carry the vacuum cleaner by the cord. Do not use the cord as a handle, close a door on the cord or pull the cord around sharp edges or corners. Do not run the vacuum cleaner over the cord. Keep the cord away from heated surfaces.
- **Disconnect after use:** Always switch off the appliance first and then unplug the cord from the outlet when you have finished vacuuming, before connecting or changing accessories and before emptying or cleaning the dust tank.
- **Cord retraction:** When unplugging, grab the plug, do not pull the cord. Then press the cord retraction button and hold the plug, guiding it back onto the cord reel to prevent whipping and causing injury or damage.

This vacuum cleaner is equipped with a plug and a power supply cord that automatically retracts. If anything is damaged, both the plug and the cord must be repaired by a qualified repairer or electrician.

- **Unattended:** Do not leave the vacuum cleaner unattended when plugged in.
- **RCD:** The installation of a residual current device (safety switch) is recommended to provide additional safety protection when using electrical appliances. It is advisable that a safety switch with a rated residual operating current not exceeding 30mA be installed in the electrical circuit supplying the appliance. See your electrician for professional advice.

---

## AFTER SALES SUPPORT

  1300 886 649  
AUS Hotline Costs

 [info@tempo.org](mailto:info@tempo.org)

MODEL: VC-460 PRODUCT CODE: 42423 09/2014

# General Safety Instructions (Cont.)

## Usage conditions and restrictions

- **Domestic use only:** This appliance is intended for indoor household use only. It is neither suitable for commercial/industrial nor for outdoor use.
- **Intended purpose:** Only use the vacuum cleaner on dry indoor surfaces, as described in this manual and with the original accessories supplied. Do not use it for any purpose other than described in this manual. Any other use is not recommended and may cause fire, electric shock or injury, or compromise the safety of the appliance and void the warranty.
- **Handle with caution:** These instructions are not intended to cover every possible condition and situation. As with any electrical household appliance, common sense and caution are therefore always recommended when installing, operating and maintaining the unit.
- **Accessories:** Improper installation and use of accessories that are not recommended in this manual may result in the risk of fire, electric shock and/or injury to persons.
- **Usage restrictions:** This appliance is not intended for use by persons (including children) with reduced physical, sensory or mental capabilities, or lack of experience and knowledge, unless they have been given supervision or instructions concerning use of the appliance by a person responsible for their safety.
- **Children:** This vacuum cleaner is not a toy. Supervise young children to ensure they do not play with the appliance. Close supervision is necessary when any appliance is used by or near children.
- **Prevent injury:** Keep hair, loose clothing, fingers and all parts of the body away from openings and moving parts. Keep openings away from moving parts. Do not point the vacuum cleaner at people or animals when in use.
- **Prevent blockage:** Do not put any objects into openings. Keep all openings free of dust, lint, hair or anything that may reduce the airflow. Do not use the product with any openings blocked or restricted airflow.
- **IMPORTANT:** If the suction opening, hose or telescopic tube is blocked, switch off the appliance and remove the blockage before restarting.
- **Protect the appliance:** Keep the vacuum cleaner away from heat sources (radiator, oven etc.), direct sunlight, moisture and sharp edges. Do not operate it too close to a heater.
- **Filter installation:** Do not use the product without the filters in place.
- **Stairs:** Take extra care when vacuuming on stairs.

# General Safety Instructions (Cont.)

- **Do not use the vacuum cleaner to pick up:**
  - Flammable or combustible fluids (such as fuel or solvent), burning substances (such as ash, cigarettes or hot coals) or use it in the presence of explosive liquids or vapours;
  - Hard or sharp objects such as shards of glass, nails, coins;
  - Harmful or toxic materials (such as chlorine bleach, ammonia, drain cleaner);
  - Any liquids, or vacuum in areas where liquids may be present.
- **After use:** Put the vacuum cleaner away after every use to prevent anyone tripping over it.
- **Cleaning:** Only clean the housing with a soft, dry cloth. Do not use liquid or aerosol cleaners.
- **Repair:** Never attempt to open the motor base of the vacuum cleaner yourself, or to replace the power cord. Only have the appliance repaired by an authorised technician, or contact the after sales support line for advice.
- **Storage:** Store the appliance in a cool, dry indoor area, out of reach of young children.
- **Damage:** Check the appliance and power cord regularly for visible damage. Do not use it if the cord or housing is damaged, if it has been dropped, damaged, left outdoors or dropped into water, or if it appears faulty.

A damaged cord must be replaced by the manufacturer, an authorised service centre or similarly qualified personnel in order to avoid any hazards.

**In case of damage, contact our after sales support line to arrange return or repair of the damaged product.**
- **Liability:** We accept no liability for any eventual damages or injury caused by noncompliance with these instructions.

# Product Overview

## The assembled vacuum cleaner





# Product Overview (Cont.)

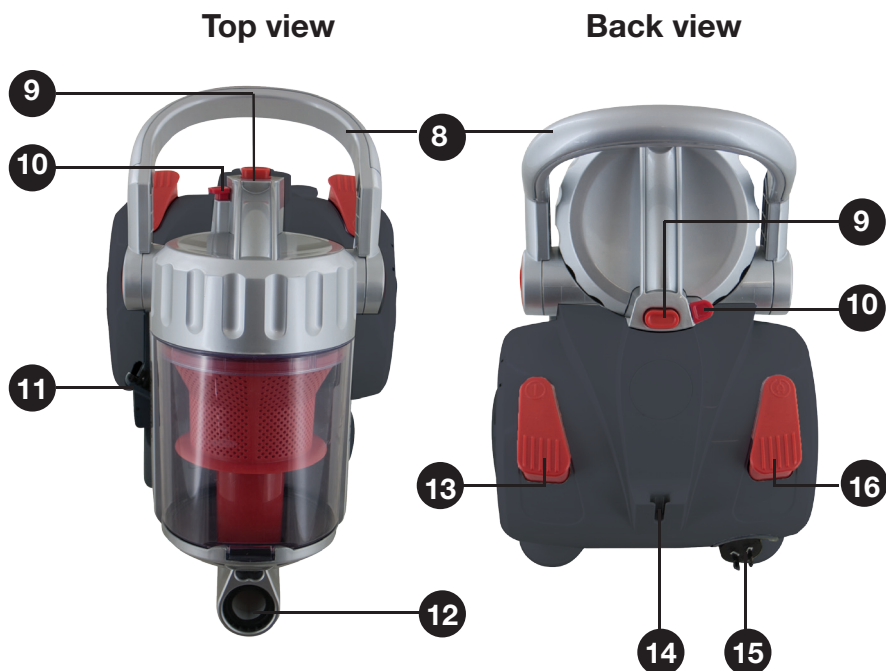

- 8 Carry handle
- 9 Dirt container release button
- 10 Flap release button
- 11 Crevice tool with fold out brush
- 12 Hose connection inlet
- 13 On/Off power switch pedal
- 14 Storage slot
- 15 Cord and plug
- 16 Cord retraction pedal

## AFTER SALES SUPPORT

 1300 886 649  
AUS Hotline Costs

 [info@tempo.org](mailto:info@tempo.org)

MODEL: VC-460 PRODUCT CODE: 42423 09/2014

# Getting Started

## Before first use

- Unpack the appliance but keep all packaging materials until you have made sure your new vacuum cleaner is undamaged and in good working order. Plastic wrapping can be a suffocation hazard for babies and young children, so ensure all packaging materials are out of their reach.
- Unwind the cord to its full length and inspect it for damage. Do not use the appliance if it is damaged. In case of damage, contact our after sales support line for advice on examination, repair or return of the damaged product.
- Read this manual to familiarise yourself with all the parts and operating principles of the vacuum cleaner. Pay particular attention to the safety instructions on the previous pages.

## Assembling the vacuum cleaner

**WARNING:** Make sure the vacuum cleaner is unplugged from the power outlet before assembling or removing any accessories.

1. Insert the flexible hose into the hose connection inlet (Fig. 1). Make sure the projected parts on the hose are aligned. Press the hose into the unit until it clicks into lock position.
2. Push the telescopic extension tube onto the end of the handle (Fig. 2, A).
3. Fit the dual function floor brush tightly onto the end of the extension tube (Fig. 2, B).
4. To adjust the telescopic tube length, push in the button (marked with an arrow in Fig. 2, C) and slide the tube apart or together.

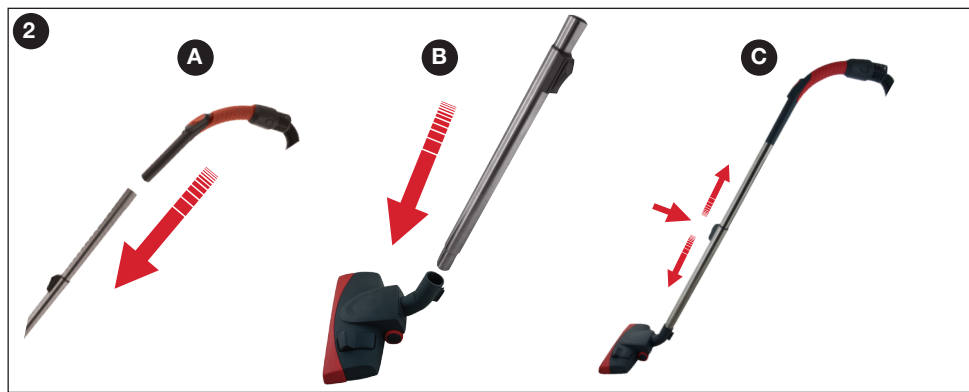

# Instructions

## Basic operations

### Cord release and rewind

- Holding the power plug (Fig. 3, A) firmly, pull it to fully unwind the cord. A yellow mark on the cord indicates the recommended cord length. Do not pull out the cord past the red mark.
- Position the cord so no one is likely to trip over it.
- To rewind the power cord, press the cord retraction pedal (Fig. 3, B).

**CAUTION:** Take care, the cord retracts very quickly. Guide it with one hand to prevent the cord from whipping, which could cause damage or injury.

### Switching on and off

- Insert the plug into a power point and press down the on/off pedal (Fig. 3, C) to switch on the vacuum cleaner.
- Press the pedal again to turn the vacuum cleaner off.

### Carpet and hard floor cleaning

- For carpet and rug cleaning, press the rocker switch on the dual function floor brush to raise the bristles (Fig. 4, A).
- When the bristles are raised, press the rocker switch to lower the bristles for vacuuming floor boards, tiles or other hard floor coverings (Fig. 4, B).

### Carry handle

- Use the carry handle (Fig. 3, D) to move the vacuum cleaner from room to room.

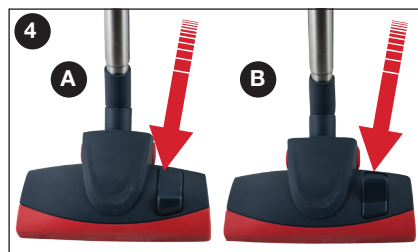
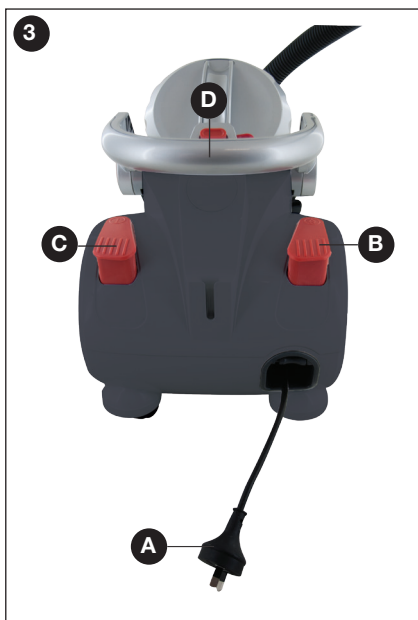

# Instructions (Cont.)

## Floor brush storage

- When moving or storing the vacuum cleaner, keep the floor brush conveniently attached in the storage slot (see the arrow in Fig. 5) at the rear of the appliance.

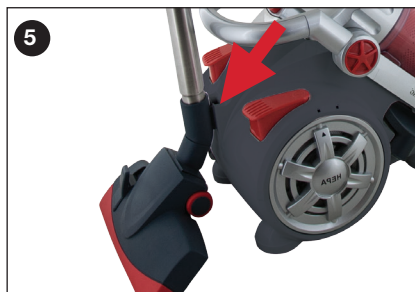

## Using the tools

- This vacuum cleaner comes with a small brush/upholstery tool (Fig. 6, B) and a dual use crevice tool with fold out brush (Fig. 6, A) for cleaning in tight spots such as in between furniture, radiators, corners, the car interior, or for vacuuming delicate curtains, books, furniture and lamps.
- Attach the tools straight to the flexible hose for cleaning items close by, or to the metal telescopic tube.

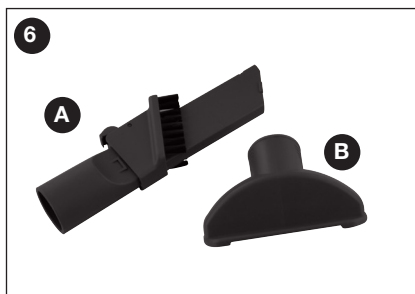

# Instructions (Cont.)

## Dirt container and filters

### IMPORTANT!

- Always unplug the vacuum cleaner from the electrical outlet before removing the dirt container.
- For consistent cleaning performance, we recommend you clean the filters every time you empty the dirt container.
- Only use the vacuum cleaner with all the filters in place.

### Emptying the dirt container

- Press down the dirt container release button on top of the dirt container (marked with an arrow in Fig. 7). Pull the container out of the vacuum cleaner towards you in arrow direction (Fig. 7).
- Hold the dirt container over a bin and press down the flap release button (marked with an arrow in Fig. 8) to empty the container.
- When all the dirt has fallen out, close the container flap until you hear it click into place. Then place the dirt container back onto the vacuum cleaner.



#### AFTER SALES SUPPORT

  1300 886 649  
AUS Hotline Costs

 [info@tempo.org](mailto:info@tempo.org)

MODEL: VC-460 PRODUCT CODE:42423 09/2014

# Instructions (Cont.)

## Cleaning the cyclonic separator

- Twist and pull the cover off the dirt container bin and take out the cyclonic separator, as illustrated below (Fig. 9).



- Clean the separator with a soft brush and wipe it with a damp cloth. If necessary, also wipe clean the dirt container bin.
- Leave the separator to dry completely before putting it back into place.
- **IMPORTANT:** Do NOT submerge the cyclonic separator in water.
- Replace the dirt container back into the vacuum cleaner body following the above directions in reverse order.

# Instructions (Cont.)

## Cleaning the HEPA filters

### IMPORTANT!

Always unplug the vacuum cleaner from the electrical outlet before maintenance.

### Pre-motor filter

- The pre-motor filter is located underneath the dirt container bin. Lightly push down the tab at the top to release the pre-motor filter cover (Fig. 10, A).
- Lift off the filter cover to gain access to the filter. Pull the tab towards you (Fig. 10, B) and remove the filter (Fig. 10, C).
- Separate the foam filter from the mesh cassette (Fig. 10, D). To remove excess dirt and dust, tap each filter against the side of a dust bin.
- If necessary, rinse the pre-motor filters in warm water (max. 40°C). Allow to air dry for 24 hours before replacing.

**NOTE:** Do not use any detergents or boiling water to wash the filter. We recommend you check and clean this filter periodically.

- Once completely dry, reinstall the pre-motor filters, cassette and the pre-motor filter cover before restarting the vacuum cleaner.



# Instructions (Cont.)

## Post-motor filter

- The post-motor filter is located on the rear wheel of the vacuum cleaner. Release the post-motor filter cover and remove it, as illustrated (Fig. 11, A).
- Remove the filter by pulling the tab towards you (Fig. 11, B).

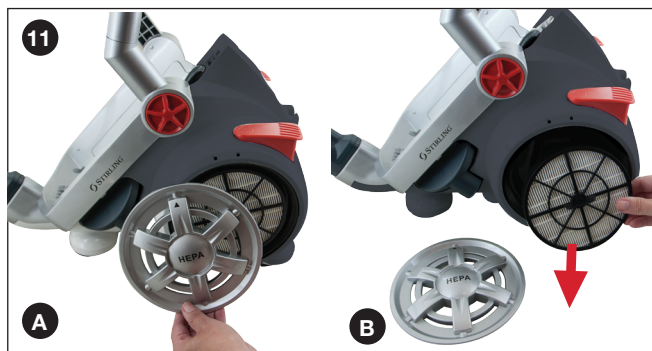

- To remove excess dirt and dust, tap the filter against the side of a dust bin.
- If necessary, rinse the post-motor filter in warm water (max. 40°C). Allow to air dry for 24 hours before replacing.  
**NOTE:** Do not use any detergents or boiling water to wash the filter. We recommend washing the filter every 9-12 months.
- Once completely dry, return the post-motor filter to the vacuum cleaner. Replace the post-motor filter cover before restarting the vacuum cleaner.

## Storage

- Put the vacuum cleaner away after every use to prevent anyone tripping over it. Make sure to unplug it from the electrical outlet and rewind the power cord.
- Store it indoors in a cool, dry area, out of reach of young children.
- Always store the vacuum cleaner base down.



# Frequently Asked Questions

## Troubleshooting guide

**WARNING:** Always unplug the cleaner before any maintenance checks.

Problem	Possible cause	Solution
The vacuum cleaner will not work.	It is not properly plugged into the electrical outlet.	Plug it in securely.
	There is no electricity in the electrical outlet.	Check the fuse or circuit breaker.
	Blown fuse/tripped circuit breaker.	Reset the breaker or replace the fuse.
	The on/off switch is not turned on.	Push down the power on/off pedal.
	The motor thermostat has tripped.	Switch off and unplug the vacuum cleaner and leave it unplugged for one hour before switching it back on.
The vacuum cleaner will not pick up / loss of suction.	The dirt container is not installed properly.	Check the dirt container assembly.
	The dirt container is full or blocked.	Empty the dirt container.
	The filters are clogged.	Remove and clean the filters according to the instructions on pages 8-10.
The accessories will not pick up properly.	The accessories are not attached correctly.	Ensure the accessories are attached properly.
	The flexible hose is not installed correctly.	Attach the hose properly.
Dust is escaping from the vacuum cleaner.	The dirt container is full.	Empty the container.
	The dirt container not installed correctly.	Check the dirt container assembly.
	The filter is not installed completely.	Remove and clean the filters according to the instructions on pages 8-10.

If the solutions above do not help you with the problem, or if you experience any other problems with your vacuum cleaner, do not try and manage them by yourself. Contact our after sales support line for advice on repair or replacement.

### AFTER SALES SUPPORT

  1300 886 649  
AUS Hotline Costs

 [info@tempo.org](mailto:info@tempo.org)

MODEL: VC-460 PRODUCT CODE: 42423 09/2014

# Other Useful Information

## Technical specifications

Voltage:	220-240V
Wattage:	1800-2000W (max.)
Dust bin capacity:	4L
Cord length:	8m
<b>Filters:</b>	Cyclonic separator (wipe clean) Pre-motor HEPA filter (washable) Post-motor HEPA filter (washable)

## Responsible disposal

At the end of its working life, do not throw this appliance out with your household rubbish. Electrical and electronic products contain substances that can have a detrimental effect on the environment and human health if disposed of inappropriately. Observe any local regulations regarding the disposal of electrical consumer goods and dispose of it appropriately for recycling. Contact your local authorities for advice on recycling facilities in your area.



# STIRLING<sup>®</sup>

Multi-Cyclonic Vacuum Cleaner

## Repair and Refurbished Goods or Parts Notice

---

Unfortunately, from time to time, faulty products are manufactured which need to be returned to the supplier for repair.

Please be aware that if your product is capable of retaining user-generated data (such as files stored on a computer hard drive, telephone numbers stored on a mobile telephone, songs stored on a portable media player, games saved on a games console or files stored on a USB memory stick) during the process of repair, some or all of your stored data may be lost. **We recommend you save this data elsewhere prior to sending the product for repair.**

You should also be aware that rather than repairing goods, we may replace them with refurbished goods of the same type or use refurbished parts in the repair process.

**Please be assured though, refurbished parts or replacements are only used where they meet ALDI's stringent quality specifications.**

If at any time you feel your repair is being handled unsatisfactorily, you may escalate your complaint. Please telephone us on 1300 886 649 or write to us at:

Tempo (Aust) Pty Ltd ABN 70 106 100 252  
PO BOX 6056 Frenchs Forest, Sydney, Australia NSW 2086  
Telephone: 1300 886 649 (Aust) - Fax: (02) 9975 2688  
Tempo Help Desk: 1300 886 649 (Aust)  
(Operating Hours: Mon-Fri 08:30am to 06:00pm EST)  
Email: [info@tempo.org](mailto:info@tempo.org)

---

### AFTER SALES SUPPORT

 1300 886 649  
AUS Hotline Costs

 [info@tempo.org](mailto:info@tempo.org)

MODEL: VC-460 PRODUCT CODE: 42423 09/2014

**3**

YEAR WARRANTY



## Warranty returns

Should you for any reason need to return this product for a warranty claim, make sure to include all accessories with the product.

## Product does not work?

If you encounter problems with this product, or if it fails to perform to your expectations, make sure to contact our After Sales Support Centre on 1300 886 649 before returning it to the store for a refund.