

TOURING ITEMS
TYPES

SMART LED FOG LIGHT SINGLE BEAM

WP ITM. LM533076
Care & Use Instructions

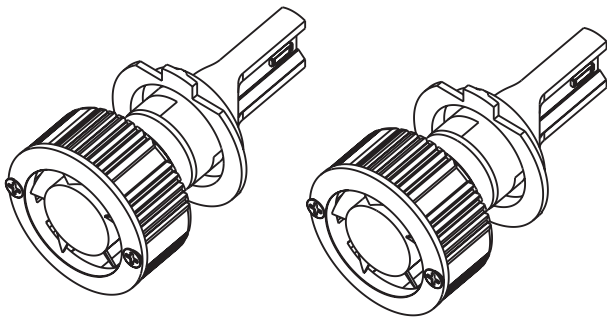

Important, retain for future reference:
Read carefully

*For Off-Road Use Only

PACKAGE INCLUDES

- 2 x UltraBright Fog Light LEDs
- 1 x Smart Hub
- 2 x Mounting Rings (Pre-Installed)
- 1 x 3M VHB™ Double-Sided Tape (For Smart Hub)
- 4 x Cable Ties
- 1 x Manual
- 1 x Warranty Card

SPECIFICATIONS

LED Quantity:	2 x White LEDs 2 x Multi-Color LEDs
LED Lifespan:	50,000 Hours
Operation Voltage:	12V
Operation Temperature:	32°F to 140°F (0°C to 60°C)
Current:	2.3A @12V
Color Temperature:	6,500K
Lumens (Effective):	1,800LM
Cable Length:	3.9 inches (10cm)
Cable Length From LED Lamp To Connector:	19.7 inches (0.5m)
Cable Length From Connector To Controller:	59 inches (1.5m)
Cable Length From Controller To Hardwire:	39.4 inches (1m)

PRODUCT OVERVIEW

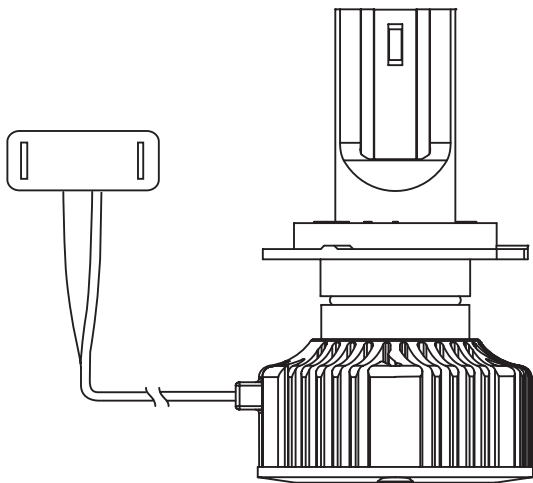

H7

FOG LIGHT INSTALLATION

Due to differences in dust covers and lighting assemblies, installation methods may vary depending on your specific vehicle make and model. Review the owner's manual of your vehicle or consult a professional if needed.

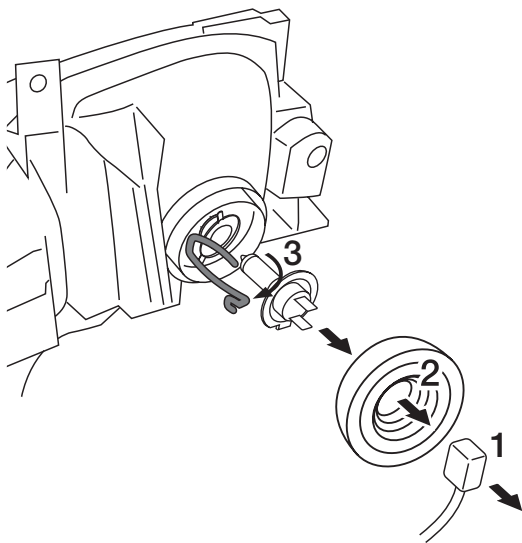

1. Disconnect the Fog Light connector.
2. Remove the headlight dust cover.
3. Release the metal spring and remove the original light bulb and its mounting ring.

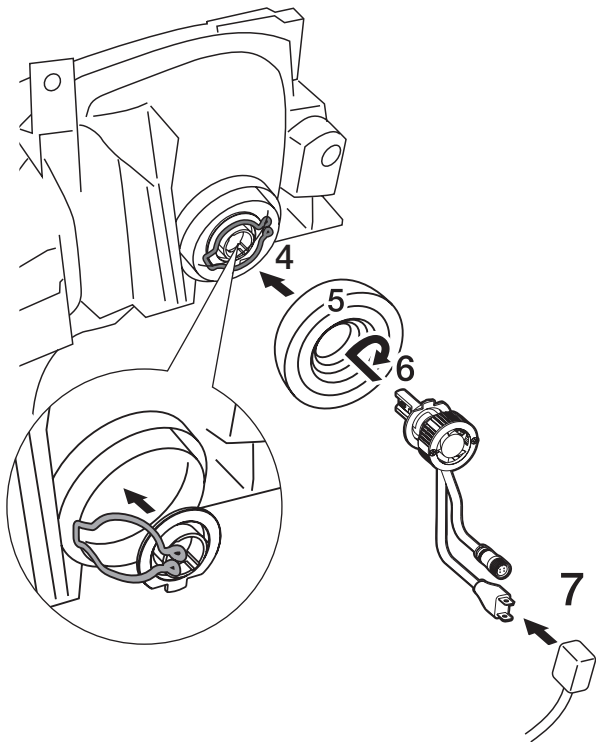

4. Insert the mounting ring into the socket and affix it with the metal spring.
5. Reassemble the dust cover.
6. Insert the Fog Light body into the socket and rotate clockwise to secure.
7. Connect the plug to the Fog Light connector.

8. Turn on the Fog Light. Make sure it is lighted and the beam is properly directed.

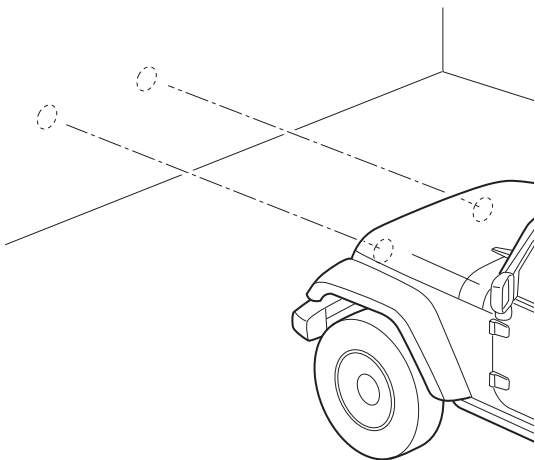

NOTES

- Some vehicles require the engine to be started for operation of all beams. If the LED light does not turn on, then rotate plug and try again.
- The headlight dust covers of some vehicles may not be put back successfully after the Fog Lights are installed. Look for the correct third party dust covers as a replacement.
- This Fog Light fits exclusively to 12V vehicle input.
- When handling and installing the Fog Lights, DO NOT touch the LED chips with your fingers to avoid injury.
- Try not to block or obstruct air flow of cooling fan.
- The fan heat sink can get very hot. Try to keep wires from touching the heat sink.
- Before installing, please make sure the Fog Lights are free from damage, fracture and no impurities on the LED chip.
- For additional installation and product information, visit www.typesauto.com.

SMART HUB INSTALLATION

- a. Connect the Fog Lights to the Smart Hub using the directional 4-pin connectors. Make sure to connect to the correct position and fasten each end of the cap. Route cables away from engine.



- b. Peel off the 3M VHB™ double-sided tape backer and affix the Smart Hub to a flat surface. Make sure it is positioned away from the car engine, areas with high heat, or any moving parts. Utilize cable ties to neatly secure all wiring, keeping them clear of any moving components.

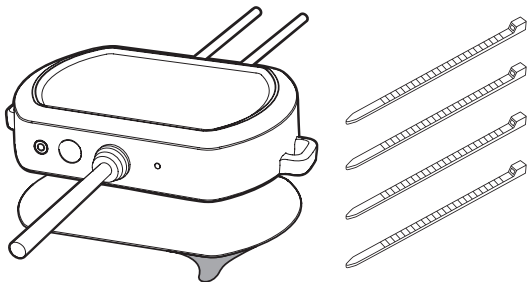

- c. Smart Hub hardwire cables are color coded, **RED** for POSITIVE (+) and **BLACK** for NEGATIVE (-).

Connect the **RED** cable to the POSITIVE (+) battery clamp. The POSITIVE battery post will be slightly larger than the NEGATIVE post, and will be marked with a PLUS (+) sign. There may also be a RED protective cover over the positive battery post.

Connect the **BLACK** cable to the NEGATIVE (-) battery clamp. The NEGATIVE will be marked with a MINUS (-) sign. There may also be a BLACK protective cover over the negative battery post.

WARNING: DO NOT mix up the cables or allow the metal ends to touch together because this may damage the battery, charging system and/or electronics on your vehicle. When installing, please make sure the battery is disconnected.

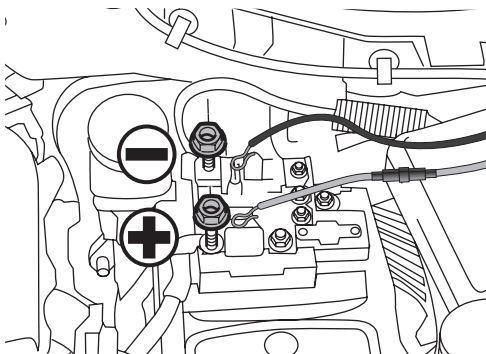

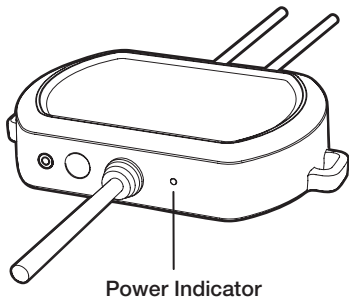

NOTE: After connecting the Smart Hub to the car battery, the blue power indicator should begin flashing. If it does not, inspect your power connections for any issues.

The Smart Hub is equipped with built-in voltage protection to prevent the car battery from draining if the Fog Lights are accidentally left on. When the voltage falls to approximately 11V, the blue power indicator will flash every half second. The Fog Lights will automatically turn off, and the Smart Hub will switch to standby mode. Do not turn the Fog Lights back on until the engine is restarted or the voltage rises to 12V or higher.

APP INSTALLATION

The auto-sync feature in the TYPE S LED App allows you to manage the Fog Light's functions from your phone. To access this feature, scan the QR code below or search for "TYPE S LED" on the App Store or Google Play. Download and install the App.



TYPE S LED



Compatible with iPhone, iPad, Mac and iPod touch running iOS 14 or higher.



Compatible with devices running Android™ 9.0 or higher.

NOTE: Not all Android™ phones are equipped with Bluetooth® v4.2 required for this application.

USING THE APP

Choose “SMART EXTERIOR” to begin. The App will seamlessly connect to the Smart Hub as soon as the Fog Lights are powered on and fall within the 30-foot Bluetooth® range. For added security, it is recommended to configure a personal password upon initial connection to prevent unauthorized devices from connecting to the Smart Hub.

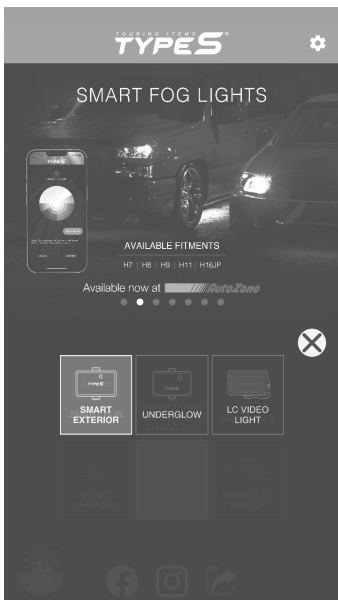
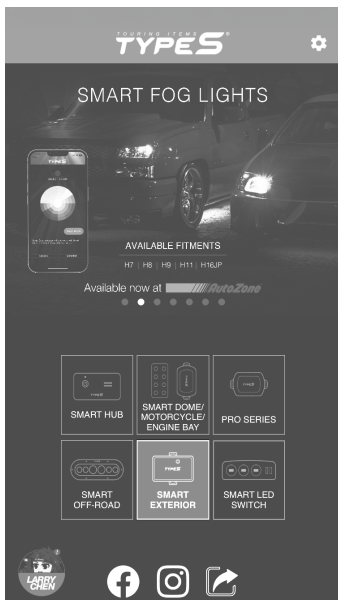

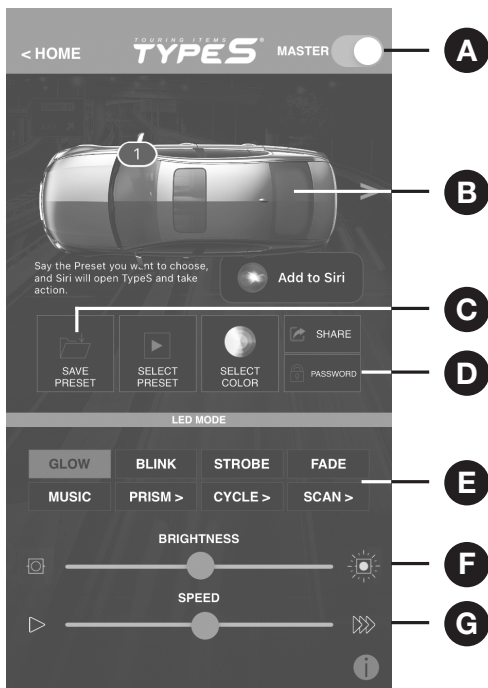

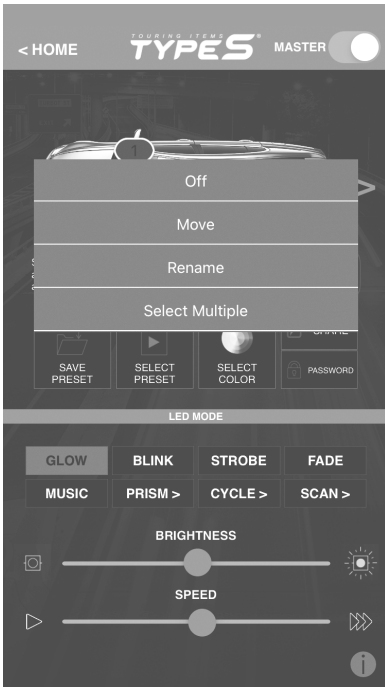

A. Master On/Off Switch

Toggle switch to turn Fog lights On or Off.

B. LED Zone Functions

Press and hold the zone icon to bring up the following settings under each zone:

- Off
- Move
- Rename
- Select Multiple

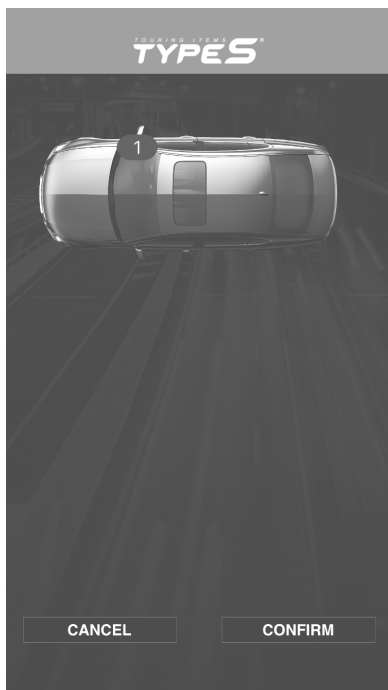

Zone On/Off: Click each zone icon to turn Fog Lights On or Off.

Move Zone Icon: Select "Move" to position each zone icon at your desired location, then confirm the placement.

Rename Zone Icon: Select "Rename" to assign a name to each zone, with a maximum of 4 characters.

Select Multiple: To control multiple zones simultaneously, click "Select Multiple", then choose your desired zones and confirm the selection. To undo your selection, press and hold the zone icon and select "Ungroup".



C. Preset Functions

Save Preset: After configuring your settings, click “SAVE PRESET” and enter a name to retain the settings. You can store up to 10 presets.

Select Preset: To retrieve the saved settings, click “SELECT PRESET” and choose your desired preset.

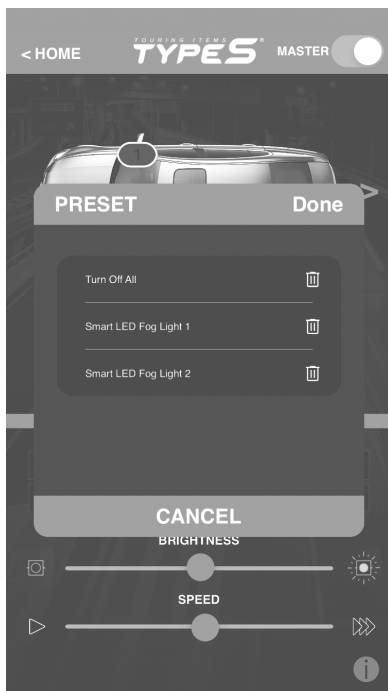

Delete Saved Preset:

To delete a saved preset, click "SELECT PRESET", then choose "Edit".

Click  next to preset you wish to delete and confirm the erase.

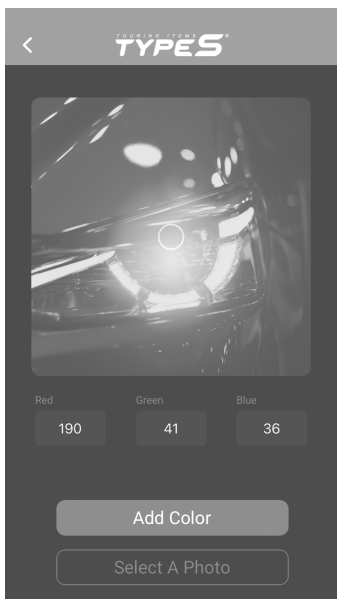
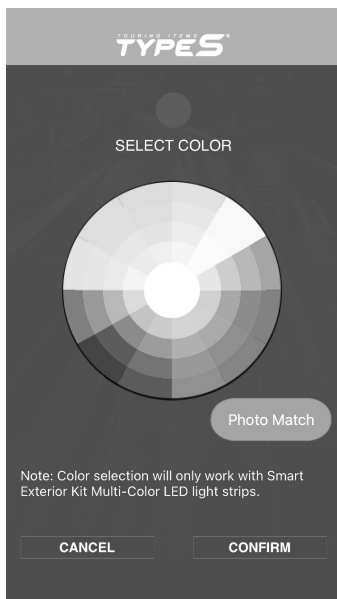

Select Color: Click “Select Color” to choose from the 49 existing presets.

Alternatively, click “Photo Match”. You can use the camera to capture the desired color, or import a photo from your smart device and tap on the area where you want to color match with your Fog Lights. Add the color and confirm your selection.

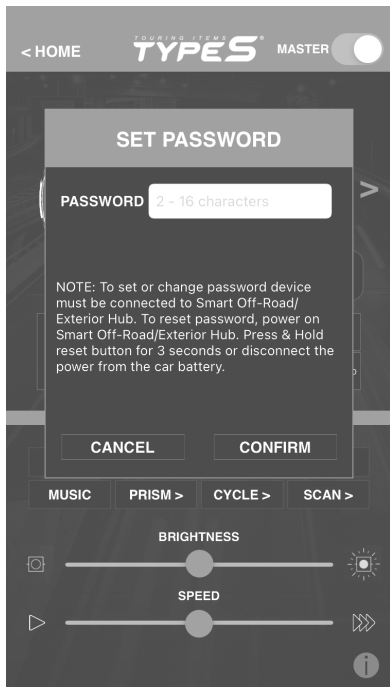

D. Password

Follow the on-screen instructions to set up a password. This can prevent other devices from controlling your Fog Lights. Once entered, the password will be saved in the App and the Smart Hub.

NOTE: To set or revise the password, your device must be connected to the Smart Hub. Failure to do so may result in an invalid password the next time you access the system. If you forget your password, simply reset by clicking the reset button on the Smart Hub for 5 seconds or disconnect it from the car battery.

Reset Button

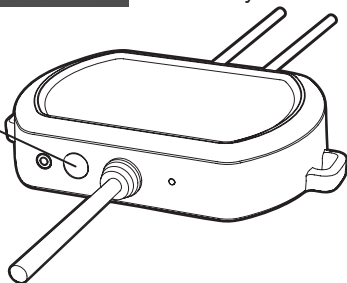



E. LED Modes

Choose from the 25 existing modes.

NOTE: Smart LED Fog Light does not support SCAN Mode.

F. Brightness

Slide bar to adjust brightness.

G. Speed

Slide bar to adjust the speed at which lighting transitions in each LED mode.

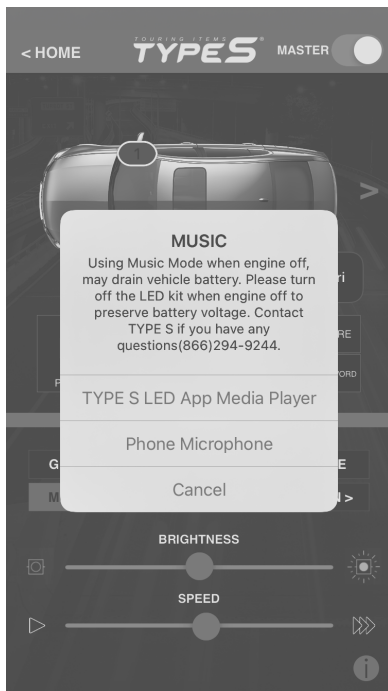

Sync lights with the music beat

Music Mode offers two ways to sync the lighting tempo with your music:

- 1) Through locally downloaded music files, or
- 2) Through an enabled microphone on the smart device.

Click “TYPE S LED App Media Player” to access and select tracks from your music library, or click “Phone Microphone” to enable your smart device’s microphone. It will capture audio played from another source or device.

Due to copyright restrictions, Music Mode is not compatible with streaming services like Apple Music, Spotify, Pandora, YouTube, etc. Even if music files are saved on your smart device from a streaming service, Music Mode will not work. A TYPE S LED App update will be provided once streaming service support becomes available.

CAUTION: When using Music Mode, ensure the engine is running. Low voltage battery protection is temporarily disabled during Music Mode, and will be reactivated once you manually close or disconnect the TYPE S LED App.

IMPORTANT SAFETY INSTRUCTIONS

1. **SAVE THESE INSTRUCTIONS** - This manual contains important safety and operating instructions for Smart LED Fog Light Model LM533076.
2. **NEVER** use the App while operating your vehicle. Use the App when vehicle is stationary only.
3. Before using the Smart LED Fog Light, read all instructions and cautionary markings to ensure the product is properly & safely installed.
4. Do not expose Smart LED Fog Light to rain, moisture, or snow.
5. Use of an attachment not recommended or sold by the Smart LED Fog Light manufacturer may result in a risk of fire, electric shock, or injury to persons.
6. Do not operate with damaged cords.
7. Do not disassemble Smart LED Fog Light; take it to a qualified serviceperson when service or repair is required. Incorrect reassembly may result in a risk of electric shock or fire.
8. To reduce risk of electric shock, disconnect all power before attempting any maintenance or cleaning. Turning off the lights will not reduce this risk.

WARNINGS

- Caution! If you get an error code, or lights are flickering, use a decoder to complete the installation. Decoder is sold separately.
- Considering the high intensity of light, DO NOT stare at the light when it is switched on.
- The surface of the LED will reach very high temperature when it is turned on. DO NOT touch the surface directly to avoid severe burns.
- Before changing the original Fog Lights, make sure it is turned off and cooled.
- Keep LED chips of the Smart LED Fog Light free of dust and oil.
- Check your state or provincial laws before installing. Vehicle owner must comply with all applicable laws.
- This product is intended solely for Off-road/Fog light purposes.
- The manufacturer and seller assume no liability for installation or use, which are solely the responsibility of the purchaser.
- This product is not DOT approved and is designed and intended for Off-road/Fog light uses only.
- Do not install or use product if it, in any way, impairs the safe operation of your vehicle. Not for use in extreme temperature.

- The manufacturer and seller are not responsible or liable for consequential, incidental, or indirect damages, whether to person or property, resulting from the installation or improper use of this product.

FCC COMPLIANCE STATEMENT

This device complies with Part 15 of the FCC rules. Operation is subject to the following two conditions: (1) This device may not cause harmful interference, and (2) this device must accept any interference received, including interference that may cause undesired operation.

WARNING: Changes or modifications to this unit not expressly approved by the party responsible for compliance could void the user's authority to operate the equipment. The manufacturer is not responsible for any radio or TV interference caused by unauthorized modifications or change to this equipment. Such modifications or change could void the user's authority to operate the equipment.

NOTE: This equipment has been tested and found to comply with the limits for a Class B digital device, pursuant to part 15 of the FCC Rules. These limits are designed to provide reasonable protection against harmful interference in a residential installation. This equipment generates uses and can radiate radio frequency energy and, if not installed and used in accordance with the instructions, may cause harmful interference to radio communications. However, there is no guarantee that interference will not occur in a particular installation. If this equipment does cause harmful interference to radio or television reception, which can be determined by turning the equipment off and on, the user is encouraged to try to correct the interference by one or more of the following measures:

- Reorient or relocate the receiving antenna.
- Increase the separation between the equipment and receiver.
- Connect the equipment into an outlet on a circuit different from that to which the receiver is connected.
- Consult the dealer or an experienced radio/TV technician for help.

This equipment complies with FCC RF radiation exposure limits set forth for an uncontrolled environment. In order to avoid the possibility of exceeding the FCC radio frequency exposure limits, human proximity to the antenna shall not be less than 20cm during normal operation.

⚠ WARNING: This product can expose you to chemicals including Di(2-ethylhexyl)phthalate (DEHP) and Diisononyl phthalate (DINP), which are known to the State of California to cause cancer and birth defects or other reproductive harm. For more information go to www.P65Warnings.ca.gov.

The Bluetooth® word mark and logos are registered trademarks owned by the Bluetooth SIG, Inc. and any use of such marks by Horizon Brands is under license. Other trademarks and trade names are those of their respective owners.

Android is a trademark of Google Inc.

iPhone, iPad, Mac and iPod touch are trademarks of Apple Inc.

3M VHB™ is a trademark of 3M company.



A Horizon Brands Company
2975 Red Hill Ave., Ste. 100, Costa Mesa, CA 92626
1.866.294.9244 | info@typesauto.com
©2025 TYPE S. All rights reserved.
www.typesauto.com

CONNECT
WITH US



@TypeSAuto